



# Büssing Nag L4500S

## 4X2 Cargo Truck



In mid-1930s, to lessen logistics burden, the German Army tried to standardize the chassis for truck. Three levels-light, medium, and heavy, chassis were standardized so that motor manufacturers can utilize their own engines and gearboxes on said standardized chassis. Five major standardized chassis were completed.

Established in 1903, Büssing-NAG mainly produced buses and trucks in Germany. Expropriated by the government in 1933, the company was made dedicated to produce over 4.5-ton military trucks. The lightest ones among this series, 500A (4-wheel drive) and 500S (2-wheel drive), both utilized 150 HP 6-cylinder diesel engines. Produced from 1938 to 1941, German Army standardized chassis and driver compartment were adopted. Derivative models, 4500A and 4500S were introduced in 1942. Based on identical specification to 500A/S, 4500A/S might have slight differentials in appearance. To fulfill various combat needs, there were further specialized modifications based on 4500A/S chassis. There were several simplified models on later stage in the war to save up material and production procedure.

The production for Büssing-NAG 4500A/S did not cease until end of the war, and a total of 15000 was produced for all 500 and 4500 series.

1930年代の中ごろ、ドイツ陸軍は輸送負担の軽減を目的とし、軍用トラックのシャーシ規格統一に着手した。すなわち、軽・中・重の3段階の規格が設定され、主要な5種類の規格統一されたシャーシが用意された。自動車メーカーは、自社のエンジンとギアボックスを、これらの規格シャーシに搭載したのである。

ビューッシング-NAG社は、1903年に設立された主にバスやトラックを製造するメーカーであった。1933年にドイツ政府によって収用され、以降同社は4.5トンの軍用トラックの製造に専念するようになった。その系列の中で最も軽量なものが500A(4輪駆動)と500S(2輪駆動)で、どちらも150馬力・6気筒ディーゼルエンジンを搭載、ドイツ陸軍によって規格されたシャーシと運転席を利用し、1938年から1941年まで製造された。そこから派生したモデルが4500Aと4500Sで、1942年に製造が始められた。500A/Sと同じ仕様に基づいているので、外見上はわずかな違いしかなかった。戦闘での様々なニーズに応えるため、4500A/Sをベースとしてさらに特殊な改造を施したタイプが数多く存在したのである。また後期には資材の節約と製造工程の短縮のために、簡易型モデルも生産された。

ビューッシング-NAG 4500A/Sの生産は終戦まで続けられ、総計15000輛ものの500/4500シリーズが製造されたのだった。



在20世紀30年代中期，為了減輕後勤作業的負擔，德國嘗試建立軍用載重車輛底盤的標準化，將適應不同需求的輕、中、重型載重車輛底盤各自予以標準化，來提供不同的汽車公司安裝自己的發動機與變速箱等組件，在這樣的要求下完成了五種主要的標準化卡車底盤。

Bussing-NAG是德國一所設立於1903年專門生產公共汽車與載重卡車的公司，二戰爆發前的1933年起為軍方徵用，專門生產載重達到4.5噸以上的軍用載重車。此一系列中最為輕量的車輛為四輪驅動的500A型，與二輪驅動的500S型，都採用了105匹馬力六汽缸的柴油引擎，生產期由1938年至1941年間，組件中使用了德軍標準化的底盤及駕駛室，1942年出現了這兩款車型的後繼型號，分別是4500A與4500S，與500A/S幾乎基於相同的技術規格，在外觀上也僅有稍許的差異，為了戰場上各種不同的需求，同時產生許多利用4500A/S為載台而衍生的特殊車輛。隨著戰事的進行，為了節省材料與生產工序的簡化，大戰後期又出現了幾款型式簡化的4500A/S。

Bussing-NAG 4500A/S的生產線一直持續至1945年大戰結束為止，500與4500各型車輛的生產數量達到約15000輛之譜。

### Illustration:圖示說明



### Method For Applying Decals:

1. Clean Model Surface With Wet Cloth.
2. Cut Out Of Decal Sheet And Dip Them In Warm Water For 10 Seconds.
3. Place it on proper position on model.
4. Slide off base paper leaving decals On Model With Wet Finger Tip.
5. Move Decals To Exact Position, Push Out Excess Water Under Decal With Soft Cotton Cloth.
6. When Decals Get Dry Then Complete.

### 水貼紙使用說明:

1. 將模型表面擦乾淨
2. 將貼紙剪下泡入溫水中浸泡約15秒
3. 將泡濕之貼紙取出置於欲貼處旁
4. 用指尖輕推貼紙表面使其滑出底紙
5. 將貼紙調整至適當位置並輕擦拭水份
6. 待其自然乾燥後即完成

### Color list: 塗料表

Color	Brand	Gunze Sangyo			Humbrol	Revell	Lifecolor
		Hobby Color	Mr.Color	Mr.Color Spray			
German gray	德國灰	H32	C40	J40	92	79	UA073
Red	紅	H3	C3	J3	19	31	LC56
Red brown	紅褐	H47	C41	J41	160	383	UA085
Sandy yellow	砂黃	H79	C39	J39	83	16	UA081
Silver	銀	H8	C8	J8	11	90	LC74
Steel	黑鐵	H18	C28	J28	53	91	LC76
Tire black	輪胎黑	H77	C33+C62		85	302	LC02
Wood brown	木棕	H37	C43		169		FS12
Yellow FS13538	黃	H329	C329		188		LC53



## Büssing-NAG Type L4500

The German Army standardized heavy field trucks to 4.5-ton

There were some variations:

Model 454 (platform 5m)

Model 354 (platform 4m)

2-wheel drive (Type S)

4-wheel drive (Type A)



L500S

4x2 wheel drive

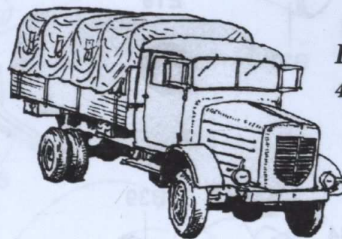

L500A

4x4 wheel drive

### 4.5-ton heavy truck

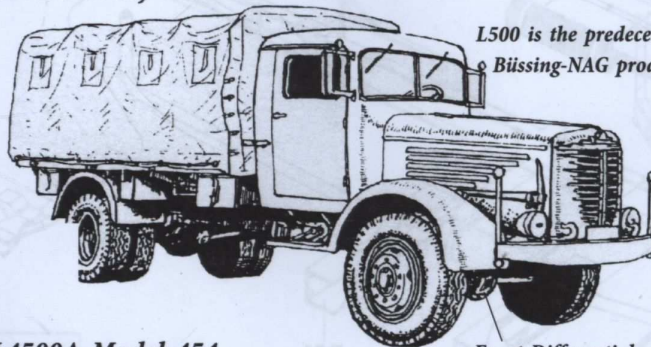

L500 is the predecessor of L4500.

Büssing-NAG produced more than 15000 of those in WWII.



Kfz 415

flak truck (Flakmesstruppkraftwagen)

### L4500A Model 454

Type A, 4x4 wheel drive

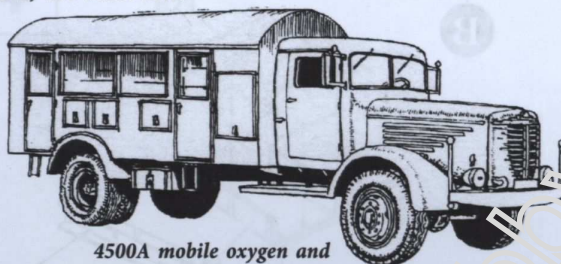

4500A mobile oxygen and nitrogen generator Kfz 4500A

Front Differential

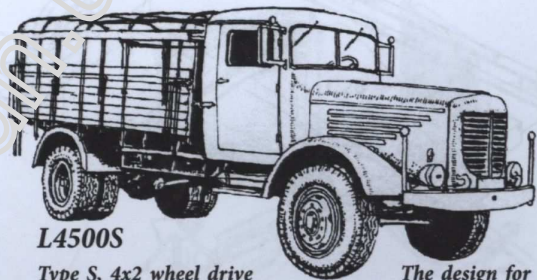

L4500S

Type S, 4x2 wheel drive

The design for

Radiator Grille and bonnet was simplified in late production.

### Kfz.100 Crane truck

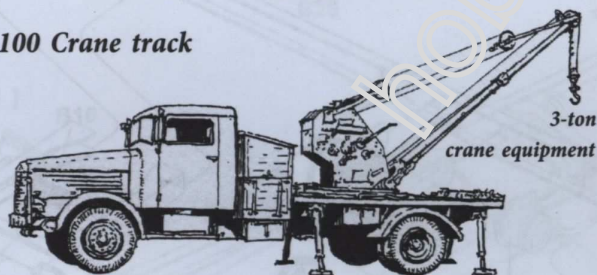

3-ton crane equipment

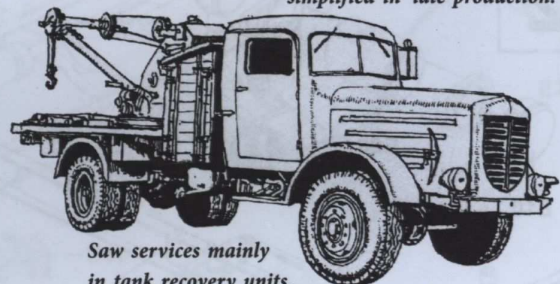

Saw services mainly in tank recovery units.

### Armored self-propelled anti-aircraft truck

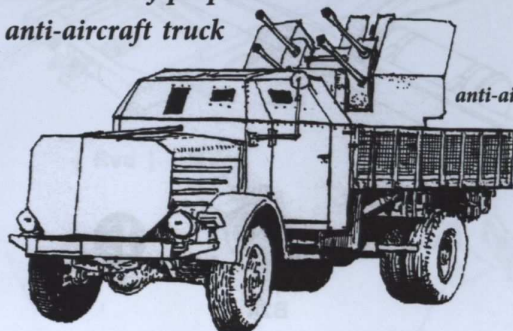

Quad 20 mm anti-aircraft gun version

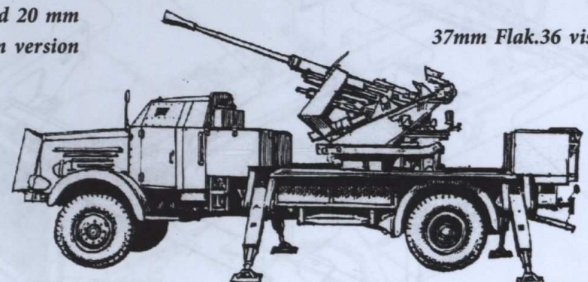

37mm Flak.36 vision

L4500A was adopted mainly as the chassis. Saw services in Normandy campaign.

Shin. ueda  
上田 信



1

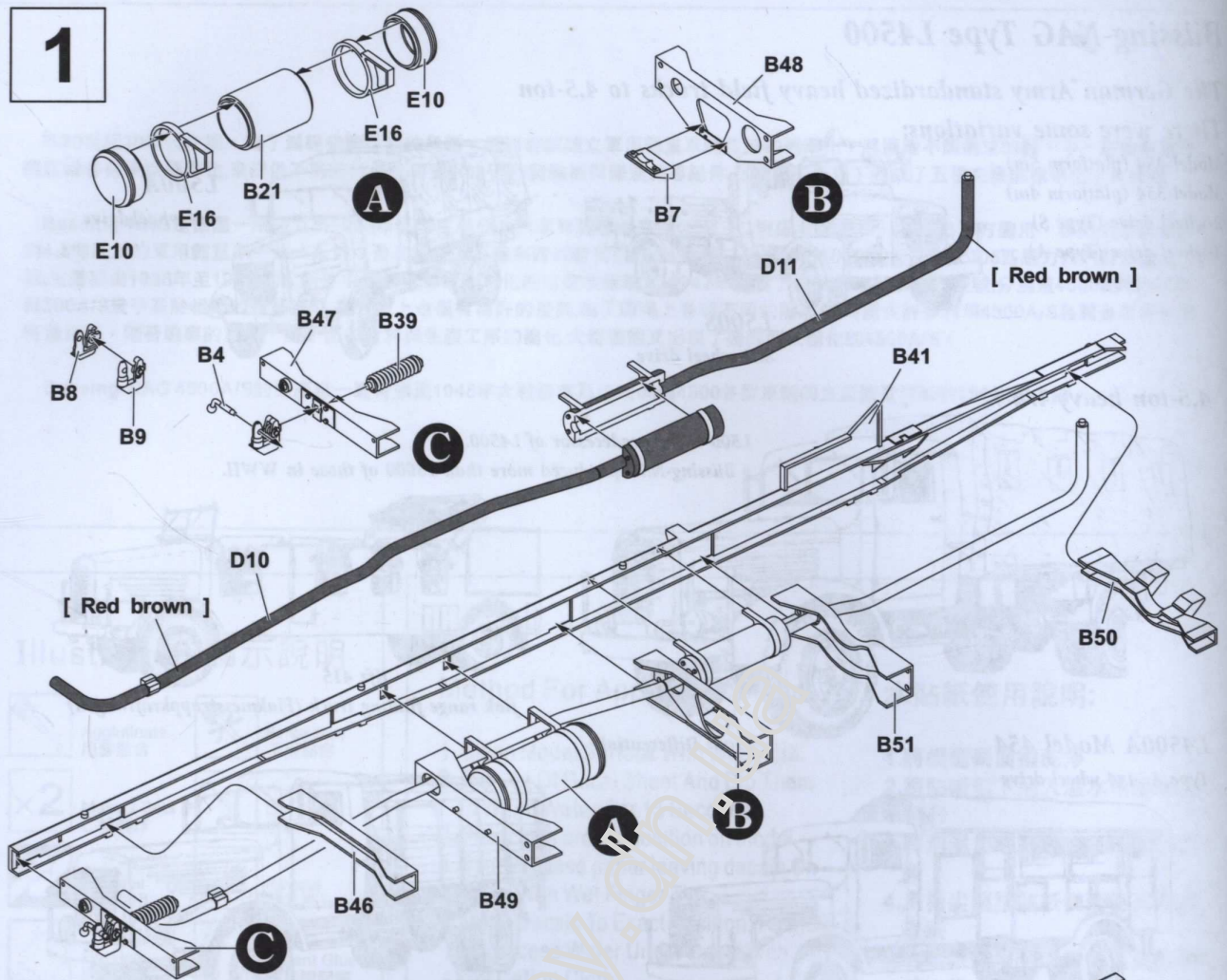

2

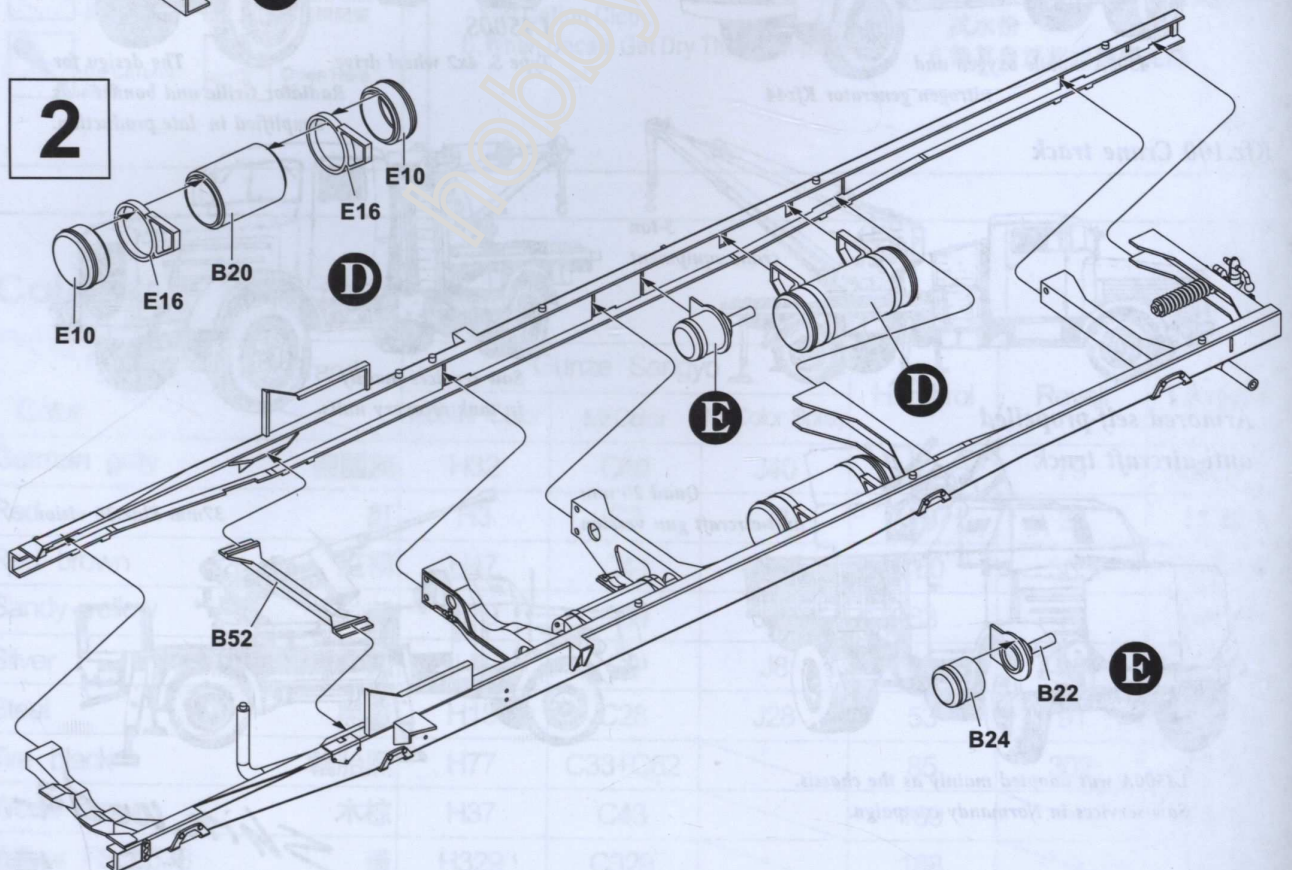



3

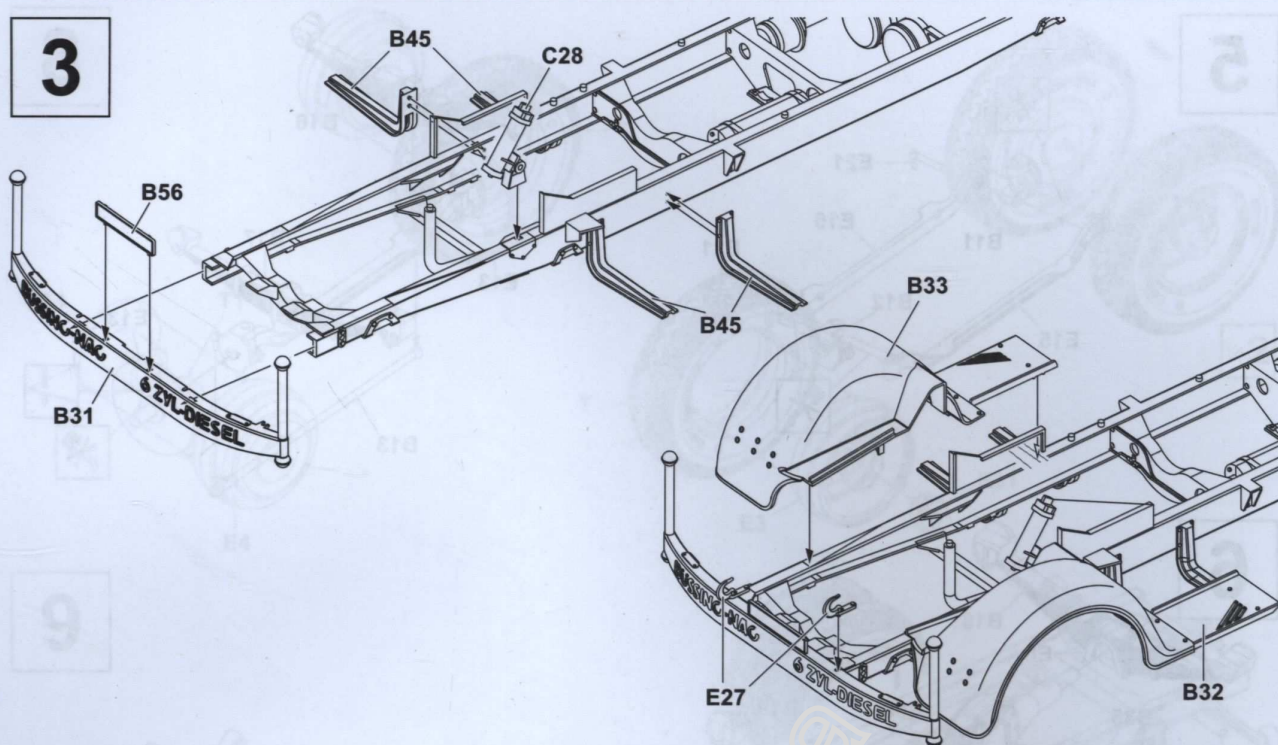

4

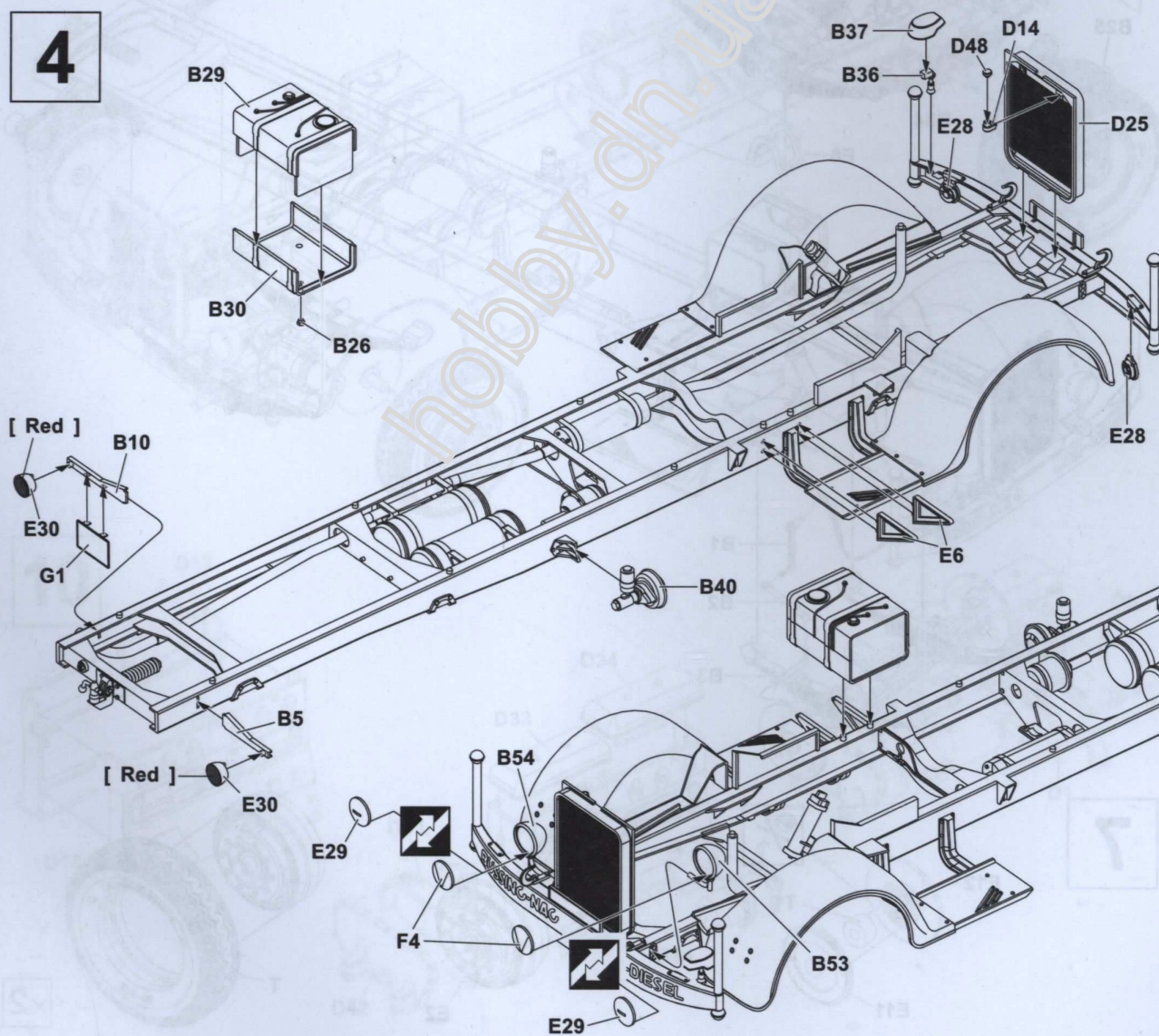



5

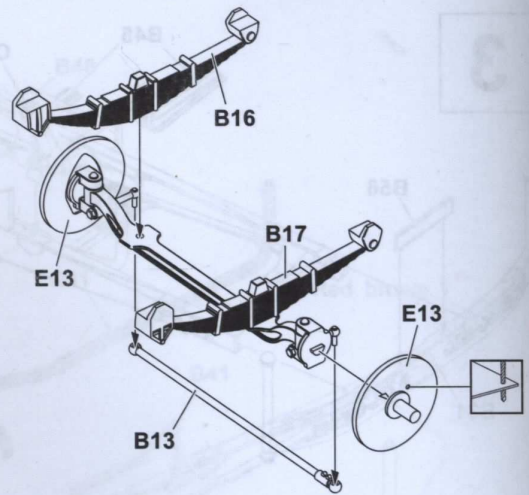
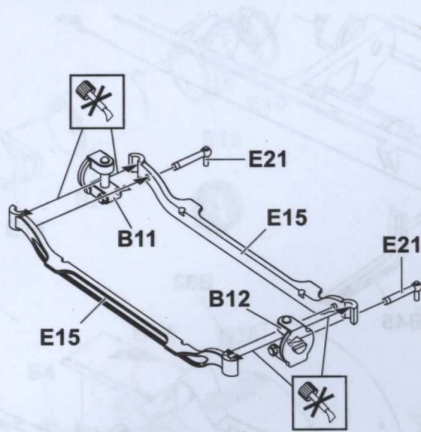

6

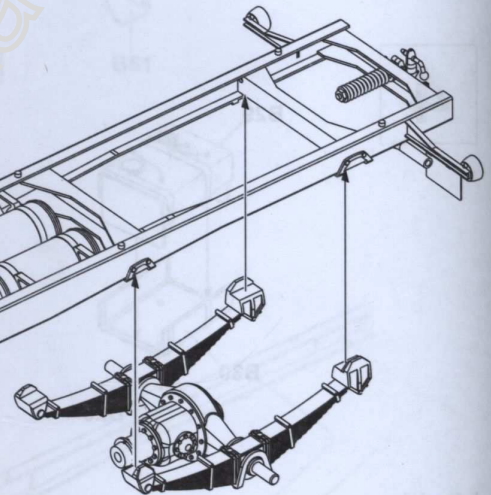
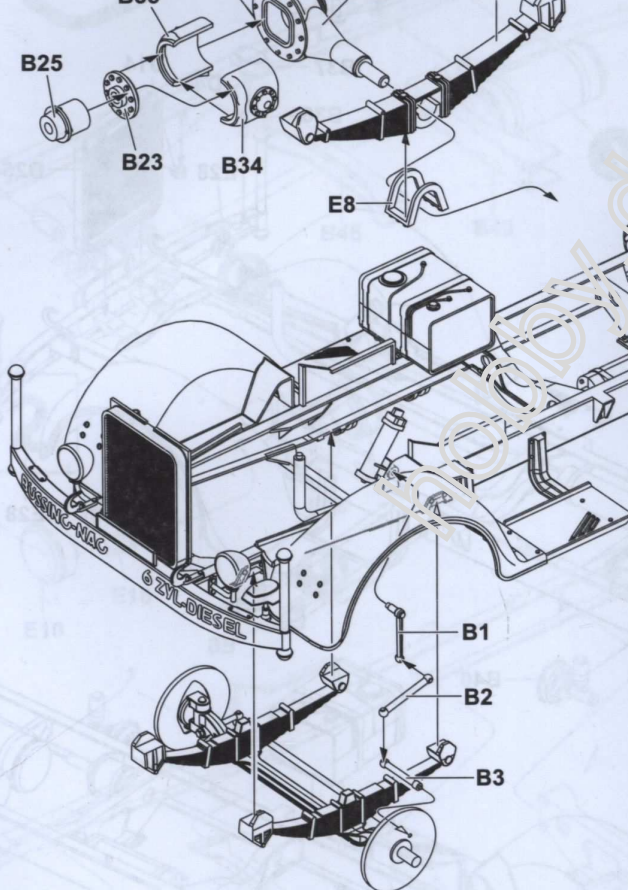
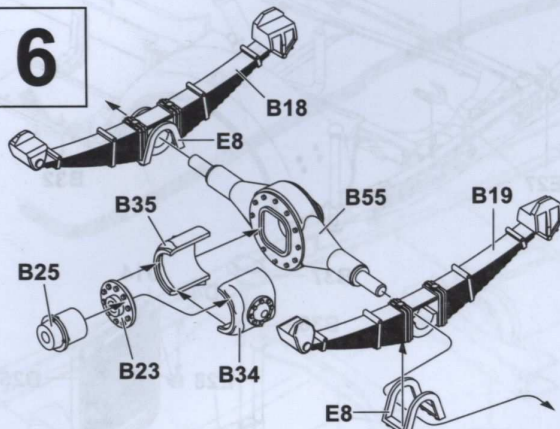

7

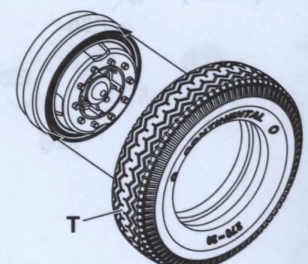
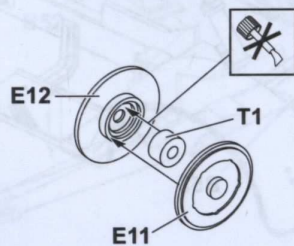

×2



8

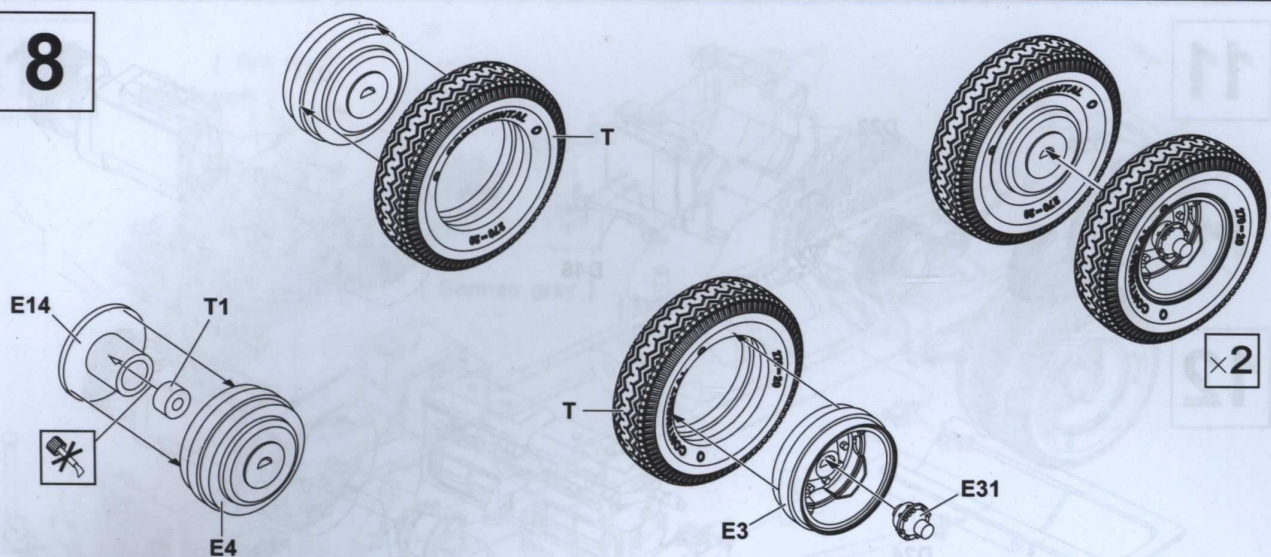

9

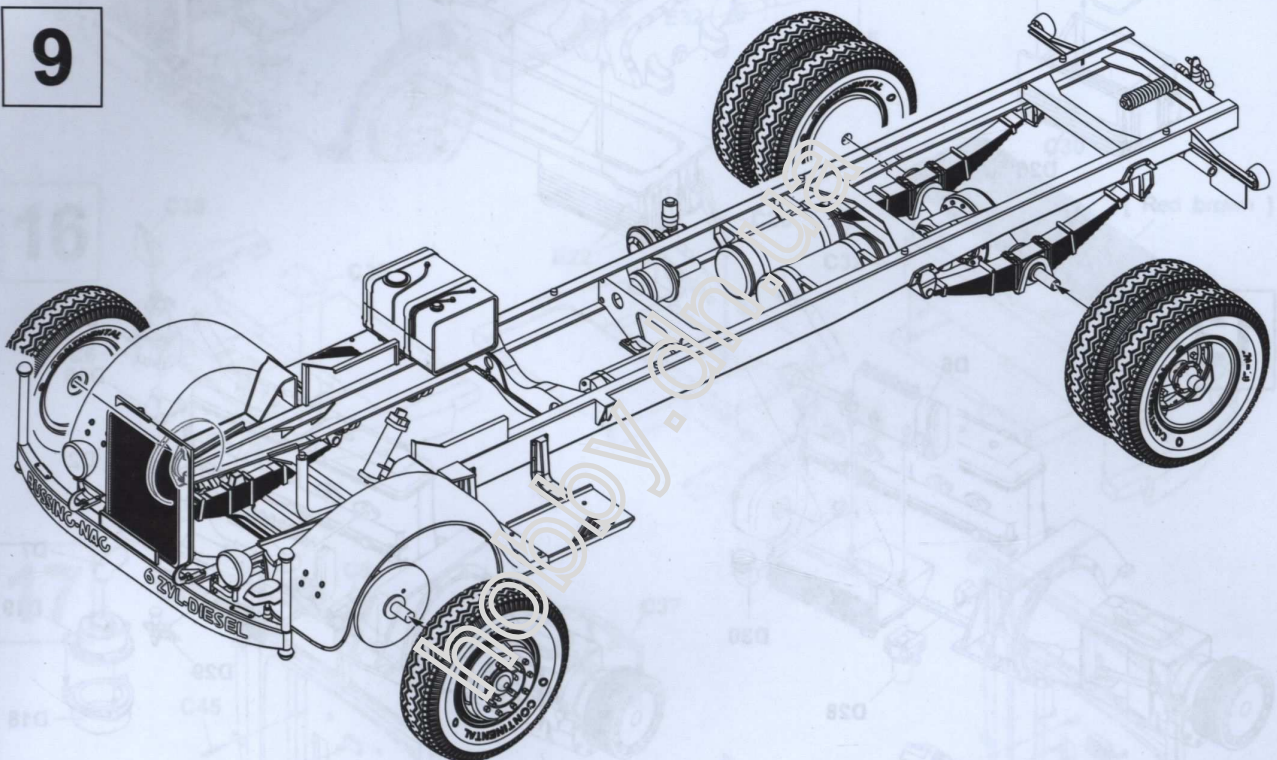

10

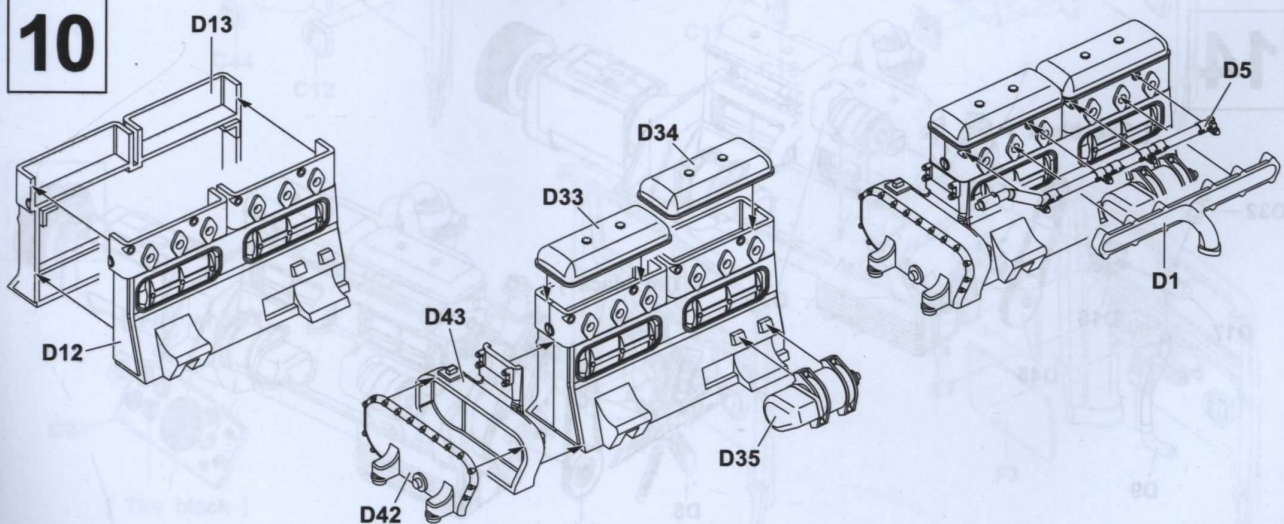



11

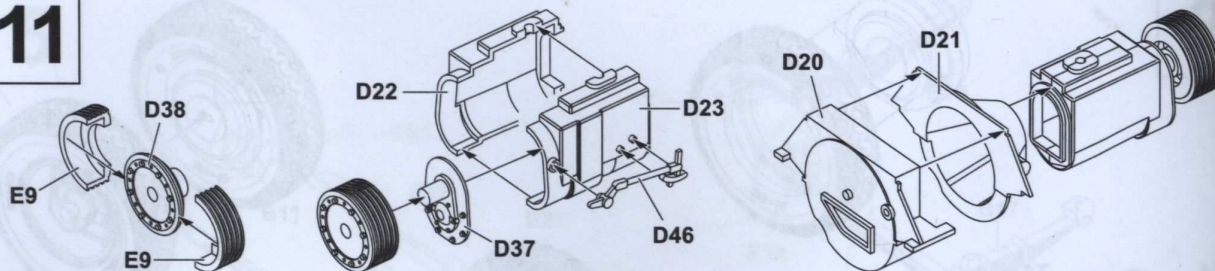

12

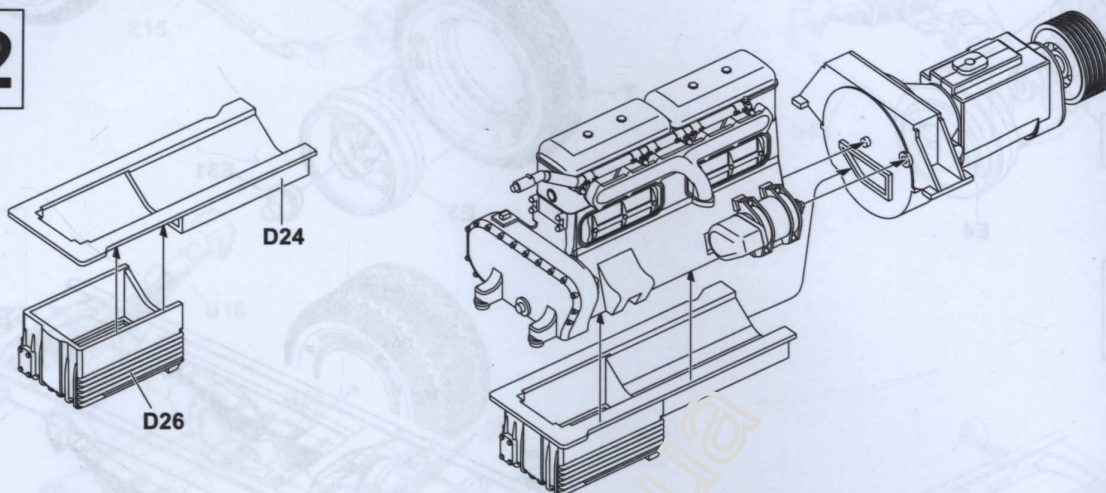

13

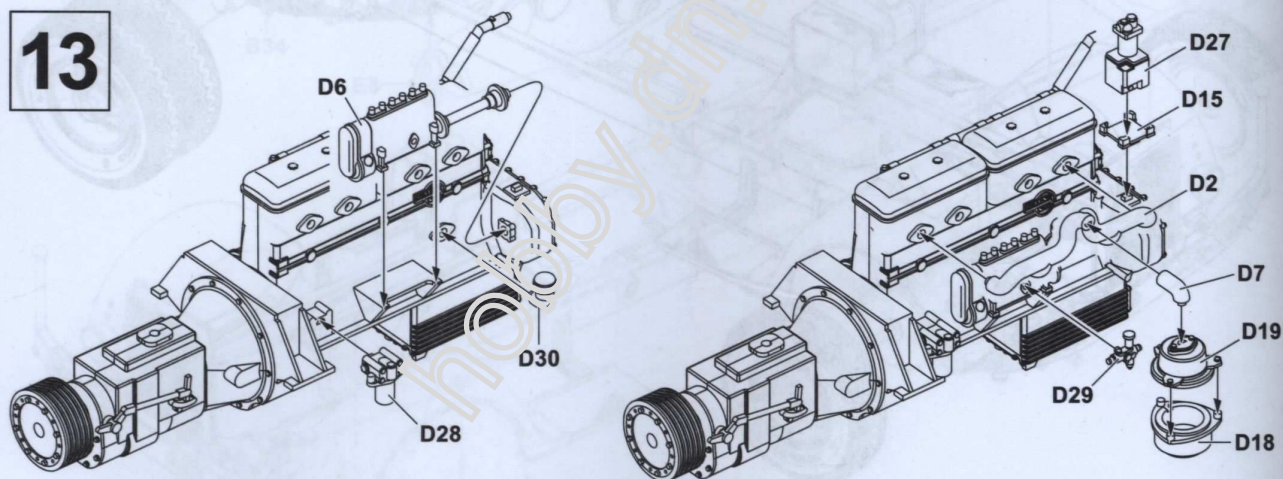

14

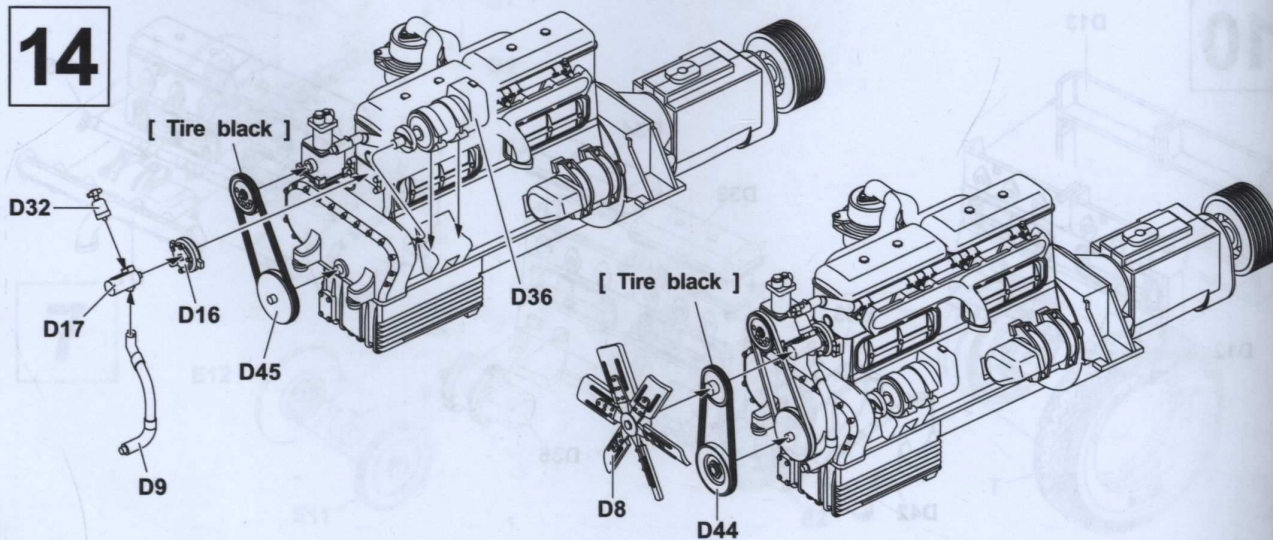



15

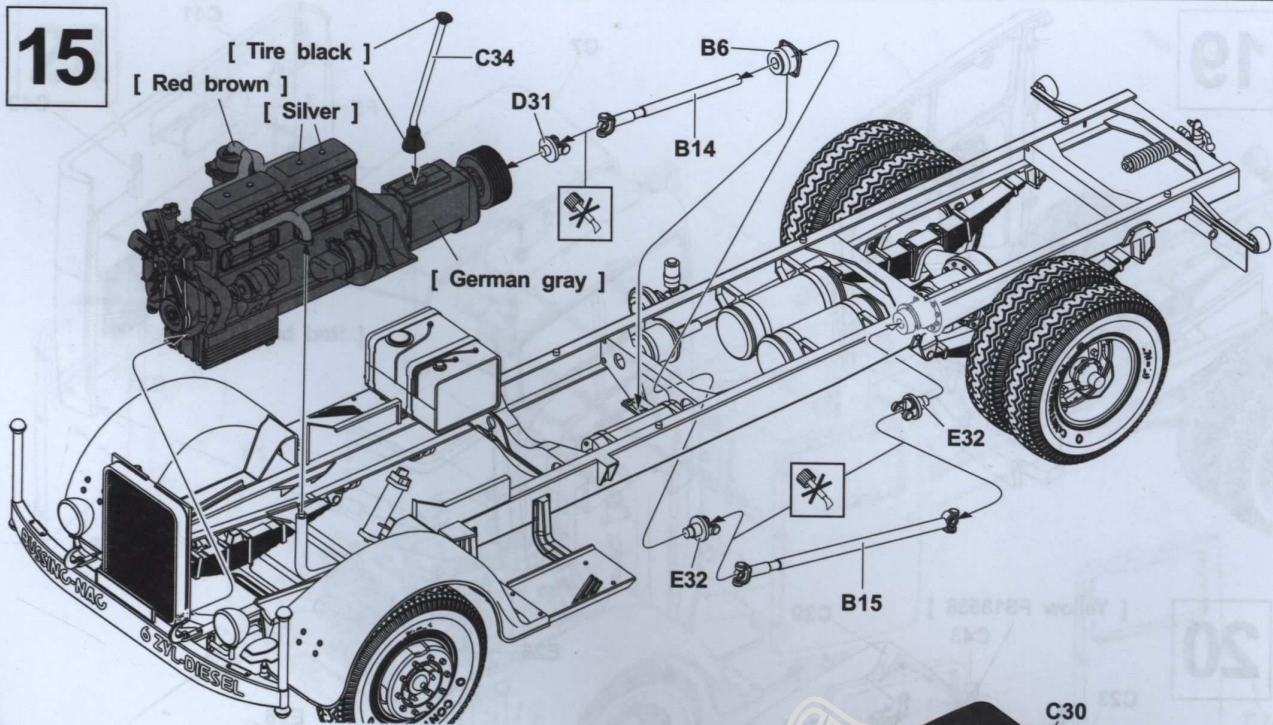

16

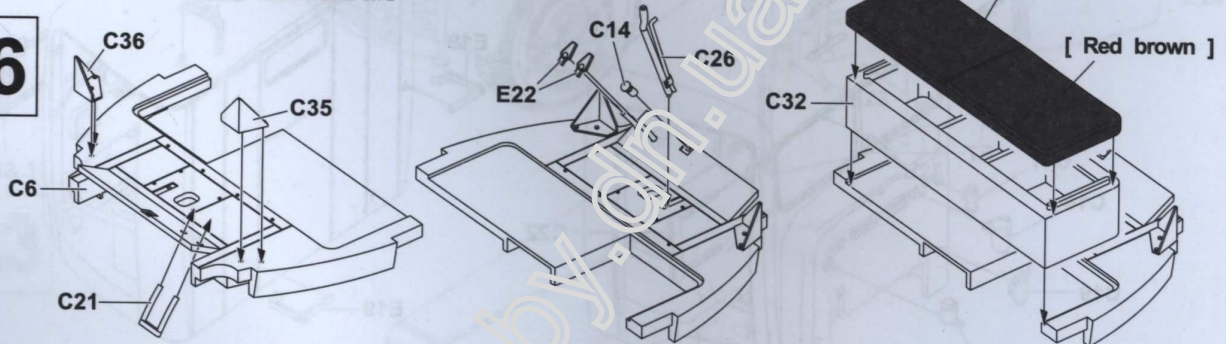

17

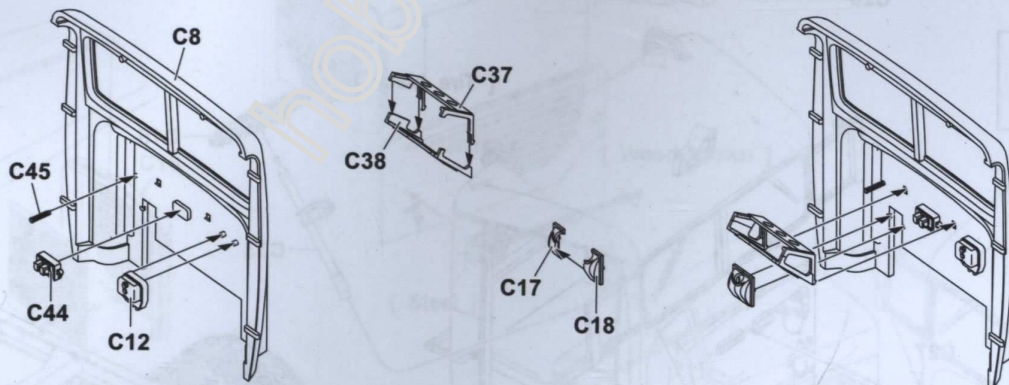

18

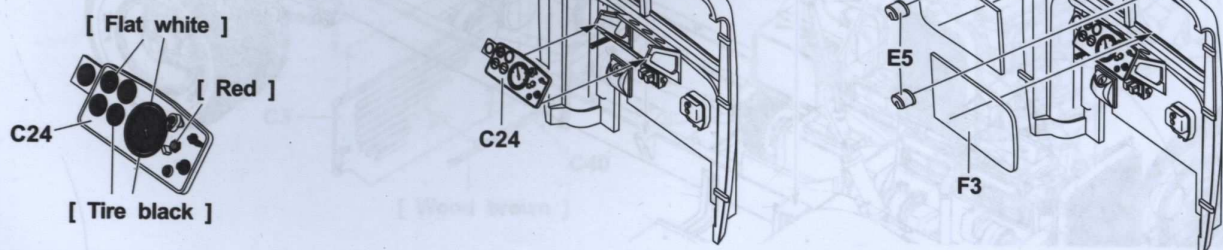



19

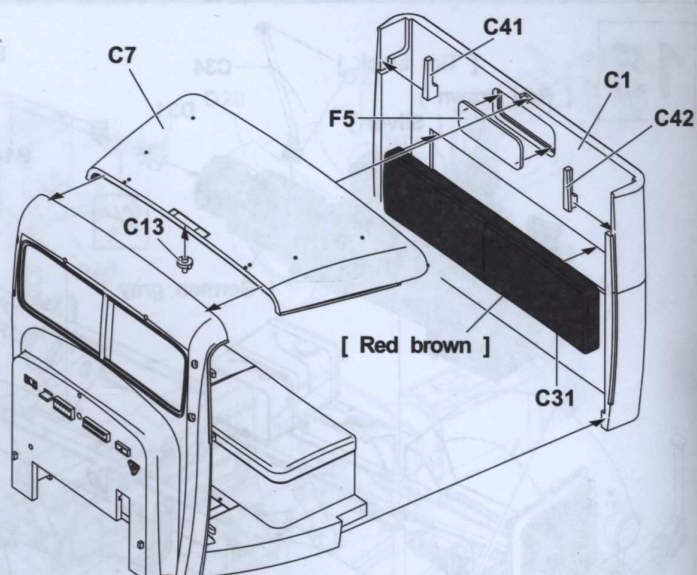
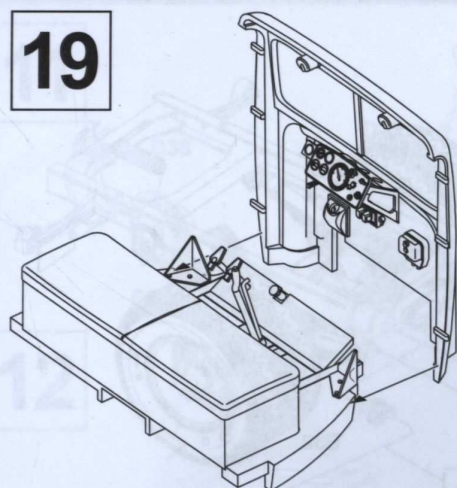

20

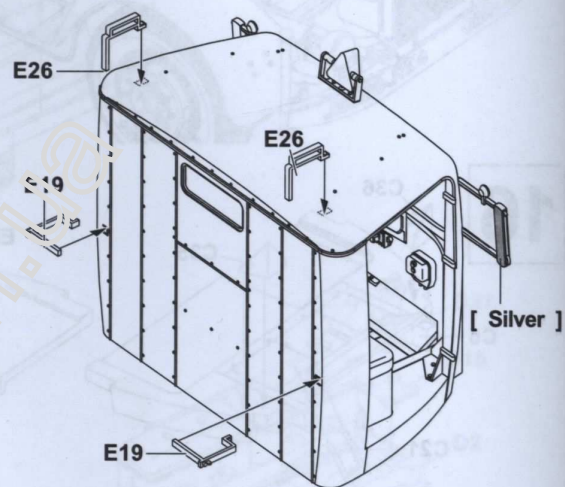
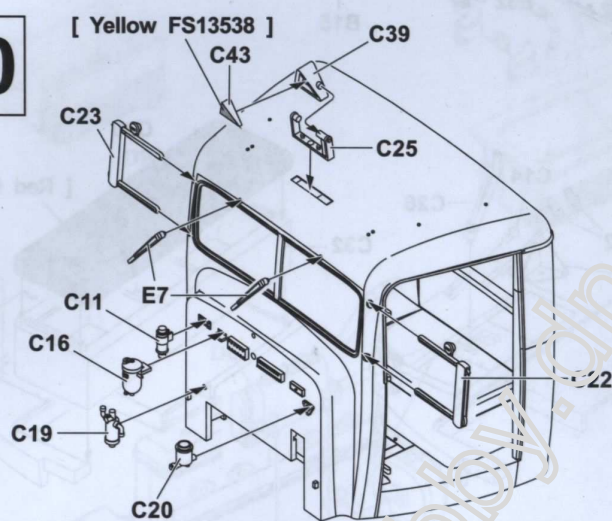

21

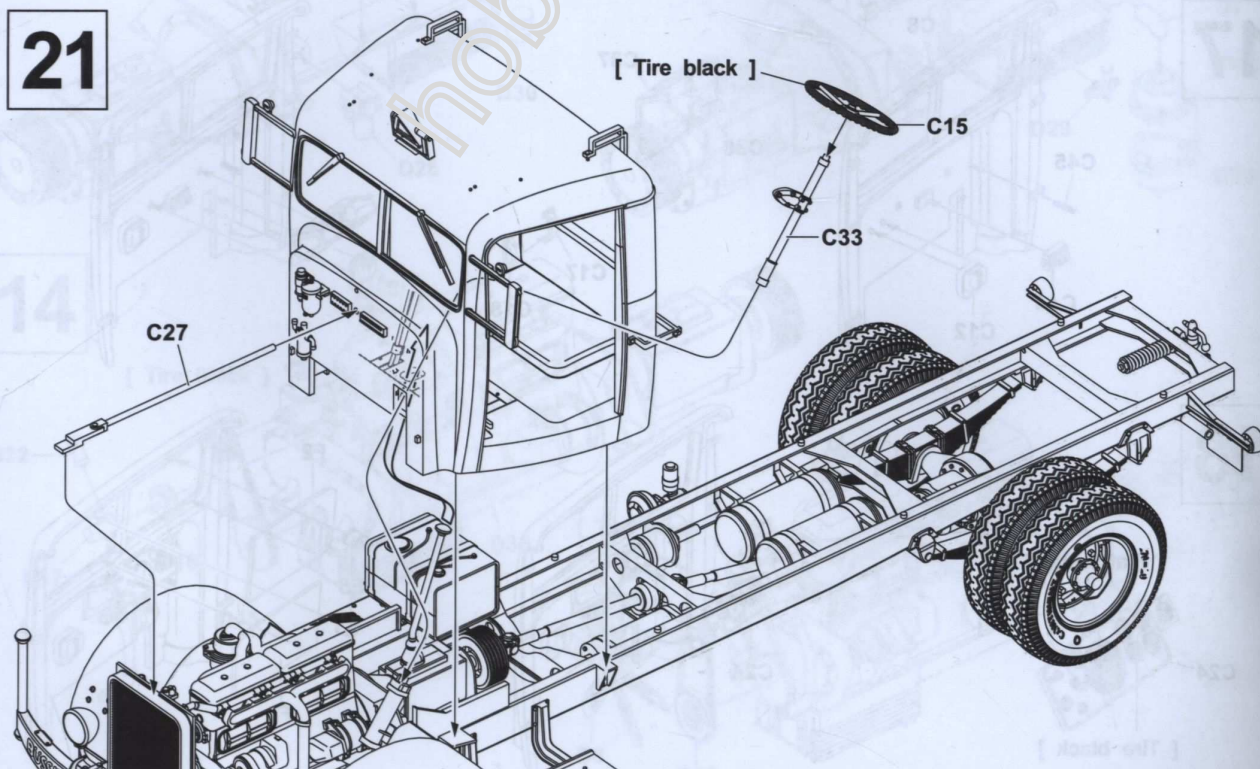



22

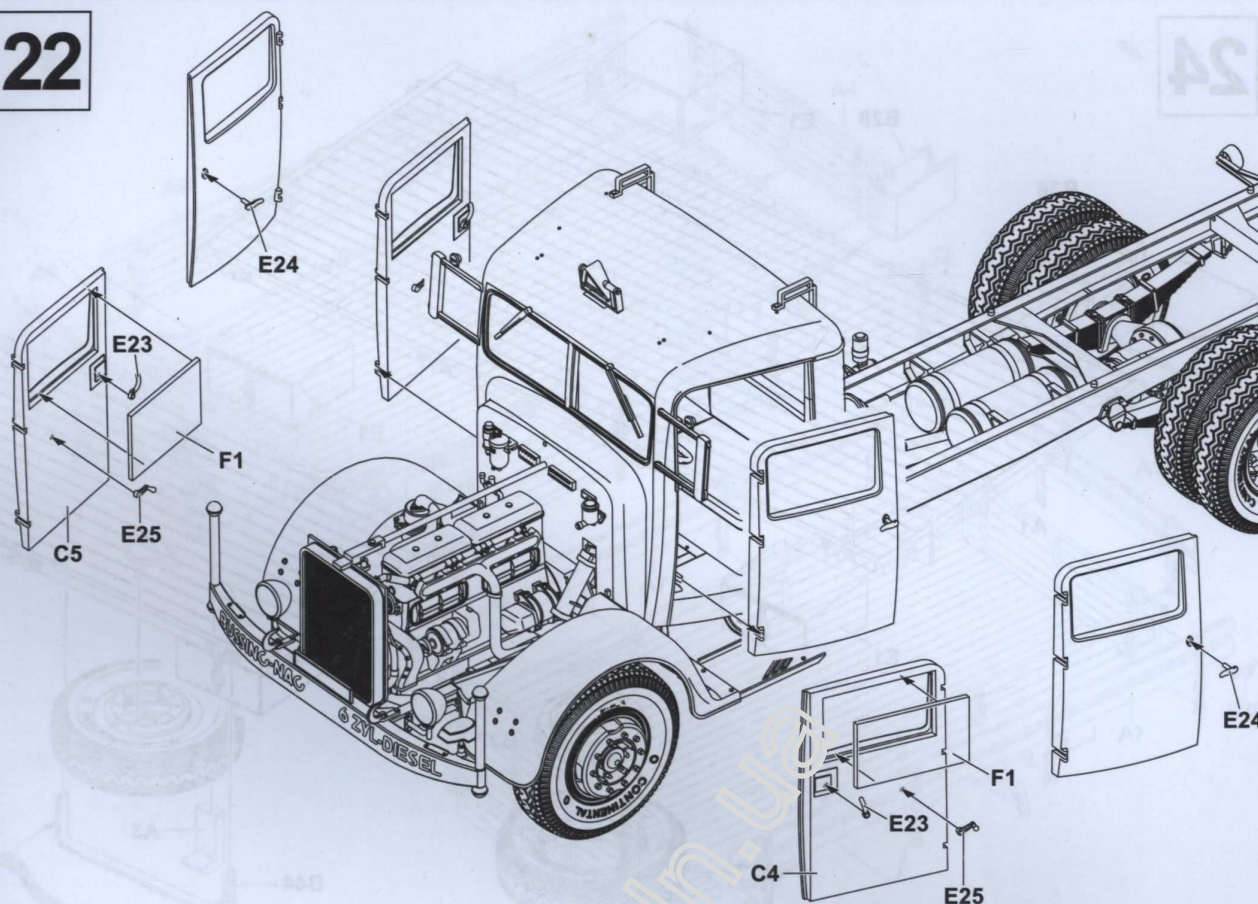

23

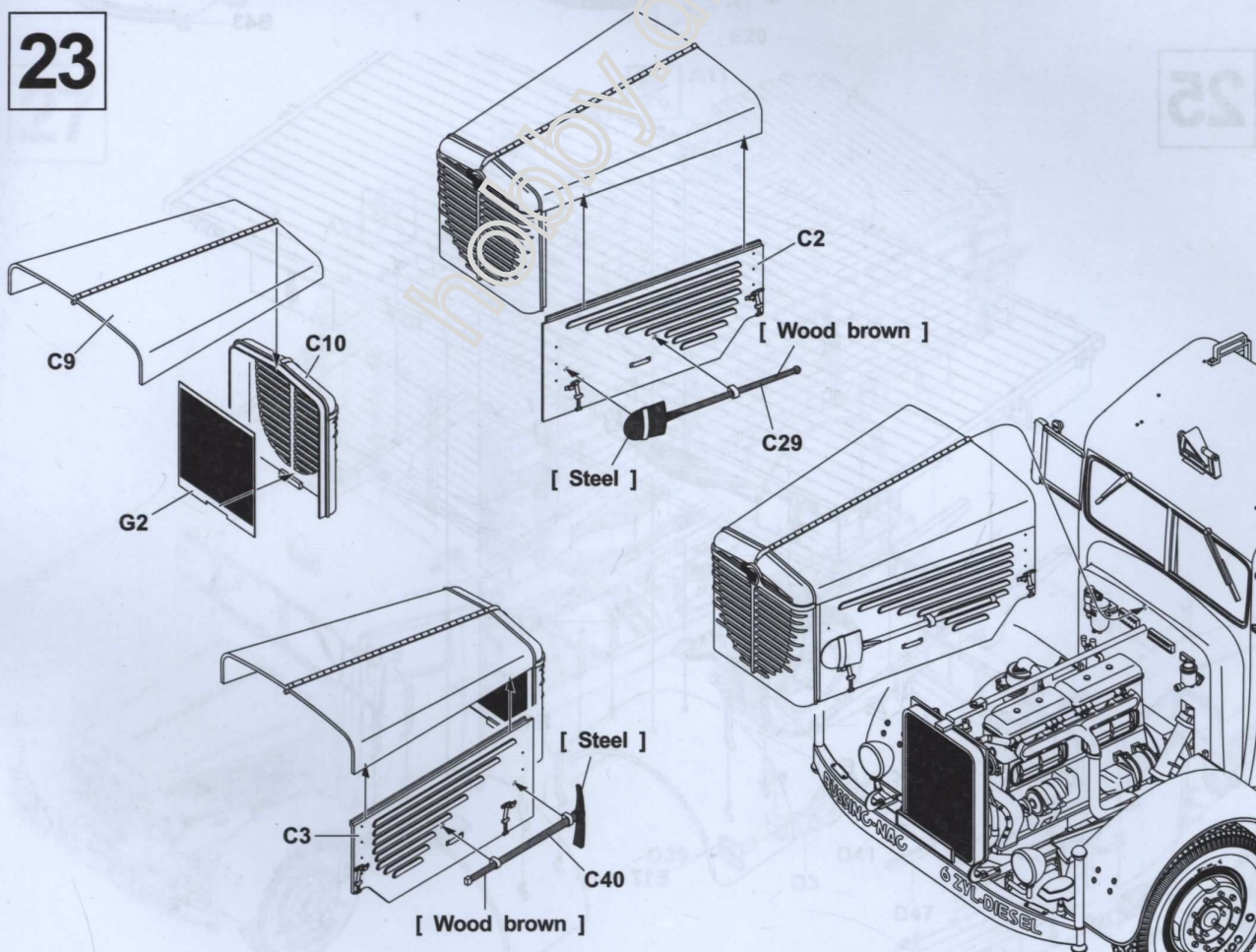



24

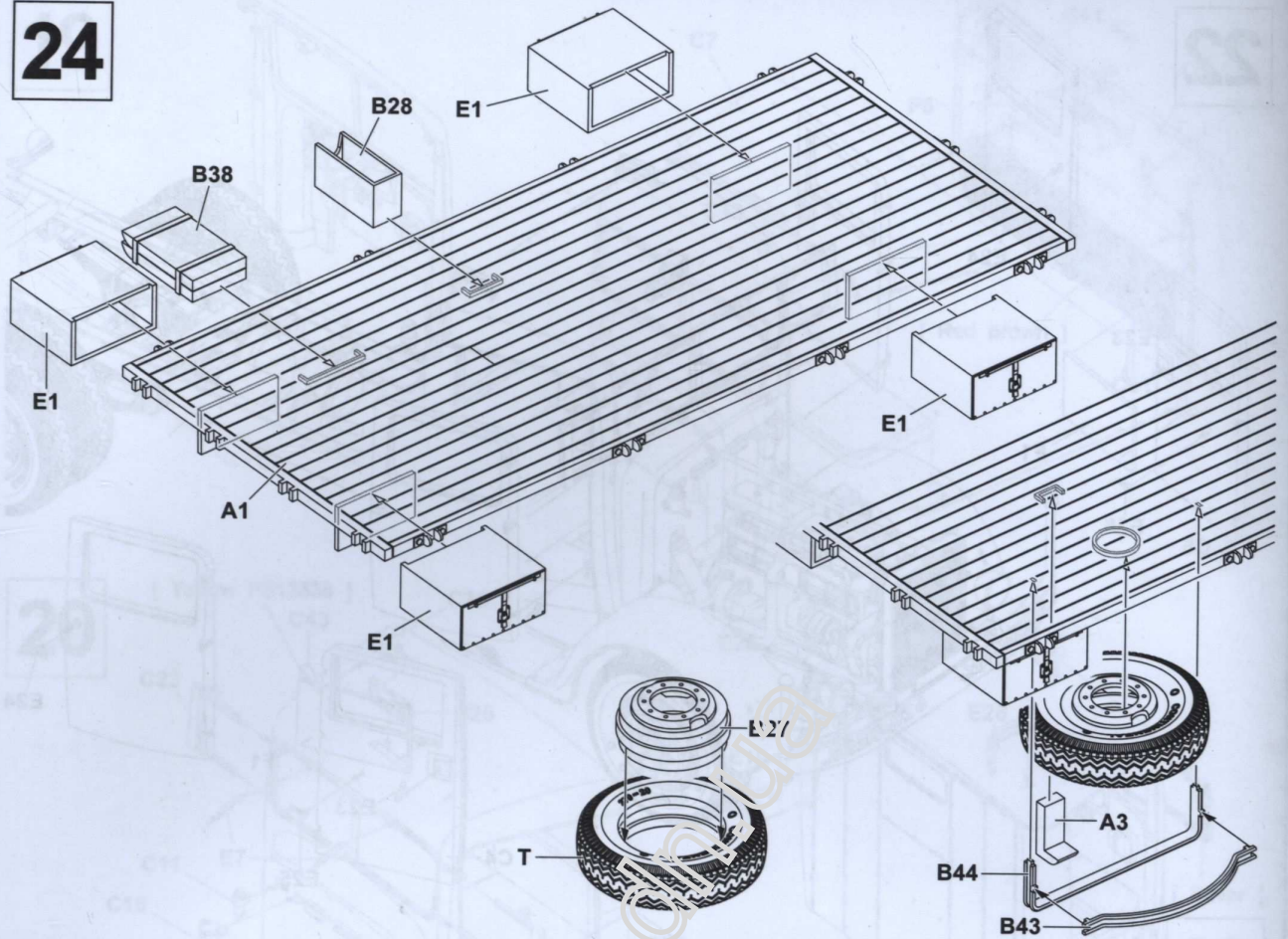

25

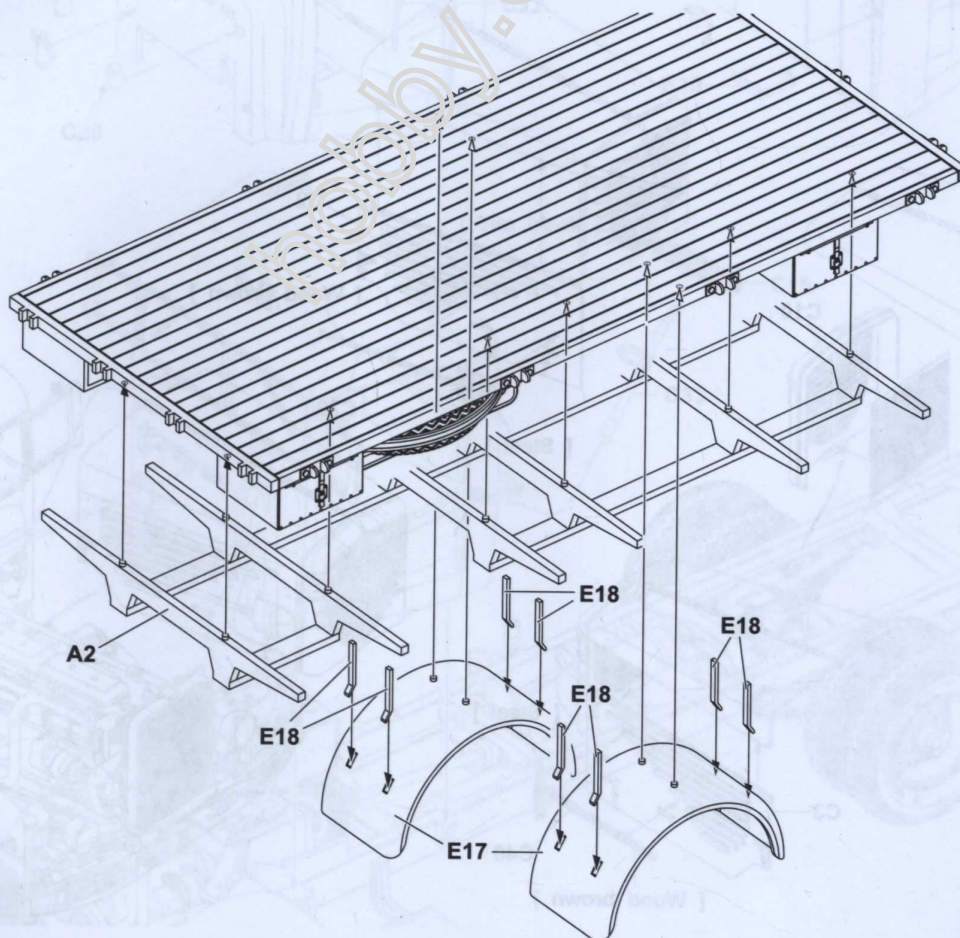



26

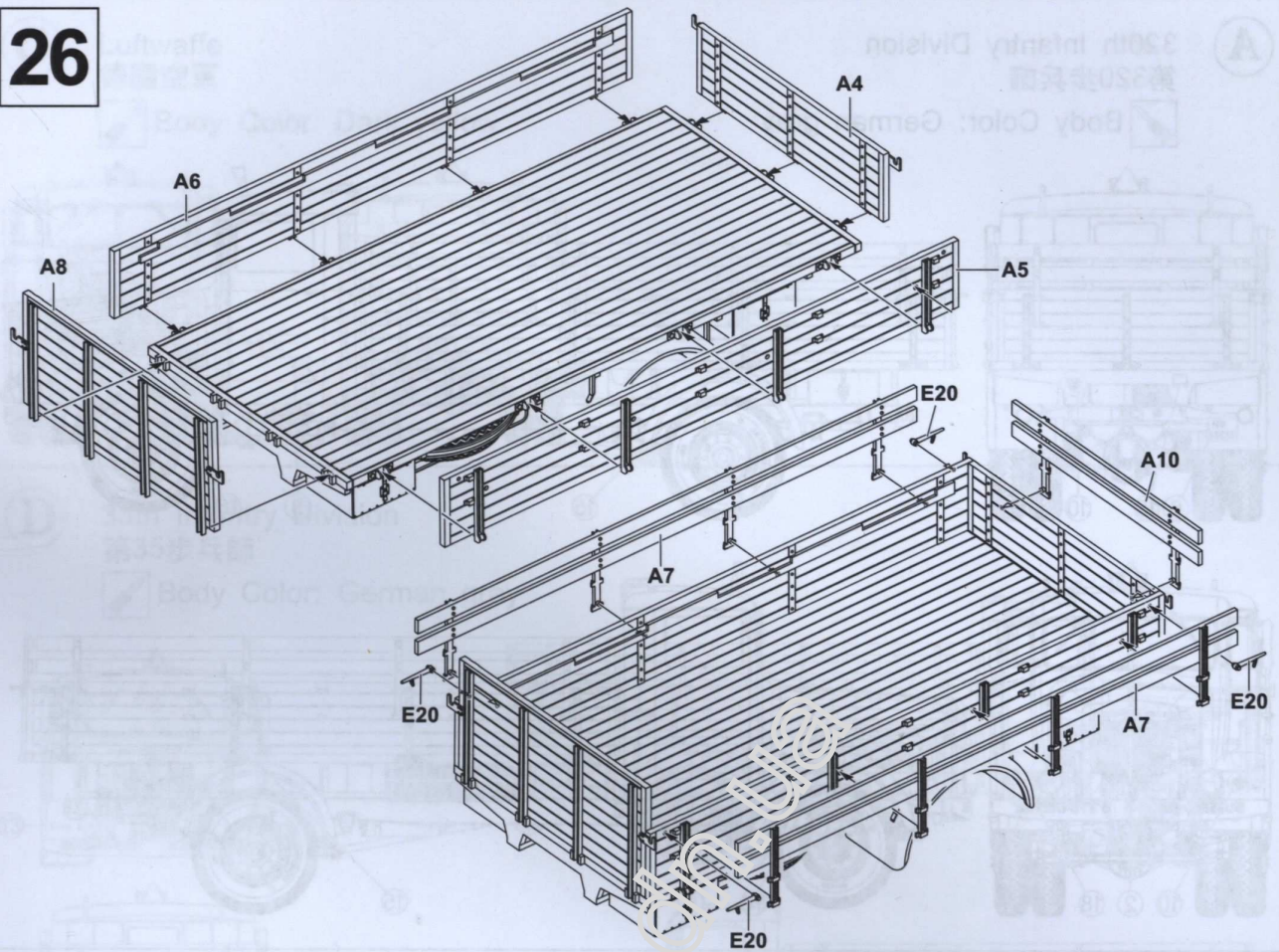

27

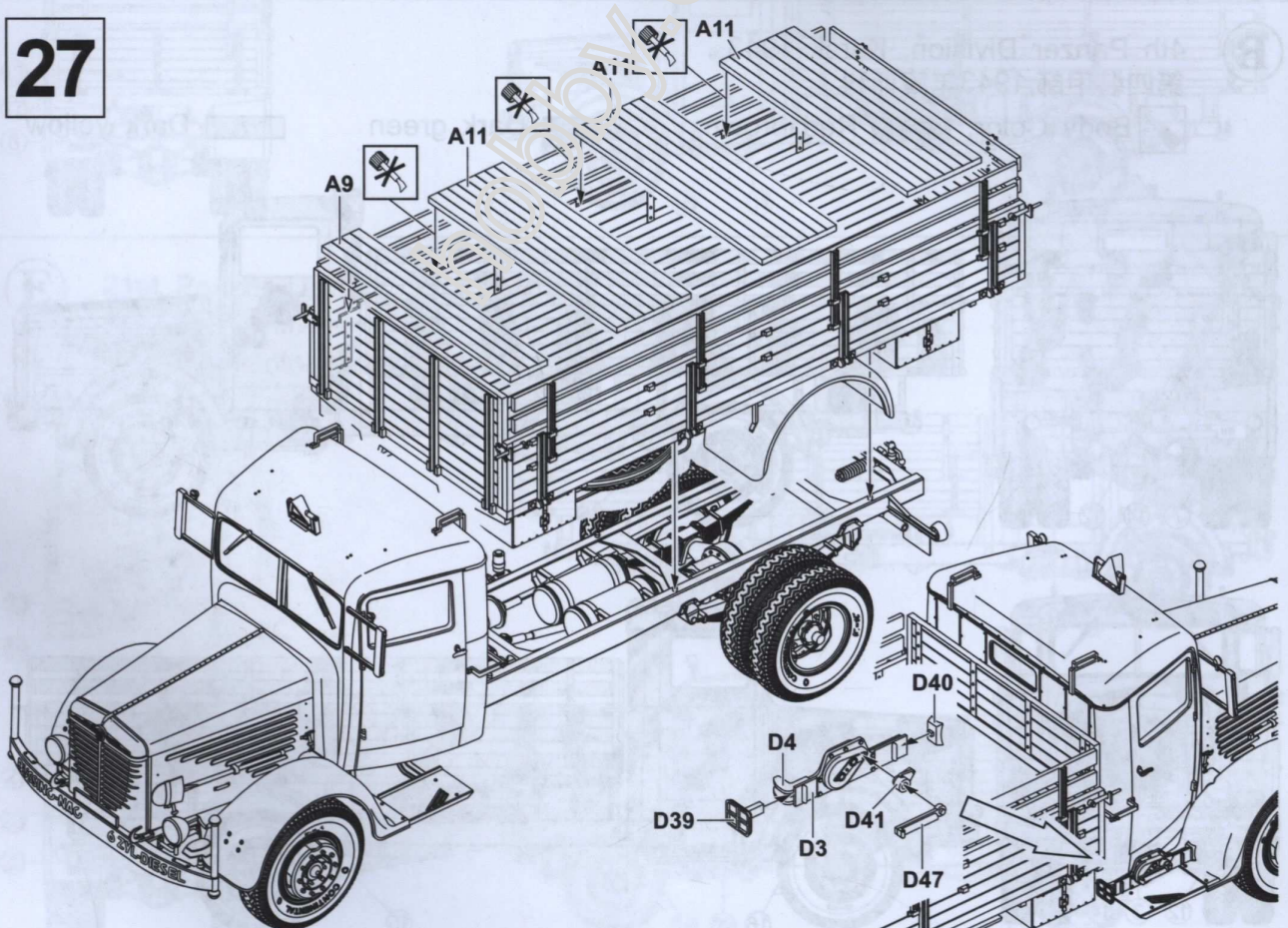



**A**

320th Infantry Division  
第320步兵師

 Body Color: German gray

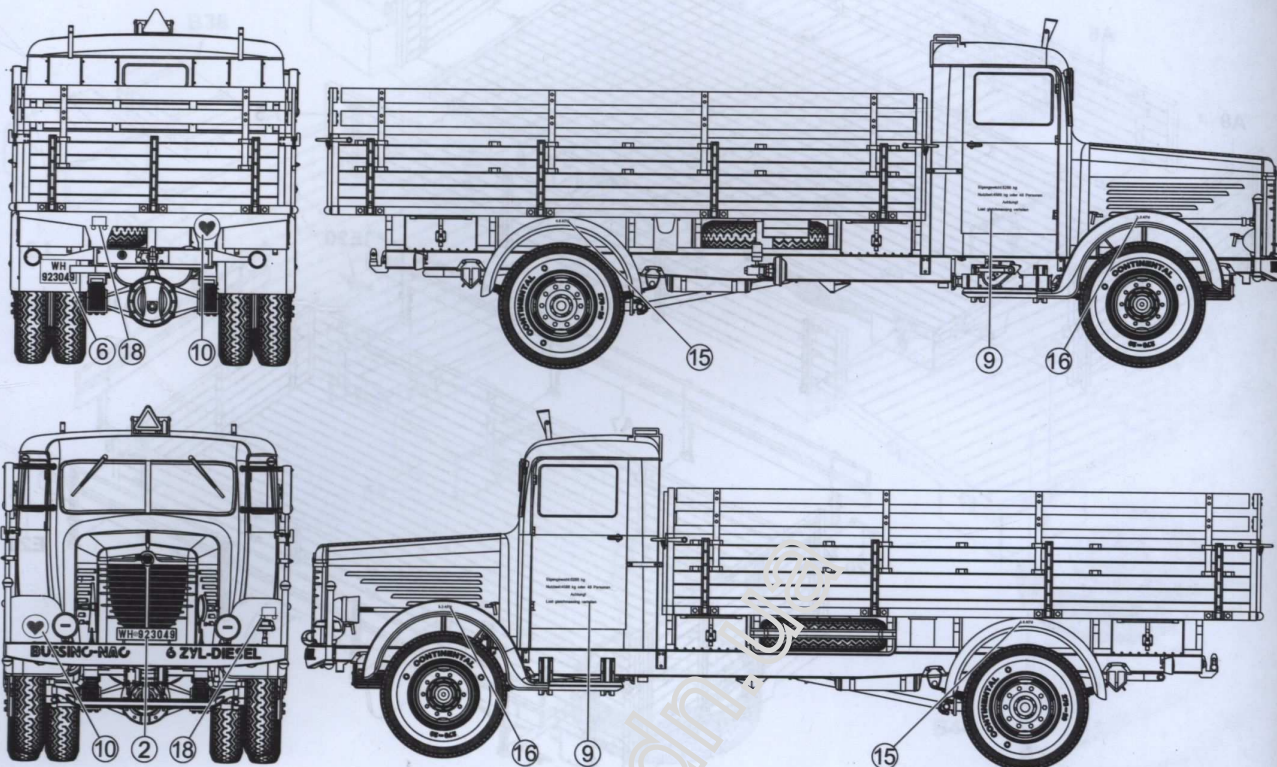



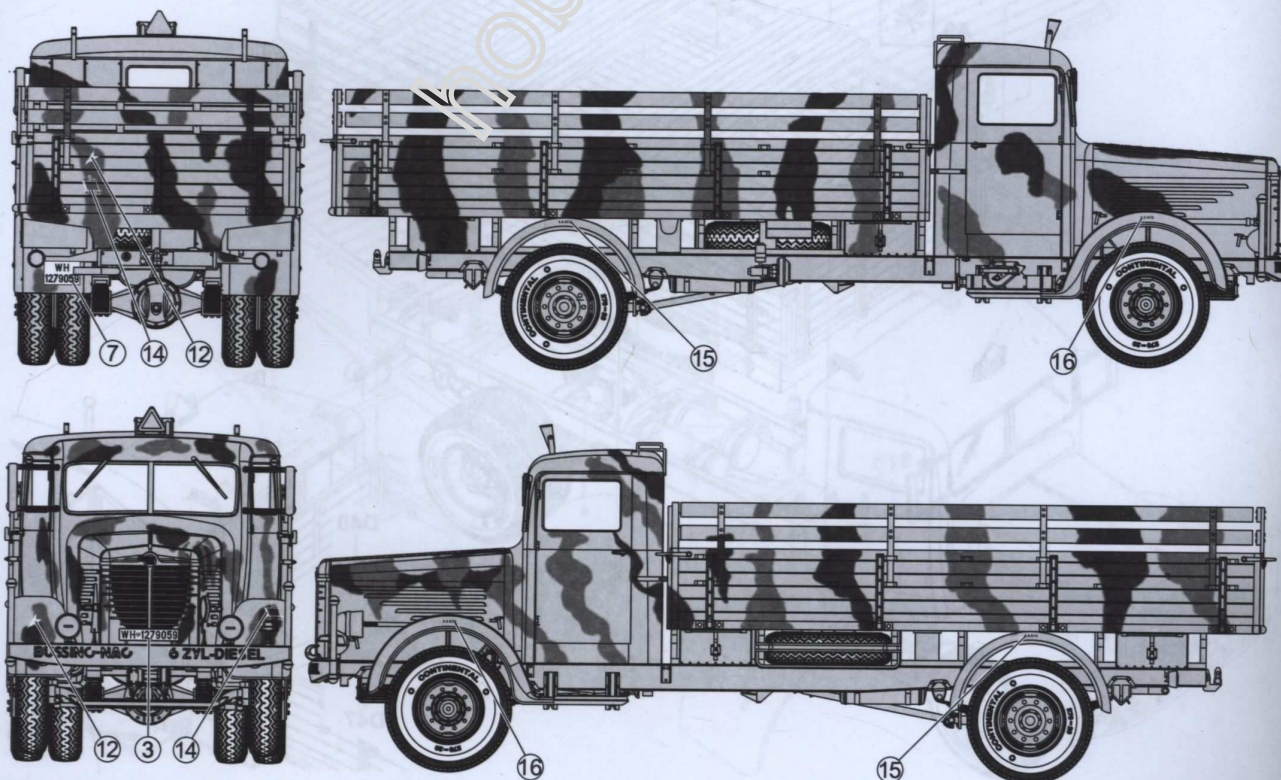

**B**

4th Panzer Division, Kursk 1943  
第四裝甲師, 1943年庫斯科

 Body Color:  Red brown  Dark green  Dark yellow

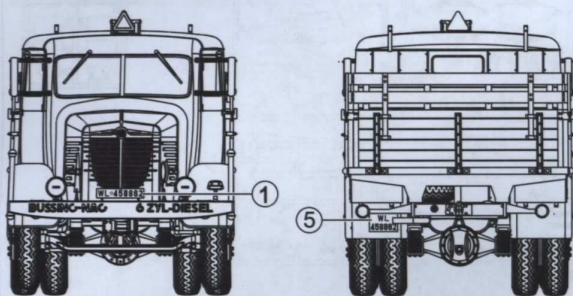

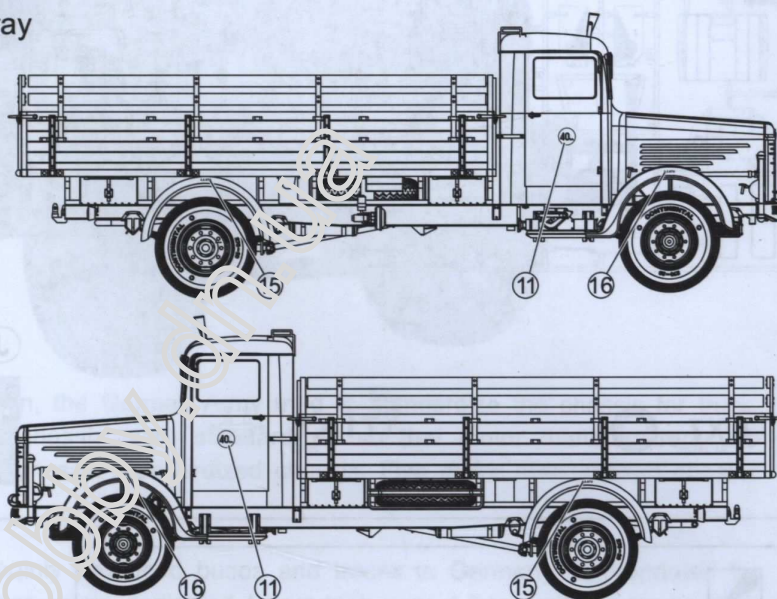
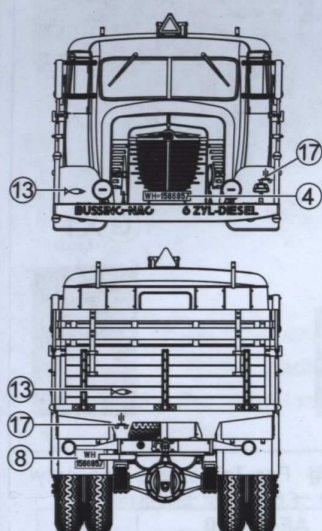

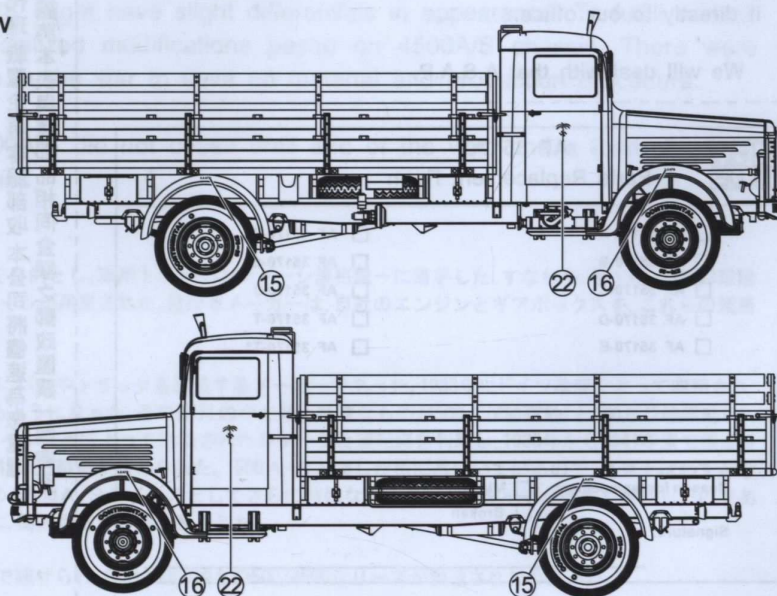
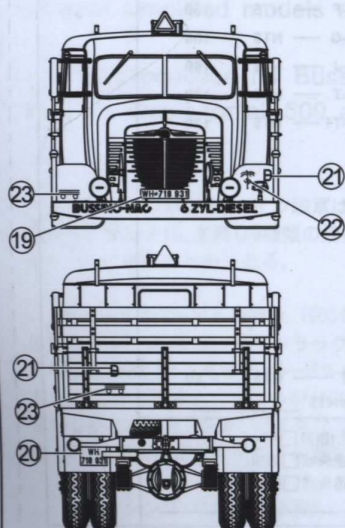
**C**Luftwaffe  
德國空軍 Body Color: Dark yellow**D**35th Infantry Division  
第35步兵師 Body Color: German gray**E**21st Panzer Division, North Africa  
第21裝甲師, 北非 Body Color: Dark yellow



# PARTS LIST 零件表

**A X1**

AF 35170

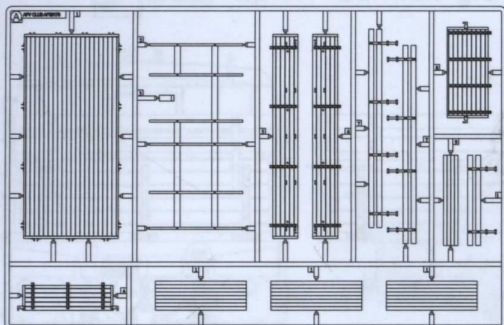

**B X1**

AF 35170

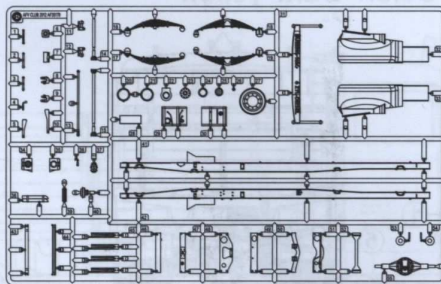

**F X1**

AF 35170

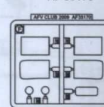

**C X1**

AF 35170

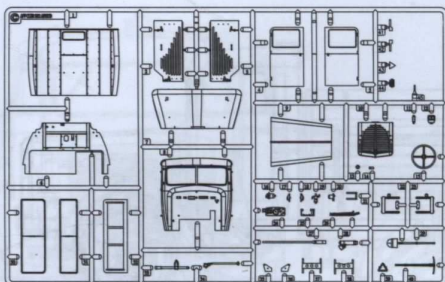

**D X1**

AF 35170

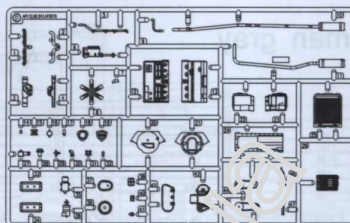

**E X2**

AF 35170

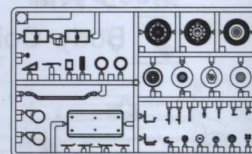

**T X7**

AF 35170



**T1 X1**

AF 35170



**J X1**

AF 35170



**G X1**

AF 35170



## Instructions:

If for some reason, you are not fully satisfied or have questions concerning our product; Please use the form provide, and send it to our nearest representative or mail it directly to our office.

We will deal with that A.S.A.P.



## AF 35170 Parts Replacement Form

- |                                     |                                      |
|-------------------------------------|--------------------------------------|
| <input type="checkbox"/> AF 35170-A | <input type="checkbox"/> AF 35170-F  |
| <input type="checkbox"/> AF 35170-B | <input type="checkbox"/> AF 35170-G  |
| <input type="checkbox"/> AF 35170-C | <input type="checkbox"/> AF 35170-J  |
| <input type="checkbox"/> AF 35170-D | <input type="checkbox"/> AF 35170-T  |
| <input type="checkbox"/> AF 35170-E | <input type="checkbox"/> AF 35170-T1 |

Reason for replacement: ☐ Missing  
☐ Broken

Signature: \_\_\_\_\_

限臺灣地區使用 For Taiwanese use only!



## AF 35170 零件補充申請表

申請人  
姓名 地址 電話

- |                                      |      |     |
|--------------------------------------|------|-----|
| <input type="checkbox"/> AF 35170-A  | NT\$ | 320 |
| <input type="checkbox"/> AF 35170-B  | NT\$ | 280 |
| <input type="checkbox"/> AF 35170-C  | NT\$ | 280 |
| <input type="checkbox"/> AF 35170-D  | NT\$ | 250 |
| <input type="checkbox"/> AF 35170-E  | NT\$ | 220 |
| <input type="checkbox"/> AF 35170-F  | NT\$ | 150 |
| <input type="checkbox"/> AF 35170-G  | NT\$ | 160 |
| <input type="checkbox"/> AF 35170-J  | NT\$ | 160 |
| <input type="checkbox"/> AF 35170-T  | NT\$ | 180 |
| <input type="checkbox"/> AF 35170-T1 | NT\$ | 120 |

+郵寄費 NT\$ 80  
(請填)總計NT\$ \_\_\_\_\_

零件補充原因:(請於 ☐ 打 ☒ )  
原包裝即 ☐ 遺失或 ☐ 毀損,  
製作途中 ☐ 遺失或 ☐ 毀損,  
其他原因 \_\_\_\_\_

總代理: 戰鷹企業 客服部收本公司將儘速為您處理。  
請將本表與該部品相同金額之郵政匯票一同寄至