

MF / MiG-21 in Czechoslovak service

eduard

SOVIET SUPERSONIC FIGHTER

1/144 SCALE PLASTIC KIT

DUAL COMBO! #4434

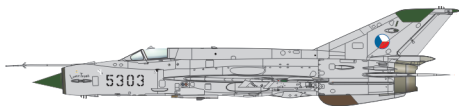

INTRO

The MiG-21 was one of a long list of Mikoyan-Gurevich products to be integrated into the armed forces of the Soviet Union, the Warsaw Pact, and allied client states. Its predecessors included such notable types as the MiG-15, MiG-17 and the supersonic MiG-19.

The roots of this project reach back to the first half of the fifties. In 1954, the Ye-1 project came to an end, and was quickly picked up by the Ye-2. Both had a swept wing. The first machine to feature the delta wing was the Ye-4, which first took to the air on June 16th, 1955. It was also demonstrated a year later at the Moscow airfield Tushino.

The first of the new line to enter production was the MiG-21F, which together with the MiG-21P and F-13 represented the first generation of the MiG-21, and was in production through the end of the fifties and the beginning of the sixties. Subsequent versions included the PF, FL, PFM, R, the production of which peaked at the end of the sixties. The third generation started production in 1968, which included such versions as M, SM, MF, SMT, bis among others.

Simultaneously, two-seat training versions were also produced designated MiG-21U, UM and US. Production of the MiG-21 ended in 1985, and was put into service with some fifty nations.

Over the course of the cold war, the opponents of the MiG-21 included the likes of the Northrop F-5 Freedom Fighter and the Dassault Mirage III. NATO assigned it the reporting name 'Fishbed'. It became the most produced supersonic fighter in terms of quantity. The new machines came off Soviet production lines in Moscow, Gorky and Tbilisi. The MiG-21F-13 was also built under license in Czechoslovakia and the MiG-21FL, M and bis in India by Hindustan Aeronautics Ltd. The Soviet Union produced 10,645 examples of all versions, 194 were built in Czechoslovakia and 657 in India. Outside of the Soviet Union, the type flew with a long list of nations on all continents with the exception of Australia. The MiG-21 participated in combat in Vietnam, the Indo-Pakistan wars, the Cuban participation in Angola and in the Arab world's attempt to eliminate Israel. Thanks to the high volume of use, the highest number of aces produced on the type was in Vietnam. The top of the ladder is occupied by Nguyen Van Coc with nine kills.

The type serving as a fighter-bomber served with the Soviet Union and other nations of the Warsaw Pact into the eighties, when it began to be displaced by the MiG-29 Fulcrum.

This kit allows you to build foremost a model of the MiG-21MF. This is an export version of the SM where the 'M' signifies 'modernizovaniy' and the 'F' 'forsirovannyi' – or 'modernized with afterburning'. In factory documentation, the type is identified as Izdelye 96F. It was powered by the Tumansky R-13-300 with afterburning and carried the Sapfir-21/RP-22 radar. The armament was composed of the GS-23-2L 23mm cannon with 200 rounds. The underwing pylons could carry a combination of FAB bombs up to 500kg in size, UB-16-57 rocket pods, and R-3S, Ch-66, S-24 missiles, as well as R-60 air-to-air missile, including the R-60M. NATO assigned the MiG-21MF the codename 'Fishbed J'.

ATTENTION



UPOZORNĚNÍ



ACHTUNG



ATTENTION



注意



Carefully read instruction sheet before assembling. When you use glue or paint, do not use near open flame and use in well ventilated room. Keep out of reach of small children. Children must not be allowed to suck any part, or pull vinyl bag over the head.



Před započítím stavby si pečlivě prostudujte stavební návod. Při používání barev a lepidel pracujte v dobře větrané místnosti. Lepidla ani barvy nepoužívejte v blízkosti otevřeného ohně. Model není určen malým dětem, mohlo by dojít k požití drobných dílů.

INSTRUCTION SIGNS * INSTR. SYMBOLS * INSTRUKTION SINNBILDEN * SYMBOLES * 記号の説明

OPTIONAL
VOLBABEND
OHNOUTOPEN HOLE
VYVRTAT OTVORSYMMETRICAL ASSEMBLY
SYMETRICKÁ MONTÁŽNOTCH
ZÁREZREMOVE
ODRŮZNOUTAPPLY EDUARD MASK AND PAINT
POUŽIT EDUARDS MASK NABARVIT

PARTS



DÍLY



TEILE



PIĚCES



部品

A> 2 pcs.

PLASTIC PARTS

4425 A

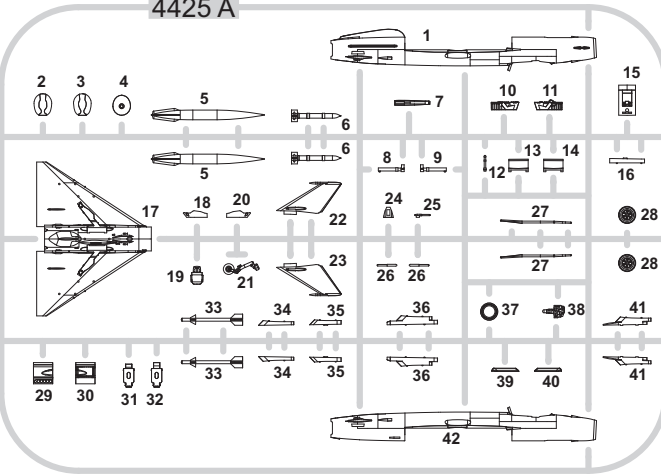

B> 2 pcs.

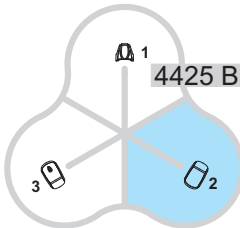

C> 2 pcs.

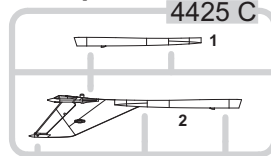
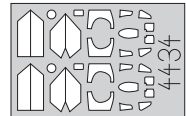
eduard
MASK

Parts not for use. -Teile werden nicht verwendet. -Piešes a he pas utilisier. -Tyto díly nepoužívejte při stavbě. - 使用しない部品

COLOURS



BARVY



FARBEN



PEINTURE



色

GSI Greys (GUNZE)		
AQUEOUS	Mr.COLOR	
H 3	C3	RED
H 6	C6	GREEN
H 11	C82	FLAT WHITE
H 12	C33	FLAT BLACK
H 13	C85	BRIGHT BLUE
H 23	C34	SKY BLUE
H 23	C86	BRIGHT GREEN
H 33	C80	COBALT BLUE
H 37	C43	WOOD BROWN
H 53	C13	NEUTRAL GRAY
H 70	C80	GRAY
H 77	C137	TIRE BLACK

AQUEOUS	Mr.COLOR	
H 60	C54	KHAKI GREEN
H 84	C42	MAHOGANY
H 95	C101	SMOKE GRAY
H 305	C305	GRAY
H 306	C306	GRAY
H 307	C307	GRAY
H 308	C308	GRAY
H 312	C312	GREEN
H 316	C316	WHITE
H 320	C320	DARK GREEN
H 321	C321	LIGHT BROWN
H 324	C325	GRAY
H 332	C332	LIGHT GRAY

AQUEOUS	Mr.COLOR	
H 334	C334	BARLEY GRAY
H 339	C338	LIGHT GRAY
H 416	C116	BLACK GRAY
H 417	C117	LIGHT BLUE
H 418	C118	LIGHT BLUE
H 420	C120	OLIVE GREEN
	C35	GRAY GREEN
Mr.METAL COLOR		
	MC213	STAINLESS STEEL
	MC214	DARK IRON
Mr.METAL COLOR		
	SM01	SUPER FINE SILVER

A38

INTERIOR COLOUR

H12
C33

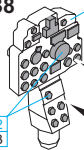

decal 62 (?)

decal 65 (?)

INTERIOR COLOUR BARVA INTERIÉRU

INTERIOR COLOUR

60% ^{H25}C34 SKY BLUE + 20% ^{H26}C66 BRIGHT GREEN + 20% ^{H35}C80 COBALT BLUE

A

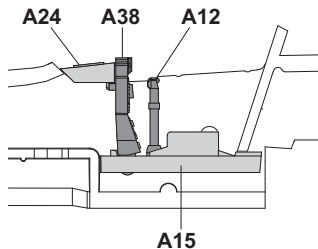
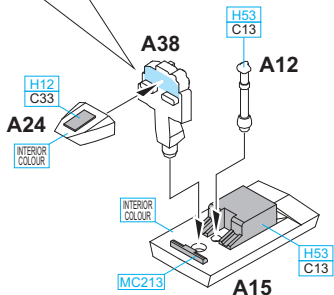

B

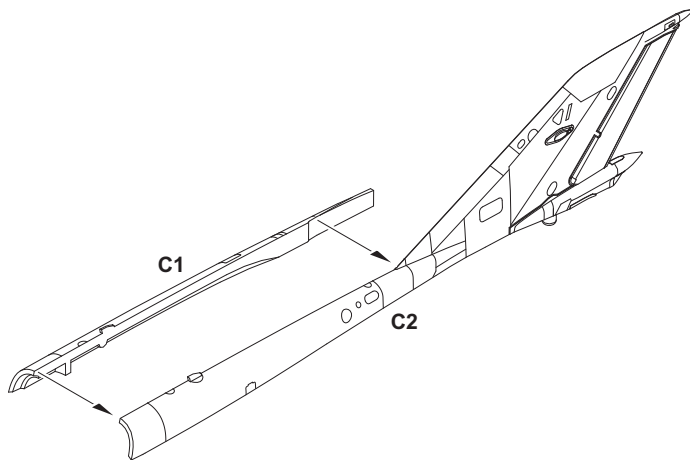

C

CANOPY OPEN
PŘEKRYT
KABINY OTEVŘENÝ
A32

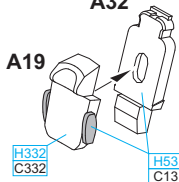

CANOPY CLOSED
PŘEKRYT
KABINY ZAVŘENÝ
A31

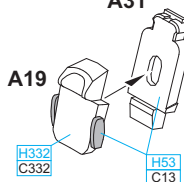

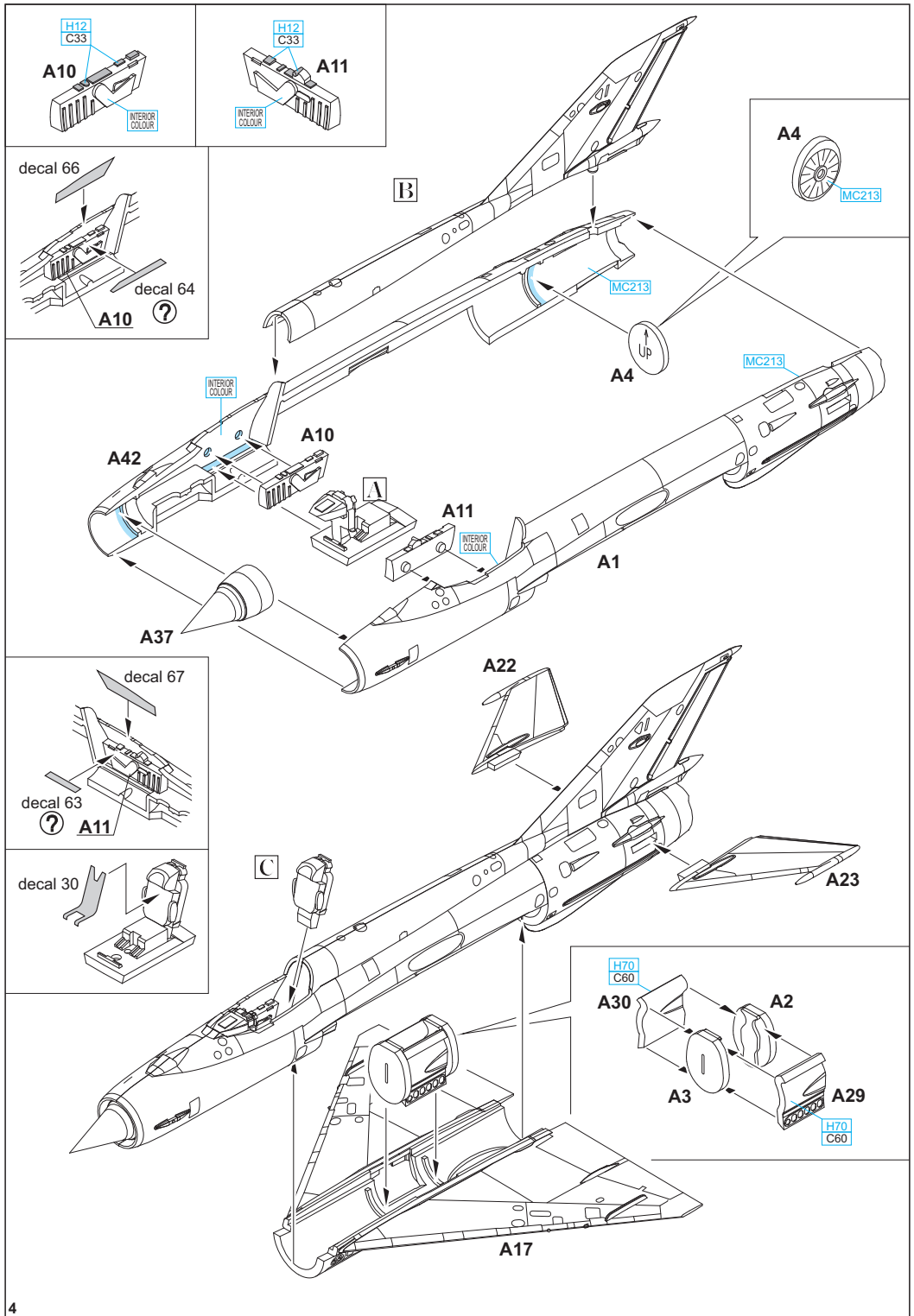

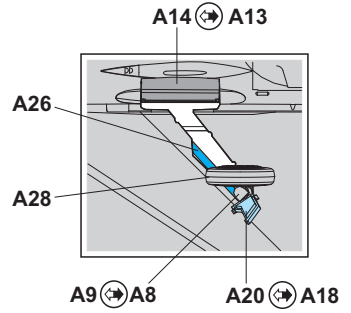
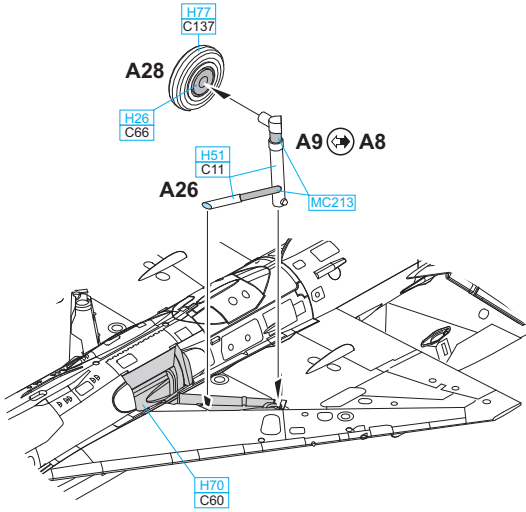

A14 → A13

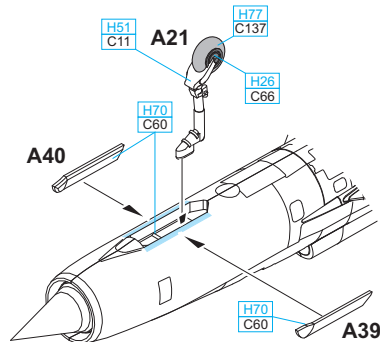
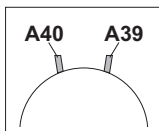
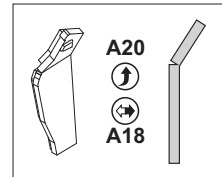
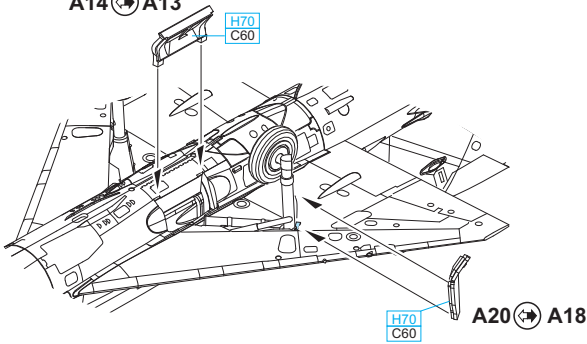

decal 45, 46, 47 - MARKING **A**

decal 70, 71, 72 - MARKINGS **C; H**

decal 50, 69, 73 - MARKINGS **B; D; E; F; G**

decal 45



decal 72



decal 73

decal 47 decal 46



decal 50 decal 69



decal 70 decal 71

B1

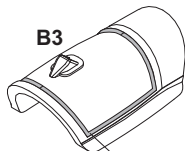
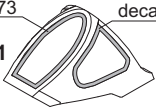

decal 43



decal 44

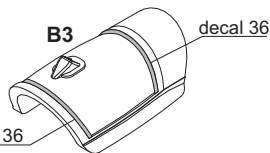

decal 36

CANOPY OPEN PŘEKRYT KABINY OTEVŘENÝ

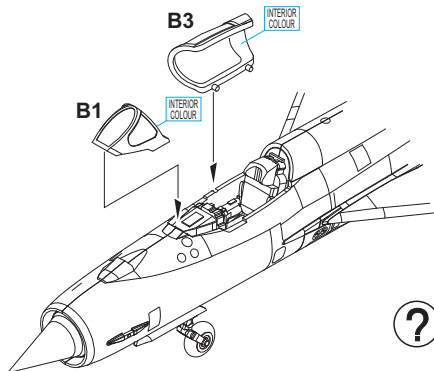

B3

B1

B1

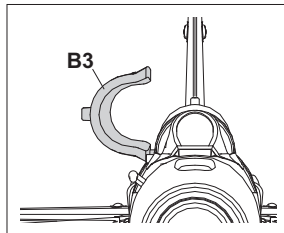

B3

CANOPY CLOSED PŘEKRYT KABINY ZAVŘENÝ

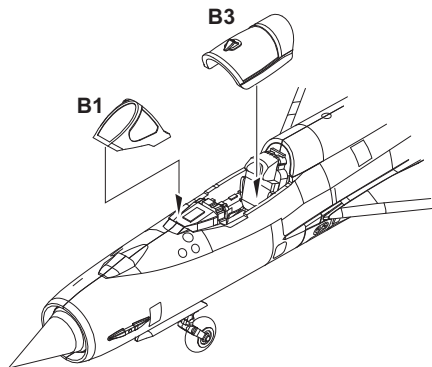

B3

B1

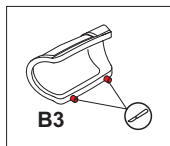

B3

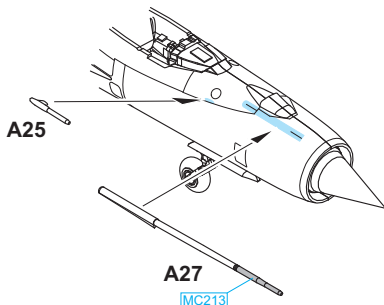

A25

A27

MC213

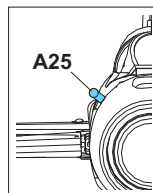

A25

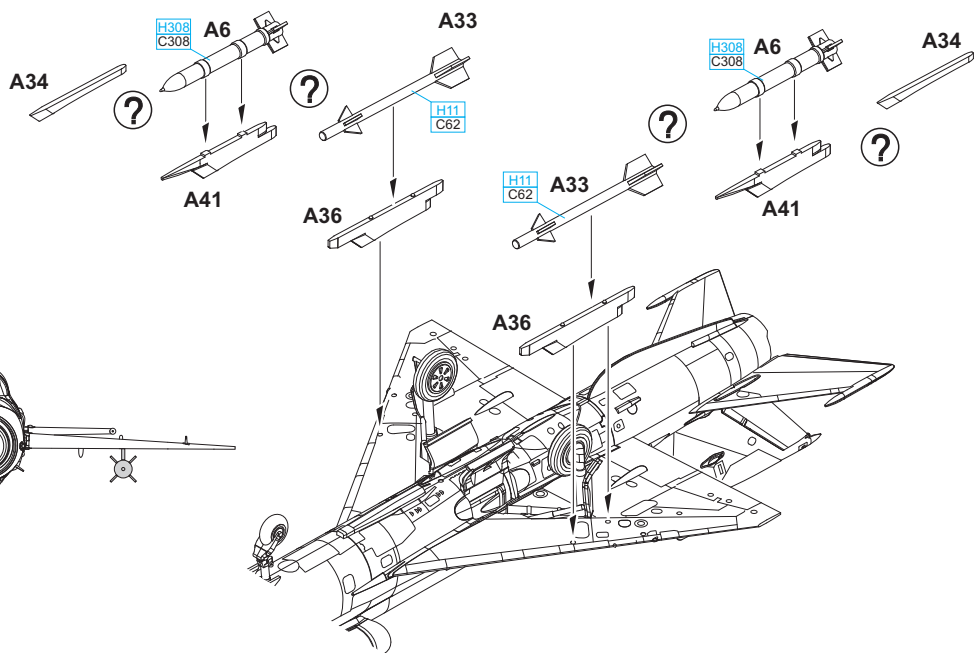
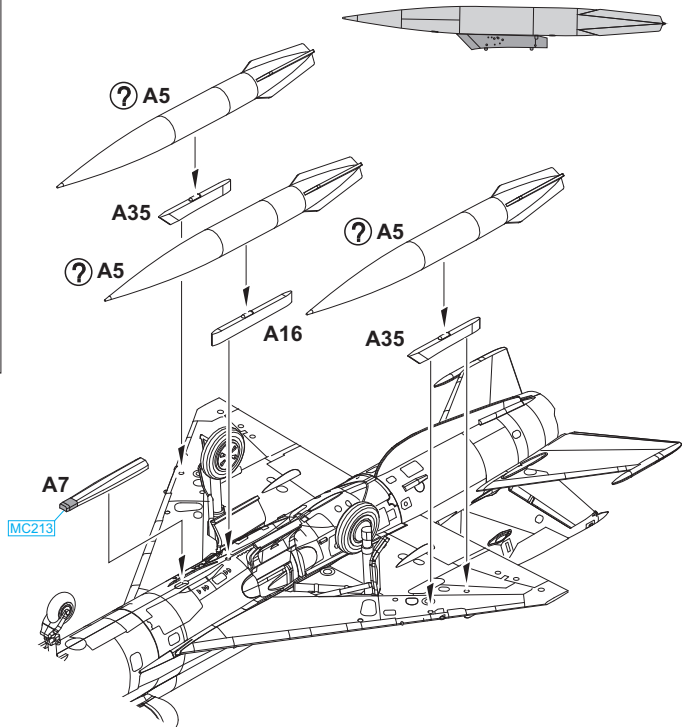
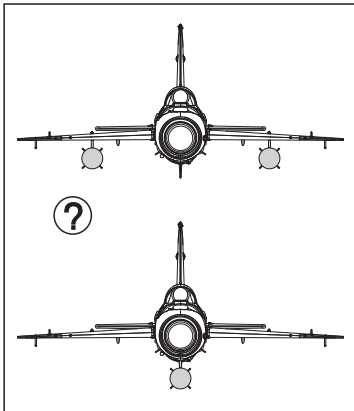

B3

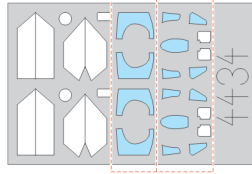
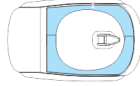

B1

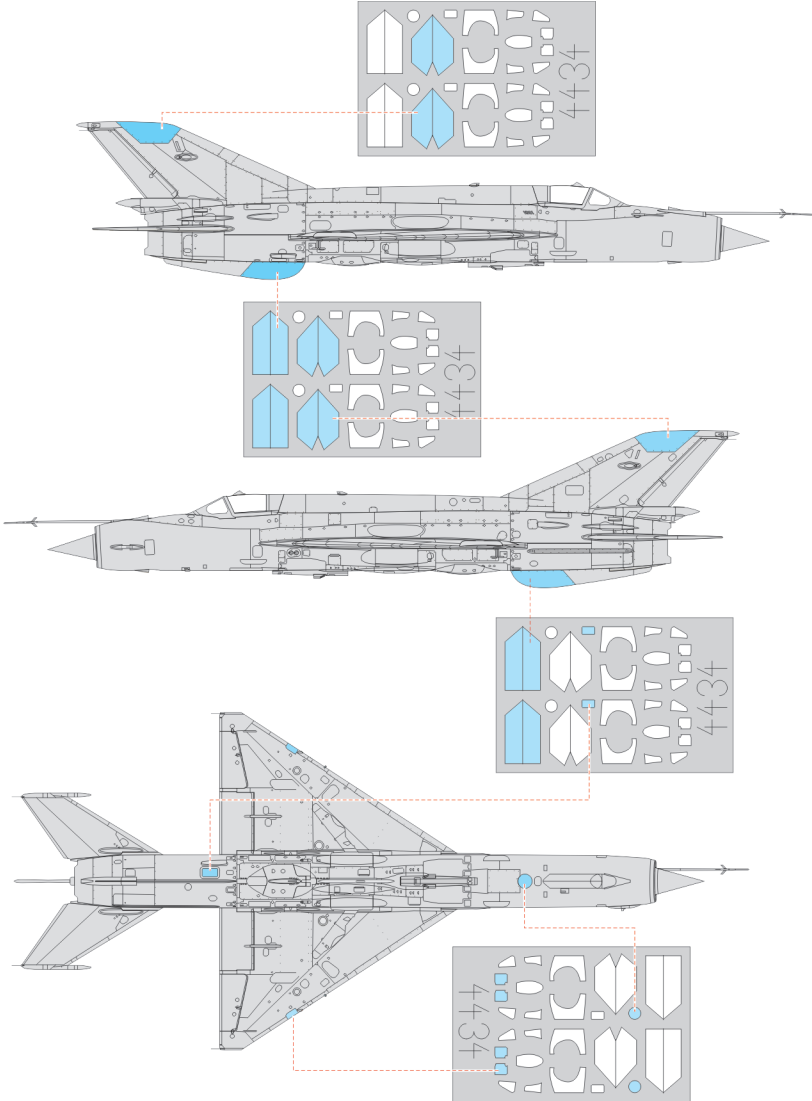

A MiG-21M, 4th Fighter Regiment, 1st Squadron, Pardubice air base, June, 1989

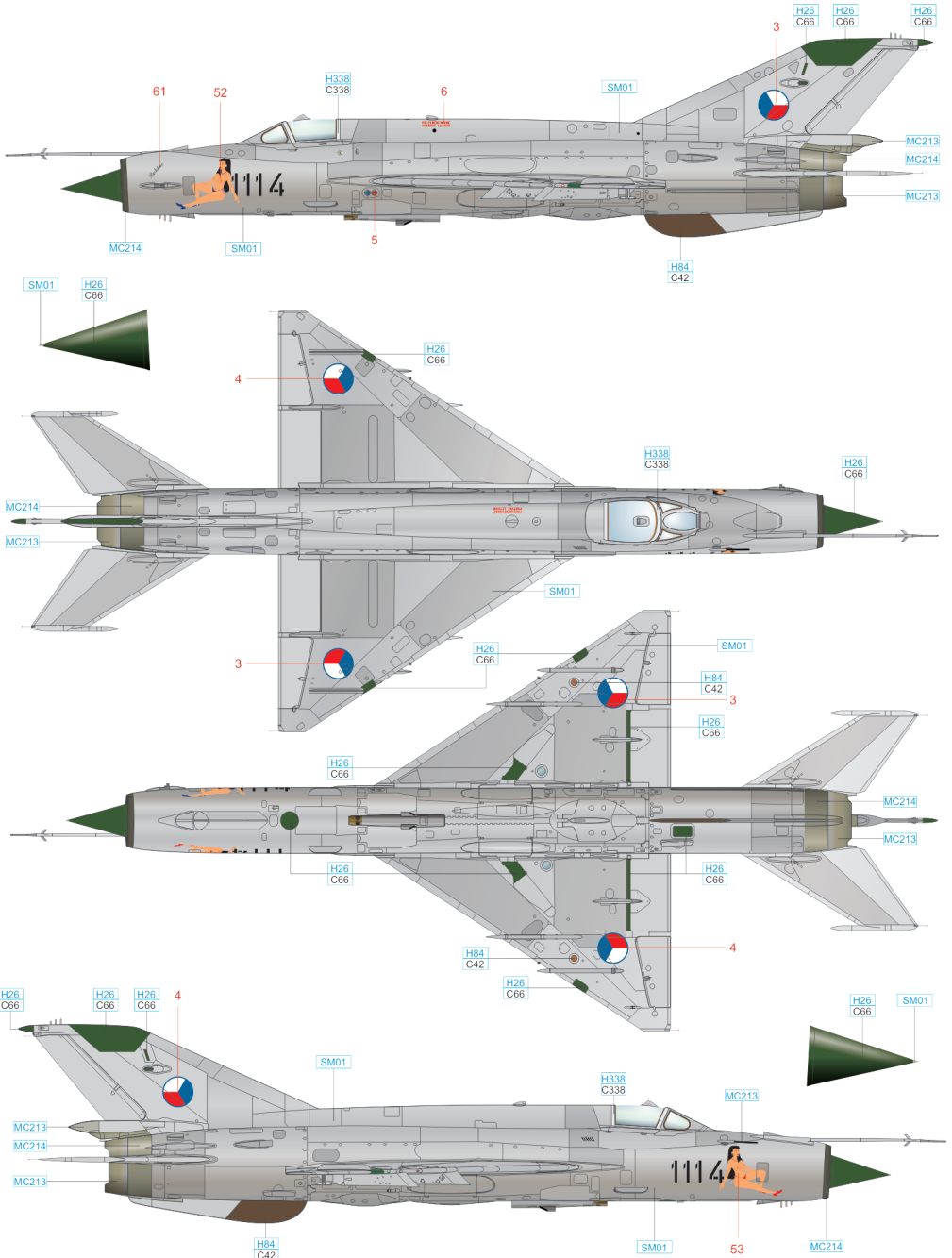

STEEL	MC213	ALUMINIUM	SM01	DARK BROWN	H84 C42
DARK IRON	MC214	GREEN	H26 C66	LIGHT GRAY	H338 C338

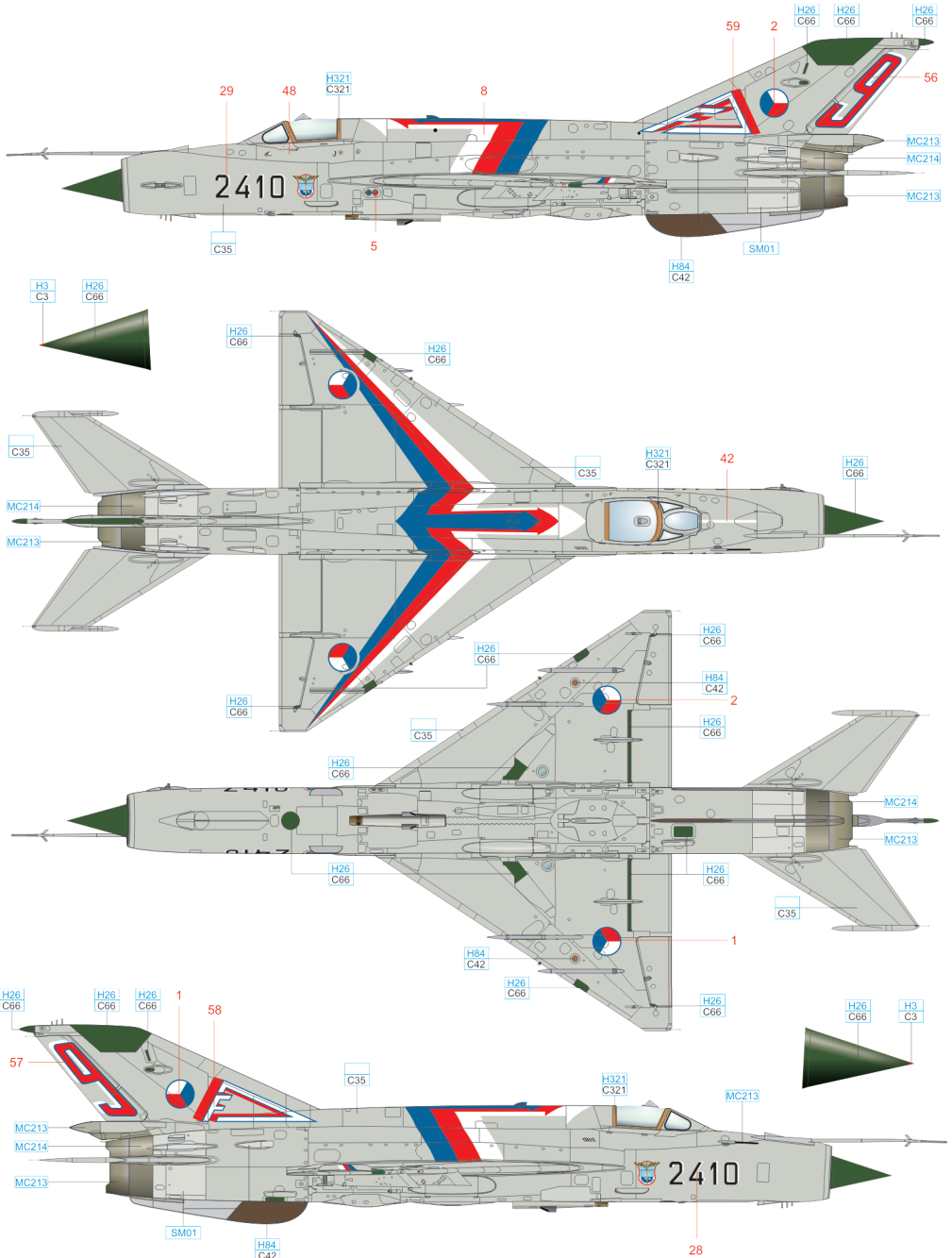

STEEL	MC213	ALUMINIUM	SM01	LIGHT BROWN	H321 C321	DARK BROWN	H84 C42
DARK IRON	MC214	GREEN	H26 C66	RED	H3 C3	LIGHT GRAY	C35

C MiG-21MF, 11th Fighter Regiment, 2nd Squadron, Zatec air base, 1991

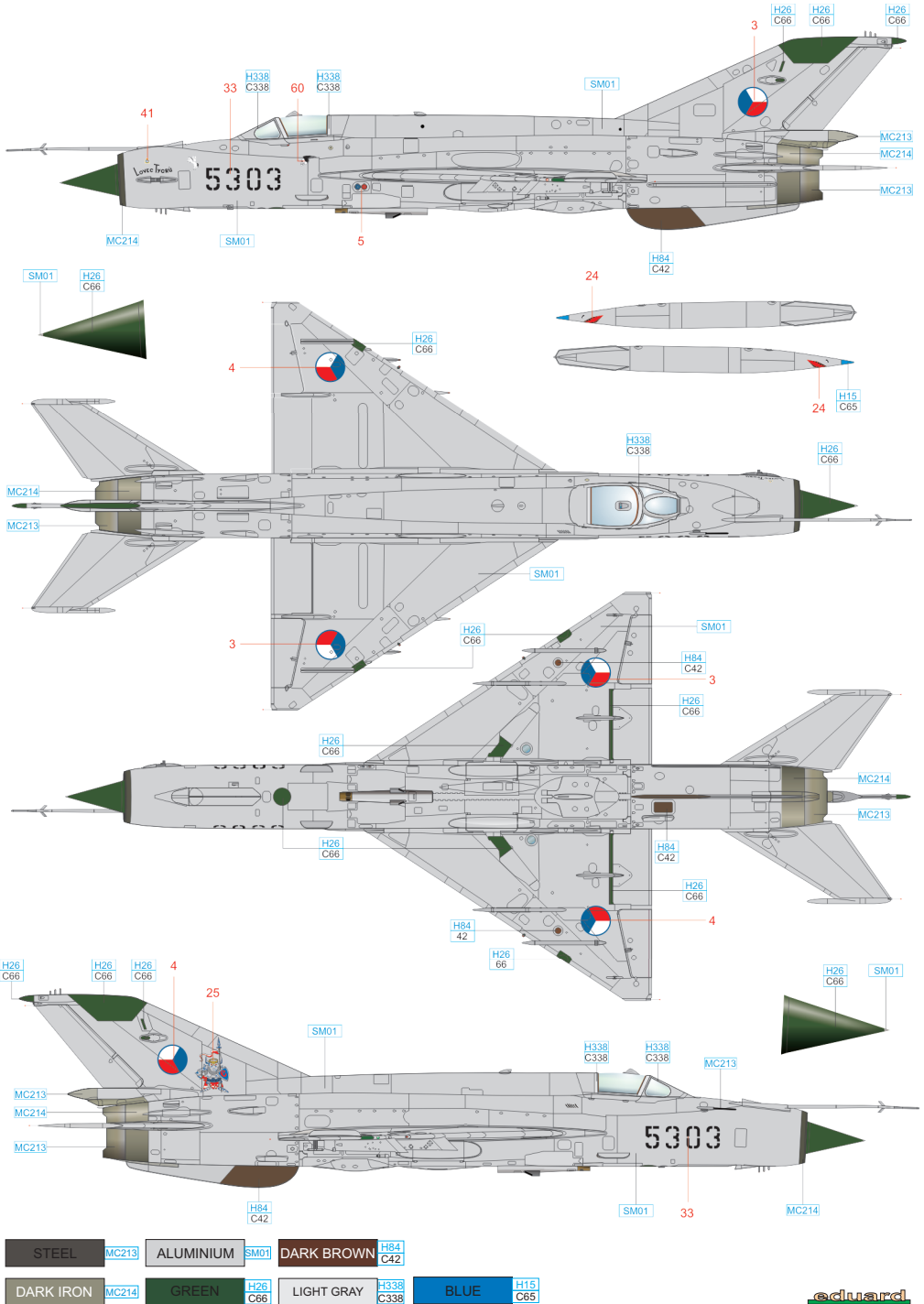

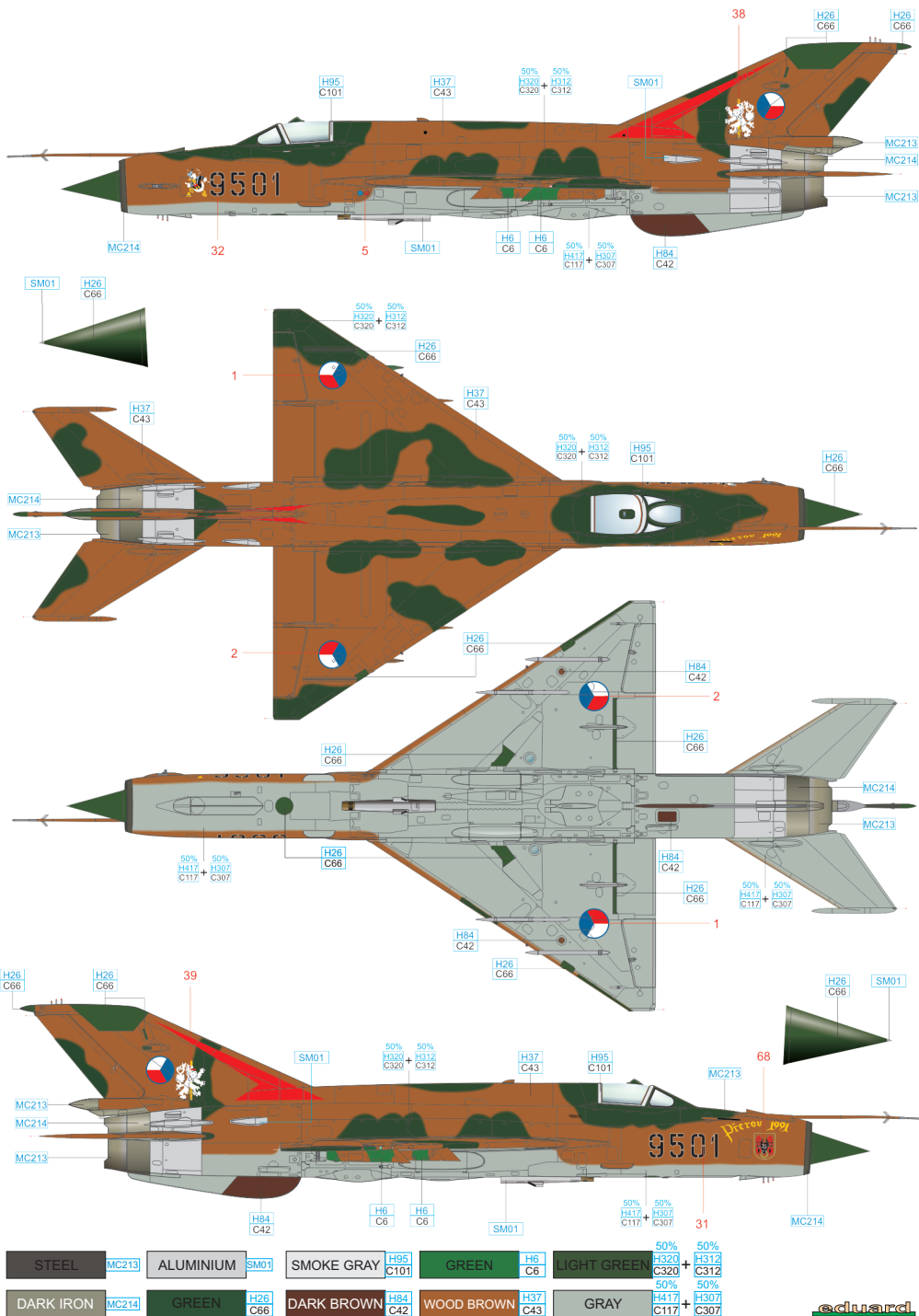

G MiG-21MF, 1st Fighter Regiment, 2nd or 3rd Squadron, Fairford, July, 1994

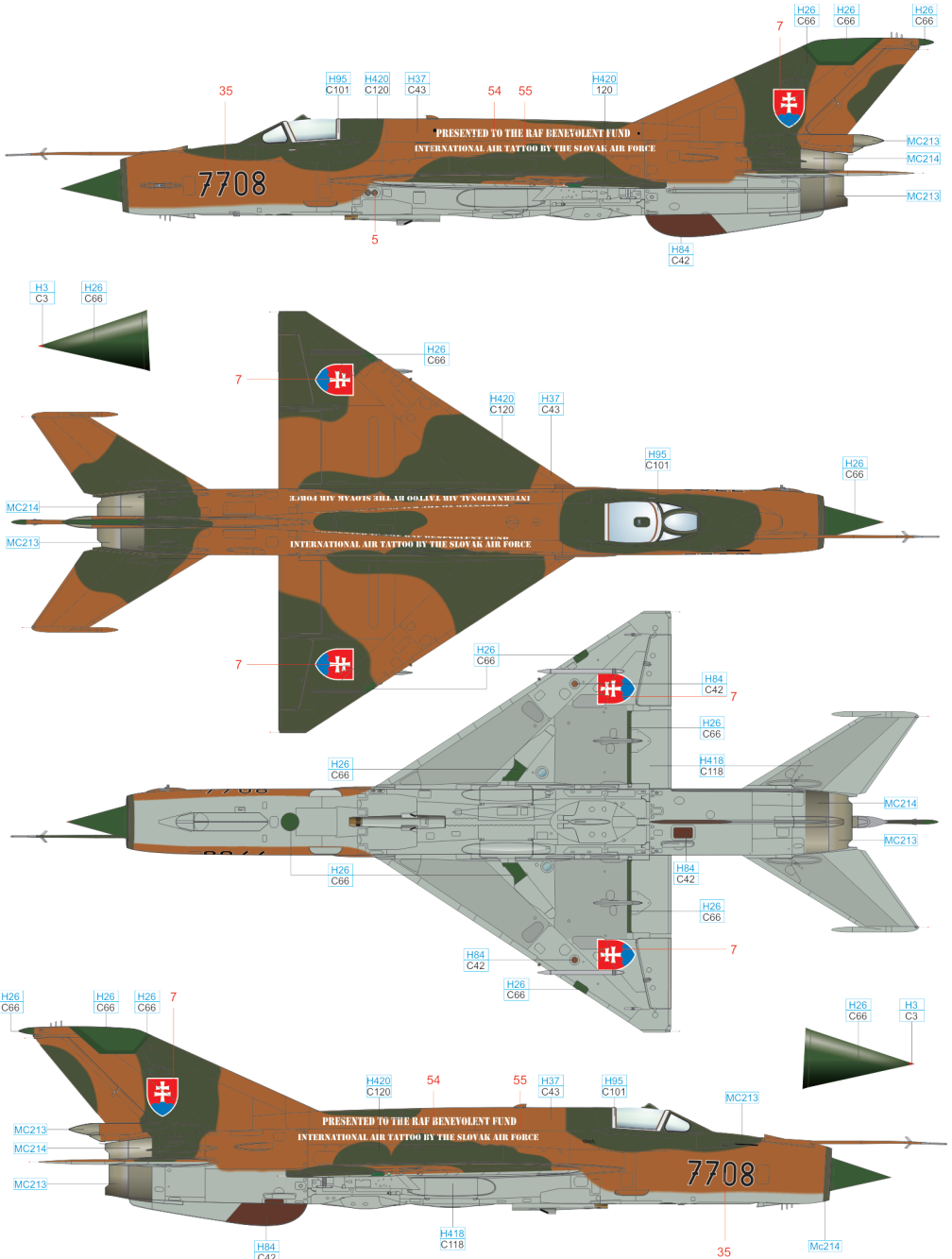

STEEL	MC213	SMOKE GRAY	H95 C101	LIGHT BLUE	H418 C118	OLIVE GREEN	H420 C120
DARK IRON	MC214	GREEN	H26 C66	RED	H3 C3	WOOD BROWN	H37 C43
						DARK BROWN	H84 C42

