

**ГІМІН**  
LIMITED EDITION

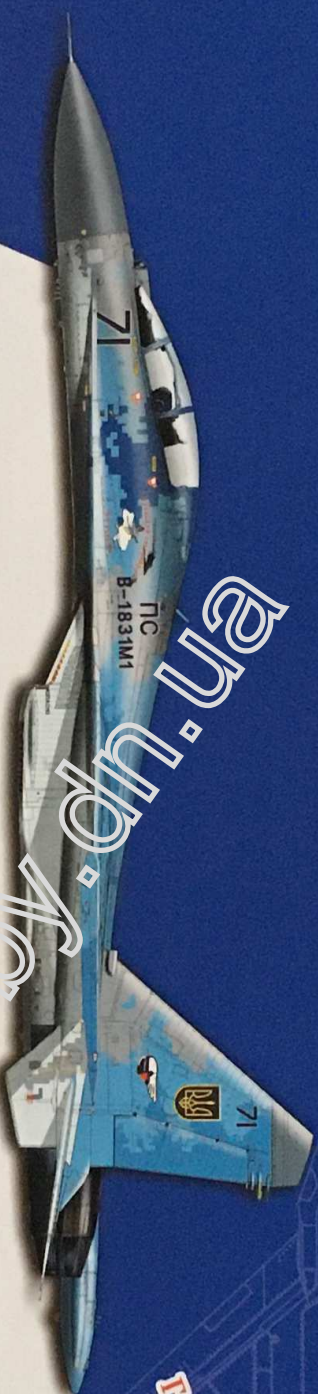

Він. Чо. Не.



**SU-27UBM**  
"FLANKER-C" IN DIGITAL CAMOUFLAGE  
Су-27УВМ "FLANKER-C" 乌克兰空军数码迷彩涂装限量版

**УКРАЇНА**  
**АВІА**  
**ПОЛК**  
**ІЛЬНИЦЬКИЙ**  
**АВІАПОЛК**



**1/48**  
SCALE **S4817**

1

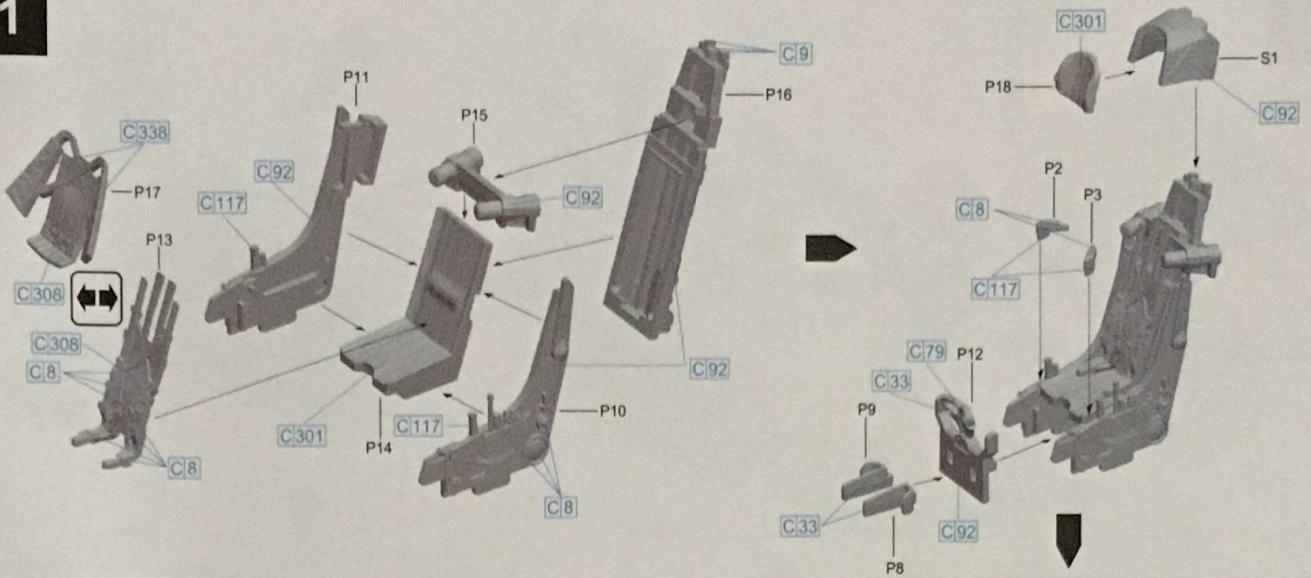

K-36DM Ejection Seat  
K-36DM弹射座椅

x2

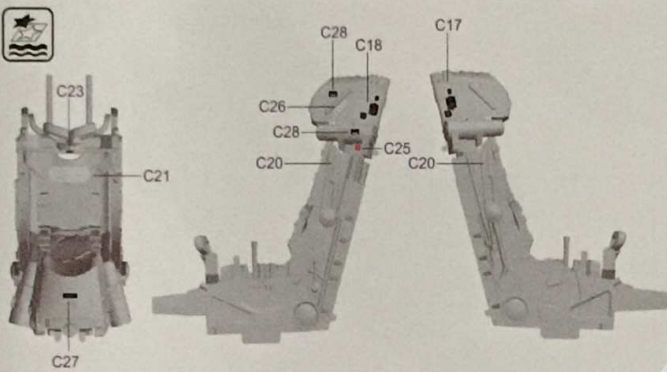

2

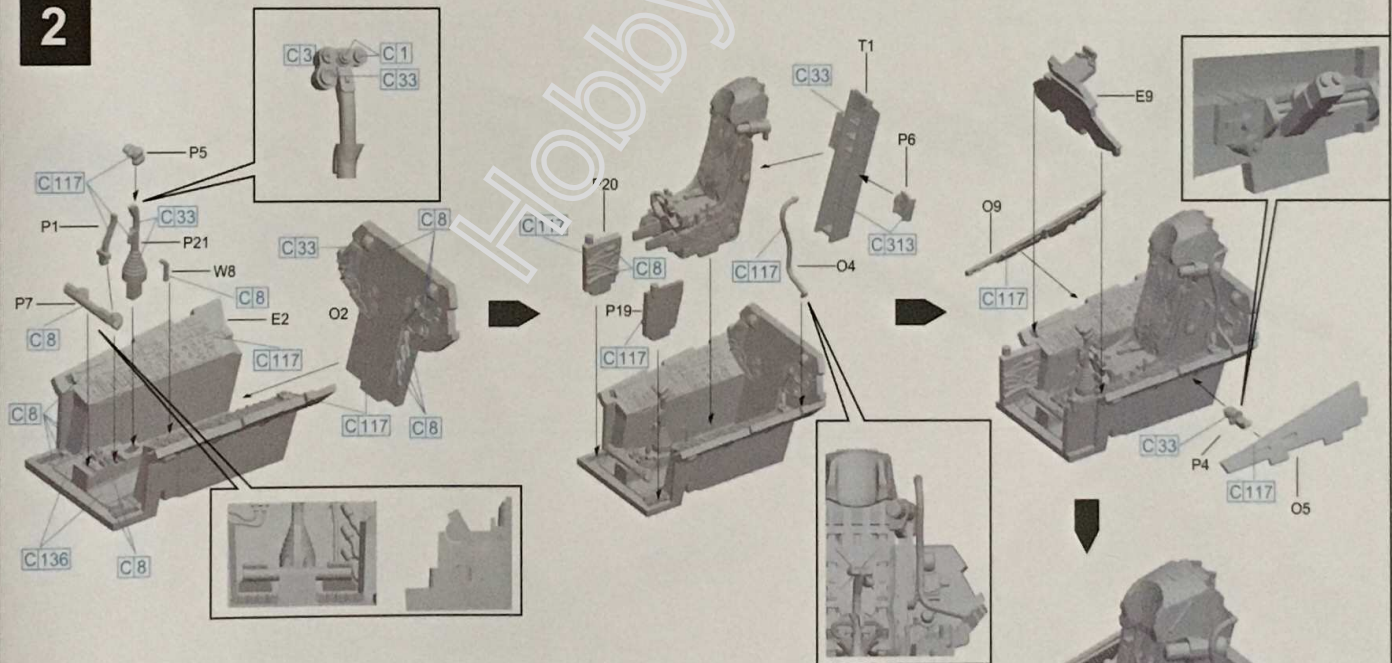

Front Cockpit  
前座舱

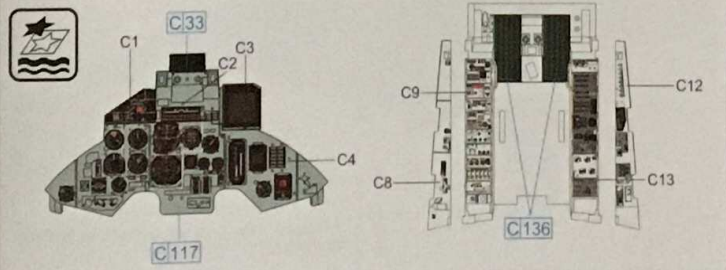

3

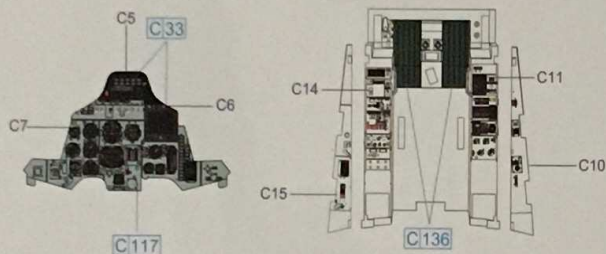
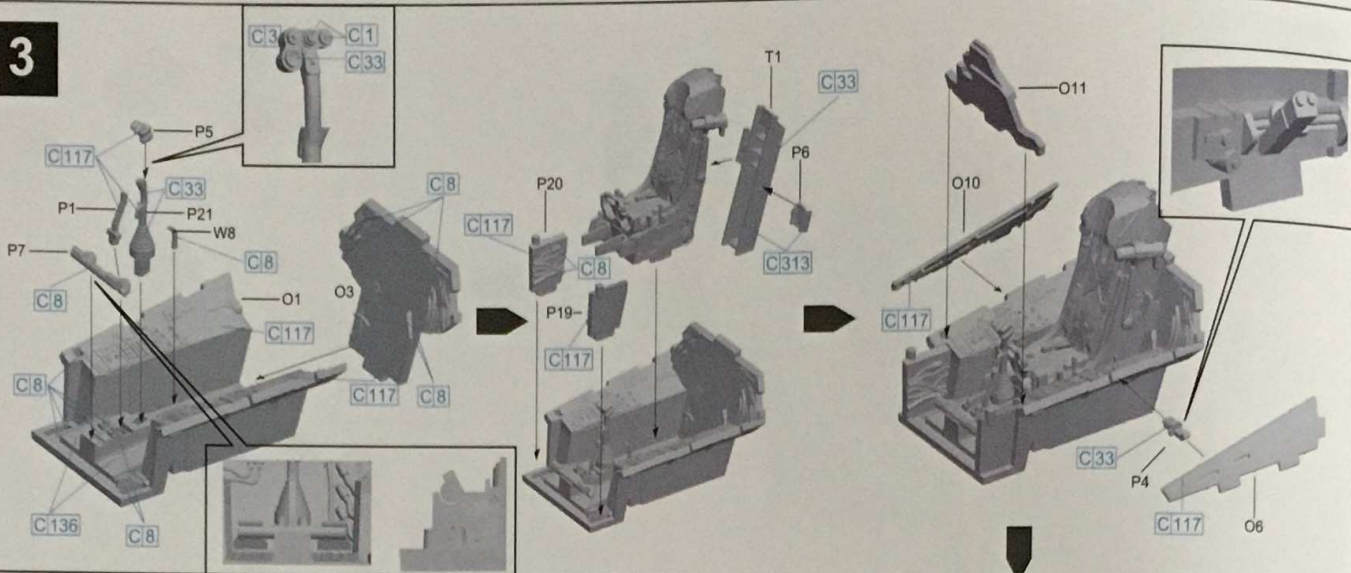

Rear Cockpit  
后座舱

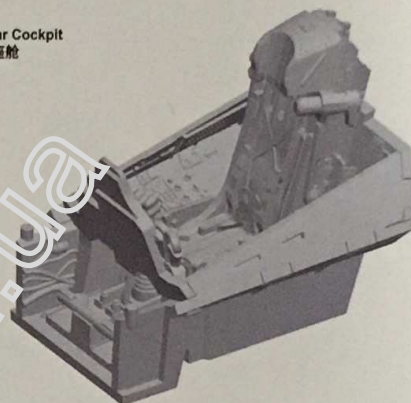

4

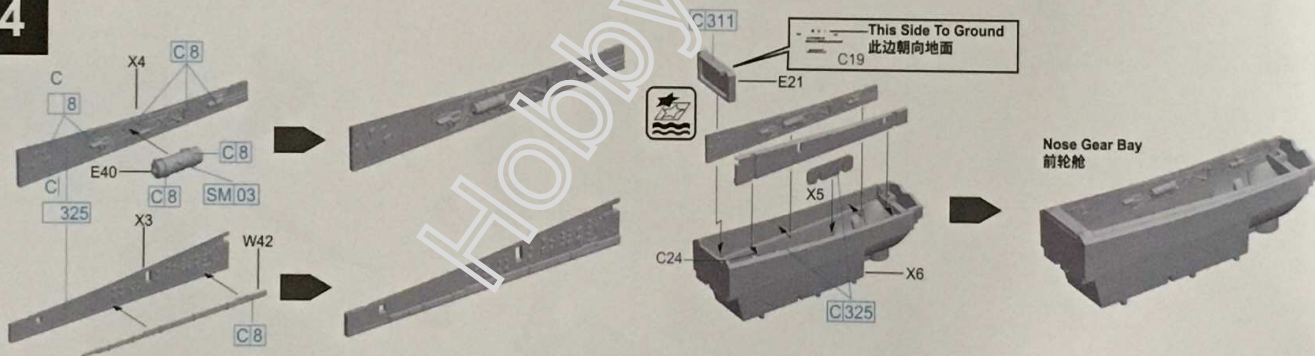

Nose Gear Bay  
前轮舱

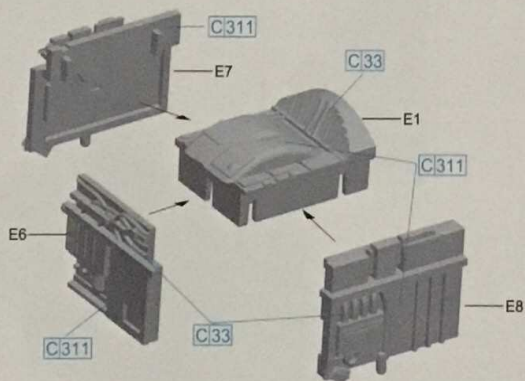

N001 Radar Equipment Box  
N001 雷达维护设备



If Radome Is Not Opened You Can Skip This Step  
如果雷达罩不打开可跳过此步骤

5

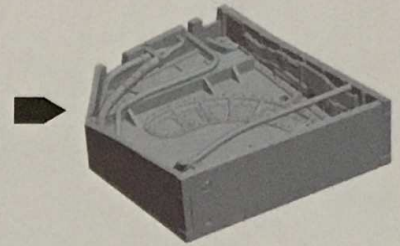
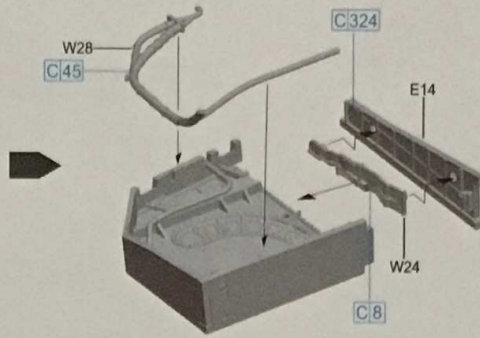
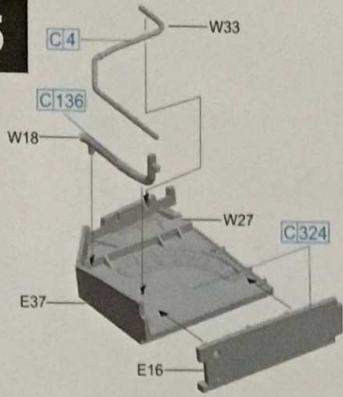

Left Wheel Bay  
左主起落架舱

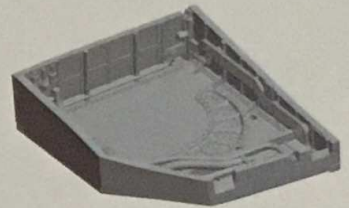
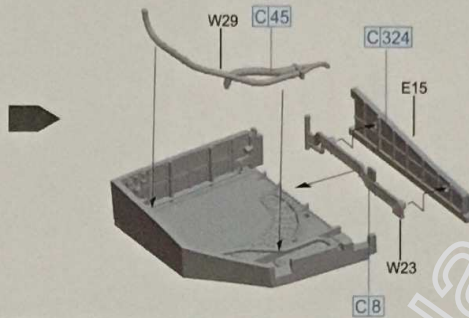
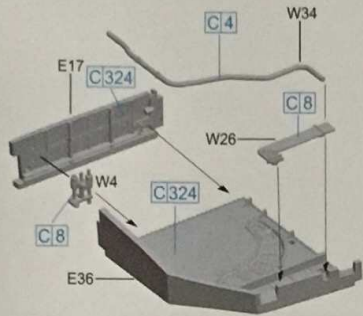

Right Wheel Bay  
右主起落架舱

5

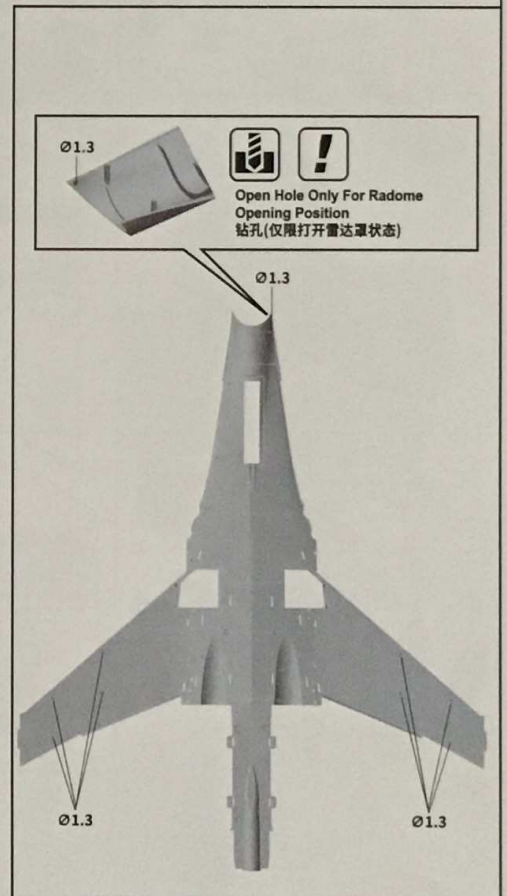

6

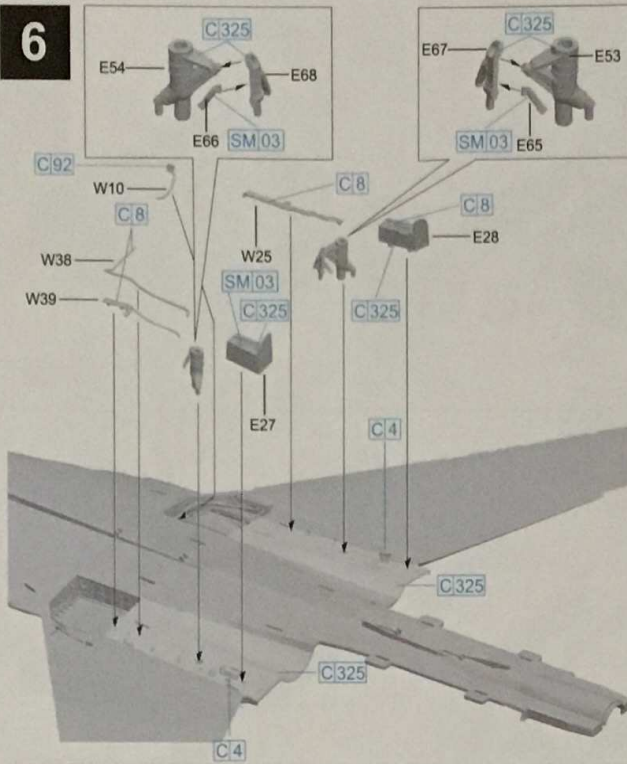

**!** Skip This Step If Close Gear Bays For In Flight Position  
如果制作飞行状态则跳过此步骤

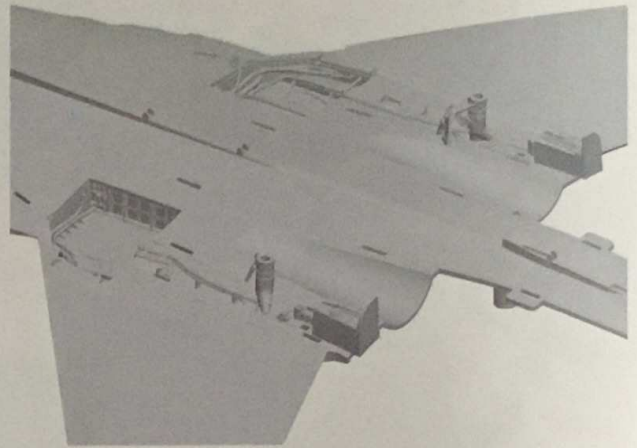

7

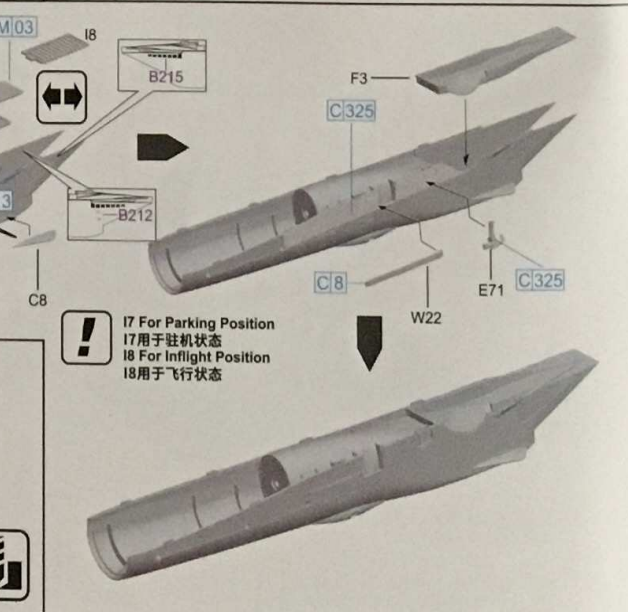
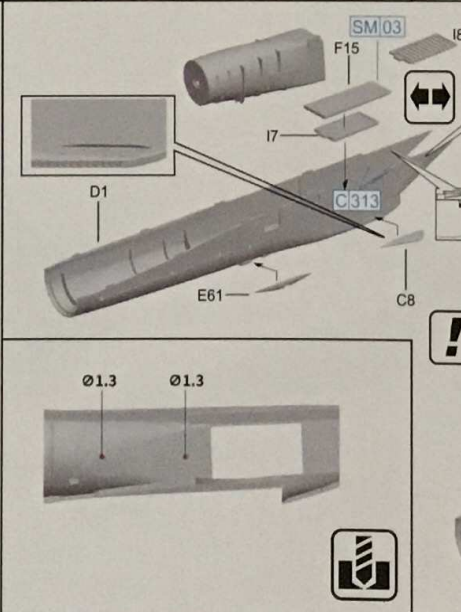
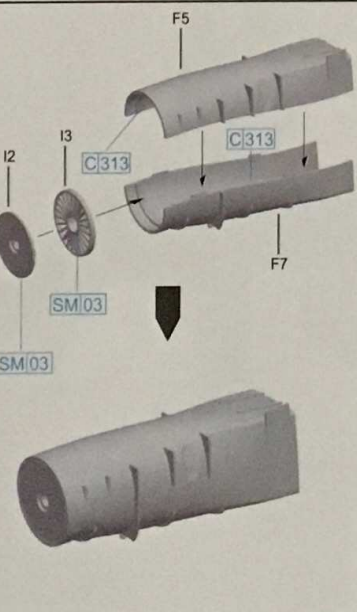
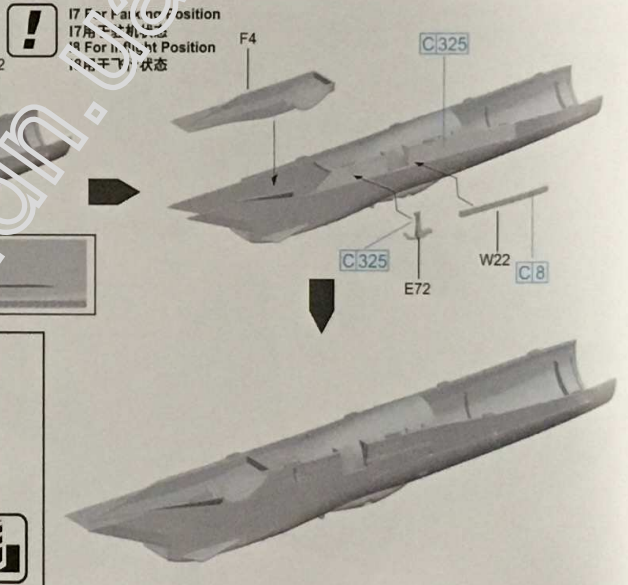
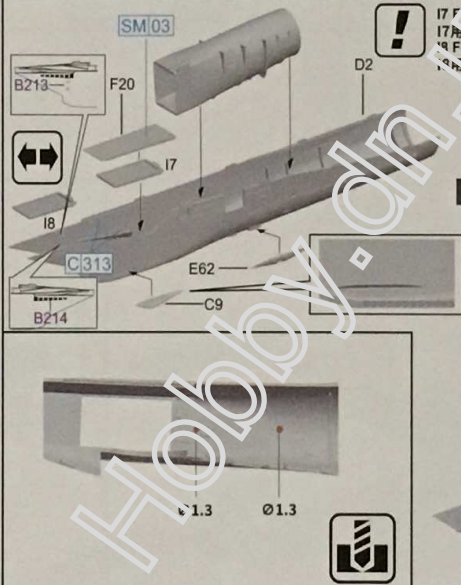
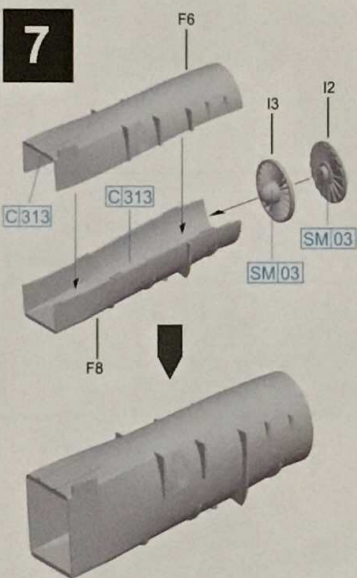

8

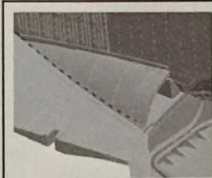
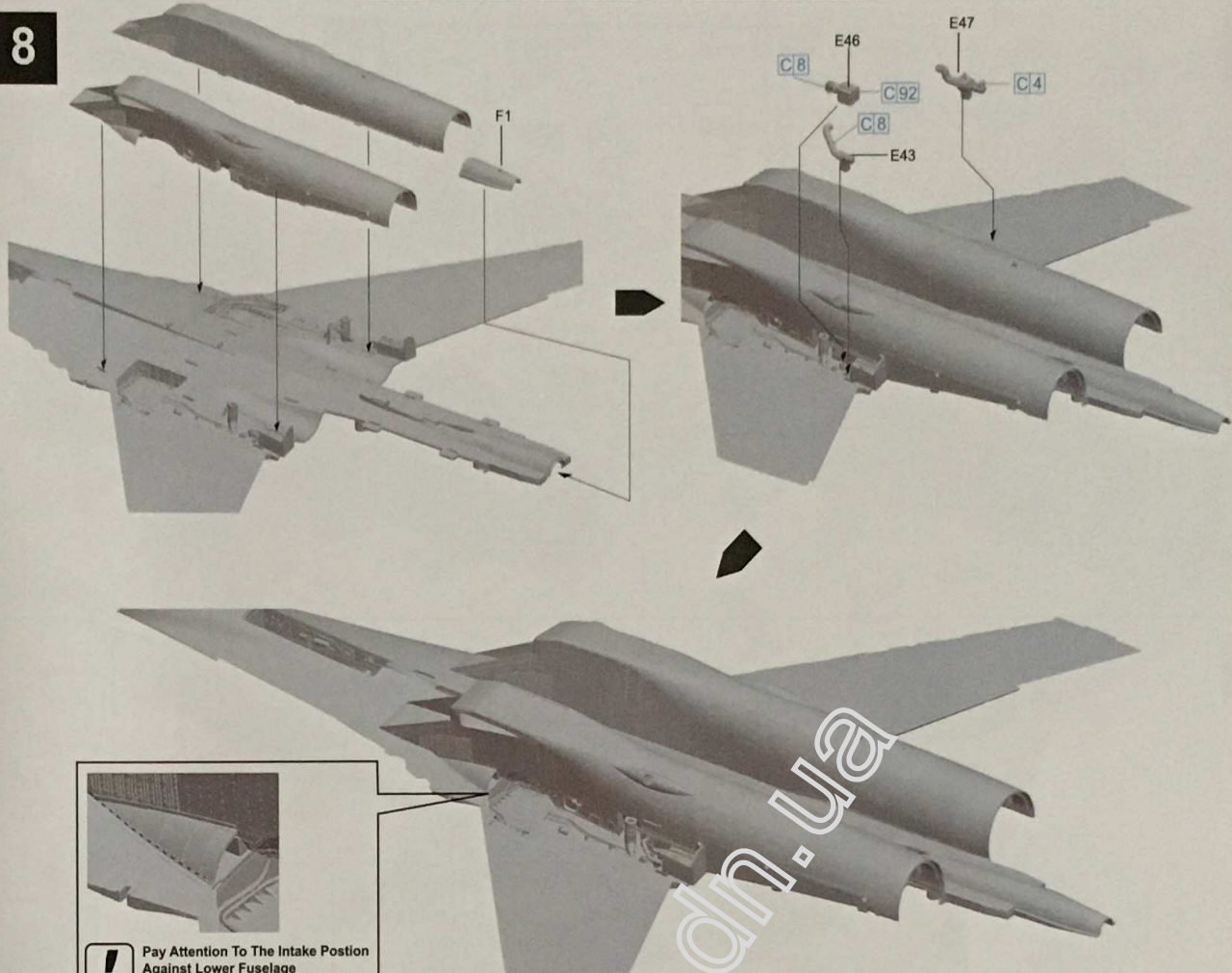

**!** Pay Attention To The Intake Position Against Lower Fuselage  
注意进气道与下机身的相对配位置

9

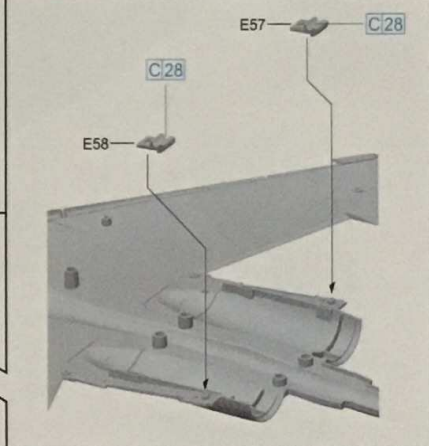
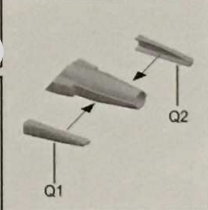
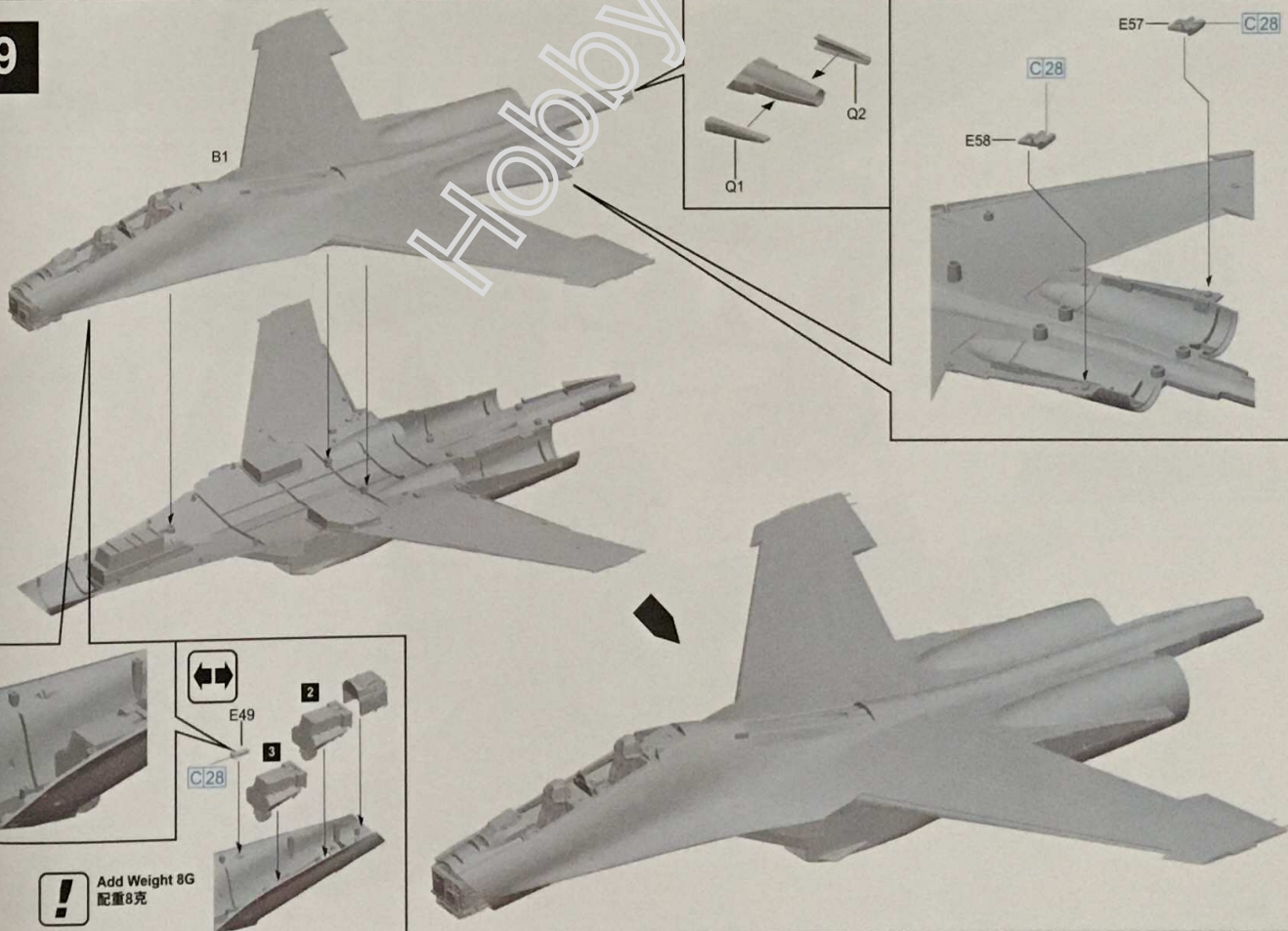

**!** Add Weight 8G  
配重8克

10

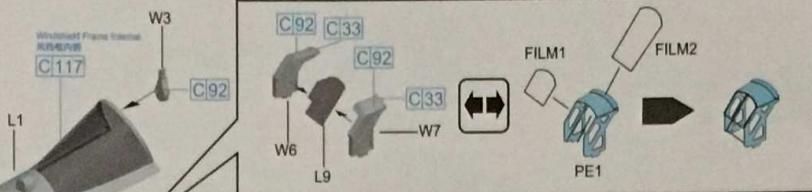

**!** **✂**  
 Cut The Hinges  
 To Close Radome  
 切去定位插栓用  
 于关闭雷达罩

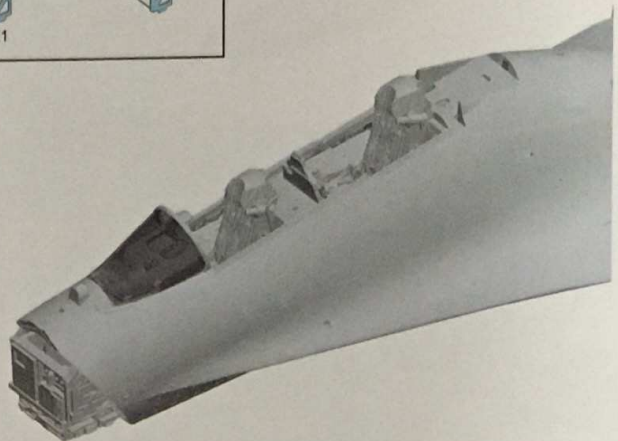
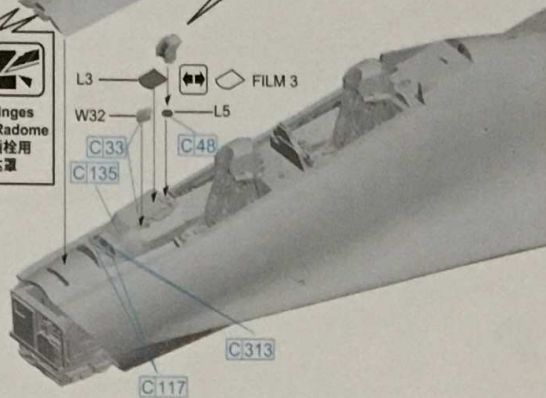

11

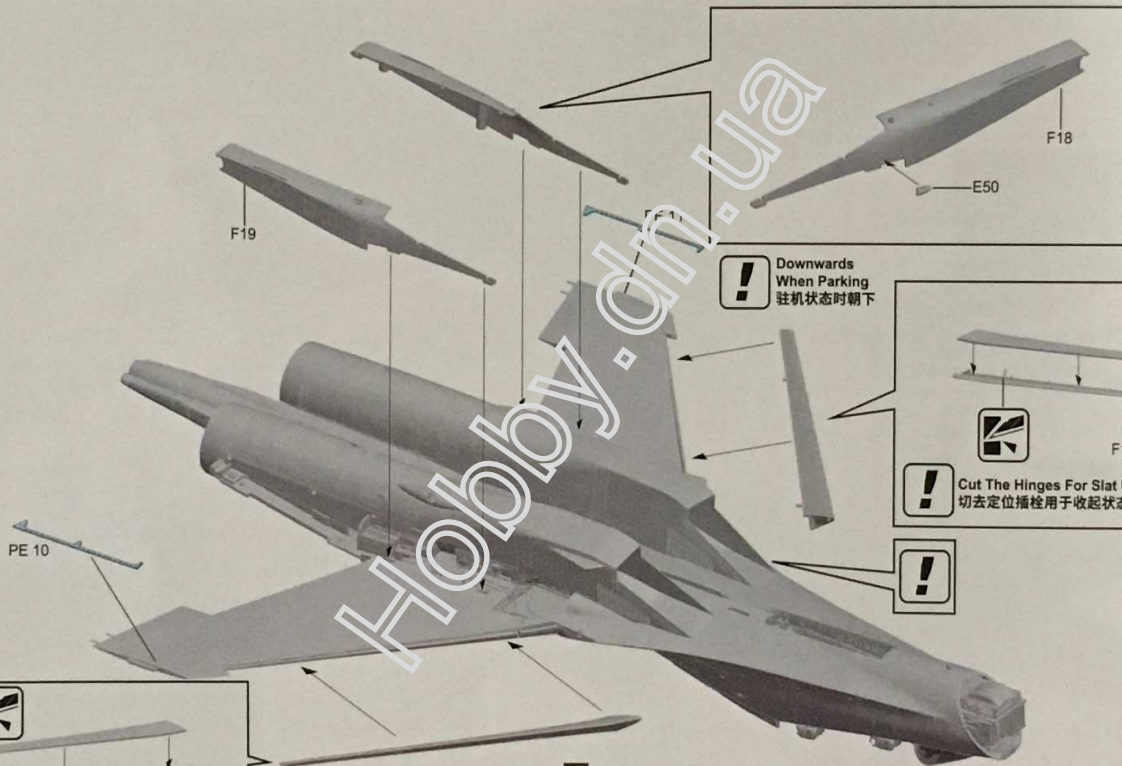

**!** Downwards  
 When Parking  
 驻机状态时朝下

**!** **✂**  
 Cut The Hinges For Slat Up ( Inflight Position)  
 切去定位插栓用于收起状态/飞行状态



**!** **✂**  
 Cut The Hinges For Slat Up ( Inflight Position)  
 切去定位插栓用于收起状态/飞行状态

**!** Downwards When Parking  
 驻机状态时朝下





**!** Open Hole Only For Radome Opening Status  
 钻孔 (仅限打开雷达罩状态)

**12**

Only For Radome Opening Position  
 仅限打开雷达罩状态

Left Side View  
 左侧视

Pilot Tube Has 3 Degree Up Against radome center line  
 空速管与雷达罩中心线呈3度上翘夹角

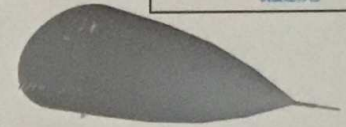
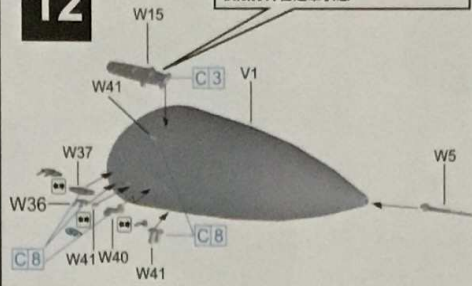

Radome  
 雷达罩

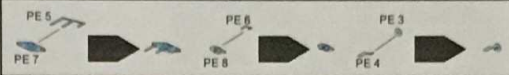

Do not Use G8 G9 Parts If Close Canopy  
 如果关闭座舱盖则无需使用G8 G9 零件

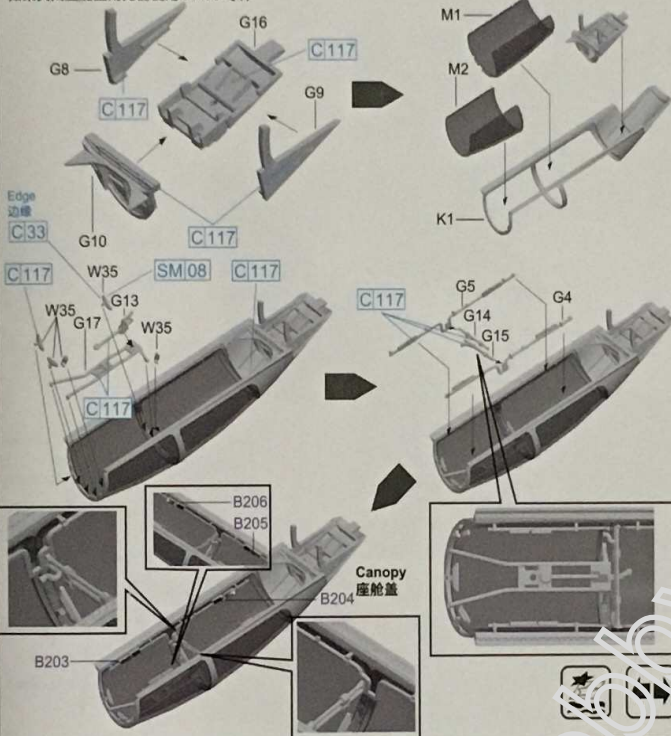

Do not Use G8 G9 Parts If Close Canopy  
 如果关闭座舱盖则无需使用G8 G9 零件

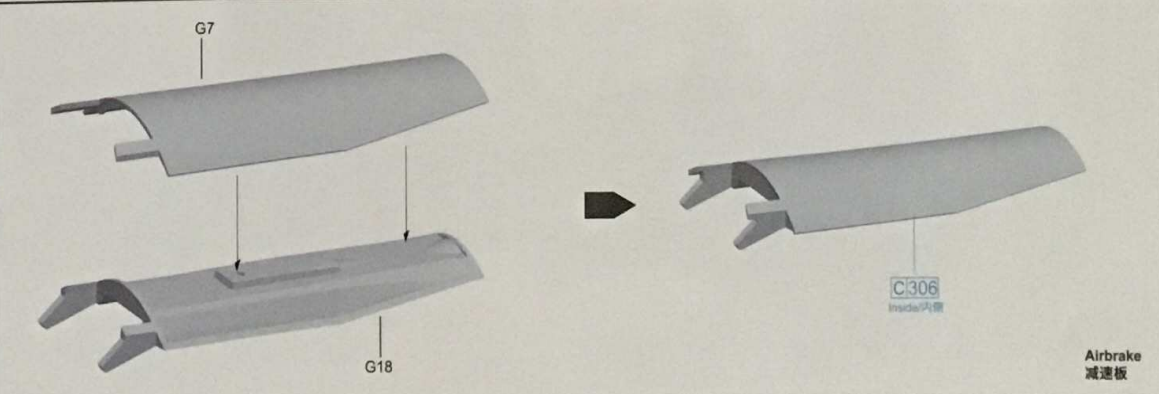
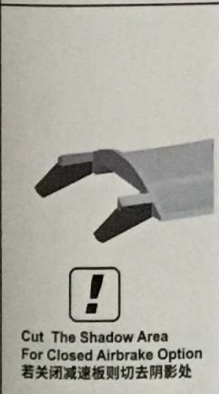
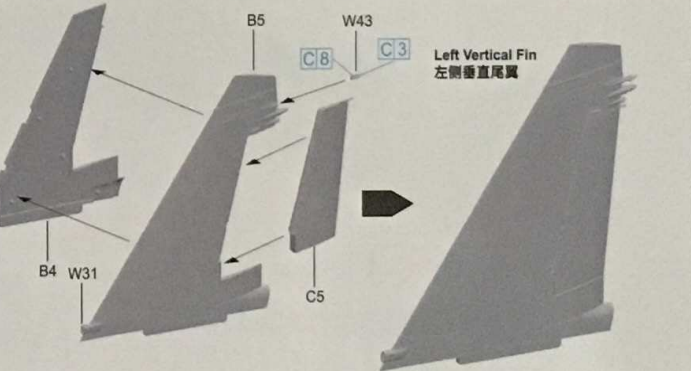
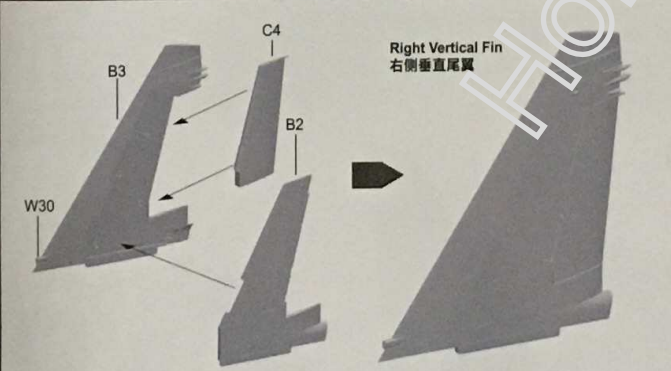
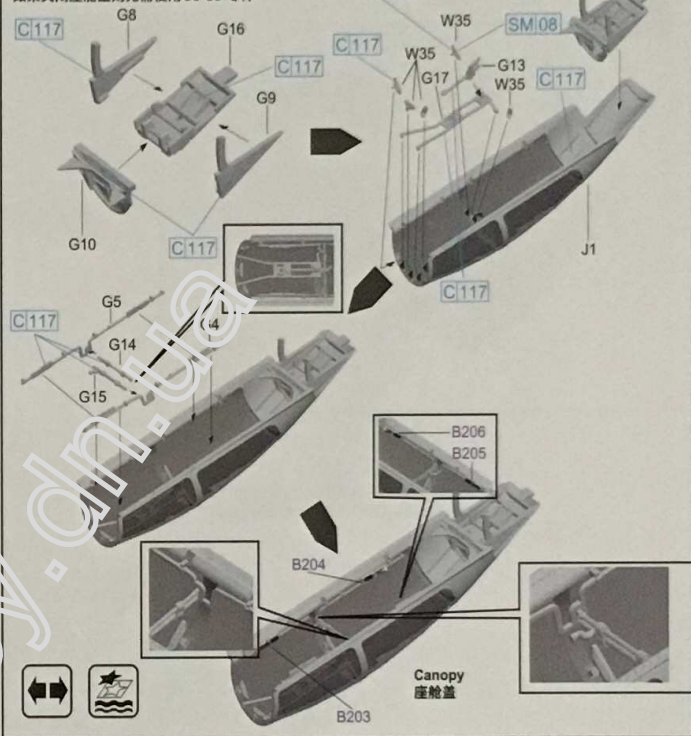



12

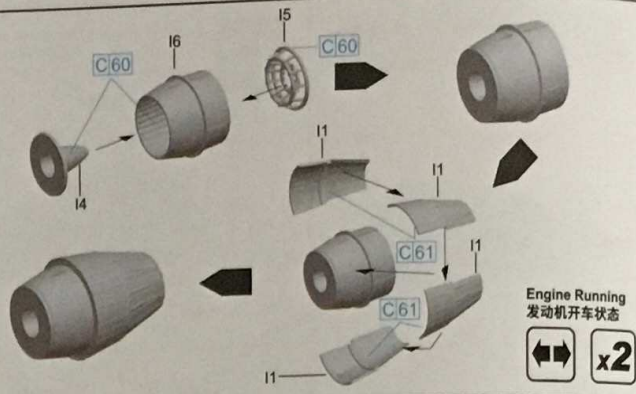
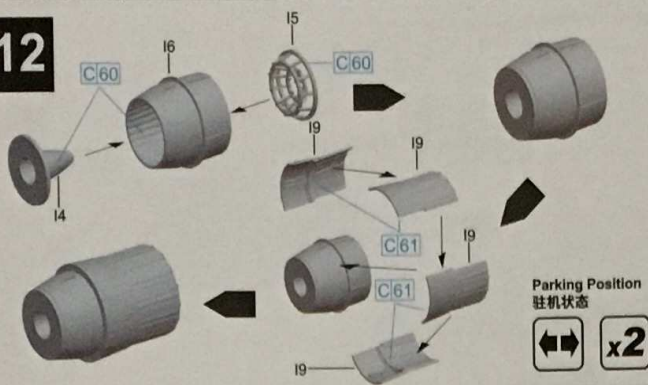

13

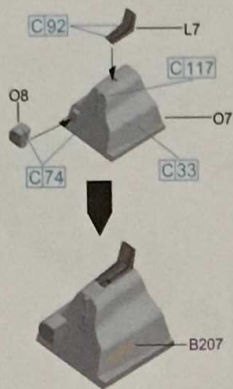

**!** Do not Use G11 G12 Parts If Close Canopy  
如果关闭座舱盖则无需使用G11 G12 零件

**!** Cut The Hinges For  
Slat Up ( Inflight Position)  
切去定位插柱用于  
收起状态/飞行状态

**!** Downwards  
When Parking  
驻车状态时朝下

**!** Only For Radome Opening Position  
仅限打开雷达罩状态

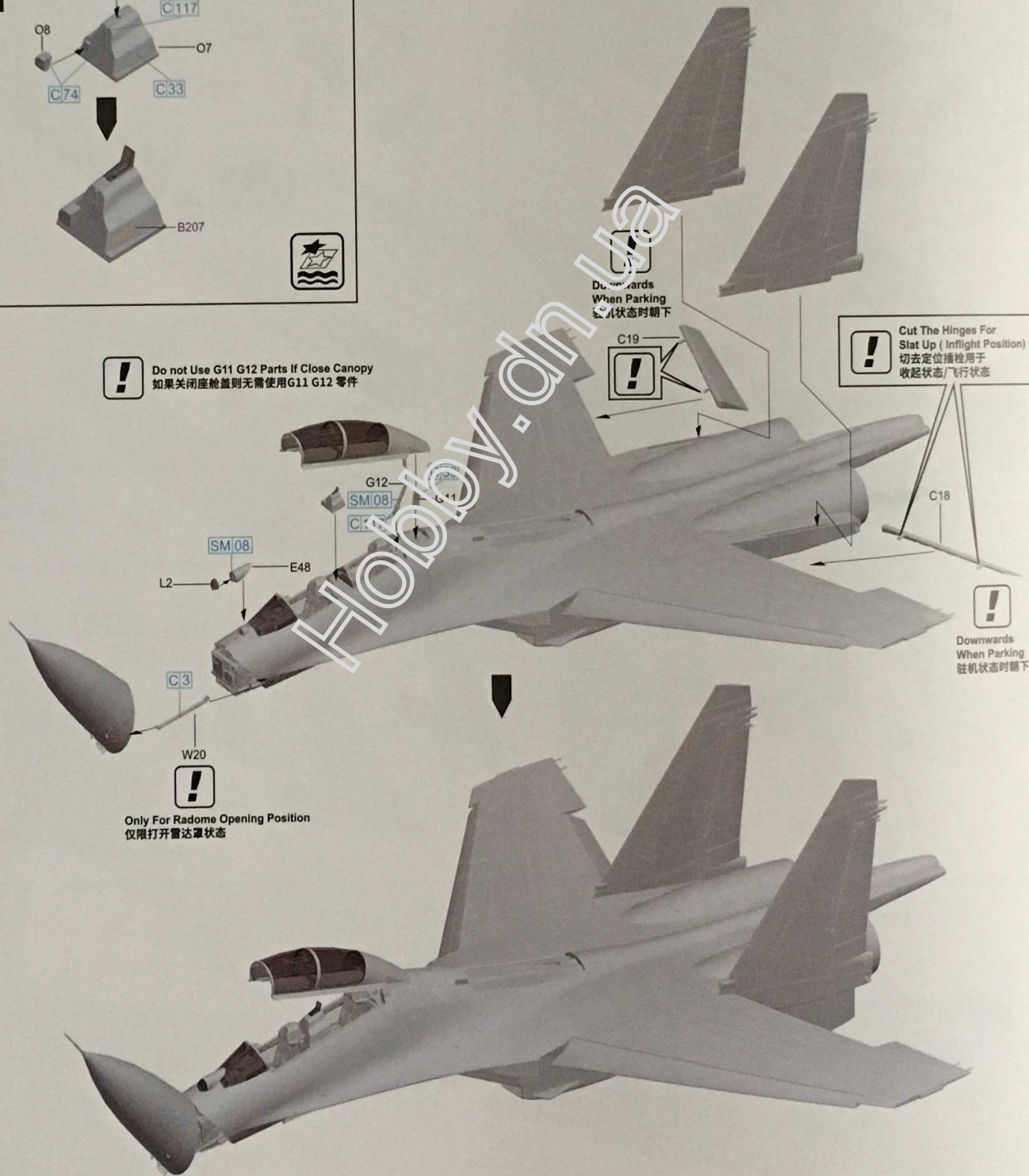

14

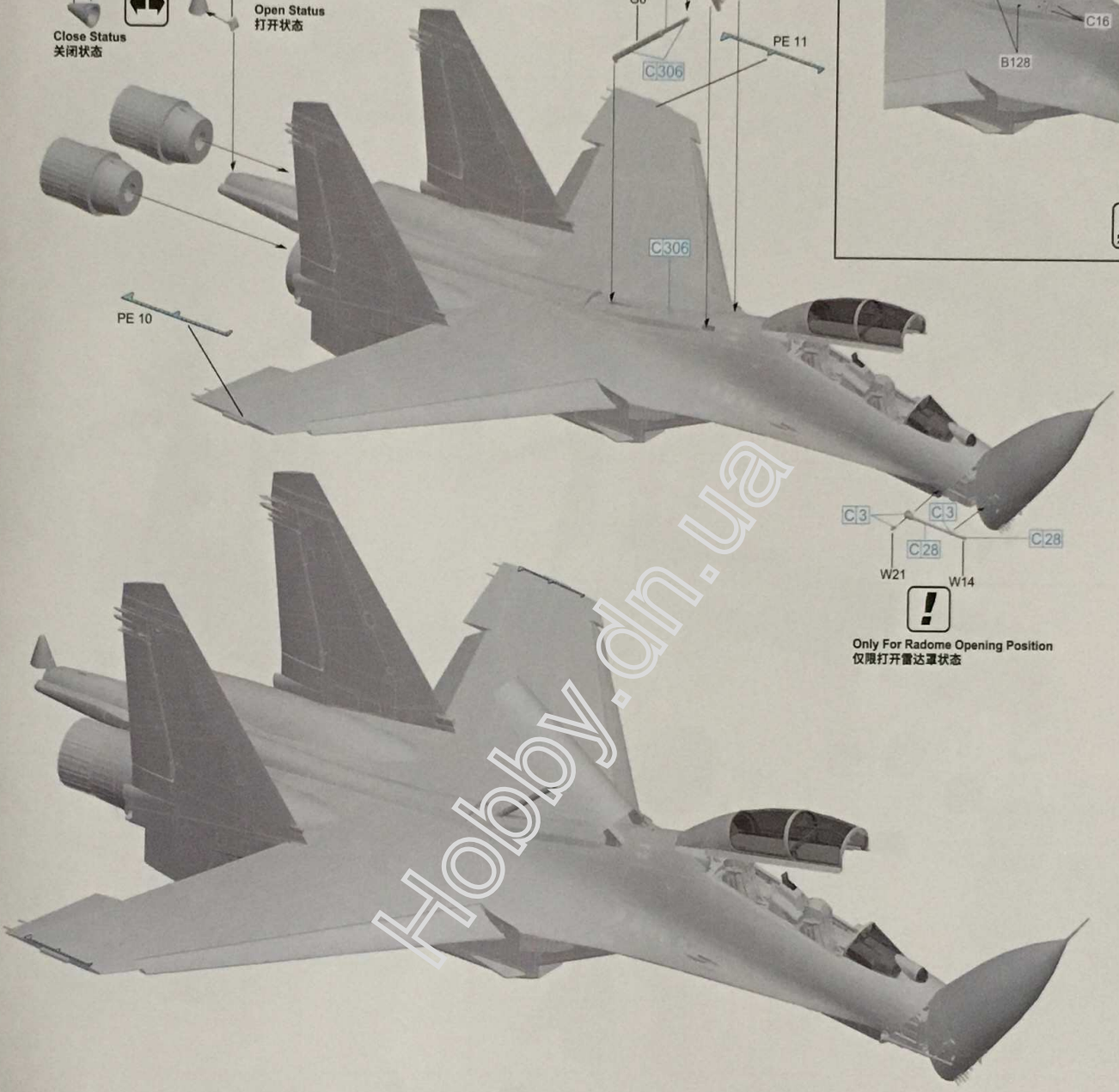
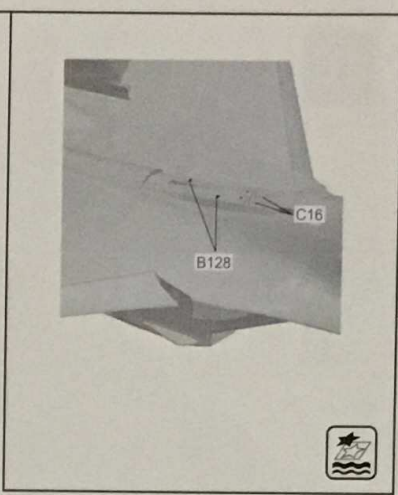
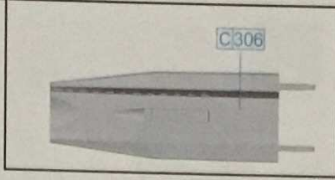

Only For Radome Opening Position  
仅限打开雷达罩状态

15

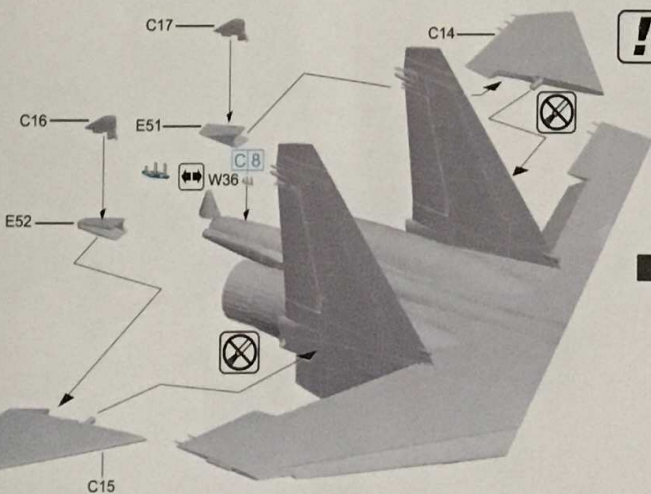

In Downward Position When Parking  
驻车状态时朝下



16

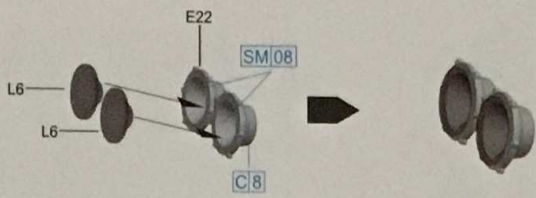

Reduce By 0.5mm For Full Load Status  
制作满载状态，液压杆缩短0.5mm

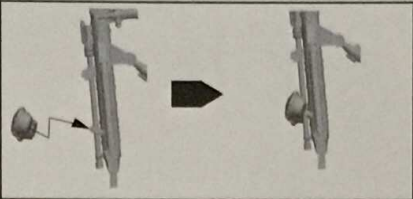

17

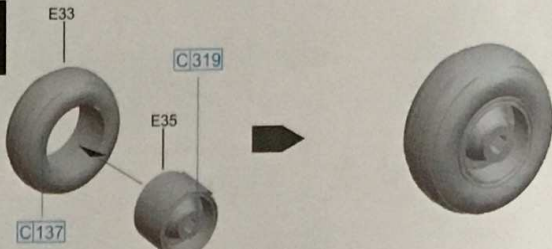

Gently Adjust Angle Of Rods If Necessary  
如有需要请轻微调节连接杆角度

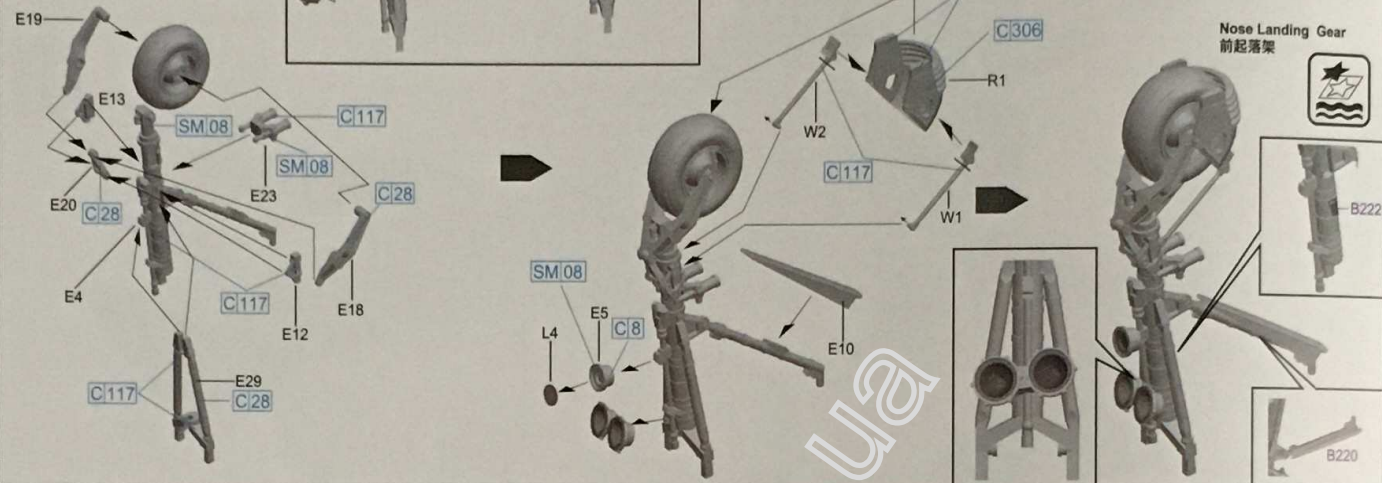

Nose Landing Gear  
前起落架

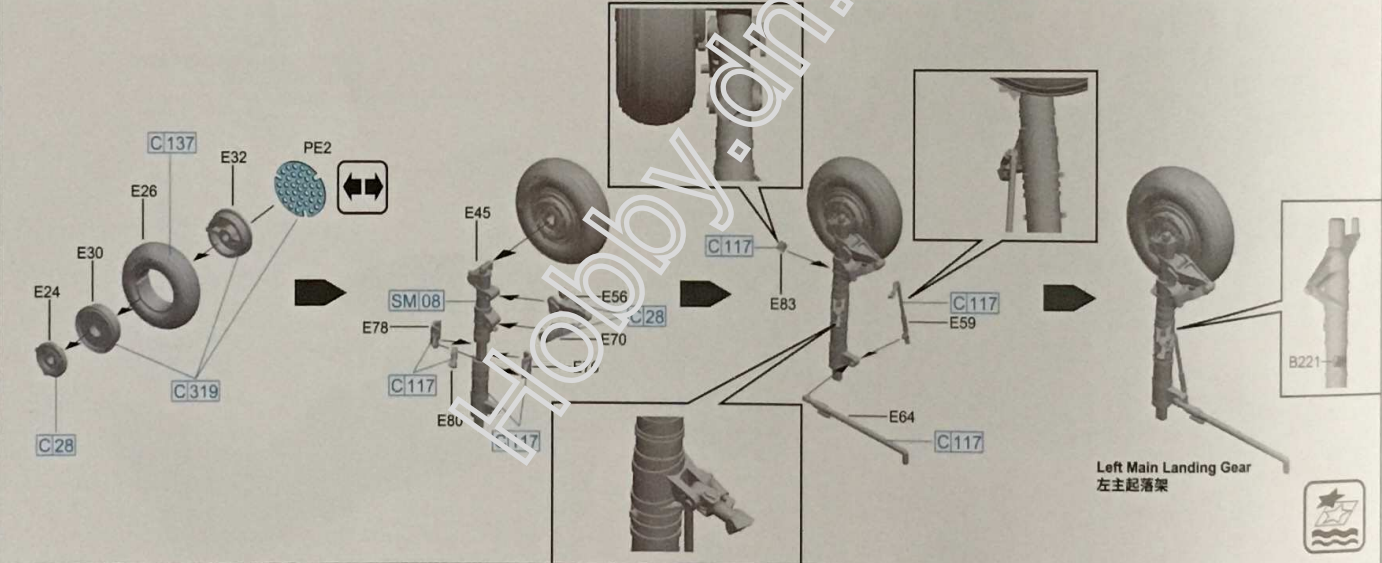
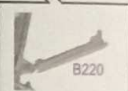

Left Main Landing Gear  
左主起落架

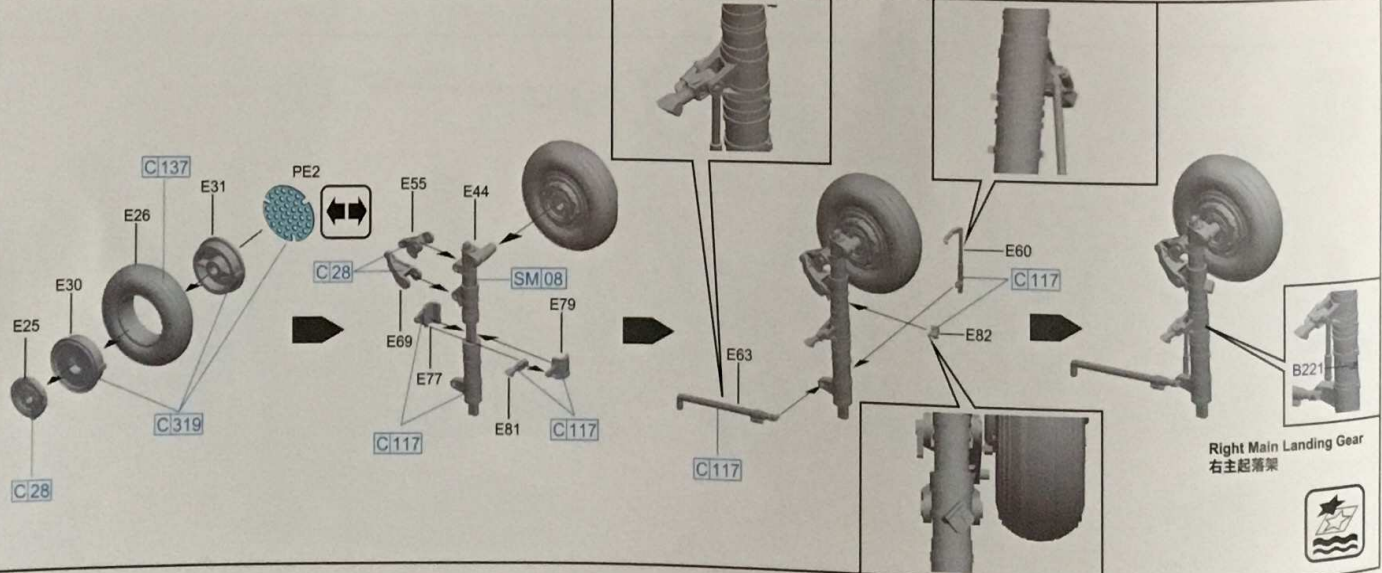

Right Main Landing Gear  
右主起落架



18

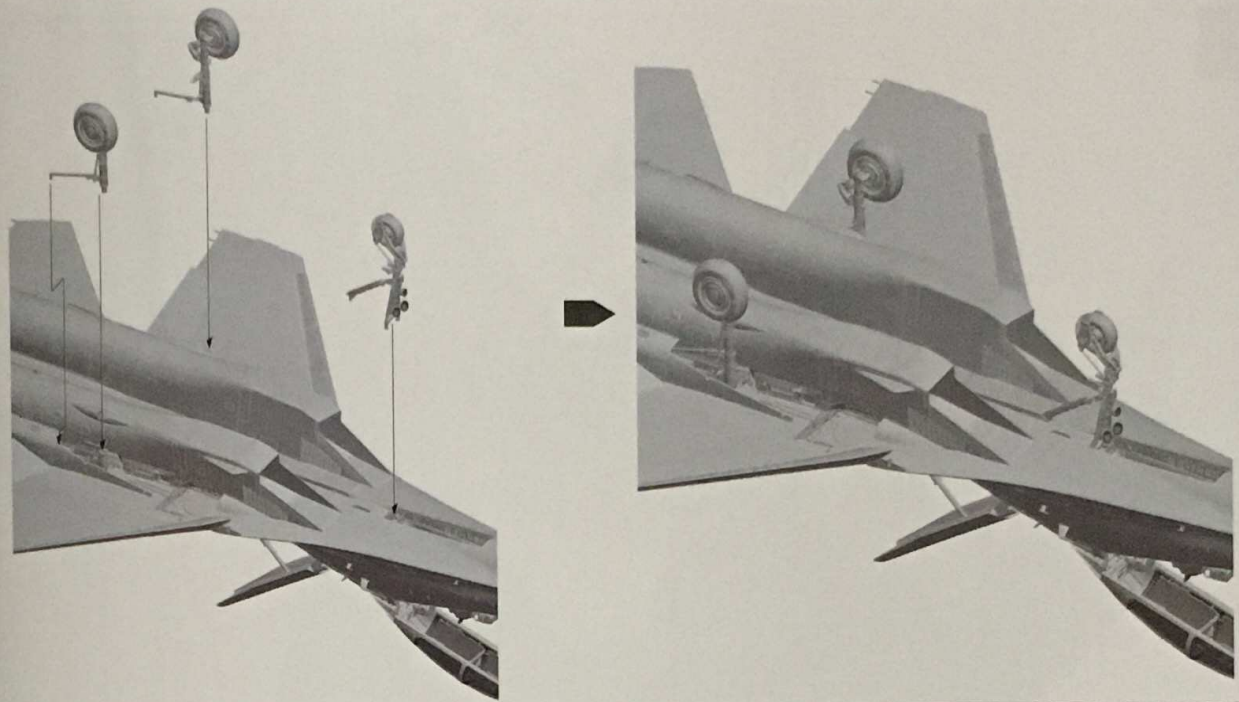

19

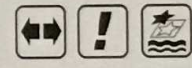
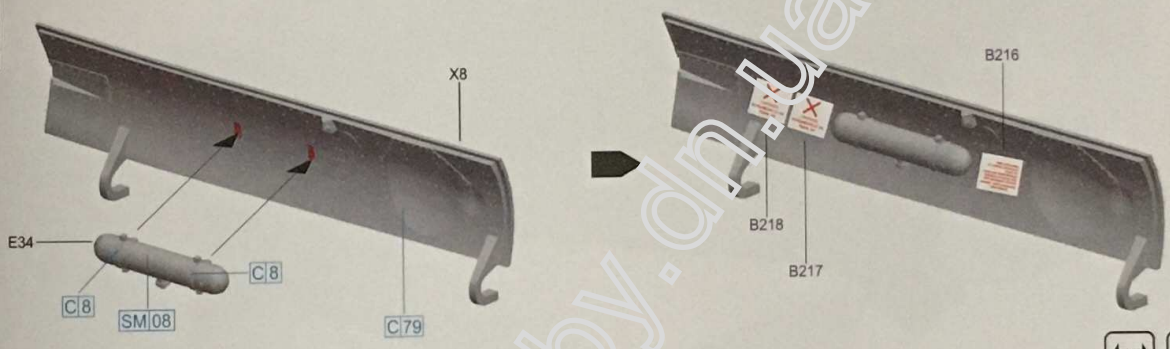

20

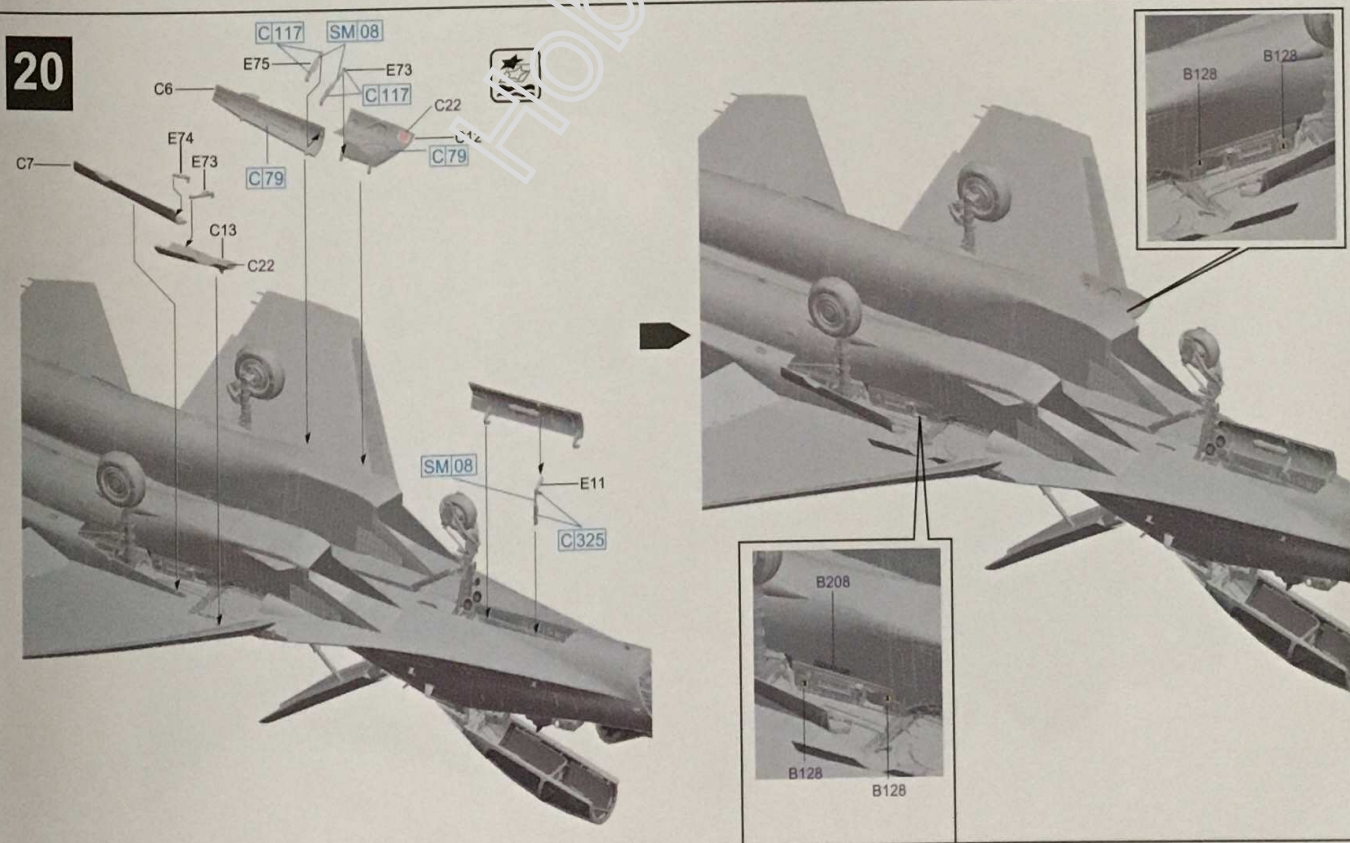

Color For All Hard Points Is Lower Fuselage Camo Color  
所有过渡梁均为机身下表面迷彩色

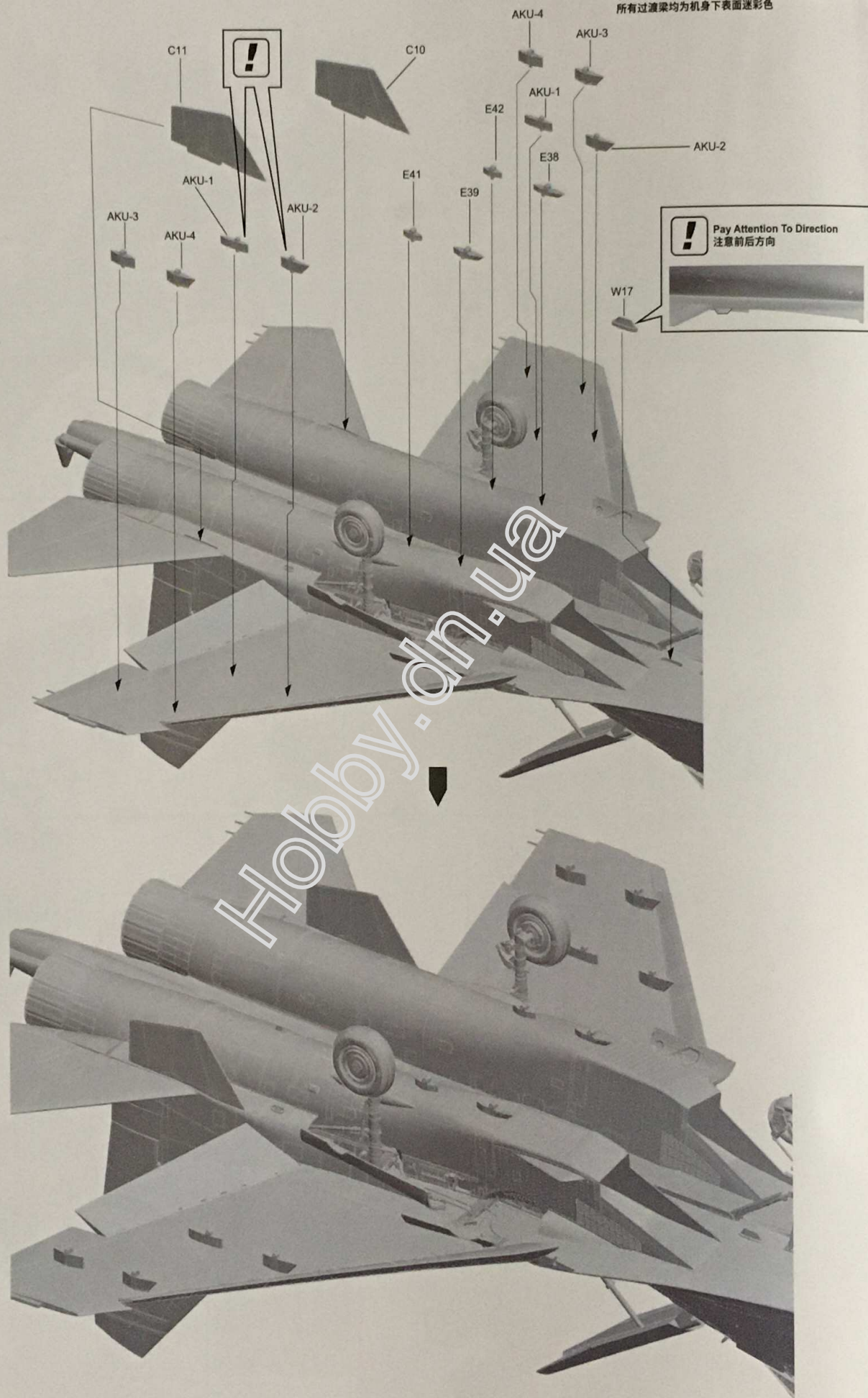

22

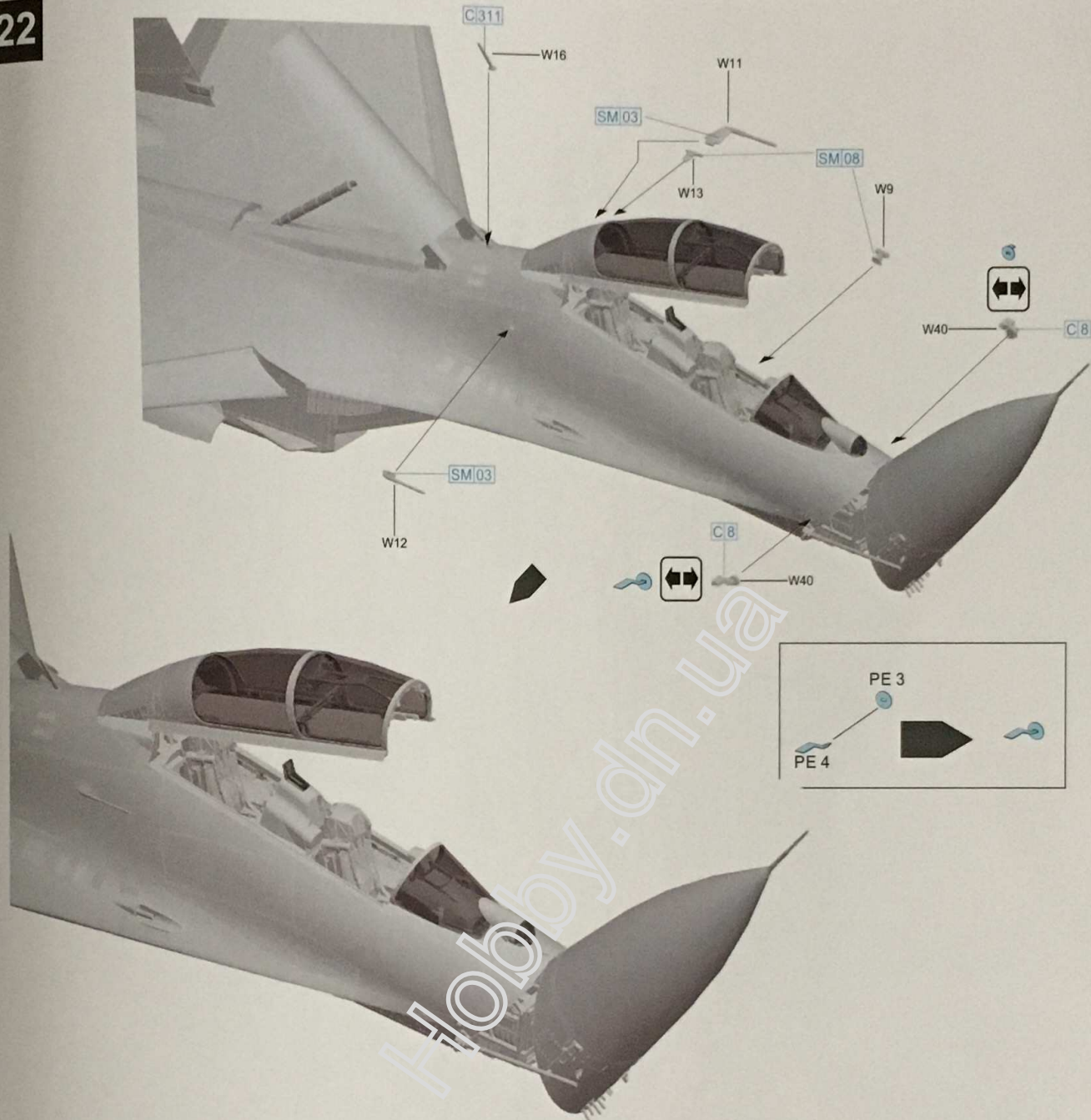

23

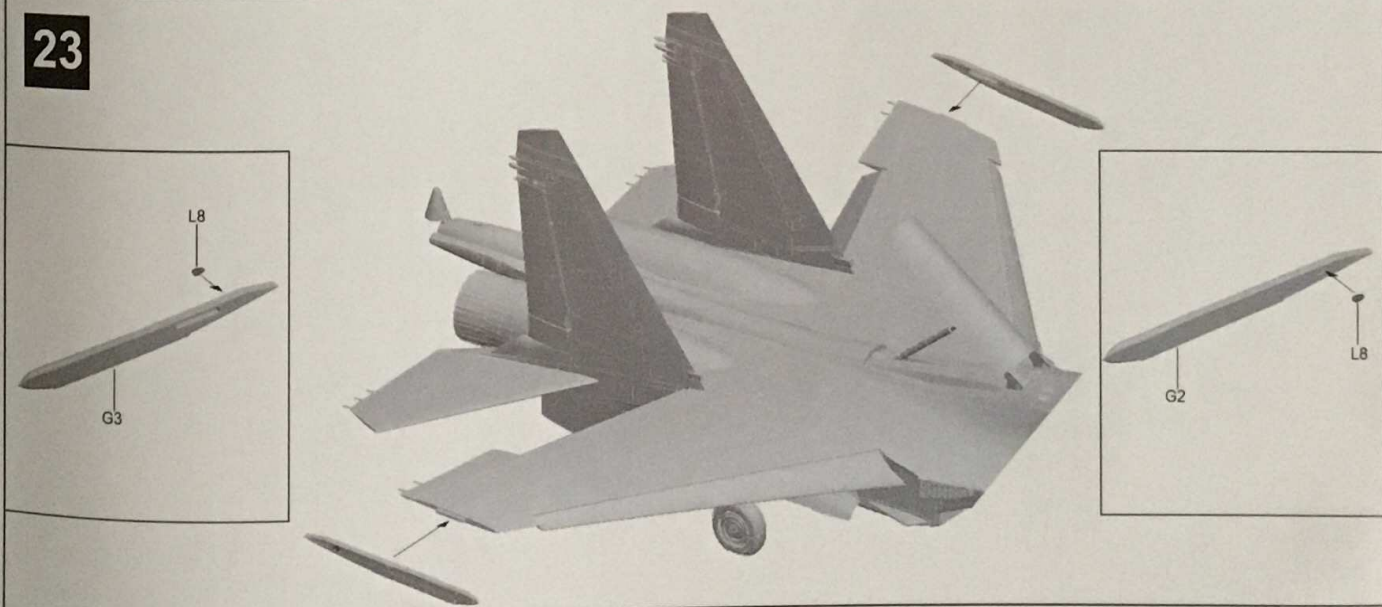

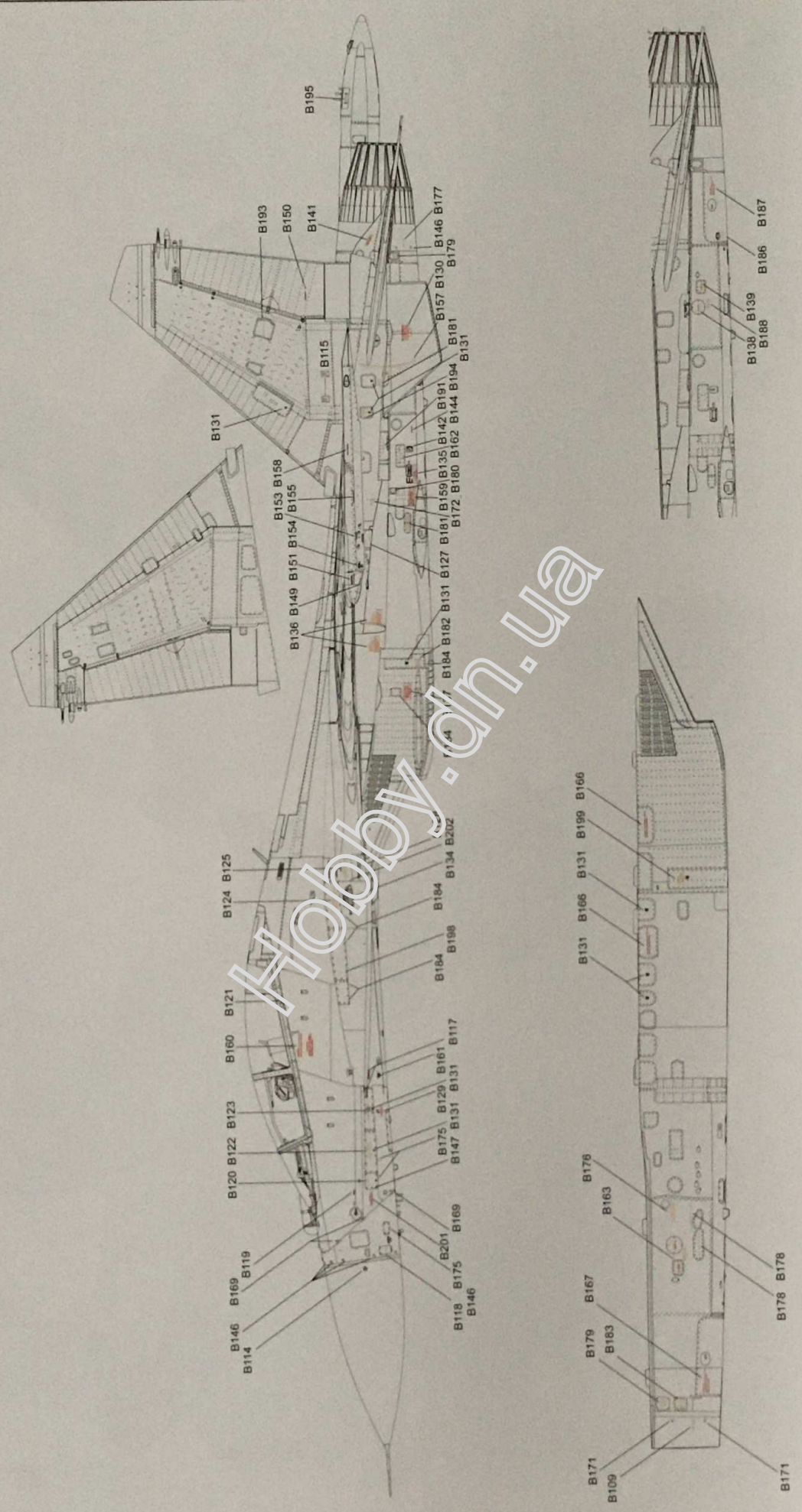

Hobby.on.ua

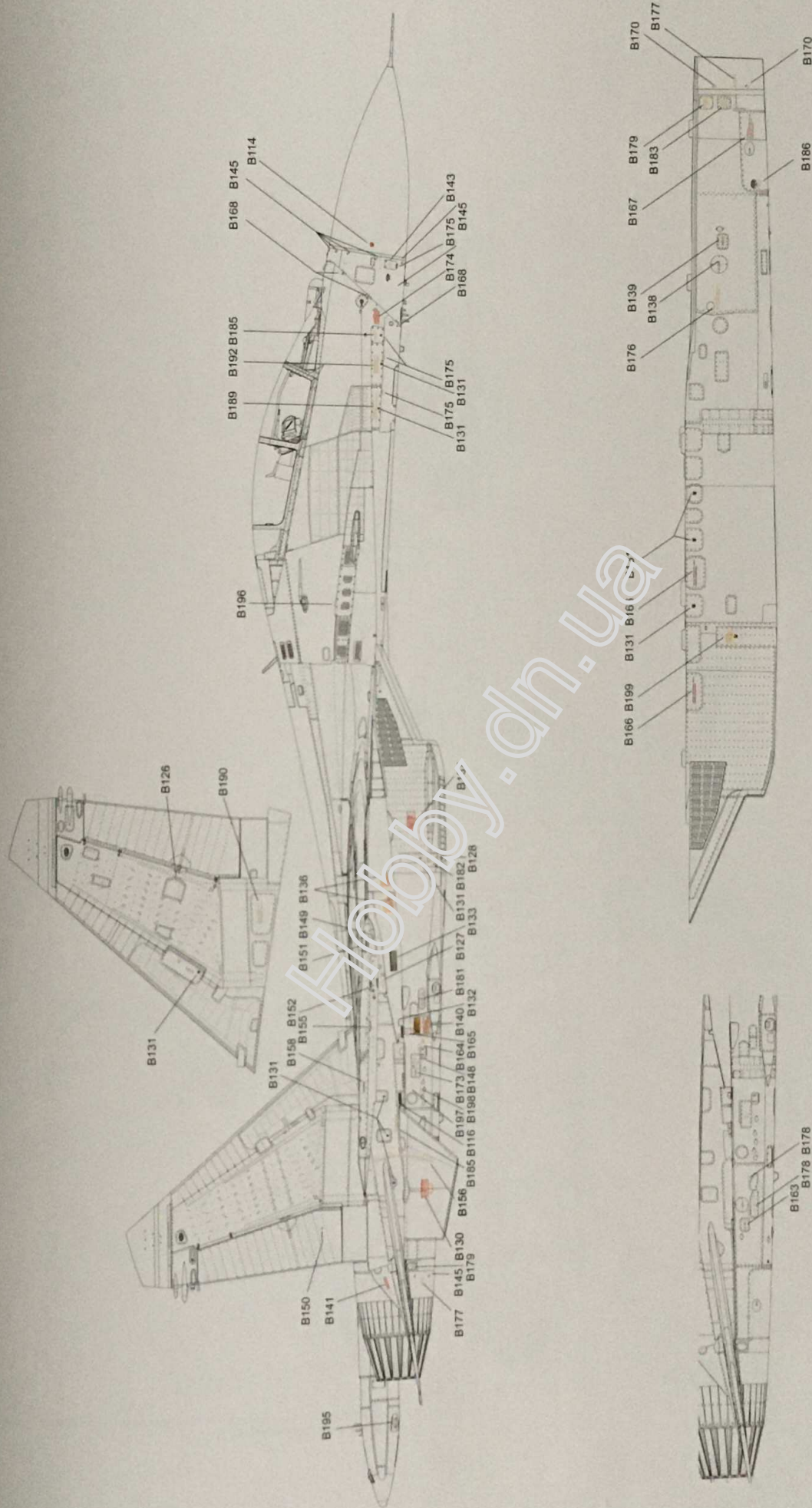



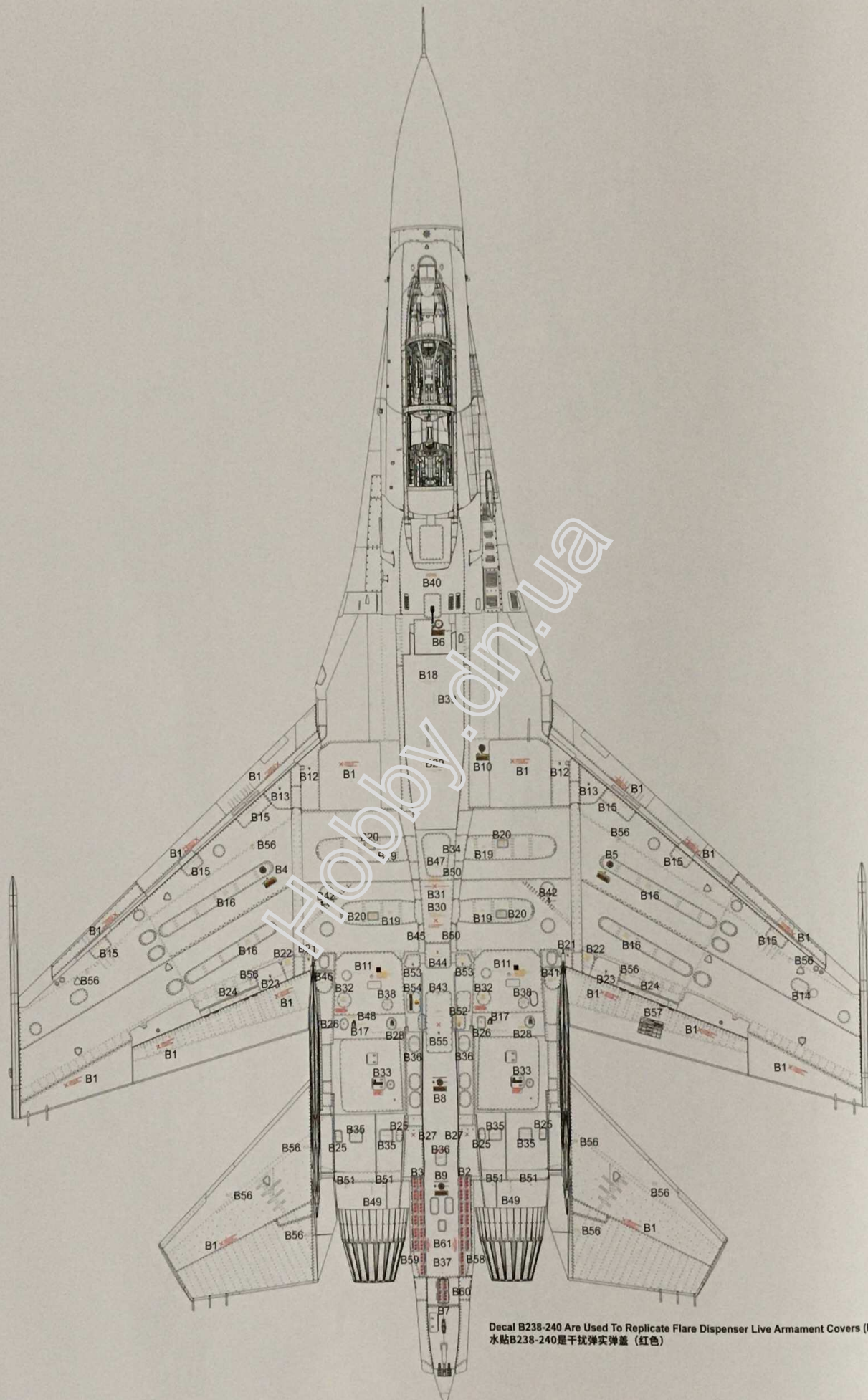

Decal B238-240 Are Used To Replicate Flare Dispenser Live Armament Covers (Red)  
 水贴B238-240是干扰弹实弹盖 (红色)



25

A-50% C323 +50% C1



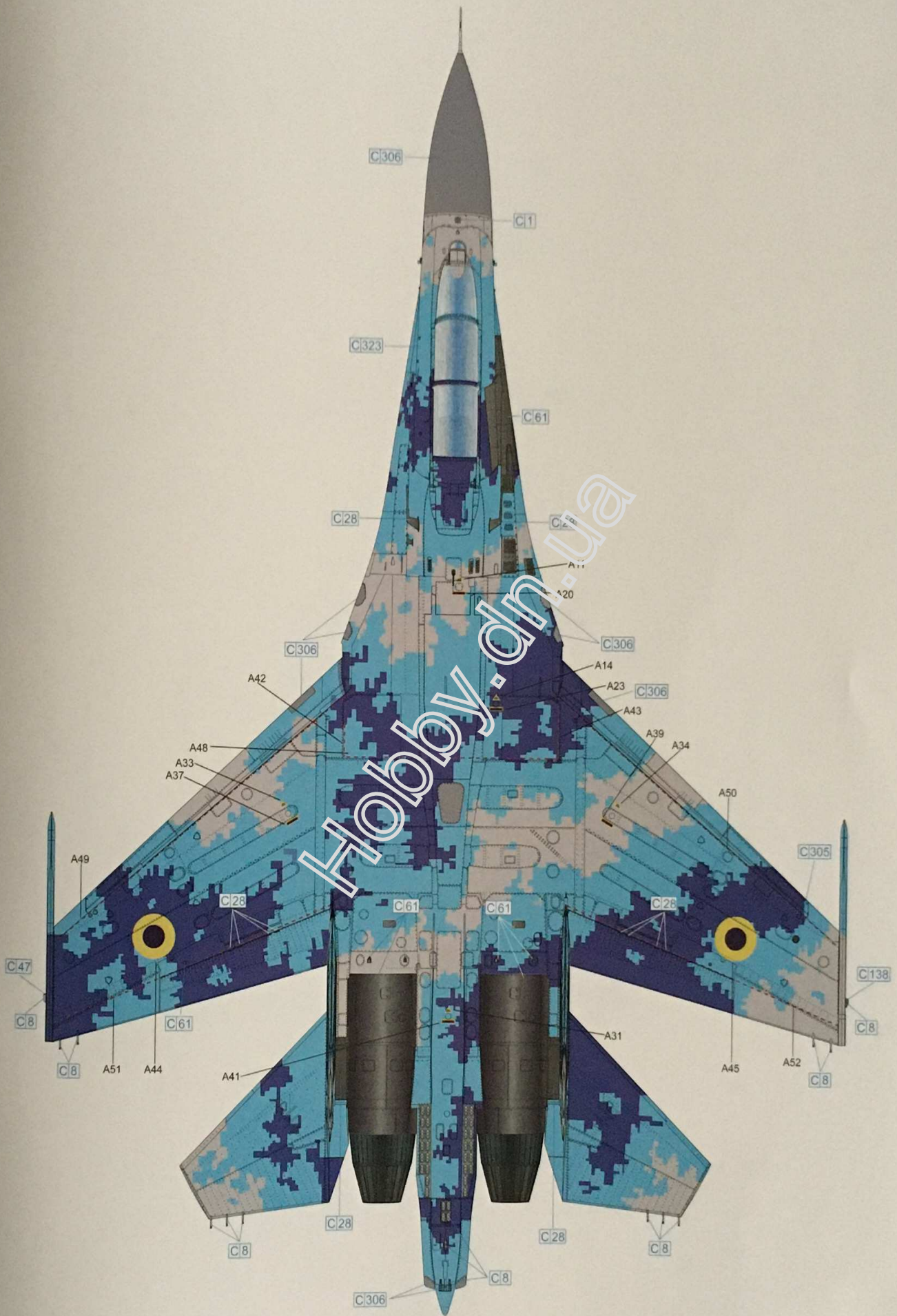



注意事項 CAUTION 組み立てのご注意

- (1) 勿于近火处使用胶水或油漆, 并打开窗户保持空气流通。
- (2) 涂料的号码请参考本栏以下的说明。本品本身不包括胶水和涂料。
- (3) 自板件中取出部件时, 应用模型专用剪, 并用介刀或小锉除去多余胶料。
- (4) 各图形的含义可参考本栏以下说明。

- (1) When you use glue or paint, do not use near a open flame, and use in a well-ventilated room.
- (2) See below for the color list. Glue and paint are not included in the kit.
- (3) When you take parts off the runner frame, use the modeling scissors and trim excess plastic with a cutter or a file.
- (4) See below for the meaning of symbols.

- (1) 接着剂や塗料は火の近くで使わないで下さい。使用の際は換気をよくして下さい。
- (2) 塗料指定のは下記のとおりです。接着剂や塗料は入っていないので別に求めて下さい。
- (3) 部品のランナーから切り離す時は模型用ハサミ等を使い、余分な部分はカッターやヤスリ等で仕上げて下さい。
- (4) 組立図のサインマークは下の説明を御覧下さい。

图形含义 CAUTION マーク

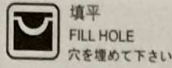

填平  
FILL HOLE  
穴を埋めて下さい

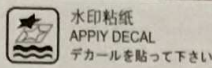

水印粘紙  
APPLY DECAL  
デカールを貼って下さい

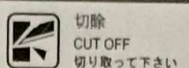

切除  
CUT OFF  
切り取って下さい



弯折  
BEND  
折り曲げて下さい

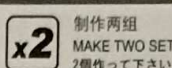

制作两组  
MAKE TWO SET  
2個作って下さい

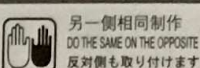

另一側相同制作  
DO THE SAME ON THE OPPOSITE  
反対側も取り付けます

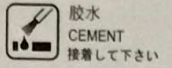

胶水  
CEMENT  
接着して下さい

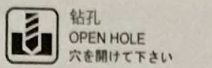

钻孔  
OPEN HOLE  
穴を開けて下さい

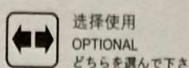

选择使用  
OPTIONAL  
どちらを選んで下さい

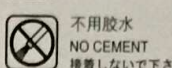

不用胶水  
NO CEMENT  
接着しないで下さい

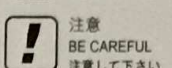

注意  
BE CAREFUL  
注意して下さい

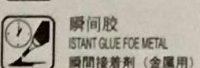

瞬间胶  
INSTANT GLUE FOR METAL  
瞬間接着剂 (金属用)

所使用工具 RECOMMENDED TOOLS 専用工具

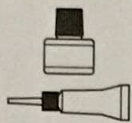

塑胶件用模型胶水  
Cement  
プラスチック用接着剂

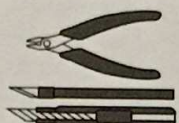

模型用剪钳  
Side cutters  
模型用ニッパー

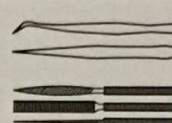

模型用镊子  
Tweezers  
ピンセット

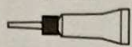

模型用瞬间胶水  
Instant Cement  
瞬間接着剂

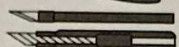

模型用刻刀  
Modeling knife  
模型用ナイフ

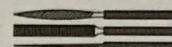

模型用锉刀  
Diamond file  
模型用ヤスリ

水贴纸使用说明 DECAL APPLICATION スライドマーカー貼り方

- (1) 用模型剪刀或刻刀切下所需的图案部分。
- (2) 将水贴纸浸泡在温水中10秒左右取出放置于戏水的干布上。
- (3) 手拿着水贴纸基的一角, 用模型镊子小心夹住浮起的水贴图案移至模型表面准确位置。
- (4) 用手指适当沾水均匀涂于水贴图案表面, 使其延展移动至精确位置。
- (5) 用柔软吸水的干布将水贴图案中的气泡向一边挤出, 使水贴在模型表面保持平整。

- (1) Cut off decal from sheet.
- (2) Dip the decal in tepid water for about 10 seconds and place on a clean cloth.
- (3) Hold the backing sheet edge and slide decal onto the model.
- (4) Move decal into position by wetting decal with finger.
- (5) Press decal down gently with a soft cloth until excess water and air bubbles are gone.

- (1) 貼りたいマークをハサミで切り抜きます。
- (2) マークをぬるま湯に10秒ほど浸してからタオル等の布の上に置きます。
- (3) 台紙のはしを手で持ち、貼るところにマークをスライドさせてモデルに移して下さい。
- (4) 指に少し水を付けてマークを濡らしてながら、正しい位置にずらしします。
- (5) 柔らかな布でマークの内側の気泡を押し出しながら、押しつけるようにして水分をとります。

蚀刻片使用说明 PHOTO-ETCHED PARTS エッチングパーツ

- (1) 使用蚀刻片专用剪刀或模型专用刻刀将蚀刻片零件切割下待用。
  - (2) 切割下的零件上有蚀刻片的残留连接点部分, 使用模型专用锉刀细心打磨干净。
  - (3) 蚀刻片部分在涂装之前必须使用专用的模型金属底漆打底。
- 注意事项: 蚀刻片很薄外延较为尖锐, 有刮伤手的可能, 在使用之时请务必小心。

- (1) Cut off photo-etched parts using a modeling knife.
  - (2) Carefully remove any excess using a file.
  - (3) Apply metal primer prior to painting.
- Attention, please. Extra care should be taken to avoid potential injury when handling photo-etched parts.

- (1) 切り離す時はカッターナイフを使用してパーツを切り離します。
  - (2) 切り出した時、部品に出っ張った部品が残っている場合は、ヤスリなどで丁寧に削り落とします。
  - (3) 塗装が必要なパーツは下地にメタルプライマーを吹き付けてから塗装します。
- ご注意: エッチングパーツは大変薄く、手などを切り恐れがあります。取扱いは十分注意して下さい。

涂装 PAINT REQUIRED カラー番号リスト

■ [C]000 GSI CREOS Mr.COLOR ■ [00-000] ACRYLICS VALLEJO

[C1] 亮光白 Light white	[C43] 木棕色 Wood brown
[C3] 亮光红 Light red	[C45] 帆布色 Sail color
[C4] 亮光黄 Light yellow	[C47] 透明红 Clear red
[C8] 亮光银 Light silver	[C60] RLM02灰色 RLM02 grey
[C9] 亮光金 Light gold	[C61] 烧铁色 Burnt iron
[C25] 暗海灰 Dark grey sea	[C66] 亮绿色 Bright green
[C28] 黑铁色 Steel	[C72] 雾蓝色 Intermediate blue
[C33] 哑光黑 Matt black	[C79] 亮红色 Shine Red
[C92] 半光泽黑 Semi-gloss black	[C308] FS36375浅灰色 FS36375 light grey
[C117] RLM76浅蓝 RLM76 pale blue	[C311] FS36622灰色 FS36622 gray
[C135] 俄国绿(1) Russian Green(1)	[C313] FS33531沙黄色 FS33531 yellow
[C136] 俄国绿(2) Russian Green(2)	[C319] 浅松绿色 Light green
[C137] 消光轮胎黑色 Dull tire black	[C323] 亮光浅蓝色 Light blue
[C138] 透明绿 Transparent green	[C324] 半光浅灰色 Light grey
[C301] FS36081深灰色 FS36081 dark grey	[C325] FS26440灰色 FS26440 gray
[C306] FS36270灰色 FS36270 gray	[C338] FS36495浅灰色 FS36495 light grey
	[SM03] 超级熟铁色 Super wrought iron
	[SM05] 超级钛金属色 Titanium color
	[SM08] 特效电镀银色 Special plating silver