



**Plastic model
scale 1/72**

LET L-200 A/D MORAVA

History in brief

The Let L-200 Morava is a two-engine touring and light passenger aircraft of the 1960s, designed and produced in Let Kunovice in Czechoslovakia.

Three prototypes were built. The first, designated XL-200 (OK-LNA) made its maiden flight on 9 April 1957. It was followed in flight testing by the second prototype (OK-LNB) while the third was used for static testing. The aircraft sported clean, elegant lines. During the same year the factory built a run of 10 pre-production L-200s, one of these aircraft undergoing government flight testing in 1958. The program was successful, and the airplane was ordered into full-scale production. One L-200 was converted into a prototype of the M-337-powered production model L-200A. This aircraft incorporated minor changes, consisting mostly of new two-blade V-410 propellers, a cockpit lowered by 43mm, a modified tailfin design as well as longer engine nacelles. It was completed in 1959 and shown at the Paris Air Show in July of that year. The aircraft underwent government trials in the fall of 1959, having been fitted with M-337 engines. The trials once again proved successful and were completed the following July. The first production L-200A took to the skies in February 1960.

L-200B and C models were not produced. The second production variant was the L-200D, modified according to Soviet Aeroflot demands. It was fitted with new three-blade propellers V-506 of a smaller diameter and some minor improvements, such as dust filters. It also received more comprehensive navigation equipment. The prototype (OK-NIA) was converted from the L-200A prototype in 1960 and tested in 1961-1963.

In all, 367 L-200s were built by 1964, including 3 prototypes and 197 L-200D (eight L-200A and the L-200A prototype were converted to L-200D as well). 5 aircraft were manufactured from parts by Libis in Yugoslavia.

Plastic parts

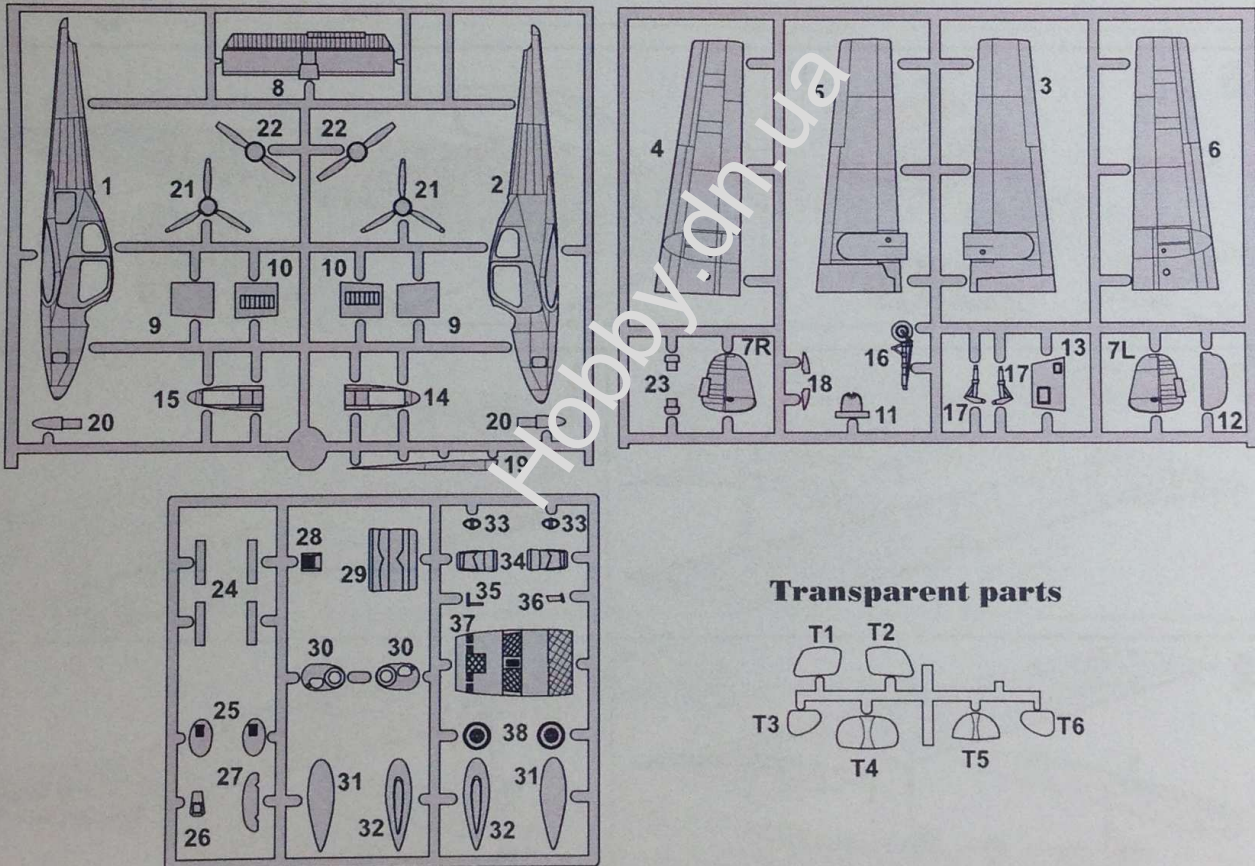

Transparent parts

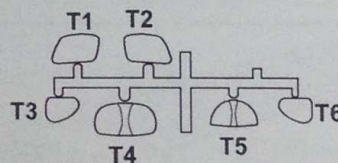

Symbols/Symboly

Drill hole Vyvrátat	Cyanoacrylate Vteřinové lepidlo	Remove Odstranit	Reduce Zbrousit
Make new Vyrobít	Option Volba	Bend Ohnout	Putty Tmel

	Colour name	Humbrol		Colour name	Humbrol
A	Black	H33	F	Aluminium	H56
B	White	H34	G	Dark Brown	H186
C	Dark Grey	H27	H	Red	H132
D	Light Grey	H64	I	Tyre	H85
E	Silver	H11	J	Rust	H113

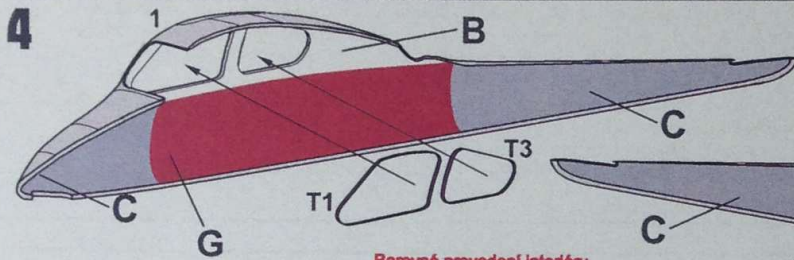
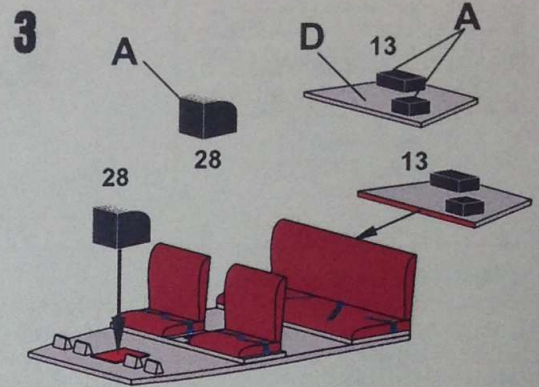
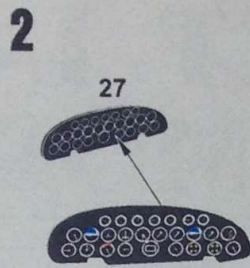
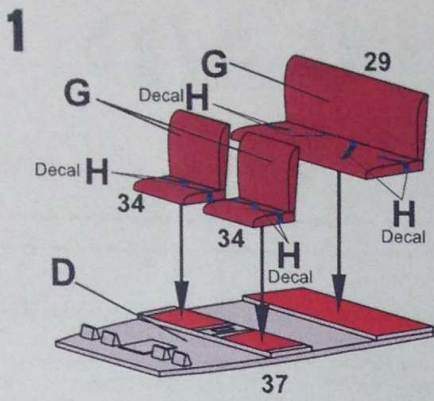

Barevné provedení interiéru se liší dle přání zákazníka
Interior colours differed according to customer wish

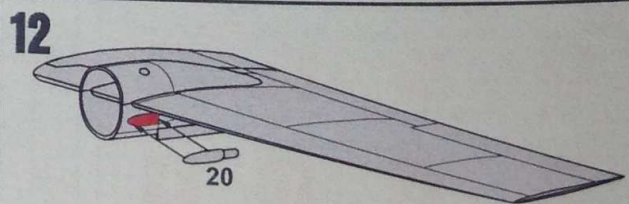
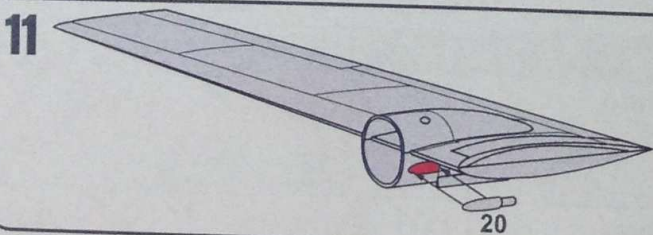
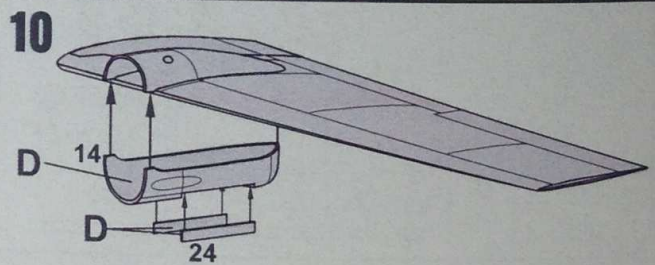
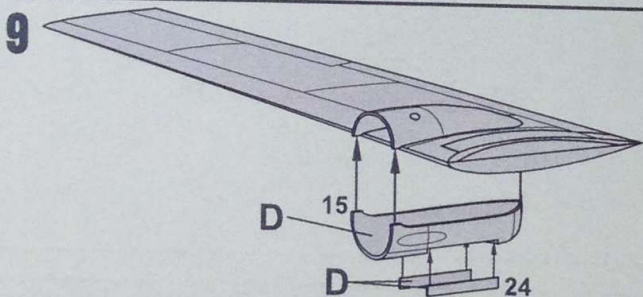
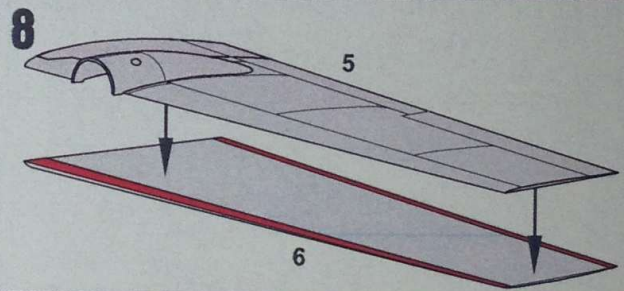
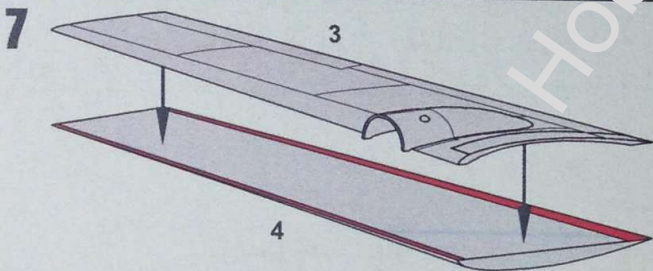
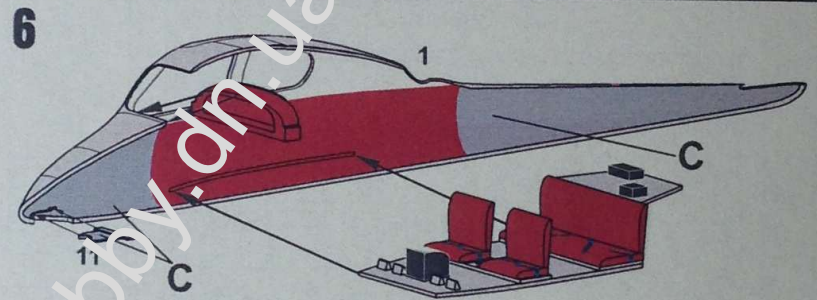
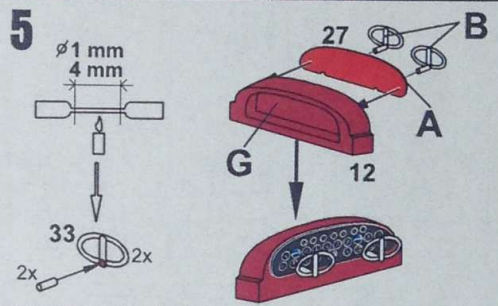
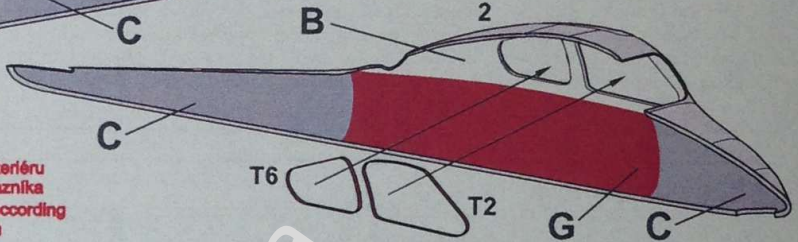

13

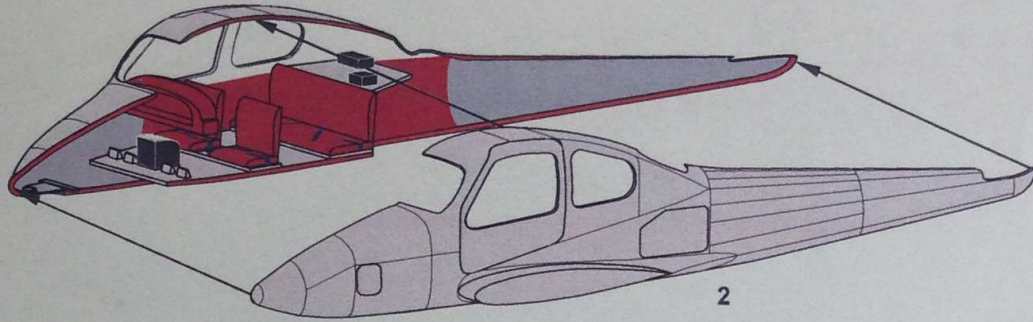

14

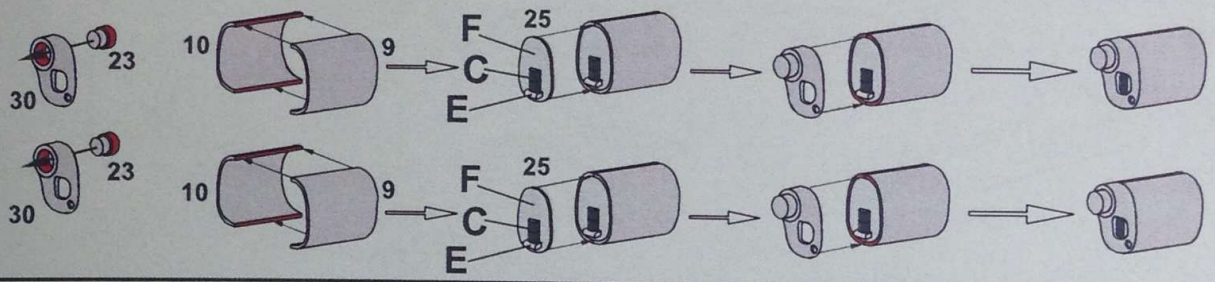

15

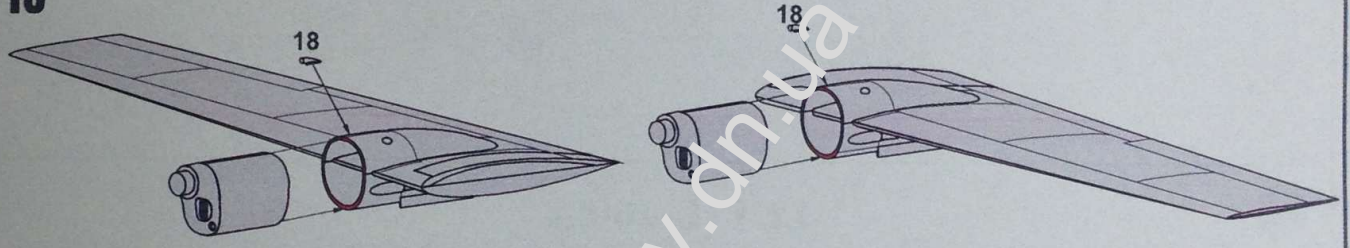

16

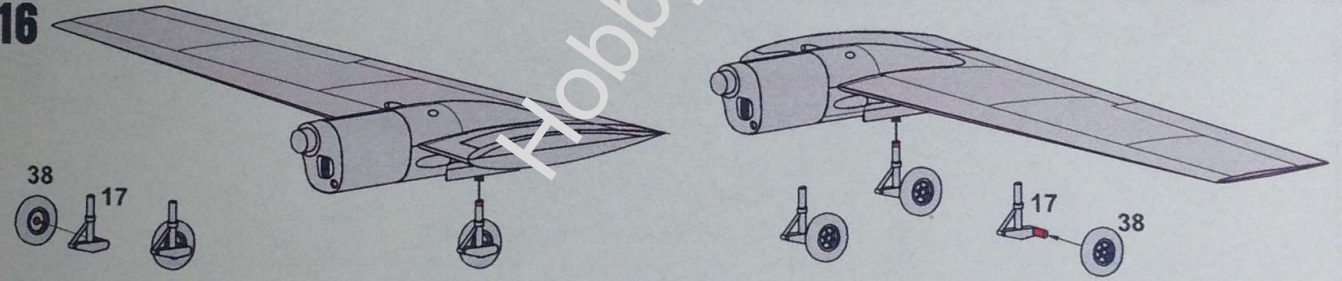

17

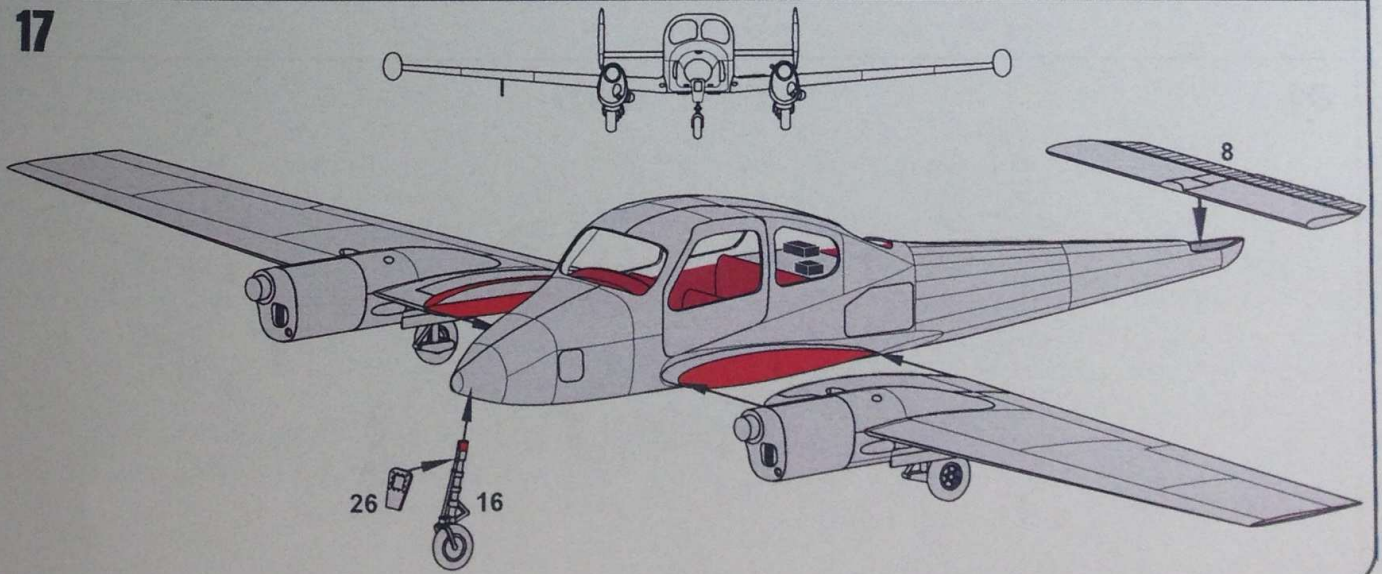

18

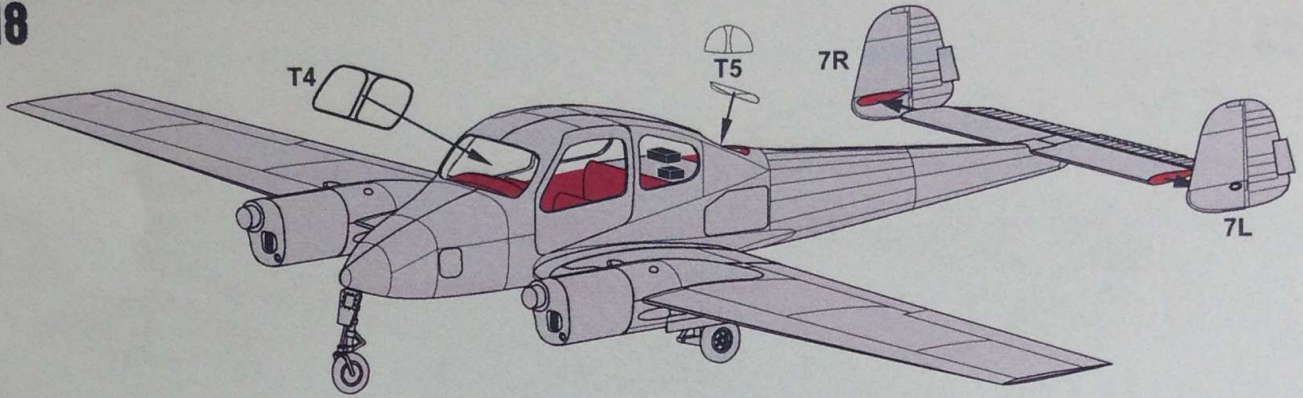

19

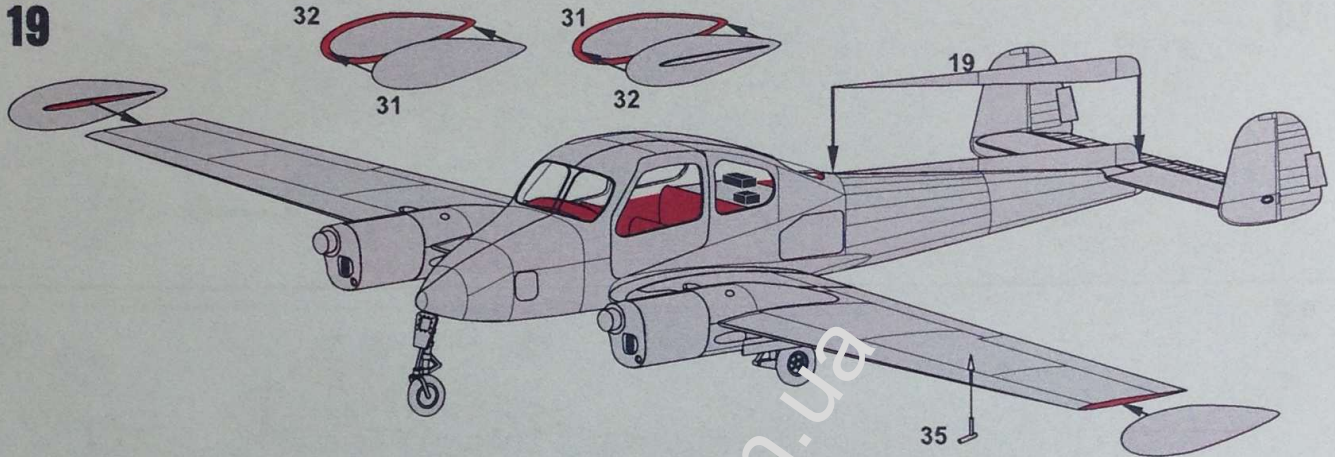

20

LET L-200 A

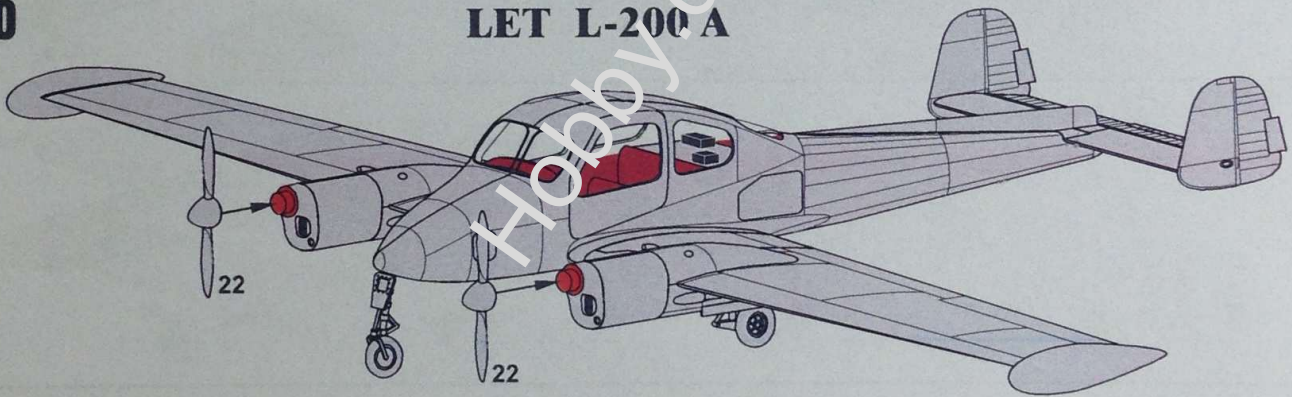

21

LET L-200 D

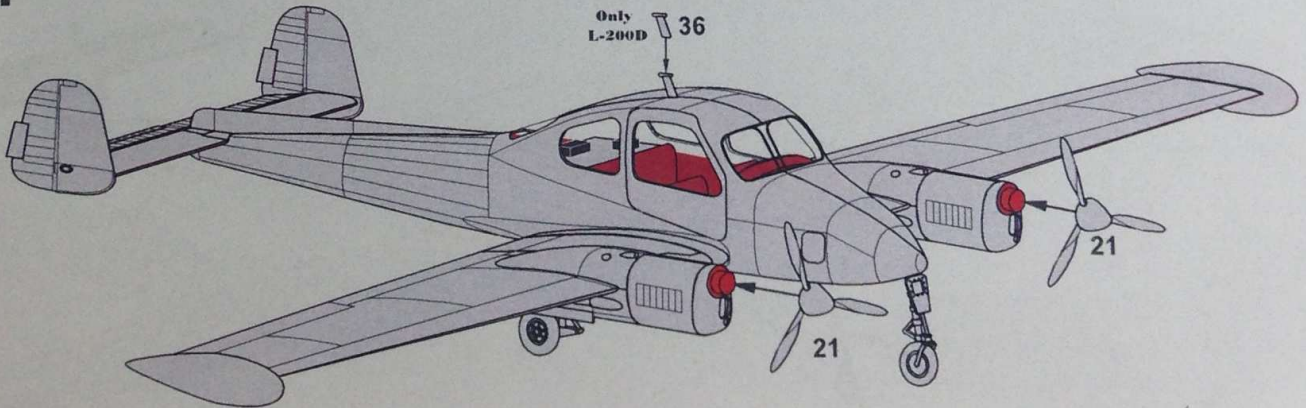

Zbarvení & Označení Colours & Markings

1 L-200D Morava, OK-RFS, letiště Kunovice, Československo, 1977.
L-200D Morava, OK-RFS, Kunovice airfield, Czechoslovakia, 1977.

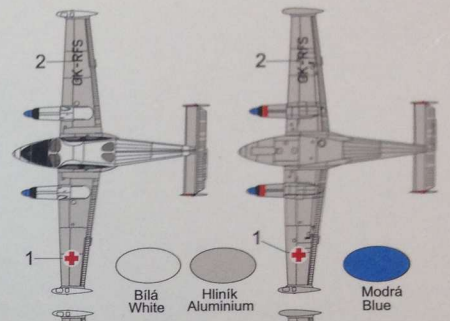
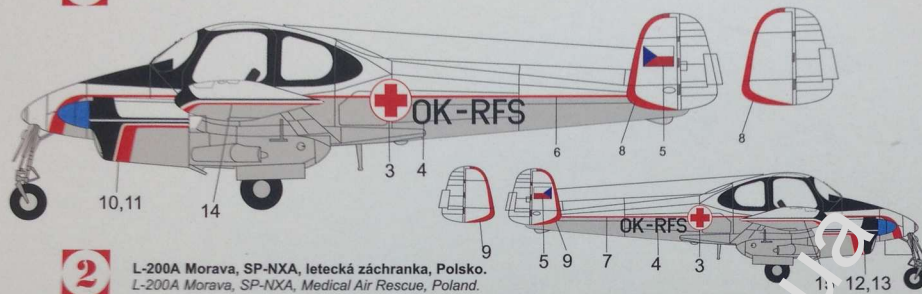

2 L-200A Morava, SP-NXA, letecká záchranka, Polsko.
L-200A Morava, SP-NXA, Medical Air Rescue, Poland.

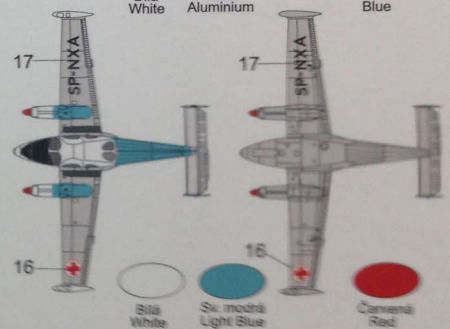
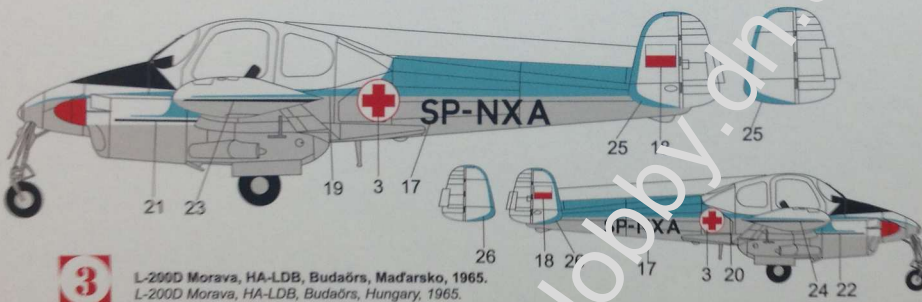

3 L-200D Morava, HA-LDB, Budaórs, Maďarsko, 1965.
L-200D Morava, HA-LDB, Budaórs, Hungary, 1965.

