

# U.S. ARMY BULLDOZER

35195

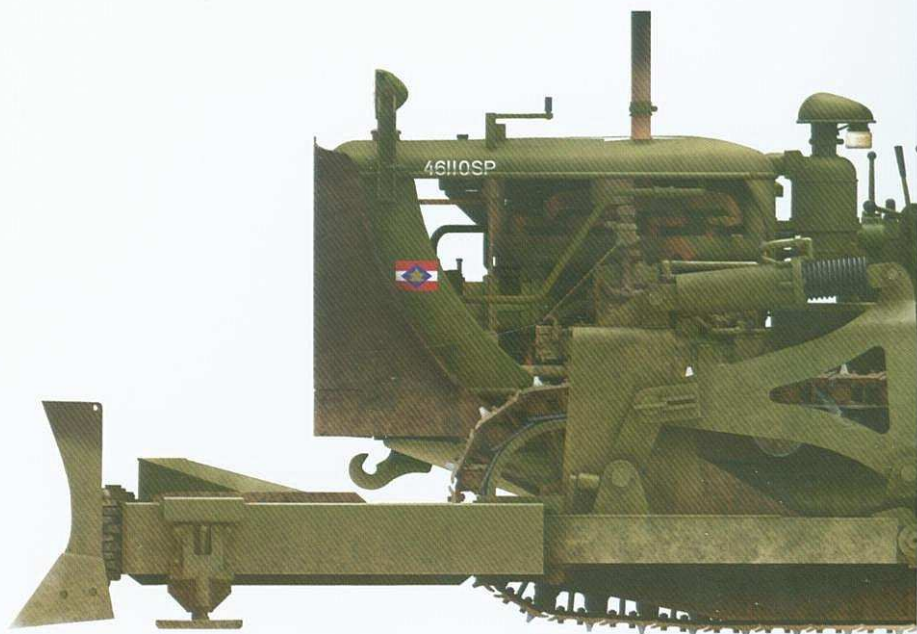
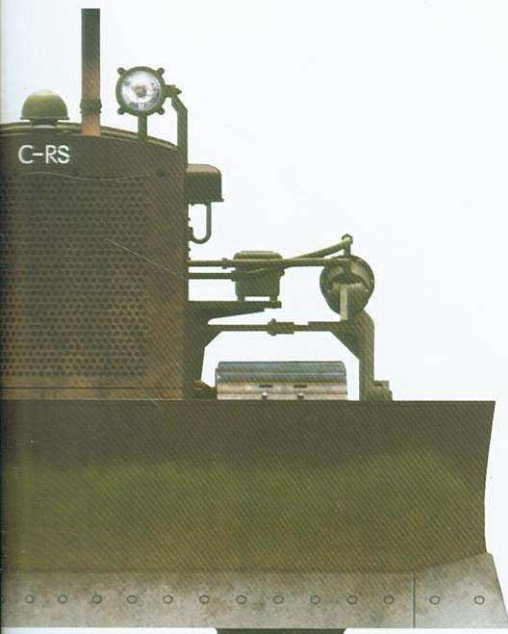

## GENERAL INSTRUCTION

- HIGHLY DETAILED MODEL
- TOTAL DETAILS 726
- 716 PLASTIC PARTS
- 8 PHOTOETCHED PARTS
- 2 CLEAR PLASTIC PARTS
- DECALS SHEET FOR 3 OPTIONS
- FULL-COLOUR INSTRUCTION
- WORKABLE TRACK LINK
- FULLY DETAILED ENGINE COMPARTMENT AND CHASSIS
- UP-TO-DATE TECHNOLOGY USING SLIDING MOULDS

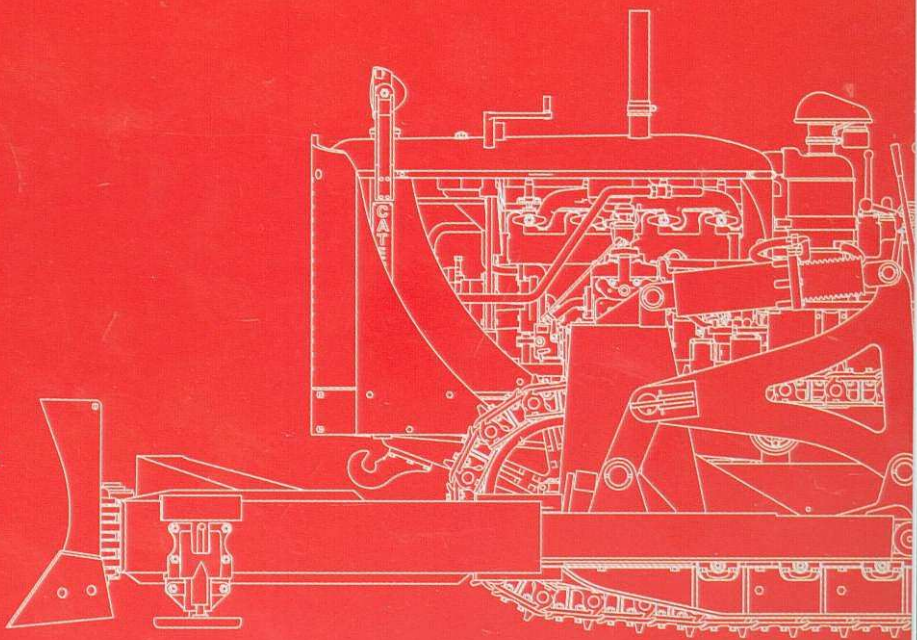

x2

MAKE 2PCS  
2 TEILE FERTIGEN  
EFFECTUER 2 PIECES  
FARE DUE PEZZI  
TEE 2 KPLA  
GOR 2 ST  
ПОВТОРИТЬ ДВА РАЗА  
КЛЫКСТЬ РАЗВ



DO NOT CEMENT  
NICHT KLEBEN  
NE PAS COLLER  
NON INCOLLARE  
EILIMAA  
LIMMAEJ  
НЕ ИСПОЛЬЗОВАТЬ КЛЕЙ  
НЕ КЛЕИТИ



OPTIONAL  
NACH BELIEBEN  
FACULTATIF  
FACOLTATIVO  
VALINNANVARAINEN  
VALBAR  
ВАРИАНТЫ  
ВАРИАНТИ



OPEN HOLE  
OFFNEN  
FAIRE UN TROU  
FORO APERTO  
AVAA REIKÄ  
ÖPPNÄ HALET  
СДЕЛАТЬ ОТВЕРСТИЕ  
ЗРОБИТИ ОТВІР



REMOVE  
ENTFERNEN  
RETRIEREN  
SEPARARE  
POISTA  
AVLAGSNA  
ОТРЕЗАТЬ  
ВІДРІЗАТИ



BEND  
BITTE BIEGEN  
PLIER S'IL VOUS PLAÎT  
PIEGARE  
TAITA  
BOCKA  
ВЫГНУТЬ  
ВИГНУТИ



SCRATCHBUILD  
AM MEISTEN ZU MACHEN  
FAIRE LE PLUS  
RENDITI  
TEE ITSE  
GOR DIG SJÄLV  
СДЕЛАТЬ САМОМУ  
ЗРОБИТИ САМОМУ



PARTS NOT FOR USE  
TEILE WERDEN NICHT VERWENDET  
N'EST PAS UTILISÉ  
PARTI NON PER L'USO  
OSIA EI KÄYTÄ  
INTE FOR ANVÄNDNING  
НЕ ИСПОЛЬЗУЕТСЯ  
НЕ ВИКОРИСТОВУЄТЬСЯ

A

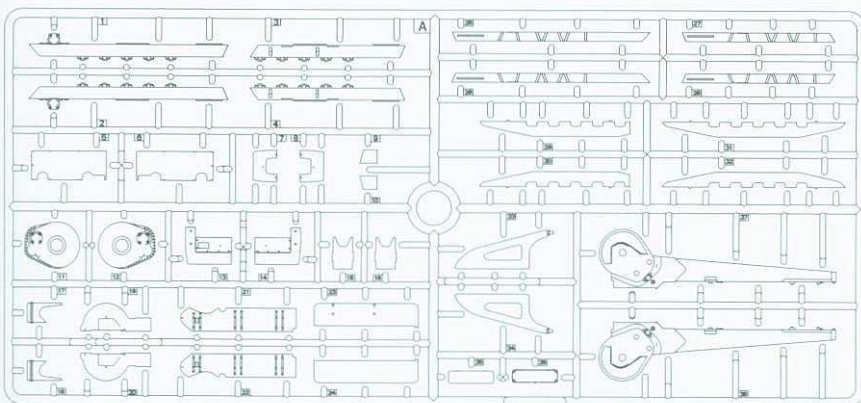

B

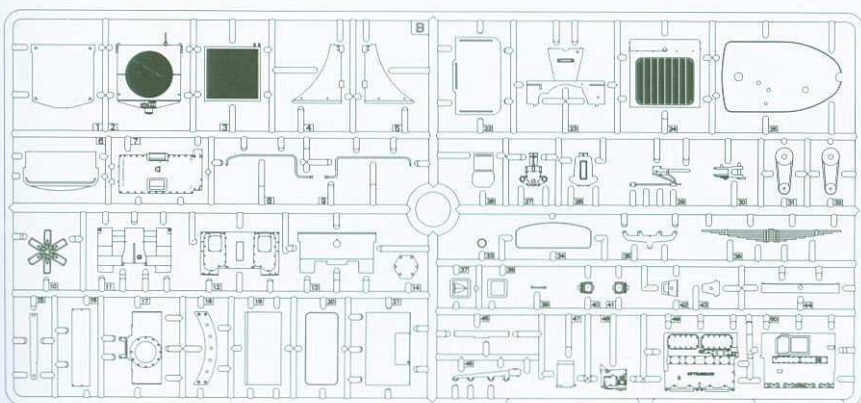

C

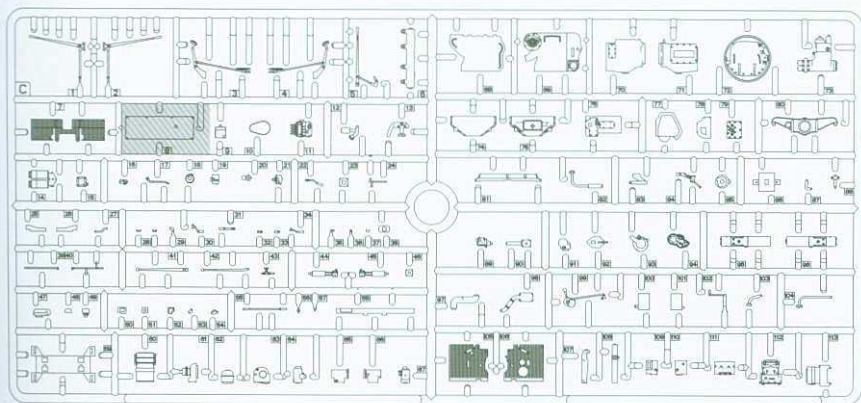

F

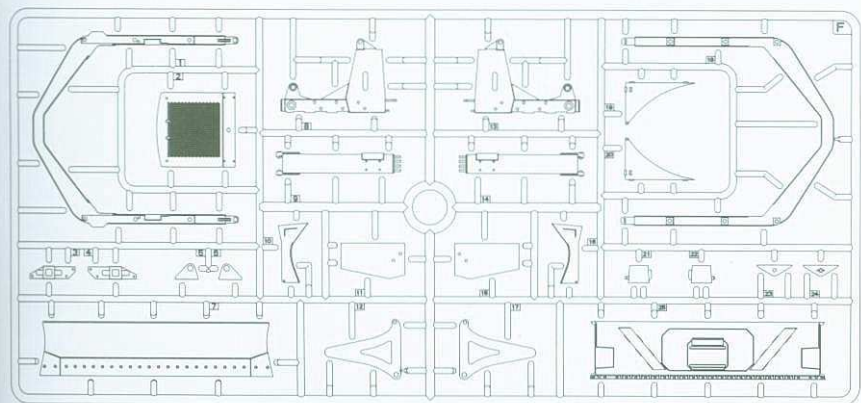

H

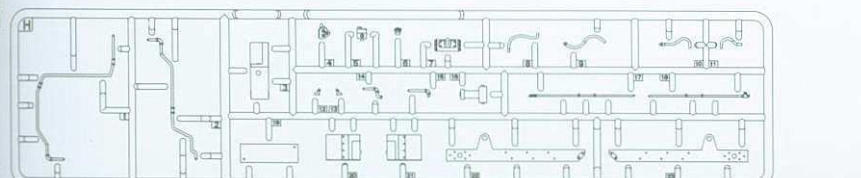

D x4

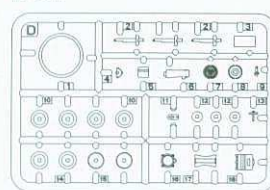

Da x2

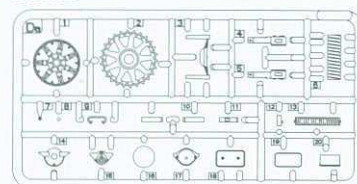

Db x2

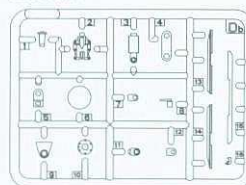

Dc x8

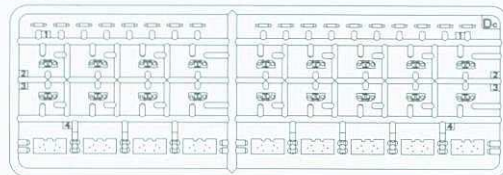

Ha



Hb

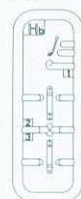

Hd

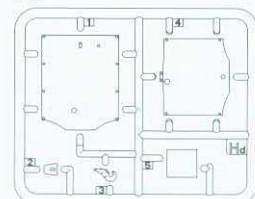

Hf

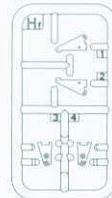

PE (Photo-etched parts)  
Детали фототравления



Decal/Деколь



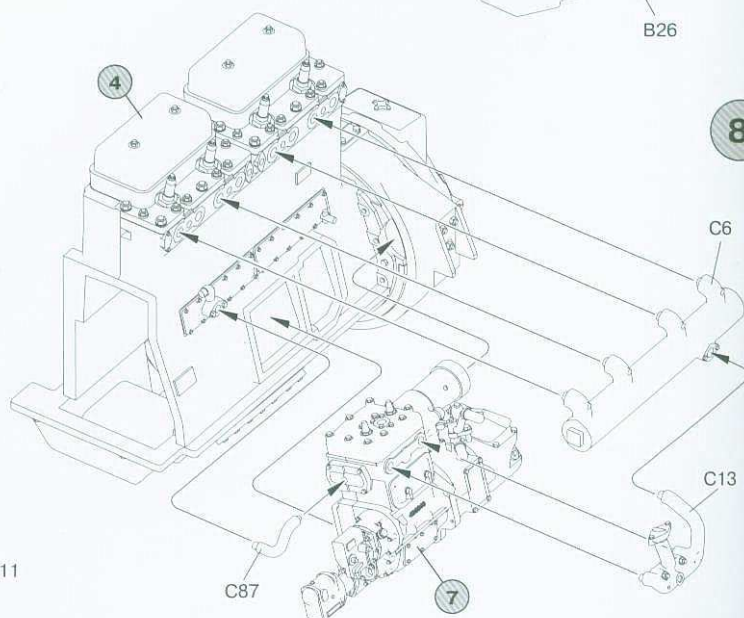
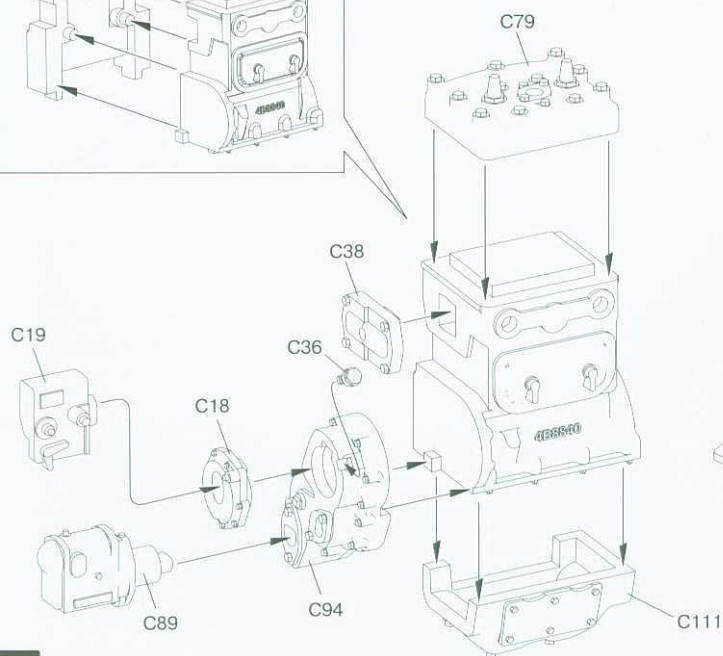
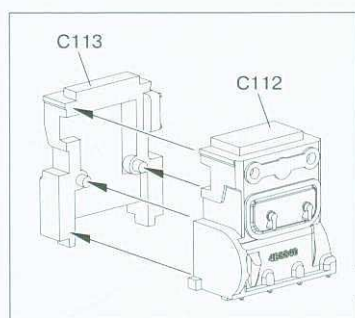
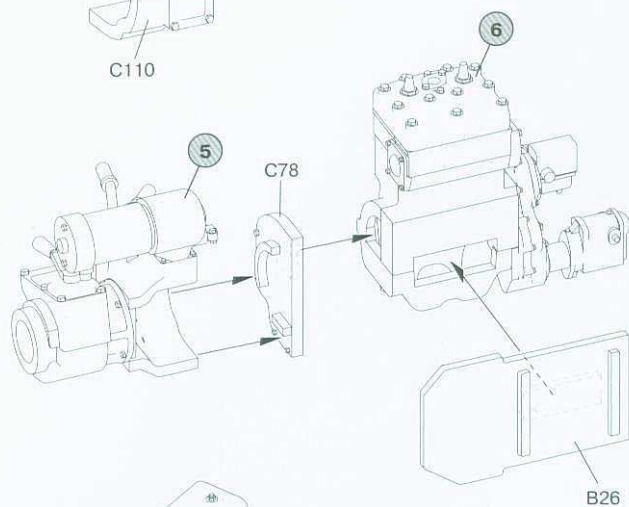
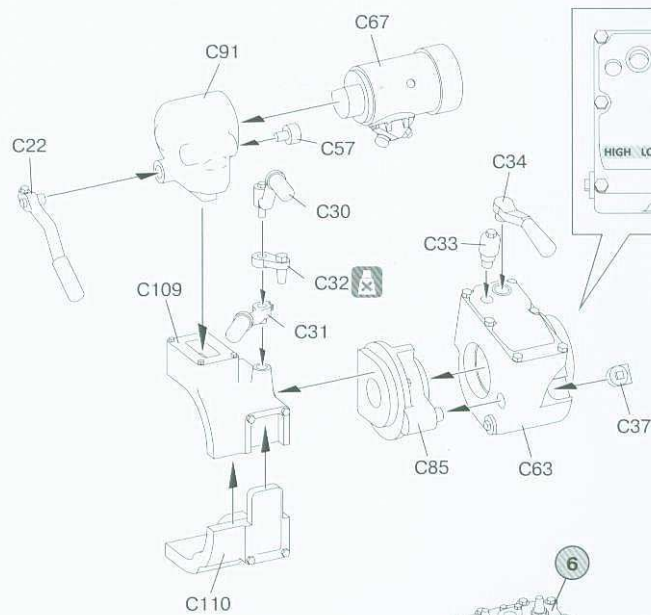
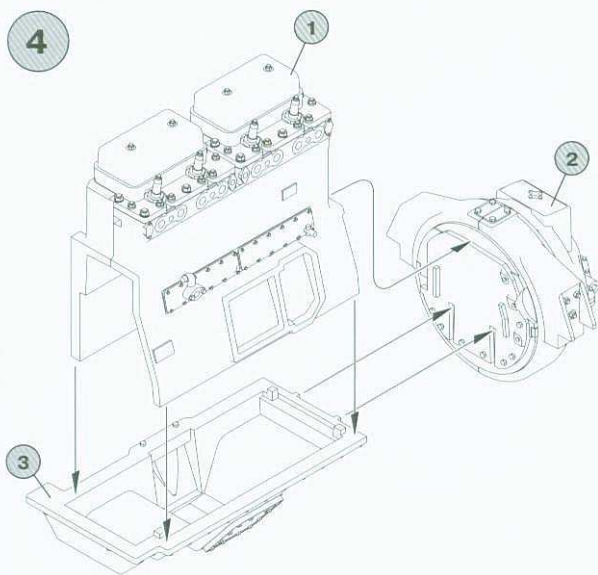
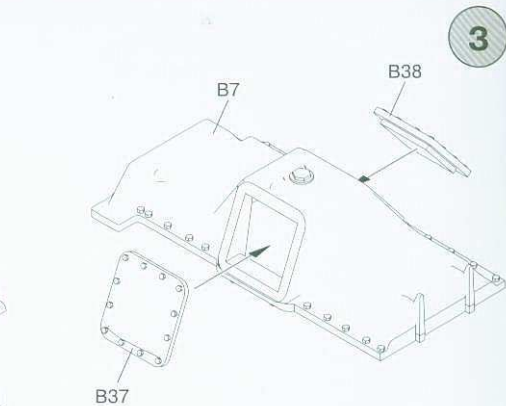
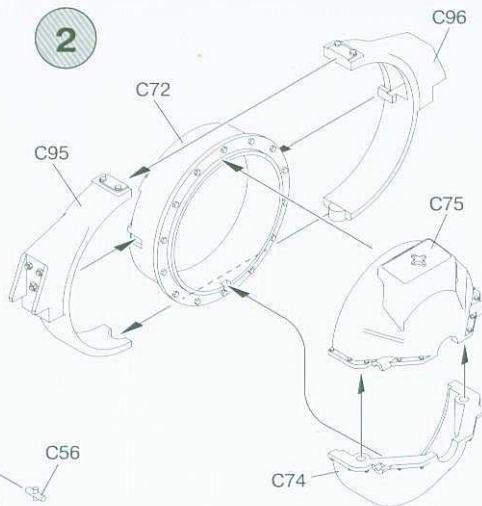
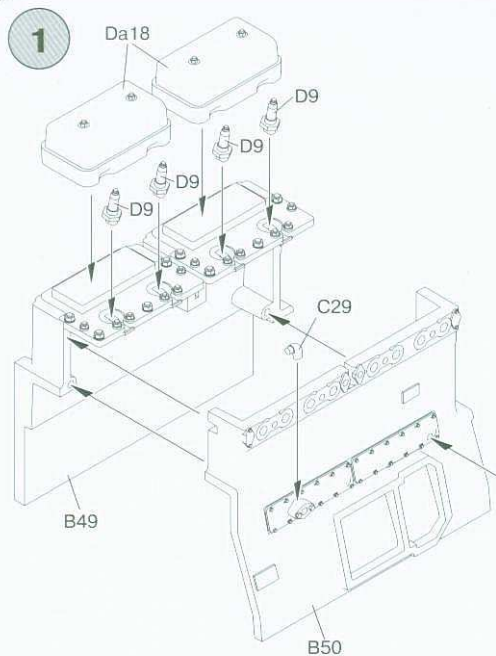

9

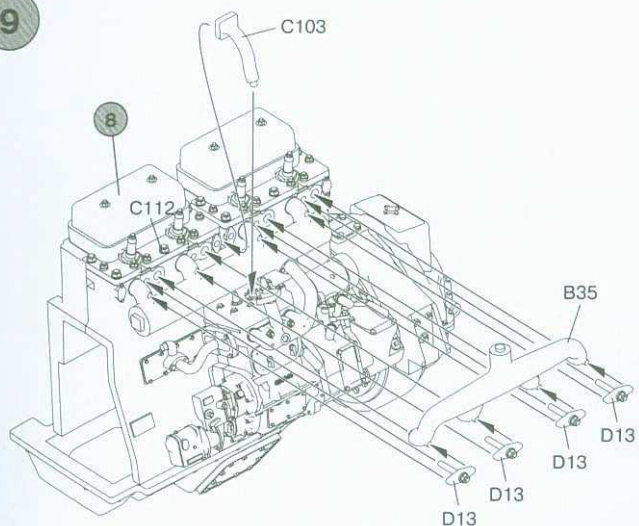

10

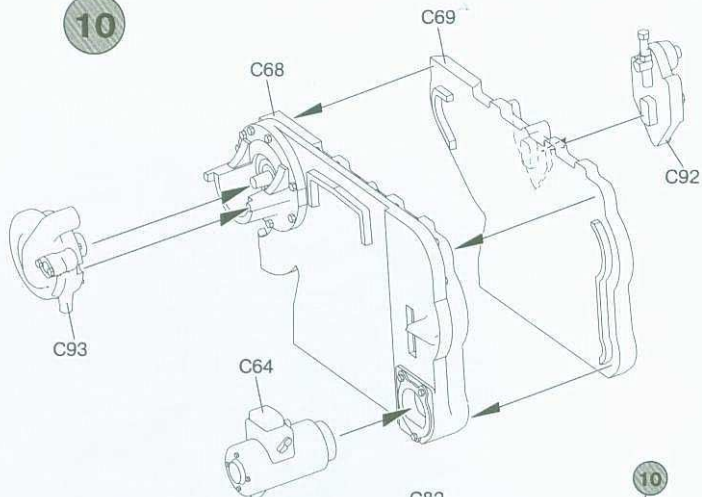

11

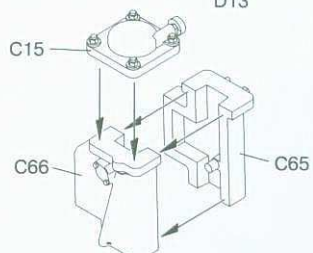

12

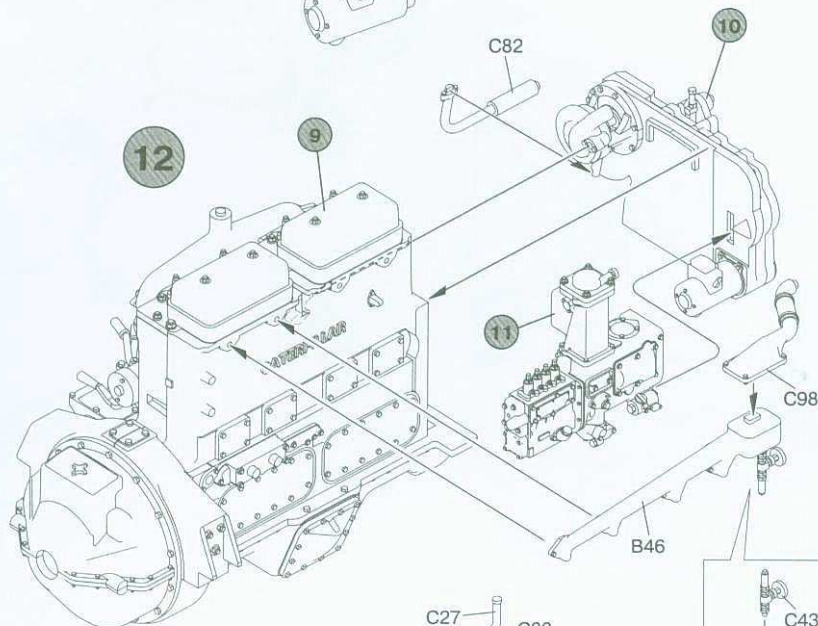

13

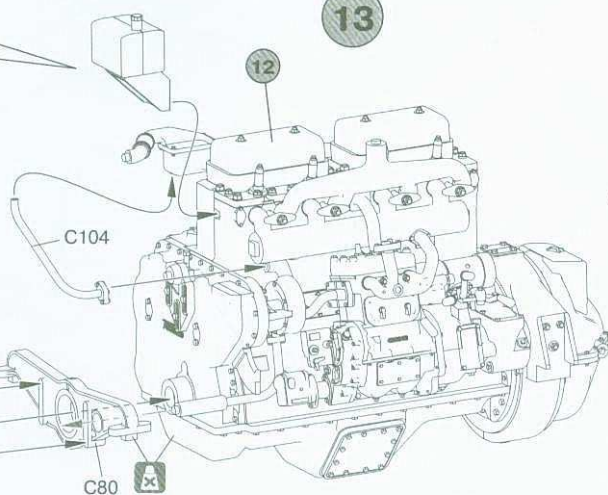

14

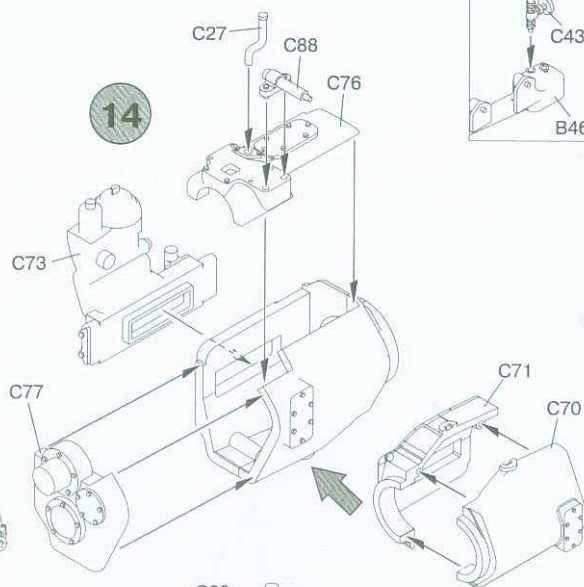

16

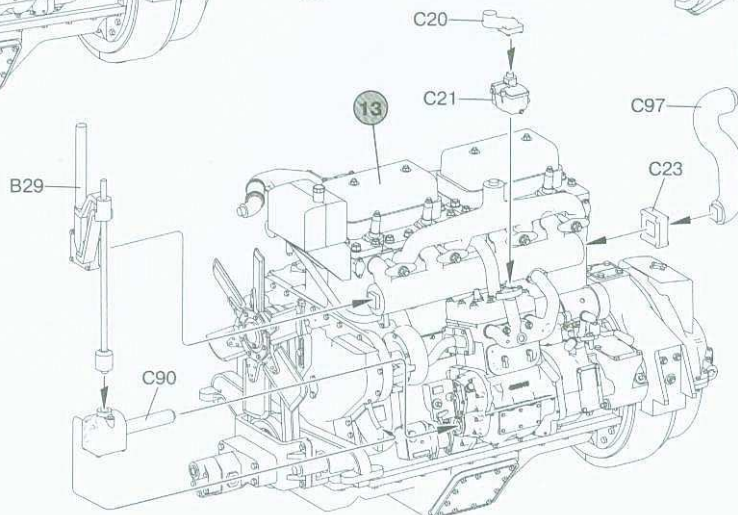

15

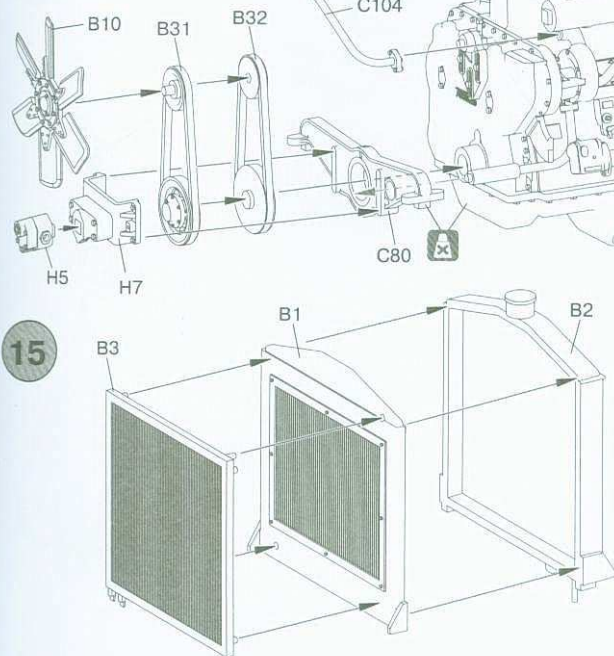

17

C84

14

desal  
деколь

16

15

18

17

C14

B9

B39

B8

C17

C84

14

PEa2

20

C40

C39

19

B27

B28

B12

B17

B13

B45

B41

B40

B11

A38

A38

A37

A37

19

Da7

21

14

20

22

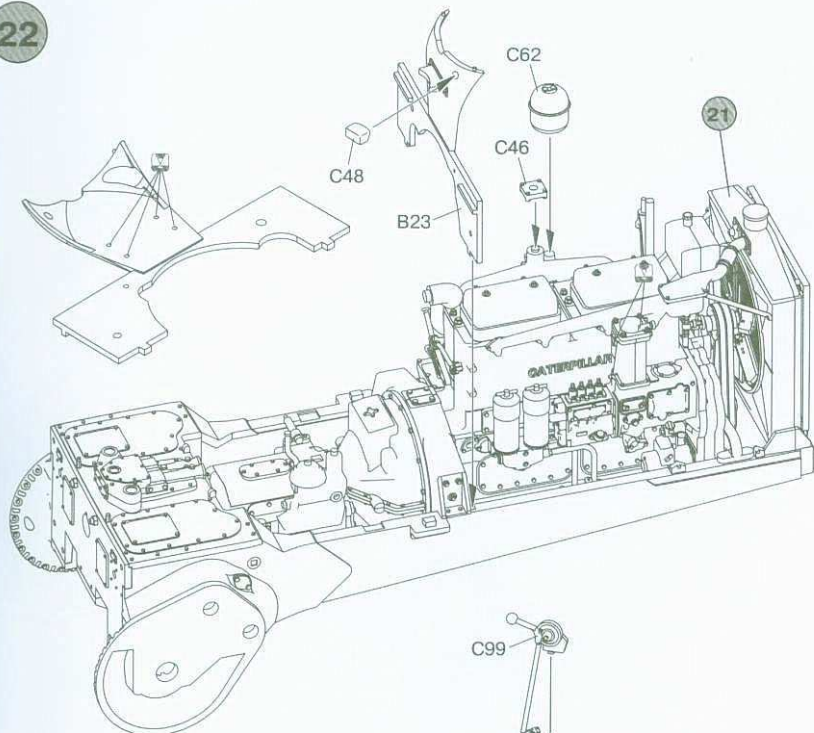

23

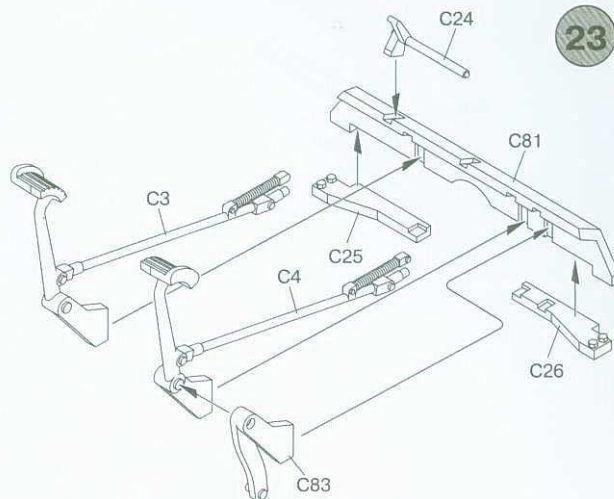

24

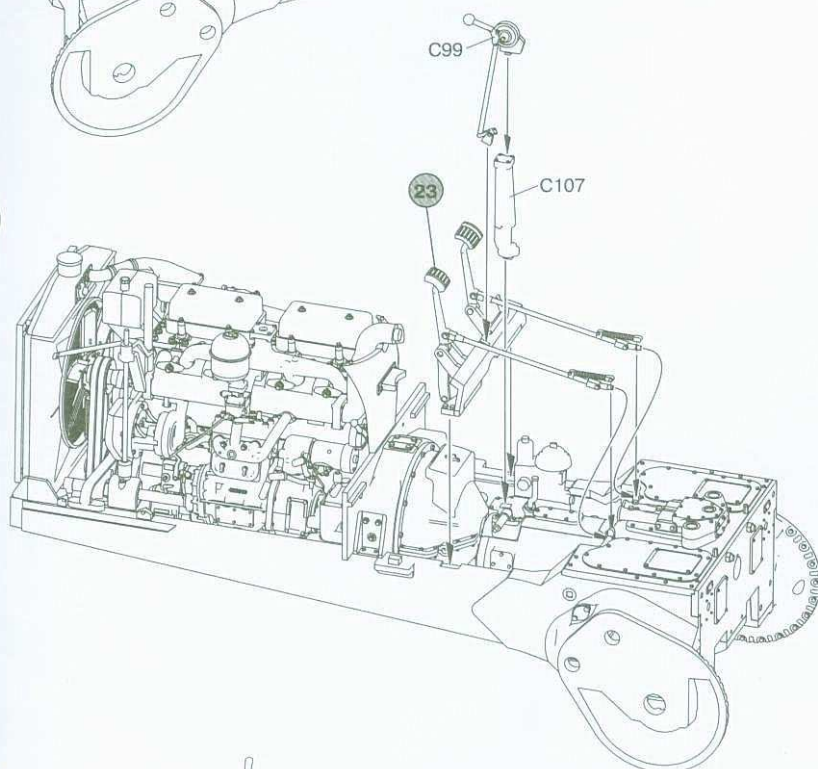

25

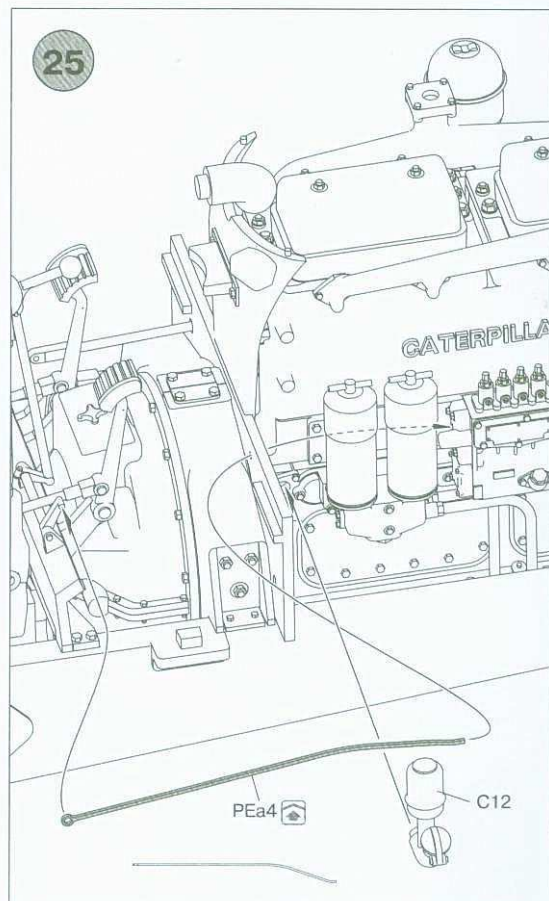

26

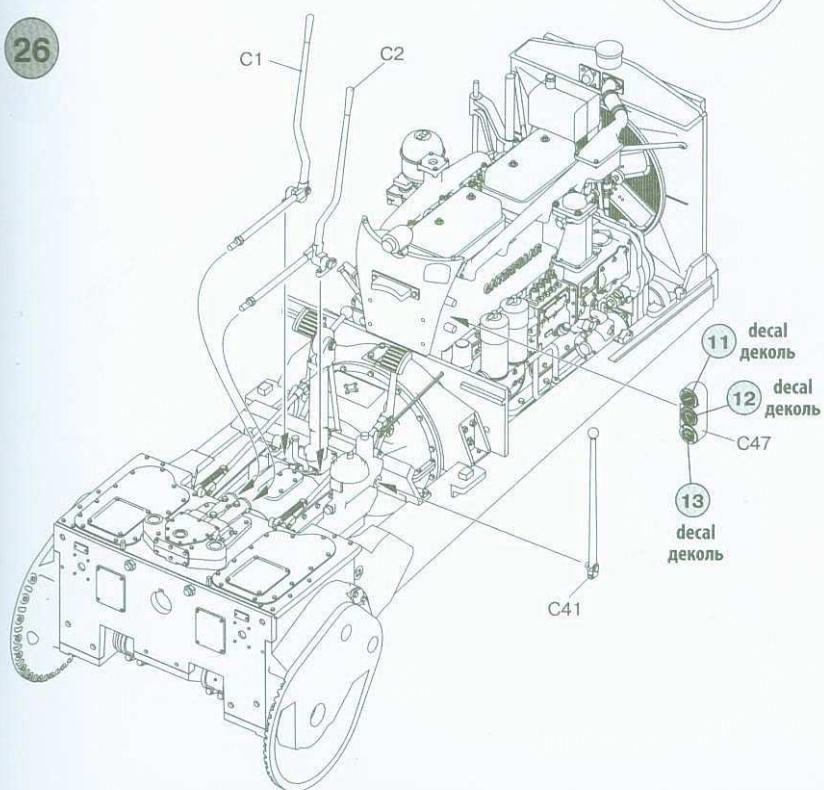

27

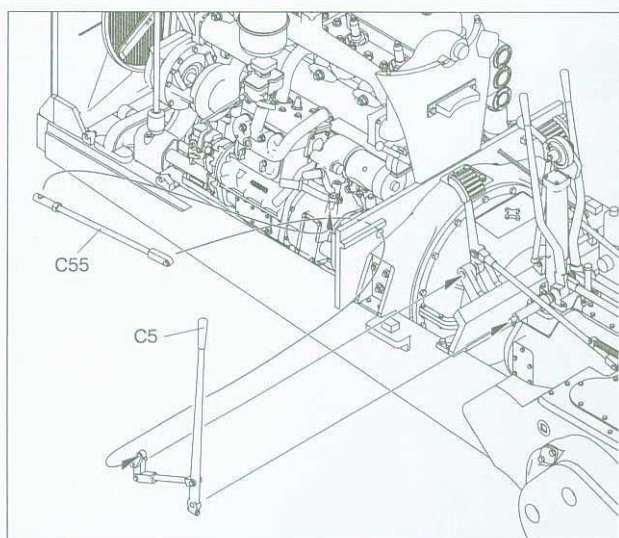

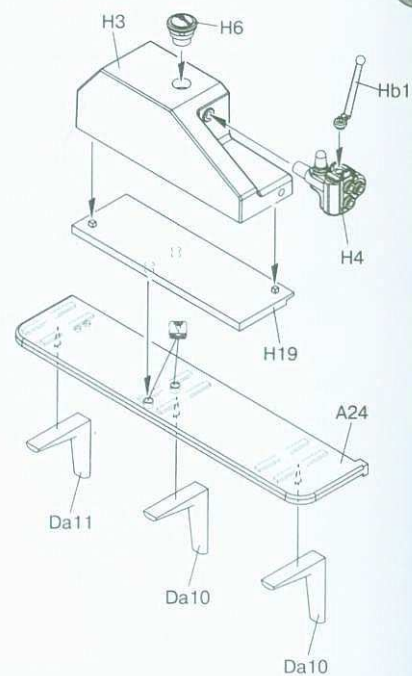
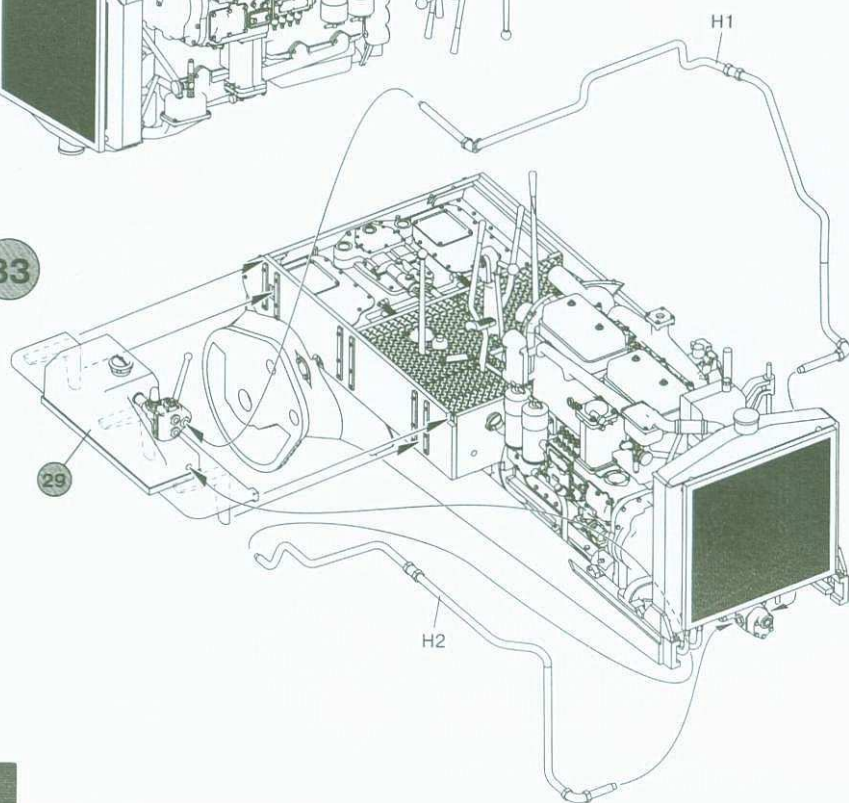
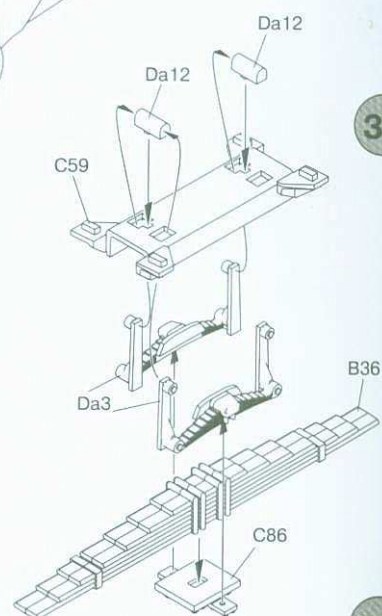
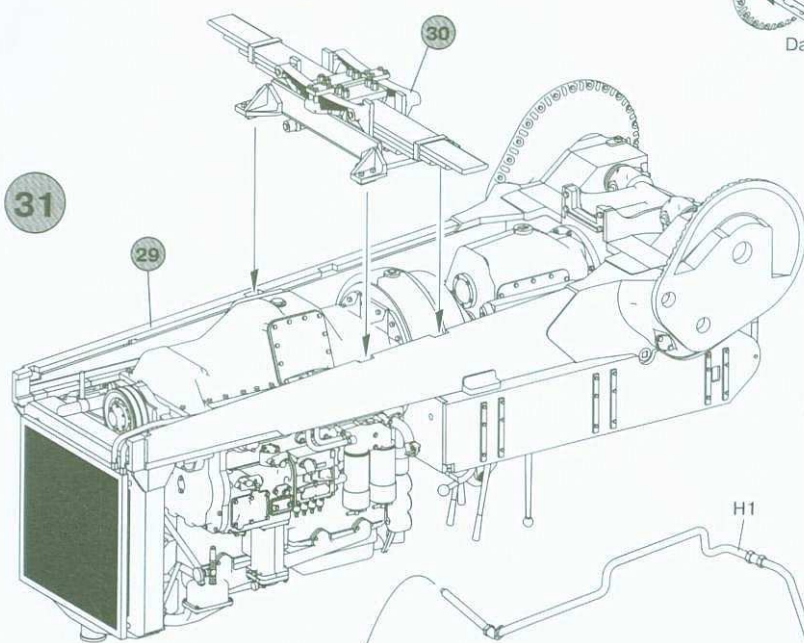
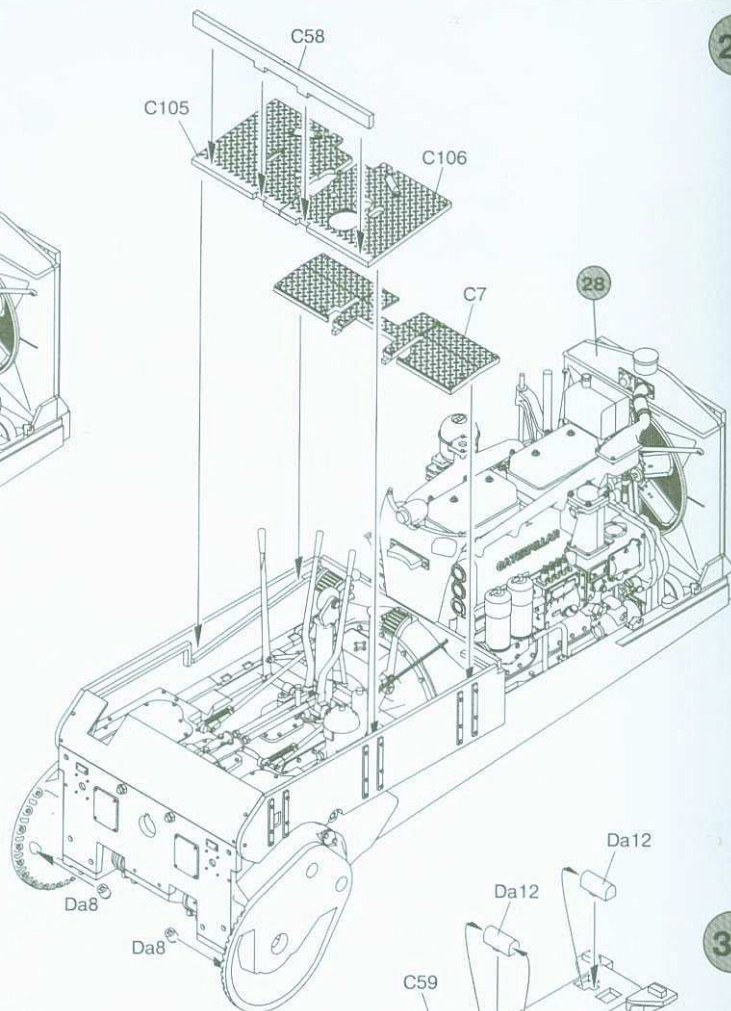
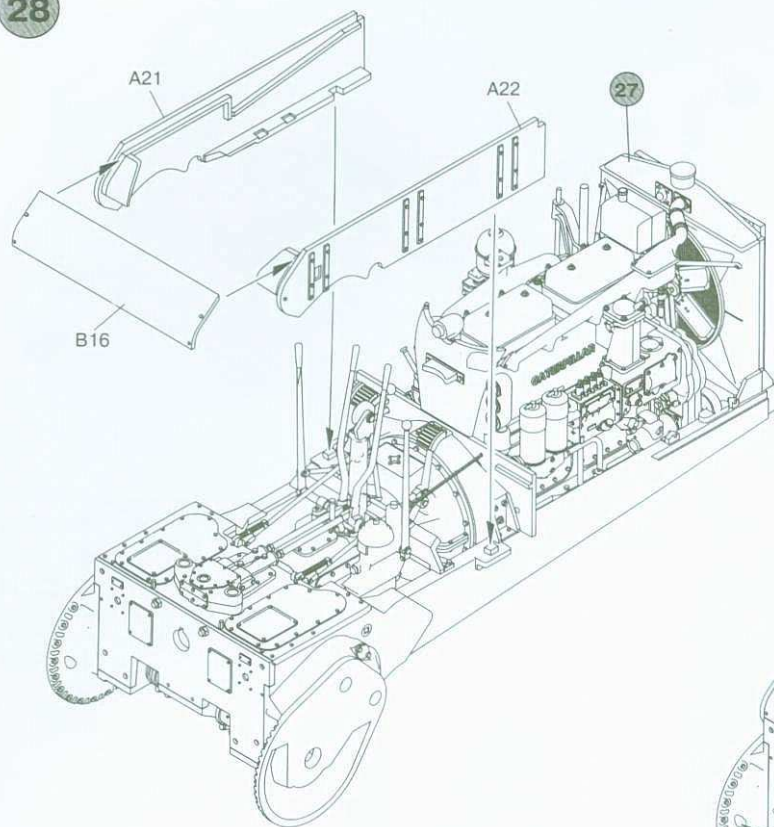

34

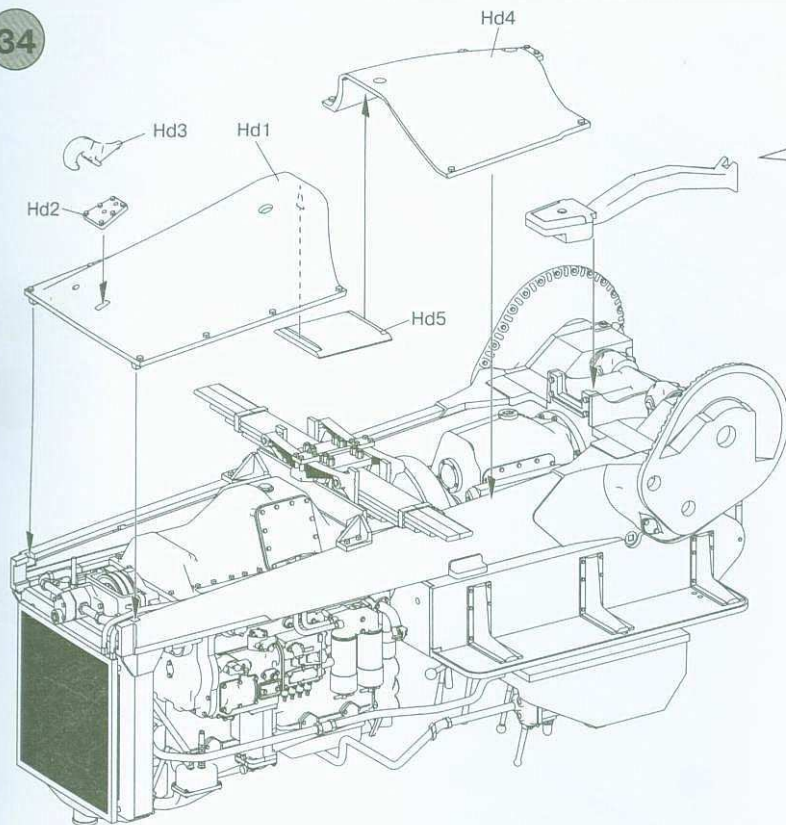

35

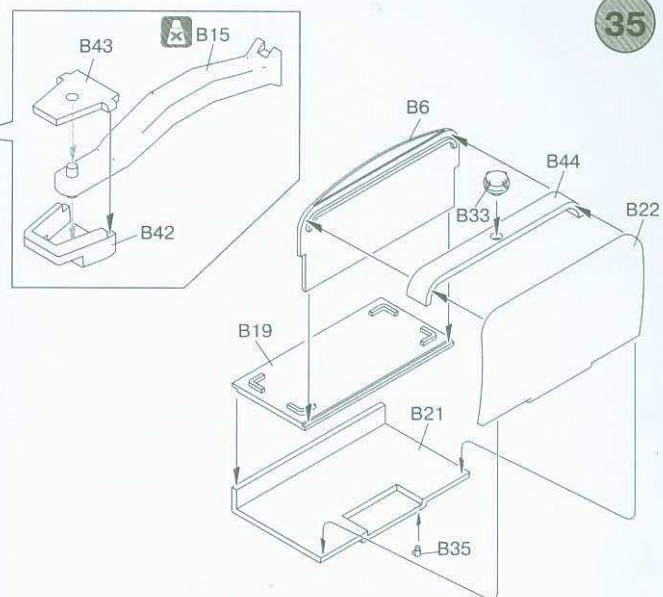

37

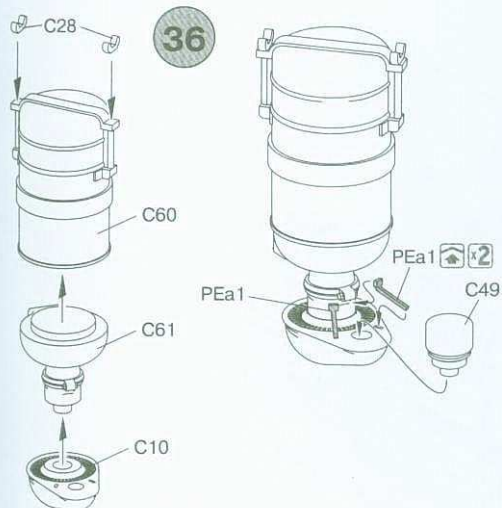

38

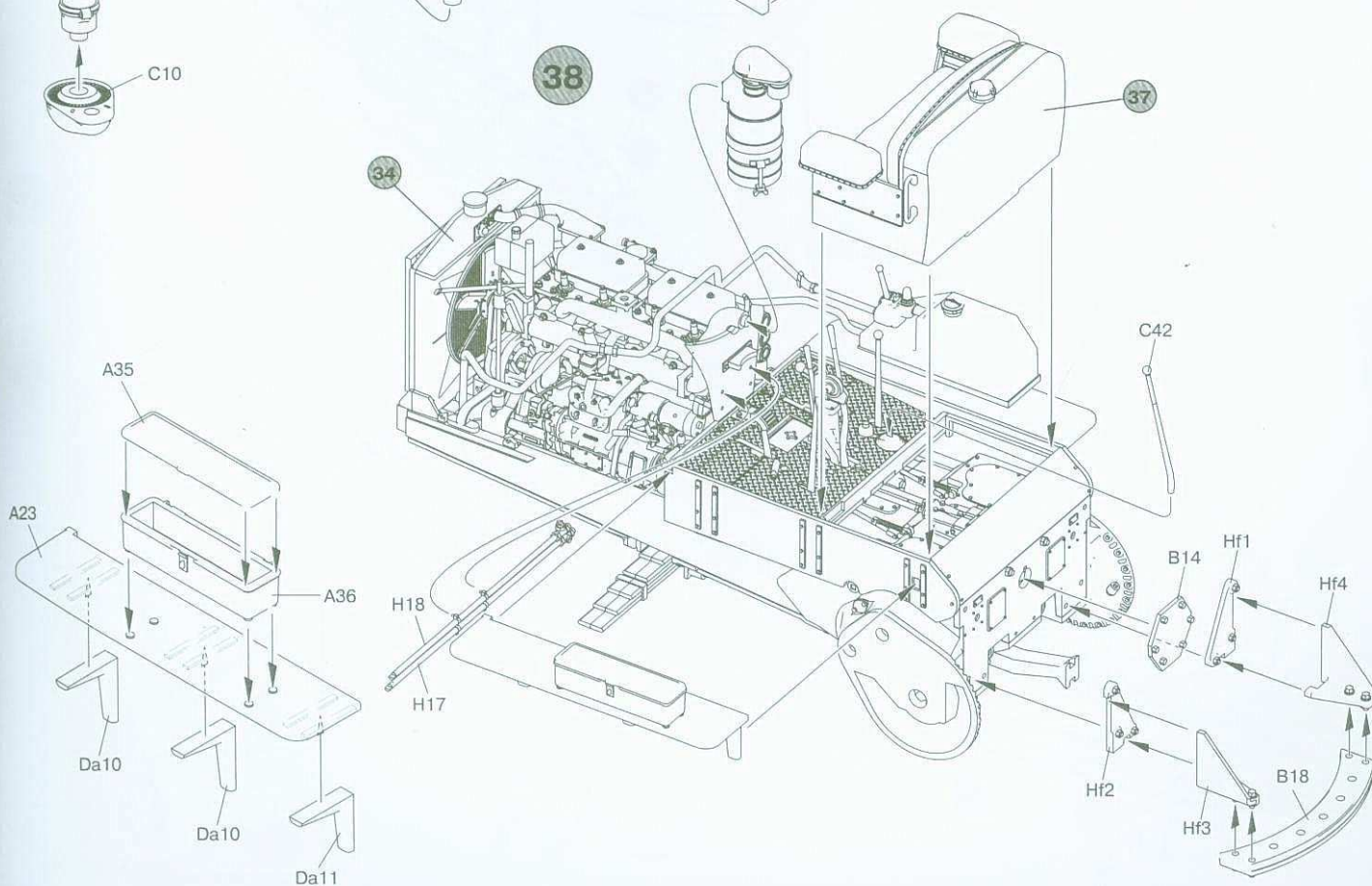

39

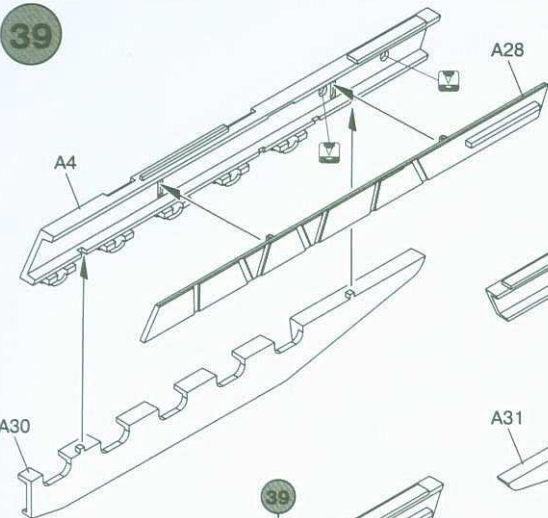

43

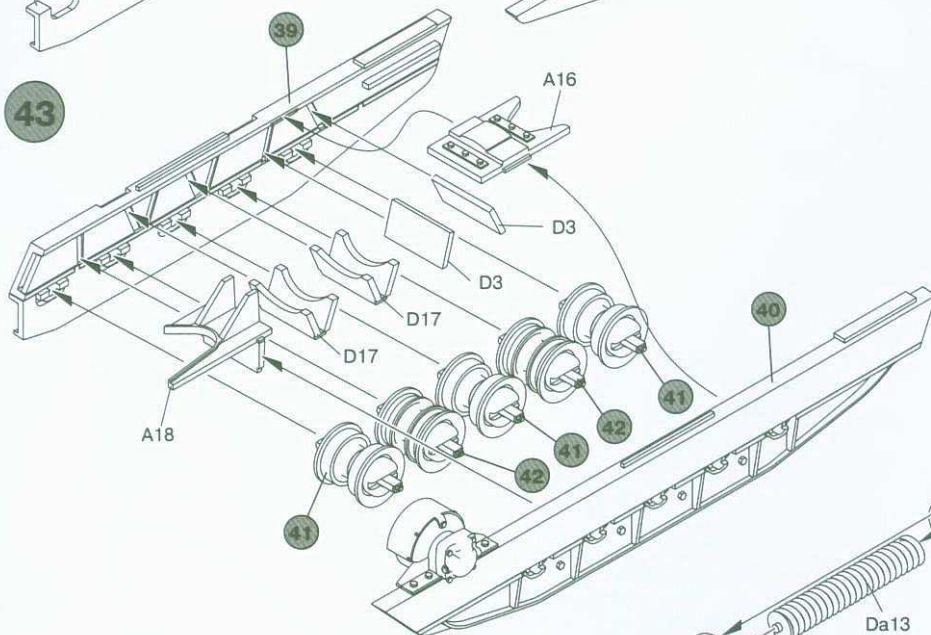

46

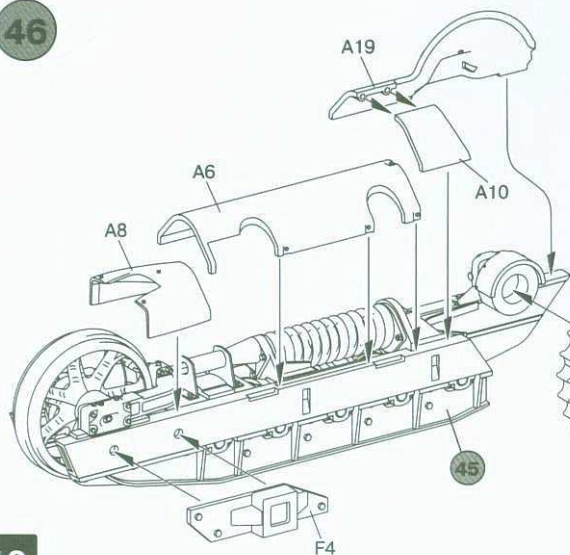

10

40

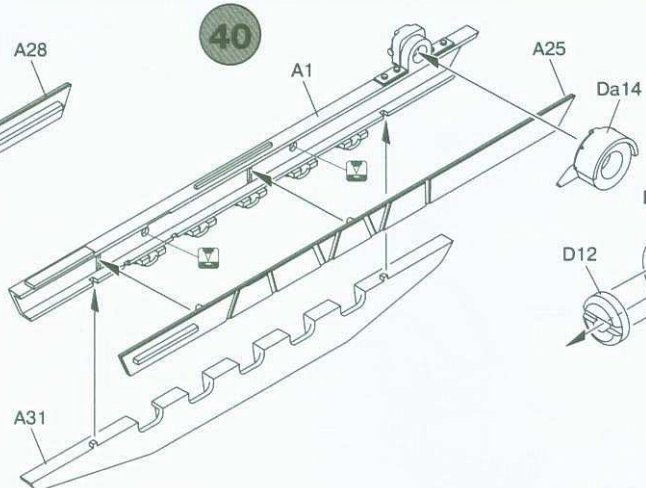

x3

41

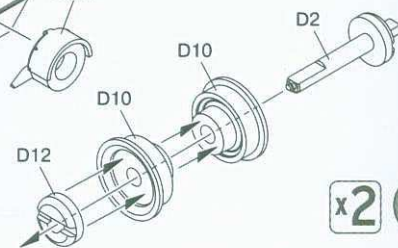

x2

42

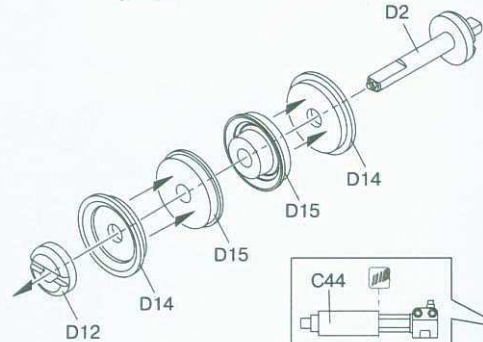

44

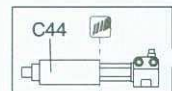

45

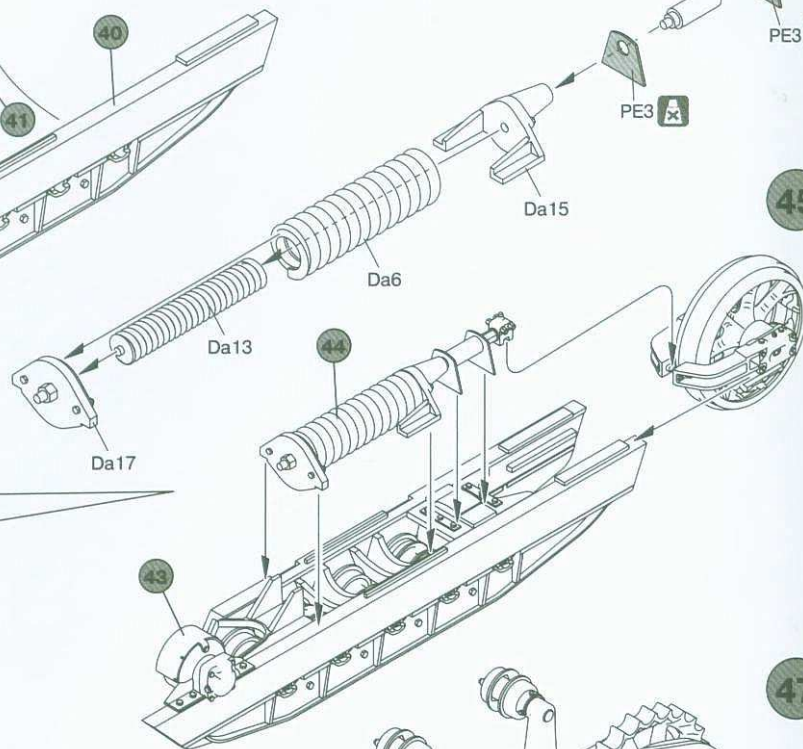

47

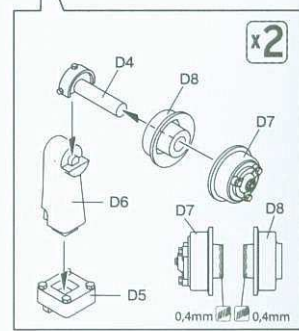
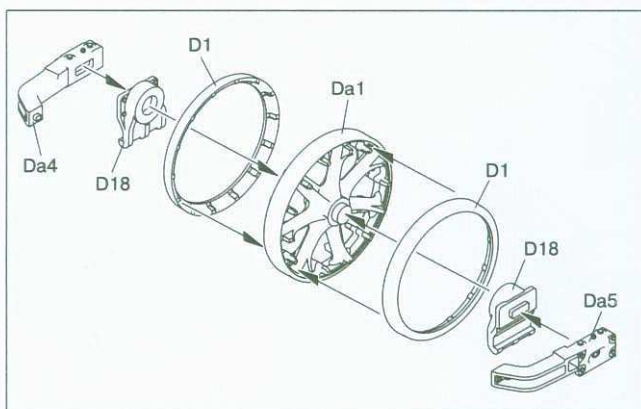

x2

0,4mm 0,4mm

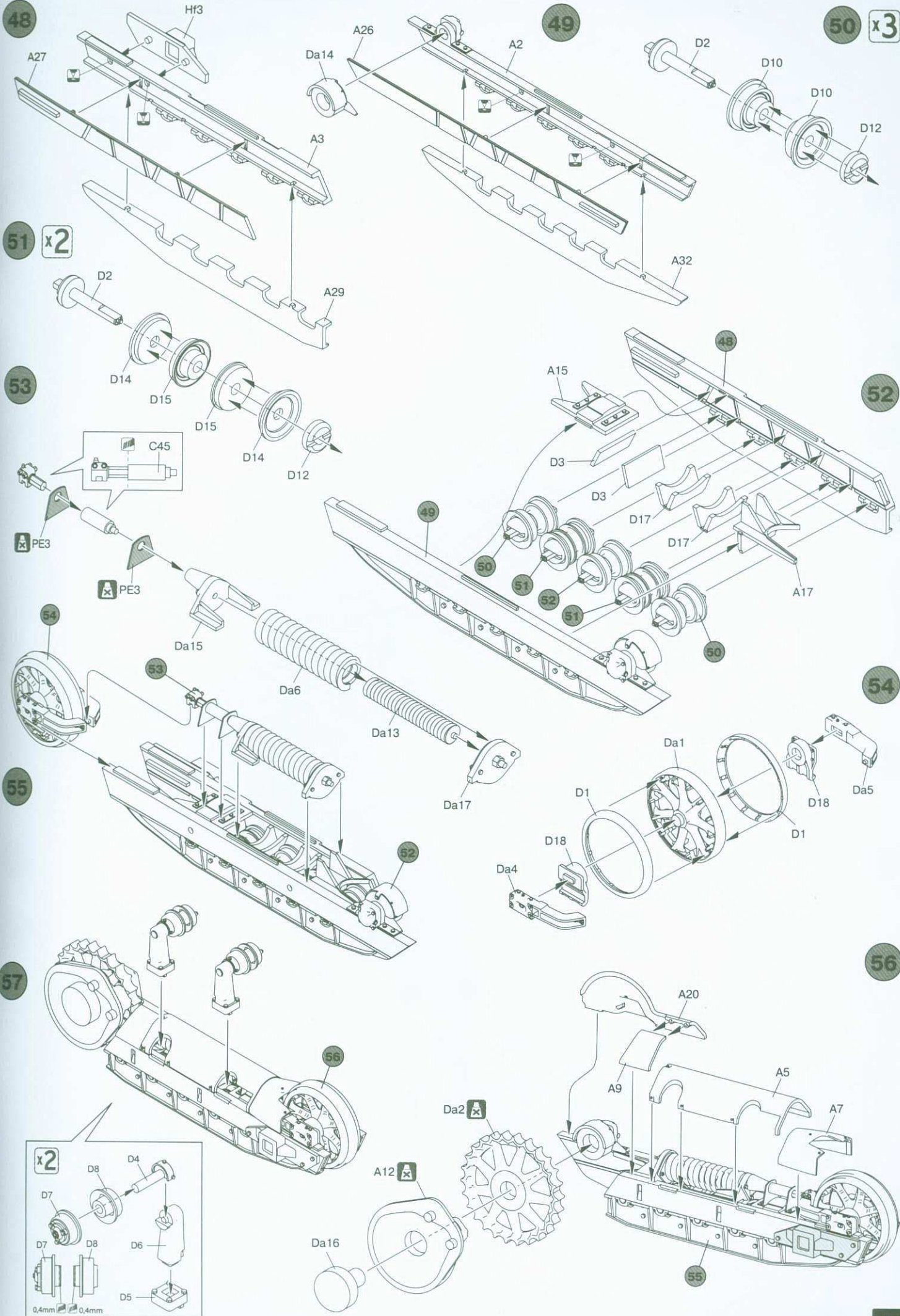

58

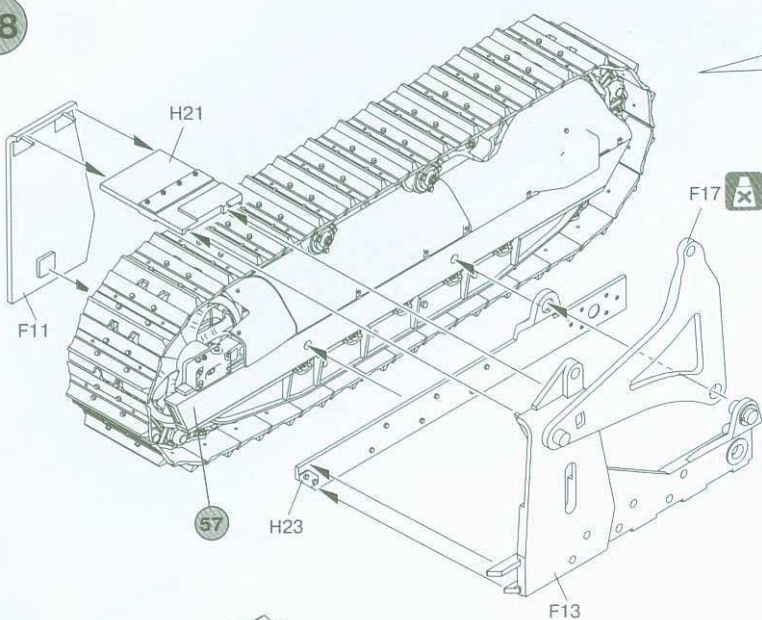

59

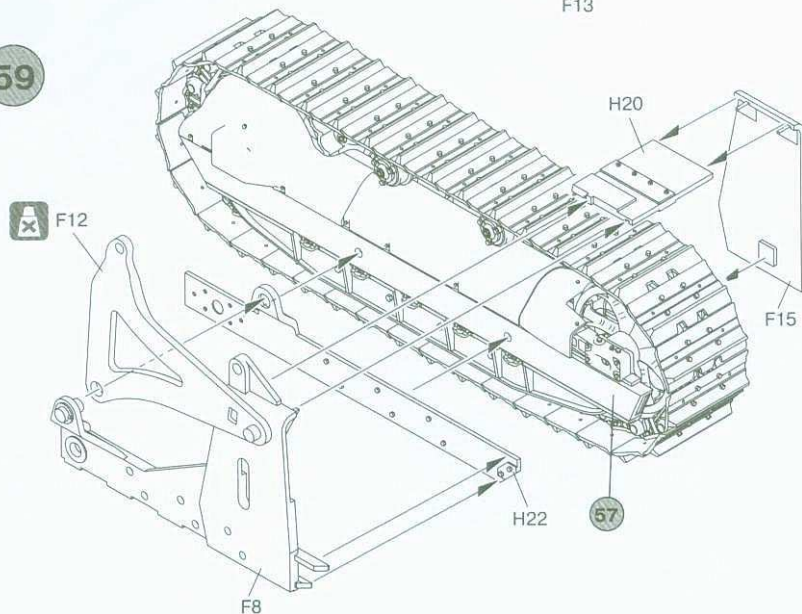

60

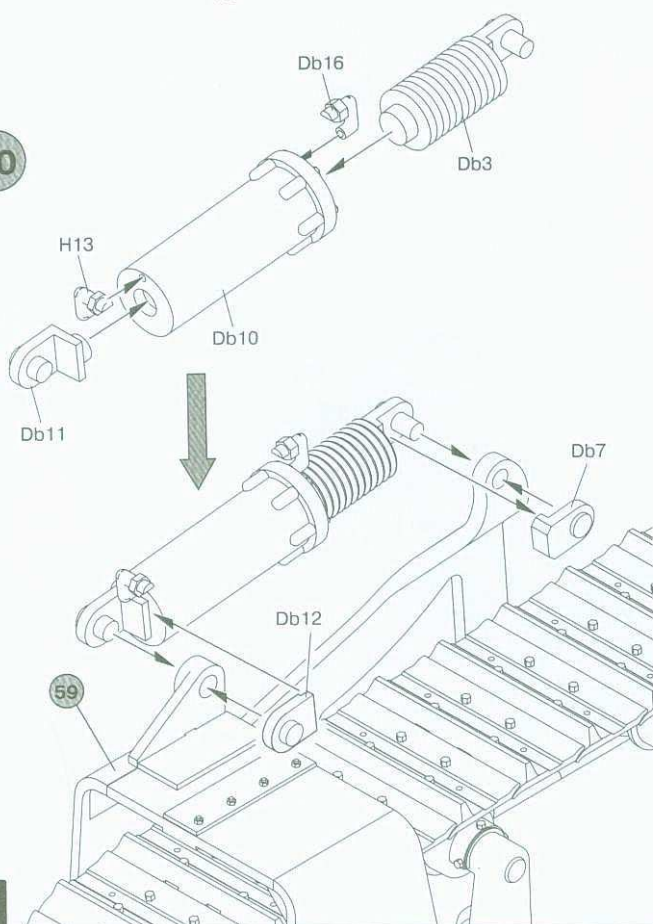

12

each track link contains 36 tracks  
каждая гусеничная лента состоит из 36 траков

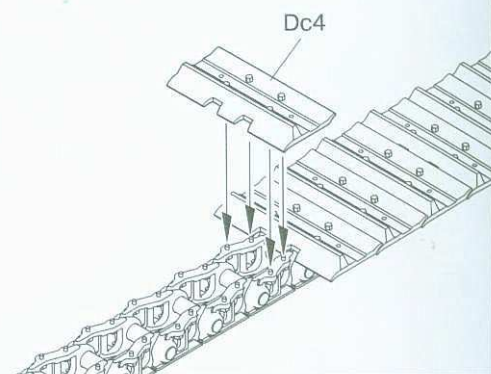
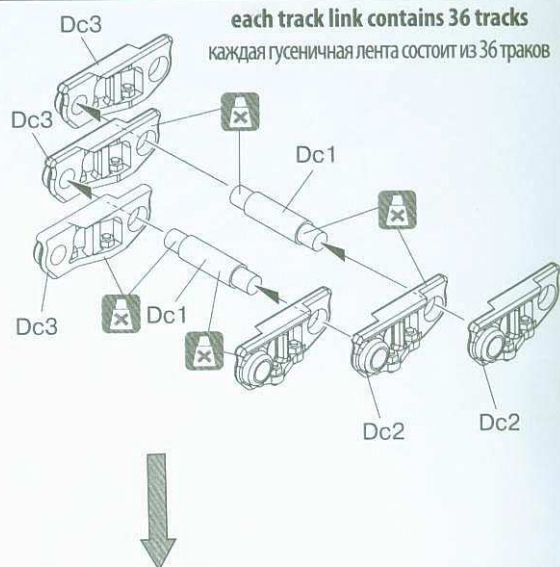

61

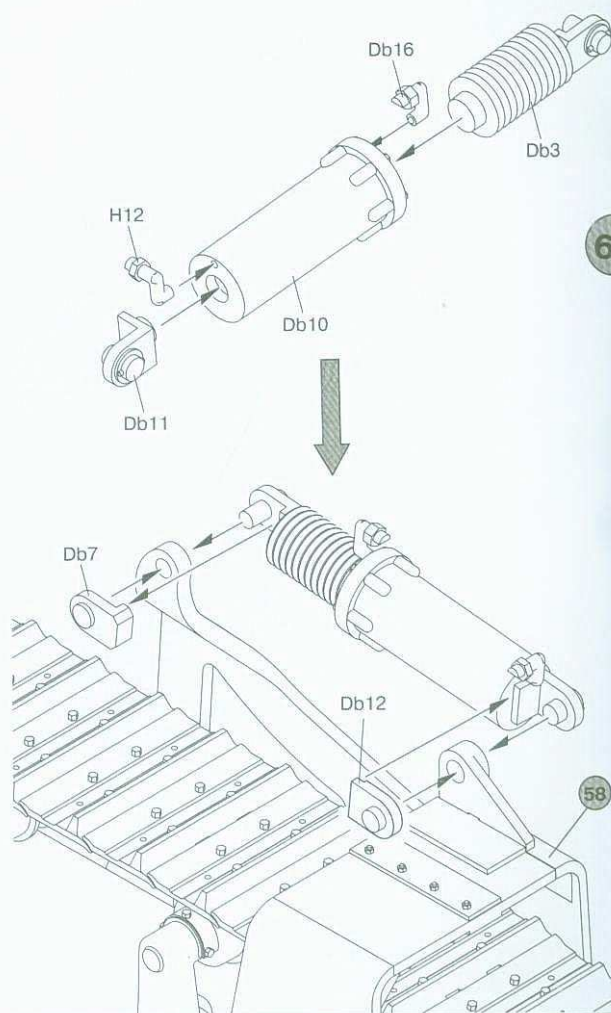

62

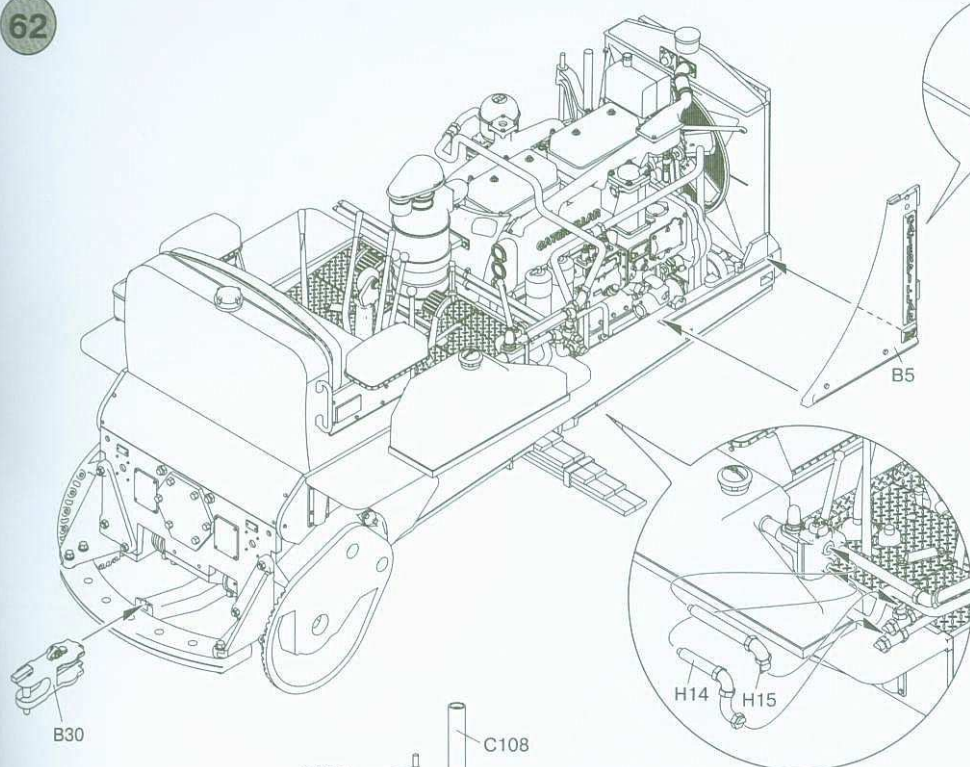

63

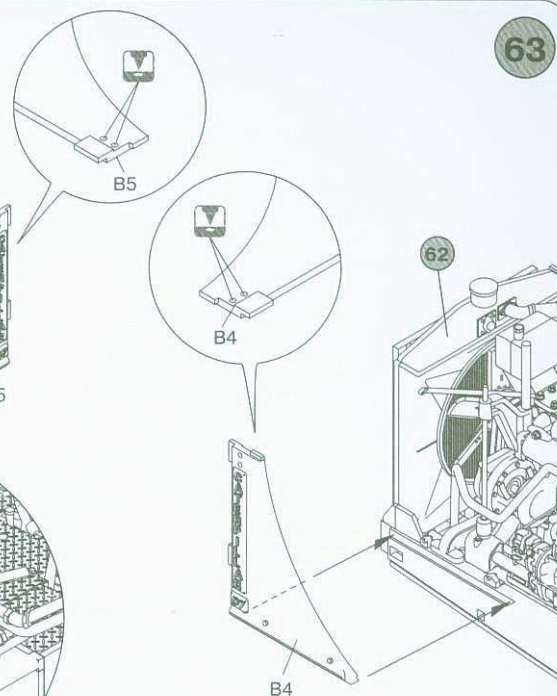

64

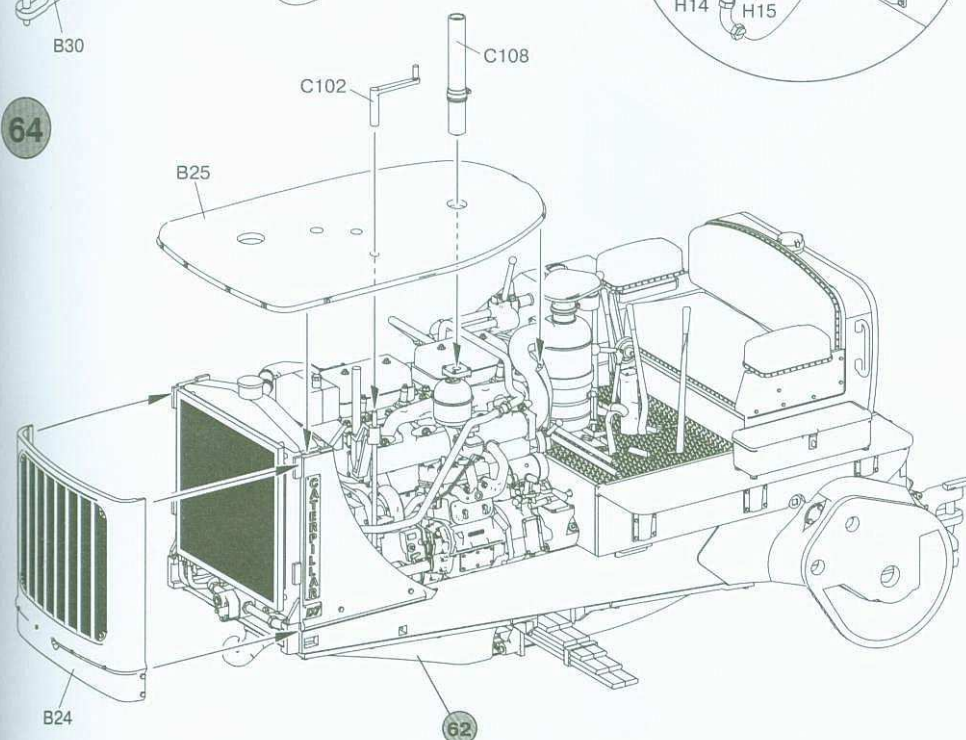

65

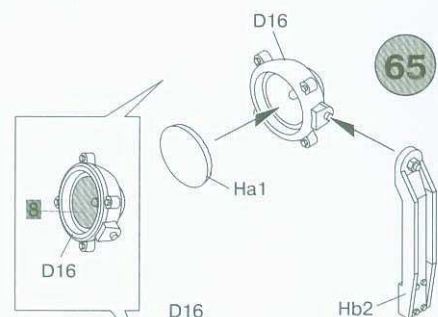

66

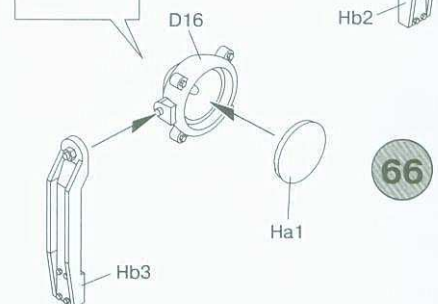

67

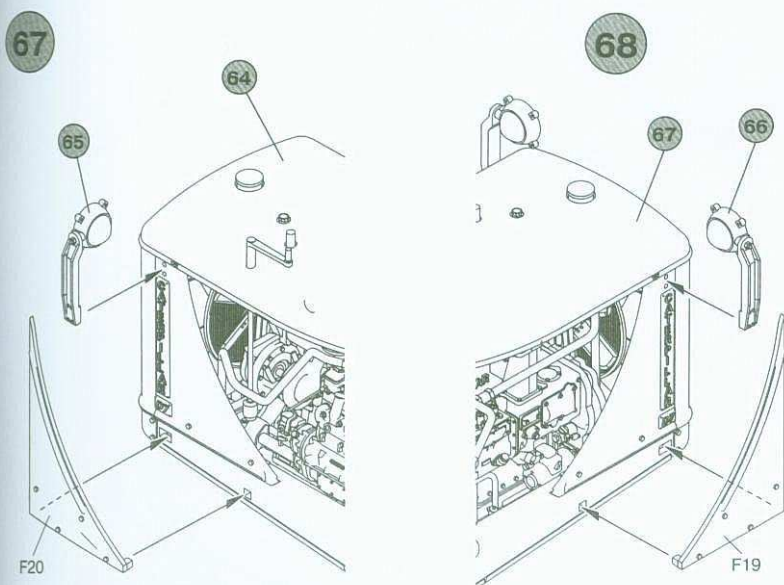

69

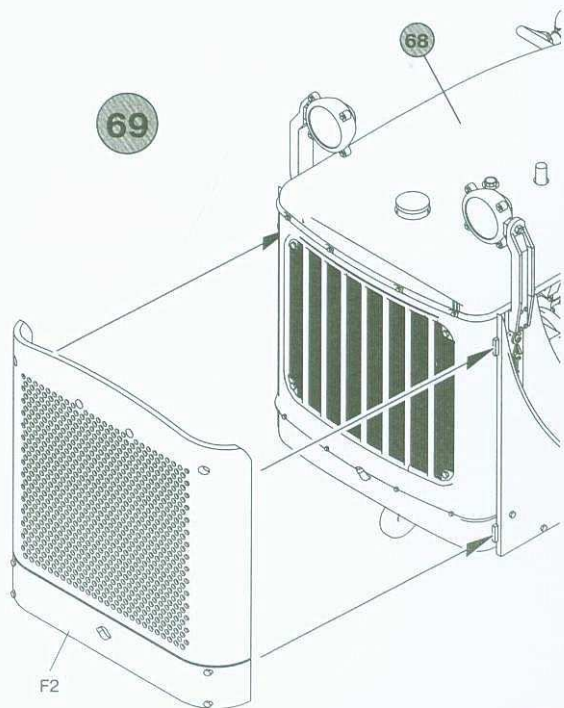

70

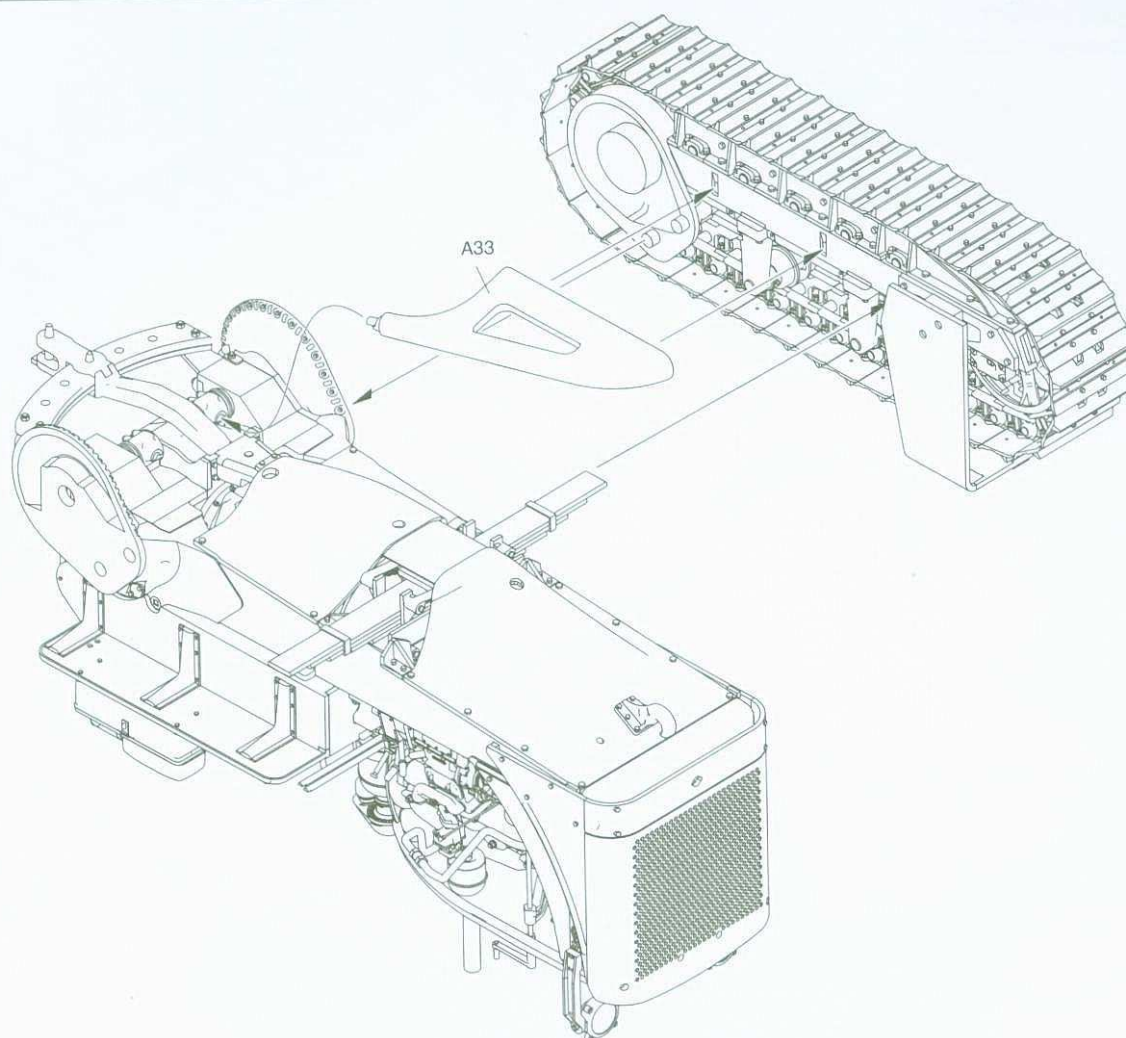

71

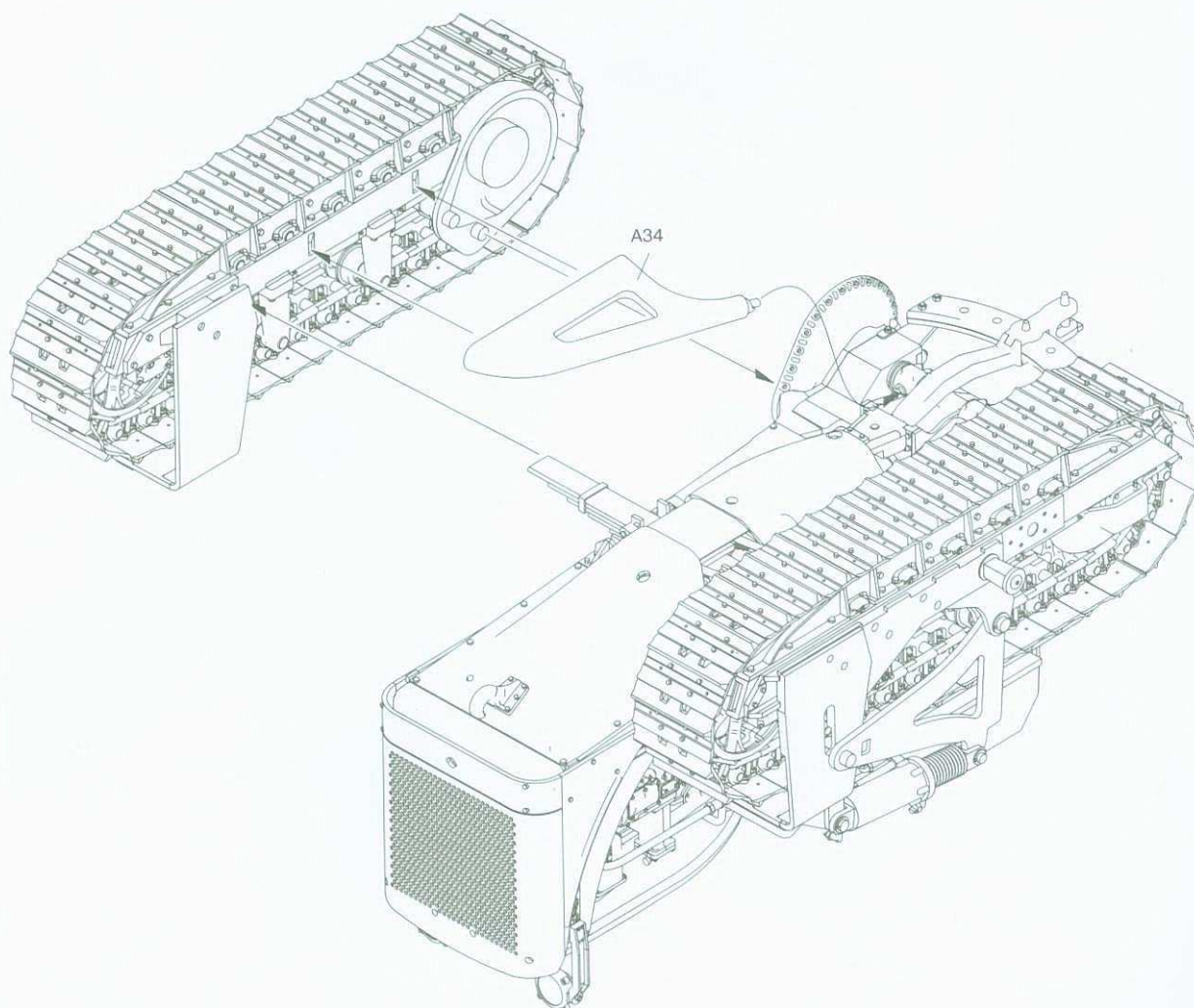

72

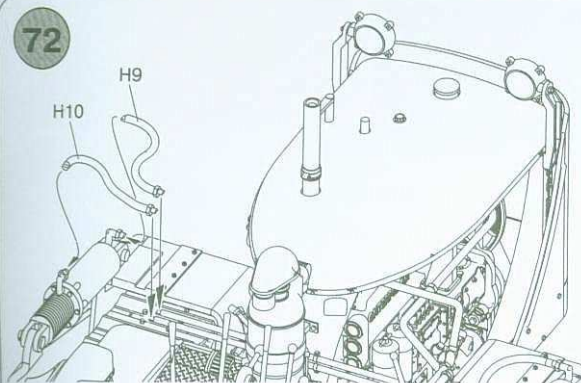

73

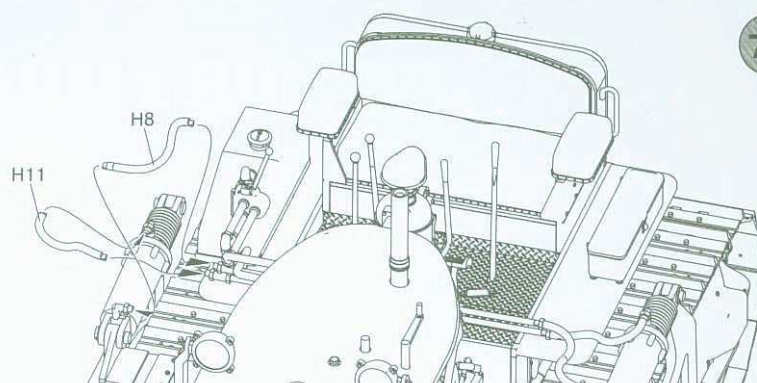

74

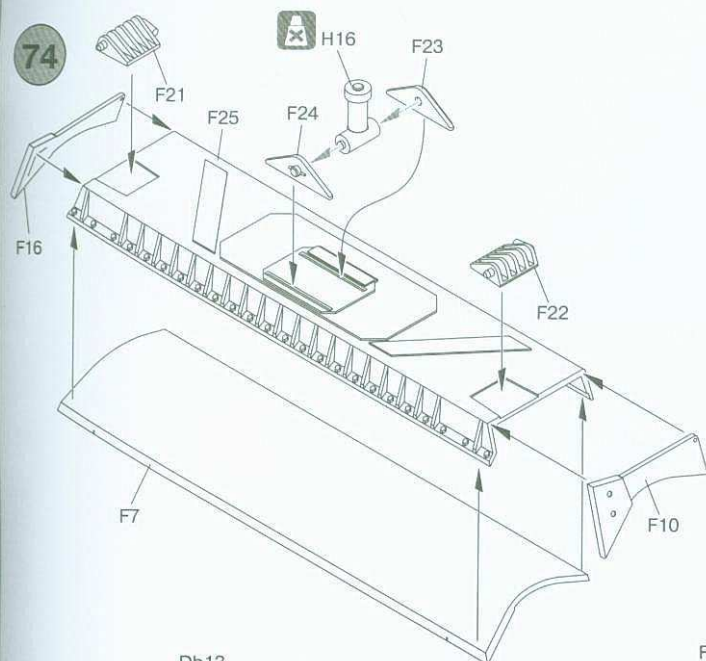

75

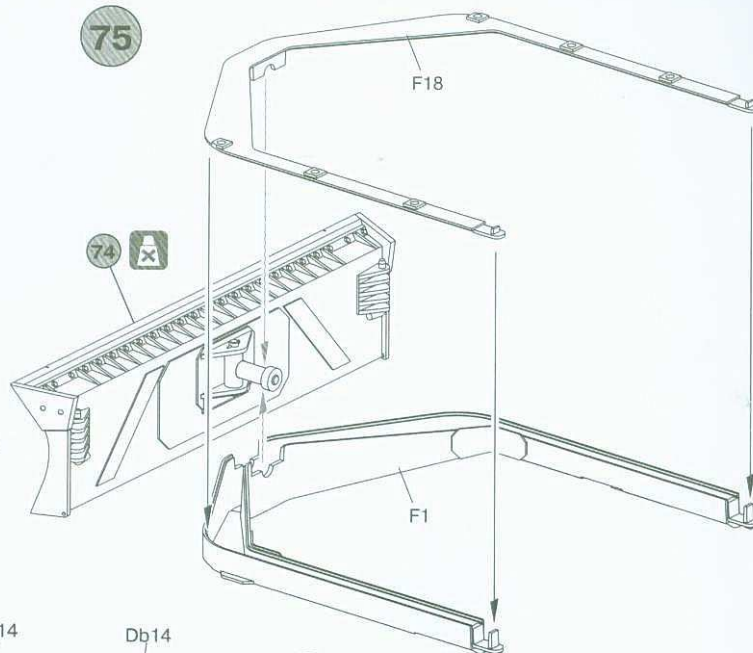

76

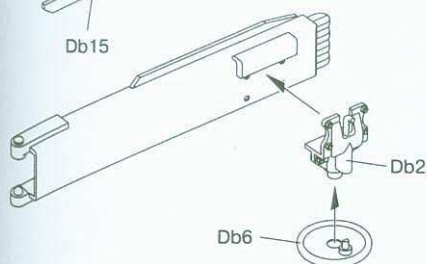
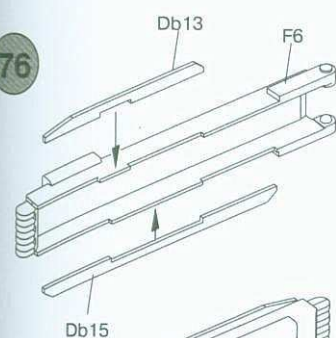

78

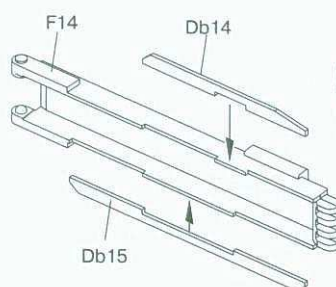

77

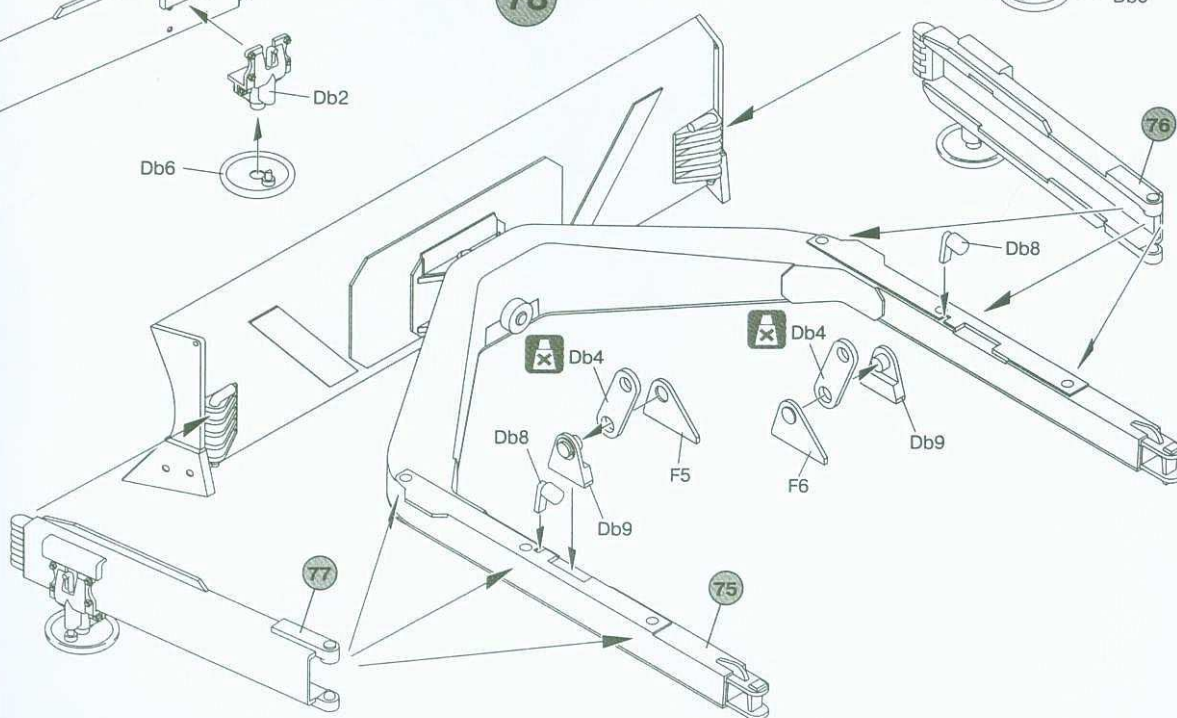
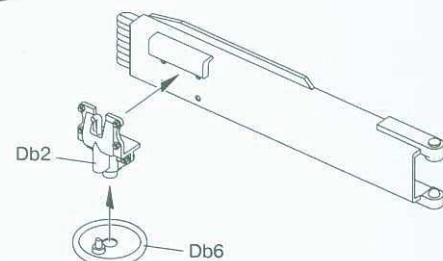

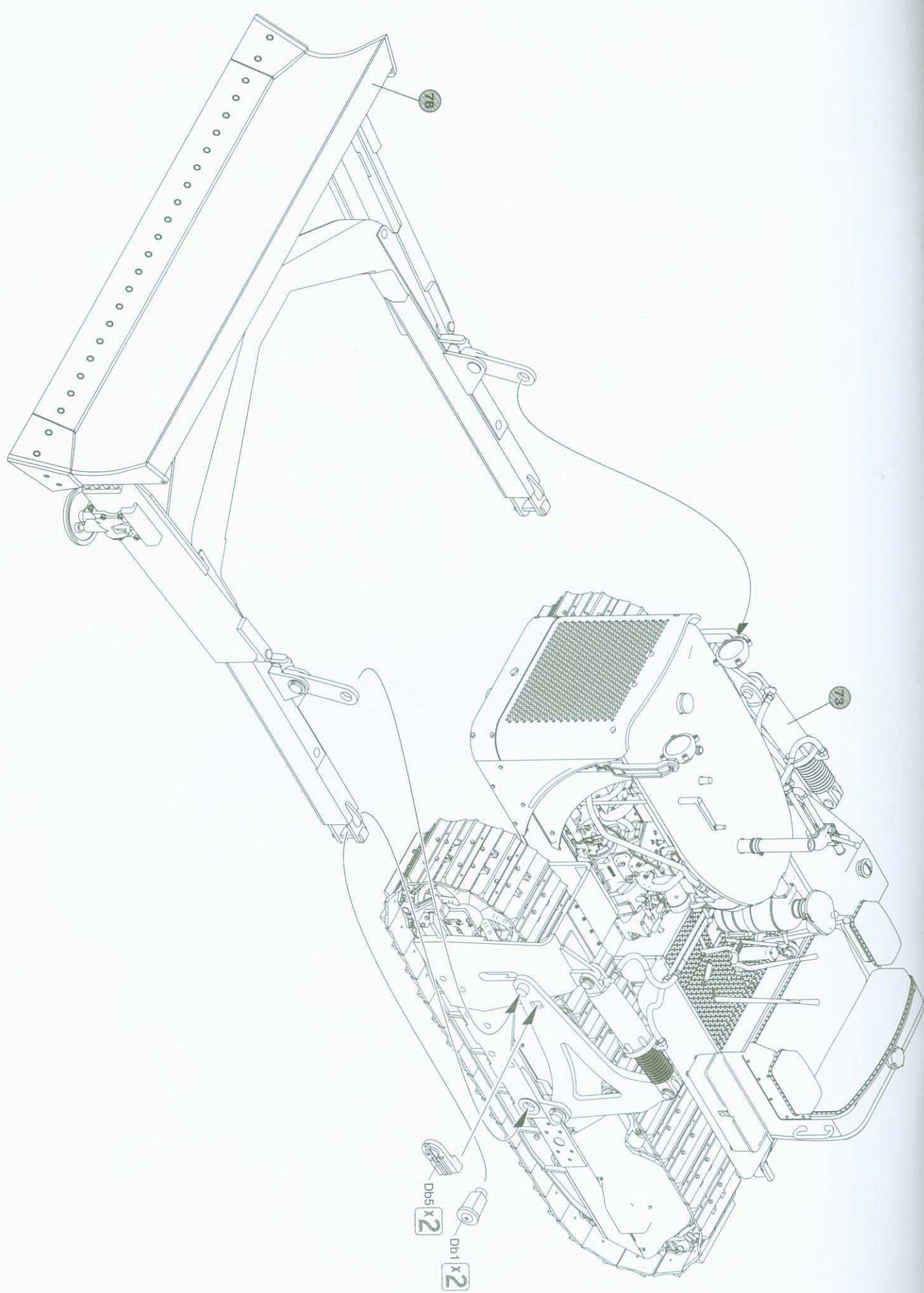

The U.S. Army, France. Summer 1944.

Армия США, Франция. Лето 1944 года.



COLOR NAME	AMMO
Medium Rust	A.MIG-040
Dark Tracks	A.MIG-035
Satin Black	A.MIG-032
Red	A.MIG-049
Matt Black	A.MIG-046
Olive Drab Base	A.MIG-926

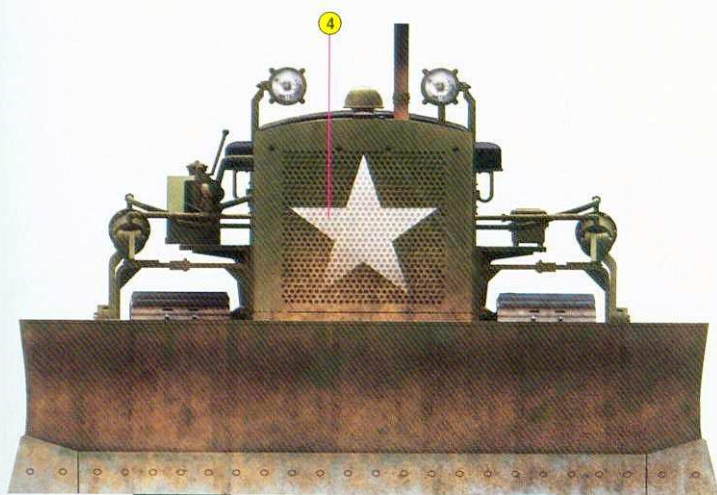

The Royal Engineers Battalion of the 2nd Canadian Corps., Falaise, France. Summer 1944.

Батальон королевских инженеров 2-го Канадского корпуса, Фалез, Франция. Лето 1944 года.

COLOR NAME	AMMO
Medium Rust	A.MIG-040
Dark Tracks	A.MIG-035
Satin Black	A.MIG-032
Red	A.MIG-049
Matt Black	A.MIG-046
Olive Drab Base	A.MIG-926
British Brown	A.MIG-110

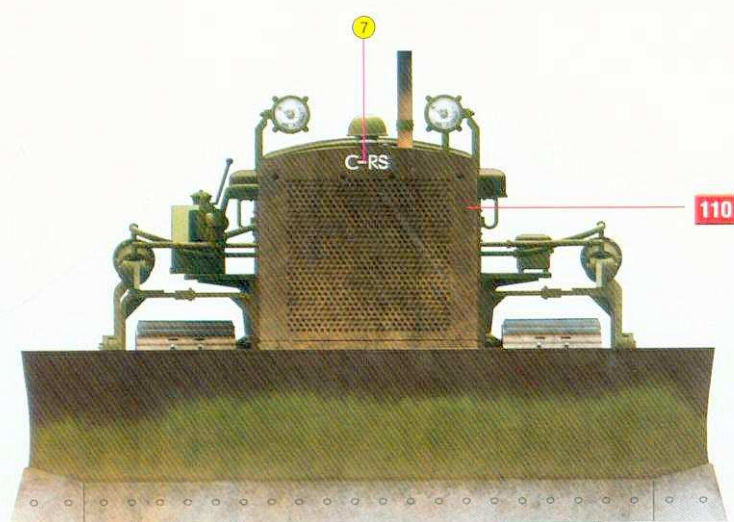
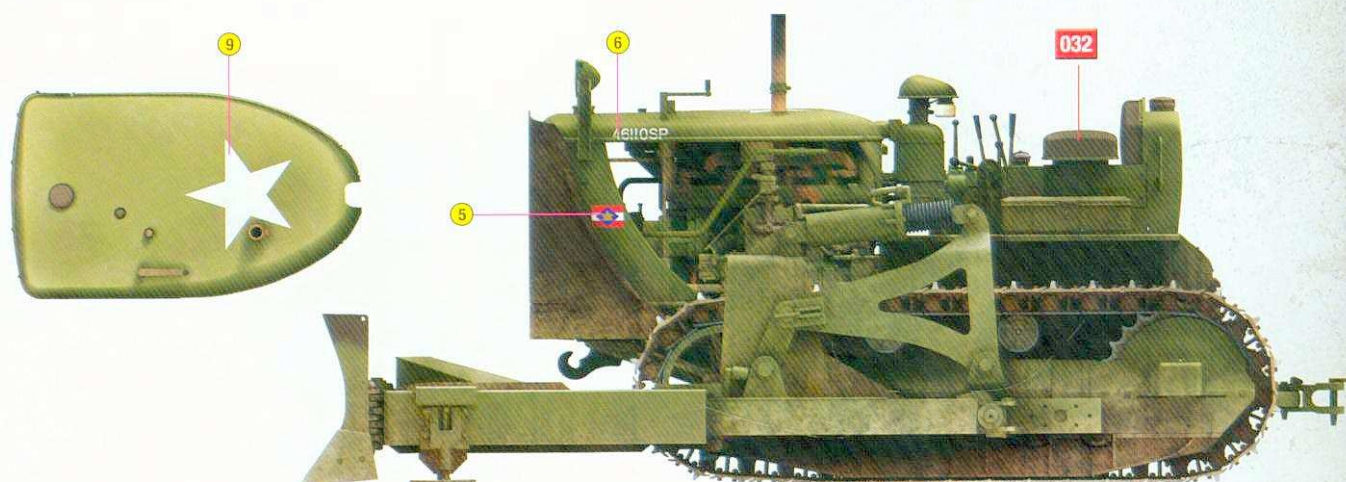
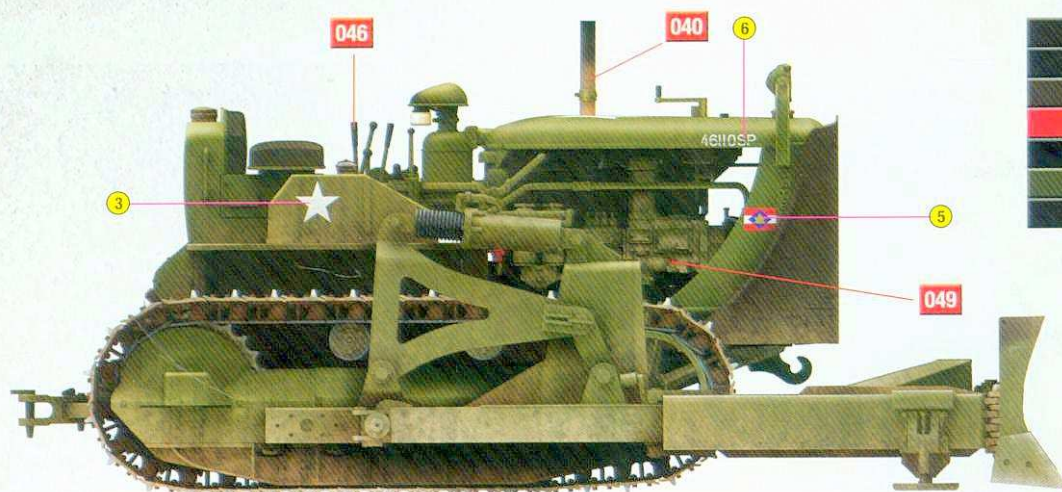

1304th Engineer Battalion of the U.S. Army, construction of Ledo Road (from India to China), 1944.

1304-й инженерный батальон армии США, строительство дороги Ледо. Индия-Бирма-Китай. 1944 год.

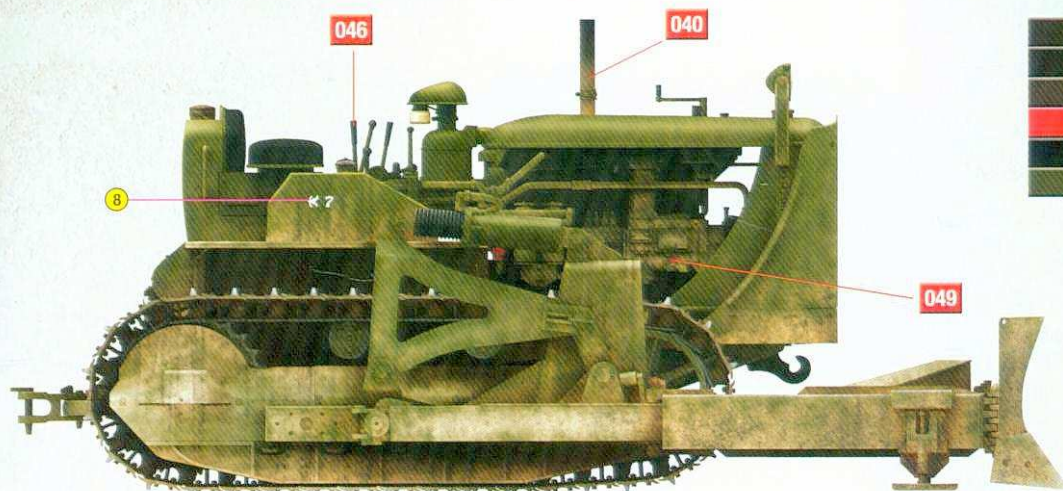

COLOR NAME	AMMO
Medium Rust	A.MIG-040
Dark Tracks	A.MIG-035
Satin Black	A.MIG-032
Red	A.MIG-049
Matt Black	A.MIG-046
Olive Drab Base	A.MIG-926

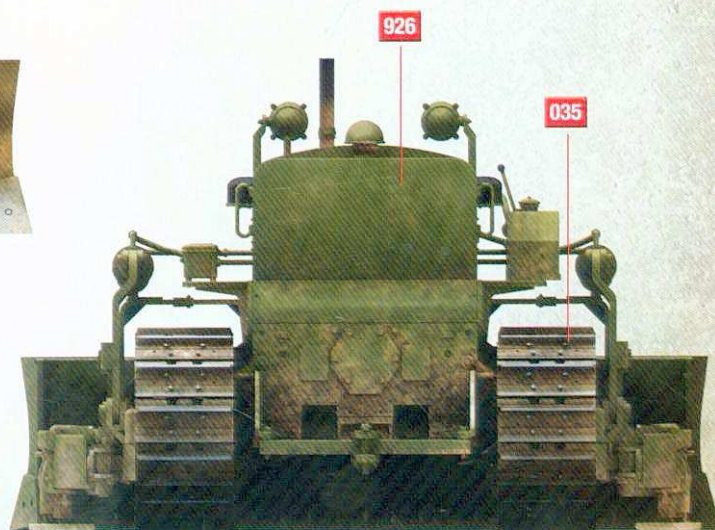
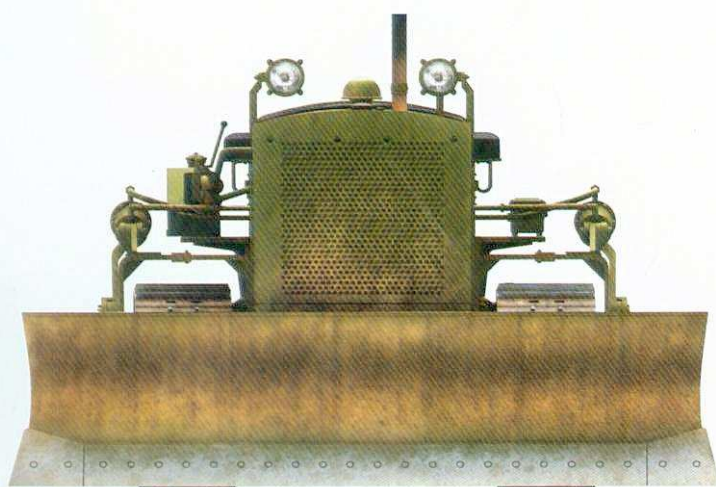



## U.S. ARMoured BULLDOZER

WW II MILITARY MINIATURES SERIES

UNASSEMBLED PLASTIC MODEL KIT  
THIS IS NOT A KIT  
KIT CONTAINS 117 PARTS  
BOX CONTAINS MODEL OF TRACTOR  
2 PROPORTIONED PARTS  
2 CLEAR PLASTIC PARTS  
KIT PLASTIC PARTS  
AND DETAILS ARE  
INCLUDED

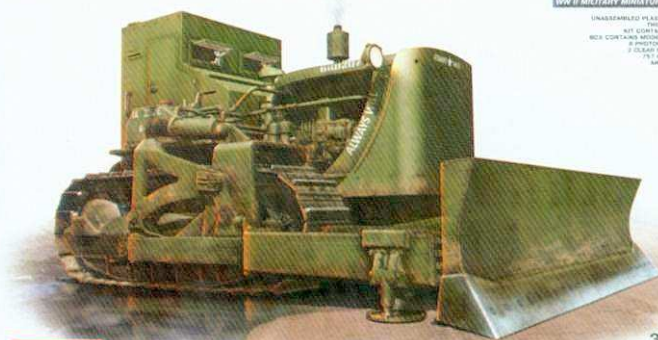
35188  
1:35

## U.S. ARMY BULLDOZER

WW II MILITARY MINIATURES SERIES

UNASSEMBLED PLASTIC MODEL KIT  
THIS IS NOT A KIT  
KIT CONTAINS 117 PARTS  
BOX CONTAINS MODEL OF TRACTOR  
2 PROPORTIONED PARTS  
2 CLEAR PLASTIC PARTS  
KIT PLASTIC PARTS  
AND DETAILS ARE  
INCLUDED



35195



1:35



## U.S. TRACTOR D7 w/Towing Winch D7N

WW II MILITARY MINIATURES SERIES

UNASSEMBLED PLASTIC MODEL KIT  
THIS IS NOT A KIT  
KIT CONTAINS 117 PARTS  
BOX CONTAINS MODEL OF TRACTOR  
2 PROPORTIONED PARTS  
2 CLEAR PLASTIC PARTS  
KIT PLASTIC PARTS  
AND DETAILS ARE  
INCLUDED



35174



1:35



## U.S. ARMY TRACTOR w/ANGLED DOZER BLADE

WW II MILITARY MINIATURES SERIES

UNASSEMBLED PLASTIC MODEL KIT  
THIS IS NOT A KIT  
KIT CONTAINS 117 PARTS  
BOX CONTAINS MODEL OF TRACTOR  
2 PROPORTIONED PARTS  
2 CLEAR PLASTIC PARTS  
KIT PLASTIC PARTS  
AND DETAILS ARE  
INCLUDED



35184



1:35

