



03840-0379

LEVEL 4  
1 2 3 4 5



# Airbus A320neo British Airways

Beiliegenden Sicherheitstext beachten / Please note the enclosed safety advice

- Ⓞ Beiliegenden Sicherheitstext beachten und nachschlagbereit halten.
- Ⓞ Please note the enclosed safety advice and keep safe for later reference.
- Ⓞ Respecter les consignes de sécurité ci-jointes et les conserver à portée de main.
- Ⓞ Houdt u aan de bijgaande veiligheidsinstructies en hou deze steeds bij de hand.
- Ⓞ Seguire le avvertenze di sicurezza allegate e tenerle a portata di mano.
- Ⓞ Observar y siempre tener a disposición este texto de seguridad adjunto.
- Ⓞ Ter em atenção o texto de segurança anexo e guardá-lo para consulta.

- Ⓞ Overhold vedlagte sikkerhedsanvisninger og hav dem liggende i nærheden.
- Ⓞ Ha alltid vedlagt sikkerhetstekst klar til bruk.
- Ⓞ Beakta bifogad säkerhetstext och håll den i beredskap.
- Ⓞ Huomioi ja säilytä oheiset varoitukset.
- Ⓞ Соблюдать технику безопасности, сохранить инструкцию для дальнейших обращений.
- Ⓞ Przestrzegać załączonego tekstu dotyczącego bezpieczeństwa i mieć go zawsze pod ręką.
- Ⓞ Dodržujte tento příložený bezpečnostní text a mějte ho po ruce.
- Ⓞ A mellékelt biztonsági szöveget vegye figyelembe és tartsa fellelőzásra készen.

- Ⓞ Respektujte priložený bezpečnostný text a uchovajte ho pre budúce použitie.
- Ⓞ Respectati textul de siguranță atașat și păstrați-l la îndemână.
- Ⓞ Спазвайте приложения текст за безопасност и го дръжте под ръка за справки.
- Ⓞ Priloga varnostna navodila izvajajte in jih hranite na vsem dostopnem mestu.
- Ⓞ Λάβετε υπόψη σας το συνημμένο κείμενο ασφαλείας και φυλάξτε το ώστε να ανατρέχετε σε αυτό όποτε χρειάζεται.
- Ⓞ Ektekiküvenlik talimatlarını dikkate alıp, bakabileceğiniz bir şekilde muafaza ediniz.

© 2021 Revell GmbH, Henschelstr. 20-30, D-32257 Bünde.

REVELL IS THE REGISTERED TRADEMARK OF REVELL GMBH, GERMANY. [www.revell.de](http://www.revell.de)



- ③ Kundenservice: **www.revell-service.de** oder **Revell GmbH, Abteilung X**, Hensslerstr. 20-30, D-32257 Bünde (enclaves pour DE, AT, NL, BE, LU, ES, IT, PL, US, CA). For other countries please contact your dealer or distributor only.
- ③ Kundenservice: **www.revell-service.de** oder **Revell GmbH, Abteilung X**, Hensslerstr. 20-30, D-32257 Bünde (enclaves para DE, AT, NL, BE, LU, ES, IT, PL, US, CA). Para todos los demás países, por favor, póngase en contacto con su proveedor o distribuidor solamente.
- ③ Kundenservice: **www.revell-service.de** oder **Revell GmbH, Abteilung X**, Hensslerstr. 20-30, D-32257 Bünde (enclaves pour DE, AT, NL, BE, LU, ES, IT, PL, US, CA). Pour tous les autres pays, veuillez contacter votre revendeur ou distributeur uniquement.
- ③ Servico cliente: **www.revell-service.de** ou **Revell GmbH, Abteilung X**, Hensslerstr. 20-30, D-32257 Bünde (enclaves para DE, AT, NL, BE, LU, ES, IT, PL, US, CA). Para todos os demais países, por favor, póngase em contato com seu provedor o distribuidor somente.
- ③ Servico al cliente: **www.revell-service.de** o **Revell GmbH, Abteilung X**, Hensslerstr. 20-30, D-32257 Bünde (enclaves voor DE, AT, NL, BE, LU, ES, IT, PL, US, CA). Voor alle andere landen kunt u alleen contact opnemen met uw dealer of distributeur.
- ③ Klienťservis: **www.revell-service.de** of **Revell GmbH, Abteilung X**, Hensslerstr. 20-30, D-32257 Bünde (enclaves pre DE, AT, NL, BE, LU, ES, IT, PL, US, CA). Pre všetky ostatné krajiny kontaktujte výhradne svojho obchodníka alebo predajcu.
- ③ Serviciul clienți: **www.revell-service.de** sau **Revell GmbH, Abteilung X**, Hensslerstr. 20-30, D-32257 Bünde (enclaves pentru DE, AT, NL, BE, LU, ES, IT, PL, US, CA). Pentru toate celelalte țări contactați doar comercianții dvs. sau distribuitorii.
- ③ Grenzen za odcinkovanje in kmetovine: **www.revell-service.de** in **Revell GmbH, Abteilung X**, Hensslerstr. 20-30, D-32257 Bünde (enclaves para DE, AT, NL, BE, LU, ES, IT, PL, US, CA). Za vsa ostala področja kontaktirajte izključno s prodajalci ali distributerji.
- ③ Služba za pomoci stankam: **www.revell-service.de** ali **Revell GmbH, Abteilung X**, Hensslerstr. 20-30, D-32257 Bünde (enclaves para DE, AT, NL, BE, LU, ES, IT, PL, US, CA). Za všechny ostatní země kontaktujte výhradně svého obchodníka nebo prodejce.
- ③ Tilgjæring: **www.revell-service.de** og **Revell GmbH, Abteilung X**, Hensslerstr. 20-30, D-32257 Bünde (enclaves for DE, AT, NL, BE, LU, ES, IT, PL, US, CA). For alle andre land gælder det alene omhandler eller distributør.
- ③ Kundendienst: **www.revell-service.de** eller **Revell GmbH, Abteilung X**, Hensslerstr. 20-30, D-32257 Bünde (enclaves for DE, AT, NL, BE, LU, ES, IT, PL, US, CA). For øvrige lander vær god kontakta återförsäljaren eller distributören.
- ③ Müşteri Hizmetleri: **www.revell-service.de** veya **Revell GmbH, Abteilung X**, Hensslerstr. 20-30, D-32257 Bünde (enclaves için sadece satıcınıza veya distribütörünüze başvurun.
- ③ Nicht b  
③ Parts  
③ Pieces  
③ Part  
③ Pegas

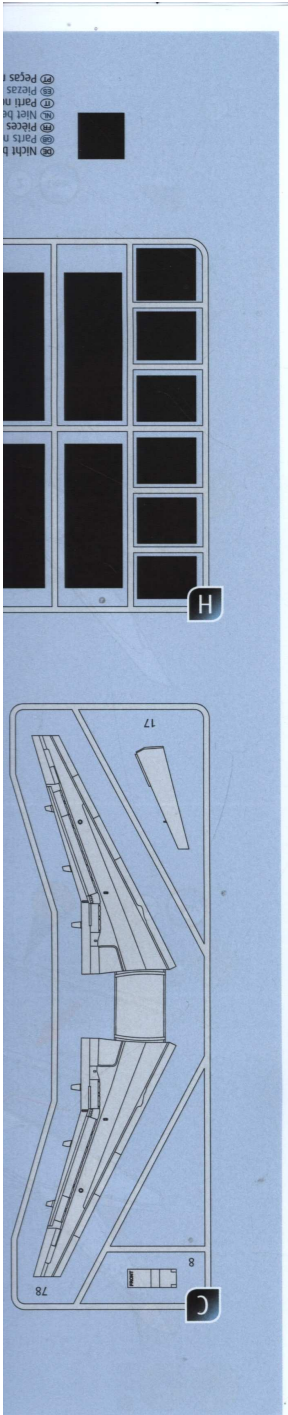
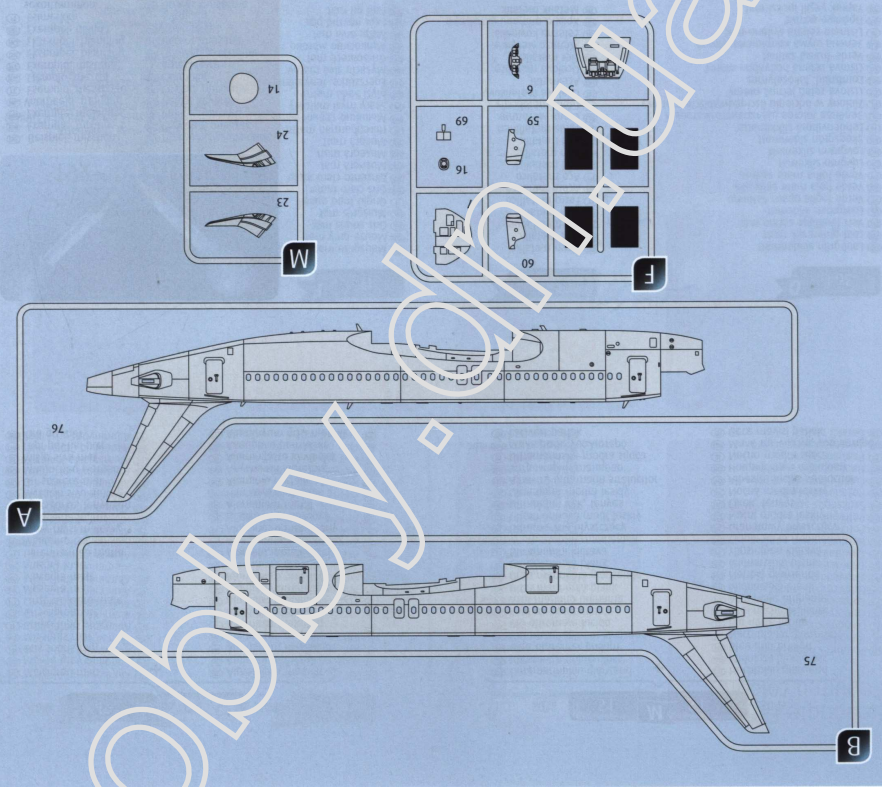







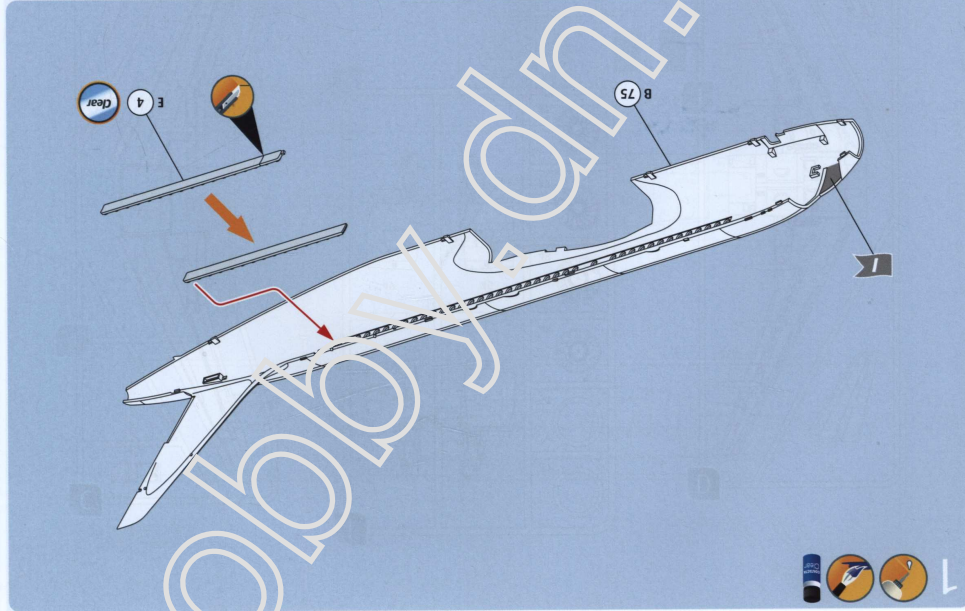
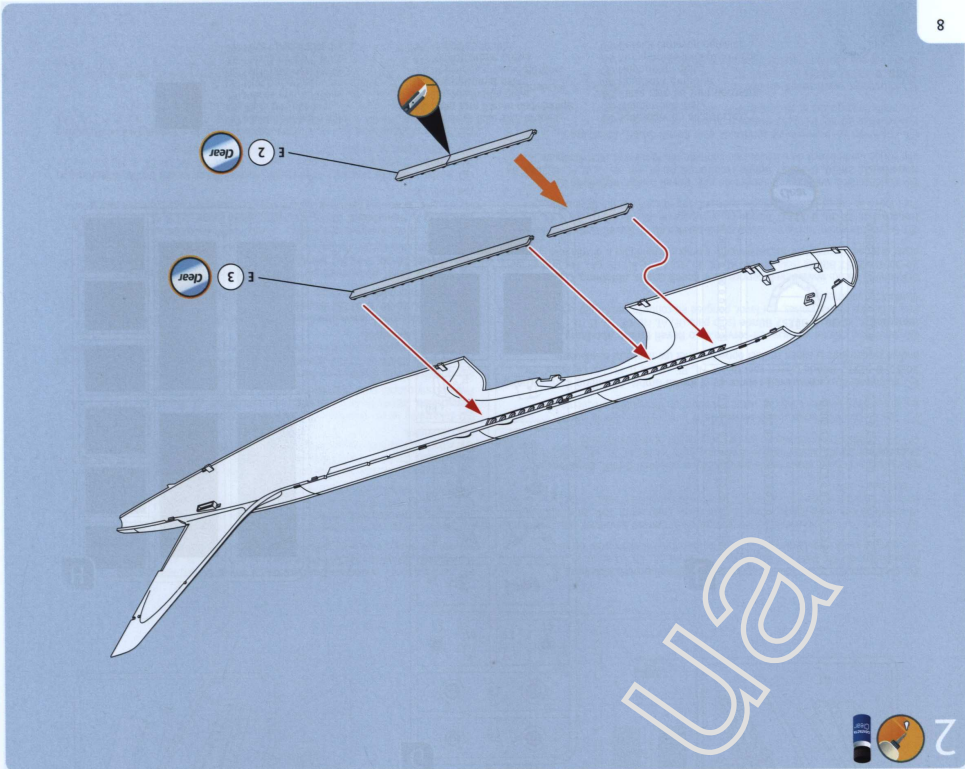
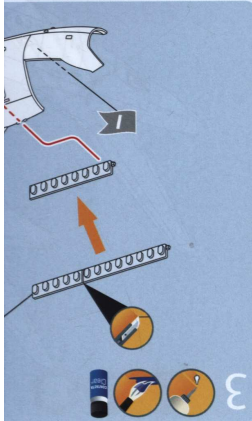
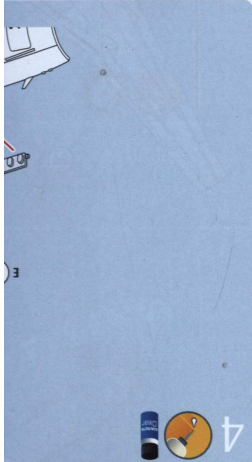
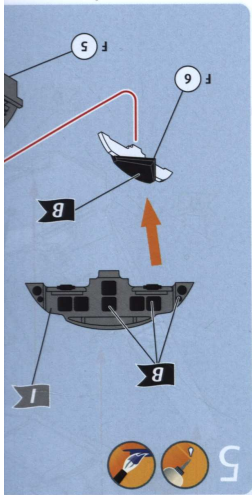



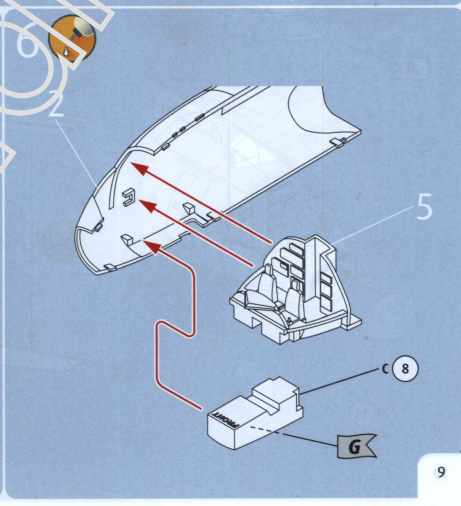
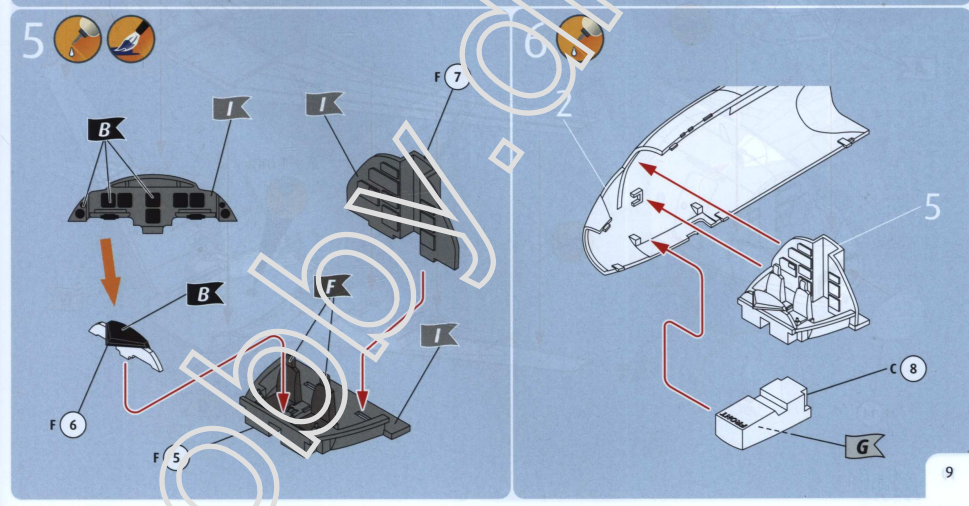
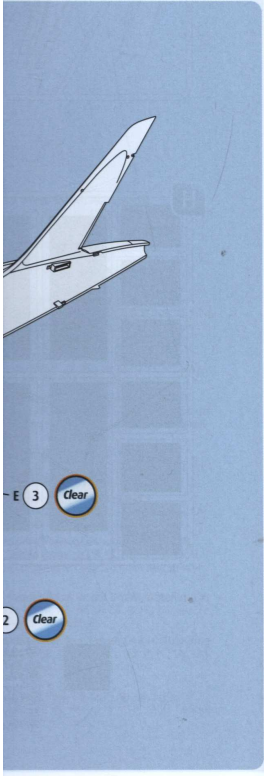
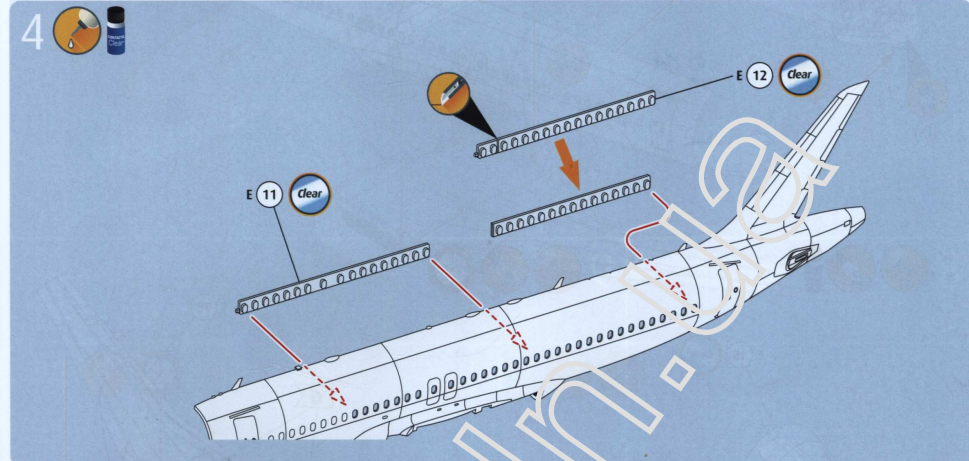
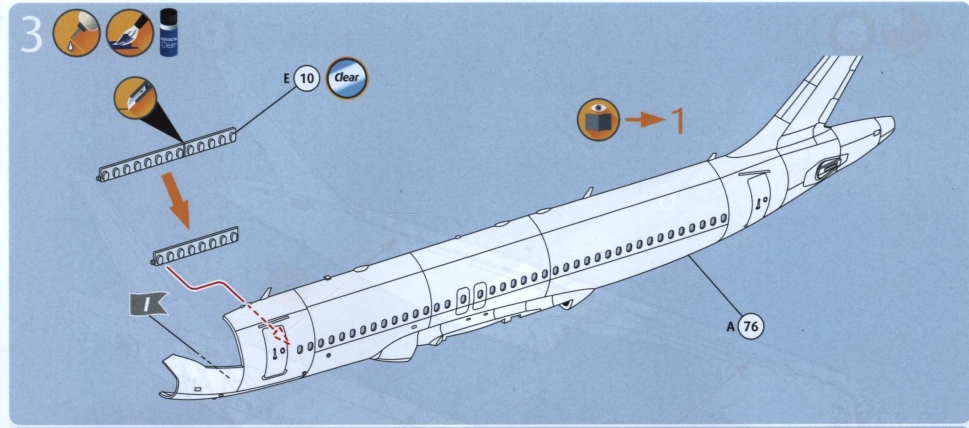
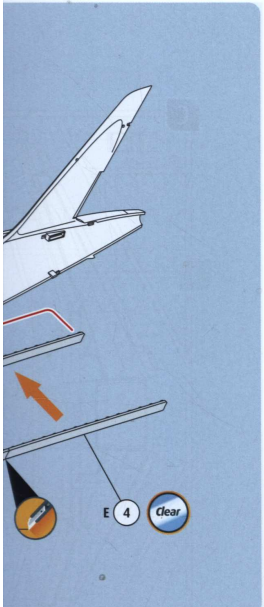



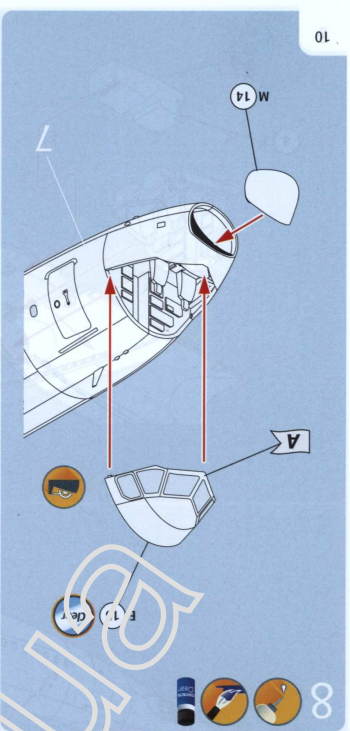
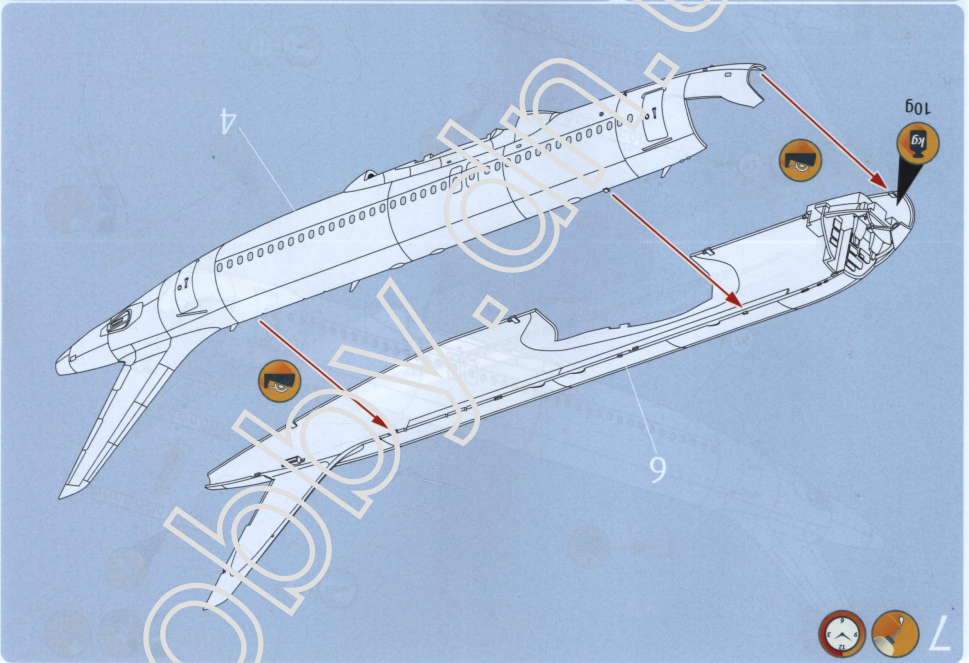
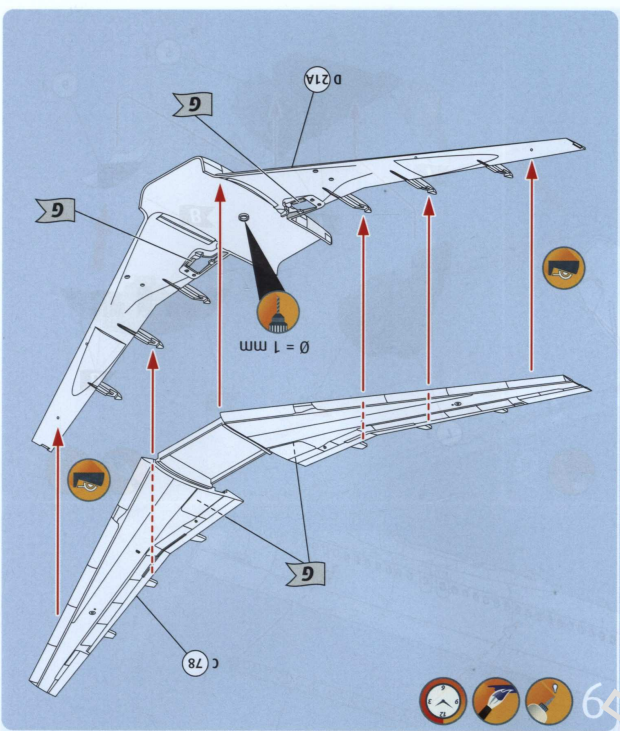
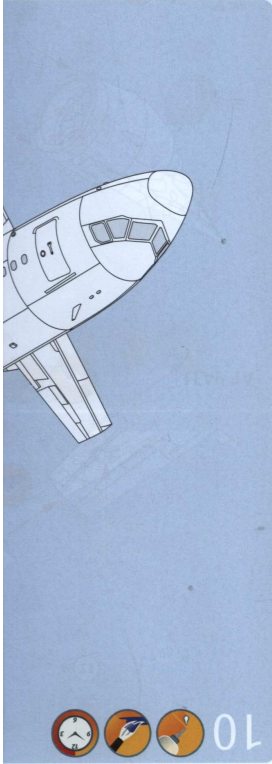
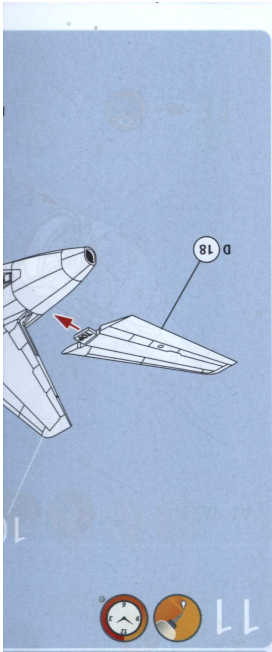



10 



11 



12 

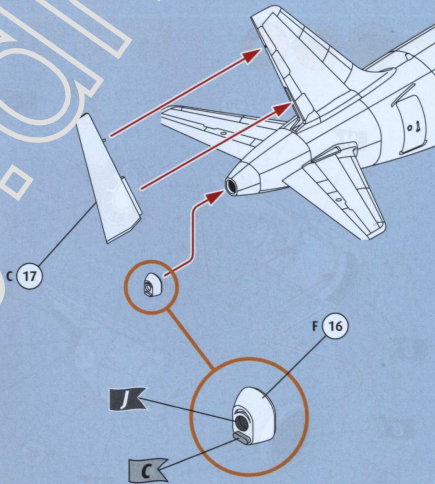



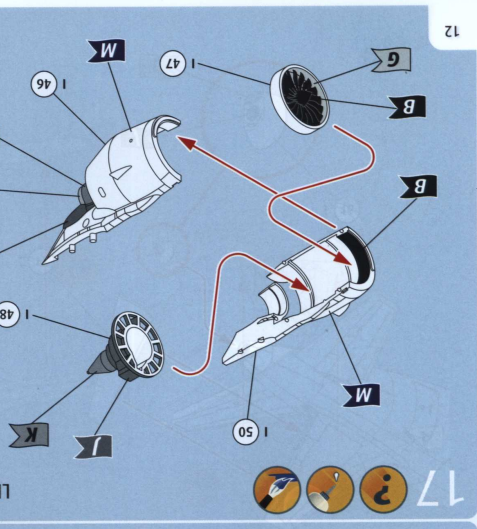
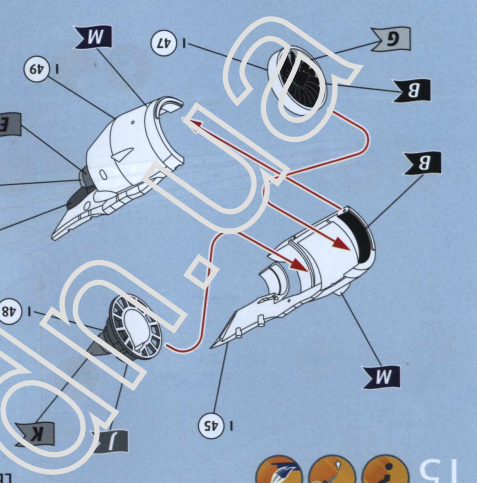
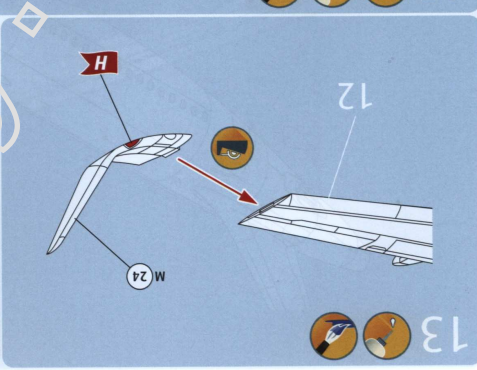
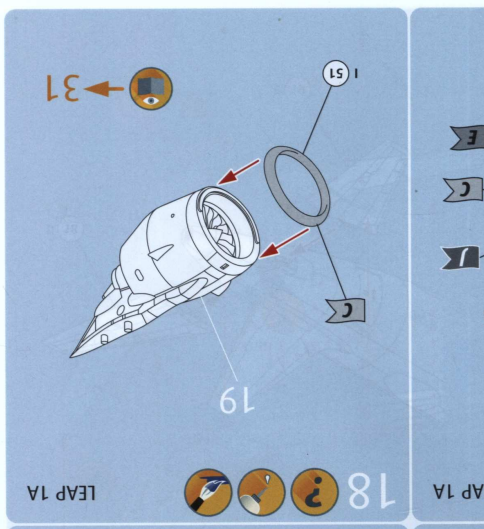
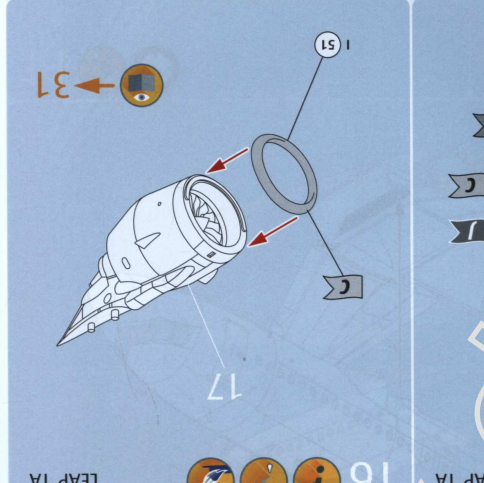
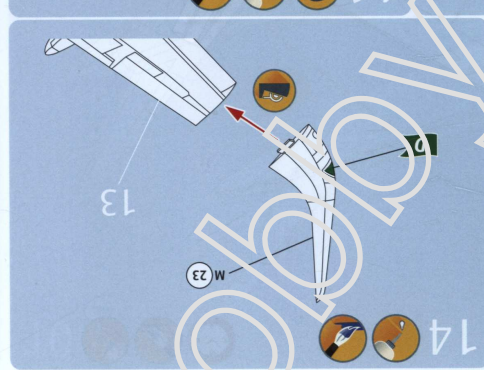
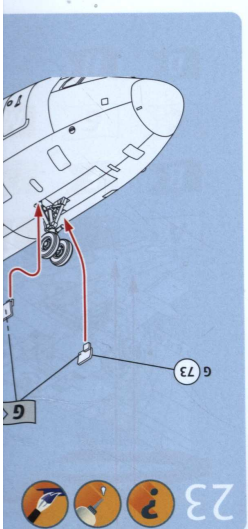
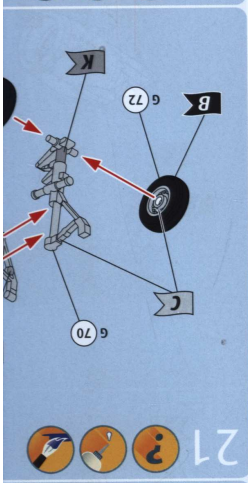
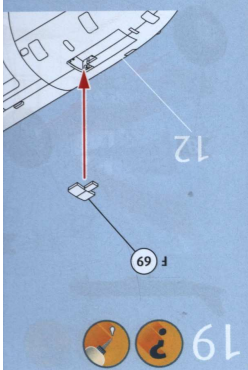



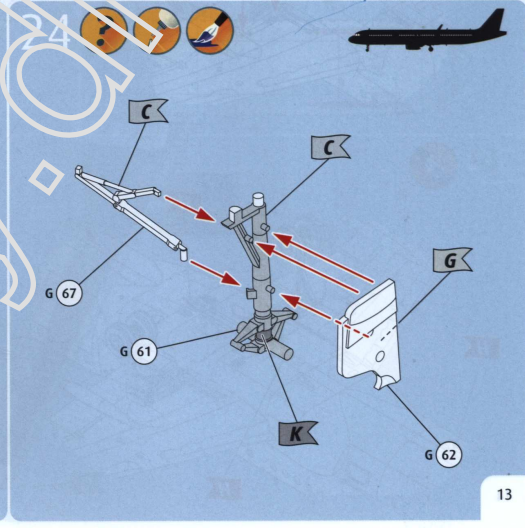
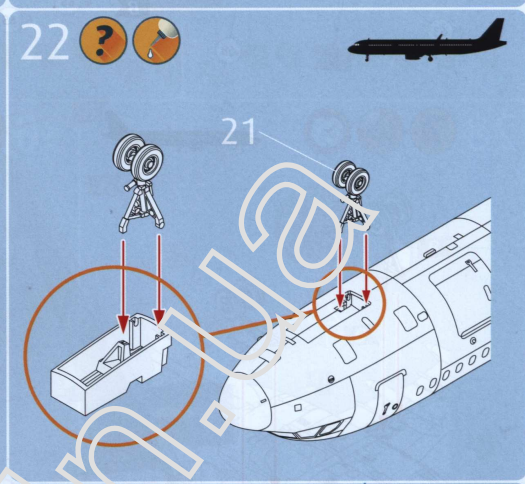
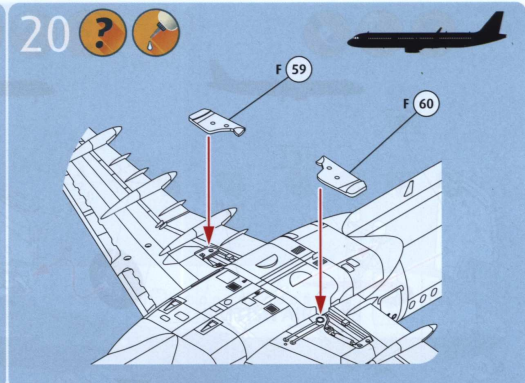
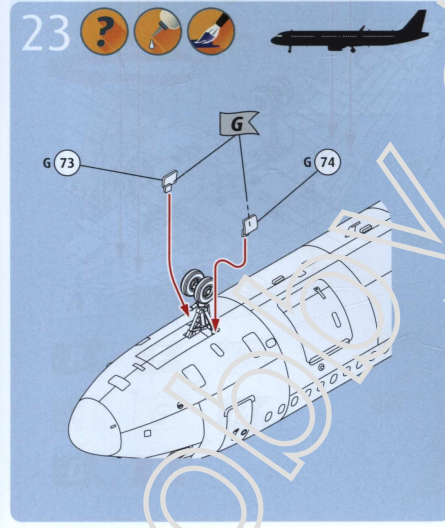
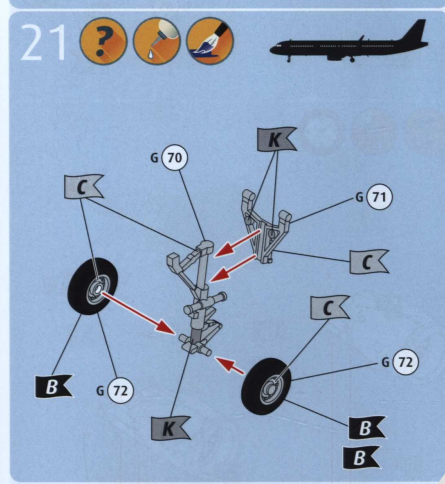
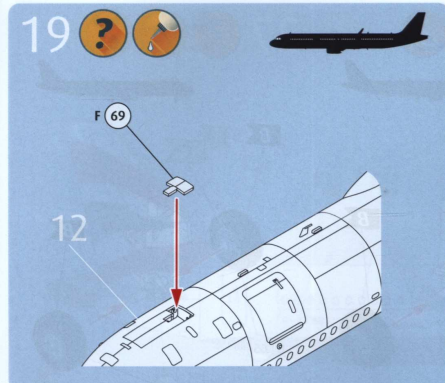
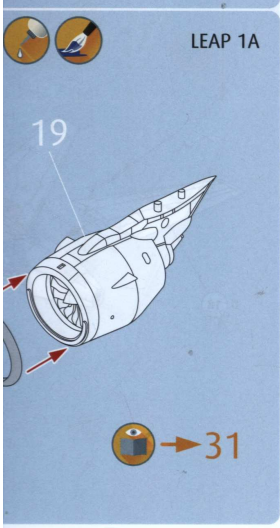
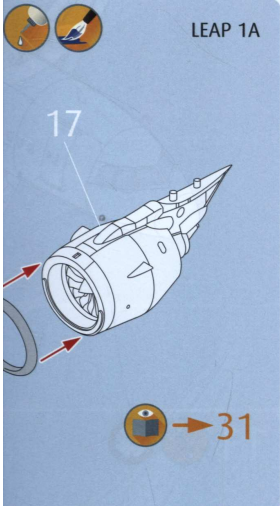
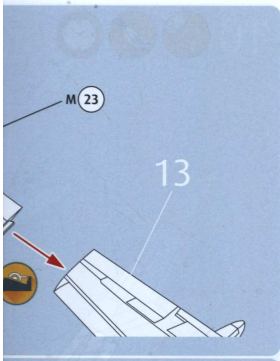



<b>H</b>	<b>D</b>
<b>G</b>	<b>C</b>
<b>F</b>	<b>B</b>
<b>E</b>	<b>A</b>

Assembly diagrams for the tail section of the model airplane, showing the attachment of various parts like the stabilizer and rudder.

Diagram 29: Attaching the fuselage to the landing gear assembly. Red arrows indicate the insertion points for the fuselage into the gear structure.

Diagram 14: Attaching the wing to the fuselage. Red arrows point to the wing root and fuselage connection points.

Diagram 25: Attaching the landing gear to the fuselage. Red arrows show the gear being pushed into the fuselage's gear bay.

Diagram 28: Attaching the landing gear to the fuselage. Red arrows show the gear being pushed into the fuselage's gear bay.

Diagram 26: Attaching the landing gear to the fuselage. Red arrows show the gear being pushed into the fuselage's gear bay.



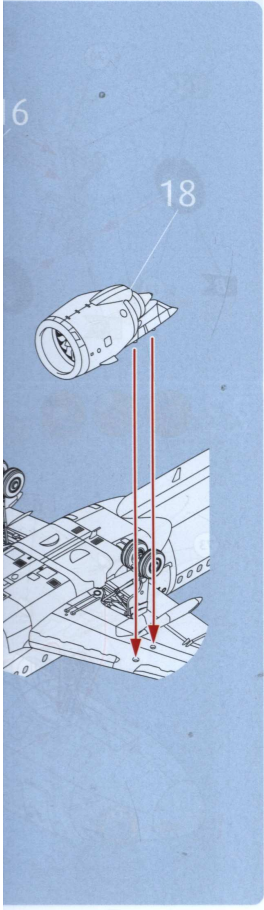
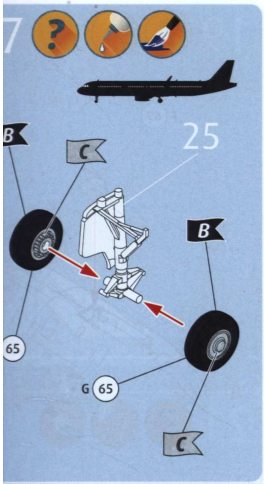





Airbus A320neo British Airways



- |          |          |          |
|----------|----------|----------|
| <b>A</b> | <b>E</b> | <b>J</b> |
| <b>B</b> | <b>F</b> | <b>K</b> |
| <b>C</b> | <b>G</b> | <b>M</b> |
| <b>D</b> | <b>H</b> |          |