



RFM
OVERFIELD MODEL

1/35 SCALE

5025

MILITARY MINIATURE SERIES

TIGER I

W/ FULL INTERIOR & CLEAR PARTS OF THE HULL & TURRET

ASSEMBLY ICONS



OPTIONAL
选择



CEMENT
膠水



DO NOT CEMENT
不使用膠水



INSTANT CEMENT
瞬間接著劑



BEND
彎折



MAKE 2
製作2組



OPEN HOLE
鑽孔



REMOVE
切除



BE CAREFUL
注意



APPLY DECAL
貼上水貼紙

CAUTION!

Read carefully and fully understand the instructions before commencing assembly.
Supervising adult should also read the instructions if a child assembles the model.
When you used glue or paint, do not use near a naked flame, and use in a well-ventilated room.
When assembling this kit, tools including knives are used. Extra care should be taken to avoid personal injury.
Read and follow the instructions supplied with paints and/ or cement. Use plastic cement and paints only.
Keep out of reach of small children. Children must not be allowed to suck any part, or pull vinyl bag over the head.

在裝配前仔細閱讀說明並完全理解。小孩裝配時需成人看護且需仔細閱讀說明。
使用膠水和油漆時，應遠離火源並打開窗戶保持空氣流通。
製作時請格外注意工具刀和零件的鋒利尖銳部分，避免對身體造成傷害。
在使用膠水和油漆前仔細閱讀注意事項，按照說明正確使用膠水和油漆。
請將本品放在兒童接觸不到的地方，套件中的塑膠包裝袋會對兒童造成窒息的危險。

The assembly of this instructions is based on the No.S04 vehicle.

The No.1331 vehicle and the clear parts are optional. We use the color of the line to distinguish the type of assembly.

The No.1331 is green lines, The clear parts is blue lines.

Please read the instructions carefully to select the type before assembly.

本产品说明书的装配步骤是基于No.S04的车辆。No.1331车辆和透明壳体零件选装。我们用线条的颜色来区分装配的类型。

No.1331为绿色线条，透明壳体零件为蓝色线条。

请在组装前仔细阅读说明书以选择适合的装配类型。

STEP 1

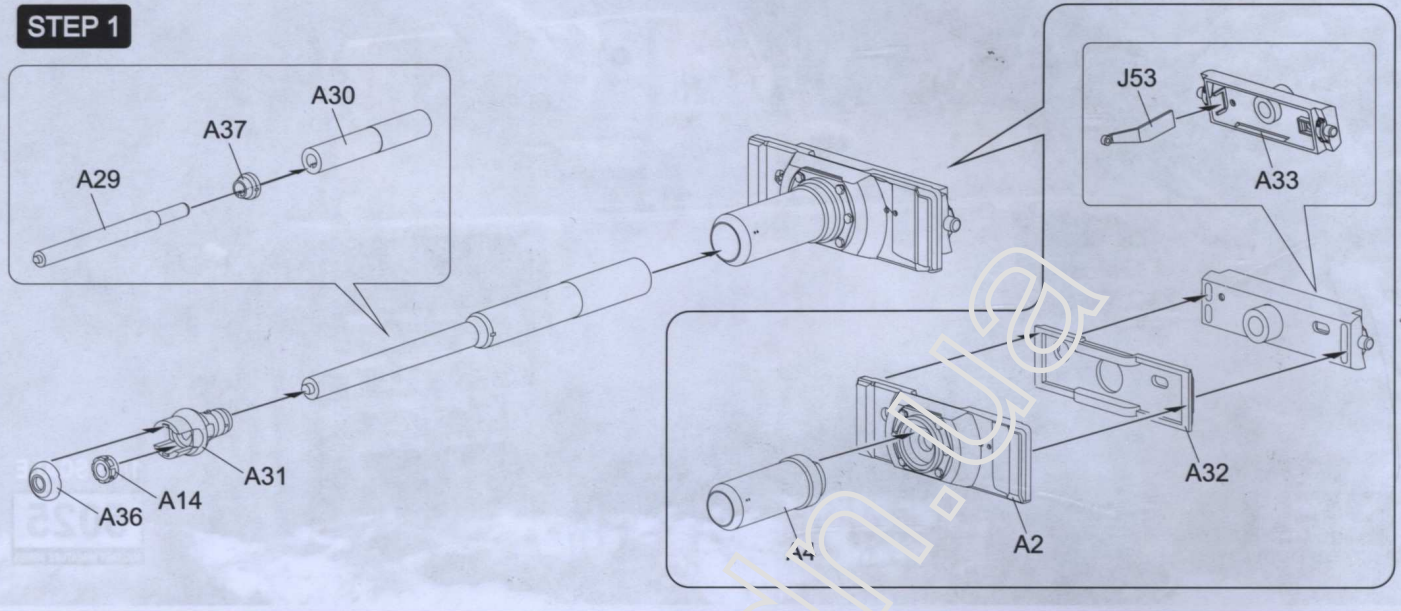

Apply for the No.1331 use only
仅适用于NO.1331

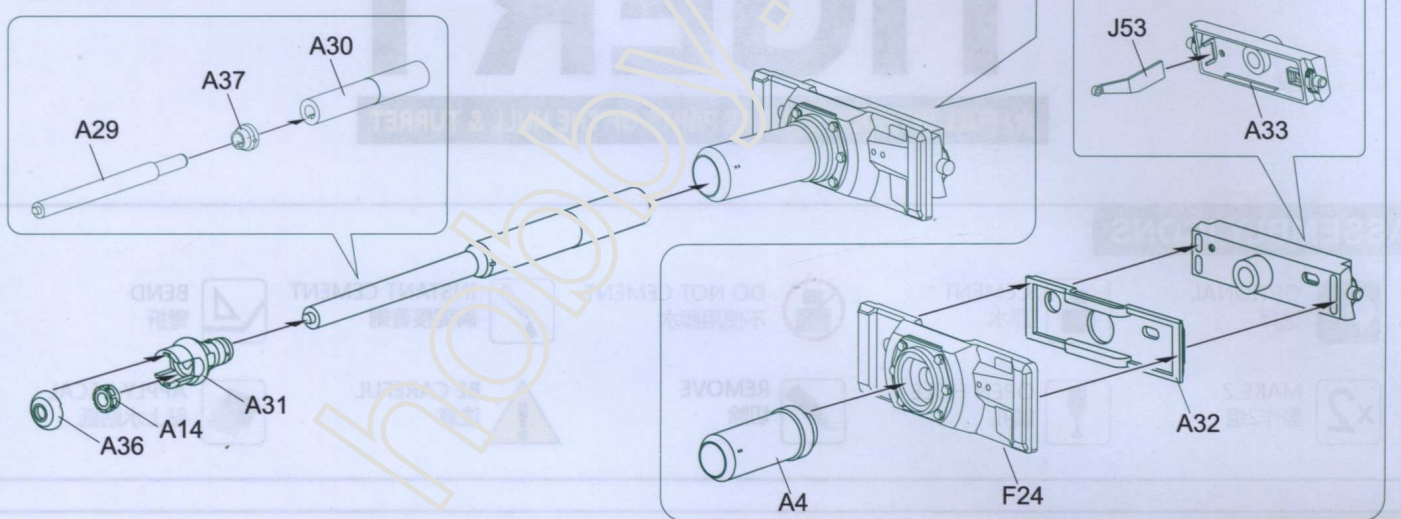

STEP 2

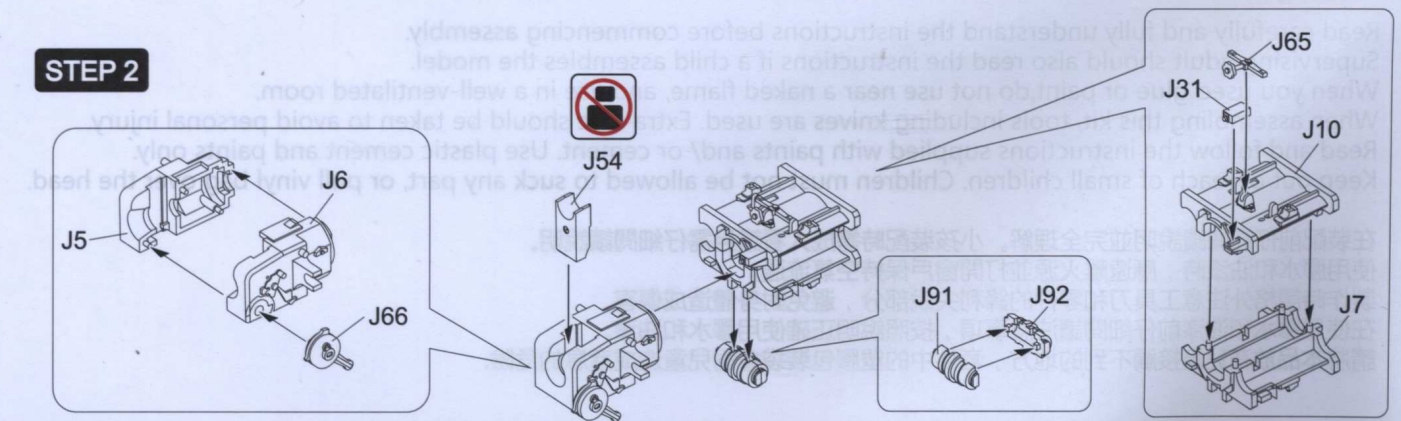

STEP 3

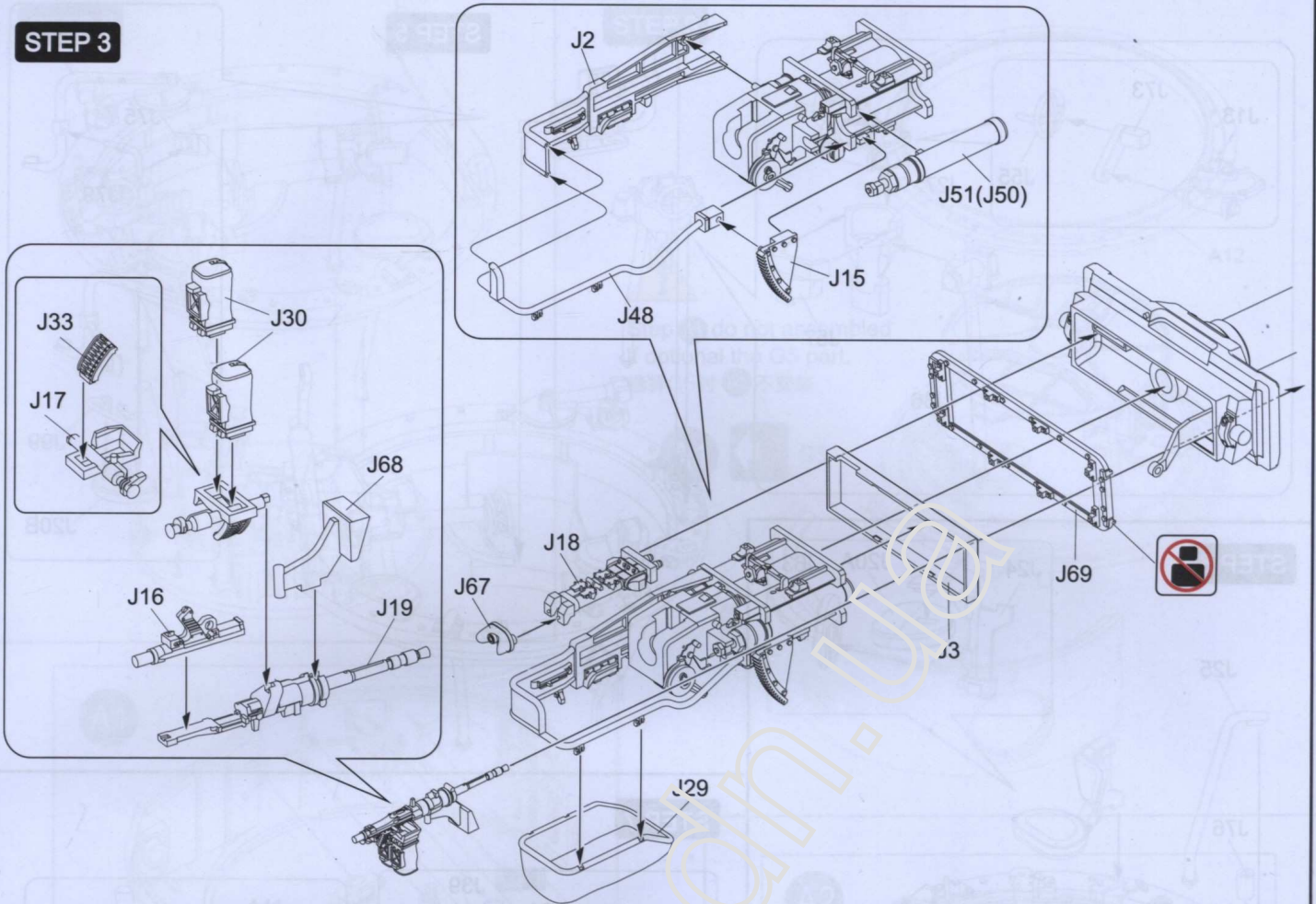

STEP 4

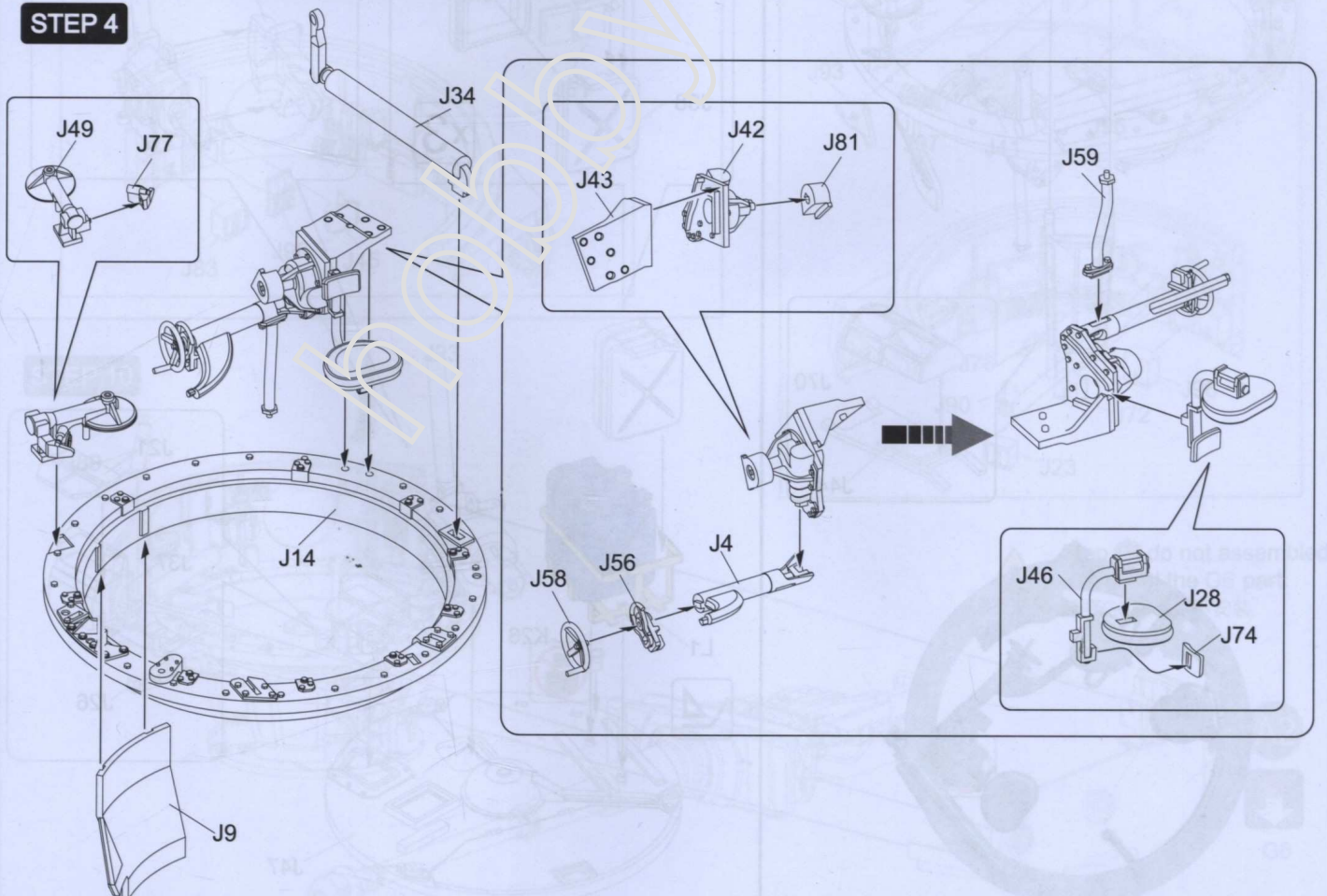

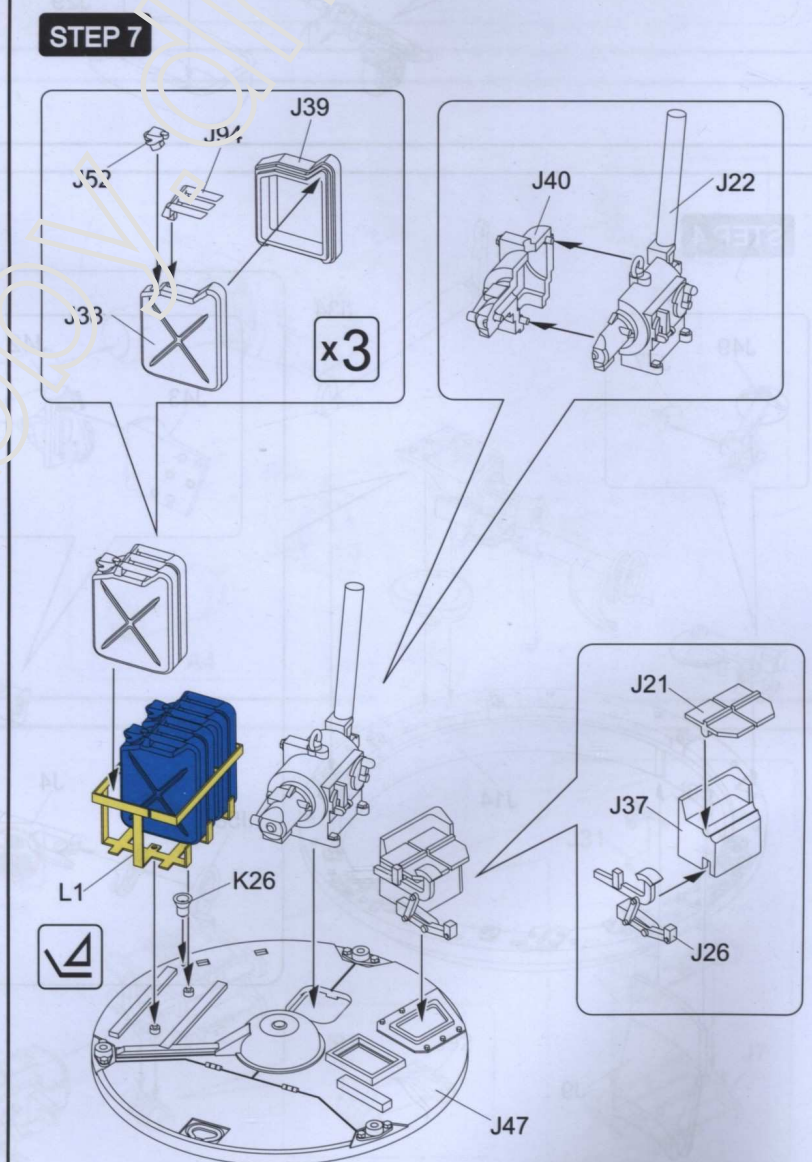
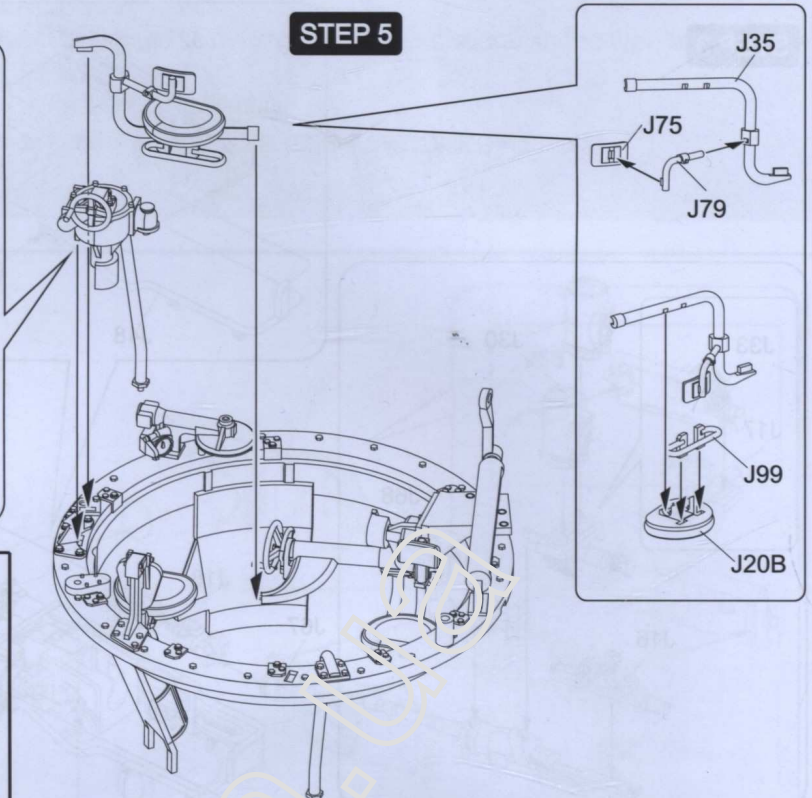
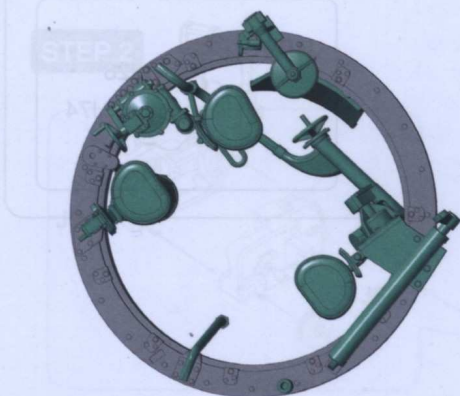
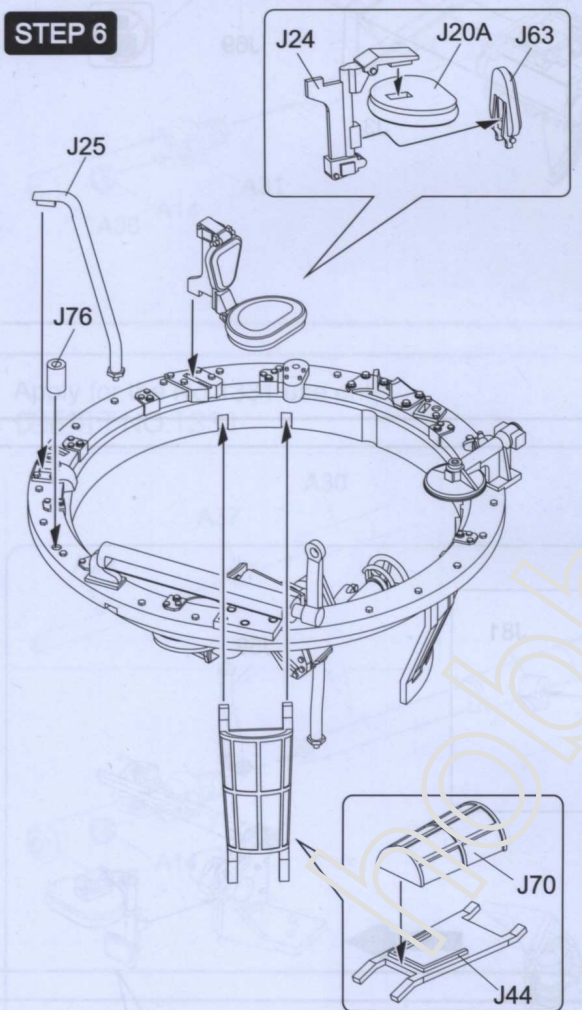
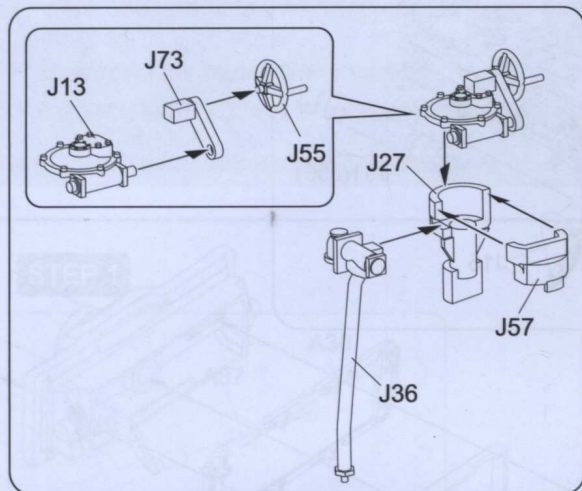

STEP 8

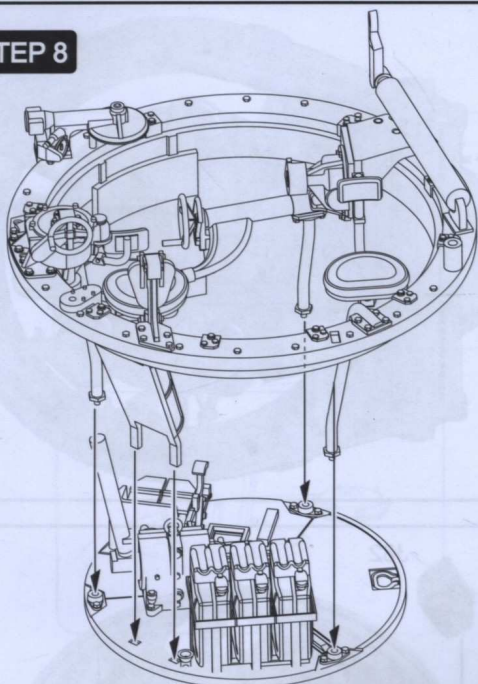

STEP 9



Step A1 do not assembled
if optional the G5 part.
选择G5时 A1 不安装

A1



G5

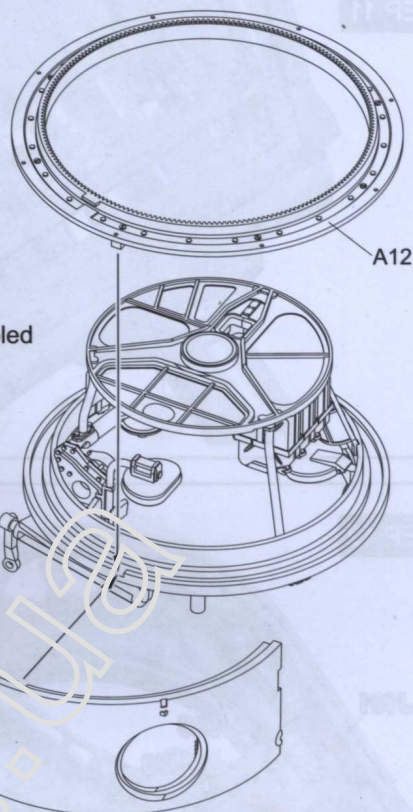

A1

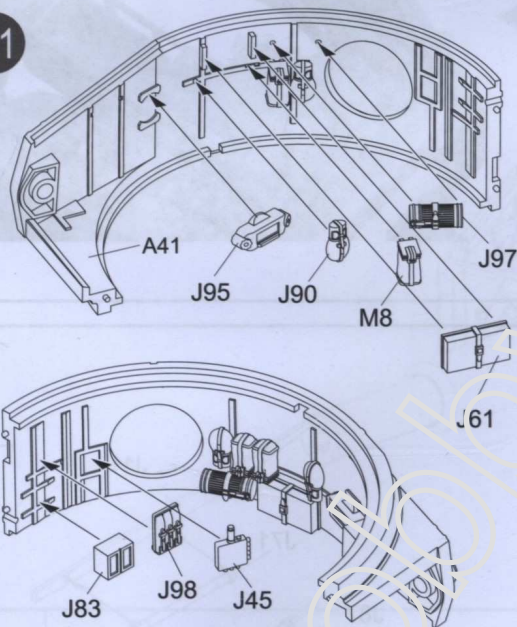

A2

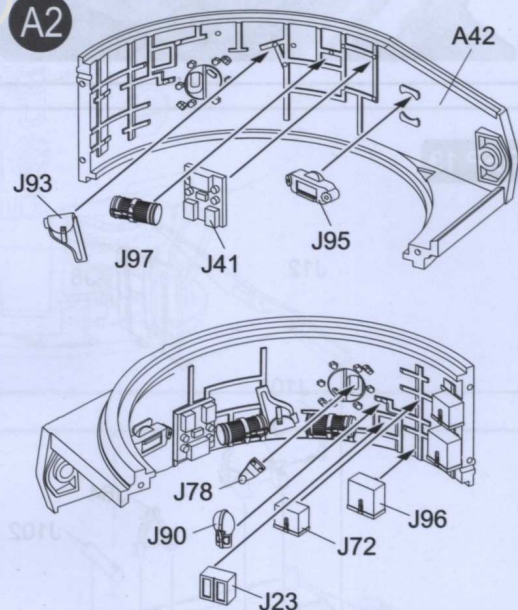

STEP 10

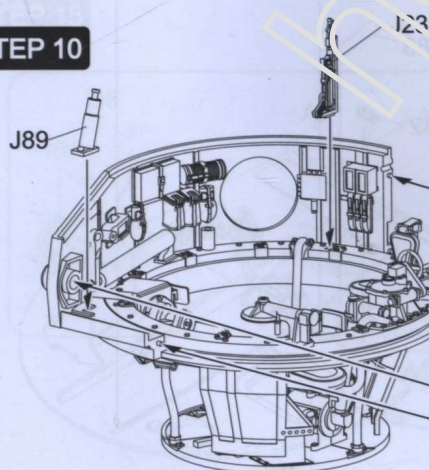

Step A2 do not assembled
if optional the G6 part.
选择G6时 A2 不安装

A2



G6

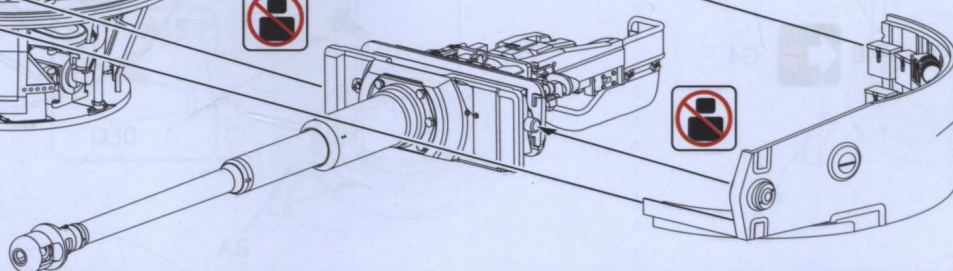

STEP 11

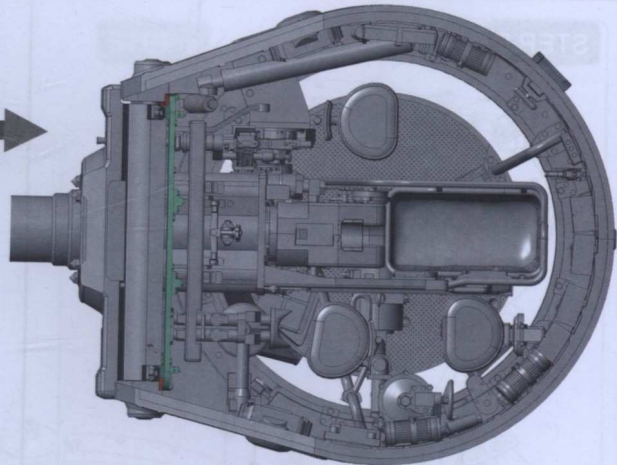
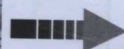
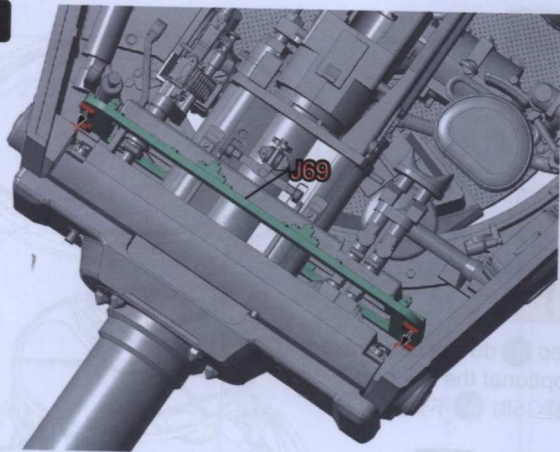

STEP 12

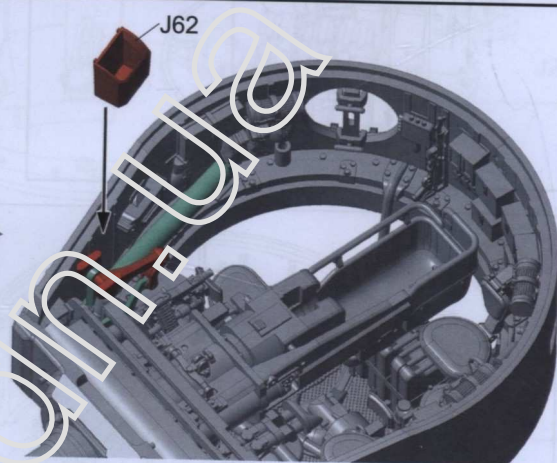
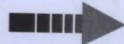
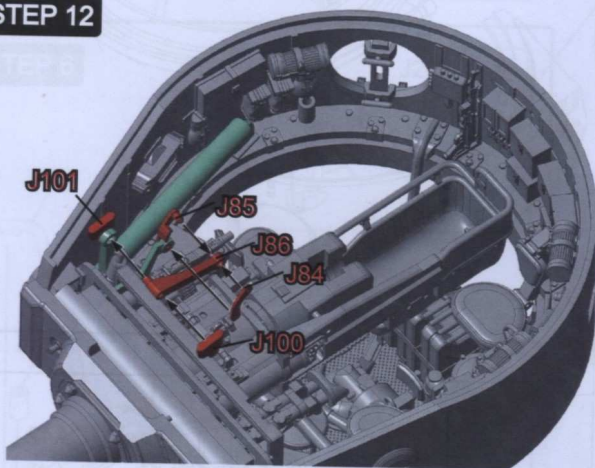

STEP 13

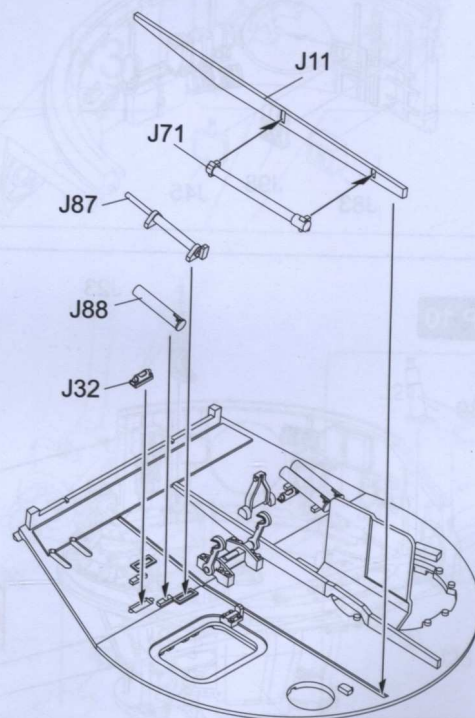
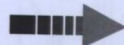
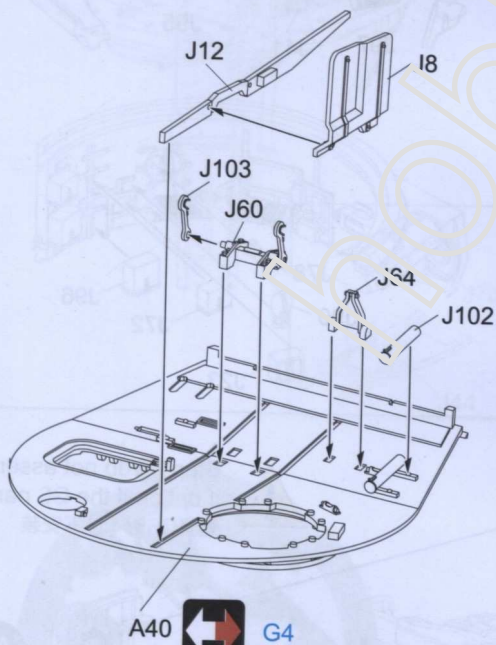

STEP 14

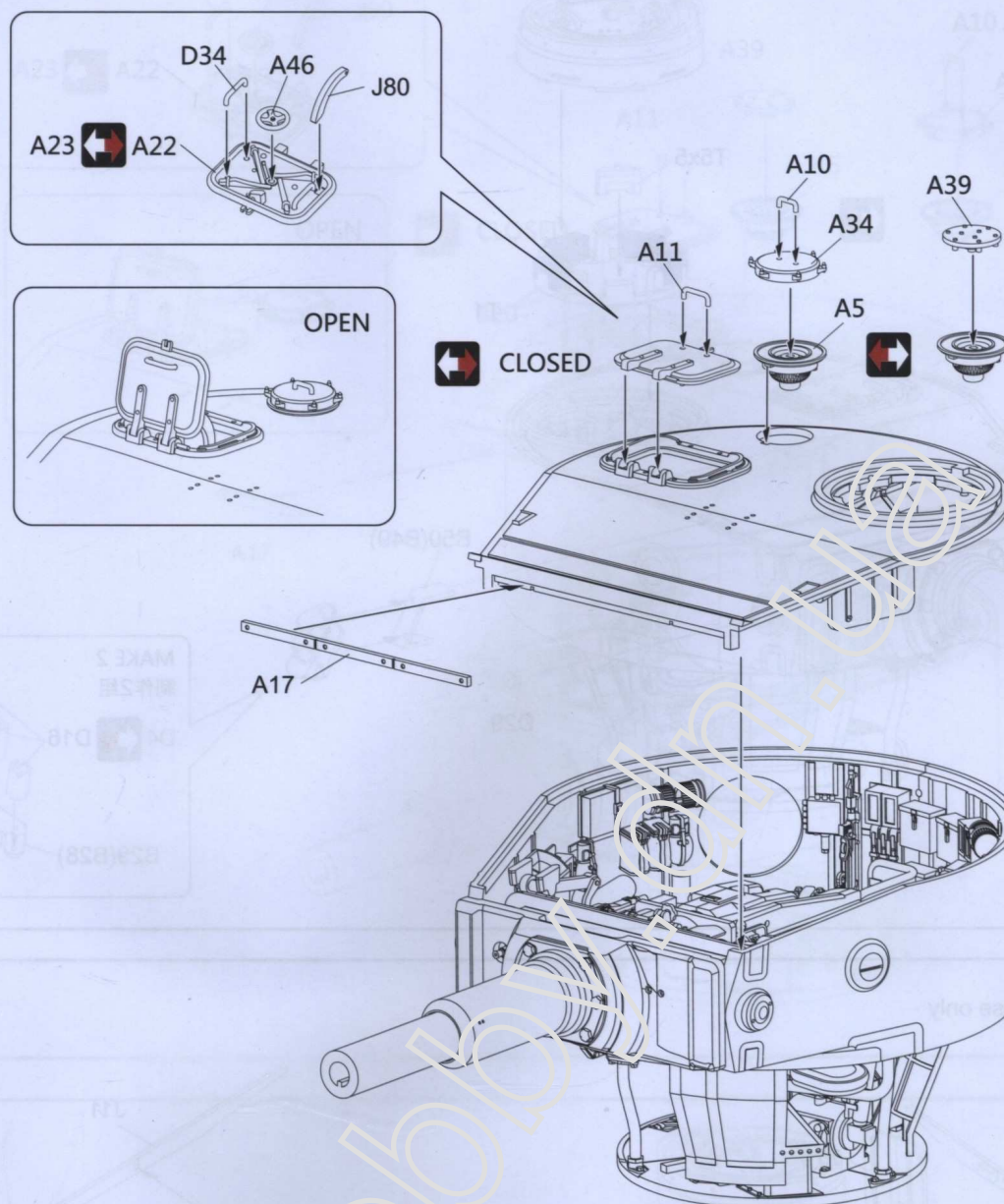

STEP 15

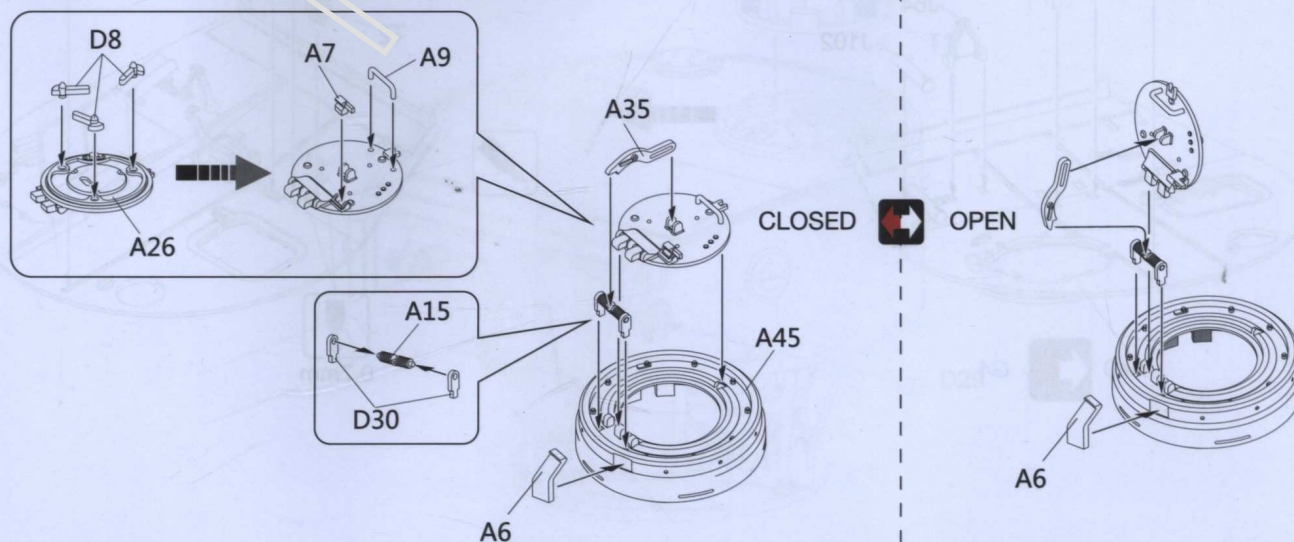

STEP 16

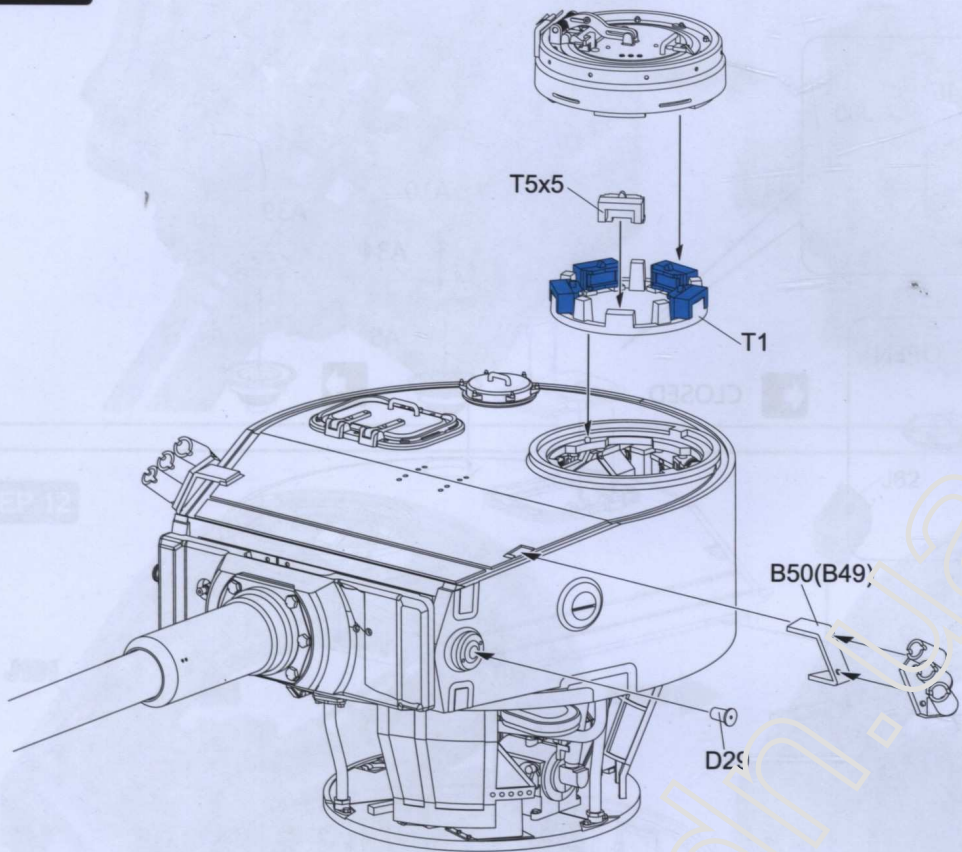

Apply for the NO.1331 use only
仅适用于NO.1331

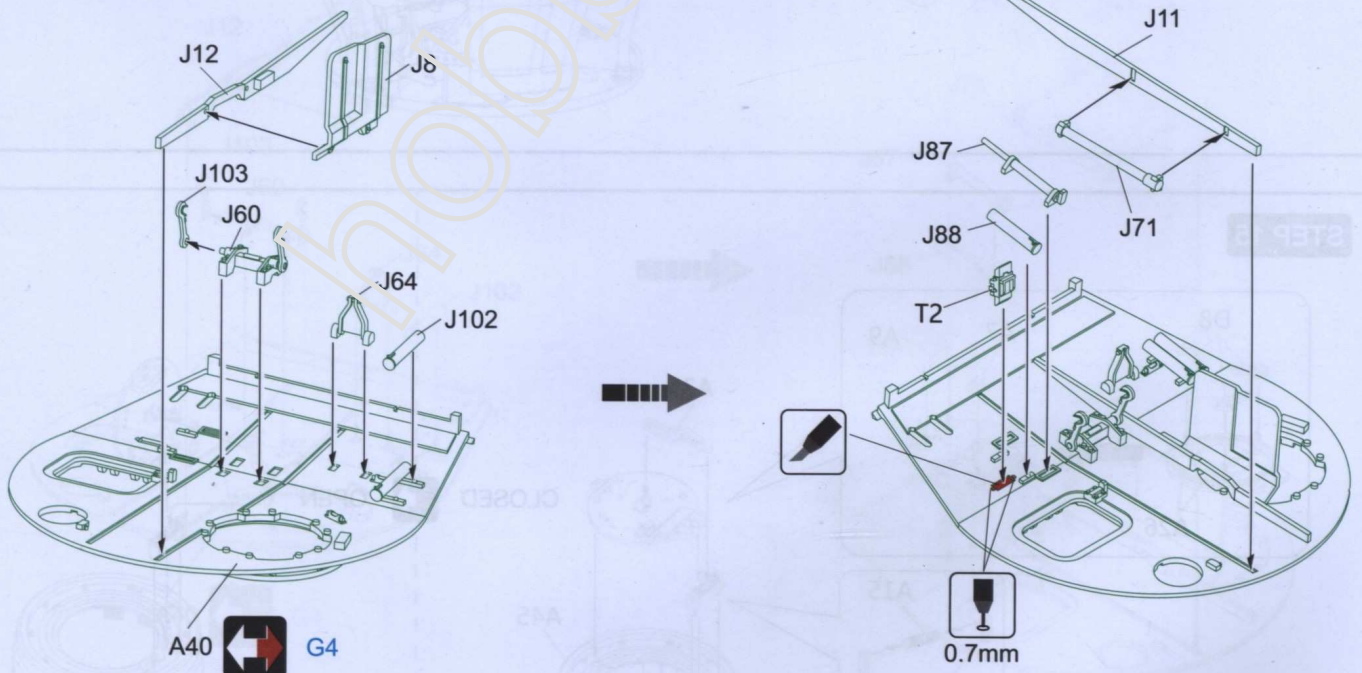

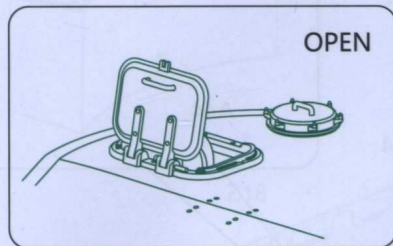
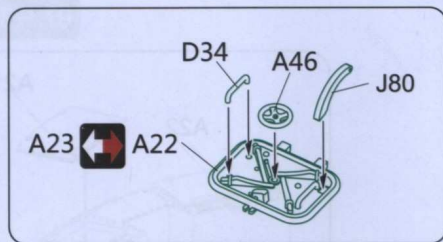

← CLOSED

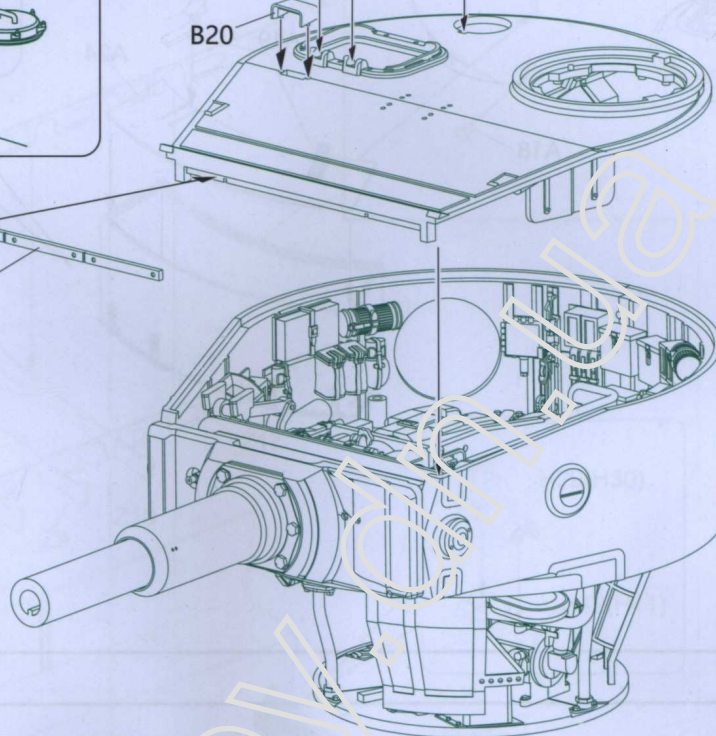
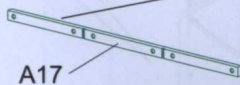
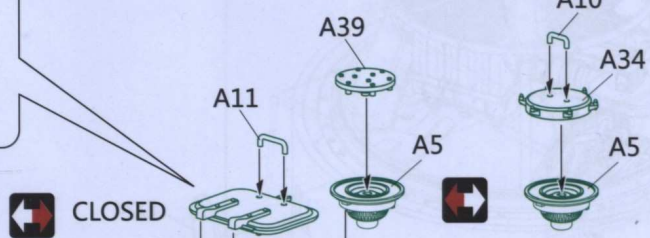

STEP 18

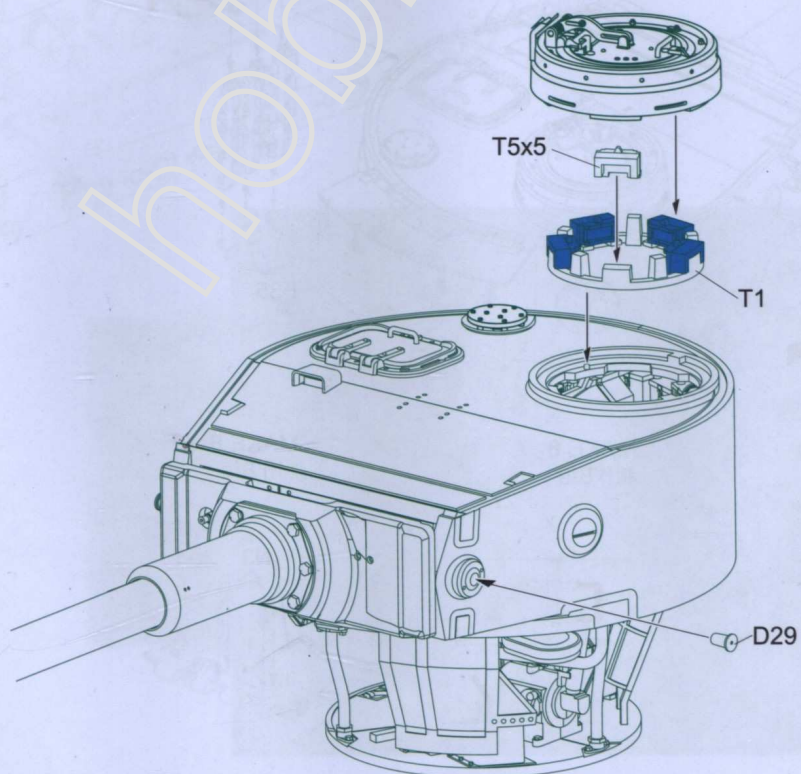

STEP 17

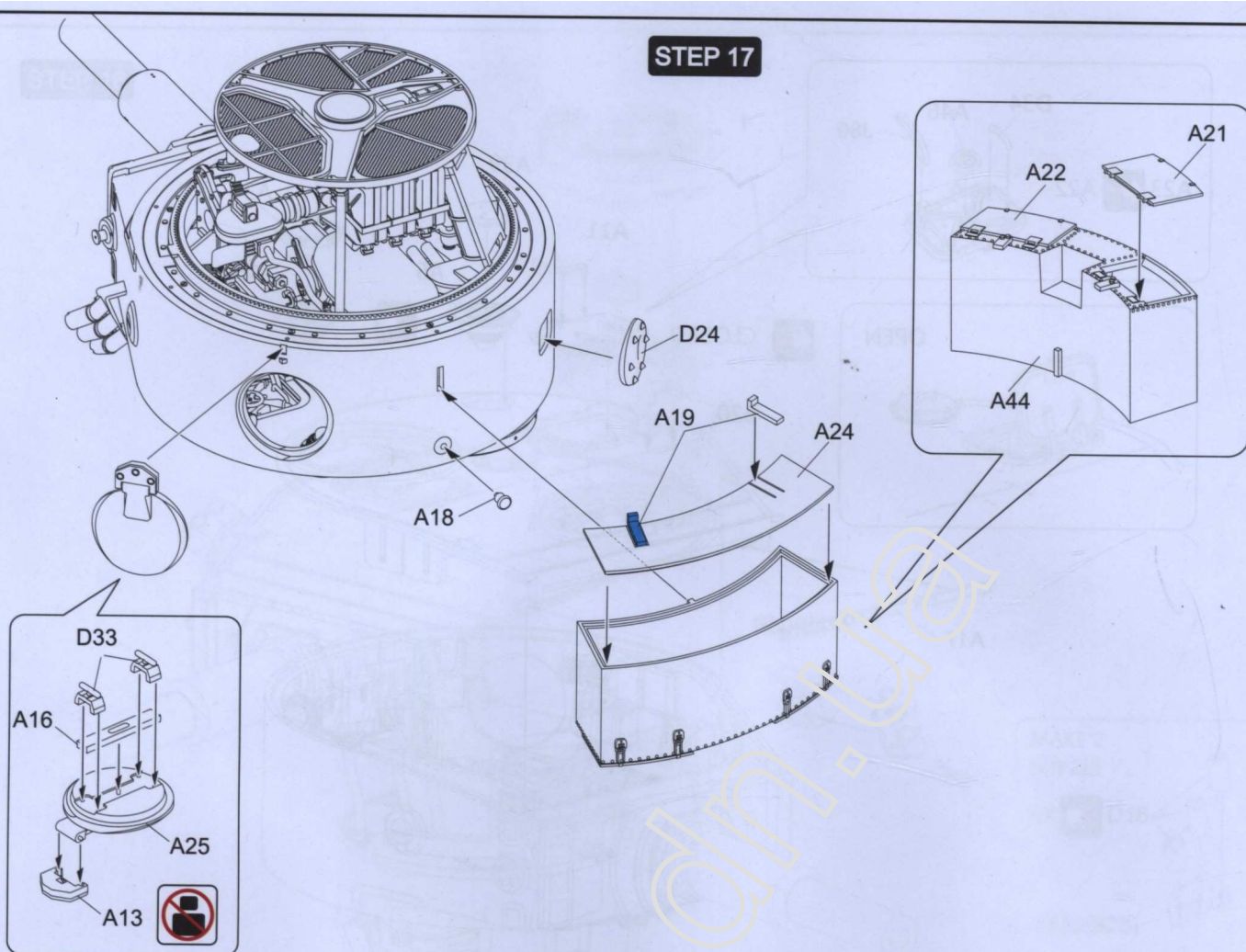

STEP 18

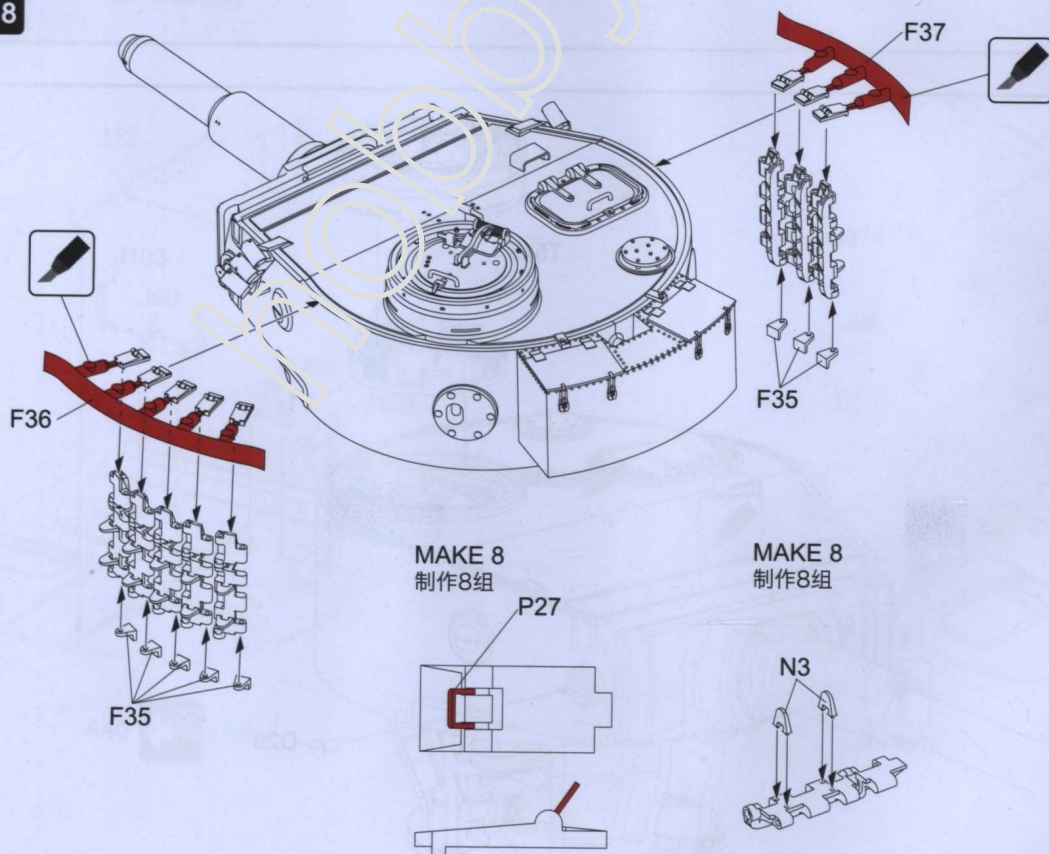

STEP 19

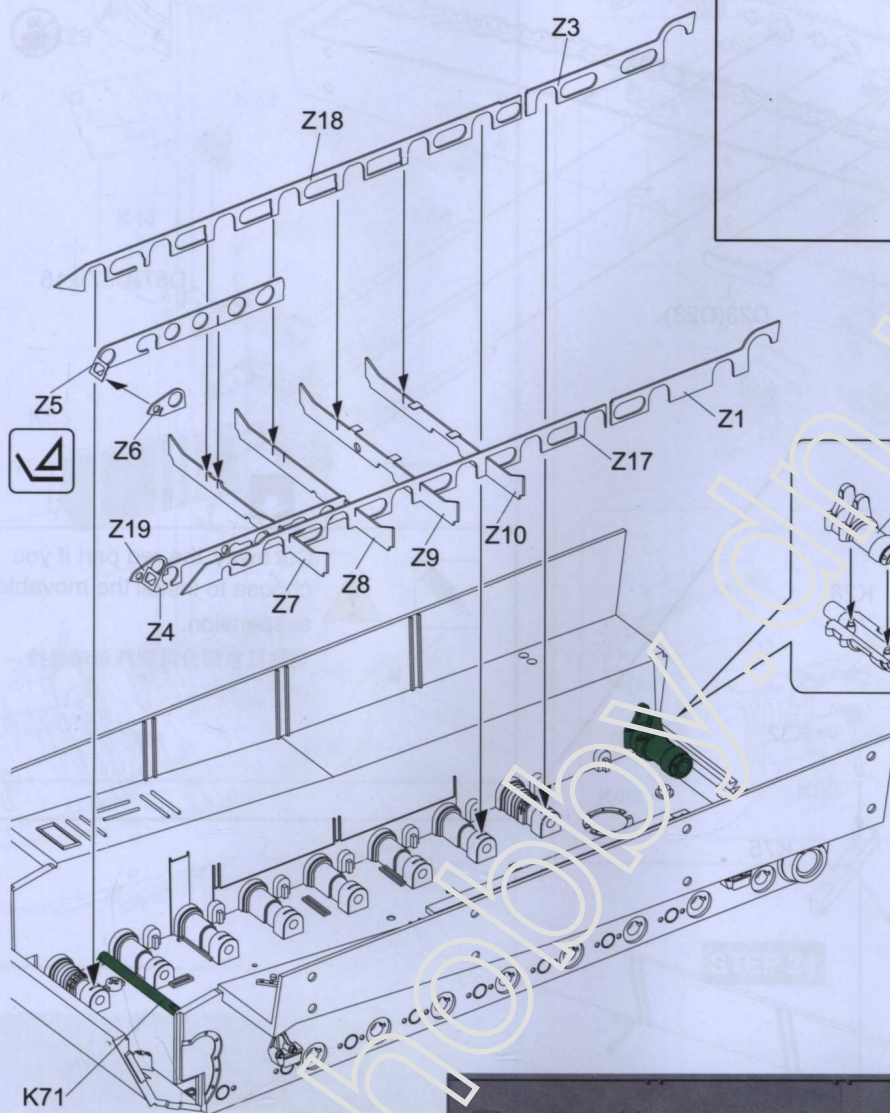

STEP 20

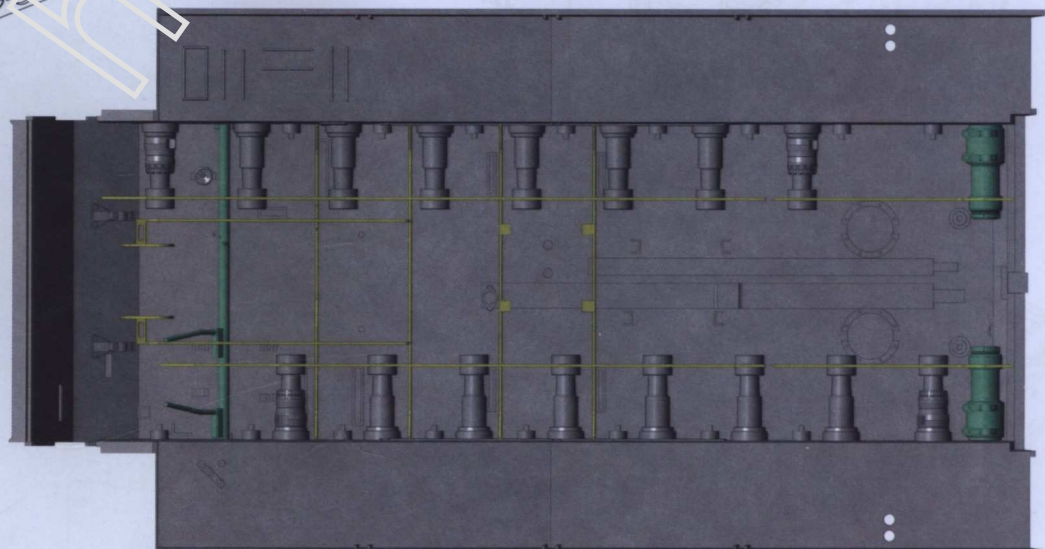
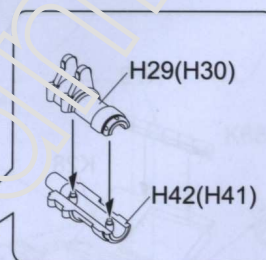
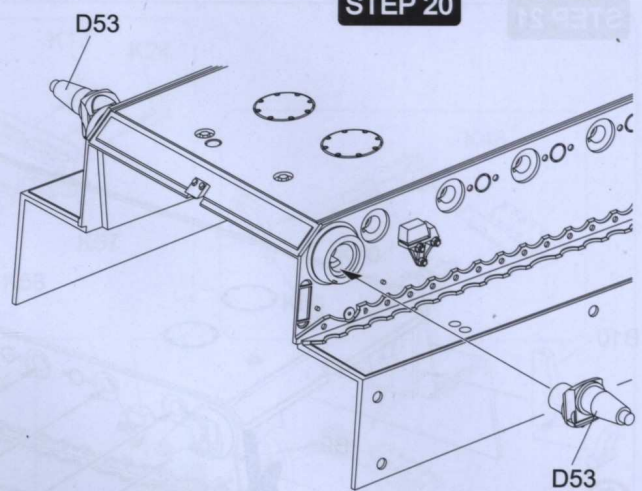

K79

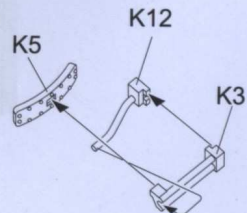
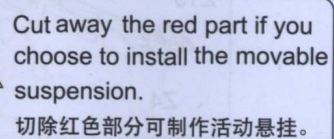
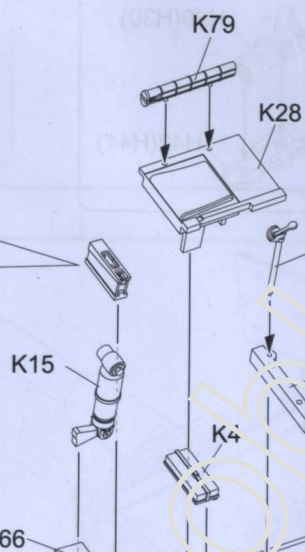

STEP 23

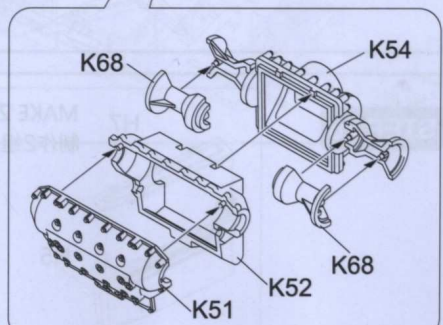
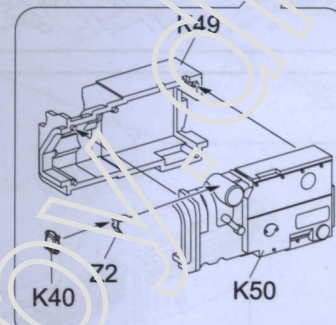
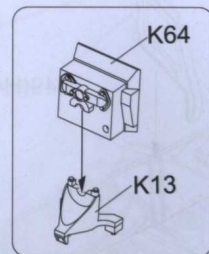
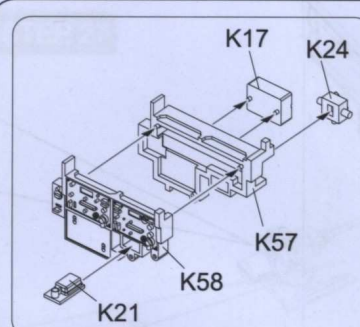
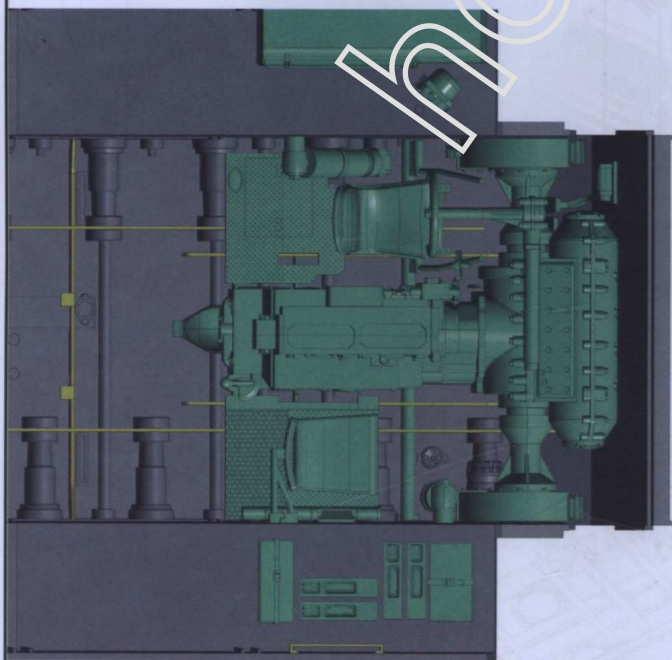
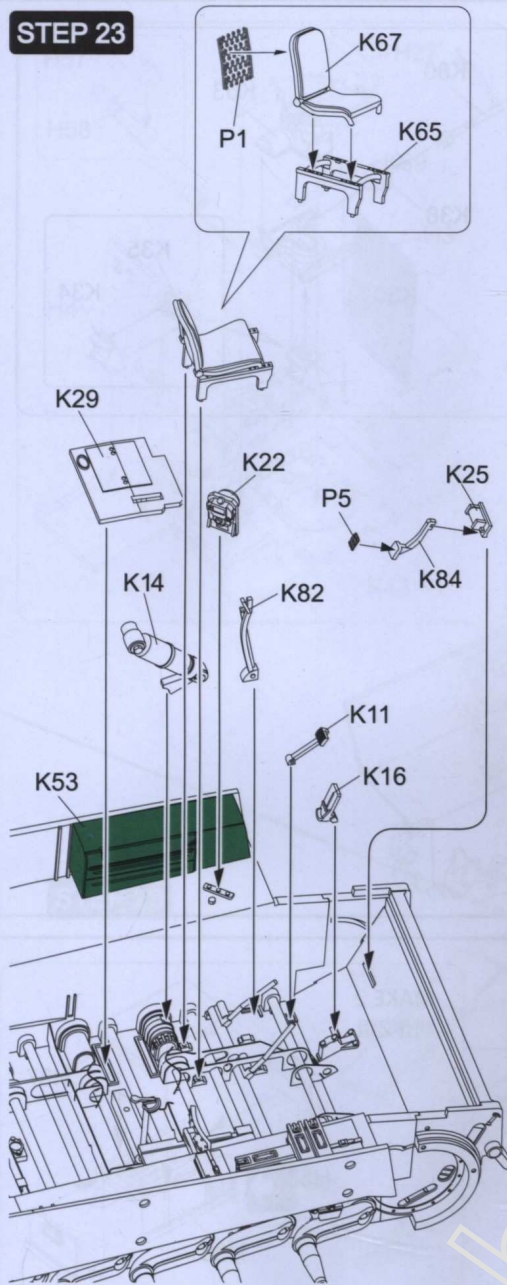

STEP 24

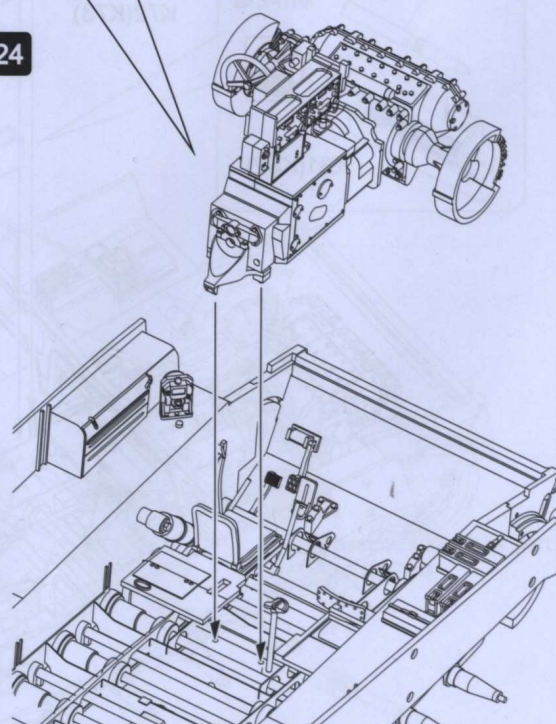

STEP 25

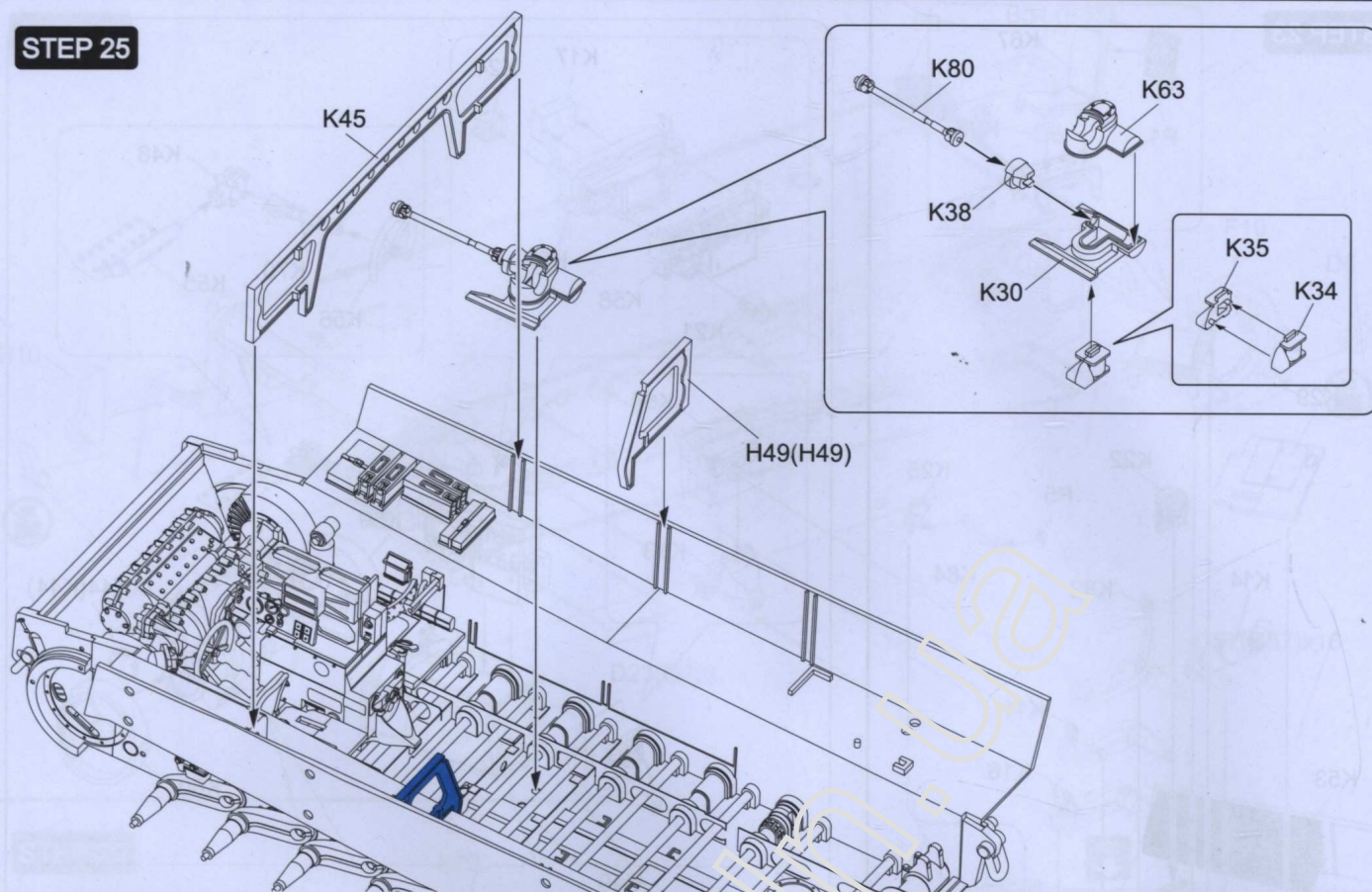

STEP 26

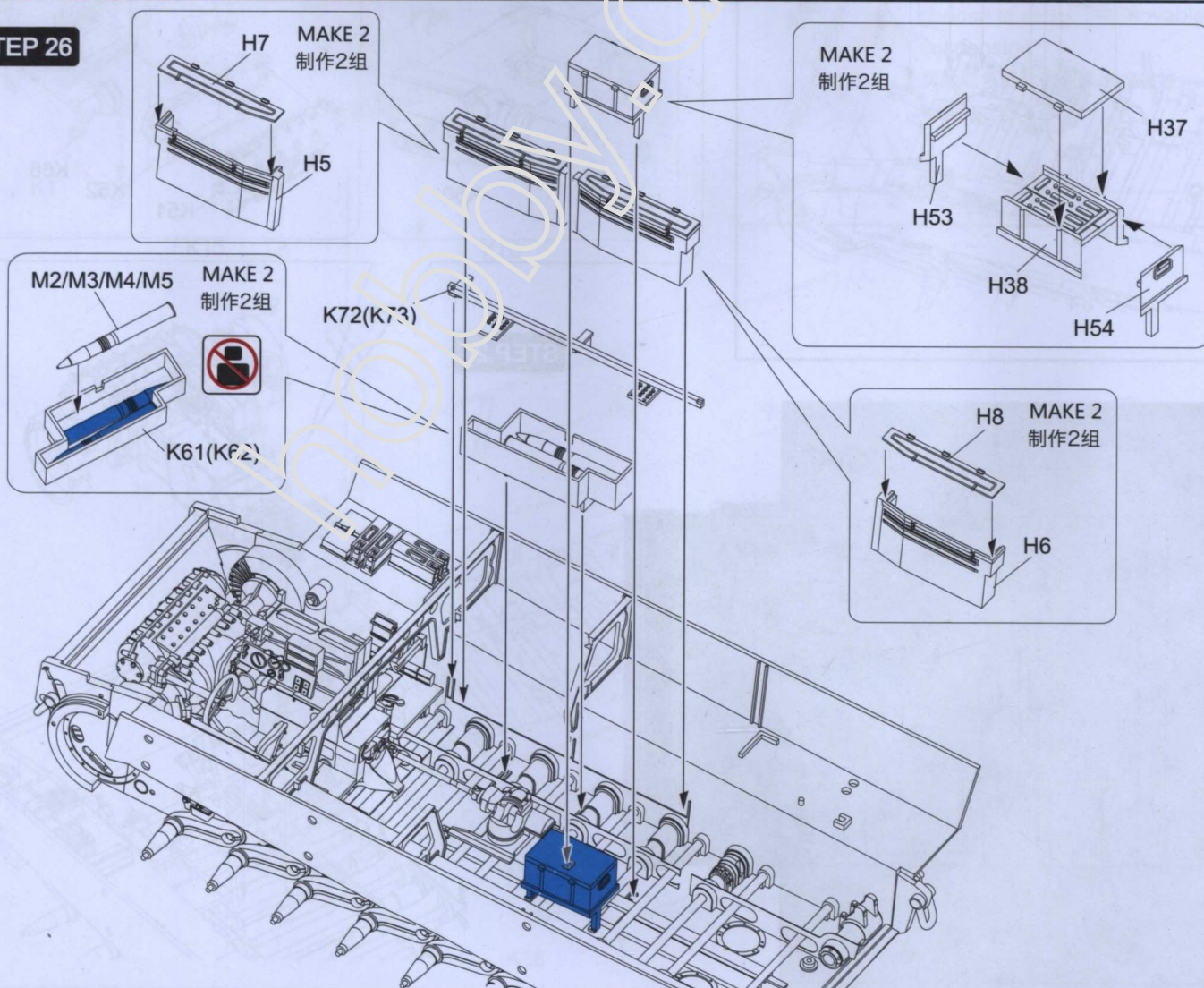

STEP 27

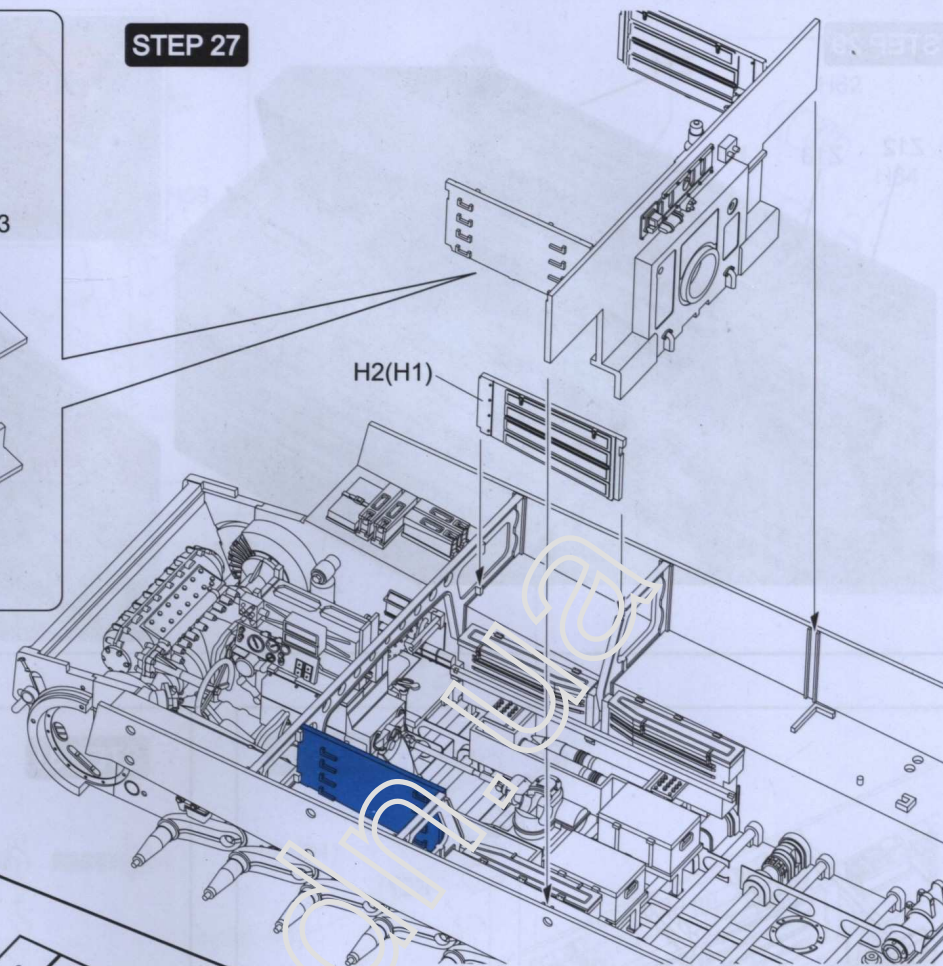
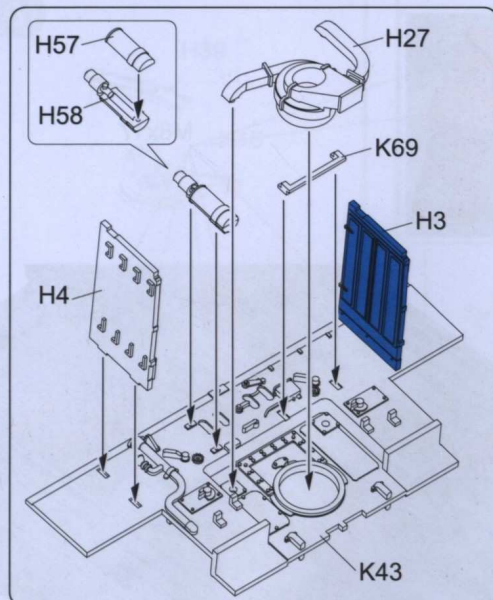

STEP 28

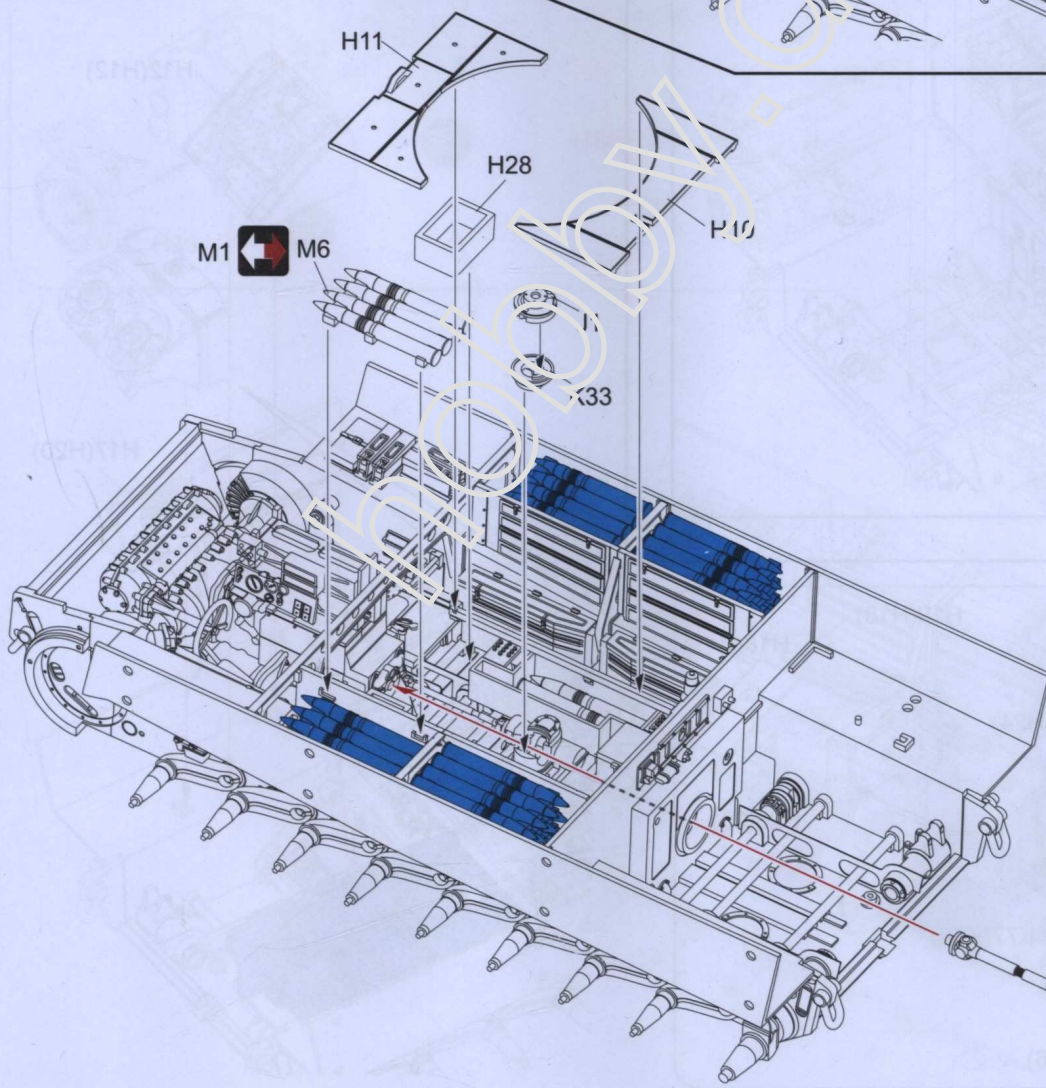

Please assembly the K74 part first.
请优先组装K74

K74

STEP 29

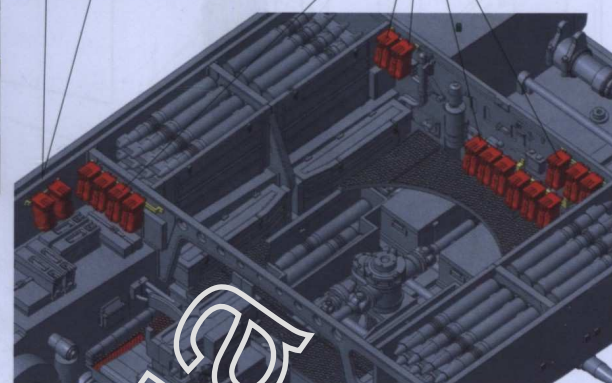
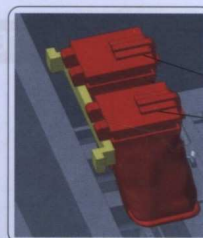
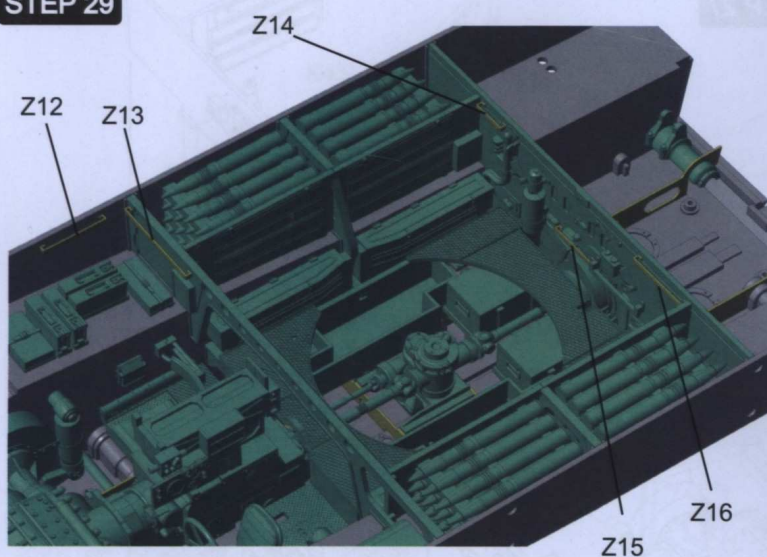

STEP 30

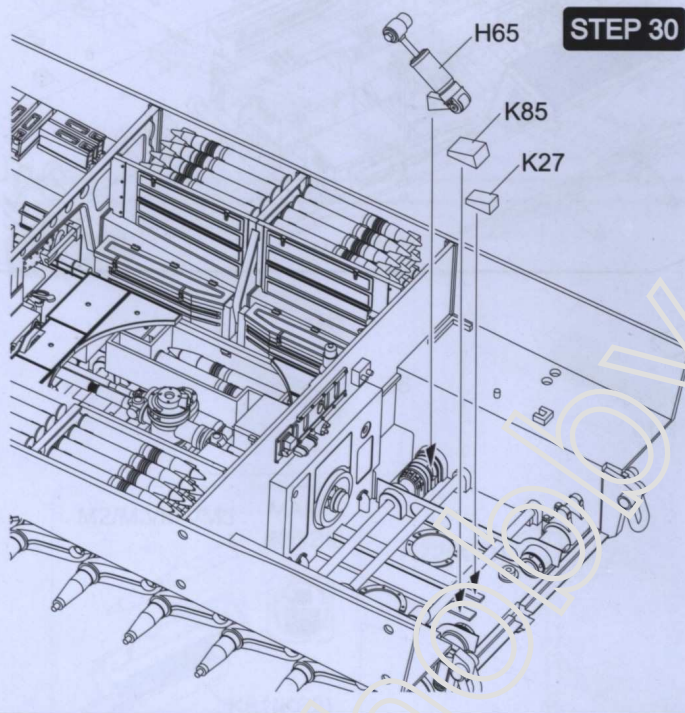

STEP 31

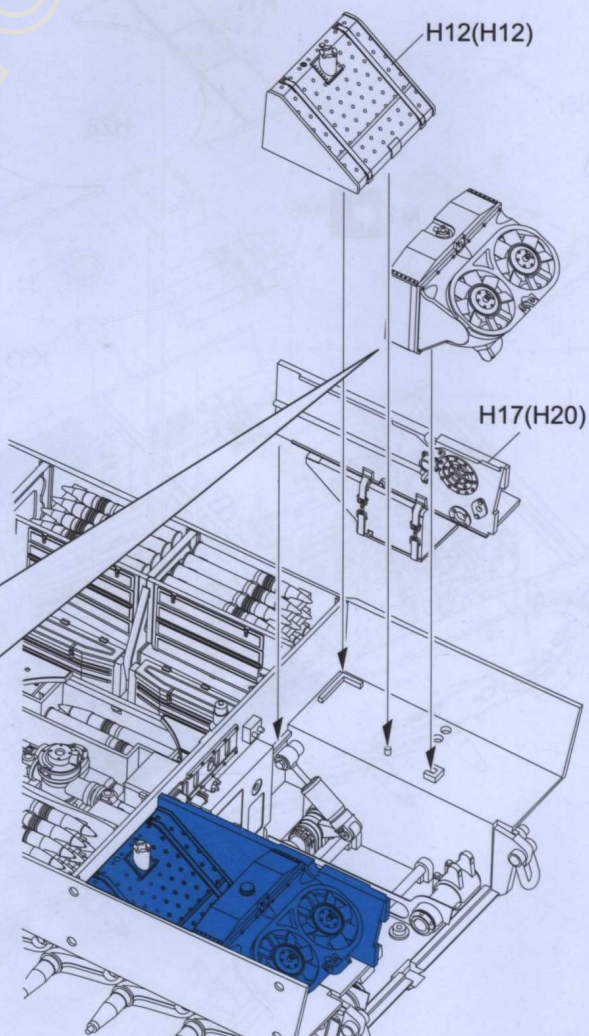

MAKE 2
制作2组

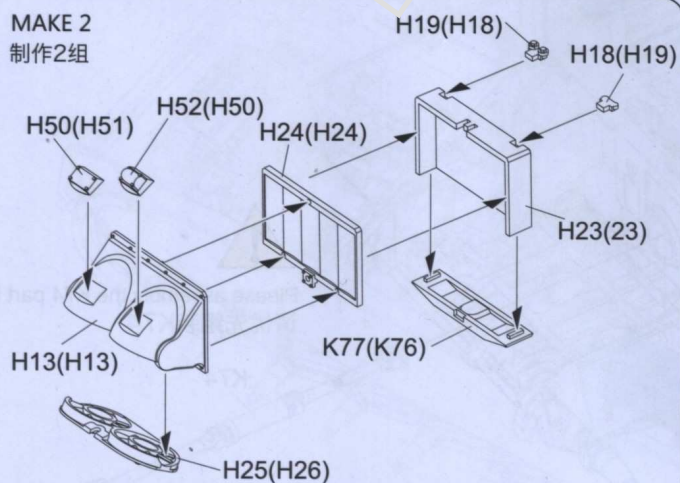

B1

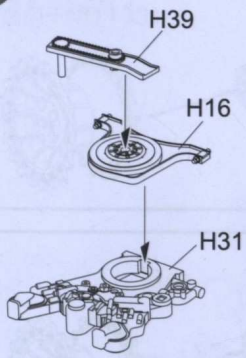

B2

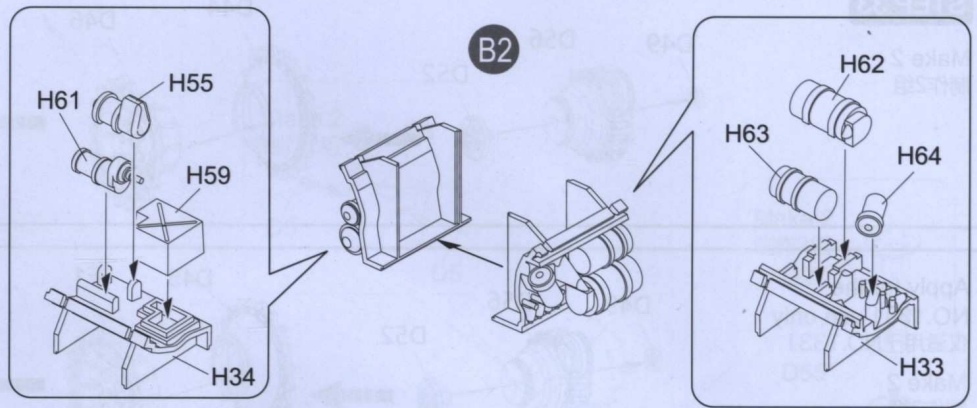

STEP 32

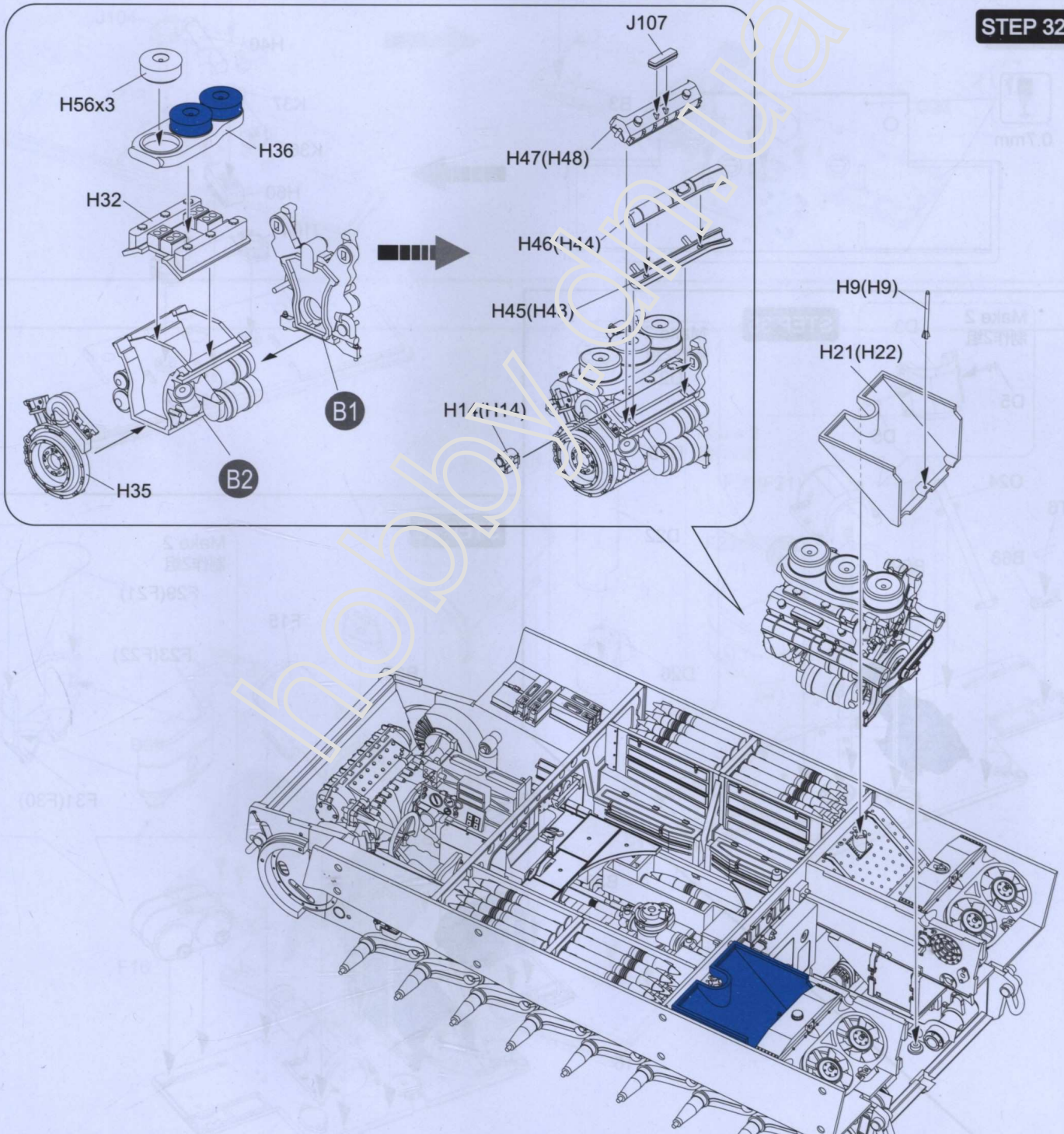

STEP 33

Make 2
制作2组

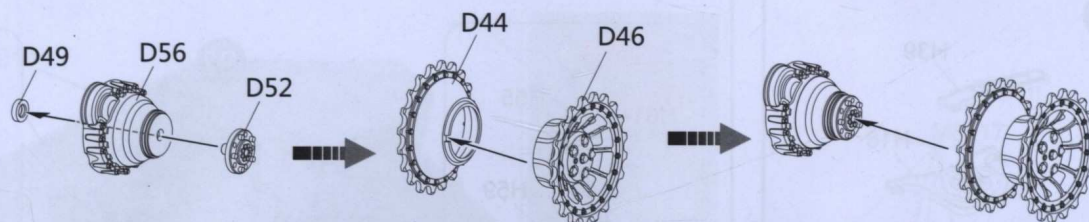

Apply for the
NO.1331 use only
仅适用于NO.1331

Make 2
制作2组

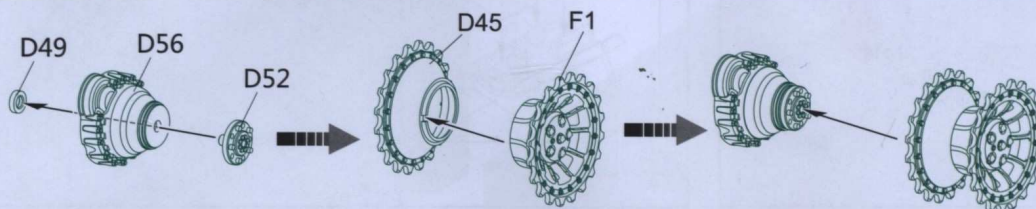

STEP 34

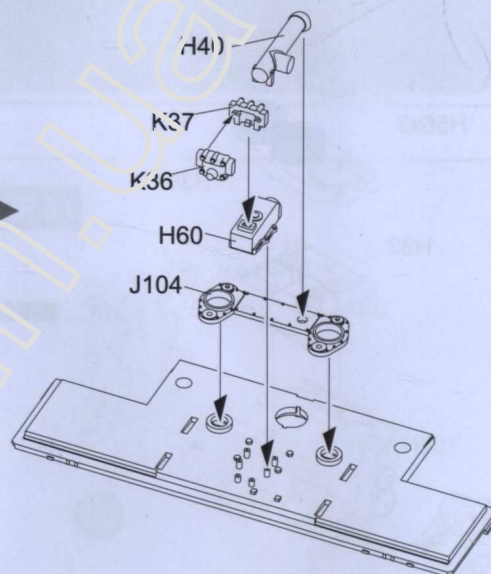
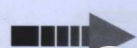
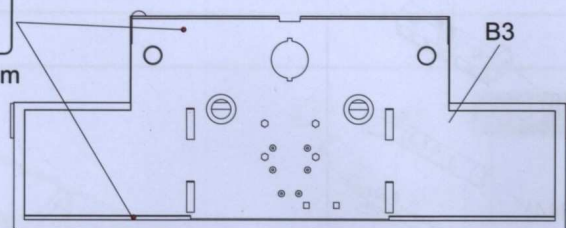
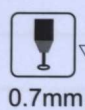

STEP 35

Make 2
制作2组

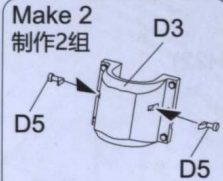

Make 2
制作2组

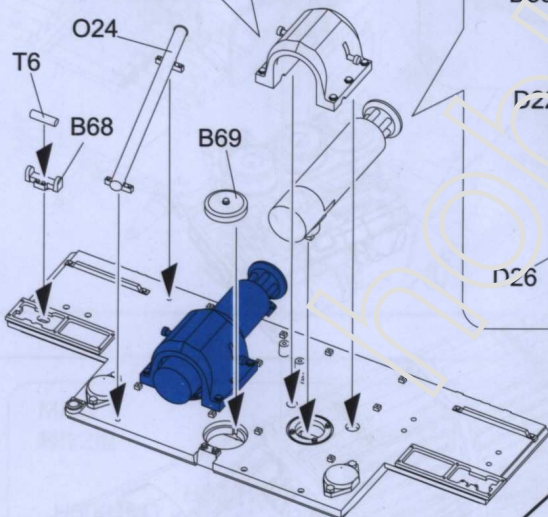
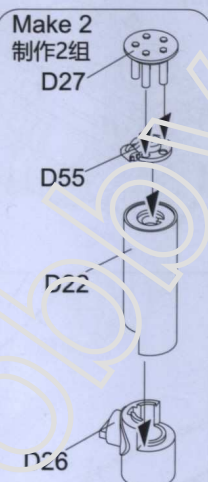

STEP 36

Make 2
制作2组

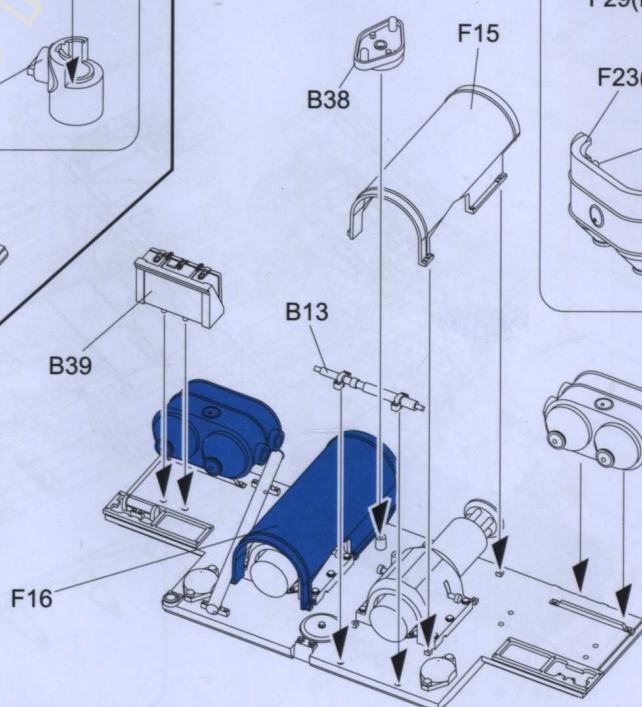
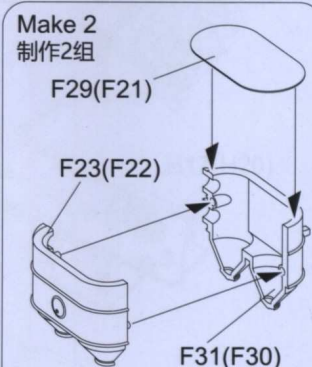

Apply for the NO.1331 use only
仅适用于NO.1331

STEP 31

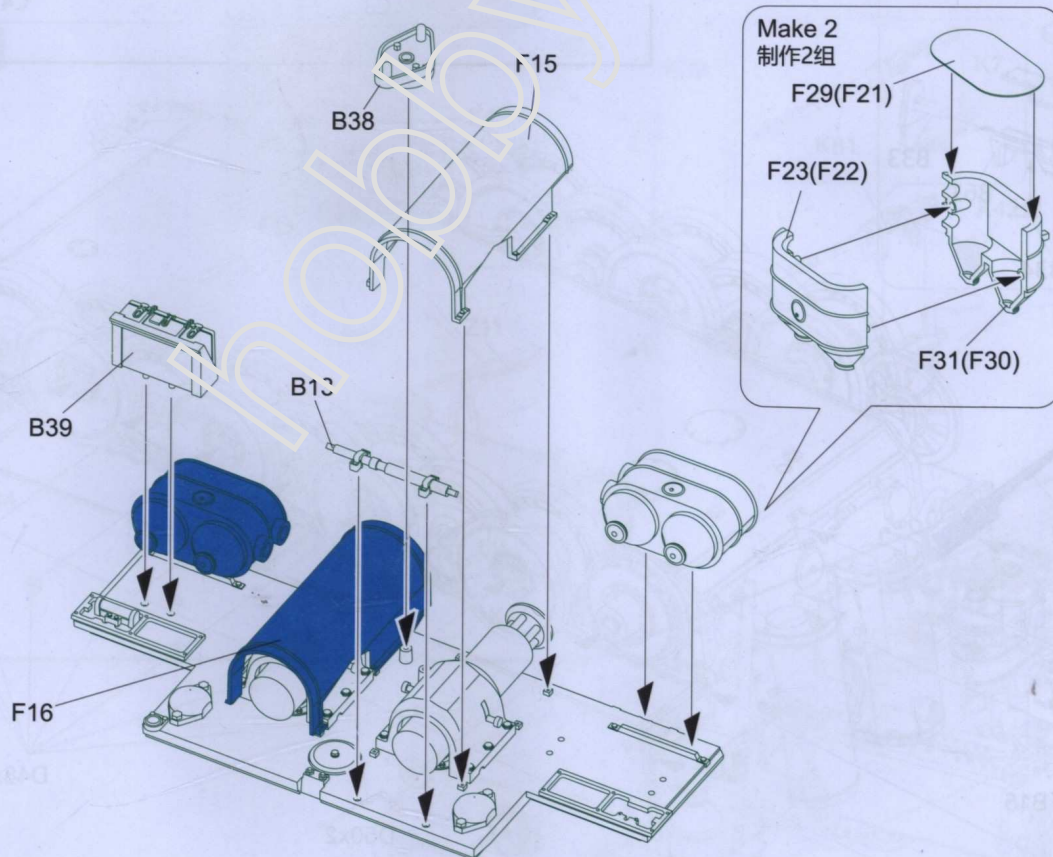
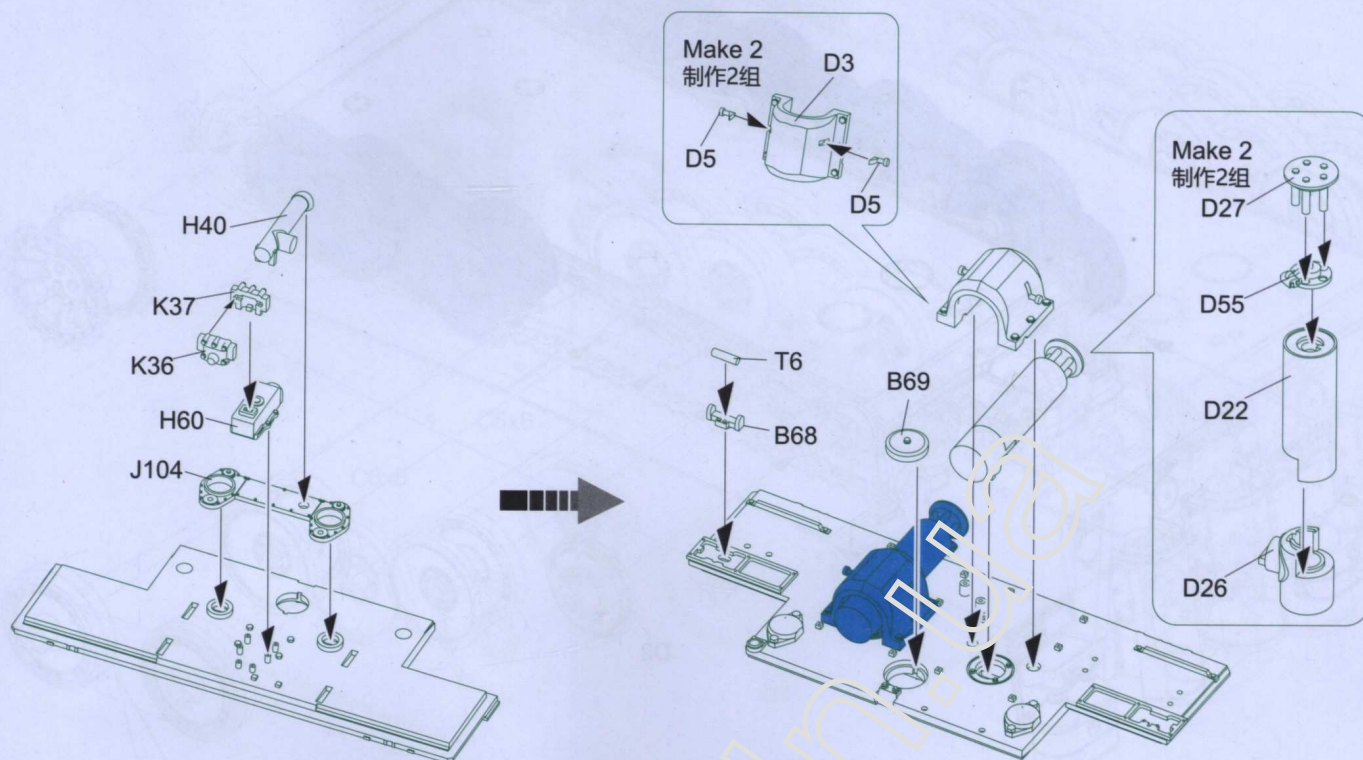

STEP 37

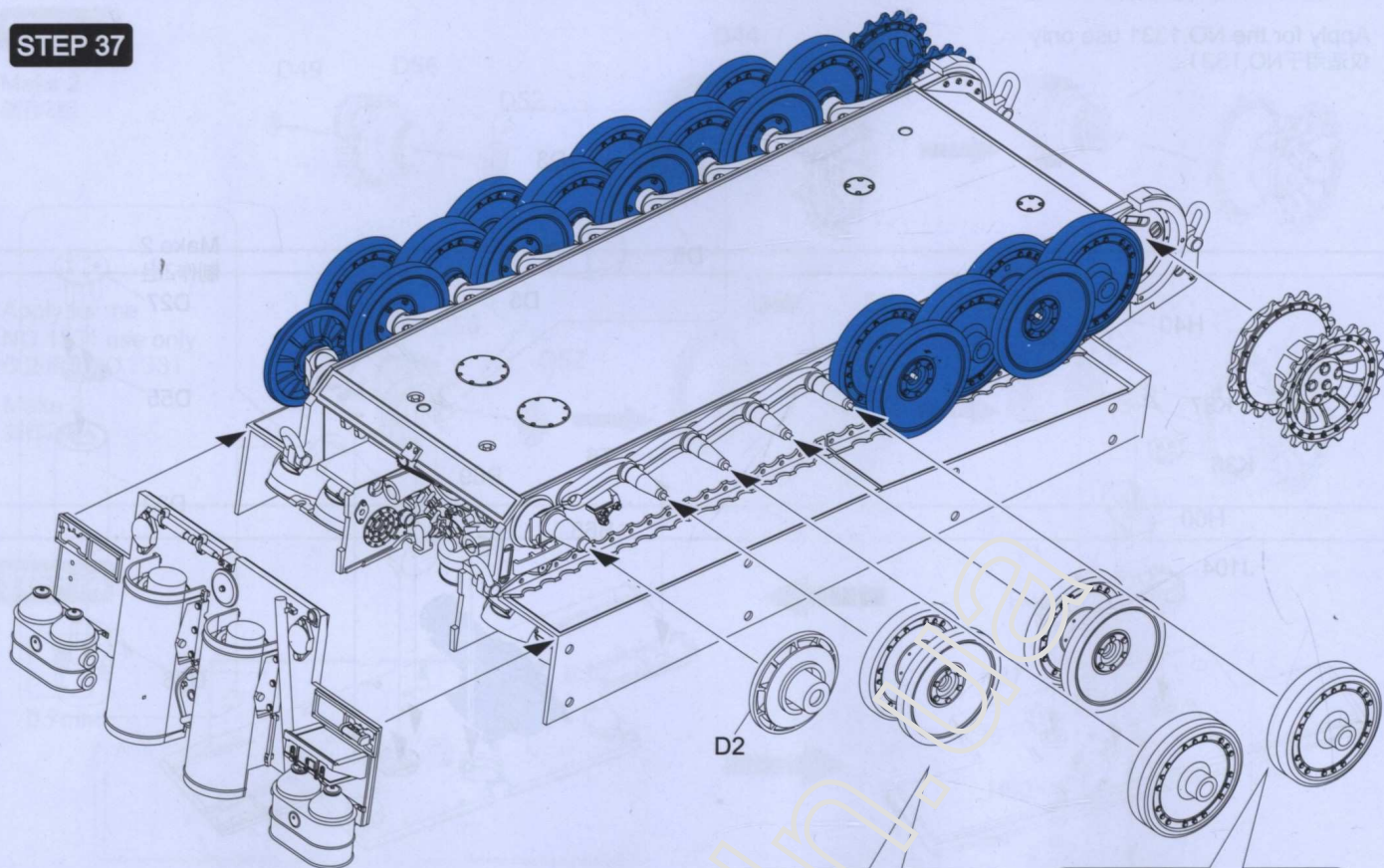

STEP 38

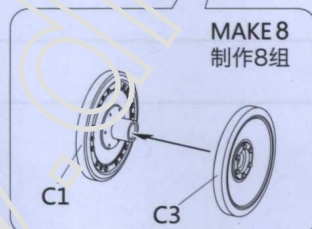
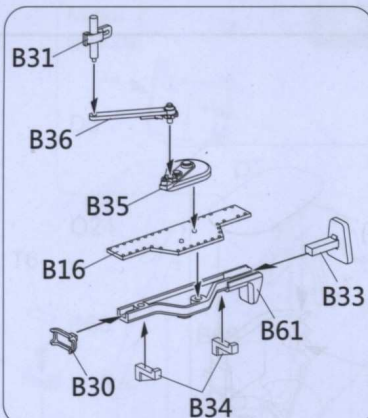

MAKE 8
制作8组

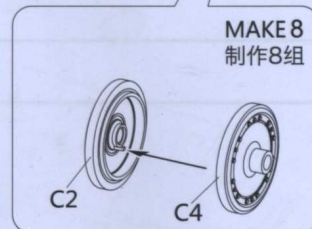

MAKE 8
制作8组

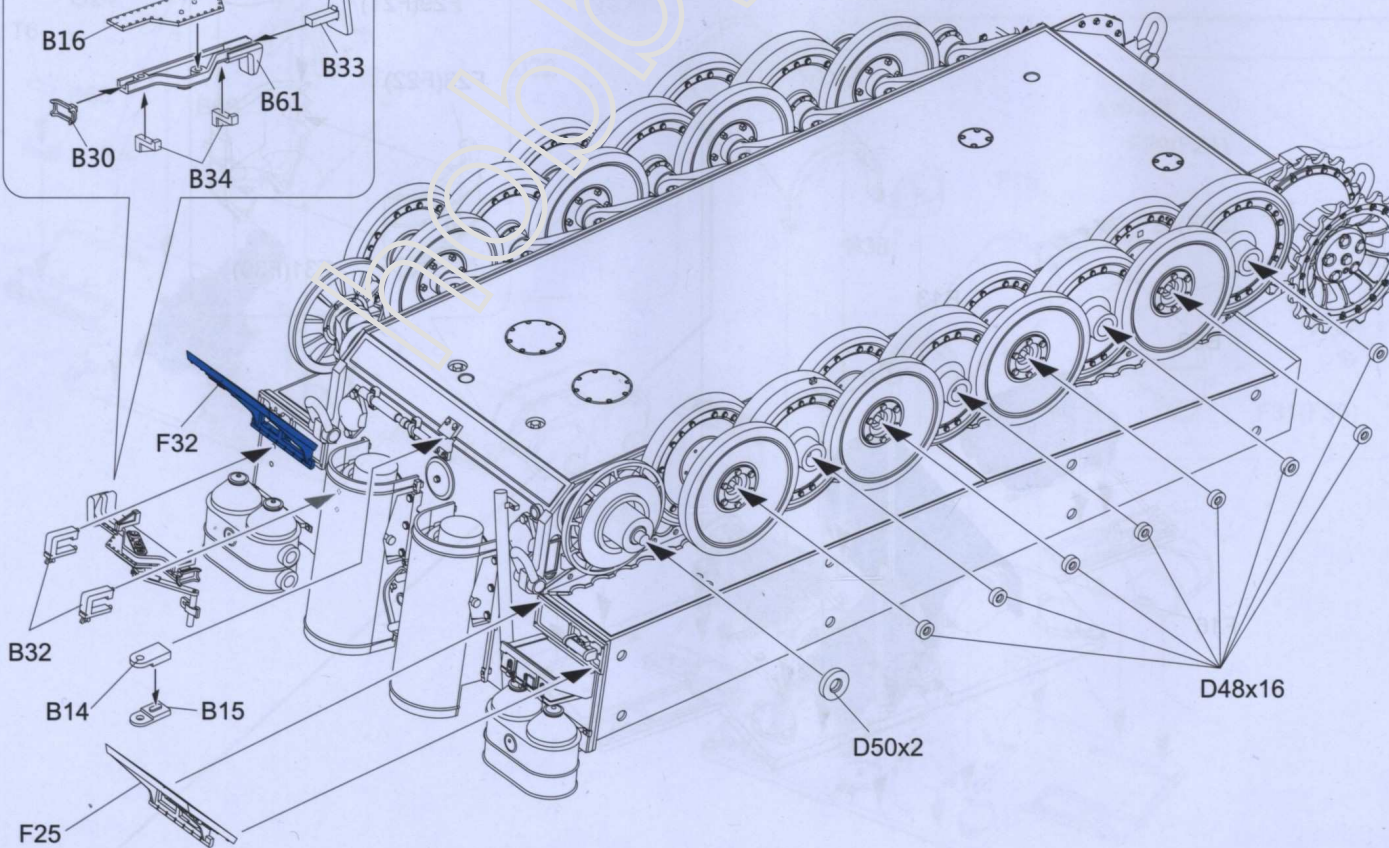

STEP 39

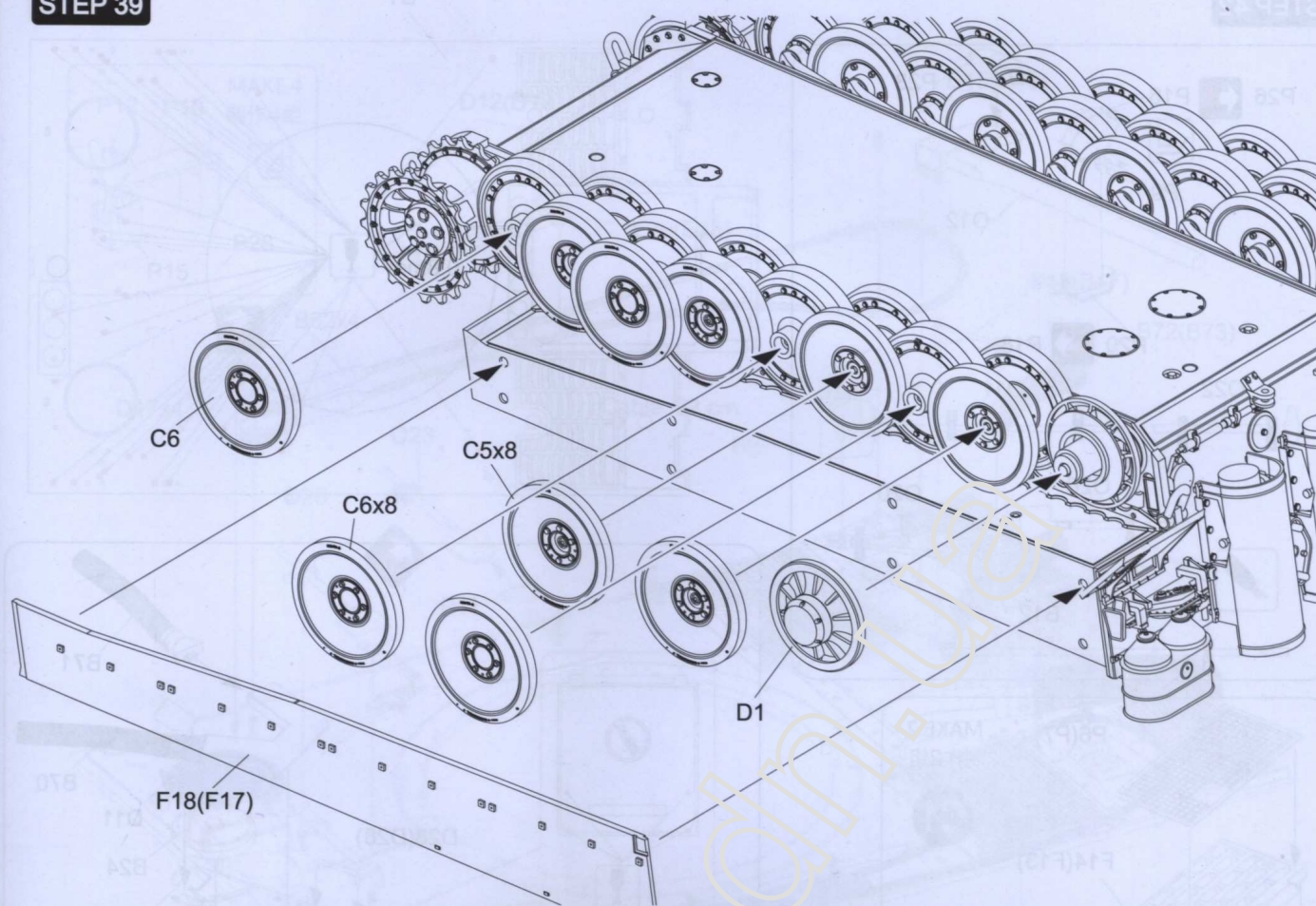

STEP 40

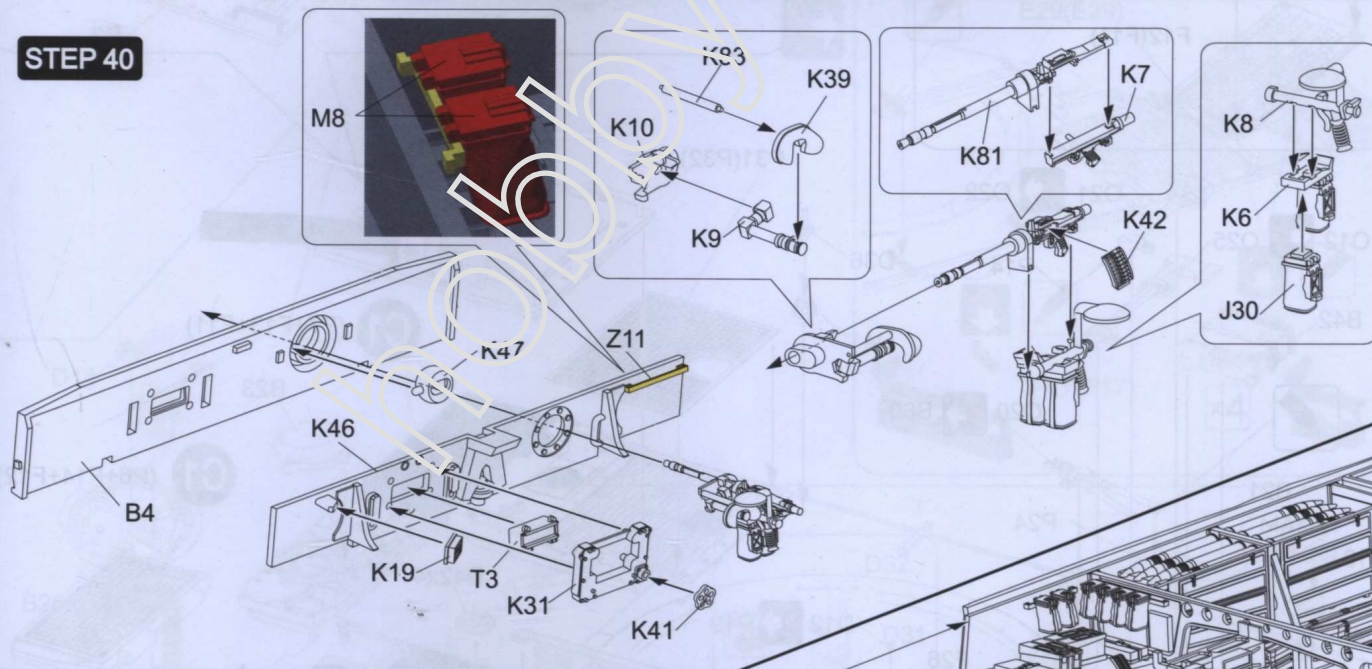

STEP 41

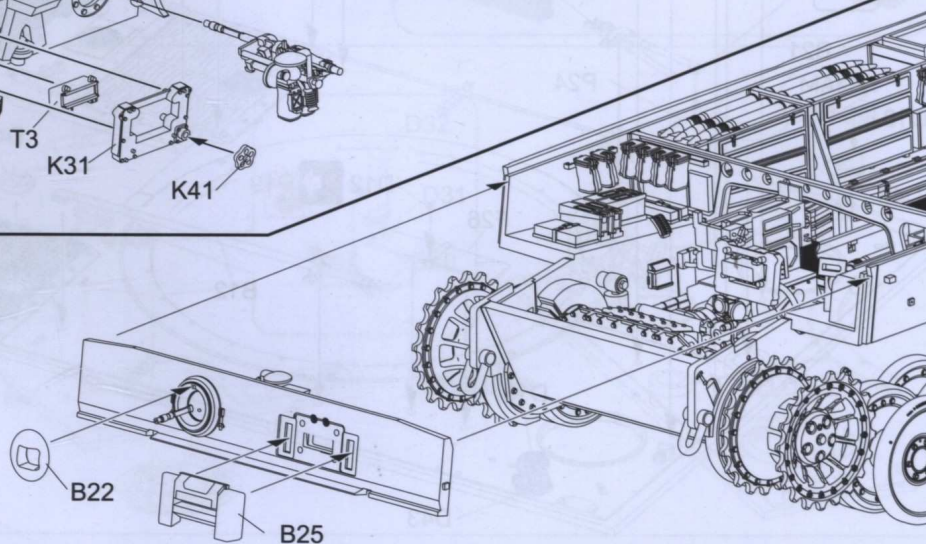

STEP 42

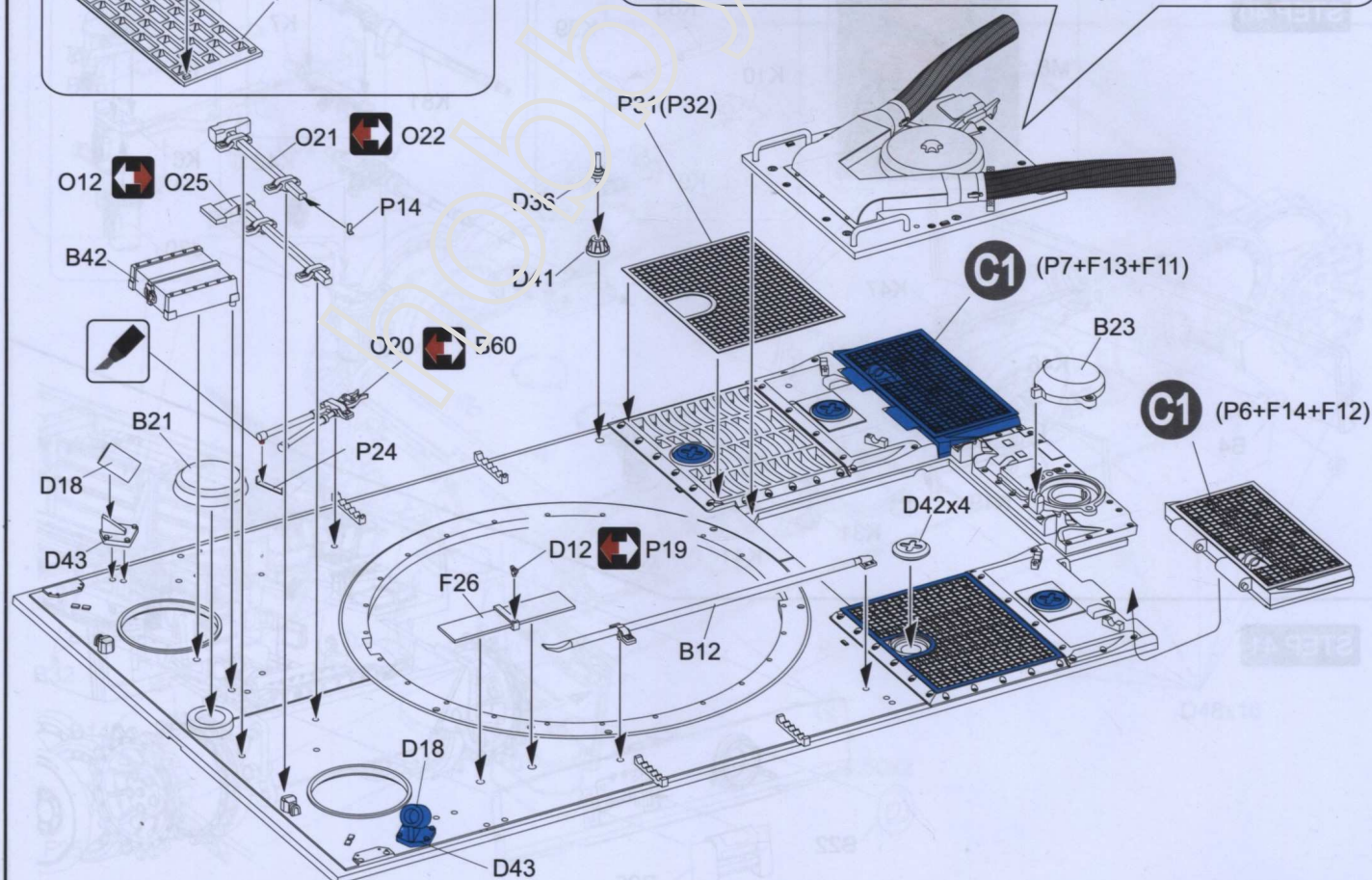
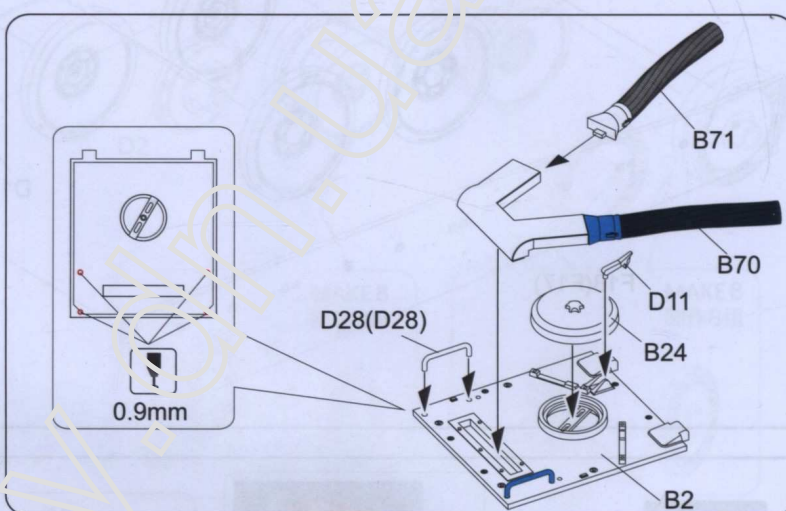
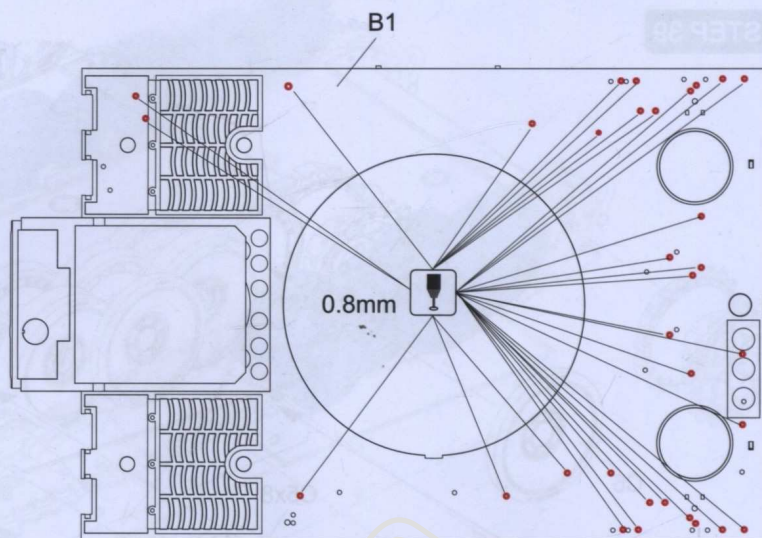
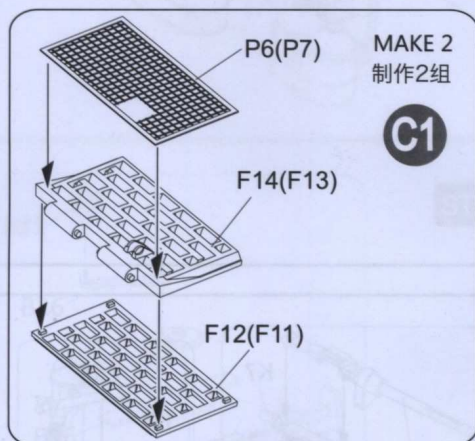
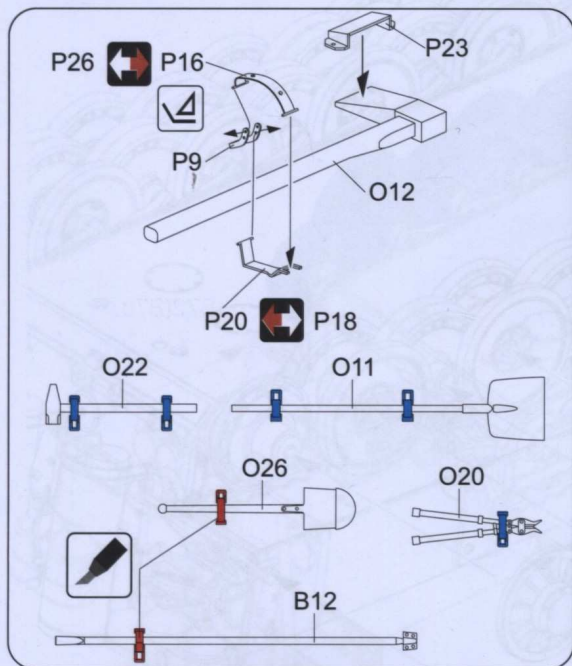

STEP 43

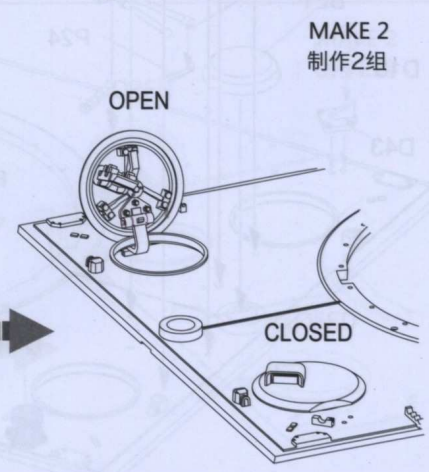
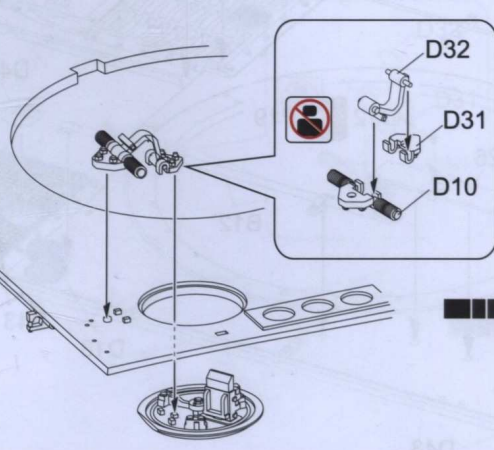
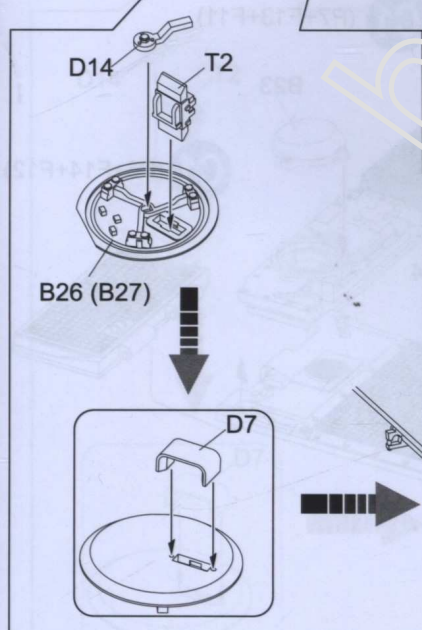
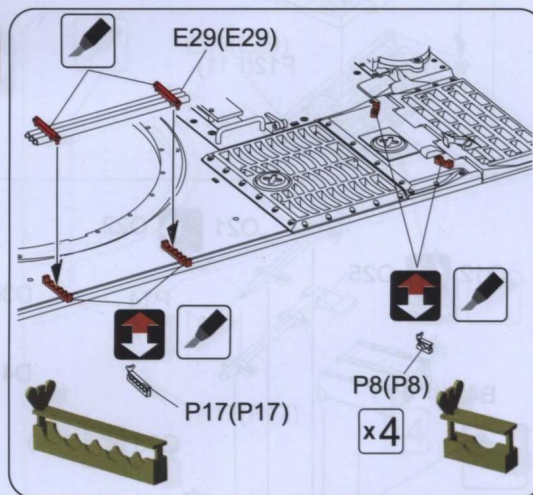
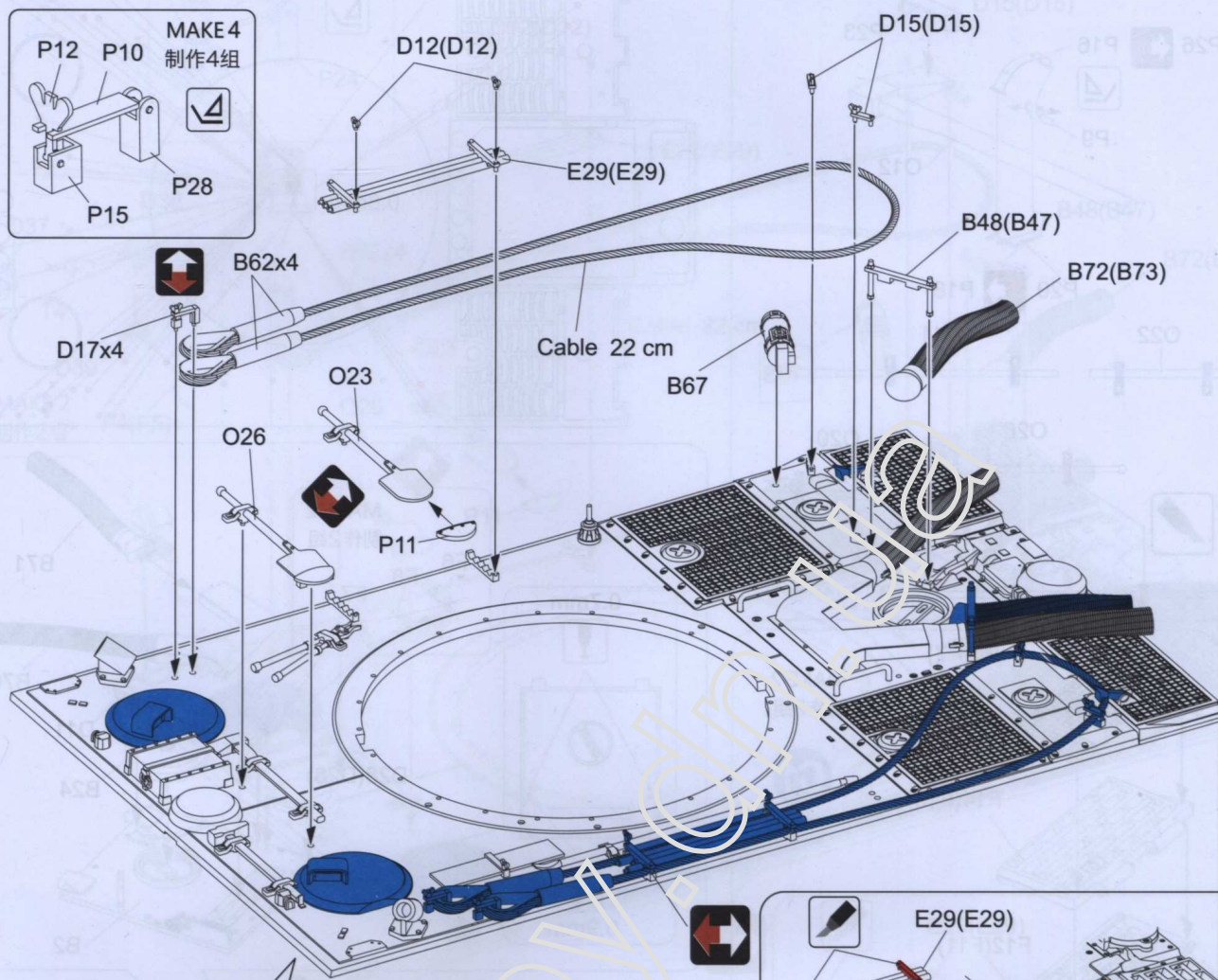
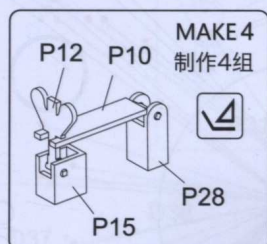



Apply for the No.1331
仅适用于No.1331

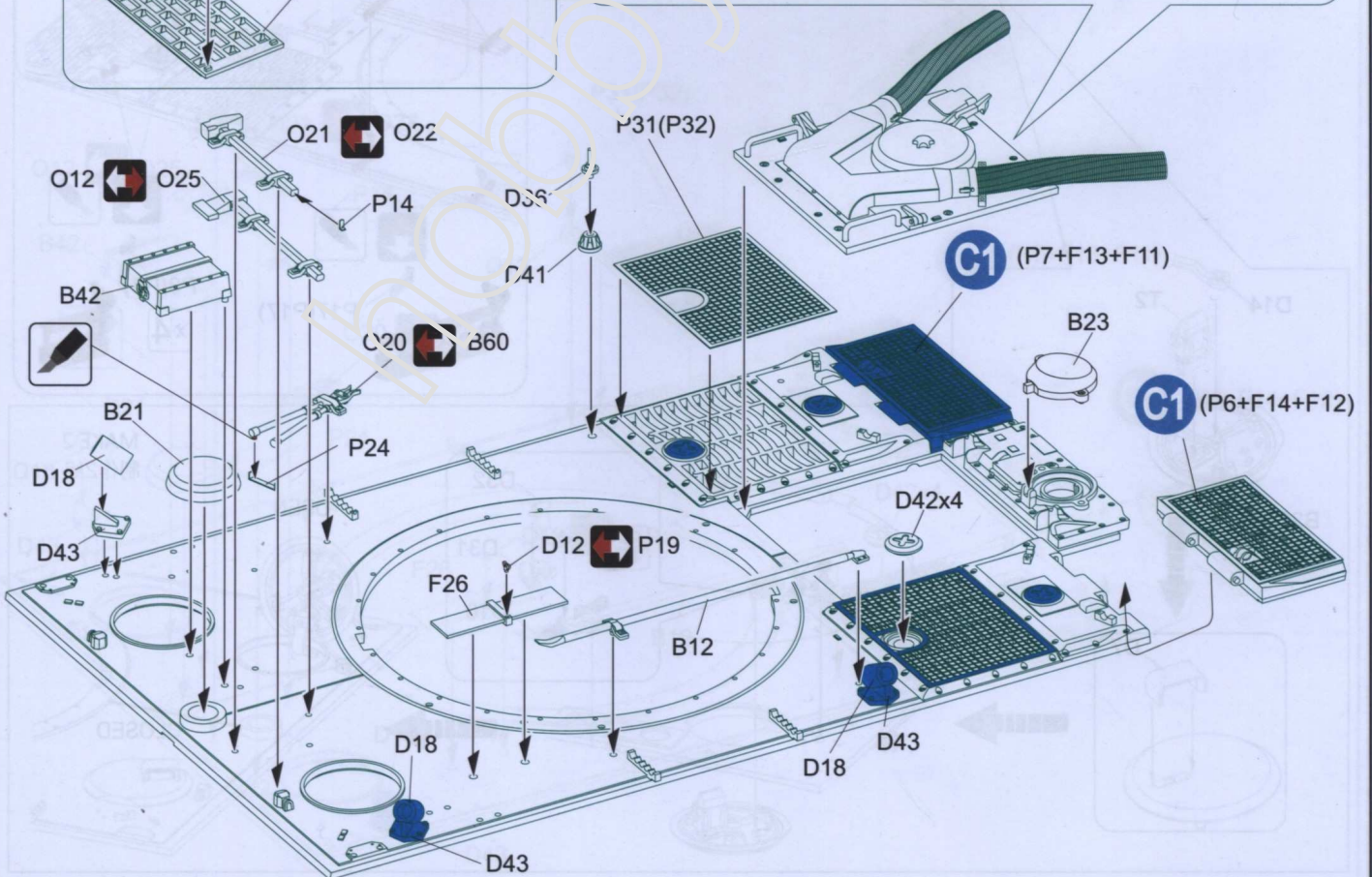
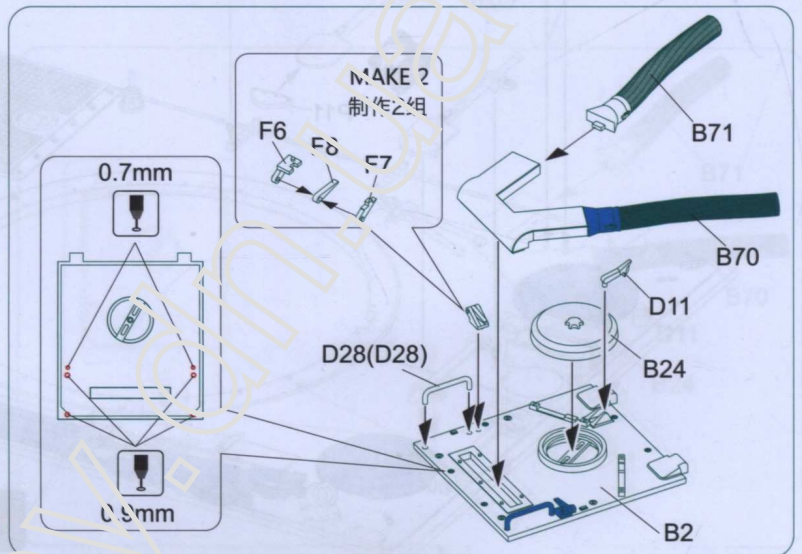
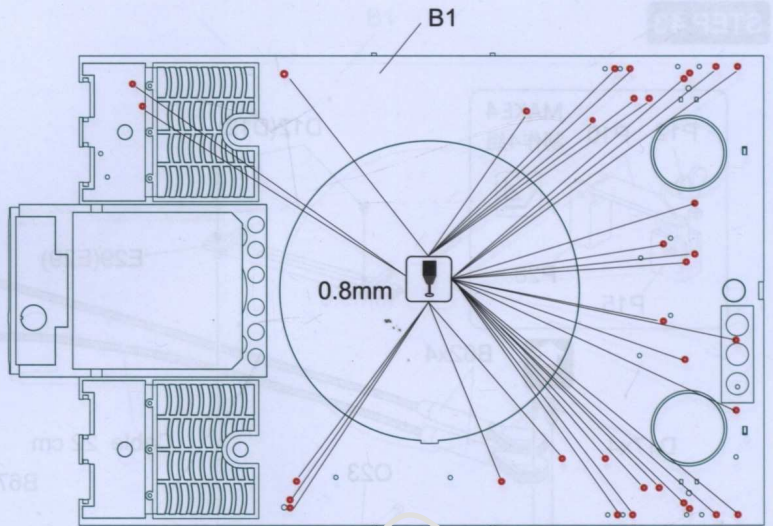
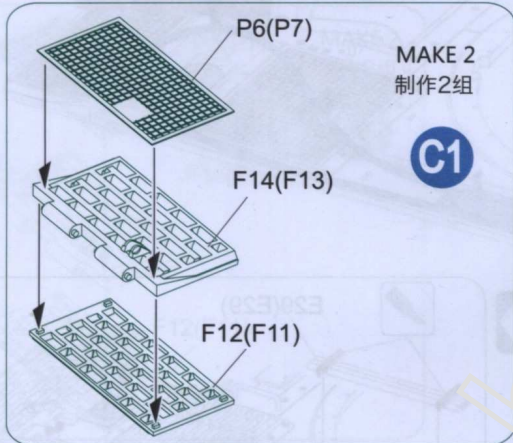
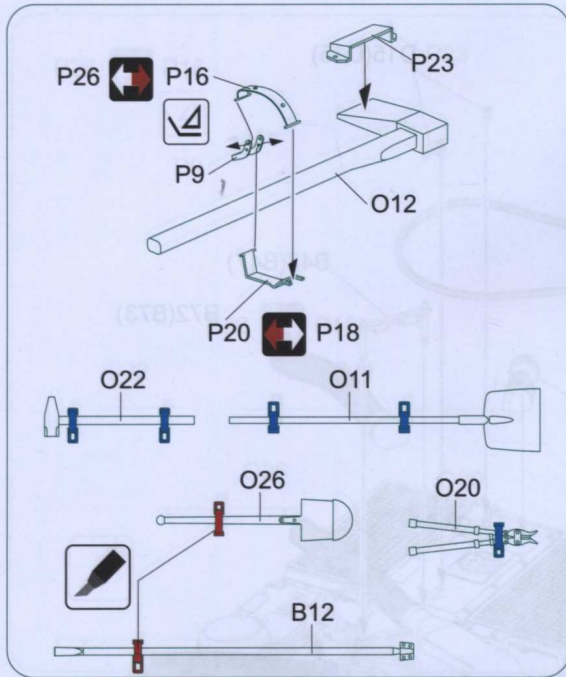

STEP 4

MAKE 4
制作4组

P15 P25
P31 P24

MAKE 2
制作2组

D37 D38
T4 D39
F4(F5)

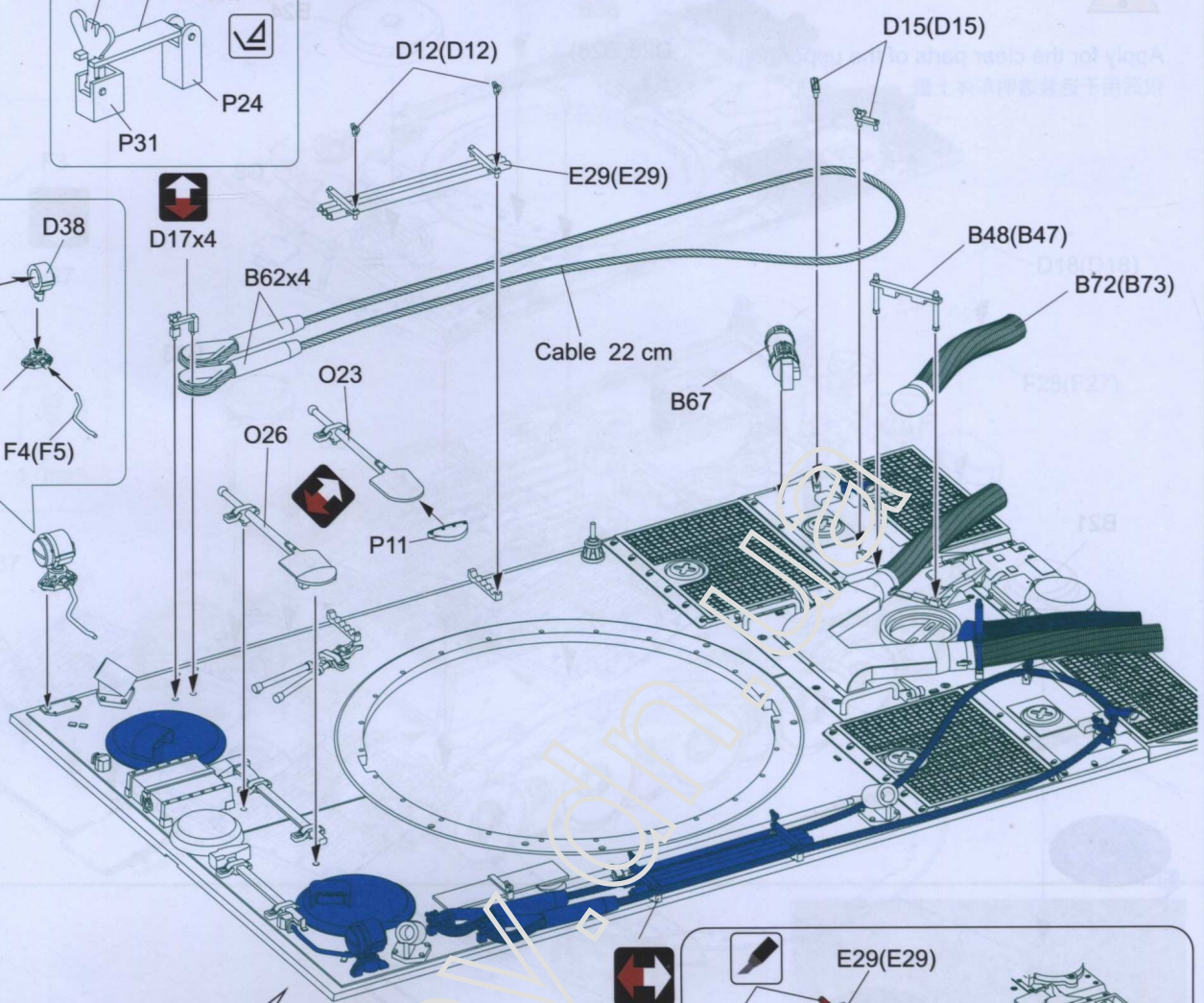

E29(E29)
P17(P17)
P8(P8)
x4

D14 T2
B26 (B27)
D7

D32 D31
D10

MAKE 2
制作2组

OPEN

CLOSED



Apply for the clear parts of the upper hull
仅适用于选装透明车体上盖

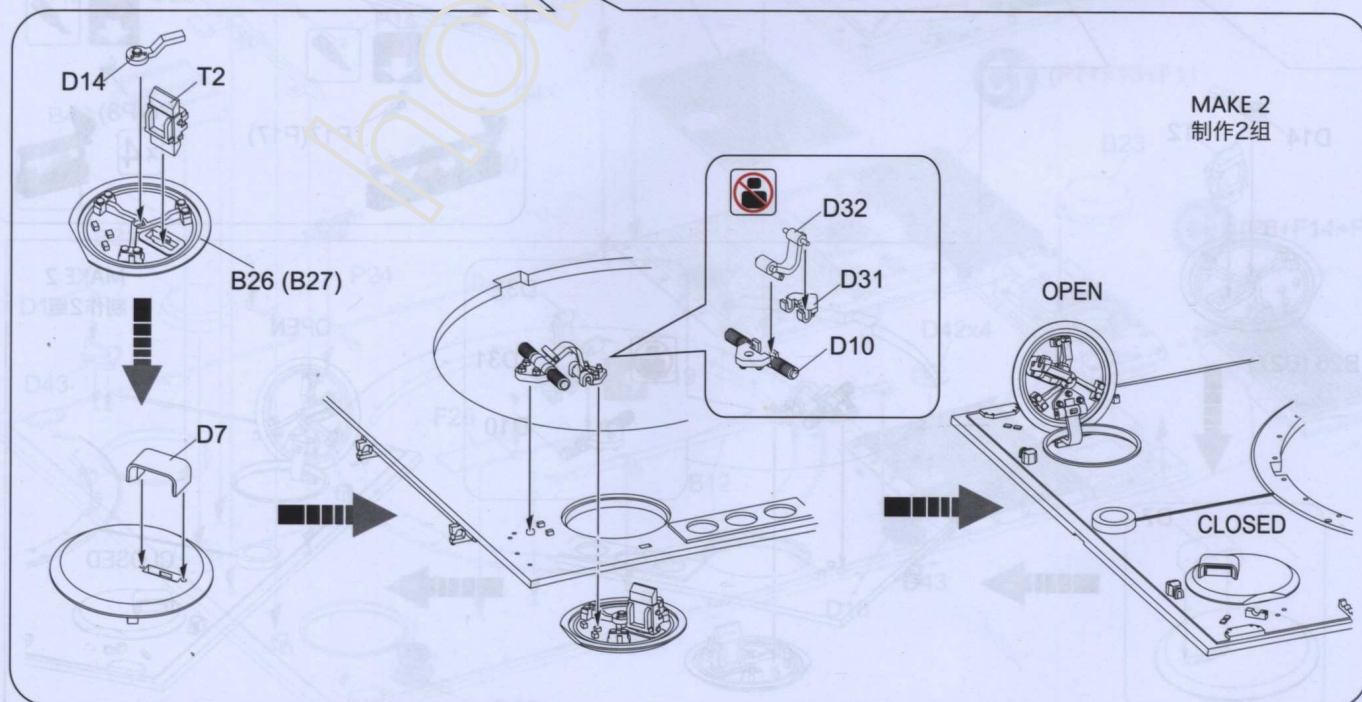
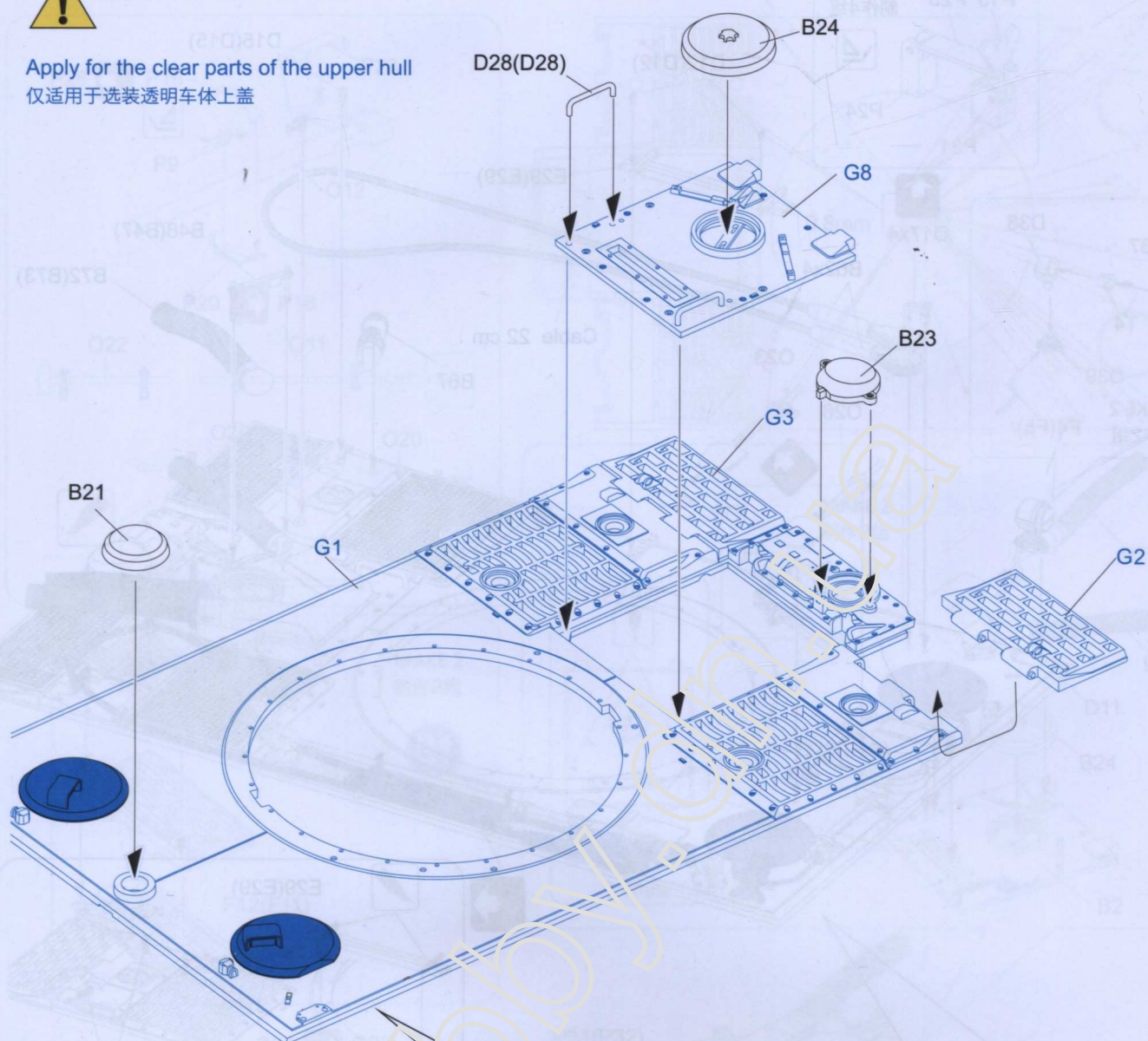

STEP 44

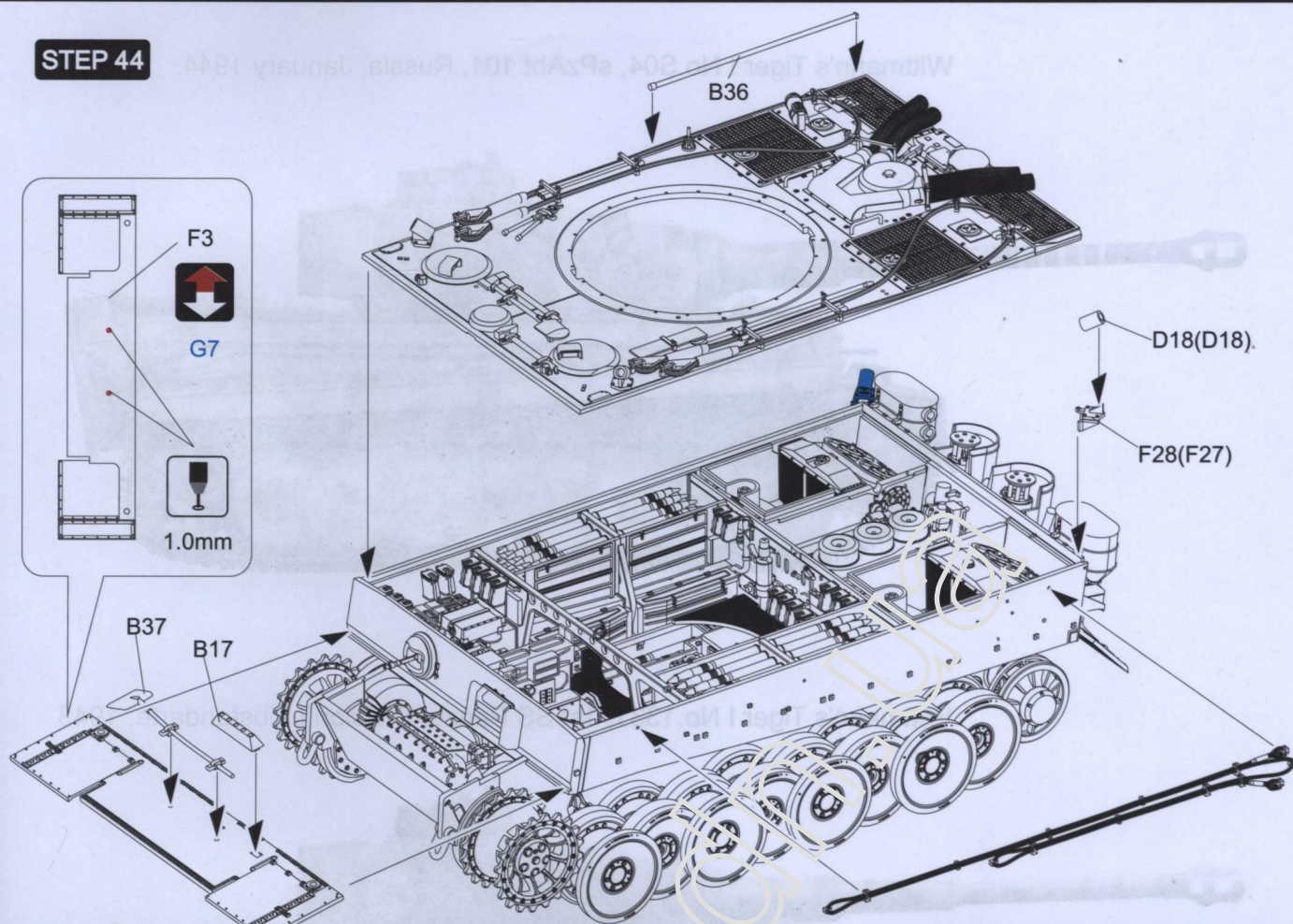

STEP 45

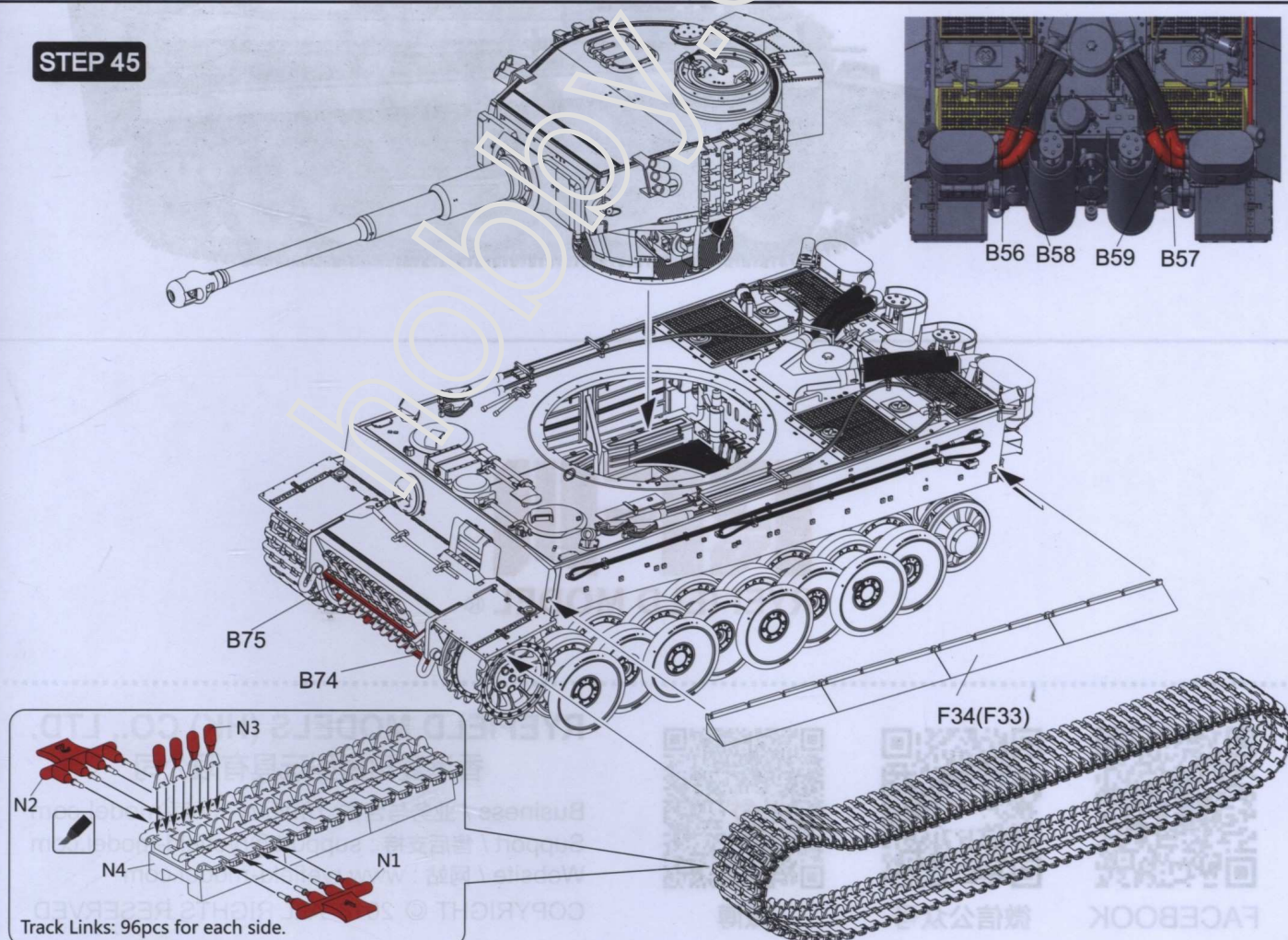

Wittmann's Tiger I No.S04, sPzAbt 101, Russia, January 1944.



Wittmann's Tiger I No.1331, 1st SS Panzer Division Leibstandarte, 1943



RFM
RYEFIELD MODEL®



FACEBOOK



微信公众号



微博

RYEFIELD MODELS (HK) CO., LTD.

香港麦田模型玩具有限公司

Business / 业务与合作: rfm@ryefield-model.com

Support / 售后支持: support@ryefield-model.com

Website / 网站: www.ryefield-model.com

COPYRIGHT © 2018 ALL RIGHTS RESERVED

PARTS 部品图

A x1

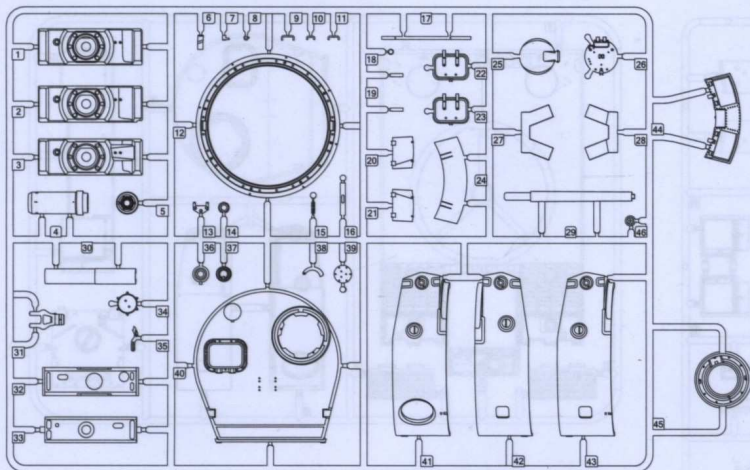

C x2

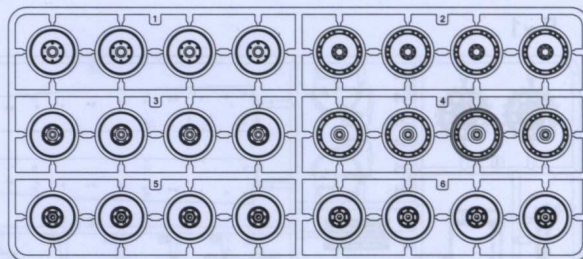

M x2

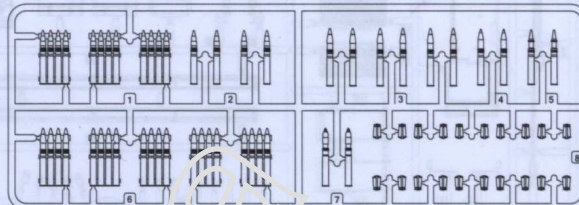

B x1

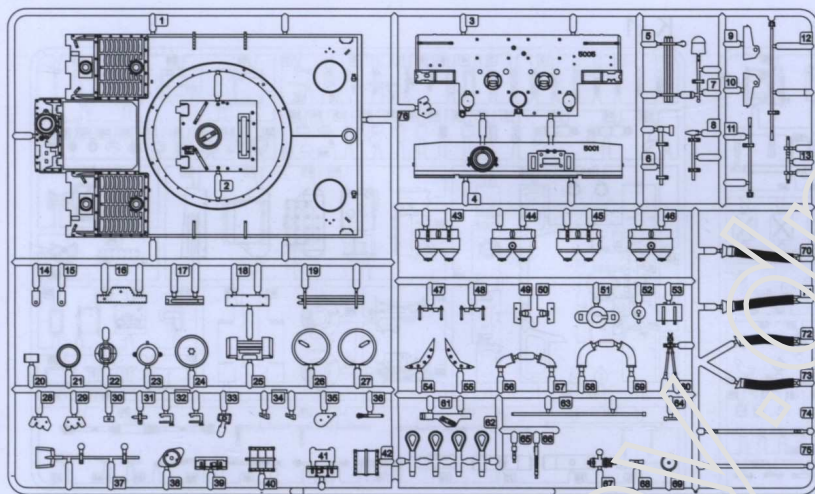

N x4

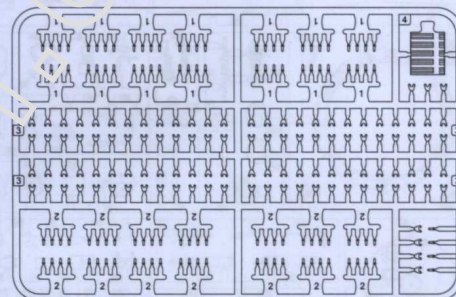

E x1

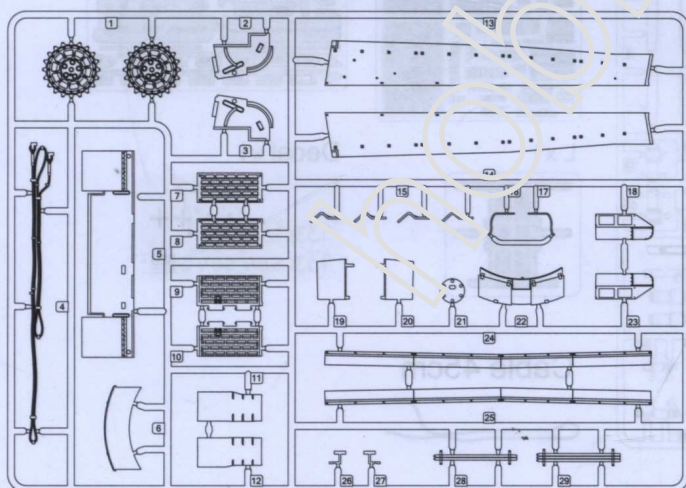

D x2

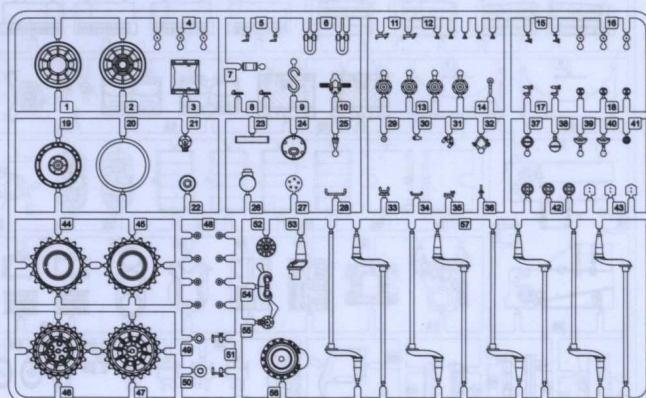

Lower hull x1

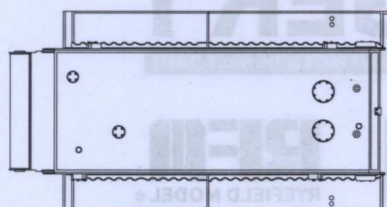

T x1

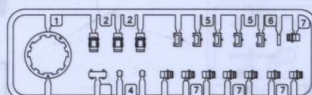

Track x192

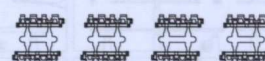

F x1

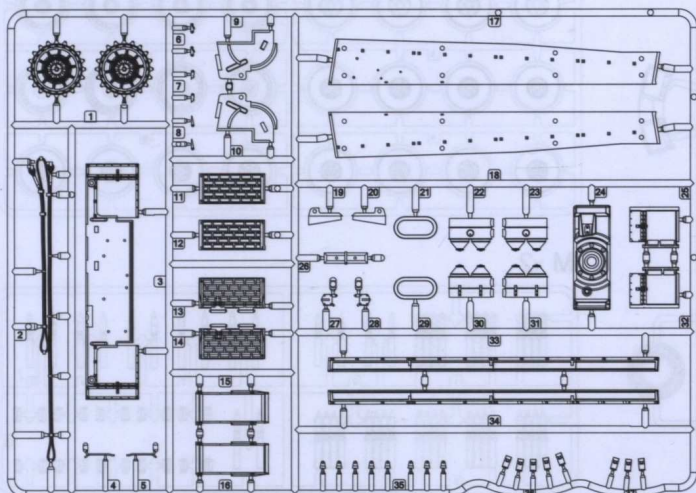

G x1

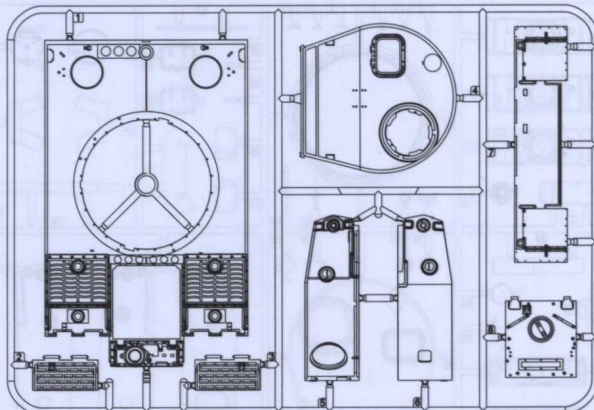

J x1

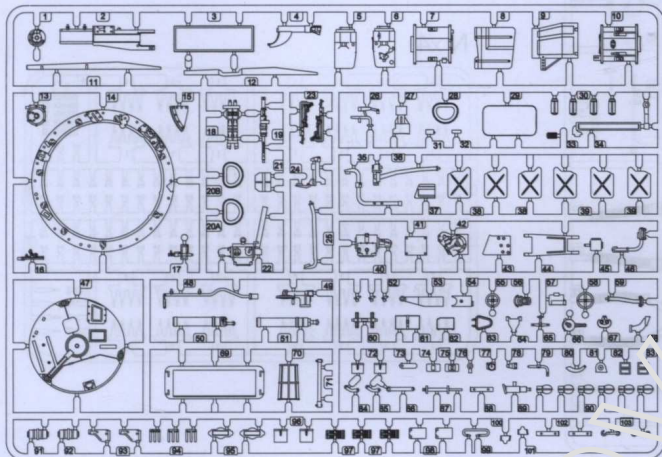

K x1

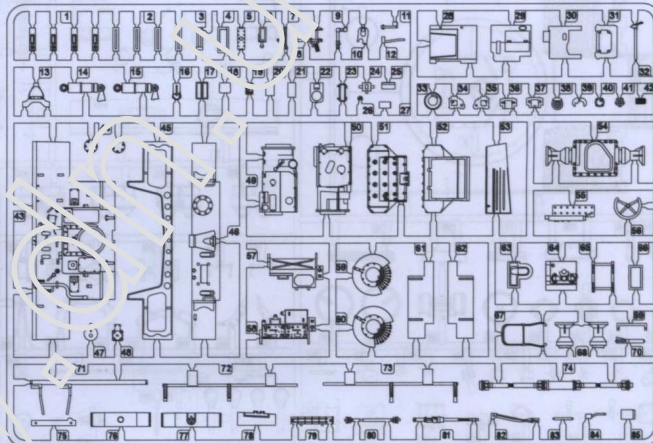

H x1

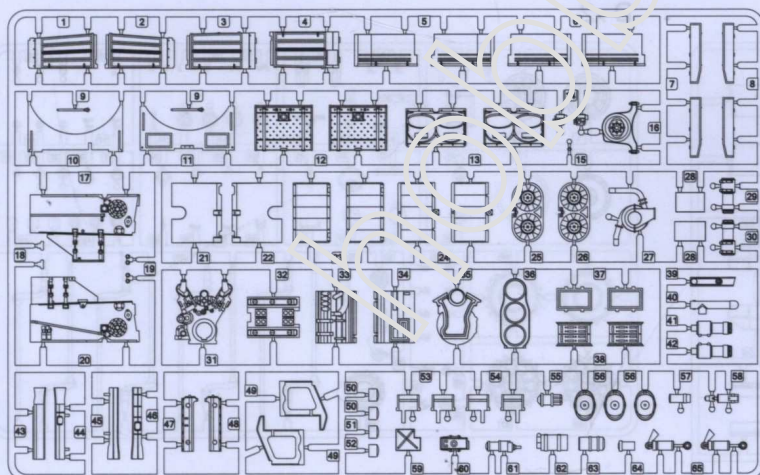

P x1

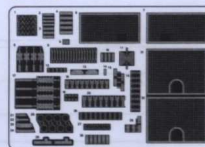

Z x1

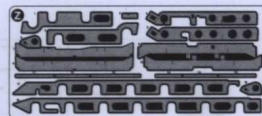

L x1

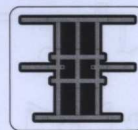

Decal x1

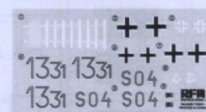

Cable 45cm

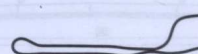

O x1

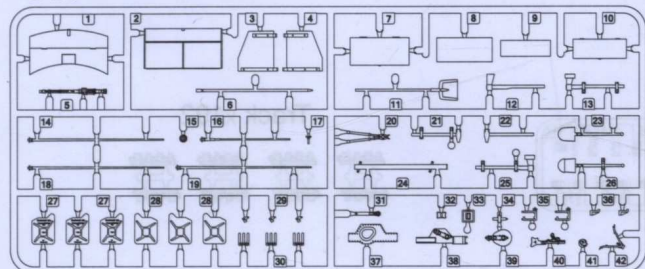

TIGER I

W/ FULL INTERIOR & CLEAR PARTS OF THE HULL & TURRET

5025

MILITARY MINIATURE SERIES

RFM

RYEFIELD MODEL®

Description of the mistakes in the instruction

关于说明书错误的说明

A- Cancel the E part

B- Step 43 on page 23: Replace E29 part with B5 part and B19 part

A- 取消E板件

B- 第23页之第43步骤: E29零件更改为B5和B19零件

STEP 43

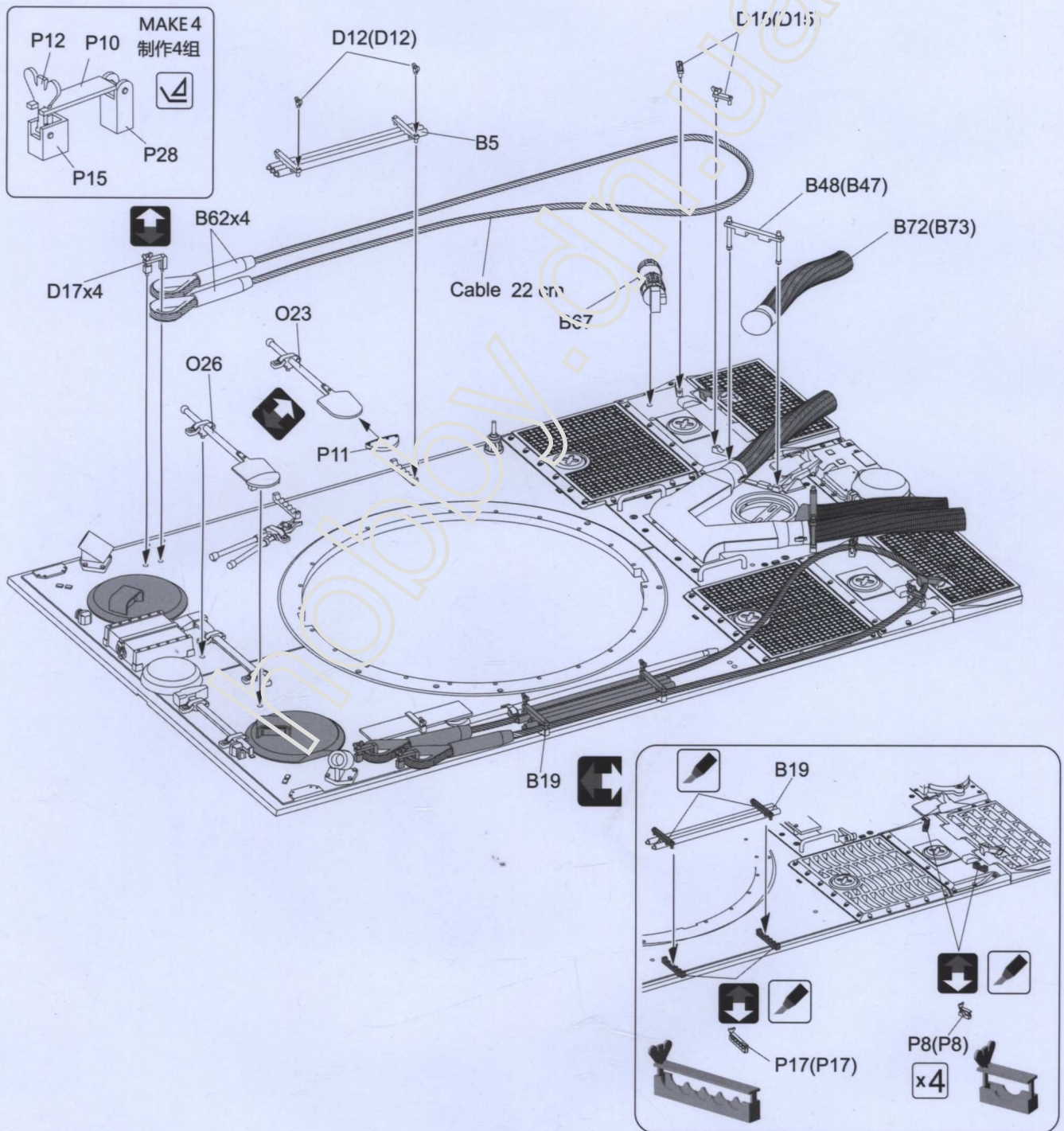



DESIGNED BY TRANSFORM

TIGER I Early Production

Painting and Marking Guide

A.MIG-0002 Olivgrün Opt.2	A.MIG-0010 Dunkelgelb Mid War	A.MIG-0041 Dark Rust
A.MIG-0035 Dark Tracks	A.MIG-0036 Old Wood	A.MIG-0038 Light Wood
A.MIG-0045 Gun Metal	A.MIG-0096 Crystal Periscope Green	A.MIG-0033 Rubber & Tires



WEATHERING STEPS WITH AMMO PRODUCTS

1 GENERAL WASH A.MIG-1000 Brown Wash for German Yellow	3 STREAKING A.MIG-1203 Streaking Grime	5 TRACK WASH A.MIG-1002 Tracks Wash	7 MUD & SPLASHES A.MIG-1704 Heavy Earth A.MIG-1753 Turned Dirt
2 FILTER A.MIG-1511 Brown for Dark Yellow	4 RUST A.MIG-1254 Streakingbrusher Rust	6 DUST A.MIG-3030 Factory Dirt Ground	8 GREASE & OIL A.MIG-1408 Fresh Engine Oil



DESIGNED BY TRANSFORM

TIGER I Early Production

Painting and Marking Guide

A.MIG-0002 Olivgrün Opt.2	A.MIG-0010 Dunkelgelb Mid War	A.MIG-0015 Schokobraun
A.MIG-0035 Dark Tracks	A.MIG-0036 Old Wood	A.MIG-0038 Light Wood
A.MIG-0045 Gun Metal	A.MIG-0096 Crystal Periscope Green	A.MIG-0042 Old Rust
A.MIG-0022 Washable White Camo	A.MIG-0033 Rubber & Tires	A.MIG-0008 Dunkelgrau

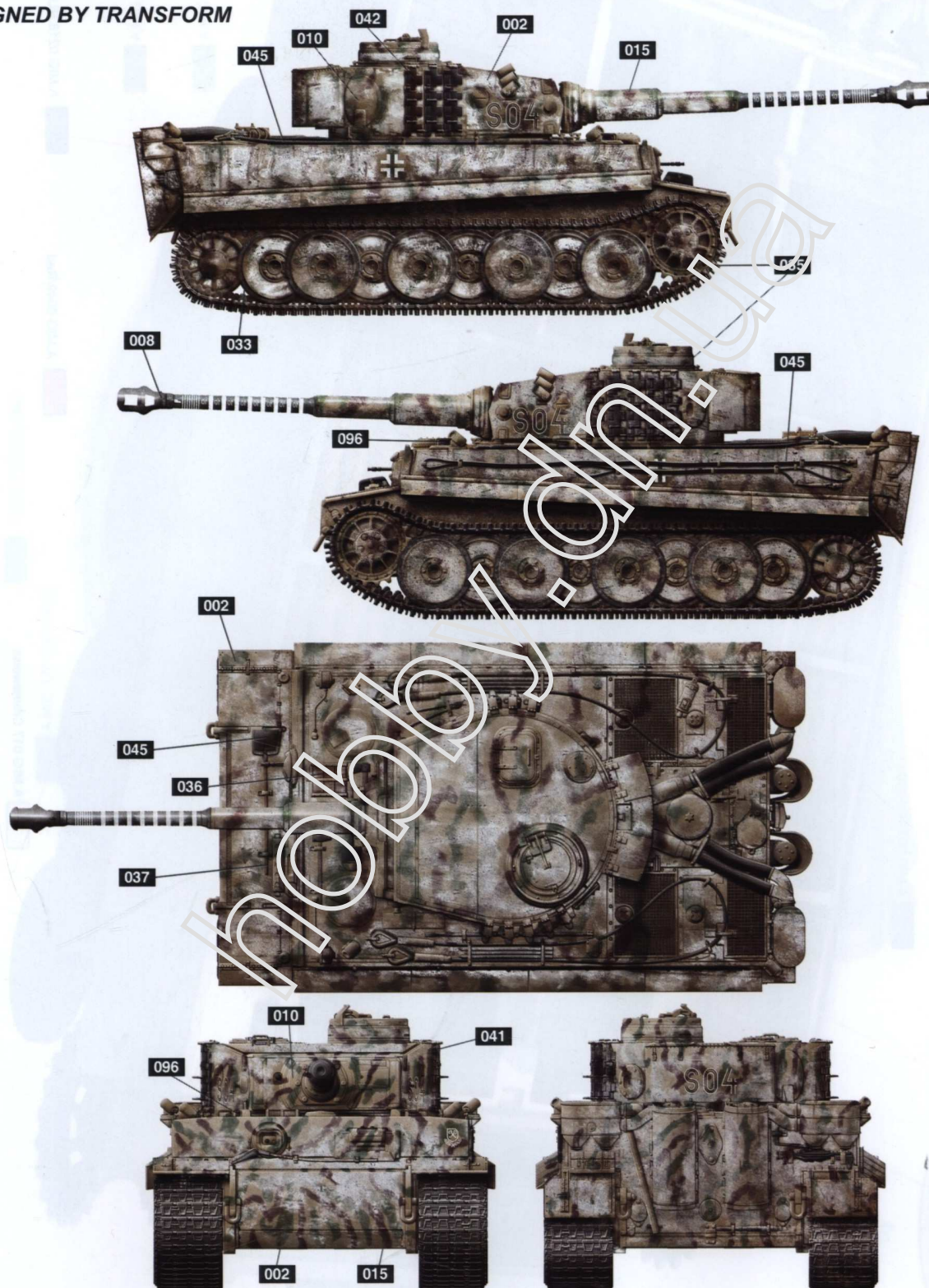

WEATHERING STEPS WITH AMMO PRODUCTS

1 GENERAL WASH A.MIG-1010 Neutral Wash	3 STREAKING A.MIG-1255 Streakingbrusher Winter Grime	5 TRACK WASH A.MIG-1002 Tracks Wash	7 MUD & SPLASHES A.MIG-1705 Wet Mud A.MIG-1754 Damp Earth
2 FILTER A.MIG-1502 Dark Grey for White	4 RUST A.MIG-3510 Rust	6 DUST A.MIG-3029 Winter Soil	8 GREASE & OIL A.MIG-1408 Fresh Engine Oil

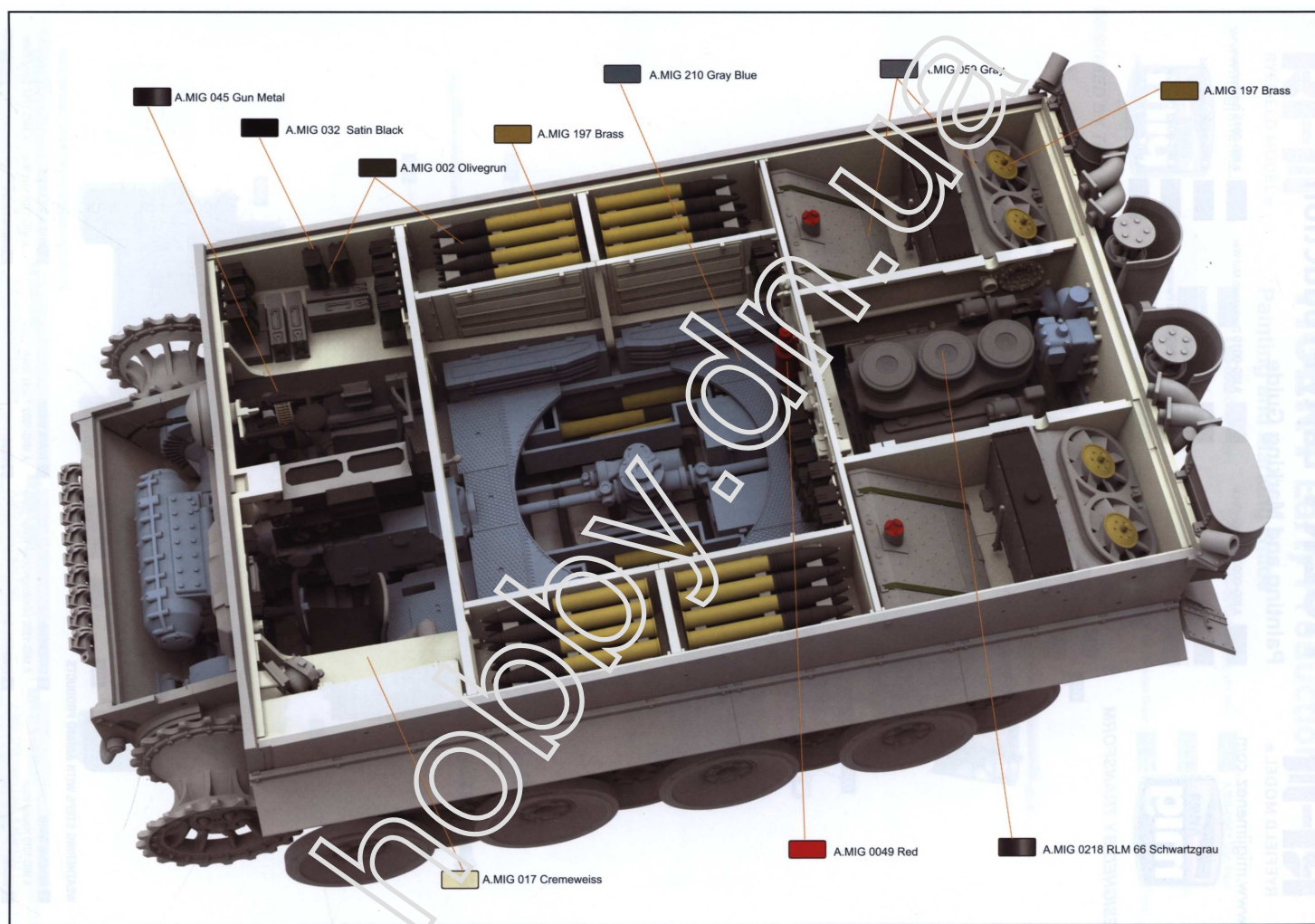

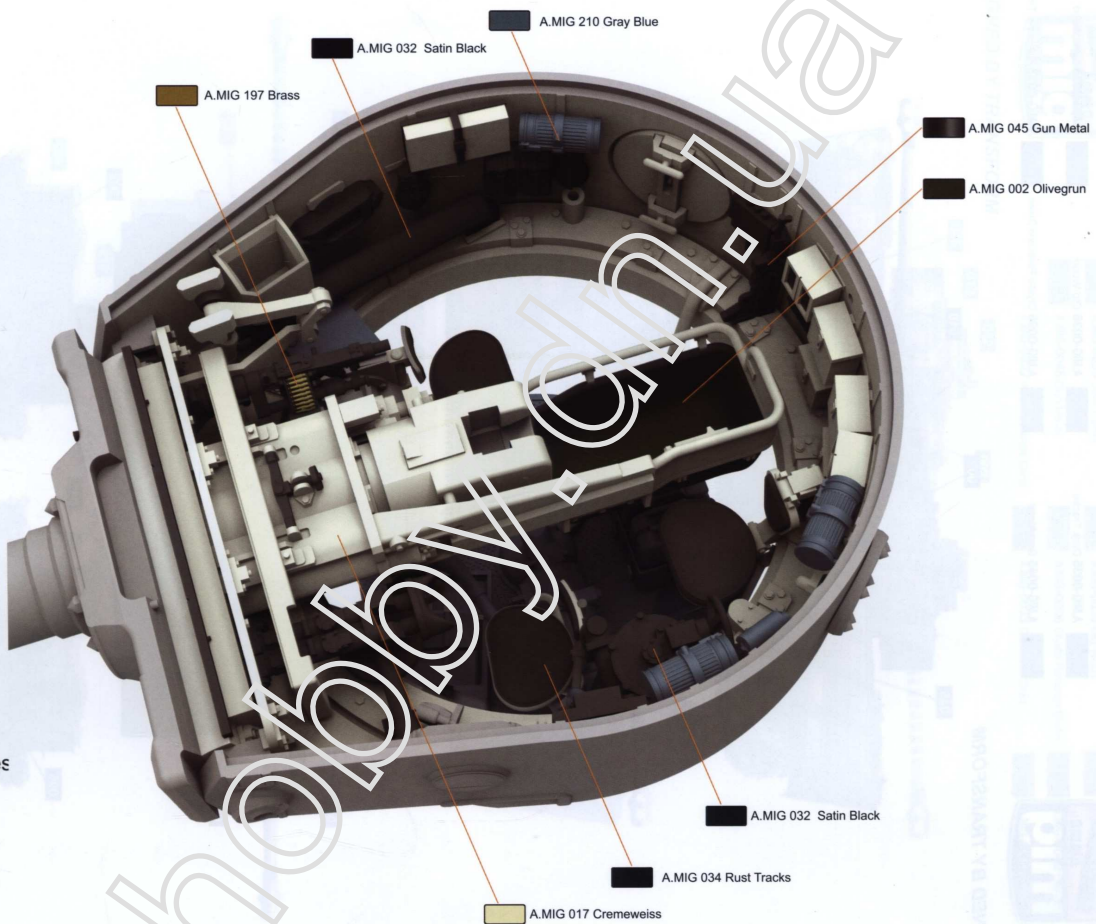

Color info and profiles
by

