

## CH-37C 'Deuce USMC'

### EN

In 1950 US Navy together with US Marines came out with specifications calling for big Assault Transport helicopter. The machine had to be capable of transporting 26 fully-equipped troops and also capable of being used for transportation of belly mounted cargoes or casualties.

According to these specifications, Sikorsky company begun design works on twin engined helicopter under factory designation S-56. Four prototypes with military designation XHR2S-1 were ordered in 1951. After successful trials US Marines had ordered series production of HR2S-1 that started to be delivered in 1956. The first machines passed difficult tests that led to changes in R-2800 engines cooling, addition of ventral fin and some additional modifications. Eventually, fifty five HR2S-1s were assigned to units. Pilots unofficially named the machine Deuce.

US Army was also very interested in the powerful helicopter. After testing one prototype series of modified S-56 designated H-37A and later modernized to H-37B version. The machines got the combat name Mojave. Under the 1962 United States Tri-Service aircraft designation system were the H-37A redesigned to CH-37A, H-37B to CH-37B and HR2S-1 to CH-37C.

HR2S-1s were assigned to HMH-461 and 462 operational squadrons, Army H-37s served both in USA and Germany.

Both US Marines and US Army machines were deployed to Vietnam. They served mainly for weapons and troops transports to combat zones. Also, they were used for transport of damaged helicopters slung below the fuselage.

The surviving machines were handed over to National Guards and eventually displaced in 1974.

#### Technical data:

Main rotor diameter: 21.95m, Tail rotor diameter: 4.57m, Fuselage length: 19.76m, Max. Speed: 209 kmh, Max. Climb rate: 4362 m/s, Service ceiling: 2 650m, Range: 233m

### CZ

V roce 1950 společně vedení US NAVY a US Marines zformulovalo požadavky na velký „útočný, vyloďovací a výsadkový vrtulník“. Stroj měl být schopen přepravy celého ozbrojeného družstva, zároveň měl být použitelný například k přepravě raněných nebo transportu nákladů pod trupem.

Dle těchto požadavků začala firma Sikorsky konstruovat dvoumotorový typ pod továrním označením S-56. V roce 1951 byly objednány čtyři prototypy s vojenským označením XHR2S-1. Na základě úspěšných zkoušek objednalo US Marines sériové vrtulníky HR2S-1. Ty začalo US Marines přebírat v roce 1956. První stroje prošly náročnými testy, na jejichž základě byly uskutečněny změny v chlazení motorů R-2800, byl přidán kýl k ocasní ploše a provedeny další úpravy. Nakonec bylo do výzbroje zařazeno padesát pět kusů HR2S-1. Od pilotů obdržely neoficiální přezdívku Deuce.

US Army projevilo o výkonný vrtulník velký zájem. Po vyzkoušení jednoho prototypu objednalo sérii upravených S-56 pod označením H-37A, později modernizovaných na verzi H-37B. Stroje dostaly bojové jméno Mojave. V rámci unifikace označení v roce 1962 byly H-37A přeznačeny na CH-37A, H-37B na CH-37B a HR2S-1 na CH-37C.

HR2S-1 sloužily u operačních squadron HMH-461 a 462, armádní H-37 sloužily jak na území USA, tak v Německu.

Stroje jak US Marines, tak US Army se dočkaly nasazení ve Vietnamu. Sloužily zejména k přepravě zbraní a vojáků do bojových prostorů. Používaly byly i k transportu poškozených vrtulníků na závěsu pod trupem.

Přeživší stroje byly předány jednotkám Národní Gardy a vyřazeny byly definitivně v roce 1974

#### Tech. údaje:

Průměr hl. rotoru: 21,95 m, průměr vyr. rotoru: 4,57 m, délka trupu: 19,76 m, max. rychlost: 209 km/h, max. stoupavost: 4,62 m/s, dostup: 2 650 m, dolet: 233 m

We would like to thank to Mr. Donald Hinton and Ralph B. Young for their invaluable help during the preparation of this kit.

Děkujeme Donu Hintonovi a Ralphu B. Youngovi za jejich neocenitelnou pomoc při přípravě tohoto modelu.

## PLASTIC PARTS

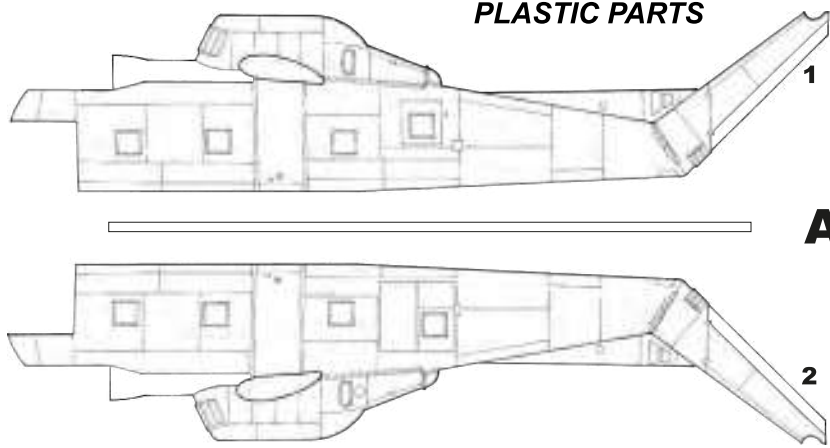

**A**

**B**

## PUR PARTS (PUR)

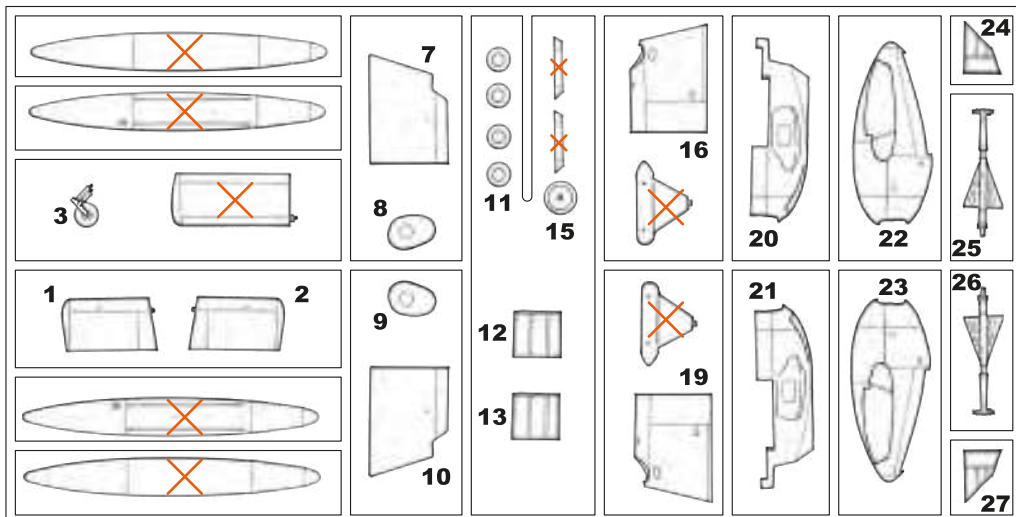
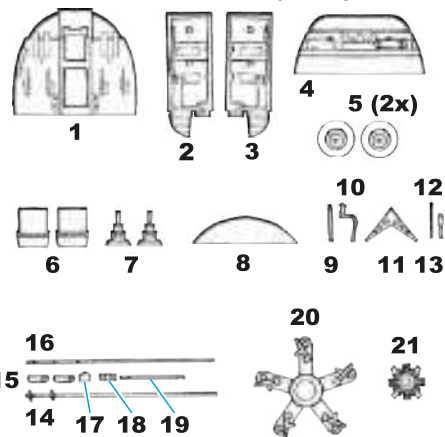

## FILM

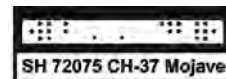

## CLEAR PARTS (CP)

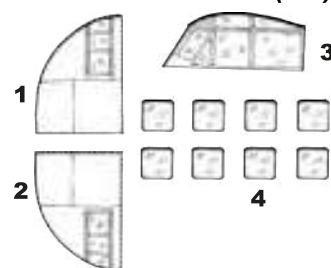

## Special MASK

**Tip and trick**  
For easier assembly we recommend use our pre-cut mask M72046, sold separately.

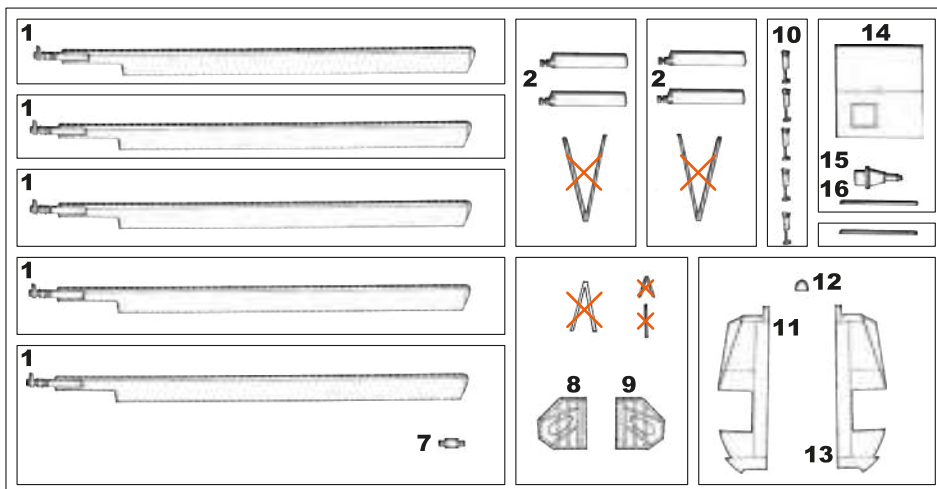
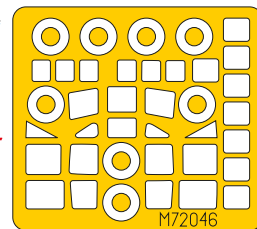

**C**

## PHOTO-ETCHED PARTS (PP)

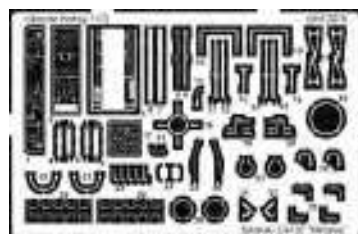

**D**

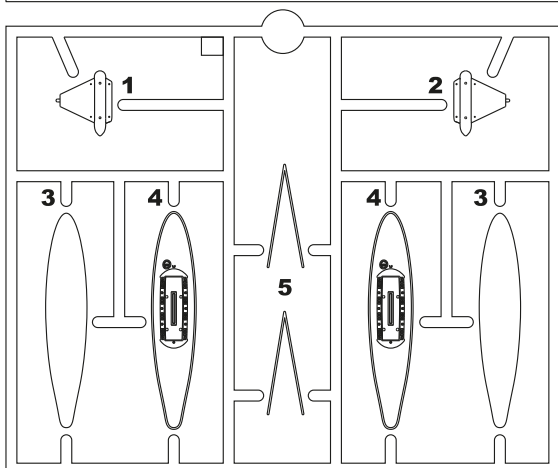

**X** Tento díl nepoužít  
Do not use this part

## SYMBOLS

**?** MOŽNOST VOLBY  
OPTIONAL  
NACH BELIEBEN  
OPTION

**👉** POUŽÍT KYANOAKRYLÁTOVÉ LEPIDLO  
INSTANT CYANOACRYLATE GLUE  
ZYANOAKRYLÁTKLEBER  
ADHÉSIF CYANOACRYLAT

**↪** OHNOUT  
BEND  
BIEGEN  
COURBER

**👤** ZHOTOVIT NOVÉ  
SCRATCH BUILD  
FERTIGSTELLEN  
ACHEVER

**🔪** ŘEZAT/VRTAT  
CUT OFF/DRILL  
ENTFERNEN  
DETACHER

**A** NATRÍT  
COLOUR  
FARBEN  
PEINDRE  
GSI colours code

**STEP 1**

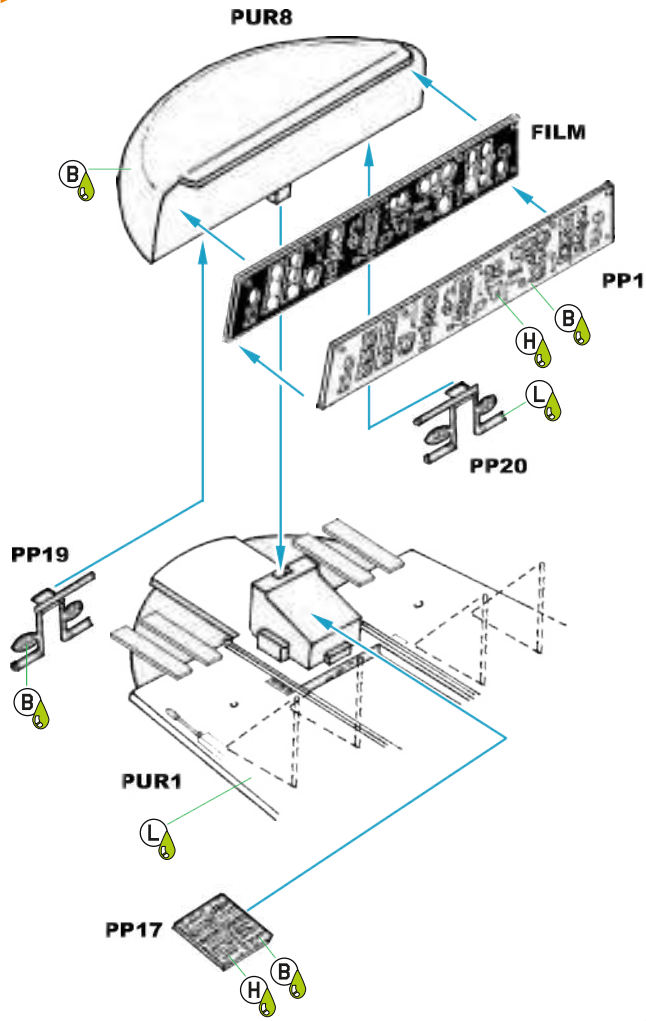

**STEP 2**

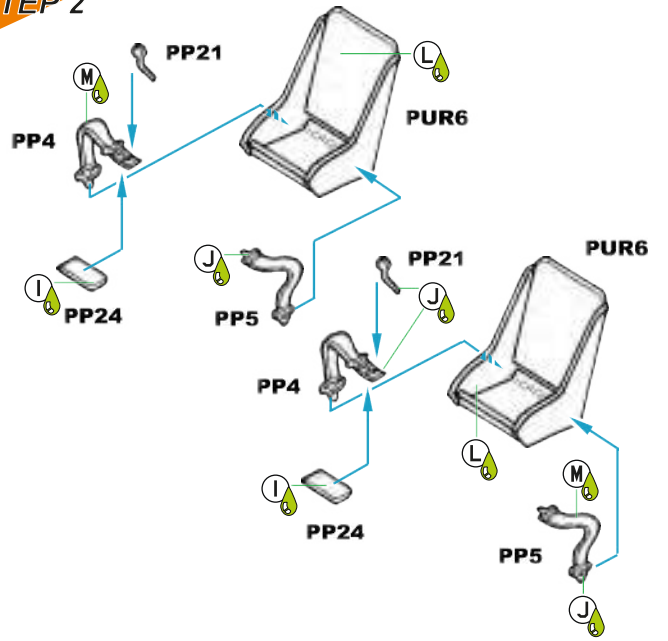

**STEP 3**

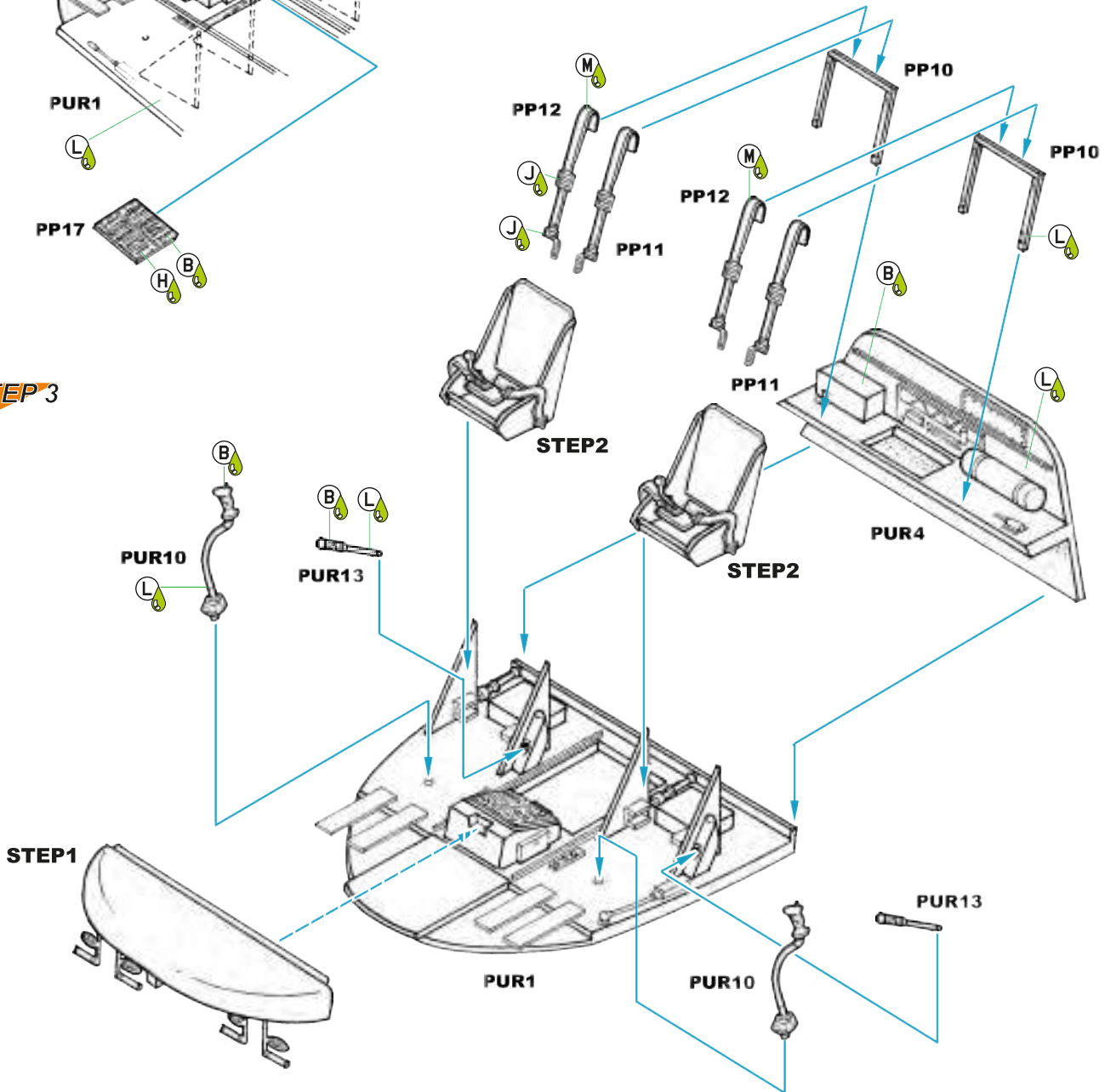

**STEP 4**

**STEP 5**

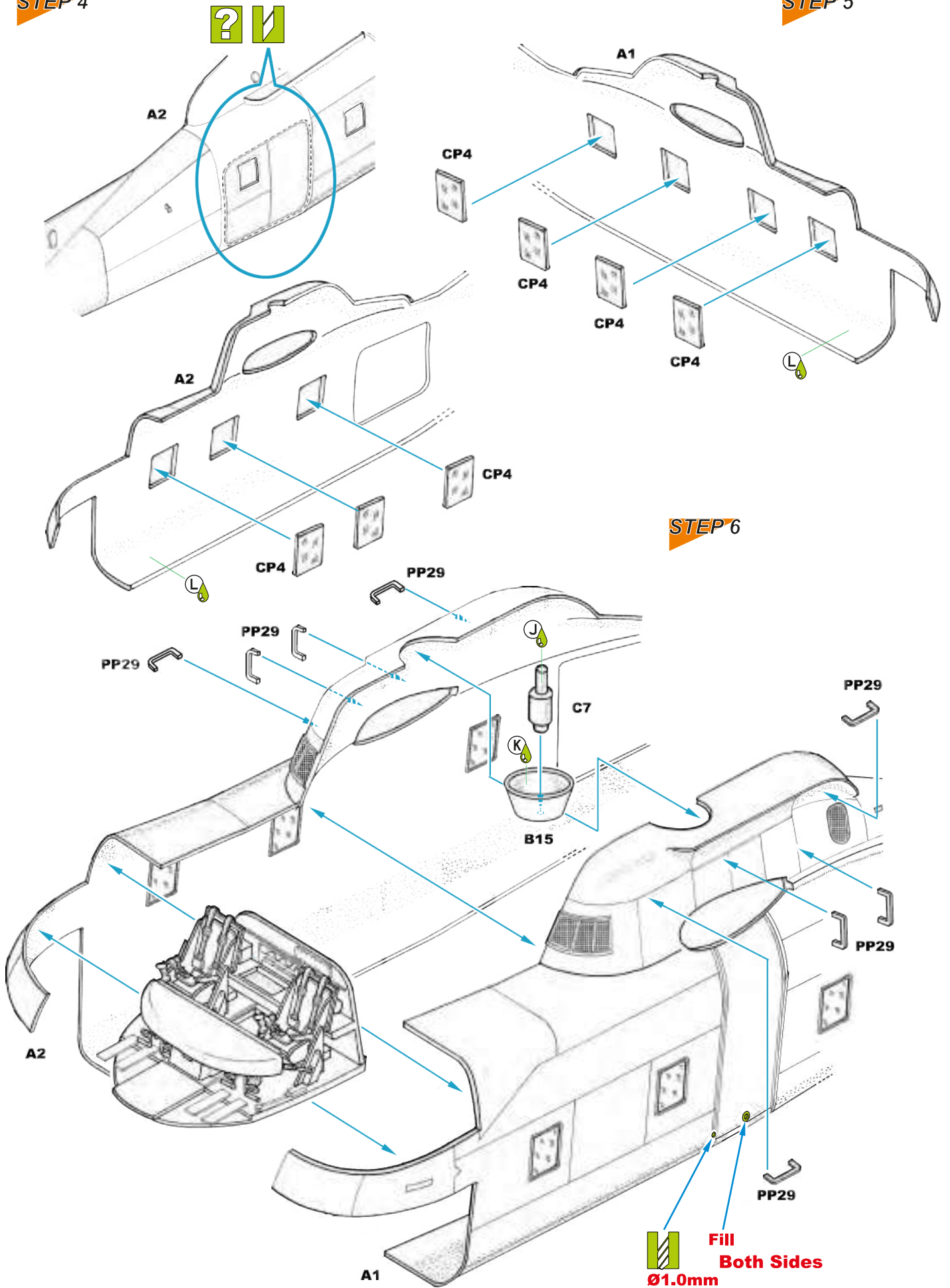

**STEP 7**

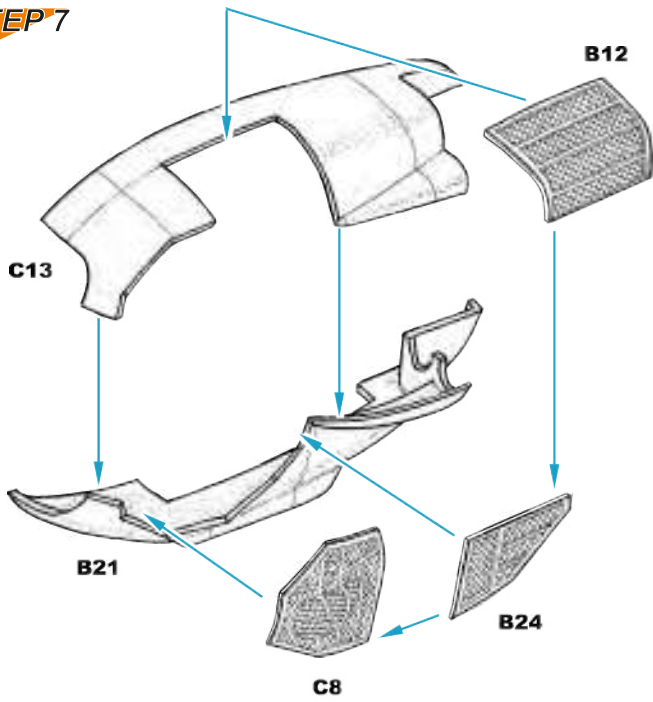

**STEP 8**

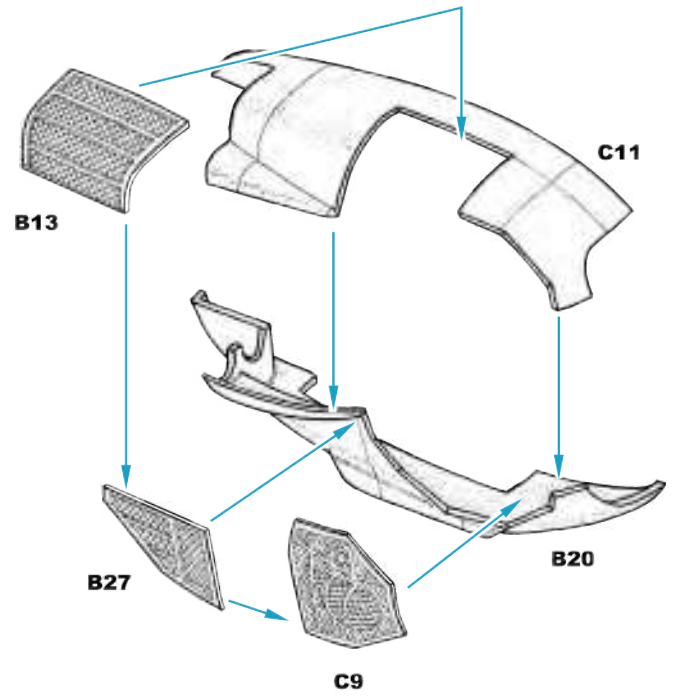

**STEP 9**

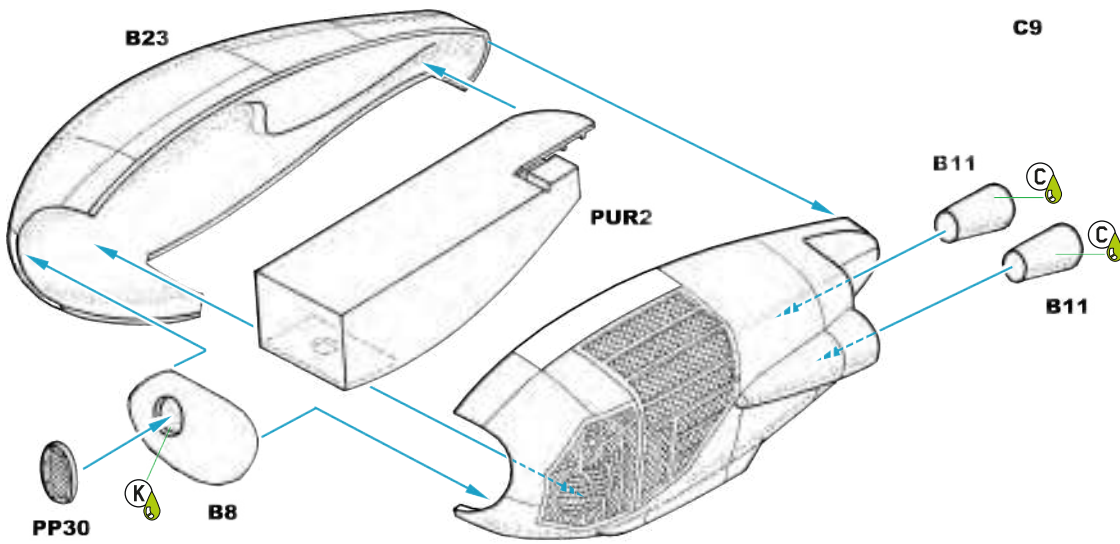

**STEP 10**

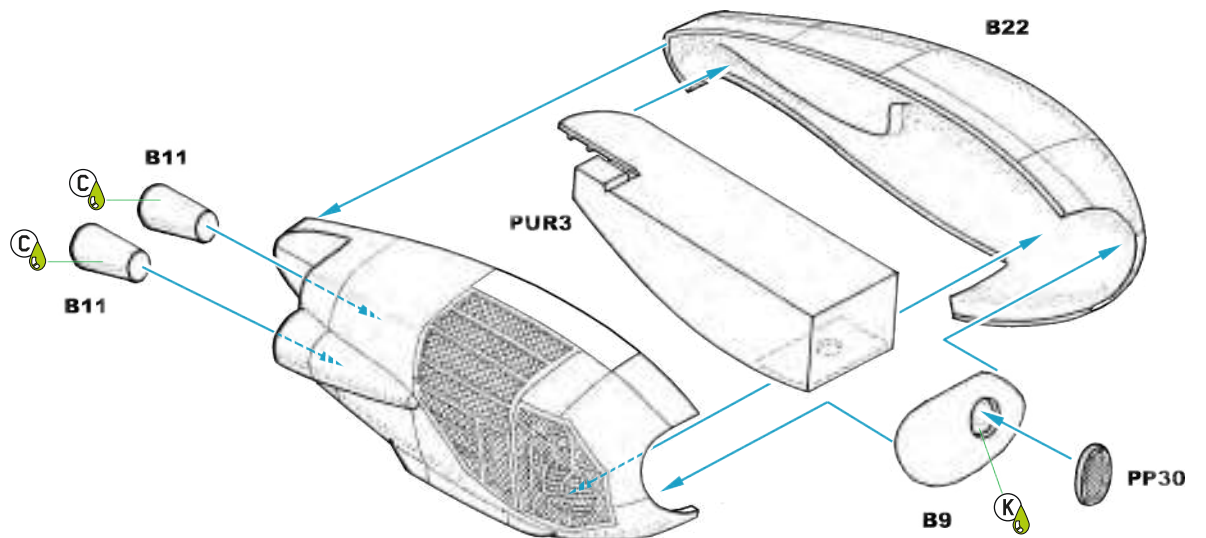

**STEP 11**

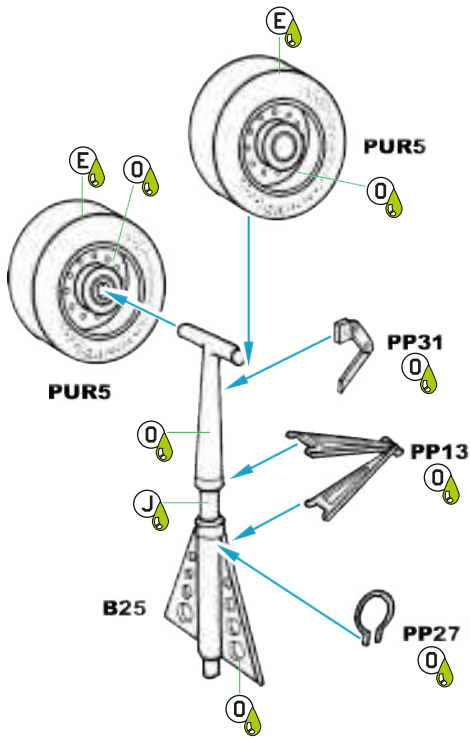

**STEP 12**

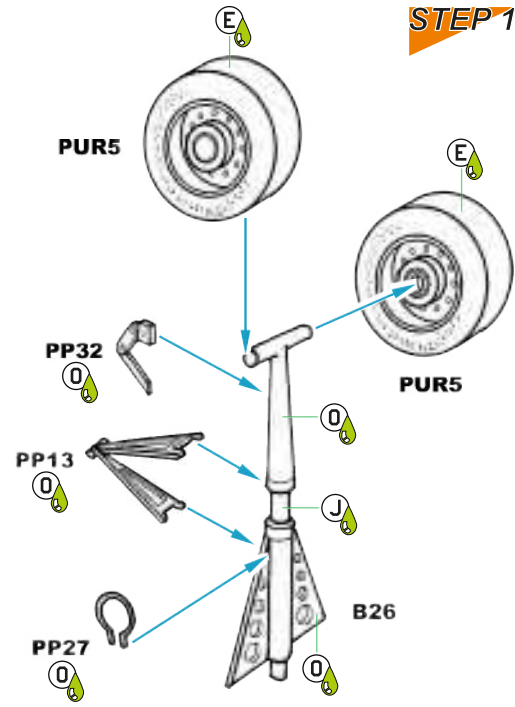

**STEP 13**

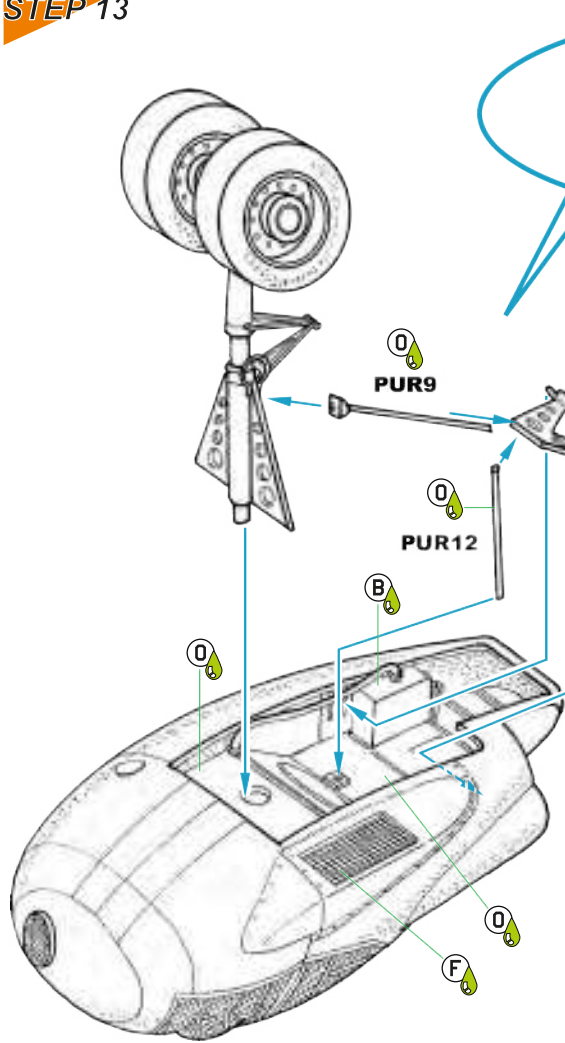

**STEP 14**

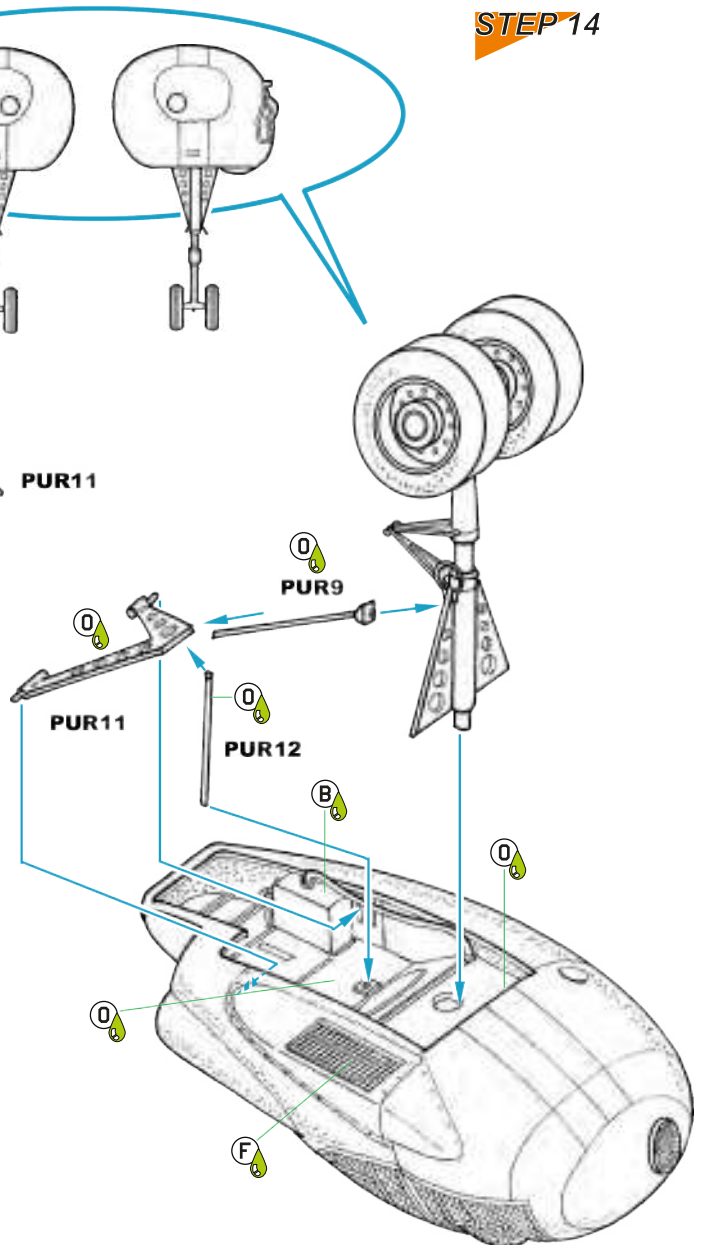

**STEP 15**

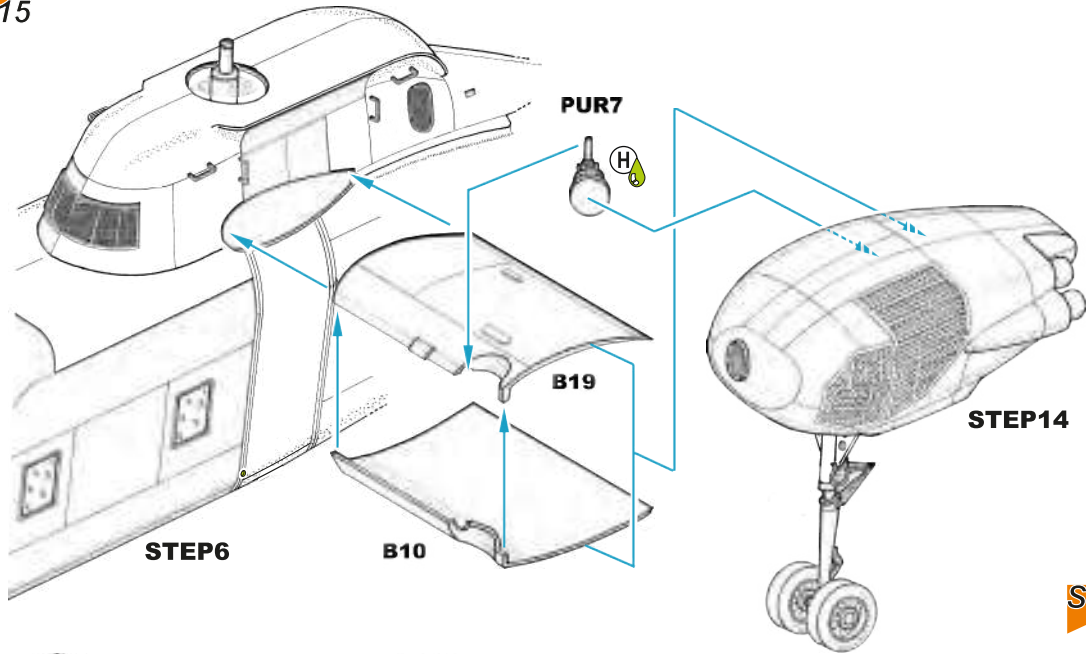

**STEP 16**

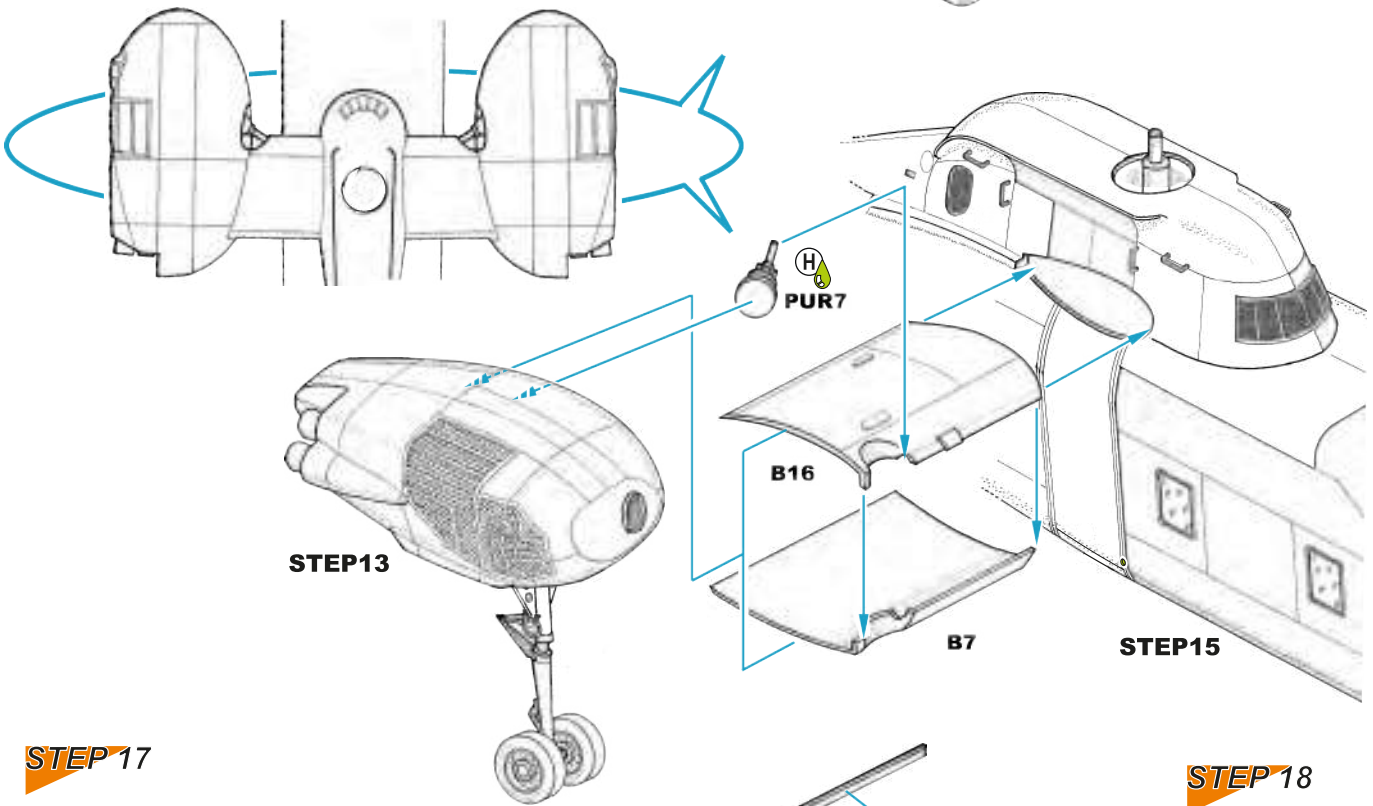

**STEP 17**

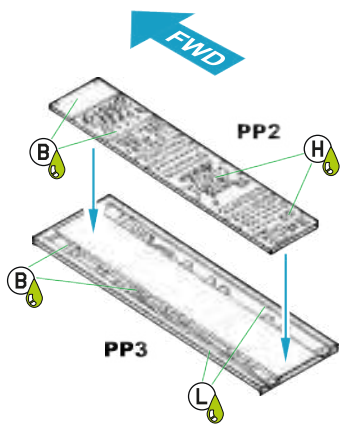

**STEP 18**

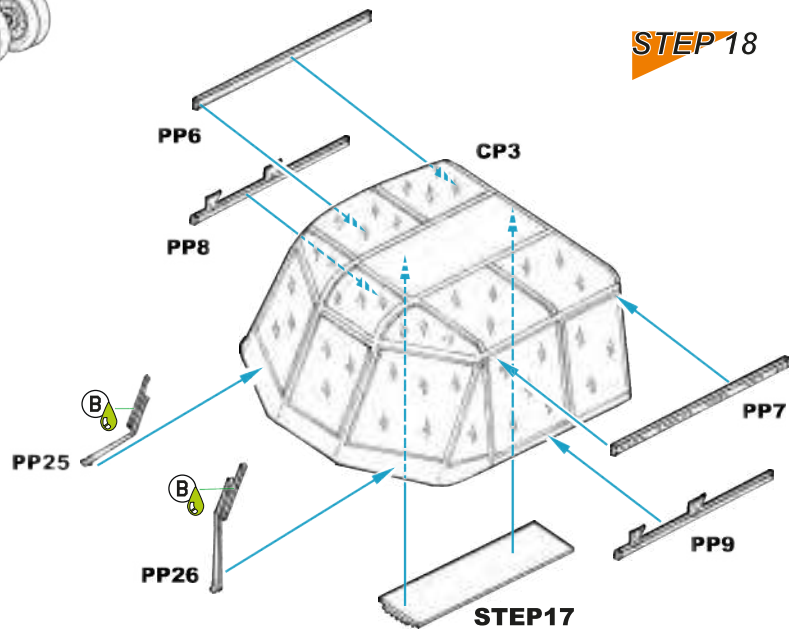

**STEP 19**

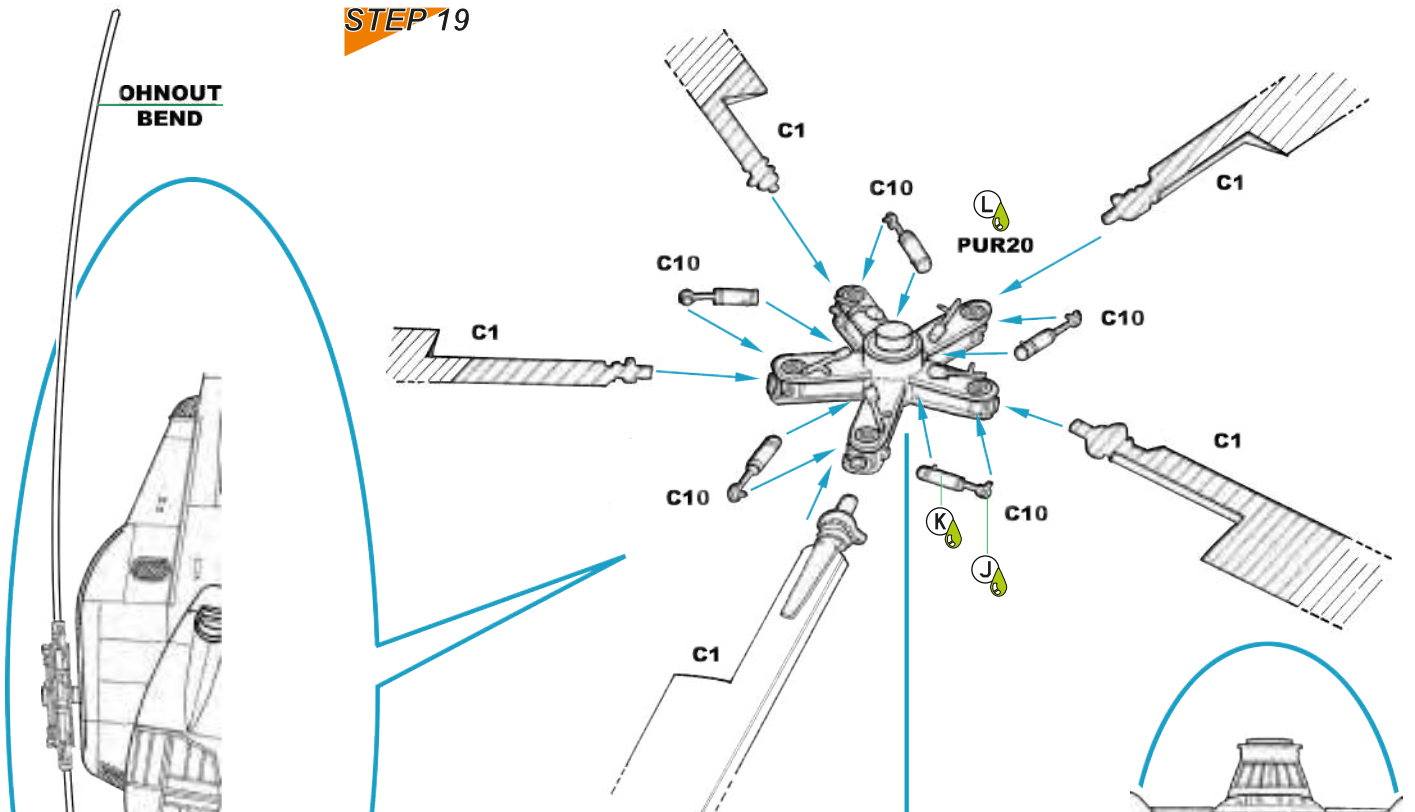

**STEP 20**

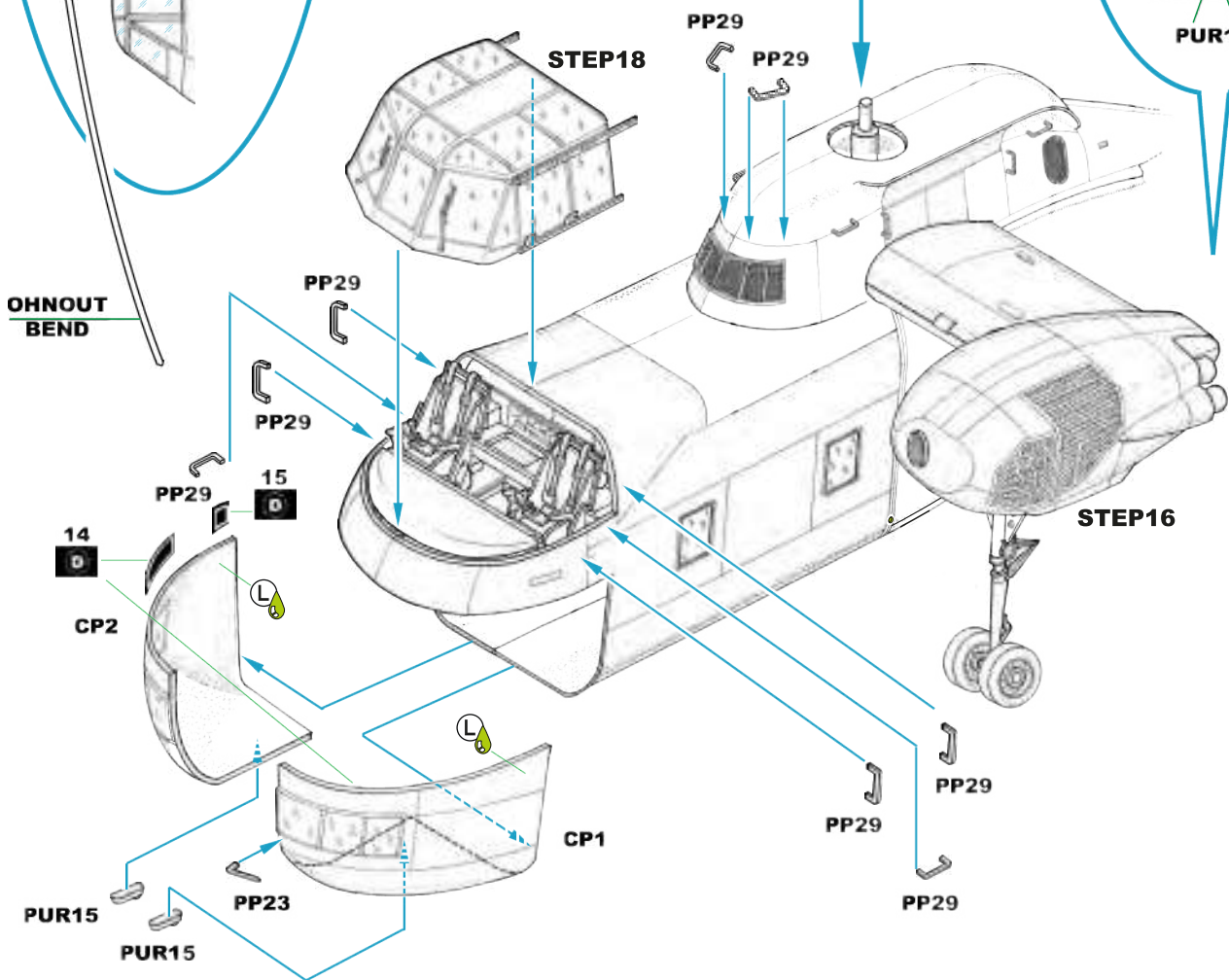



**STEP 21**

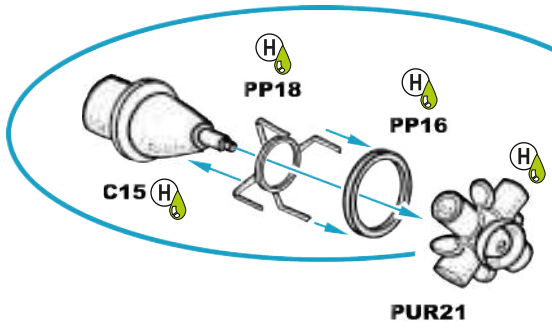

**STEP 22**

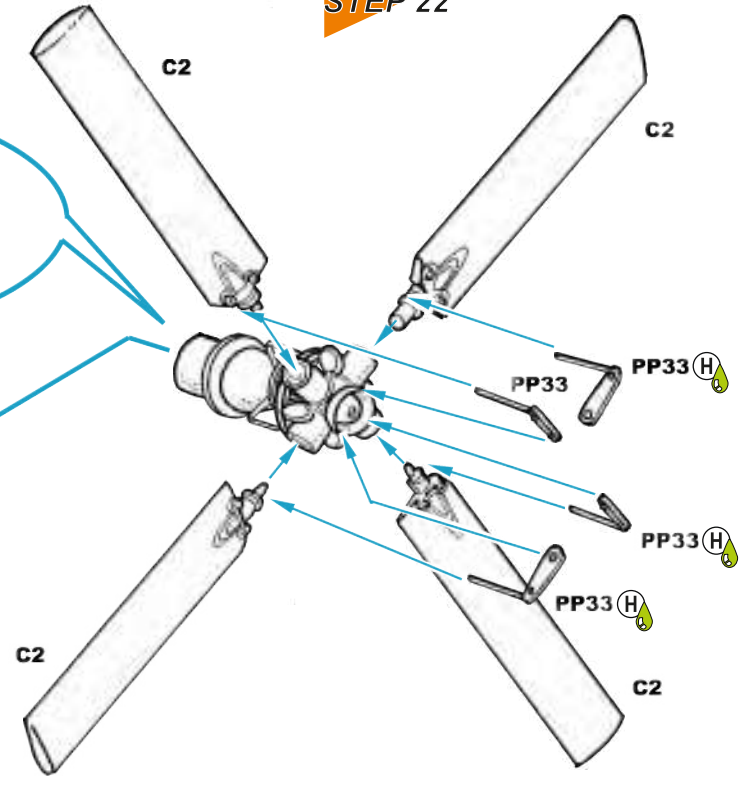

**STEP 20**

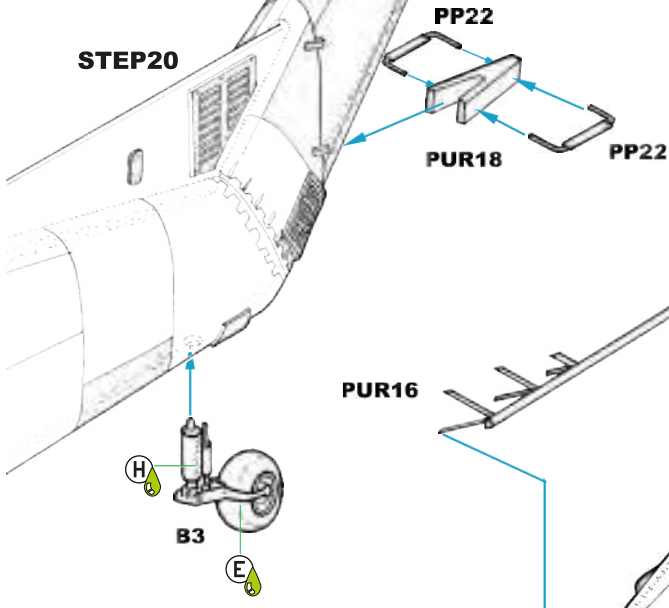

**STEP 23**

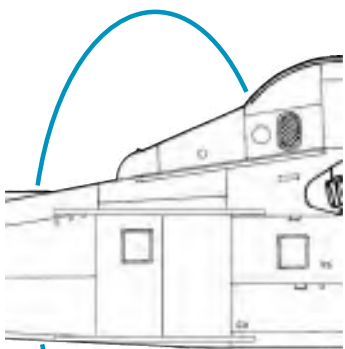
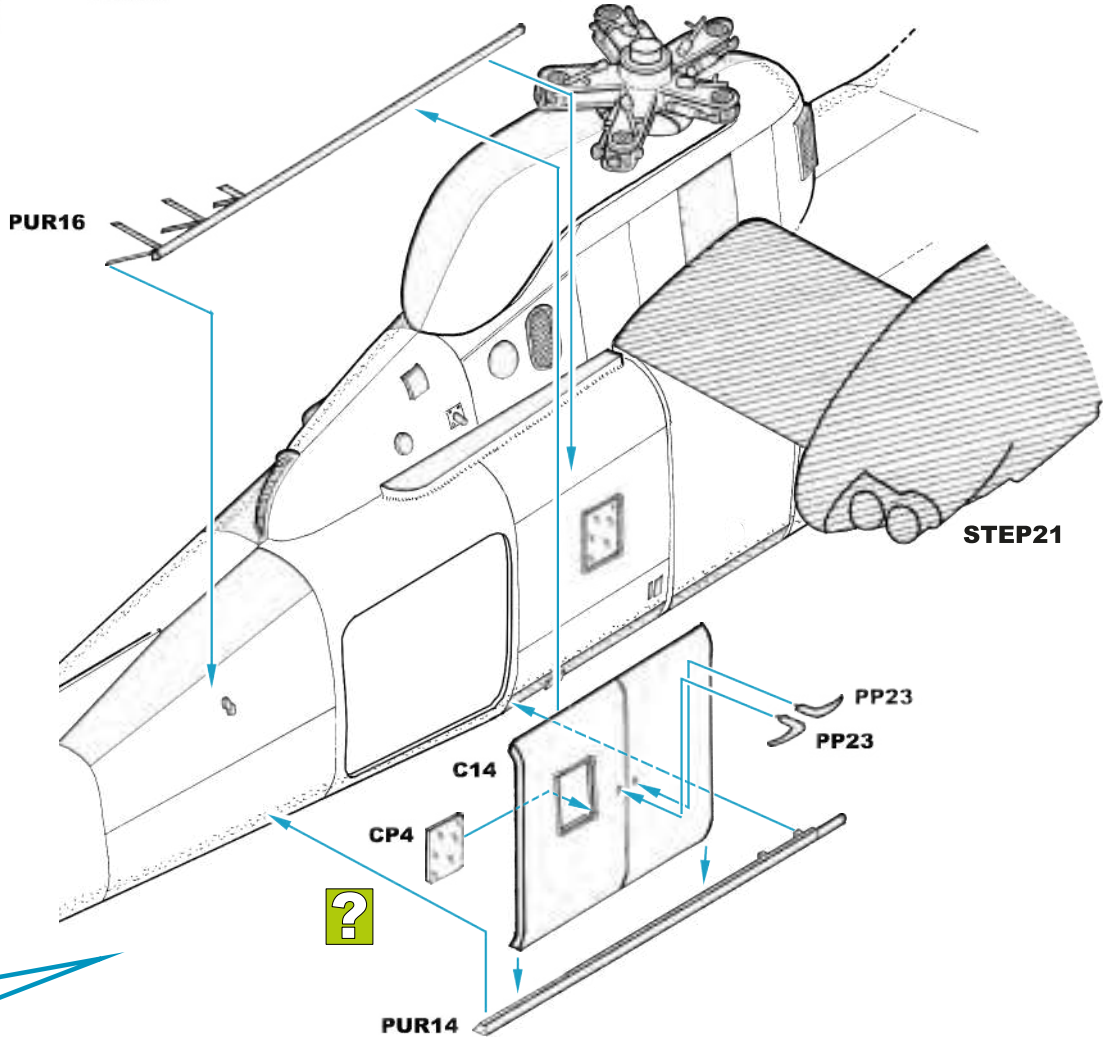

**STEP 24**

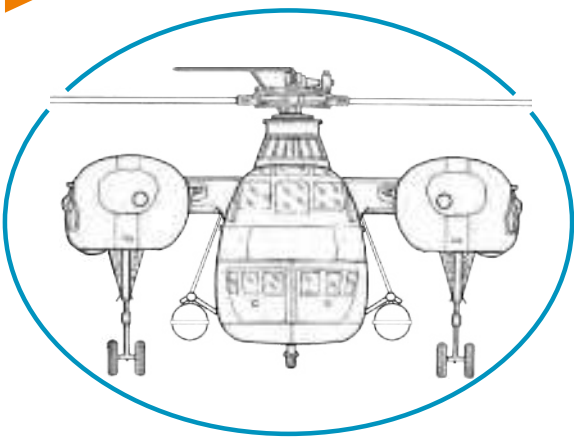

**STEP 23**

**PUR17**

**C**

**D5**

**D**

**PP28**



**D1**

**PP15**

**PUR19**

**B**

**D4**

**D3**



**STEP 25**

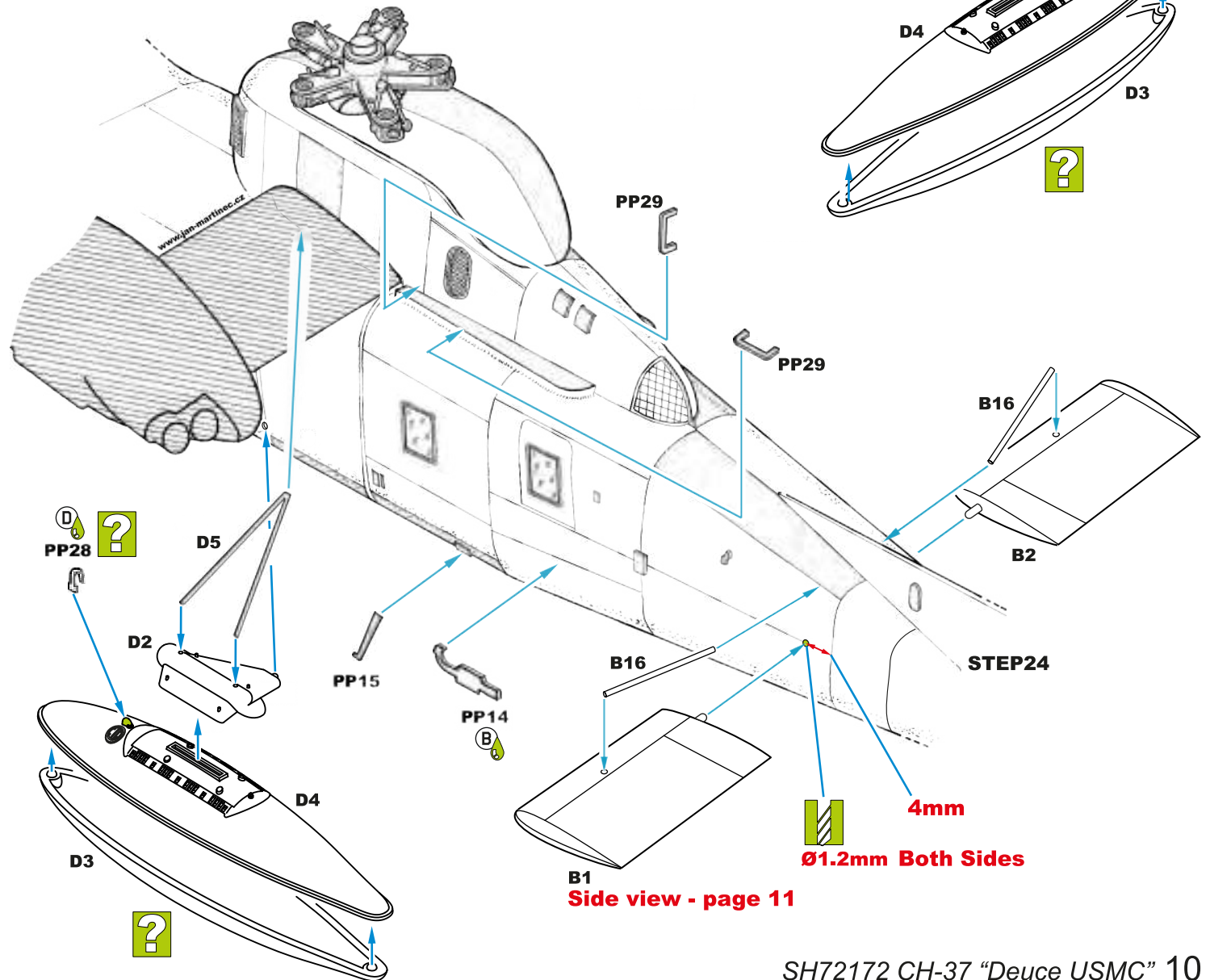

**PP29**

**PP29**

**B16**

**B2**

**STEP 24**

**PP28**



**D5**

**D2**

**PP15**

**PP14**

**B**

**B16**

**D4**

**D3**



**B1**

**Side view - page 11**

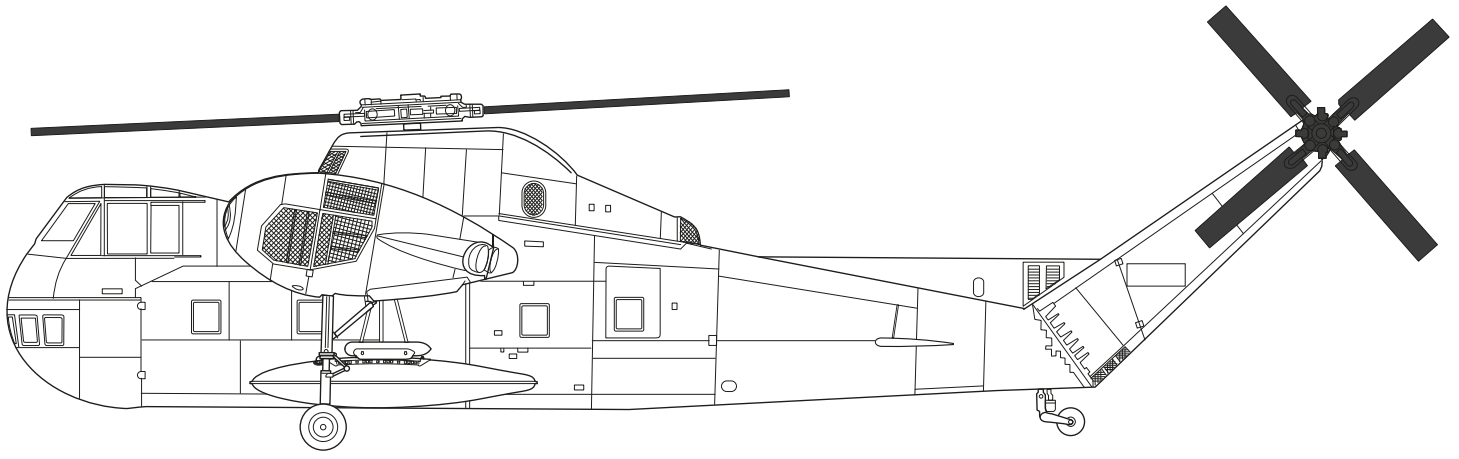

**129-H1011 SANDING STICK** – Four different grits of sanding papers on one sanding stick.

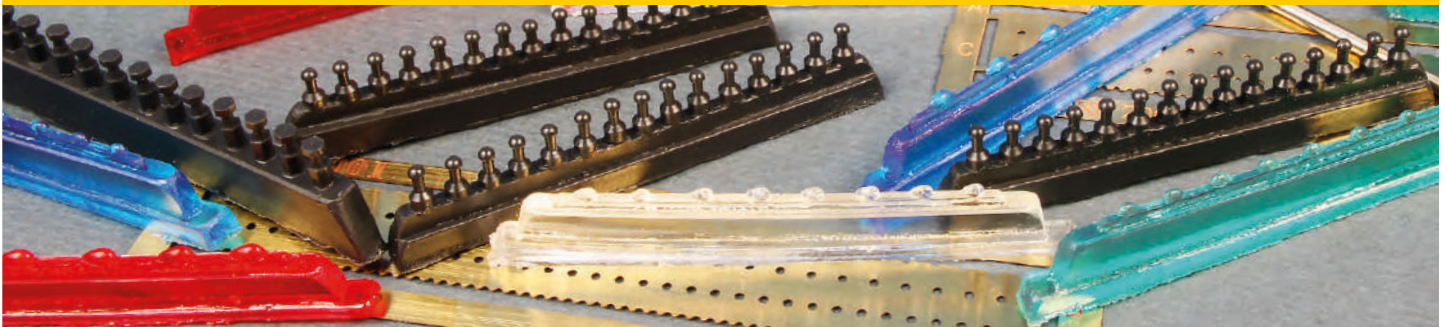

**RIVETS AND BOLTS**

- 129-001** Button Head Rivet 1.2 mm (60 pcs)
- 129-002** Button Head Rivet 1.0 mm (60 pcs)
- 129-003** Button Head Rivet 0.8 mm (60 pcs)
- 129-005** Hexagonal Head Bolt 1.5 mm (60 pcs)

- 129-015** Hexagonal Head Bolt 0.8 mm (44 pcs)
- 129-006** Bolt with Hexagonal Head 2.0 mm (44 pcs)
- 129-007** Bolt with Hexagonal Head 1.5 mm (60 pcs)

**NAVIGATION LIGHT SETS**

- 129-010** Navigation Light, Clear (any scale)
- 129-011** Navigation Light, Red (any scale)
- 129-012** Navigation Light, Green (any scale)
- 129-013** Navigation Light, Blue (any scale)



*Star Dust*  
weathering pigments



**H1020 Razor Saw Profi Set**



A new type handle for our razor saws.

Also contains H1018 and H1019 spare saws.

**H1018**  
Triangle Razor Saw (1pc)



**H1019**  
Multi-Shift Razor Saw (1pc)



CH-37C , YF7/145858, HMH-462, Marine Corps Air Station Santa Ana, Kalifornie, září 1961  
 CH-37C , YF7/145858, HMH-462, Marine Corps Air Station Santa Ana, California, September 1961

SCHEME A

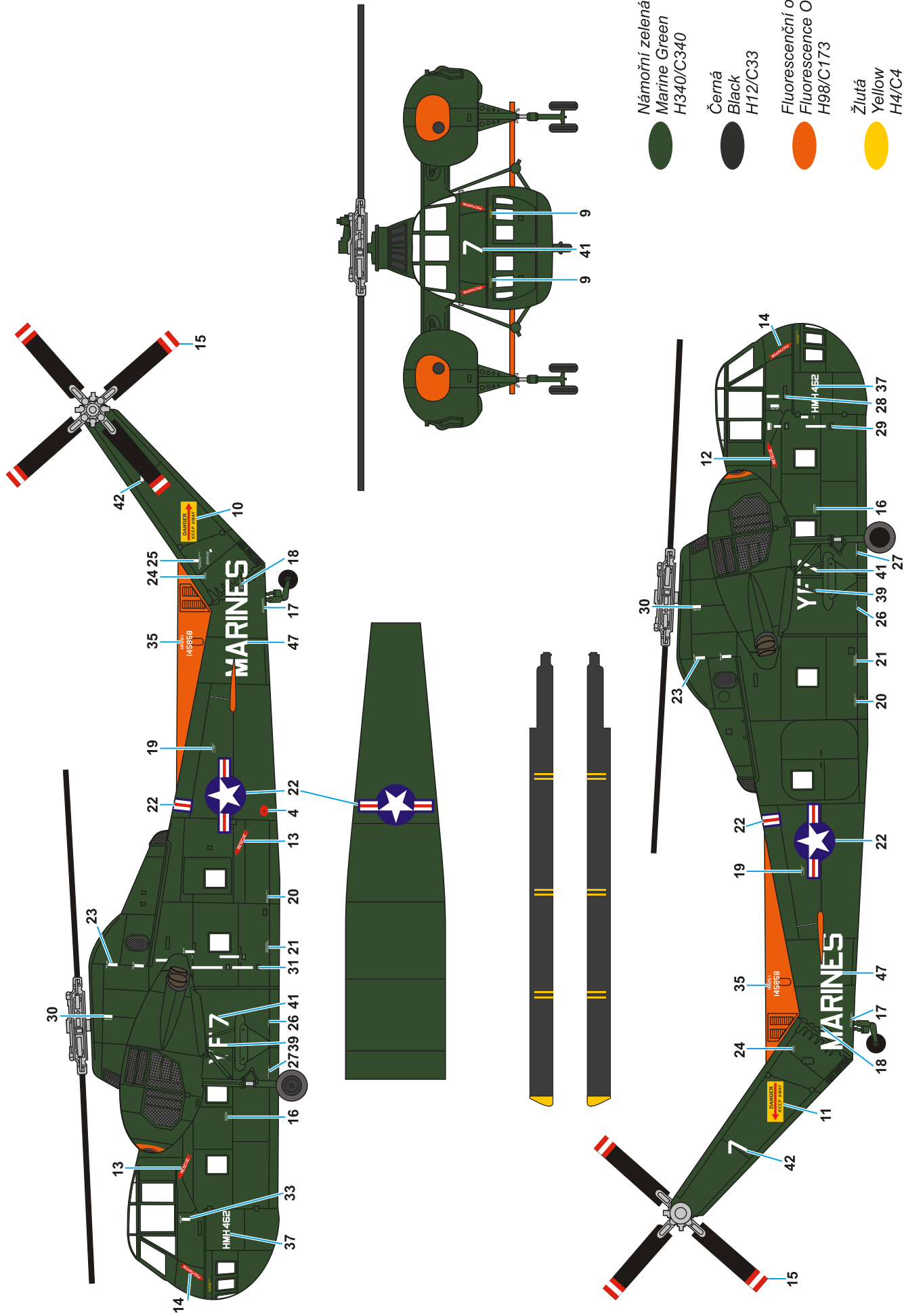

- Námořní zelená  
Marine Green  
H340/C340
- Černá  
Black  
H12/C33
- Fluorescenční oranžová  
Fluorescence Orange  
H98/C173
- Žlutá  
Yellow  
H4/C4

CH-37C , 9/145864, HMH-462, Marine Corps Air Station Santa Ana, Kalifornie, květen 1962  
 CH-37C , 9/145864, HMH-462, Marine Corps Air Station Santa Ana, California, May 1962

**SCHEME B**

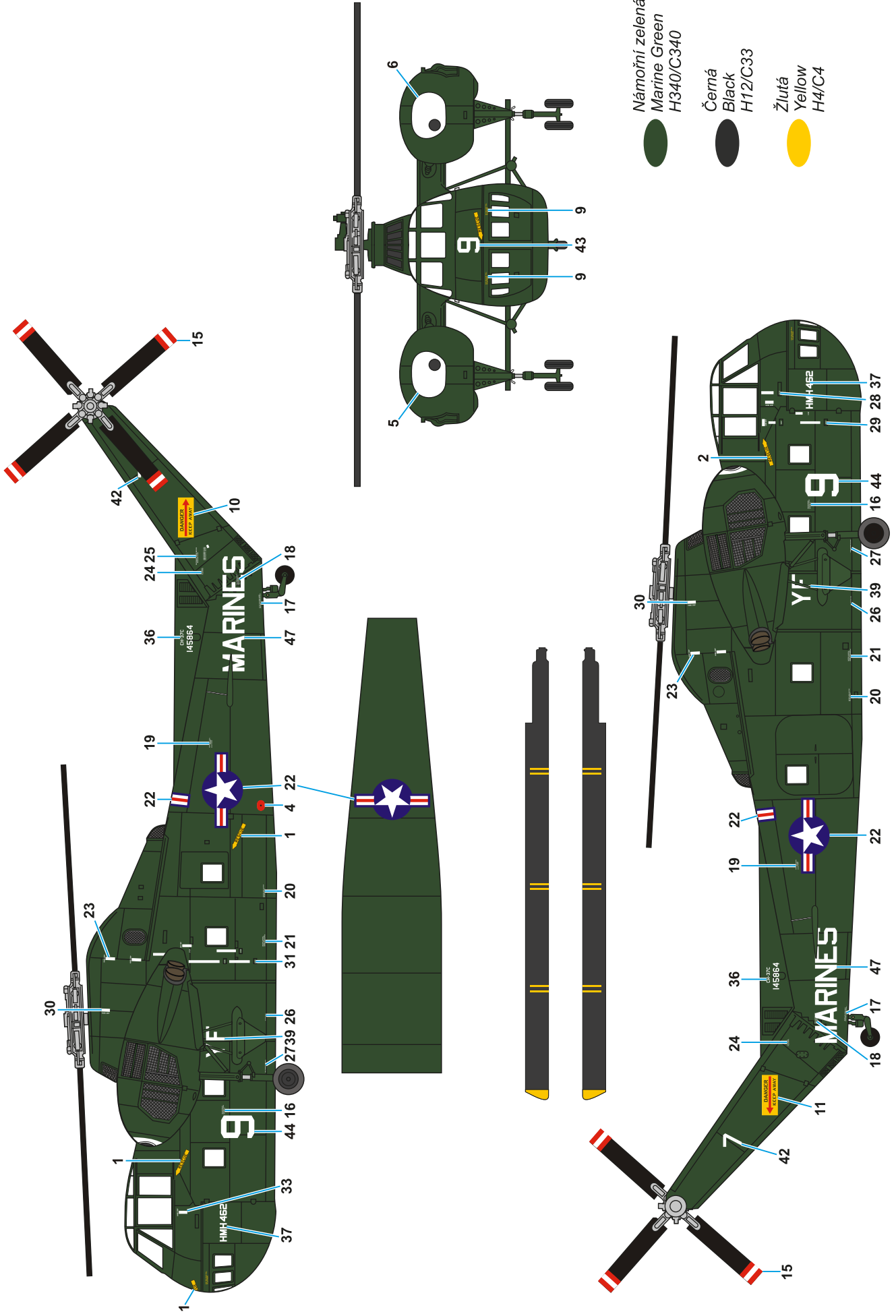

CH-37 C, 110/145875, Marine Corps Air Station New River, Jacksonville, Severní Karolína, 1664-65.  
 CH-37 C, 110/145875, Marine Corps Air Station New River, Jacksonville, North Carolina, 1664-65.

SCHEME C

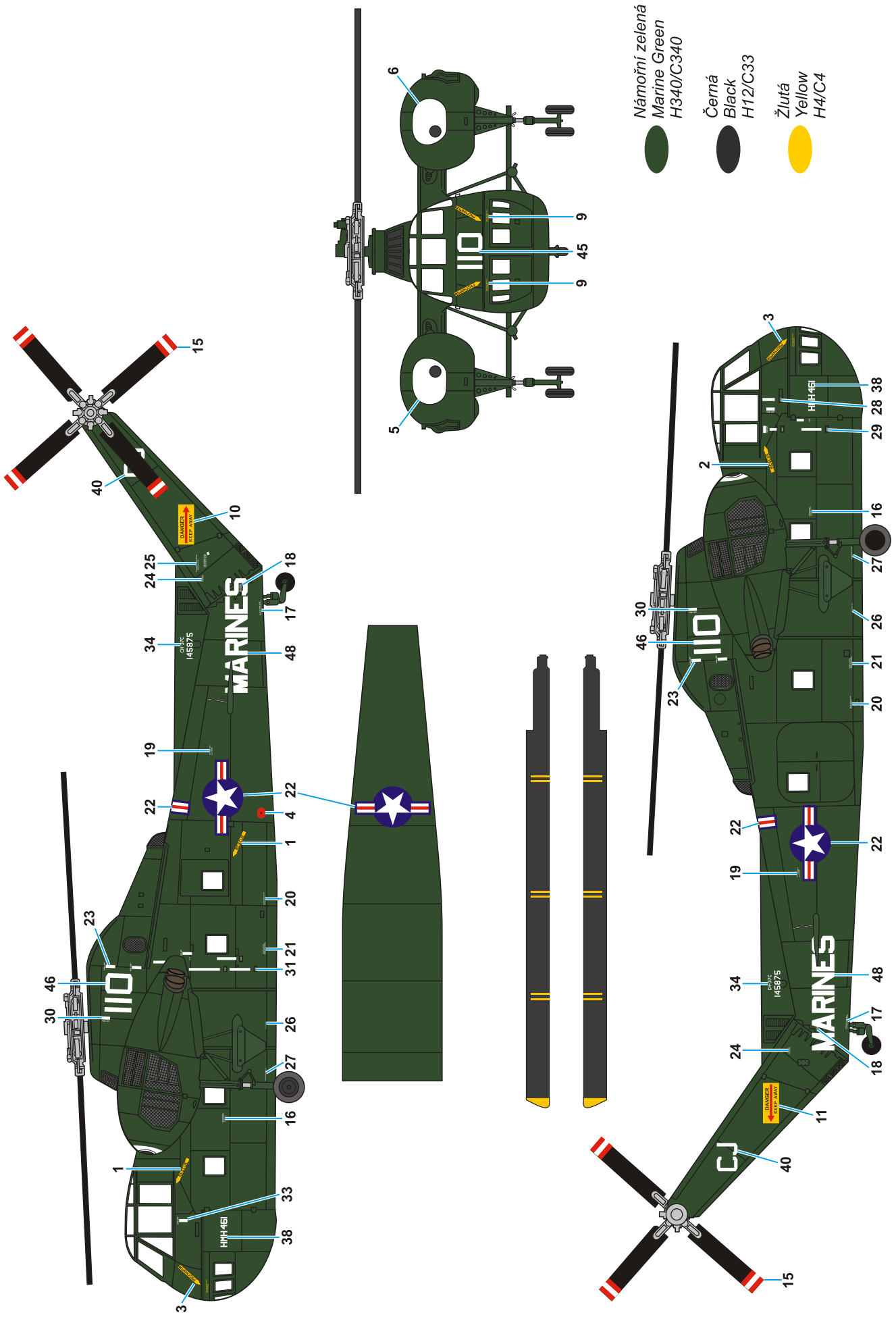



1/72  
SH72384  
**JA-37 VIGGEN FIGHTER**



1/72  
SH72390  
**SF-37 VIGGEN**  
*Reemus*  
**'Swedish Eyes'**

**CMK SETS for Viggen kits 1/72**



**Q72343**  
SAAB Viggen  
Thrust Reverser



**Q72344**  
SAAB Viggen  
Air Brakes Set



**Q72355**  
AJ/SK/SH-37  
Viggen Control  
Surface

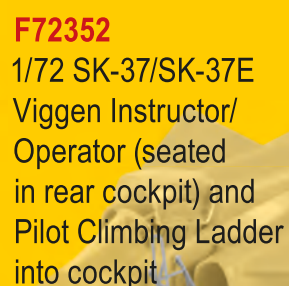

**F72352**  
1/72 SK-37/SK-37E  
Viggen Instructor/  
Operator (seated  
in rear cockpit) and  
Pilot Climbing Ladder  
into cockpit



**Q72346**  
SAAB Viggen  
Ejection  
Seat

**7328**  
Bofors m/70  
Rocket pod (2 pcs)



**Q72347**  
SAAB Viggen  
Ram Air Turbine (RAT)



**Q72345**  
SAAB Viggen Wheels

**M72002**  
SAAB 37 Viggen  
Single Seater Mask



**M72003**  
SAAB 37 Viggen  
Two Seater Mask

**Special  
MASK**

**Special  
HOBBY**

facebook.com/specialhobby  
[WWW.SPECIALHOBBY.EU](http://WWW.SPECIALHOBBY.EU) | [WWW.CMKKITS.COM](http://WWW.CMKKITS.COM)

**CMK**  
CZECH  
MASTER'S KITS

# 1/72 AH-1G Cobra 'Early Tails Over Nam'

RESIN SETS & MASKS  
for AH-1G Cobra

M72007  
AH-1G Cobra  
Inside / Outside MASK

Special  
MASK



Q72330  
AH-1G Early - Emerson  
Electric TAT-102  
(single weapon) turret

Q72331  
AH-1G - Emerson Electric  
M28 (dual weapon) turret

Q72209  
AH-1G Cobra Seats

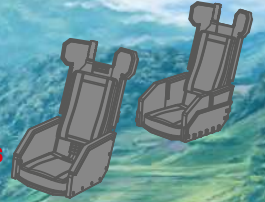

# 1/72 Mirage IIIC 'Armée de l'Air'

RESIN SETS & MASKS  
for Mirage IIIC

M72041  
Mirage IIIC  
MASK

Special  
MASK



Q72401  
Mirage III Wheels

Q72402  
Mirage III Atar 9B  
Engine Nozzle

Q72403  
Mirage III  
Seat



# 1/72 C-41A 'US Transport Plane'

RESIN SETS & MASKS  
for C-41A (CASA C.212)

M72019  
CASA C.212 / C-41A  
Inside / Outside MASK

Special  
MASK

7407  
CASA C-212 / C-41A Wing Flaps



Special  
HOBBY

facebook.com/specialhobby  
WWW.SPECIALHOBBY.EU | WWW.CMKKITS.COM

CMK  
CZECH  
MASTER'S KITS