

72137 Scottish Aviation 1/72  
Twin Pioneer

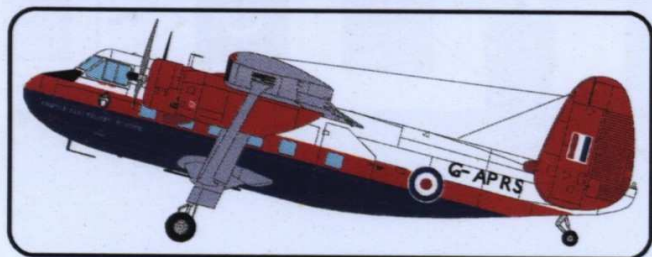

### Stručná historie Scottish Aviation Twin Pioneer

Vývoj tohoto víceúčelového letounu byl zahájen na počátku 50 let minulého století. Byl koncipován jako dvoumotorový hornoplošník s pevným podvozkem a trojitými ocasními plochami. Jeho velkou výhodou byl krátký vzlet a přistání - dle dnešních propozic letounu kategorie STOL.

Letoun byl poháněn dvojicí pístových motorů Alvis Leonides o výkonu 564 kW každý.

Prototyp Twin Pioneera vzlétl 25. června 1955 na letišti Prestwick a následně byl prezentován na letecké výstavě ve Farnborough. Pro účely další prezentace ve světě byly vyrobeny tři předseriové stroje.

Do roku 1958 bylo vyrobeno 32 ks první série, které našly uplatnění jak v civilní tak vojenské službě. Zákazníci oceňovali zejména vlastnosti krátkého vzletu a přistání z nebezpečných ploch. Uživatelé byli například Indonésie, Kuwait, Malajsie, Nepál, Filipíny a další země. V civilní verzi mohl Twin Pioneer pojmout až 17 cestujících.

Tři Twin Pioneery zakoupila nizolandská společnost Kroonduif (pobočka KLM), které nasadila do operací v Papui-Nové Guineji. Letouny byly používány i k výcvikovým účelům, např. v pilotní škole Empire Test Pilot School ve Farnborough.

Největším odběratelem vojenských verzí pod označením CC.1 byla RAF s počtem 39 ks.

Letouny byly nasazovány v oblastech Blízkého i Dálného východu. Byly schopny nést i bomby zavěšené pod pahýlem křídla na spodní části trupu. Dalšími vojenskými uživateli byly Malajsie, Nepál a Omán.

V roce 1958 byla zahájena výroba 2. série s motory Pratt & Whitney Wasp R-1340 a v roce 1959 série 3. s vylepšenými motory Alvis Leonides 531. V této sérii byly ale vyrobeny pouze 2 ks.

Twin Pioneery sloužily až do roku 1968 (jednotlivé letouny až do sedmdesátých let) a jejich celková produkce činila 87 ks.

#### Technická data:

Rozpětí (m)	23,32
Délka (m)	13,79
Výška (m)	3,73
Max. rychlost (km/hod)	266
Dolet (km)	1287
Dostup (m)	6098

# VALOM

Zlešická 1808/10 148 00 Praha 4 - Chodov  
Czech Republic



### A Brief History of the Scottish Aviation Twin Pioneer

Development of this multipurpose aircraft was launched in the early 1950s. It was conceived as a twin-engine high-wing monoplane with fixed undercarriage and triple tailfin. Its great advantage was its short take-off and landing distance - according to today's terminology it was an STOL aircraft.

The aircraft was powered by two Alvis Leonides piston engines of 564 kW each. The Twin Pioneer prototype took off from Prestwick Airport on 25 June 1955 and was subsequently presented at the Farnborough Air Show. Three pre-production machines were produced for the purpose of further demonstrations around the world.

By 1958, 32 of the first series had been produced, which were used in both civilian and military service. Customers especially appreciated the characteristics of short take-off and landing from unprepared surfaces. The users included, e.g., Indonesia, Kuwait, Malaysia, Nepal, the Philippines and other countries. In its civilian version, the Twin Pioneer could accommodate up to 17 passengers.

Three Twin Pioneers were also purchased by the Dutch company Kroonduif (KLM branch), and deployed in operations in Papua New Guinea. The aircraft were also used for training purposes, one of them at the Empire Test Pilot School in Farnborough.

The biggest buyer of the military versions under the name CC.1 was the RAF with 39 units.

The airplanes were deployed in the Near and Far East. They were able to carry bombs suspended under the stub wings at the bottom of the fuselage. Other military users were Malaysia, Nepal and Oman.

In 1958, production of the 2<sup>nd</sup> series with Pratt & Whitney Wasp R-1340 engines and in 1959, the 3<sup>rd</sup> series with the improved Alvis Leonides 531 engines was launched respectively. In the latter series, however, only 2 aircraft were made.

Twin Pioneers served until 1968 (single aircrafts up to the 1970s) and their total production amounted to 87 aircraft.

#### Technical data:

Span (ft)	76ft 6in
Length (ft)	45ft 3in
Height (ft)	12ft 3in
Top speed (mph)	165
Range (mils)	791
Servis ceiling (ft)	20000

Plastikové díly

Plastic Parts

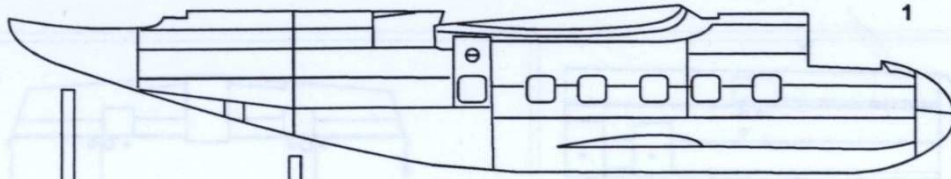

1

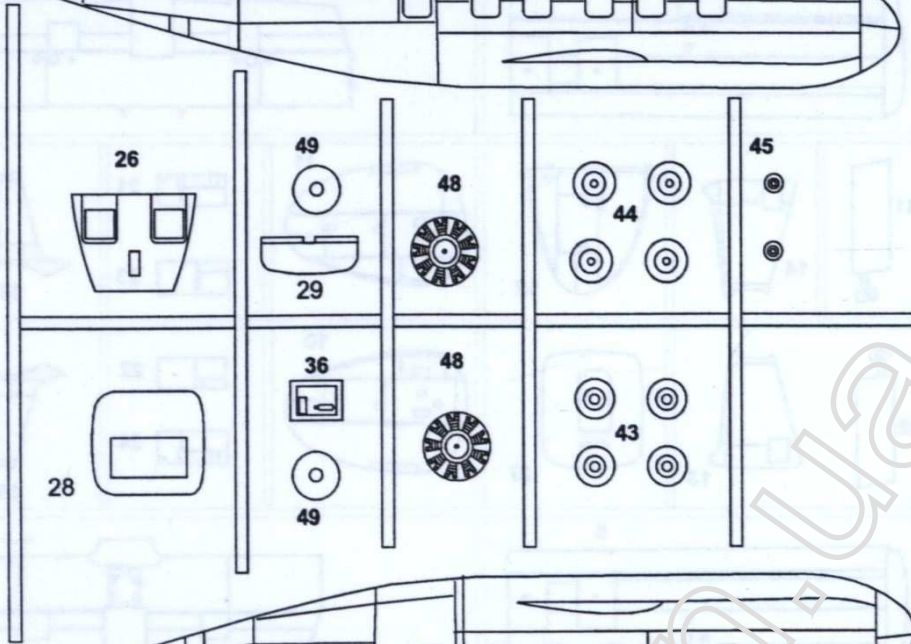

17



18



47



51



50



20



19

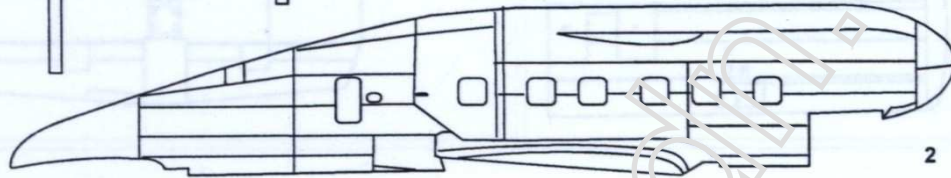

2

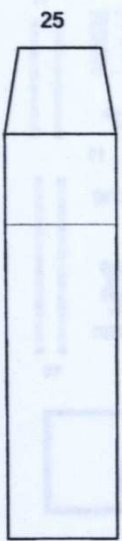

25

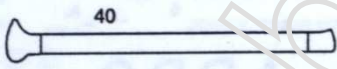

40



30

54

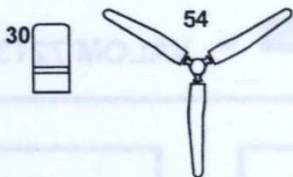

30

54

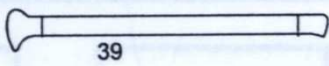

39

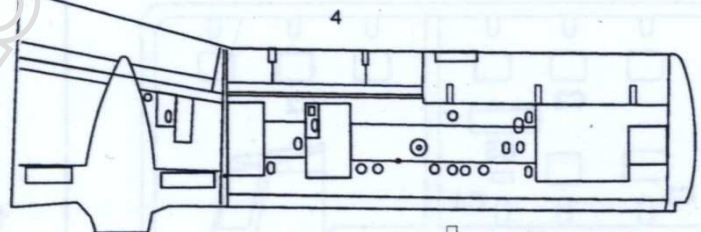

4

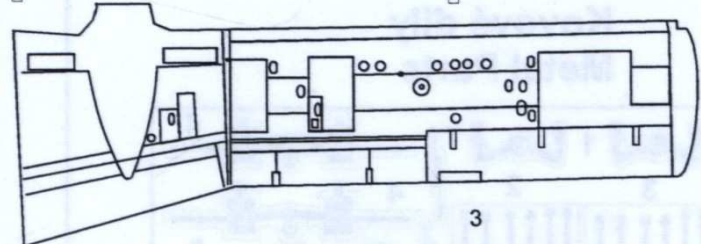
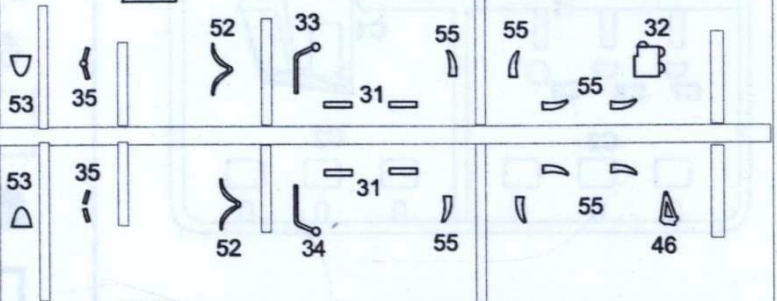

3



1

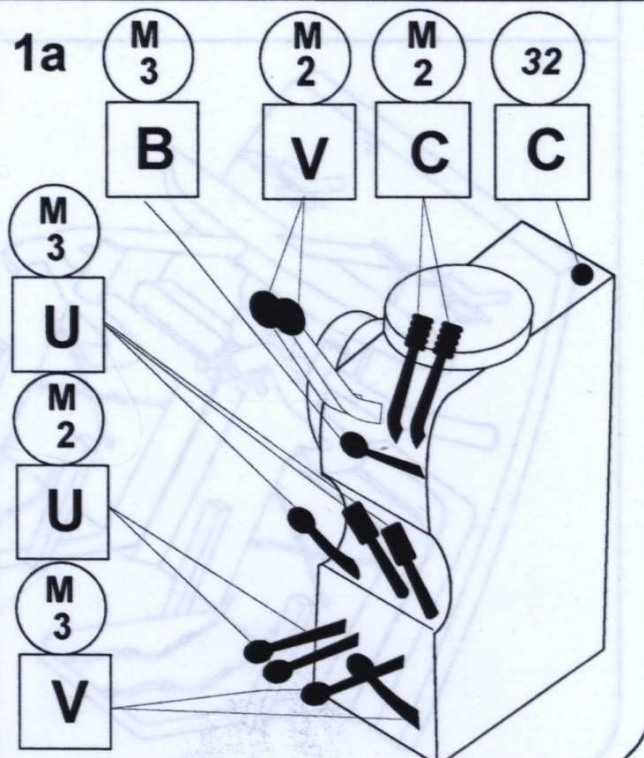
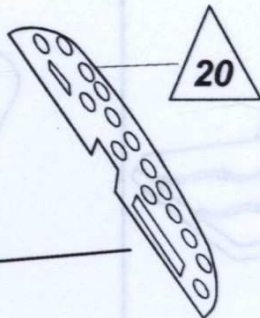
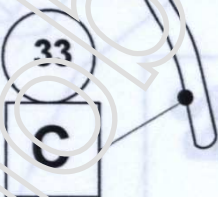
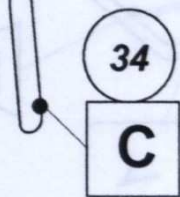
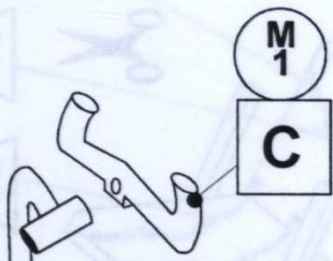
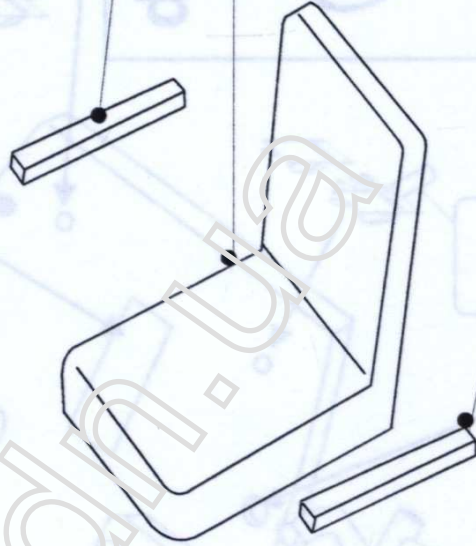
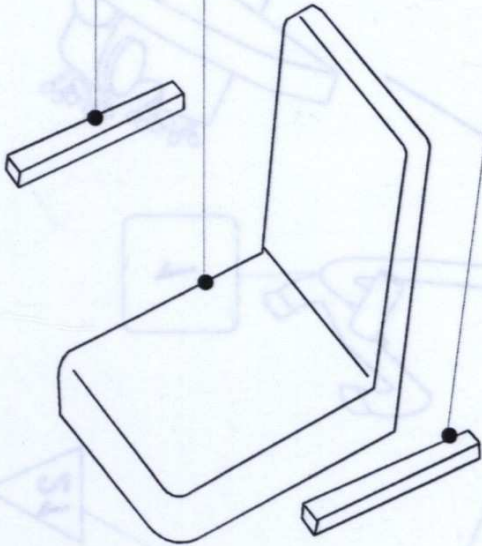
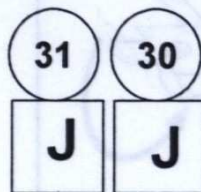
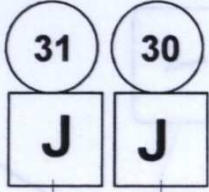

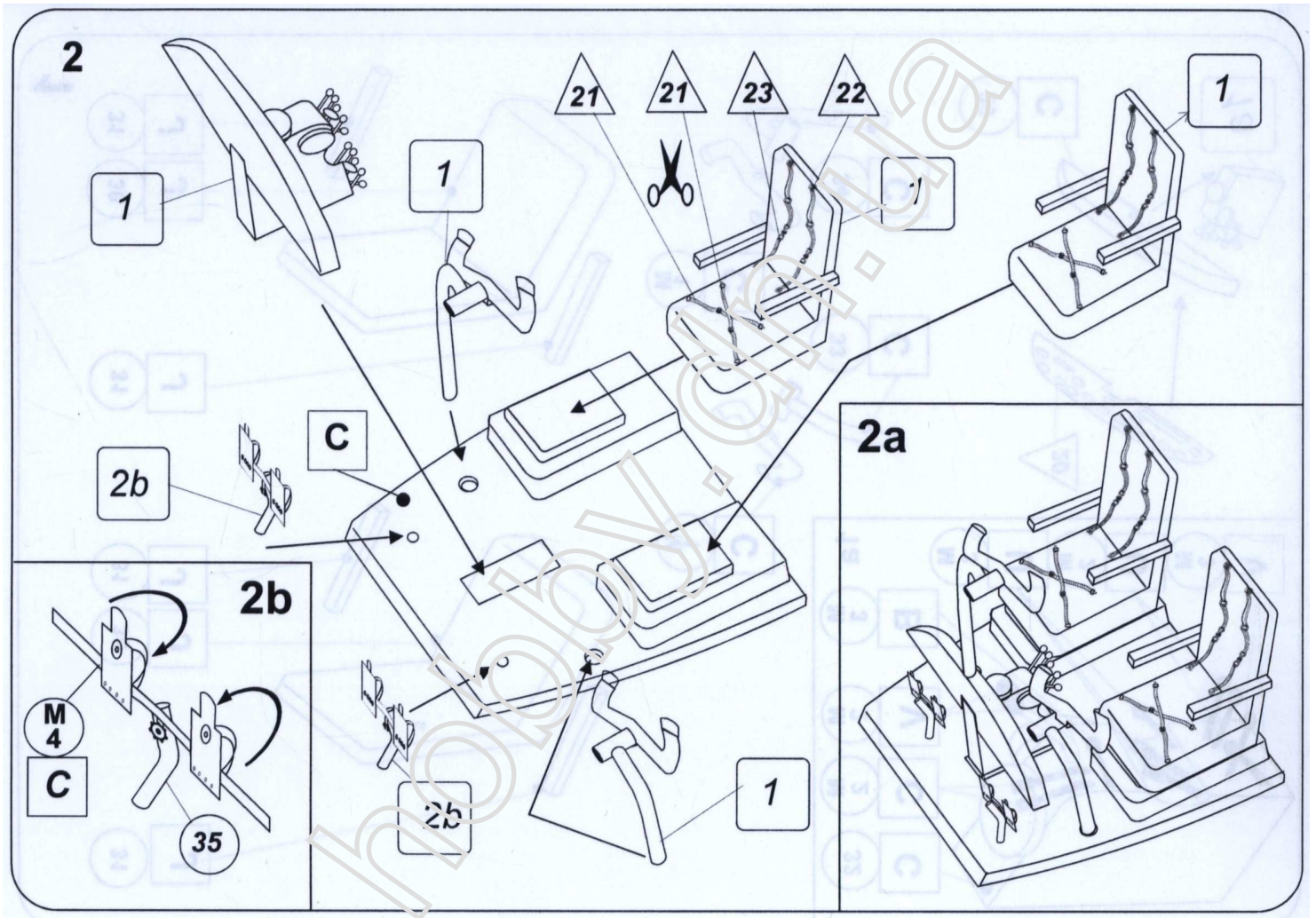

3

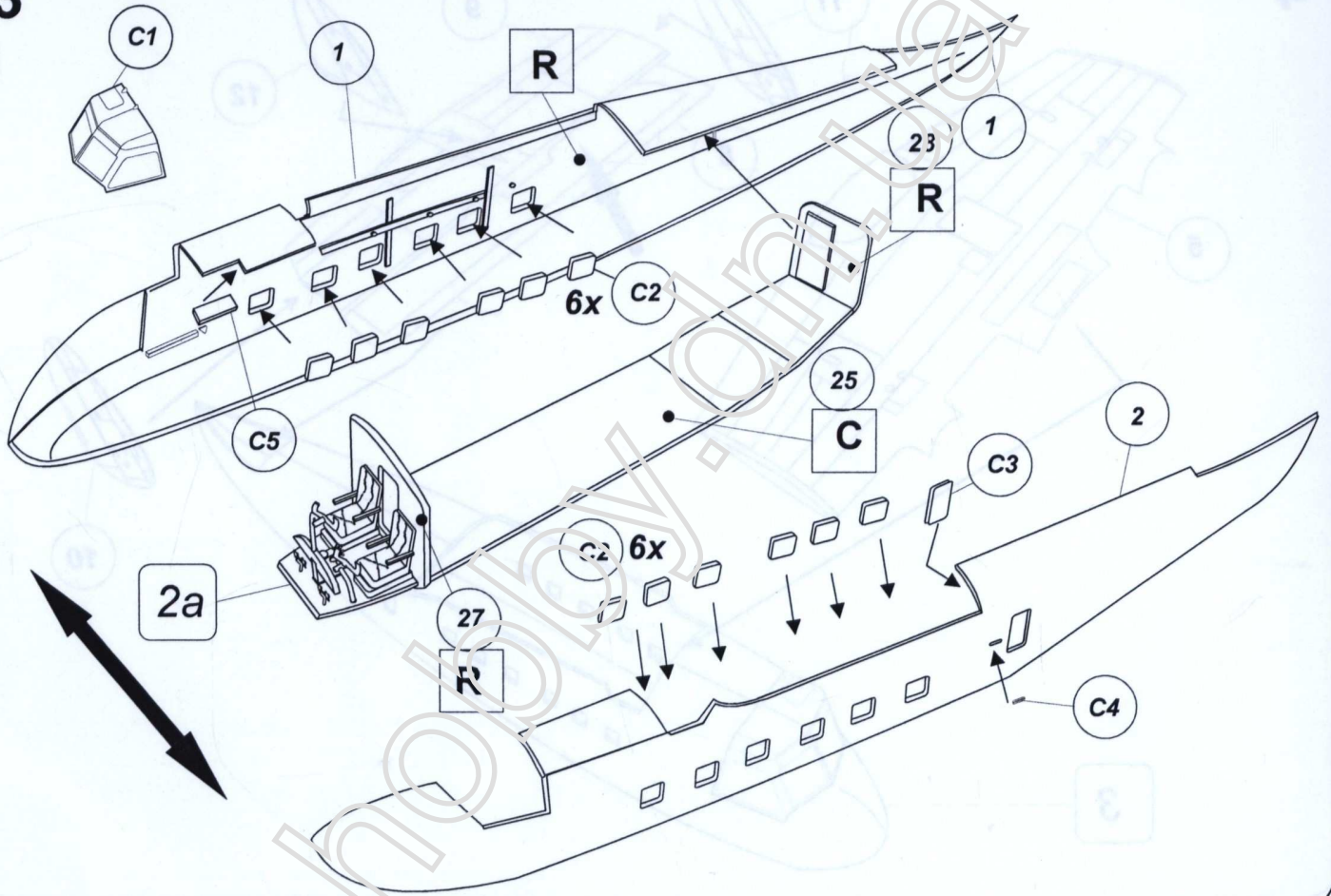

4

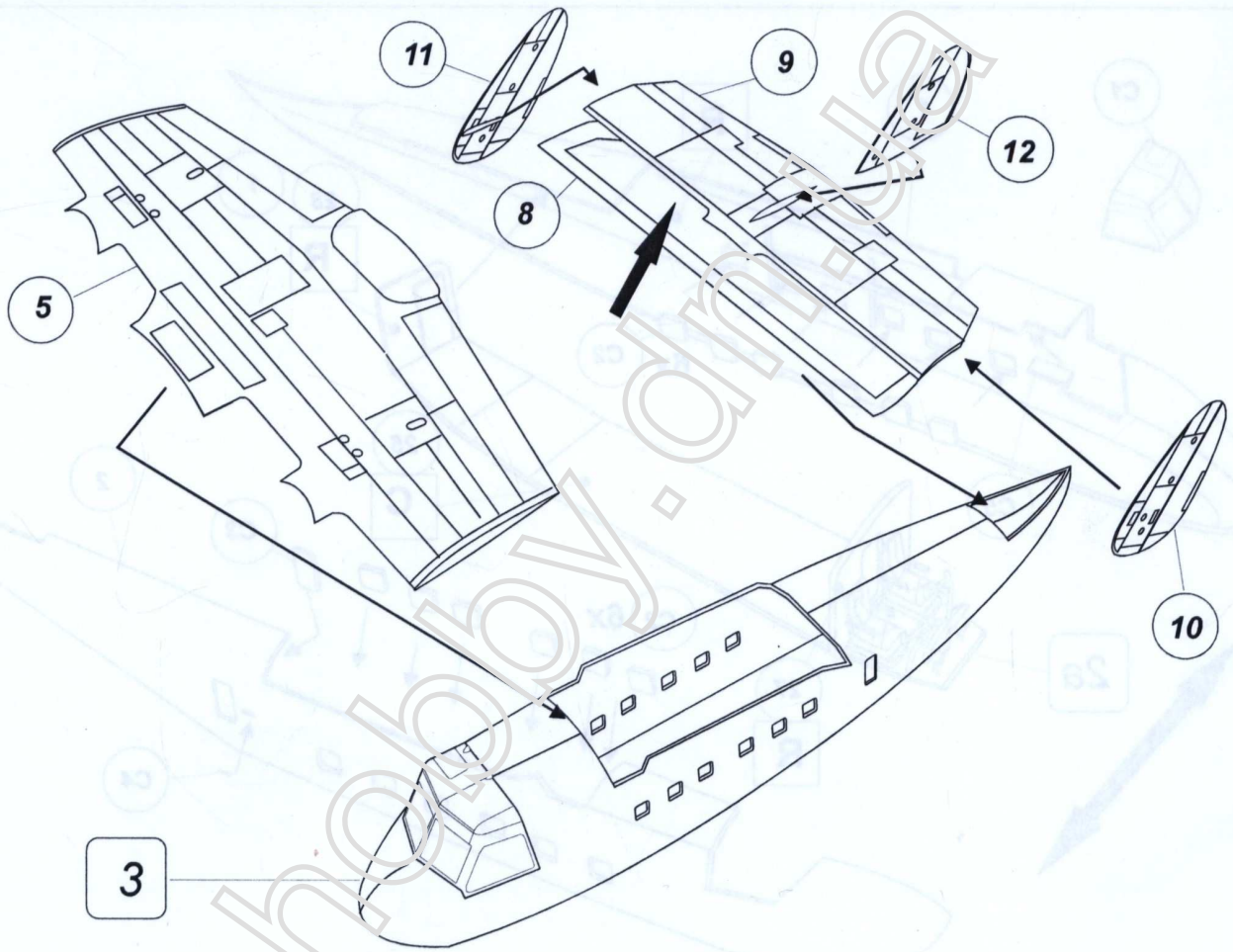

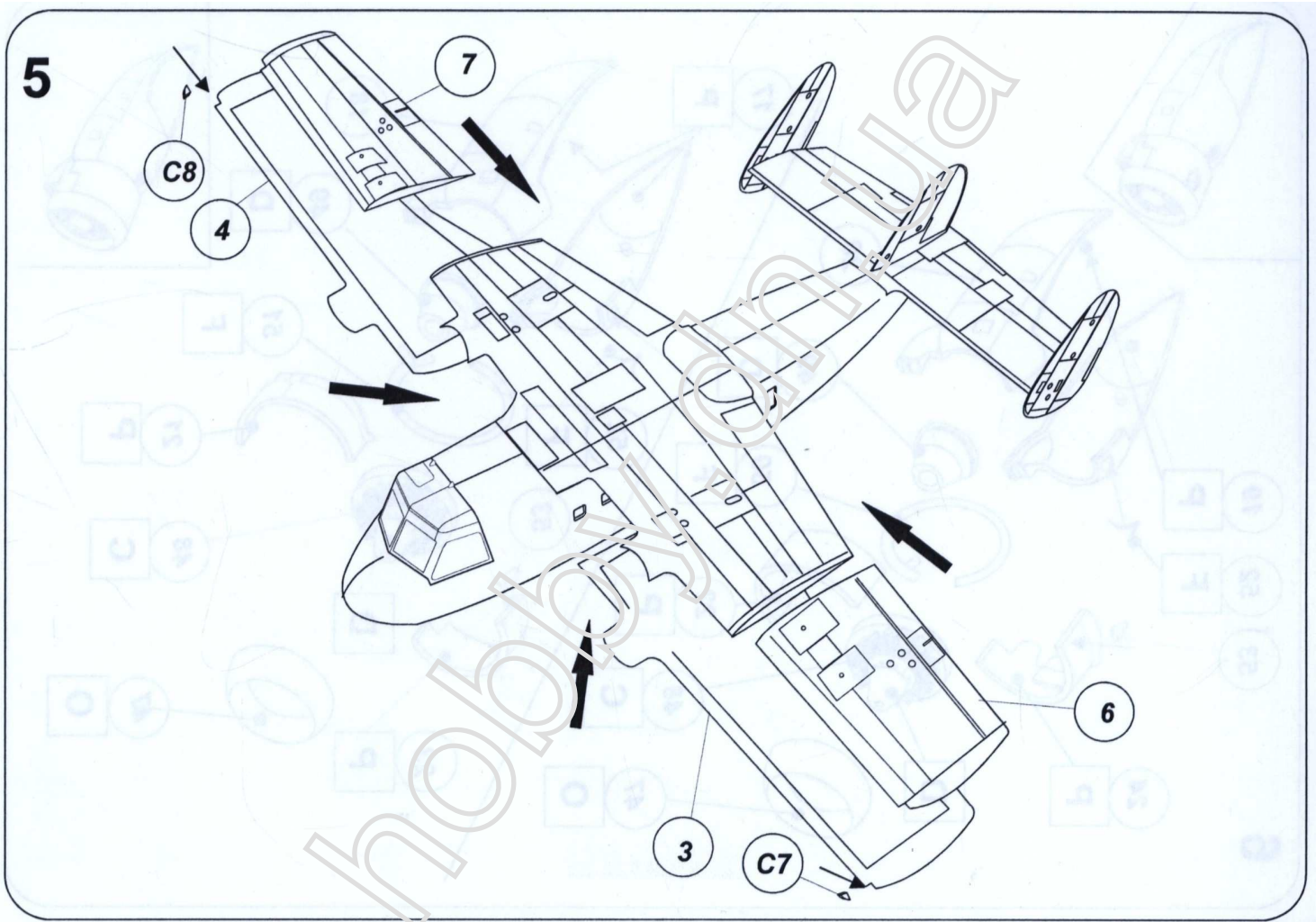

5

C8

4

7

3

C7

6



6

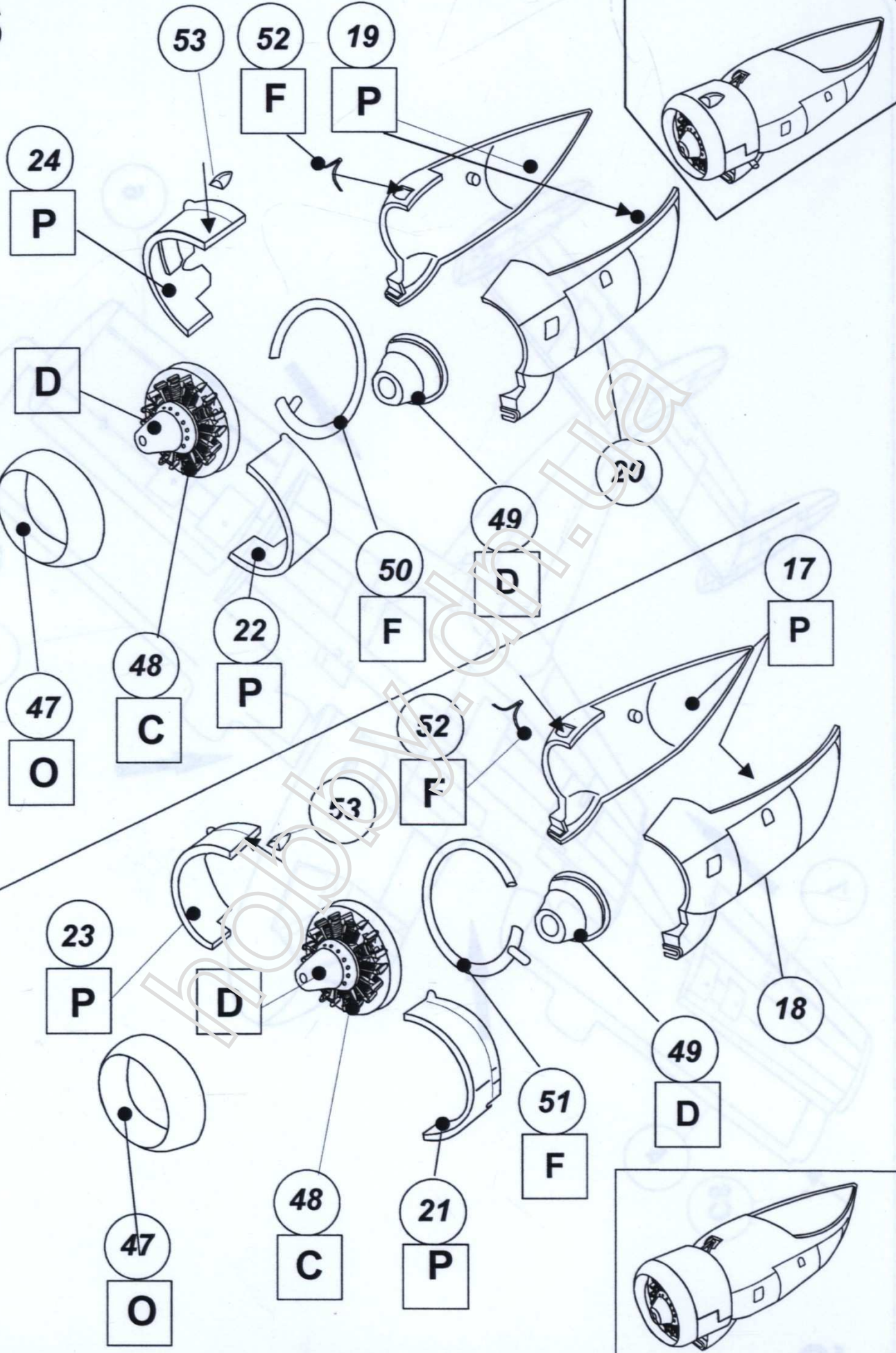

7

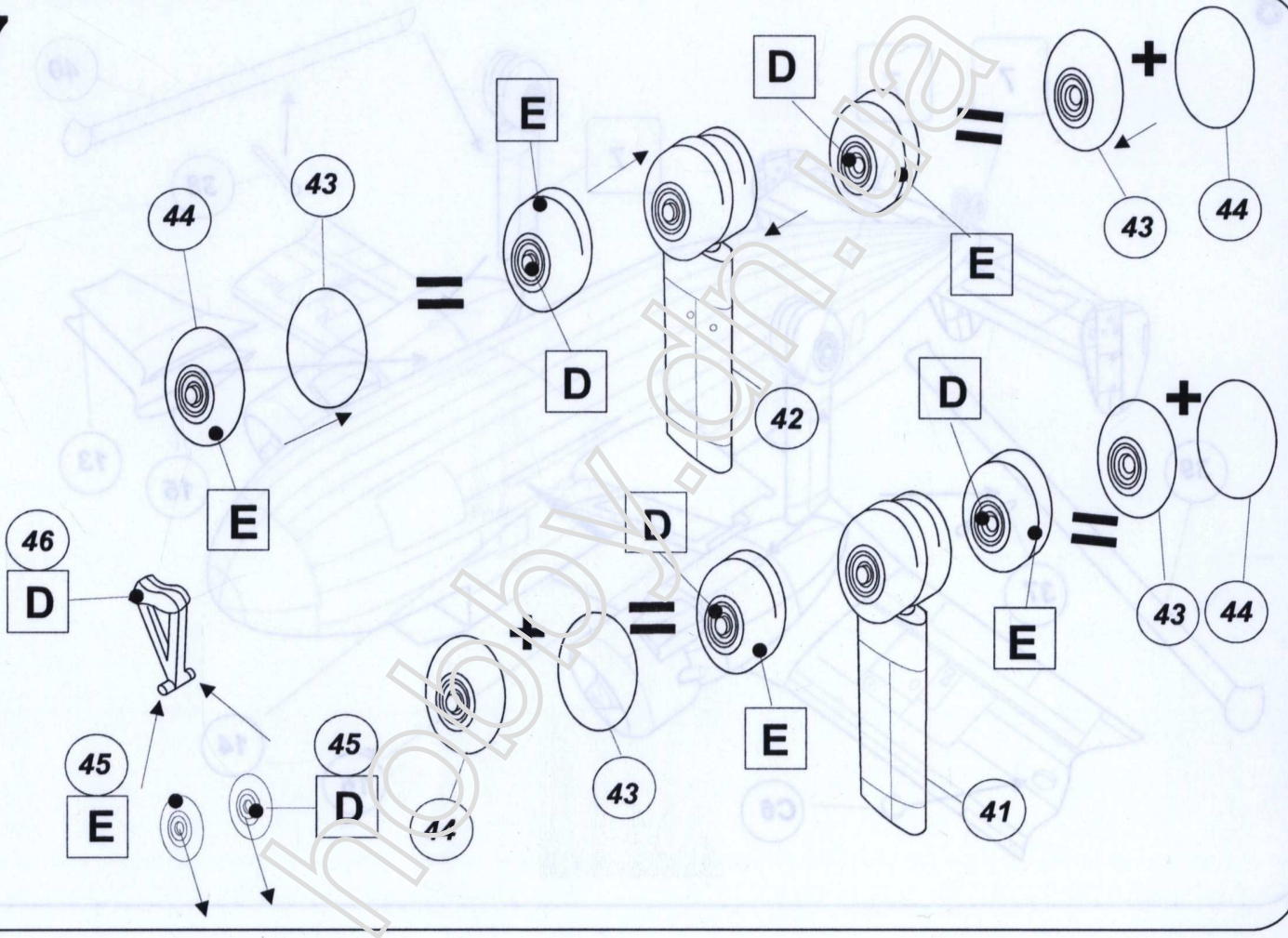

8

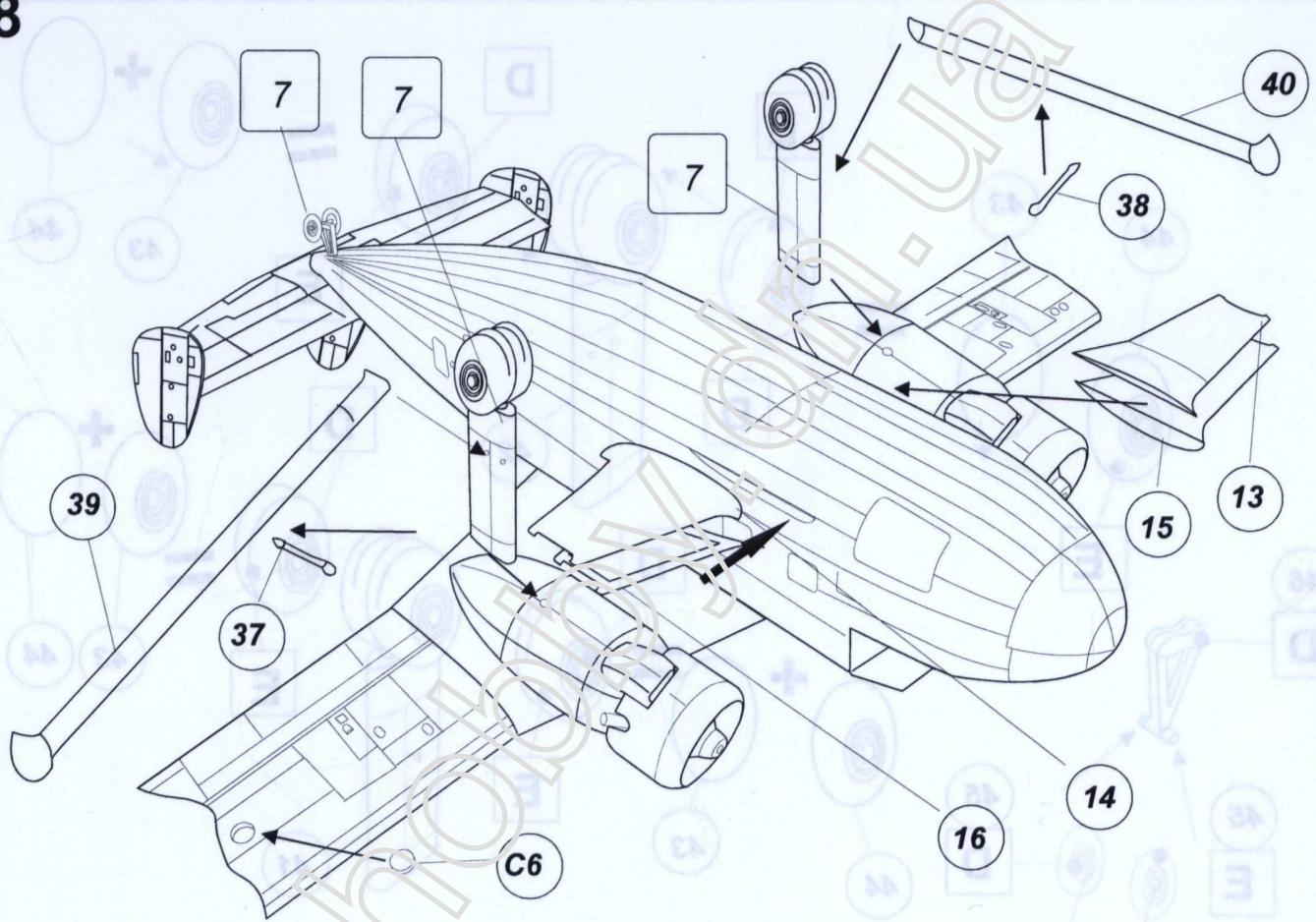

9

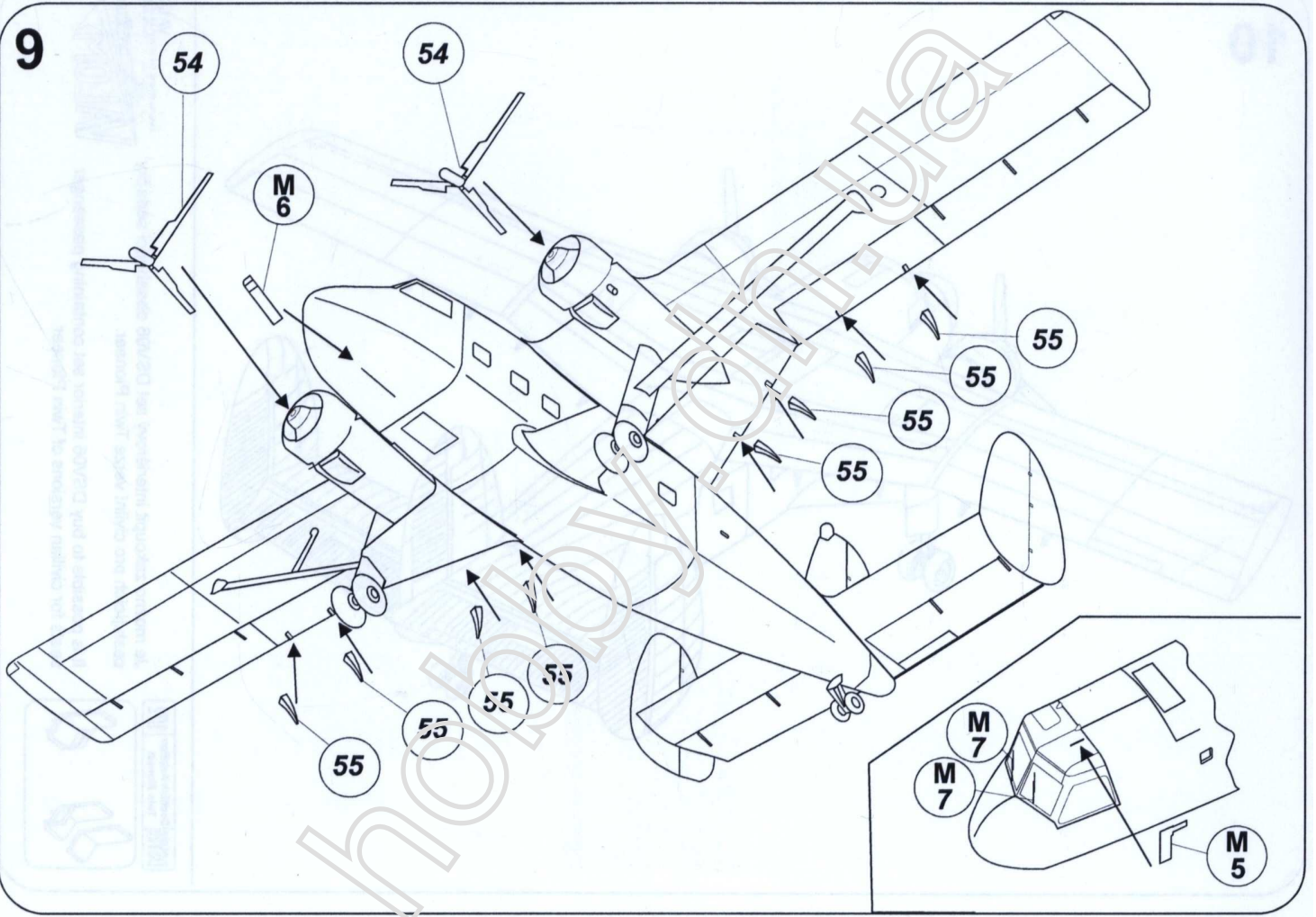

10

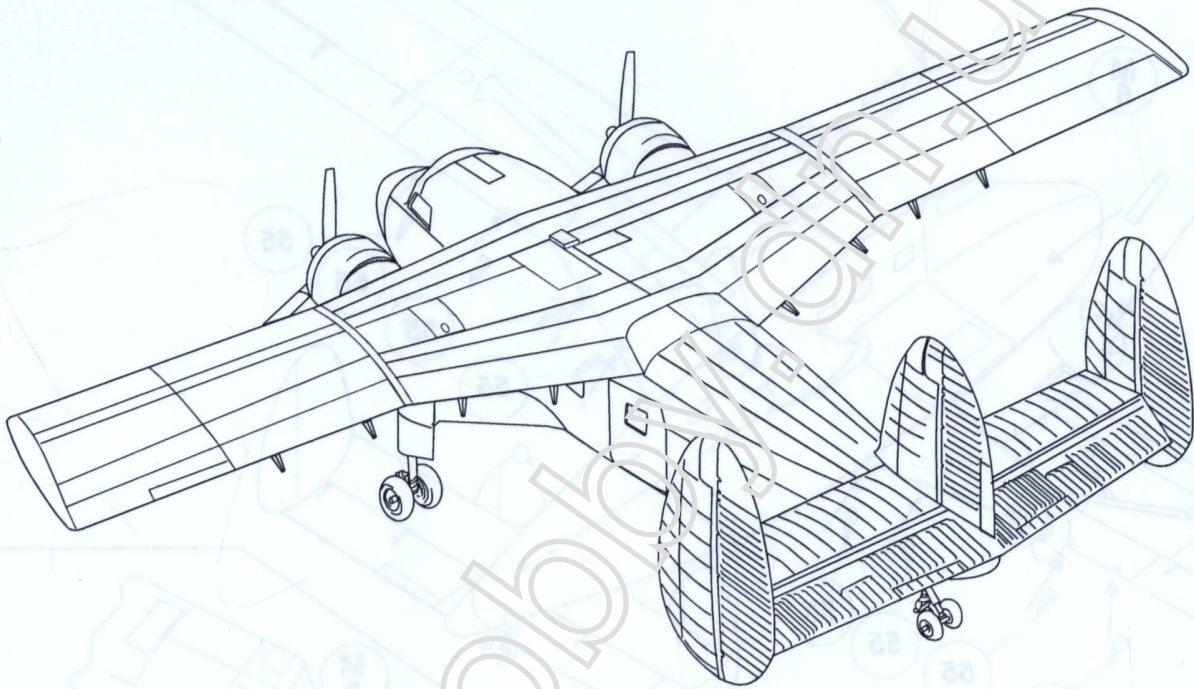

DSV06 Scottish Aviation 1/72  
Twin Pioneer

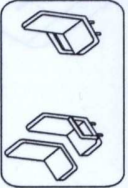

Je možno zakoupit interiérový set DSV06 obsahující sedáčky cestujících pro civilní verze Twin Pioneer.

It is possible to buy DSV06 interior set containing passenger seats for civilian versions of Twin Pioneer.

VALOM  
Základní číslo 10 148 00 Praha 4 - Chobor  
Czech Republic

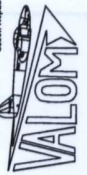

		Humbrol	Agama	Model Master	Gunze Sangyo	F.S.595b
<b>A</b>	oxfordská modrá Oxford Blue	104	09	1719	H326	35056
<b>B</b>	bílá White	34	121	1768	H11	37875
<b>C</b>	černá Black	33	07	1749	H12	37038
<b>D</b>	hliník Aluminium	56	46Me	1781	H339	17178
<b>E</b>	barva pneumatik Tyre	182	36	1592	H77	35030
<b>F</b>	výfuky Exhaust Tubs	113	54	1906	H344	30111
<b>G</b>	světlá zemitá Light Earth	119	Iz1	1742	H310	30219
<b>H</b>	zelená světlá Heli Green	120	Iz2	1716	H312	34267
<b>J</b>	tmavá zelená Dark Green	116	A17	1710	H309	34079
<b>K</b>	písková Sand	121	Iz3	1706	H313	33531
<b>L</b>	světlá modrošedá Light Blue Grey	127	F4	2109	H3338	35190
<b>M</b>	cvičná žlutá Trainer Yellow	24	N20	1599	H2	33538
<b>N</b>	barva kůže Leather	62	30	1736	H66	30215
<b>O</b>	šedá Grey	140	A18	1740	H317	36231
<b>P</b>	zinkchromátová Zink Chromat	63	A11	1735	H346	33275
<b>R</b>	světlá šedá Light Grey	129	A31	1730	H325	26440
<b>S</b>	interierová zelená interior Green	78	B10	2062	H58	34151
<b>T</b>	červená Red	19	17	1503	H3	11400
<b>U</b>	signální červená Signal Red	174	17	1705	H90	11310
<b>V</b>	signální zelená Signal Green	208	19	1524	H94	13591
<b>W</b>	signální žlutá Signal Yellow	69	15	2717	H91	13591

**X** obtisky  
Decals

## Scottish Aviation Twin Pioneer

