

Westland WS-51 Dragonfly HR.5 WG719  
on display at the Helicopter Museum in Weston-Super-Mare



Westland WS-51 Dragonfly HR.3 WG723,  
706 Squadron, Coventry, National Air Races, 1955



Westland WS-51 Dragonfly HR.5 Wg724,  
on display at the North East Land, Sea & Air Museums, Sunderland

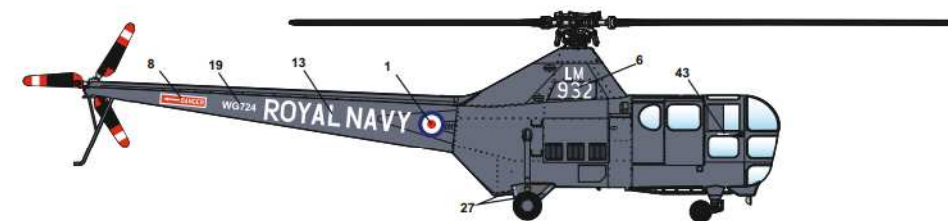

# 1/48 SCALE MODEL CONSTRUCTION KIT Ws - 51 Dragonfly Hr.3

48004

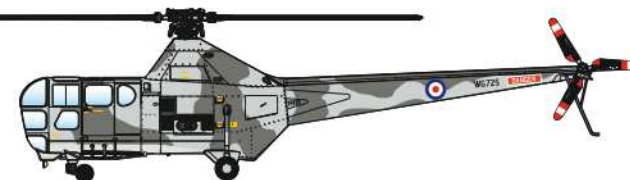

У грудні 1946 р. Було підписано угоду між Westland Aircraft та Sikorsky, що дозволило виготовляти британську версію S-51 за ліцензією у Великобританії. Вони були оснащені радіальним двигуном Alvis Leonides 500 л.с. Dragonfly вступив на службу у Королівський флот у 1950 році в ролі рятувального на морі. Деяка кількість також використовувалося Королівськими ВПС по евакуації постраждалих.

In December 1946 an agreement was signed between Westland Aircraft and Sikorsky to allow a British version of the S-51 to be manufactured under licence in the United Kingdom. These would be powered by the 500 hp Alvis Leonides radial engine.

Operational history. The Dragonfly entered service with the Royal Navy in 1950 in the air-sea rescue role. A number were also used by the Royal Air Force for casualty evacuation.

### Технічні характеристики / Technical specifications:

Довжина/Length - 17.39 м; Діаметр ротора/Rotor diameter - 19,61 м; Висота/Height - 3,86 м; Злітна вага (макс.)/Loaded weight - 2261 kg; Дальність польоту/Range - 441 км; Крейсерська швидкість/Cruising speed - 130 км/ч; Макс. висота польоту/Ceiling - 4511 м; Кількість пасажирів/Number of passengers - 3.

### СПЕЦІАЛЬНІ СИМВОЛИ/USED SYMBOLS



### КОЛЬОРИ ФАРБ/USED PAINTS

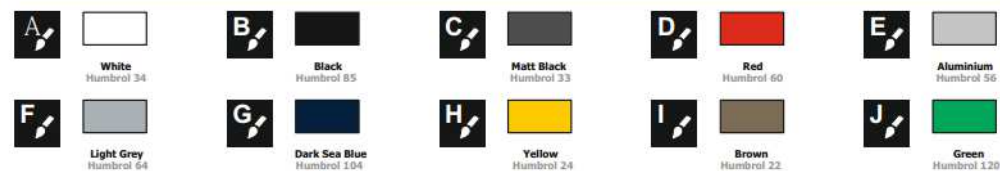

**PARTS OF THE MODEL**

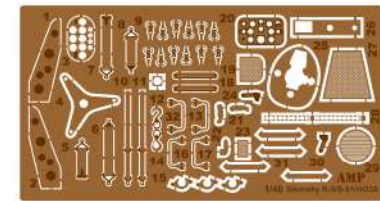
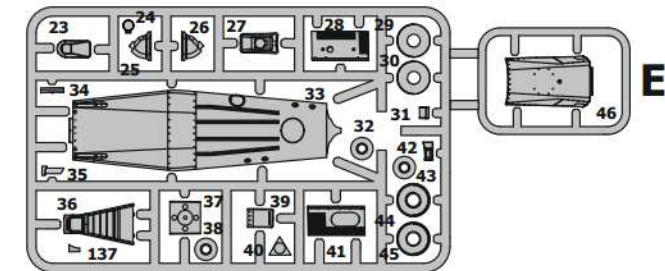
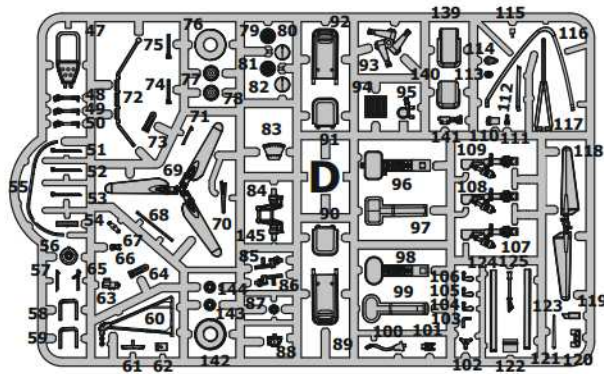
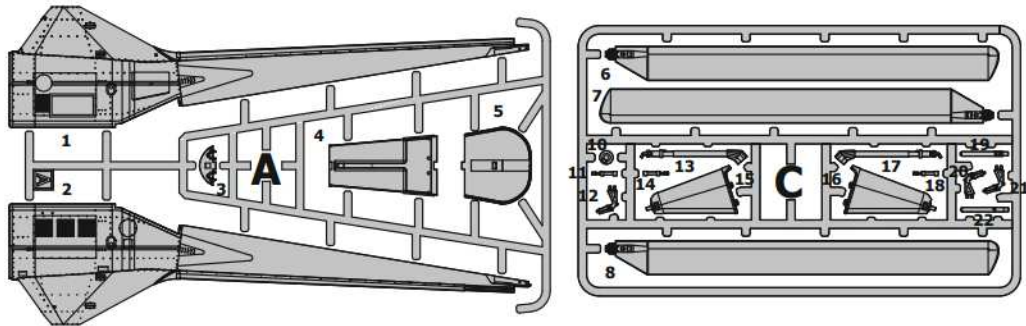

**Resin Parts**

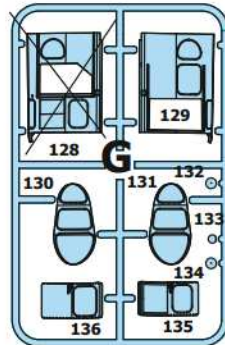
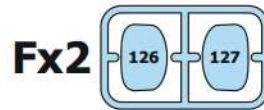
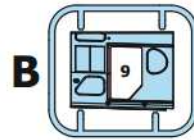

**Mask**

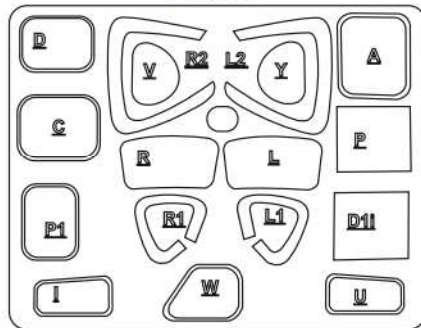

**27** D56, D60, D66, D68, D70, D95, Pe12

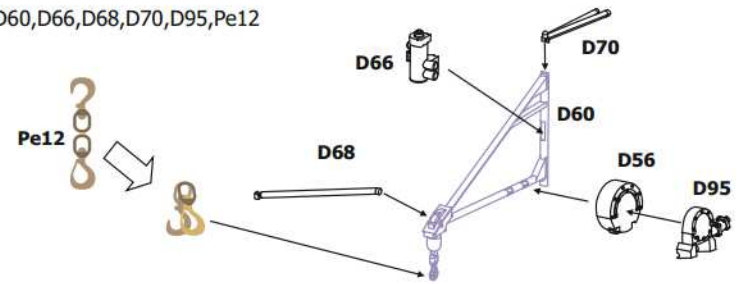

**28** C6, C7, C8

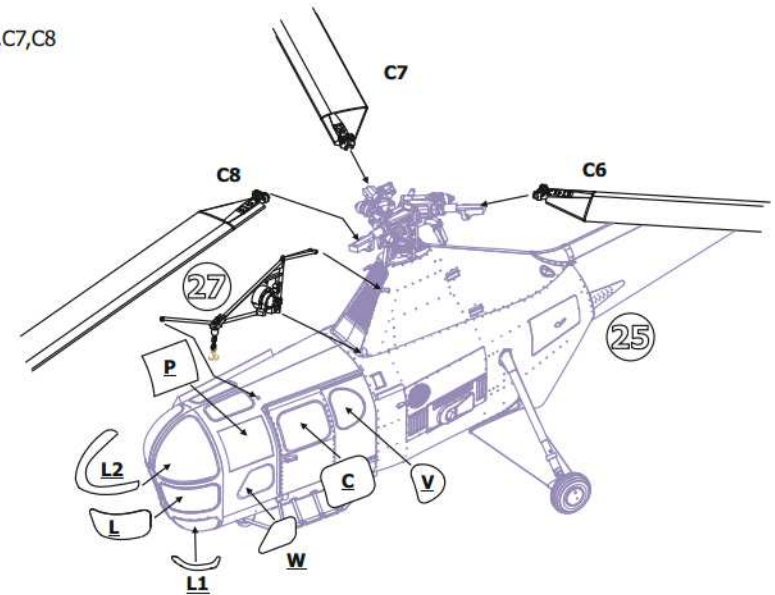

**29** D110, D112, D117, E24, E27, G133

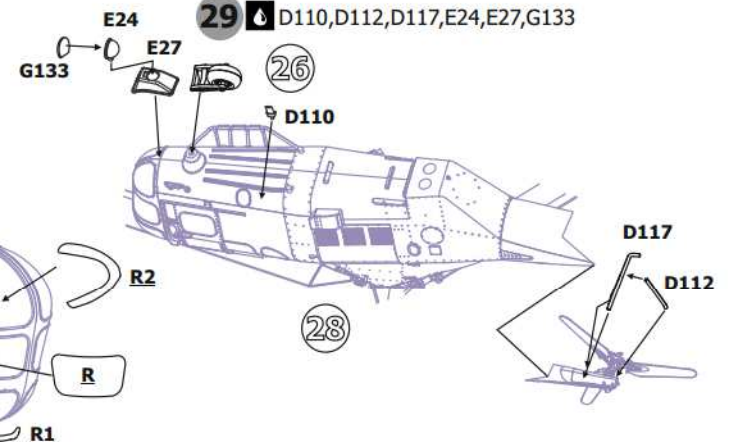



21 D93,D107,D108,D109,E40

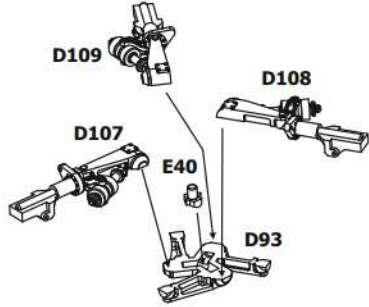

22 138

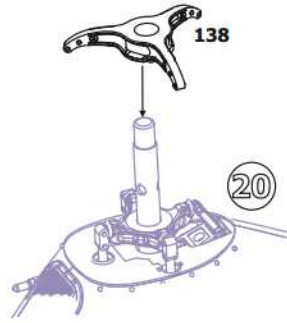

23 D57,D65,D71

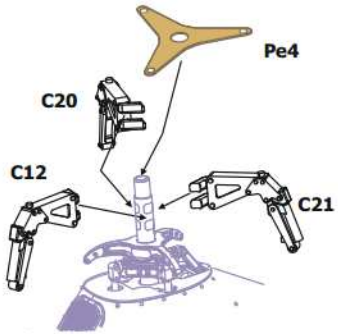

24 D104,D105,D106,Pe4

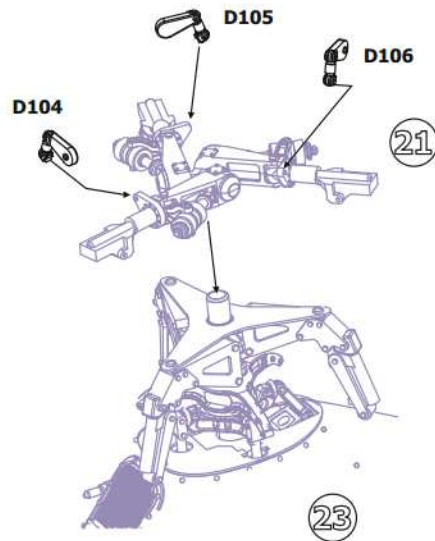

25 D48,D49,D50,D51,D52,D53

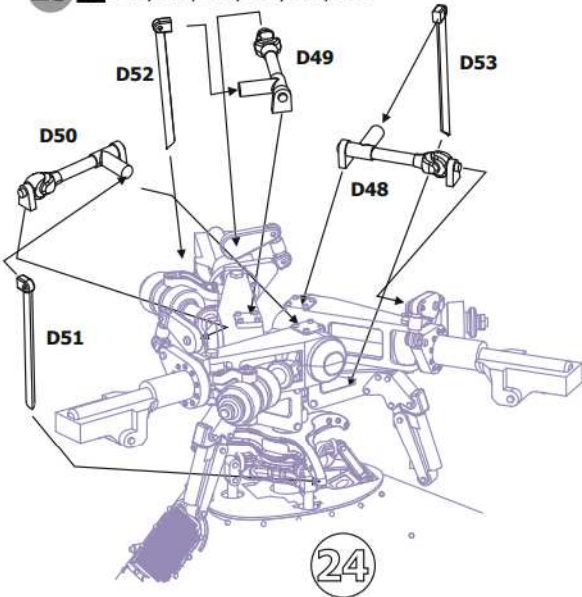

26 D77,D84,D143,D145,E32,E42

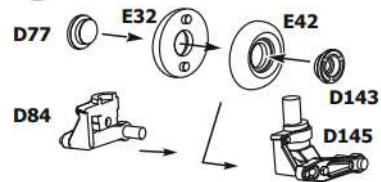

### ASSEMBLY INSTRUCTION

1 D125,Pe24,Pe30

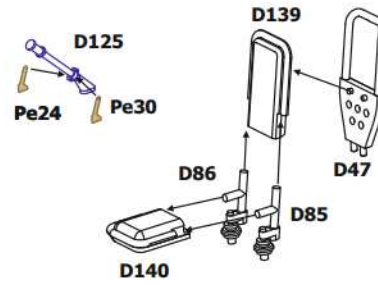

3 D91,D92,Pe,31x2

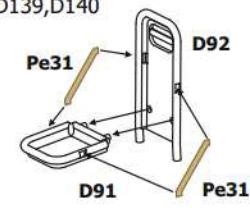

4 D89,D90,Pe31x2

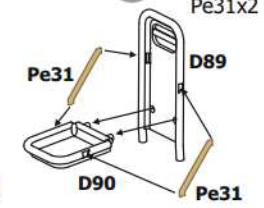

5 A4,A5,Pe10-11,Pe18x2,Pe5-6

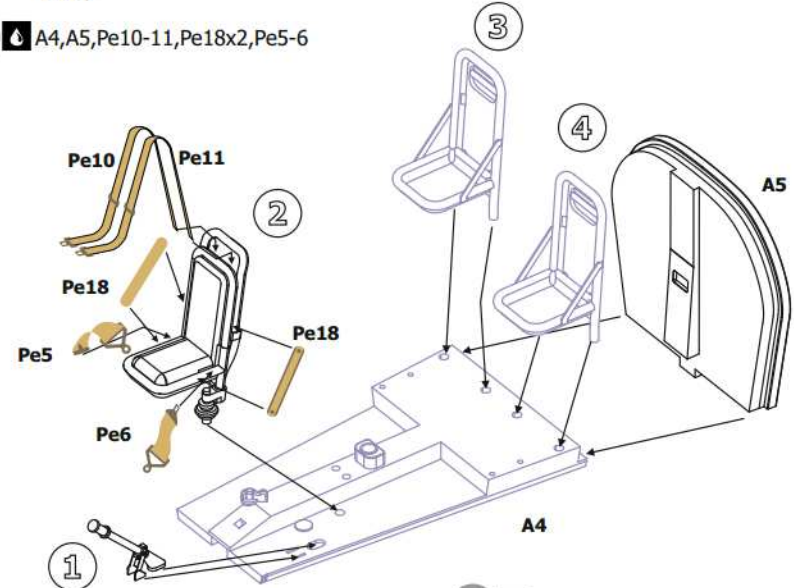

6 D96,D97,Pe1,Pe2,Pe20

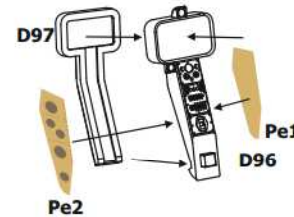

7 A3,D64,D73,D100

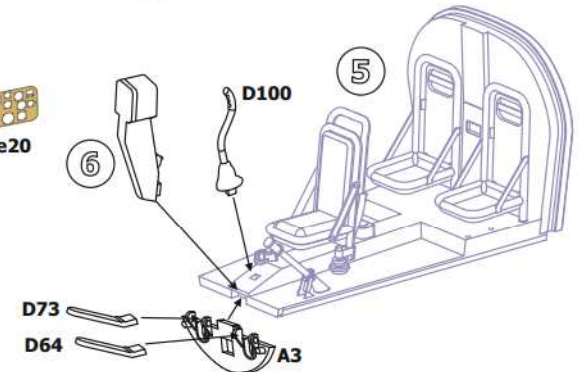

8 D55,G130,G131

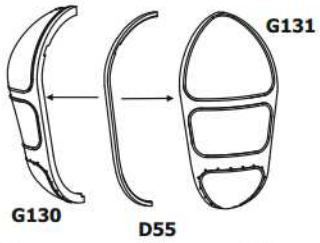

9 D119,Pe28

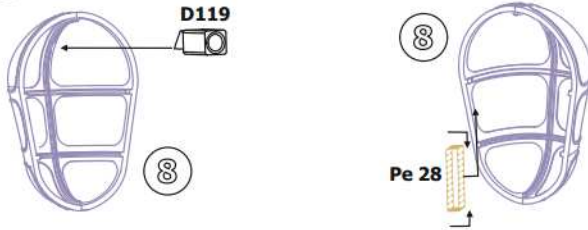

10 D120,D122,G129 11 D62,D141,B9,Pe26

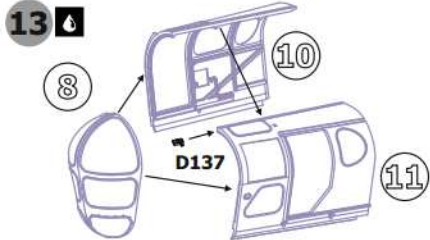
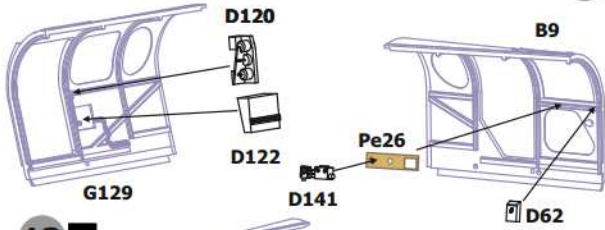

14 A1,A2,E33,E36,E28,E35,E23,E46

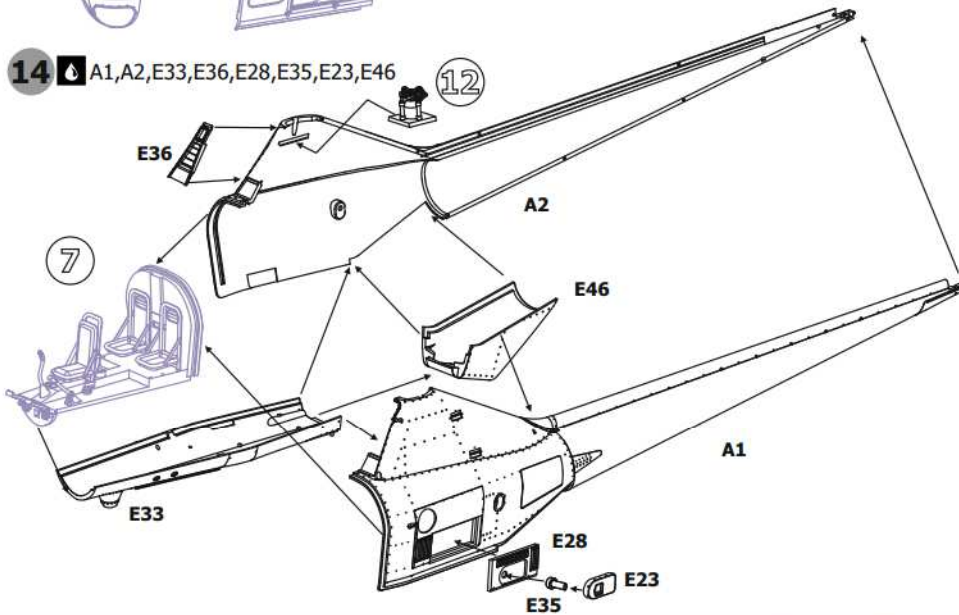

15 D76,D79,D80,D142

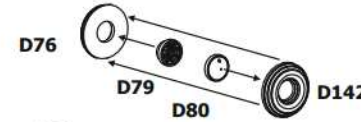

16 D87,D88

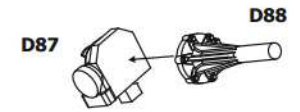

17 C16,C17,C22,D74,D75,D113,D123,D72,D69,D102,G135,Pe15x3,Pe19,Pe25,Pe27,Pe29,E31,D94

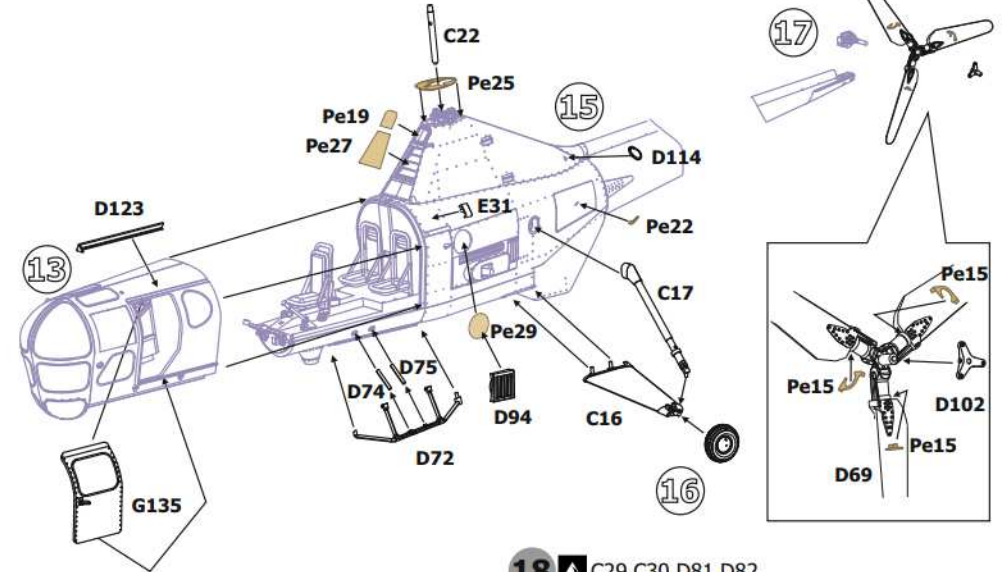

18 C29,C30,D81,D82

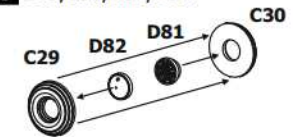

20 C13,C15,D58,D103,D124,G136

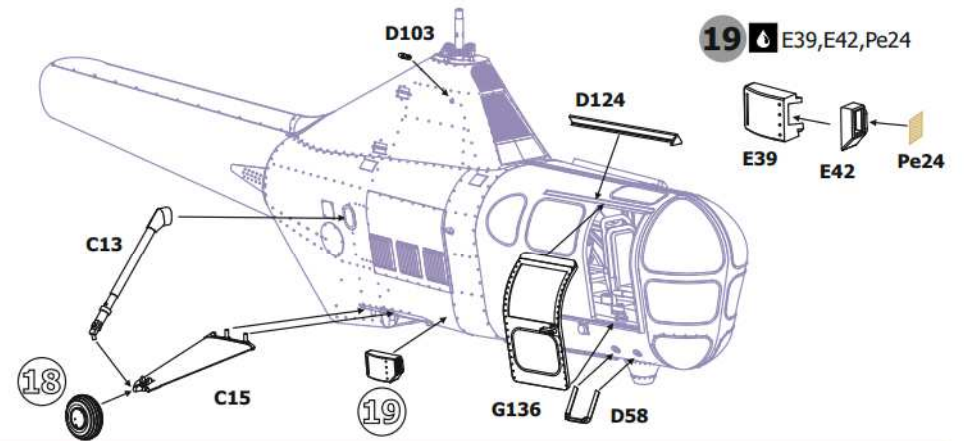

19 E39,E42,Pe24

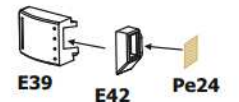



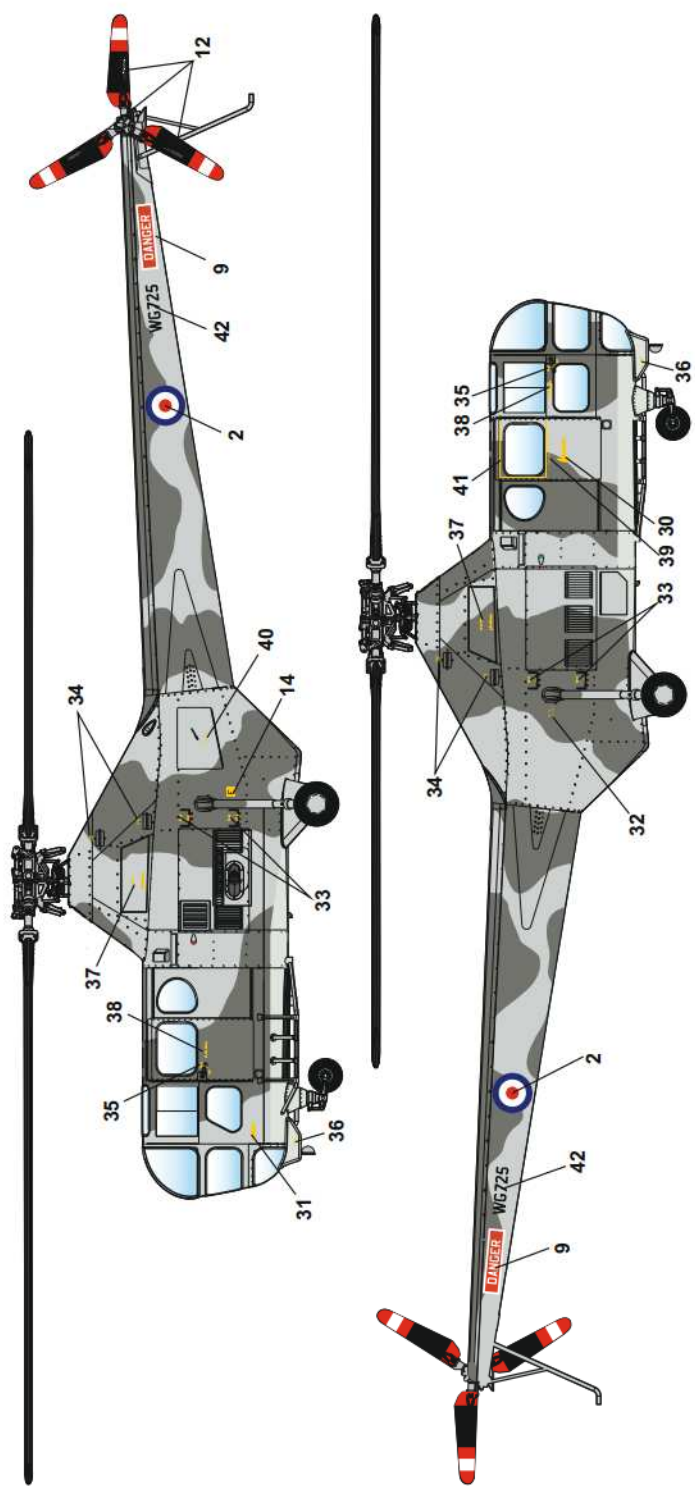

Westland WS-51 Dragonfly HR.3 Wg725, on display at the Royal Australian Navy Fleet Air Arm Museum, Nowra, Australia

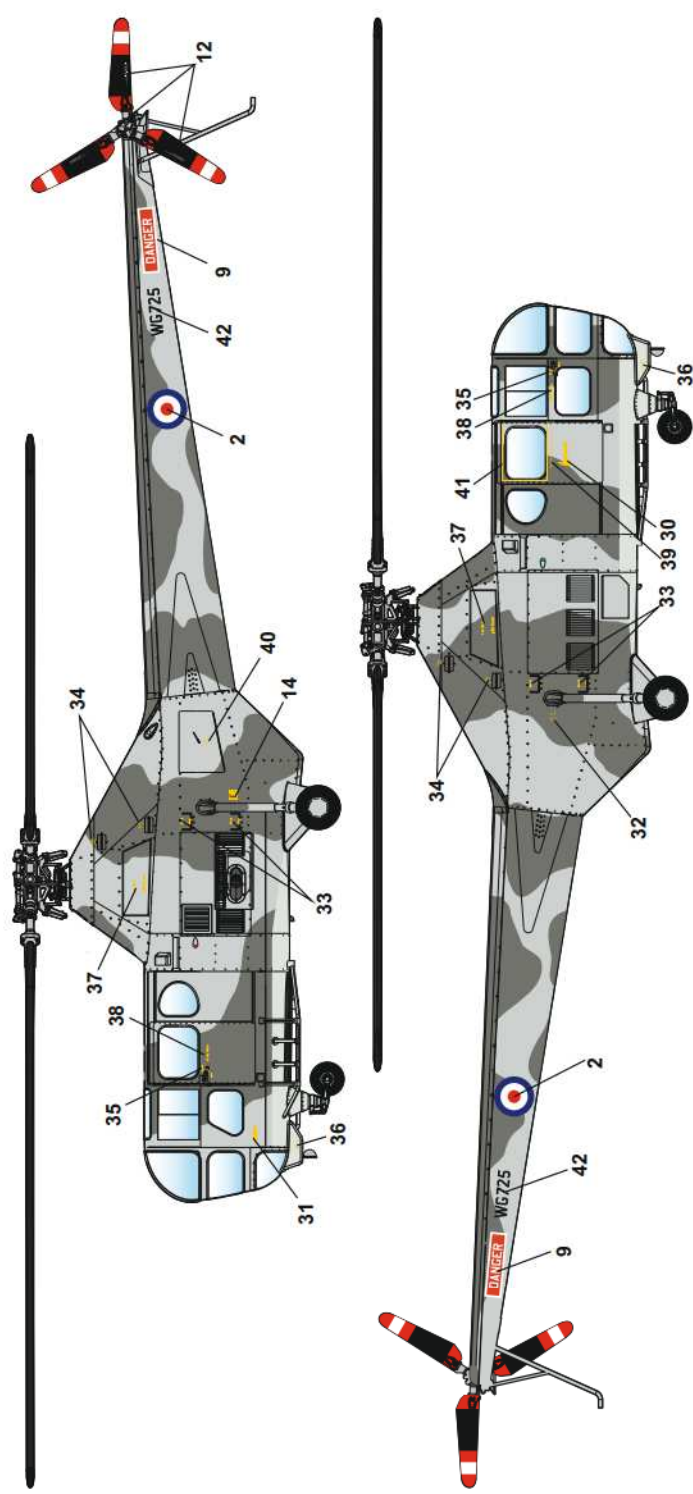

Westland WS-51 Dragonfly HR.3 Wg725, on display at the Royal Australian Navy Fleet Air Arm Museum, Nowra, Australia

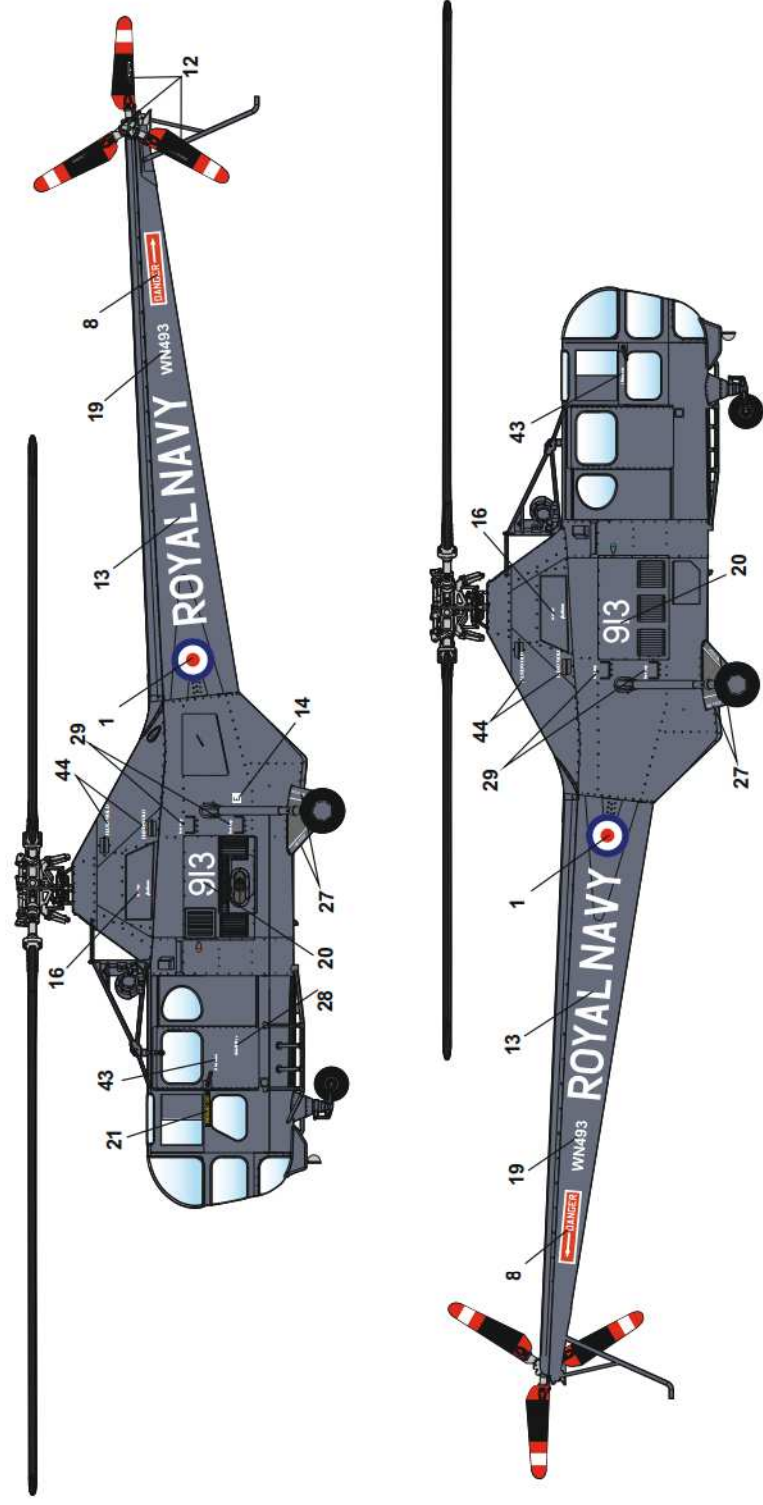

Westland WS-51 Dragonfly HR.3 WN493, Royal Navy over St Michael's Mount circa, 1959

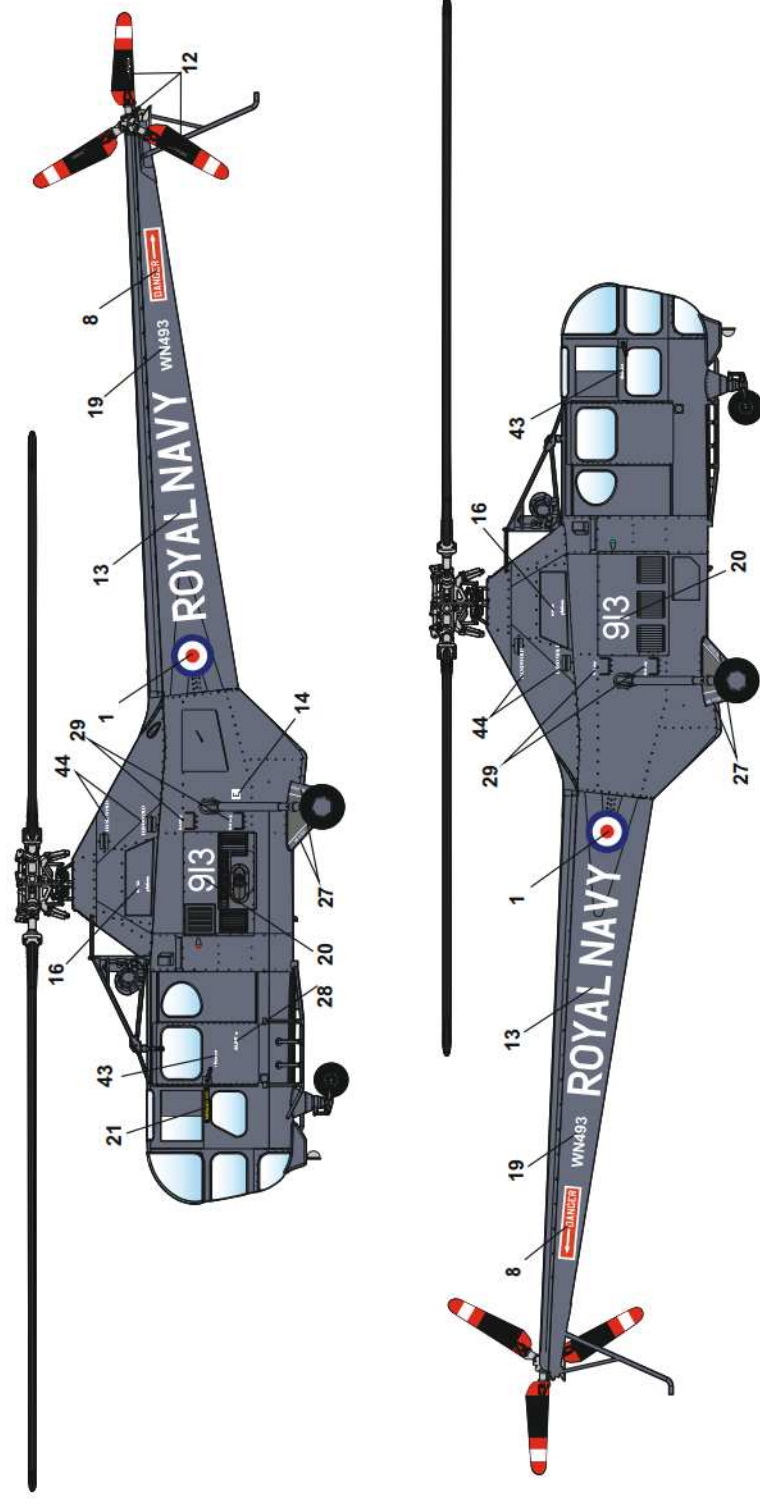

Westland WS-51 Dragonfly HR.3 WN493, Royal Navy over St Michael's Mount circa, 1959