

MiG-21MF interceptor

eduard

SOVIET SUPERSONIC FIGHTER

1/72 SCALE PLASTIC KIT

ProfiPACK
edition

#70141



INTRO

The MiG-21 was one of a long list of Mikoyan-Gurevich products to be integrated into the armed forces of the Soviet Union, the Warsaw Pact, and allied client states. Its predecessors included such notable types as the MiG-15, MiG-17 and the supersonic MiG-19. The roots of this project reach back to the first half of the fifties. In 1954, the Ye-1 project came to an end, and was quickly picked up by the Ye-2. Both had a swept wing. The first machine to feature the delta wing was the Ye-4, which first took to the air on June 16th, 1955. It was also demonstrated a year later at the Moscow airfield Tushino. The first of the new line to enter production was the MiG-21F, which together with the MiG-21P and F-13 represented the first generation of the MiG-21, and was in production through the end of the fifties and the beginning of the sixties. Subsequent versions included the PF, FL, PFM, R the production of which peaked at the end of the sixties. The third generation started production in 1968, which included such versions as M, SM, MF, SMT, bis among others. Simultaneously, two-seat training versions were also produced designated MiG-21U, UM and US. Production of the MiG-21 ended in 1985, and was put into service with some fifty nations. Over the course of the cold war, the opponents of the MiG-21 included the likes of the Northrop F-5 Freedom Fighter and the Dassault Mirage III. NATO assigned it the reporting name 'Fishbed'. It became the most produced supersonic fighter in terms of quantity. The new machines came off Soviet production lines in Moscow, Gorky and Tbilisi. The MiG-21F-13 was also built under license in Czechoslovakia and the MiG-21FL, M and bis in India by Hindustan Aeronautics Ltd. The Soviet Union produced 10,645 examples of all versions, 194 were built in Czechoslovakia and 657 in India. Outside of the Soviet Union, the type flew with a long list of nations on all continents with the exception of Australia. The MiG-21 participated in combat in Vietnam, the Indo-Pakistan wars, the Cuban participation in Angola and in the Arab world's attempt to eliminate Israel. Thanks to the high volume of use, the highest number of aces produced on the type was in Vietnam. The top of the ladder is occupied by Nguyen Van Coc with nine kills. The type serving as a interceptor served with the Soviet Union and other nations of the Warsaw Pact into the eighties, when it began to be displaced by the MiG-29 Fulcrum.

This kit presents an opportunity for you to build a model of a MiG-21MF supersonic jet fighter in a way it was produced in Gorky factory, where the production of the MF variant was moved from Moscow factory after their start with MiG-23s. The design of the fighter planes made in Gorky differed in several details from the Moscow design. The first reason for that was the unification of some features with the previously made aircraft in Gorky, the MiG-21bis, and the second reason was the use of former technological procedures followed by Gorky factory. These fighter jets were exported to German Democratic Republic, Poland, Czechoslovakia, Romania and Bulgaria. Production of this version finished after two years.

MiG-21MFs were powered by Tumanskij R-13-300 turbojet engine with additional combustion chamber and carried an RP-21 radar. The armament constituted of a twin-barreled GSch-23-2L 23mm autocannon with 200 rounds of ammunition. The racks carried a combination of FAB bombs with 500kg warhead, UB-16-57U launchers and R-3S rockets, Ch-66, S-24, including R-60 air-to-air missile and its infrared homing variant R-60M. The NATO code for MiG-21MFs was "Fishbed-J".

ATTENTION



UPOZORNĚNÍ



ACHTUNG



ATTENTION



注意



Carefully read instruction sheet before assembling. When you use glue or paint, do not use near open flame and use in well ventilated room. Keep out of reach of small children. Children must not be allowed to suck any part, or pull vinyl bag over the head.



Před započítím stavby si pečlivě prostudujte stavební návod. Při používání barev a lepidel pracujte v dobře větrané místnosti. Lepidla ani barvy nepoužívejte v blízkosti otevřeného ohně. Model není určen malým dětem, mohlo by dojít k požití drobných dílů.

INSTRUCTION SIGNS ✳ INSTR. SYMBOLY ✳ INSTRUKTION SINNBILDEN ✳ SYMBOLES ✳ 記号の説明

OPTIONAL
VOLBABEND
OHNOUTOPEN HOLE
VYVRTAT OTVORSYMMETRICAL ASSEMBLY
SYMETRICKÁ MONTÁŽREMOVE
ODRÍZNOUTREVERSE SIDE
OTOČITAPPLY EDUARD MASK
AND PAINT
POUŽIT EDUARD MASK
NABARVIT

PARTS



DÍLY



TEILE



PIĚCES



部品

PLASTIC PARTS

A>

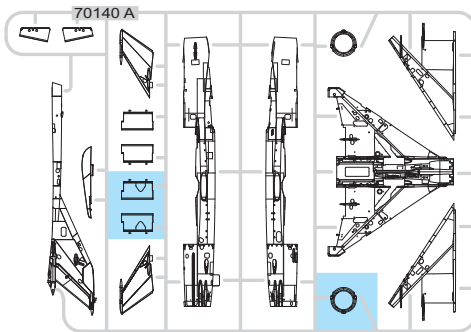

C>

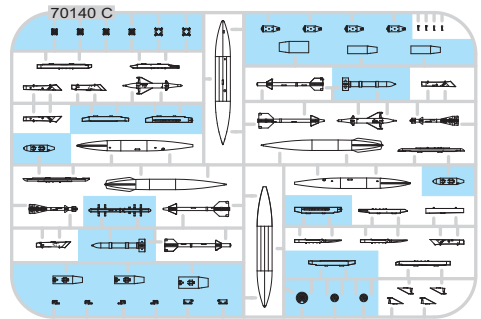

D>

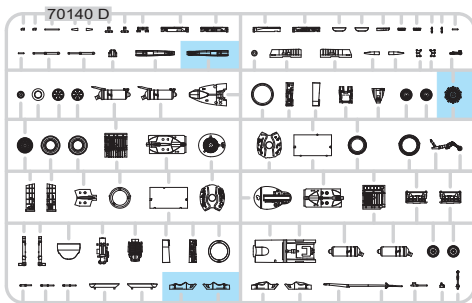

E>

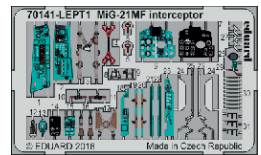
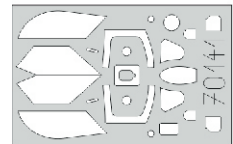
PE - PHOTO ETCHED
DETAIL PARTSeduard
MASK

Parts not for use. -Teile werden nicht verwendet. -Pièces à ne pas utiliser. -Tyto díly nepoužívejte při stavbě. - 使用しない部品

COLOURS



BARVY



FARBEN



PEINTURE



色

GSI Creos (GUNZE)		
AQUEOUS	Mr.COLOR	
H1	C1	WHITE
H3	C3	RED
H4	C4	YELLOW
H5	C5	BLUE
H7	C7	BROWN
H11	C82	FLAT WHITE
H12	C33	BLACK
H16	C84	YELLOW GREEN
H25	C34	SKY BLUE
H26	C86	BRIGHT GREEN
H35	C80	COBALT BLUE
H44	C51	FLESH

AQUEOUS	Mr.COLOR	
H47	C41	RED BROWN
H51	C11	LIGHT GULL GRAY
H53	C13	NEUTRAL GRAY
H60	C16	GREEN
H70	C60	GRAY
H77	C137	TIRE BLACK
H78	C38	OLIVE DRAB
H82	C32	DARK GRAY
H84	C42	MAHOGANY
H90	C47	CLEAR RED
H94	C138	CLEAR GREEN
H302	C302	GREEN

AQUEOUS	Mr.COLOR	
H310	C310	BROWN
H323	C323	LIGHT BLUE
H332	C332	LIGHT GRAY
H414	C114	RED
H417	C117	LIGHT BLUE
H435	C35	I/JN GRAY
Mr.METAL COLOR		
MCP13		STAINLESS
MCP14		DARK IRON
MCP16		ALUMINIUM
Mr.COLOR SUPER METALLIC		
SM01		SUPER FINE SILVER

- 1** = **MARKINGS A; D** (C11, C17, C80, C90)
- 1** = **MARKINGS B; E** (C70, C80, C90)
- 1** = **MARKING C** (C117, C17)

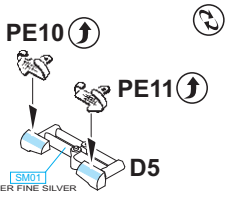

INTERIOR COLOUR BARVA INTERIÉRU

INTERIOR

60% **C34** SKY BLUE + 20% **C66** BRIGHT GREEN + 20% **C80** COBALT BLUE

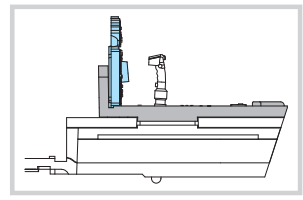
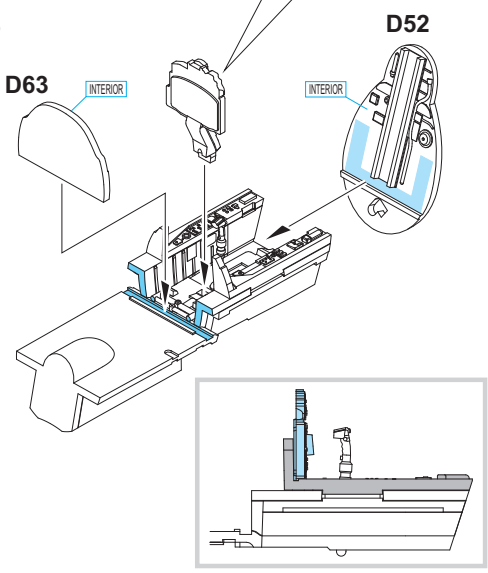
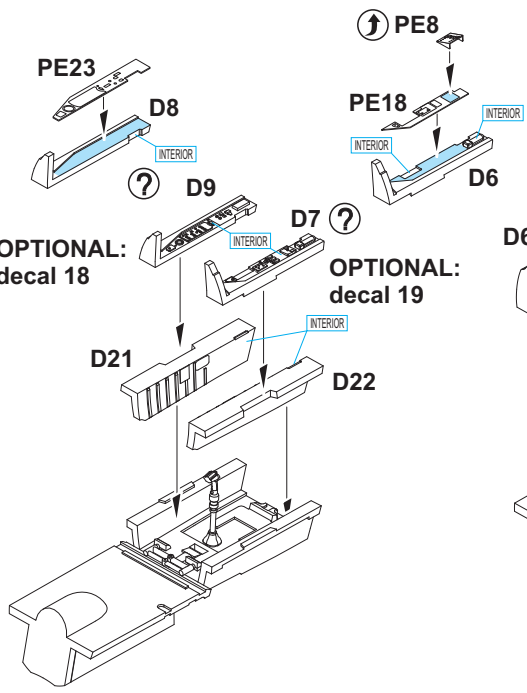
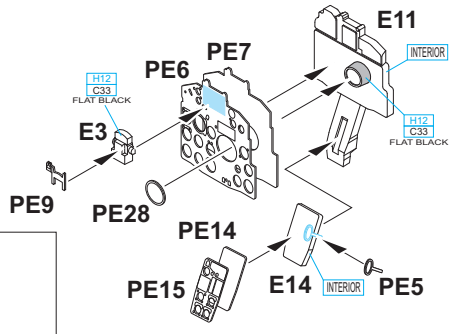
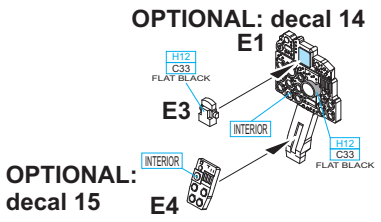
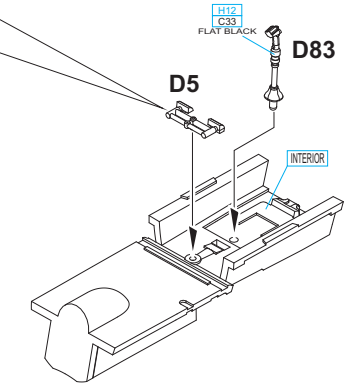
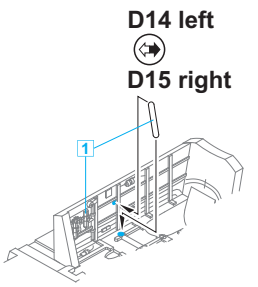
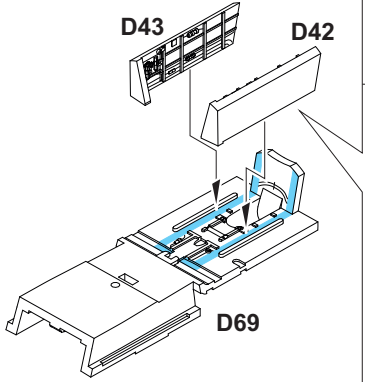

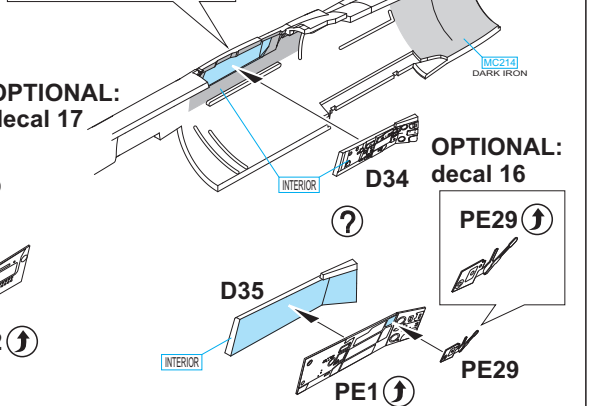
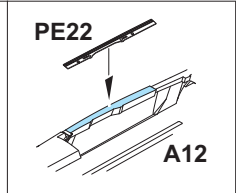
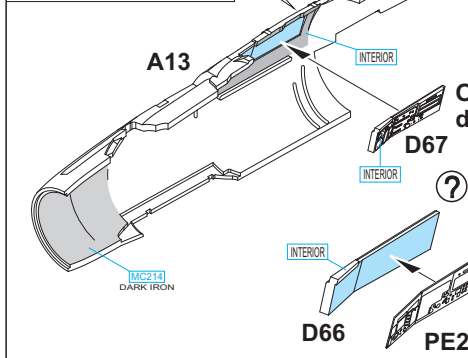
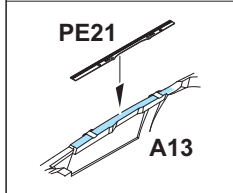
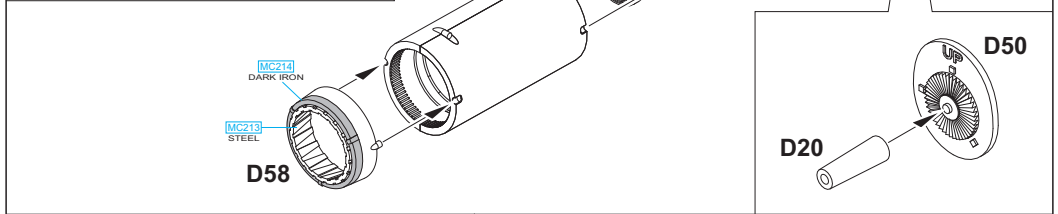
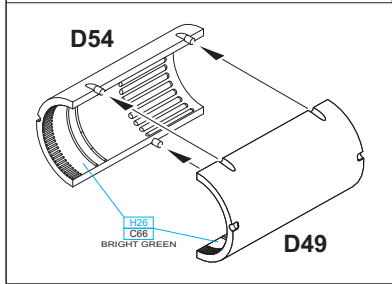
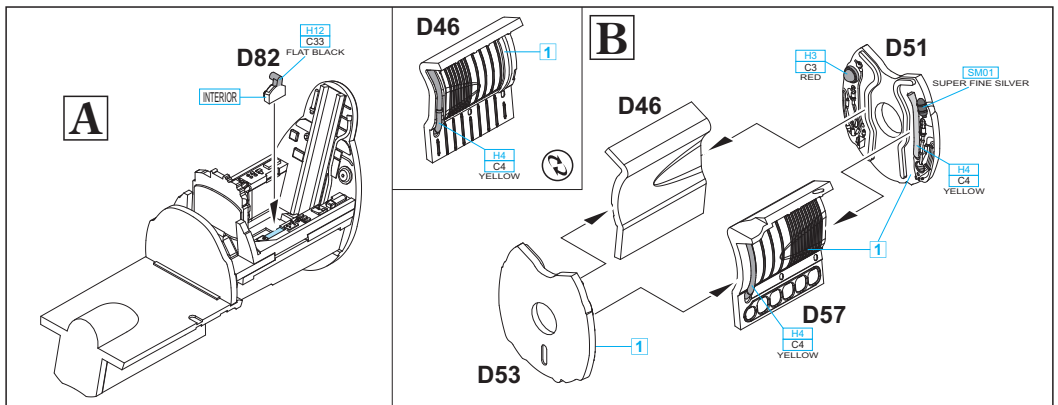

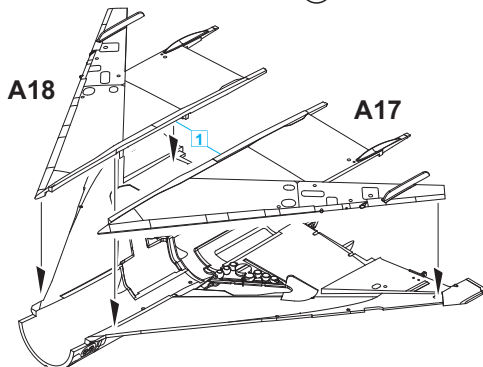
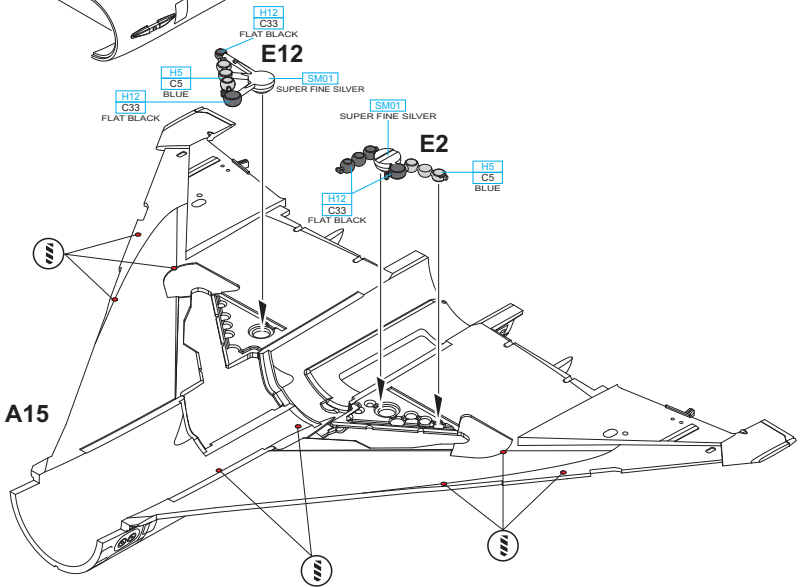
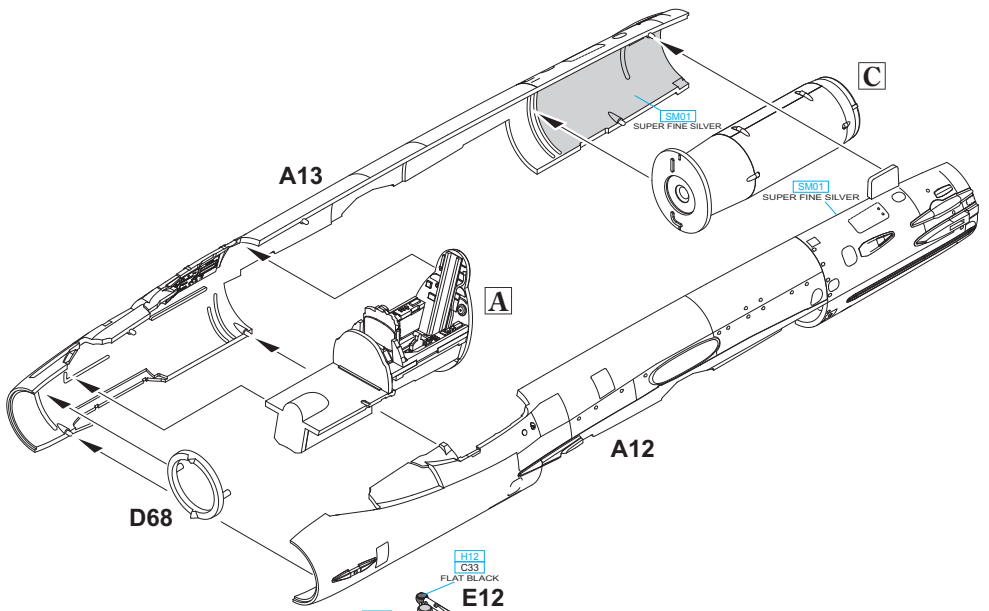

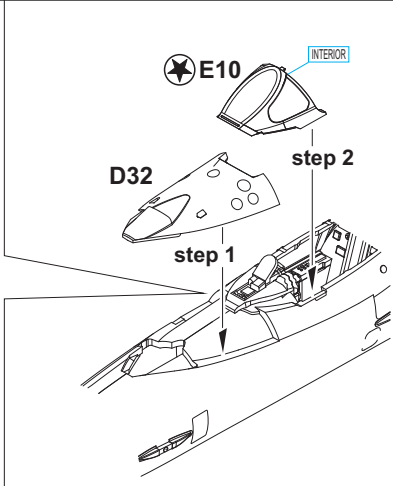
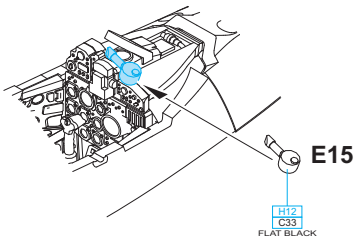
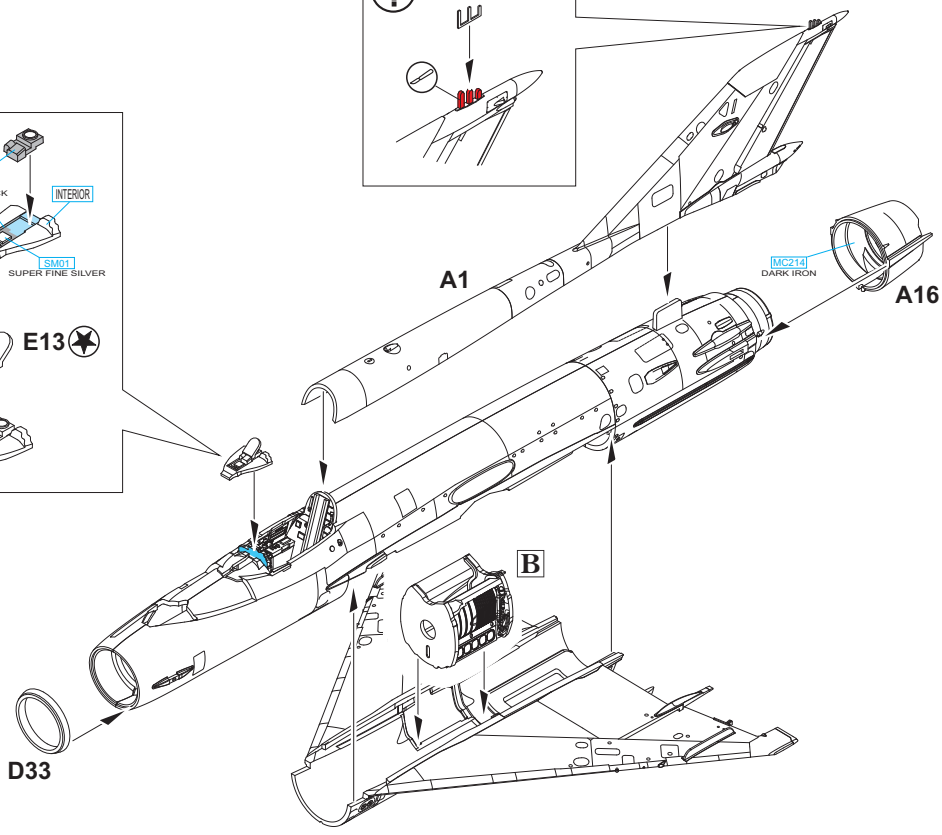
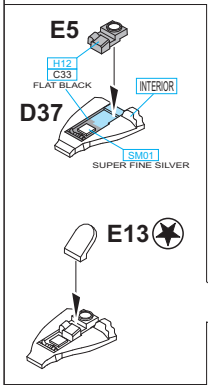
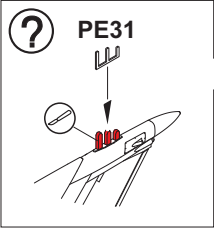

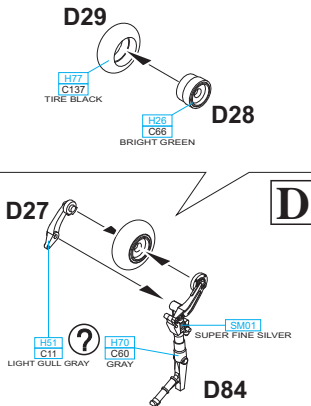
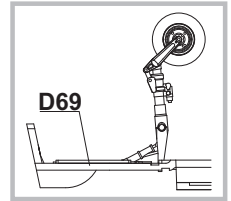
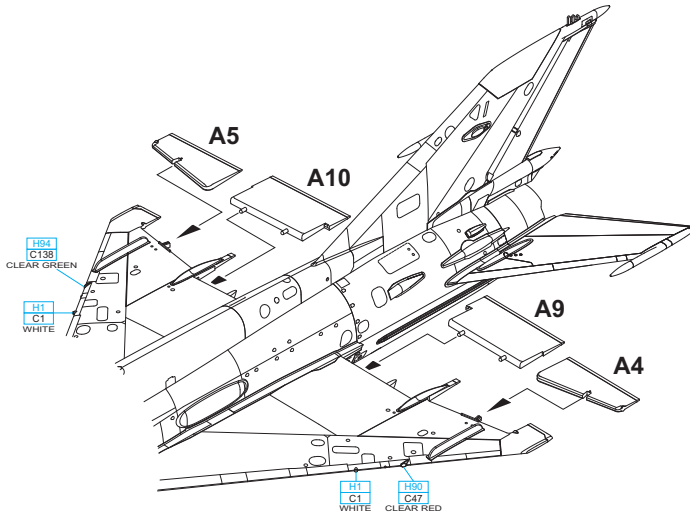
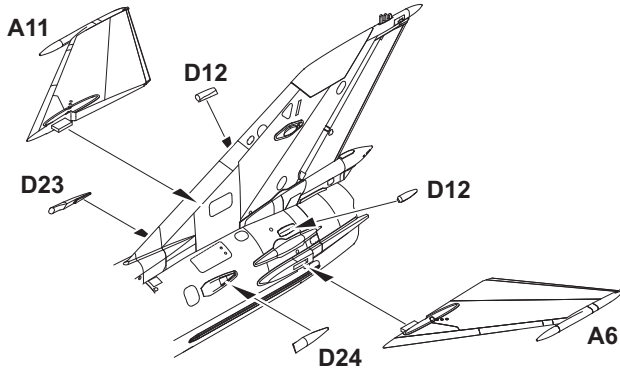

D

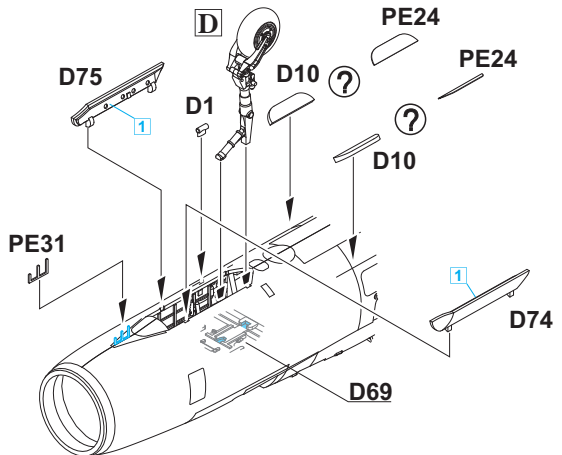

- H51
C11
LIGHT GULL GRAY - MARKINGS **A; D**
- H70
C60
GRAY - MARKINGS **B; C; E**

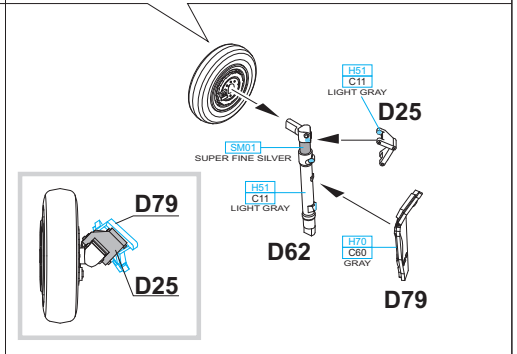
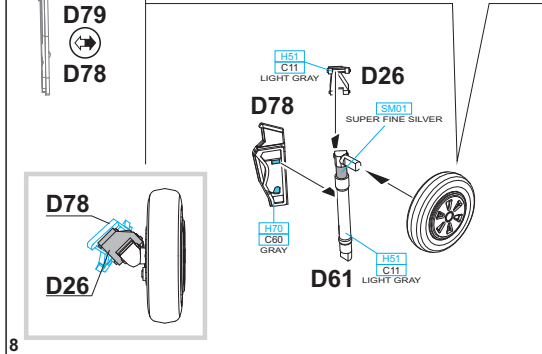
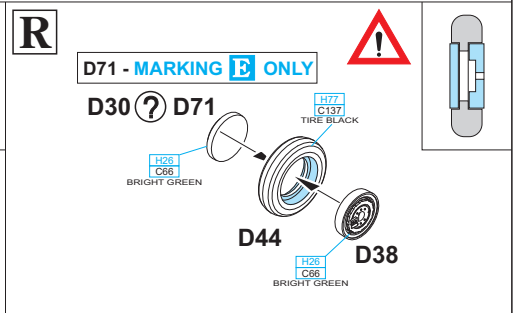
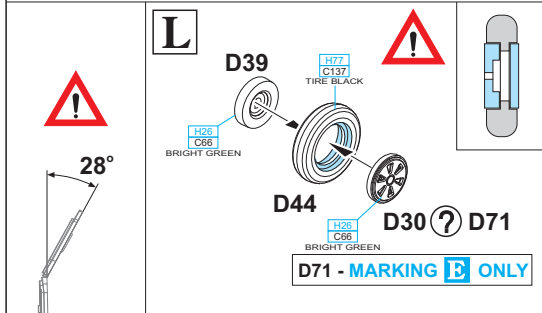
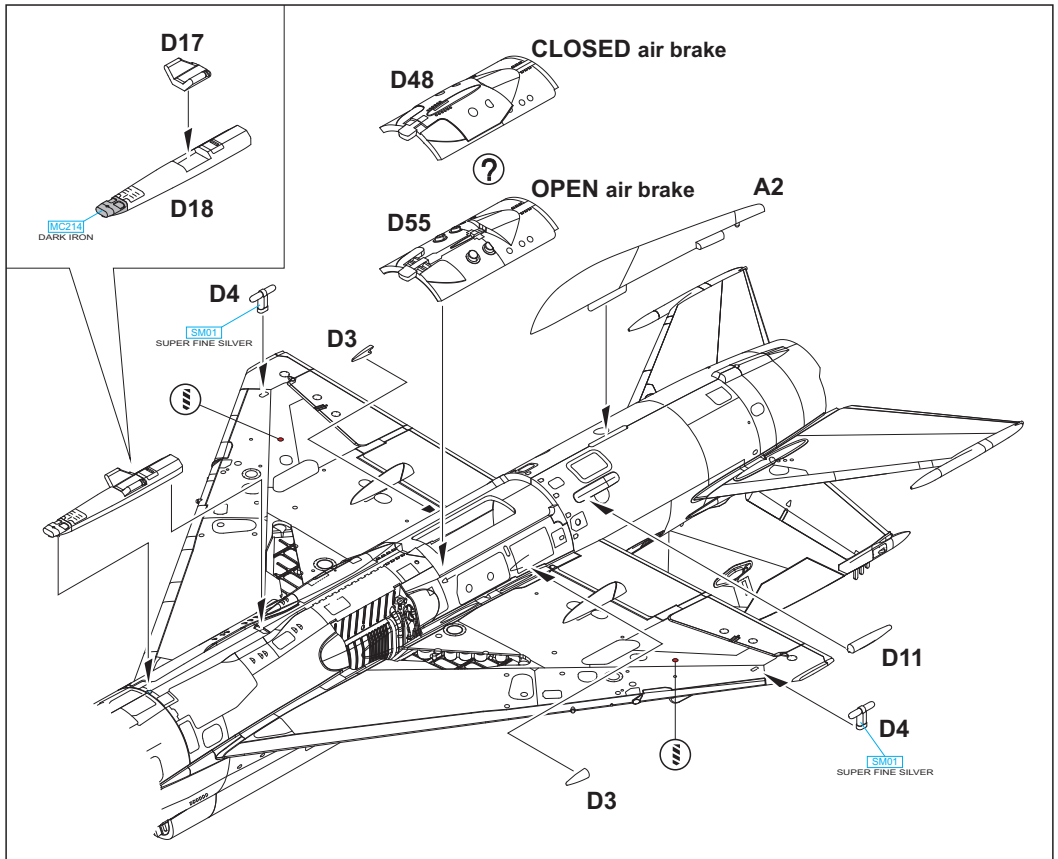

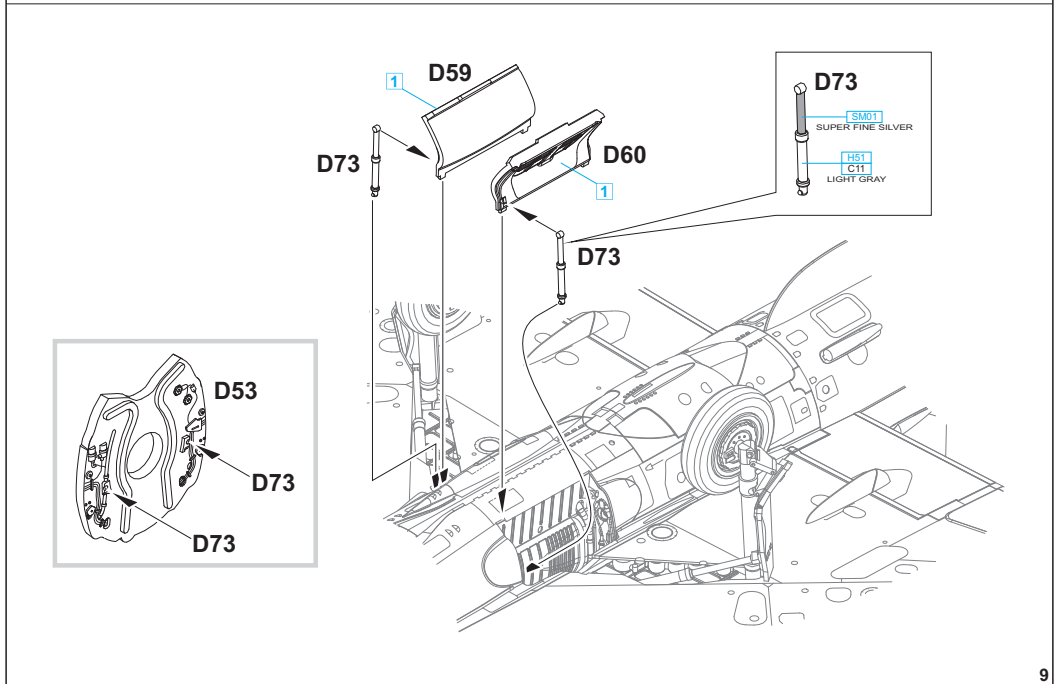
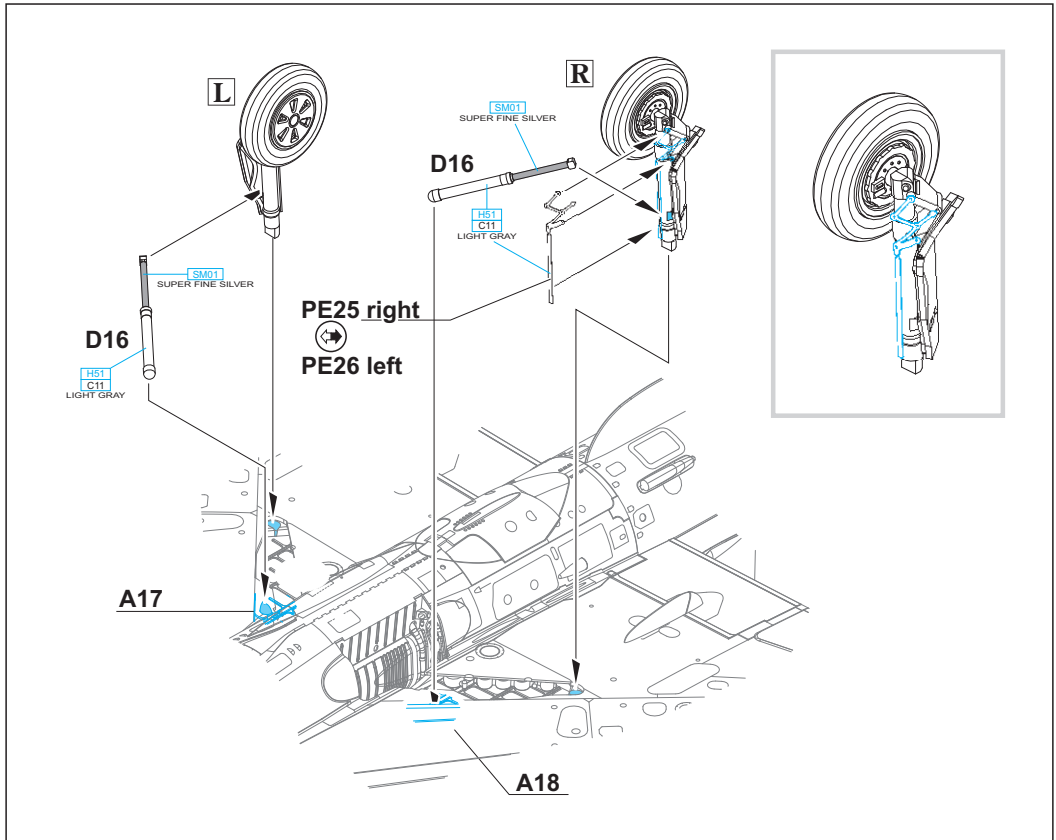

E 2 pcs.

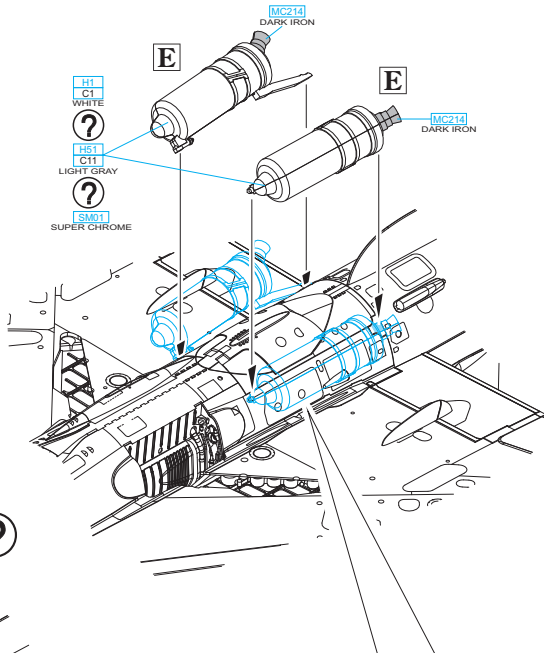
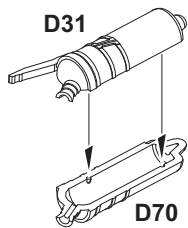

?

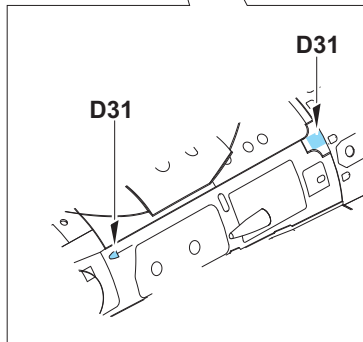
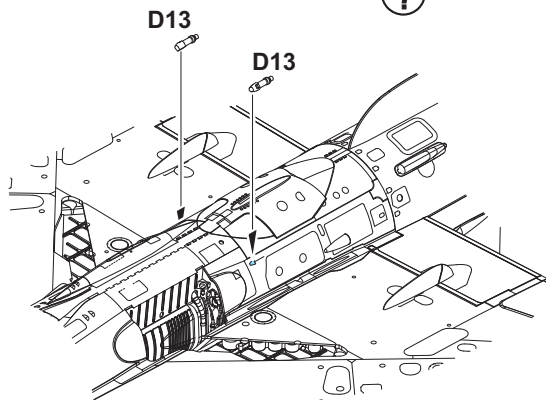

- 2** =
- H51 C11** - MARKINGS **A; D**
LIGHT GULL GRAY
 - H4 C4** - MARKINGS **B; E**
YELLOW
 - H417 C117** - MARKING **C**
LIGHT BLUE

?

OPEN air brake
D45

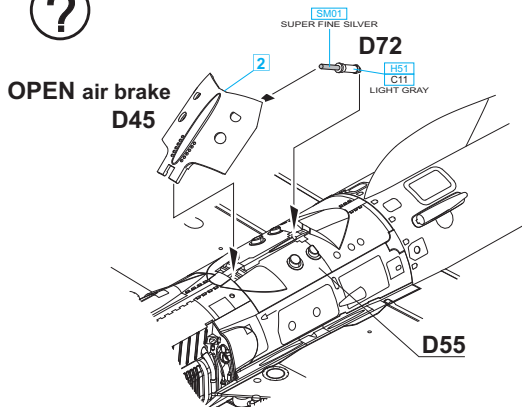
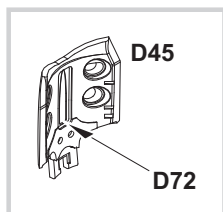

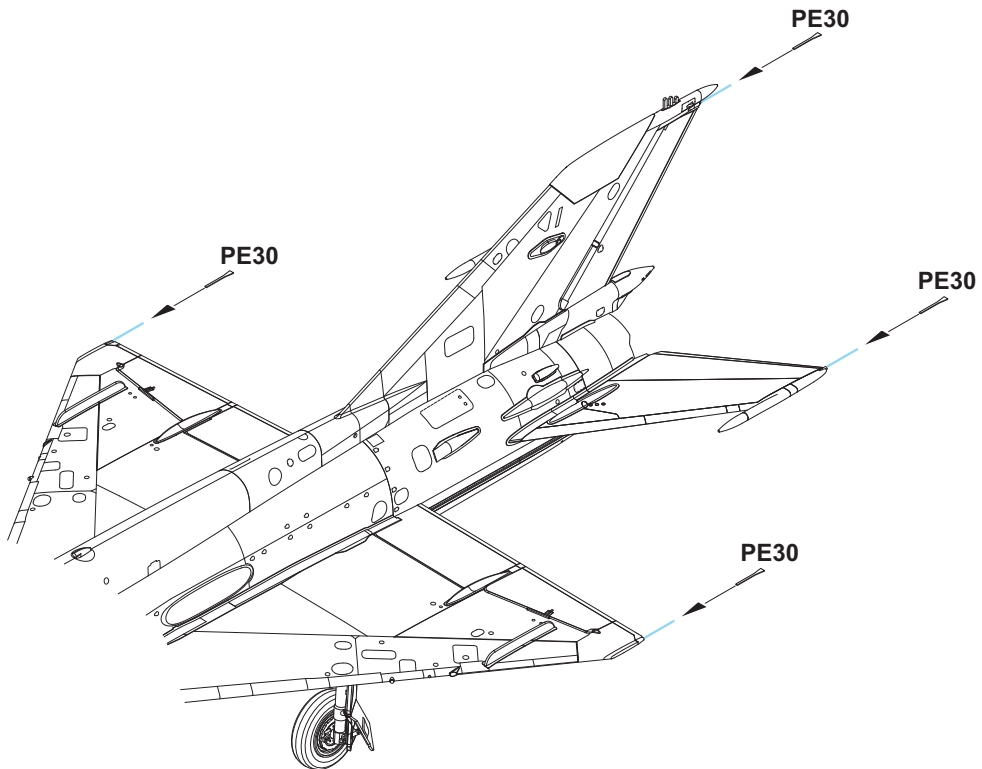

F



D65

H392
C392
LIGHT GRAY

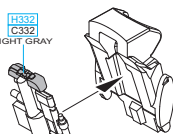

D64

H53
C13
NEUTRAL GRAY

D36

H392
C392
LIGHT GRAY

H53
C13
NEUTRAL GRAY

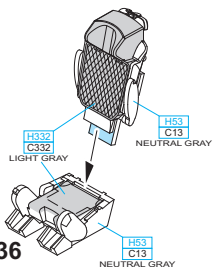

H53
C13
NEUTRAL GRAY

PE17

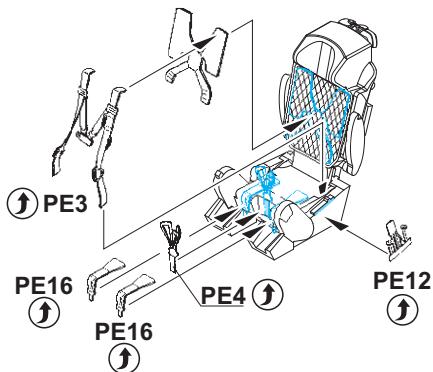

PE3

PE16

PE16

PE4

PE12

D65

D36

D64

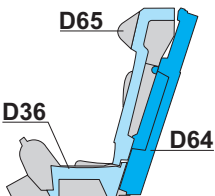

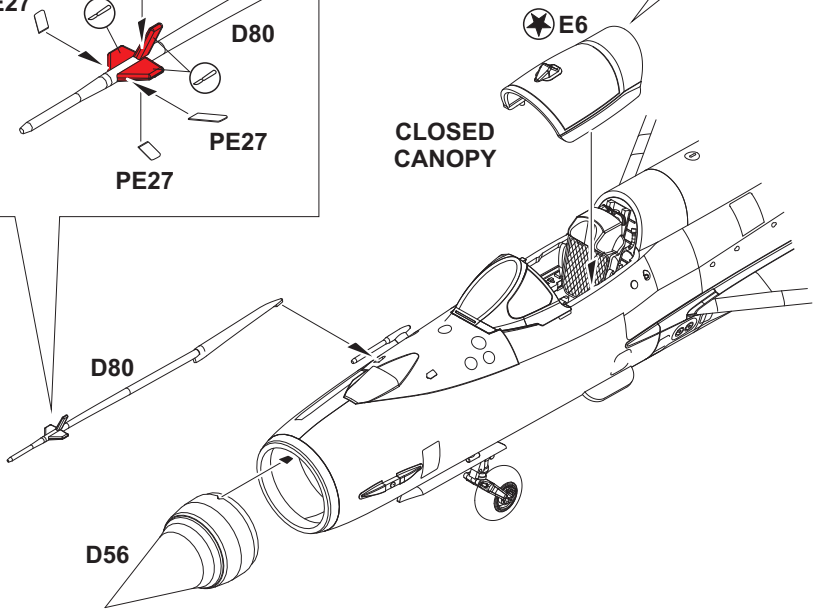
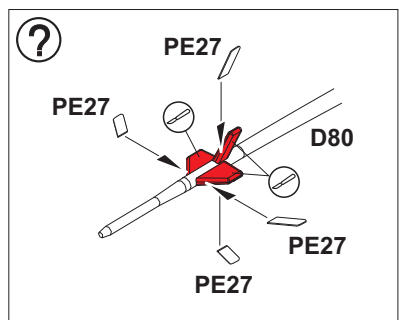
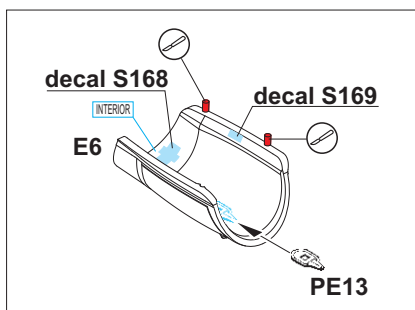
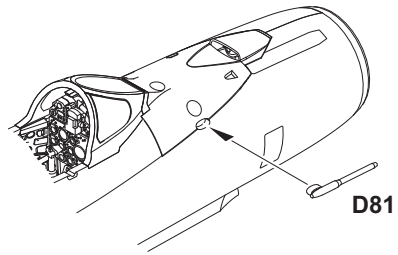
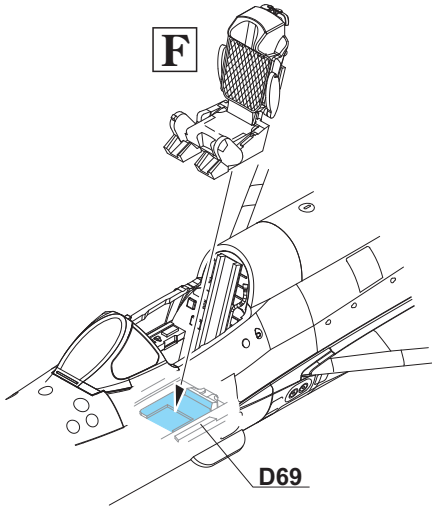

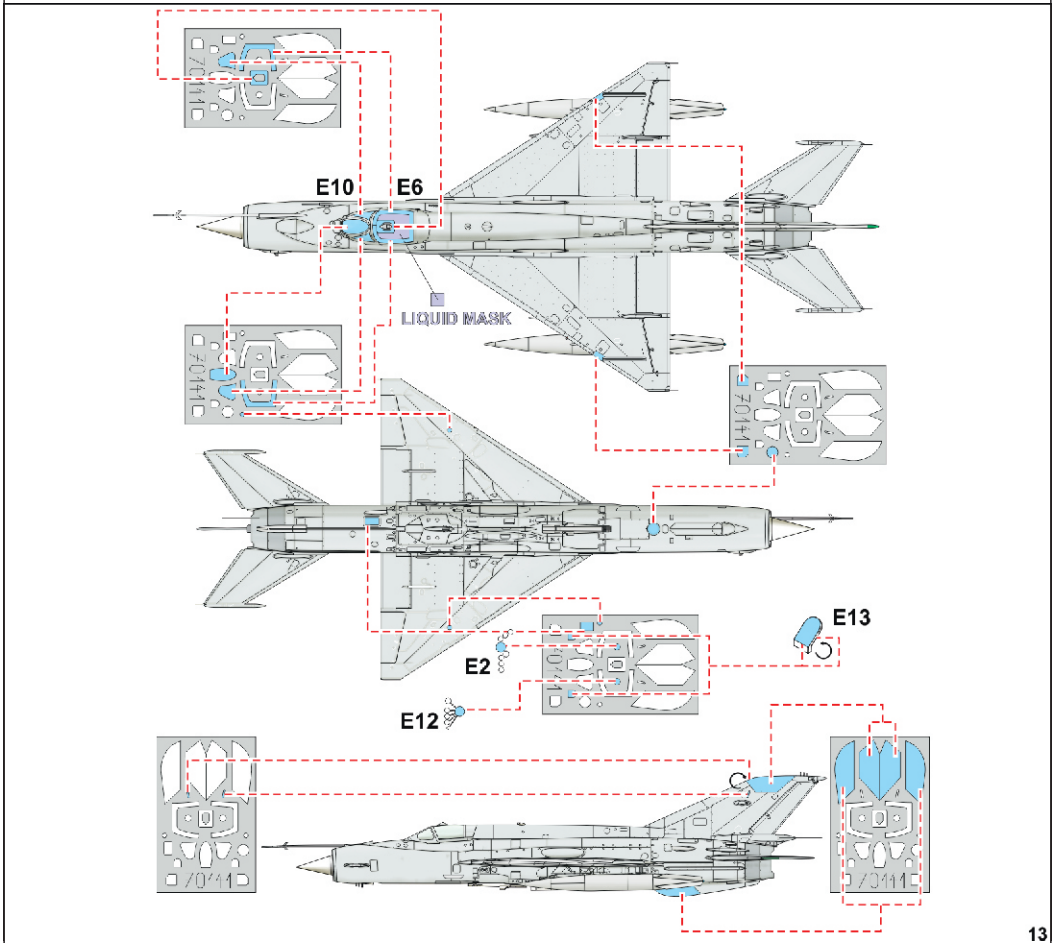
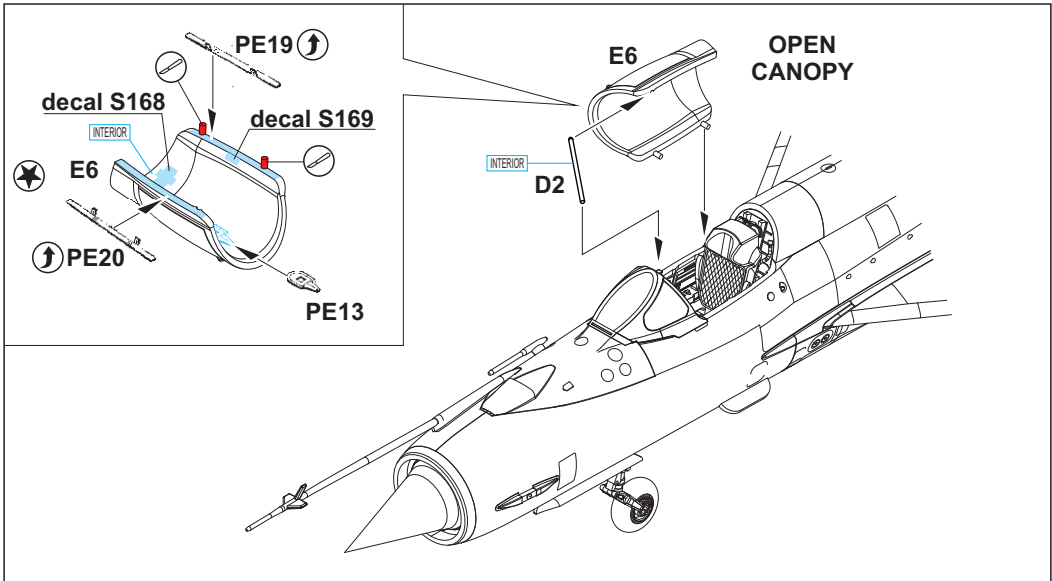

**EXTERNAL FUEL TANK 800 I
PŘÍDAVNÁ NÁDRŽ 800 I**

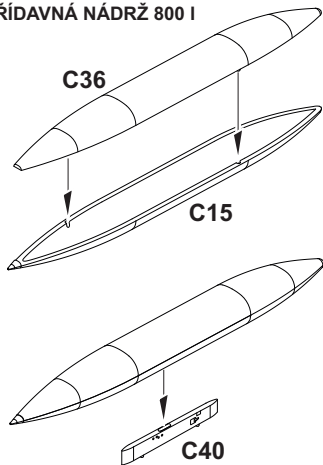

**EXTERNAL FUEL TANK 490 I
PŘÍDAVNÁ NÁDRŽ 490 I**
2 pcs.

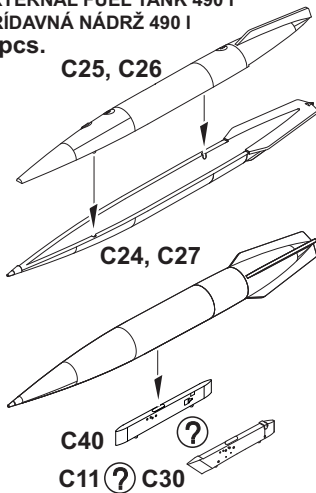

R-13
2 pcs.

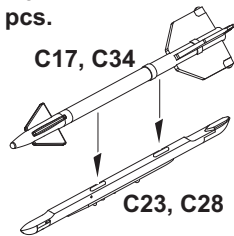

R-3S
2 pcs.

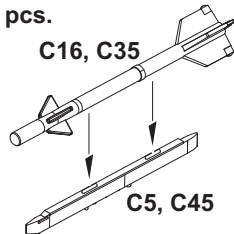

RS-2US
2 pcs.

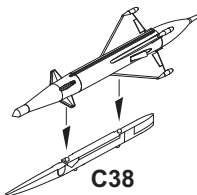
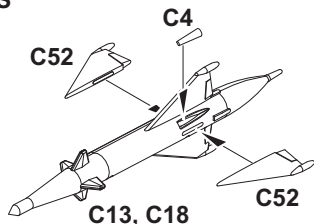

R-60
2 pcs.

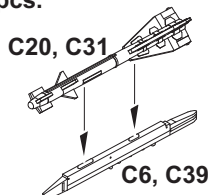

**EXTERNAL FUEL TANK PYLONS
ZÁVĚSNÍK
PŘ. NÁDRŽE
C30**

UNDERSURFACE
COLOR



**EXTERNAL FUEL TANK PYLONS
ZÁVĚSNÍK
PŘ. NÁDRŽE
C40 C10**

UNDERSURFACE
COLOR

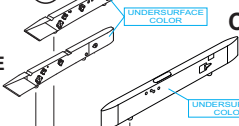

UNDERSURFACE
COLOR

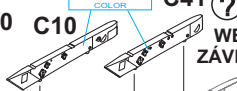

**EXTERNAL FUEL TANK PYLONS
ZÁVĚSNÍK
PŘ. NÁDRŽE
C11**

UNDERSURFACE
COLOR

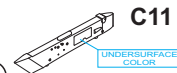

**WEAPON PYLONS
ZÁVĚSNÍK VÝZBROJE
C9**

**WEAPON PYLONS
ZÁVĚSNÍK VÝZBROJE**

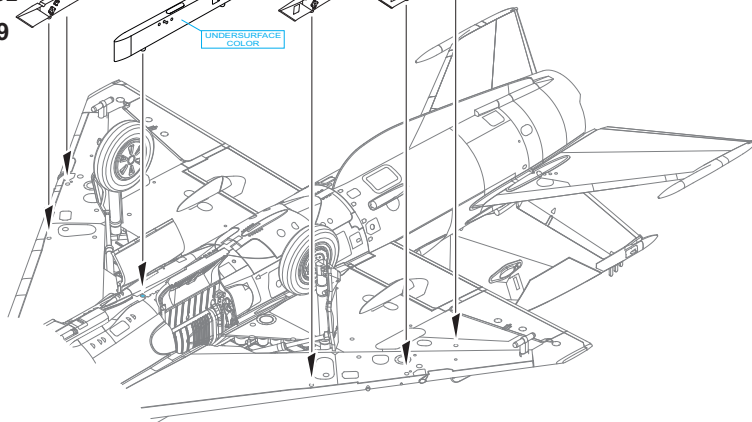

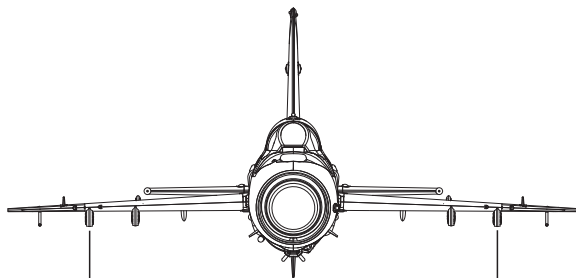

**EXTERNAL
FUEL
TANK 800 l**

|| C40



**EXTERNAL
FUEL
TANK 490 l**

|| C40



**EXTERNAL
FUEL
TANK 490 l**

|| C11



|| C30



TYPICAL ARMAMENT FOR QUICK REACTION ALERT DUTY

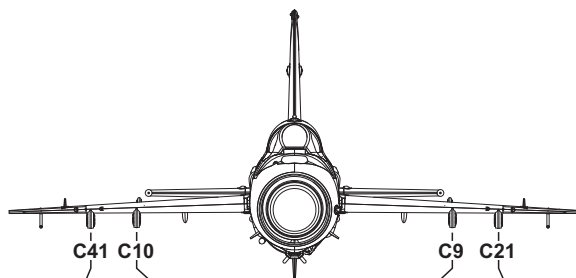

2x RS-2US

|| C5



|| C38



|| C38



|| C45



2x R-3S

2x RS-2US

|| C23



|| C38



|| C38



|| C28



2x R-13

**TO CHOOSE WEAPON AND EXTERNAL FUEL TANK
OPTION PLEASE FOLLOW YOUR REFERENCE.**

**PRO VOLBU VÝZBROJE A PŘÍDAVNÝCH NÁDRŽÍ SE DRŽTE
DOKUMENTACE KONKRÉTNÍHO STROJE.**

The aircraft with a production number 96007600 was handed over to the Polish Air Force in December 1975, it was then sent to the 34th Pułk Lotnictwa Myśliwskiego at Gdynia-Babie Doły Base. It then served by other squadrons. From May 13th, 1989 it was used by 2nd Eskadra Lotnictwa Myśliwskiego, located at Mierzęcice Air Base. The 2nd ELM used the plane until October 1998. In 1999, the aircraft was sold to the USA, where it could have been seen until its heavy damage caused by the hurricane in the autumn 2008 in Texas Lone Star Flight Museum in Galveston. MiG-21MF No. 7600 was painted in aluminium paint with Polish national insignia on the aft surfaces and on the undersides of the wing. The nose of the aircraft had a 2nd ELM sign; its smaller version was painted on the vertical stabilizer. There is an 11th PLM sign behind the red number 7600.

STENCILS: blue variant

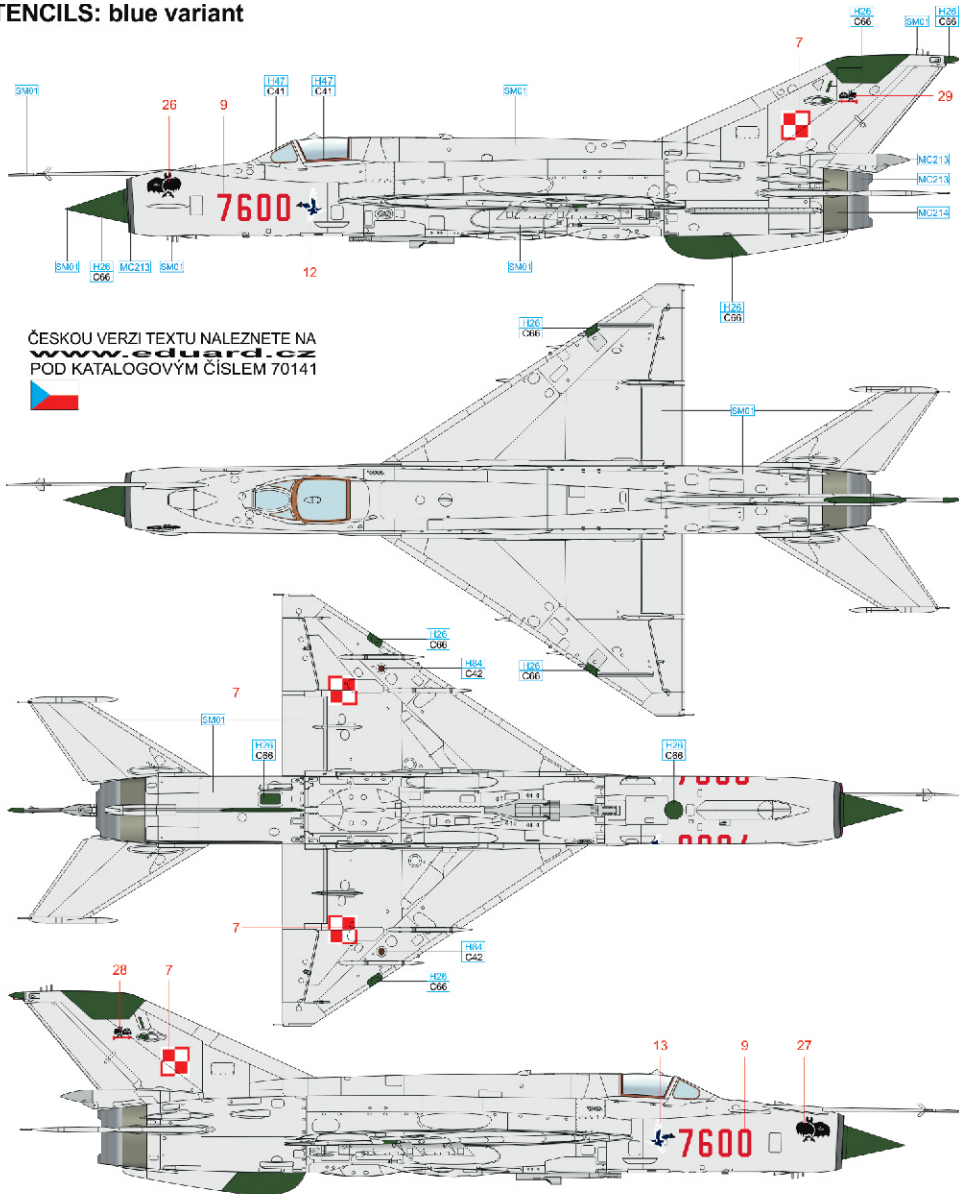

ČESKOU VERZI TEXTU NALEZNETE NA
www.eduard.cz
 POD KATALOGOVÝM ČÍSLEM 70141



Following the write off of the MiG-21s from the Czech Air Force in the mid 2005, the MiG-21MFs No. 5508 and 5512, along with the MiG-21UM No. 9341, were purchased by The Republic of Mali. After the transfer of the aircraft to the Senou Airbase, all three fighter planes were assembled by a group of Czech specialists encompassing two pilots, and then there were test flights performed and the planes were handed over to Malian Air Force. The final phase of the mission included the fly-by of TZ-356 MiG piloted by Malian pilot above the capital city of Bamako. The TZ-356 aircraft, as the aircraft No. 5512 was marked, had a camouflage in a form of two shades of green and two shades of brown colour on the upper surfaces and the sides. The undersides were painted blue. The usual six positions of the MiG aircraft bore the Malian national insignia.

STENCILS: none

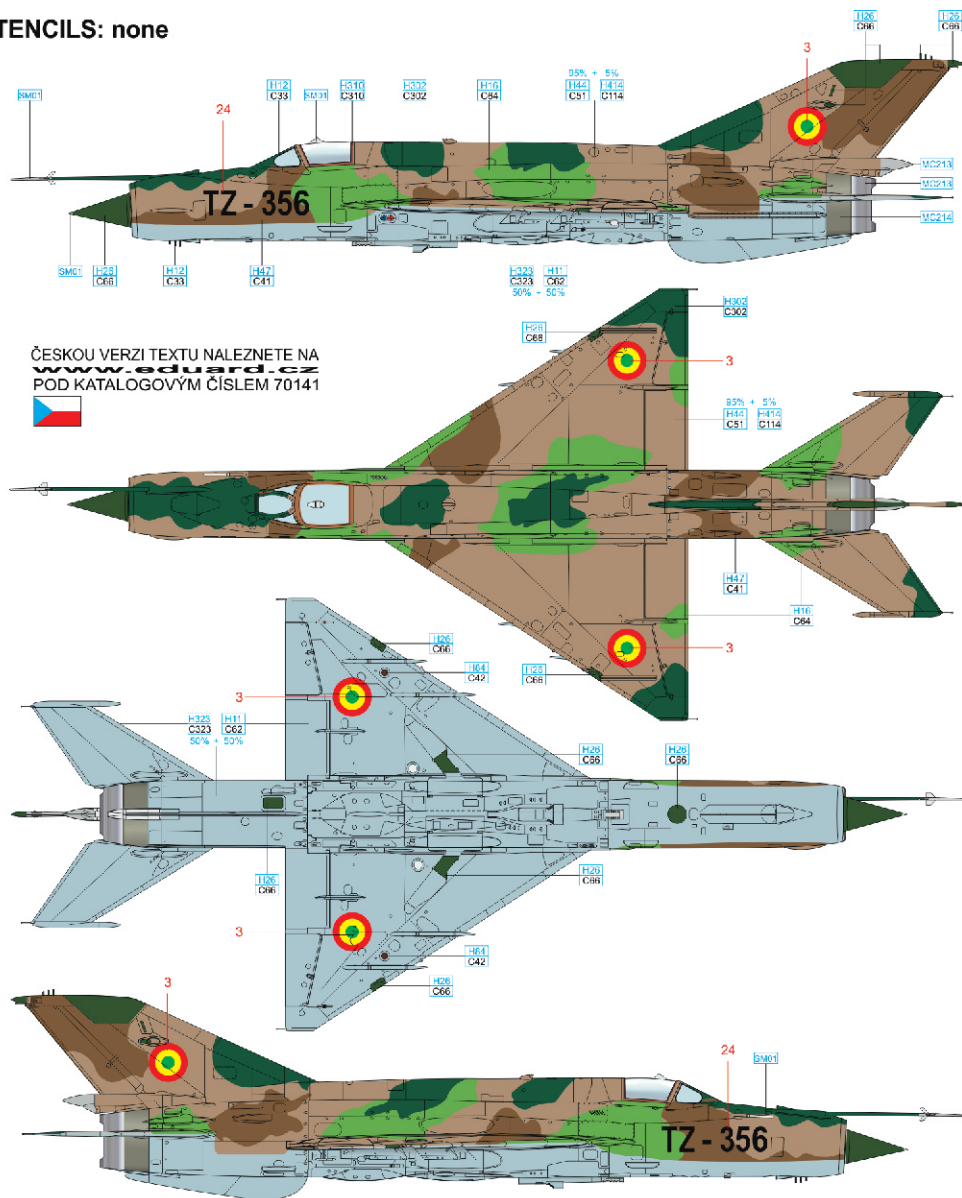

ČESKOU VERZI TEXTU NALEZNETE NA
www.eduard.cz
 POD KATALOGOVÝM ČÍSLEM 70141



STEEL	MC213	SUPER FINE SILVER	SMC1	MAHOGANY	H34 C42	RED BROWN	H47 C41	BROWN	H310 C310	LIGHT BLUE	H328 C328	FLESH	H442 C51
DARK IRON	MC214	BRIGHT GREEN	H20 C66	GREEN	H202 C62	YELLOW GREEN	H13 C54	BLACK	H12 C33	WHITE	H11 C62	RED	H114 C114



LEVÝ VNĚJŠÍ PALIVOVÝ PYLON
LEFT OUTSIDE UNDERWING TANK PYLON

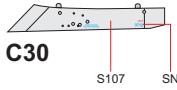

SN - SERIAL NUMBER
MALÉ NA DRÁK LETOUNU
STŘEDNÍ NA ZÁVĚSNÍKY
VELKÉ NA RAKETNICE

SN - SERIAL NUMBER
SMAL TO AIRFRAME
MEDIUM TO PYLONS
LARGE TO ROCKET LAUNCHERS

PODTRUPOVÝ PYLON
FUSELAGE PYLON

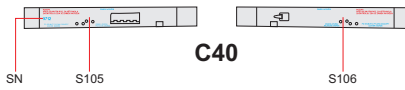

PRÁVÝ VNĚJŠÍ PALIVOVÝ PYLON
RIGHT OUTSIDE UNDERWING TANK PYLON

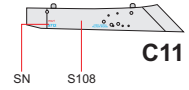

LEVÝ VNĚJŠÍ PYLON
LEFT OUTSIDE PYLON

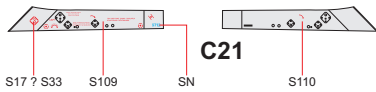

PRÁVÝ VNĚJŠÍ PYLON
RIGHT OUTSIDE PYLON

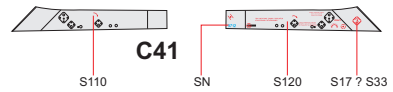

LEVÝ VNITŘNÍ PYLON
LEFT INSIDE PYLON



PRÁVÝ VNITŘNÍ PYLON
RIGHT INSIDE PYLON



C38

APU-7

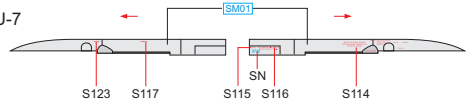
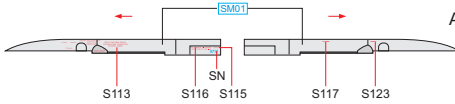

C5, C45

APU-13

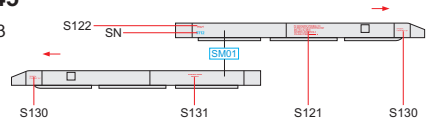
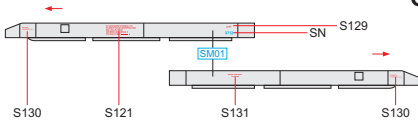

C23, C28

APU-13MT

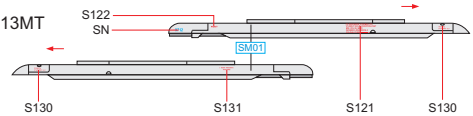
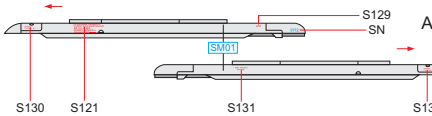

C6, C39

APU FOR R-60

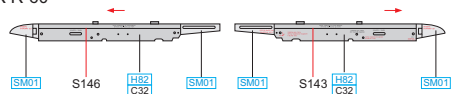
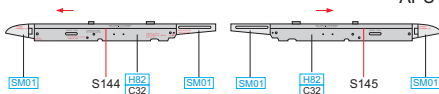

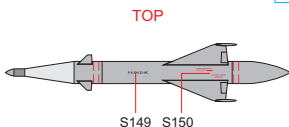
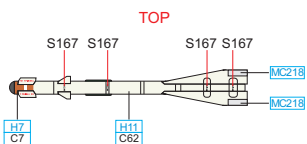
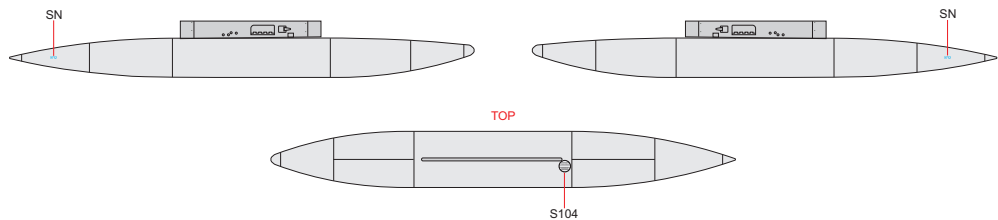
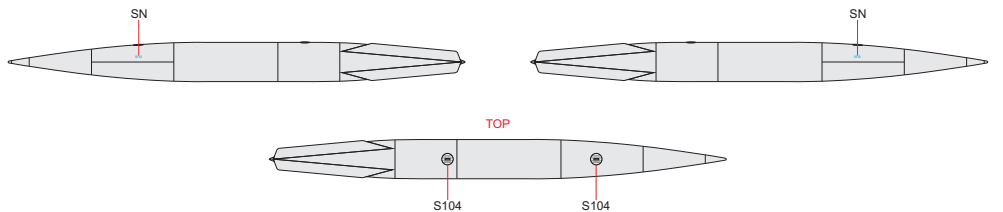

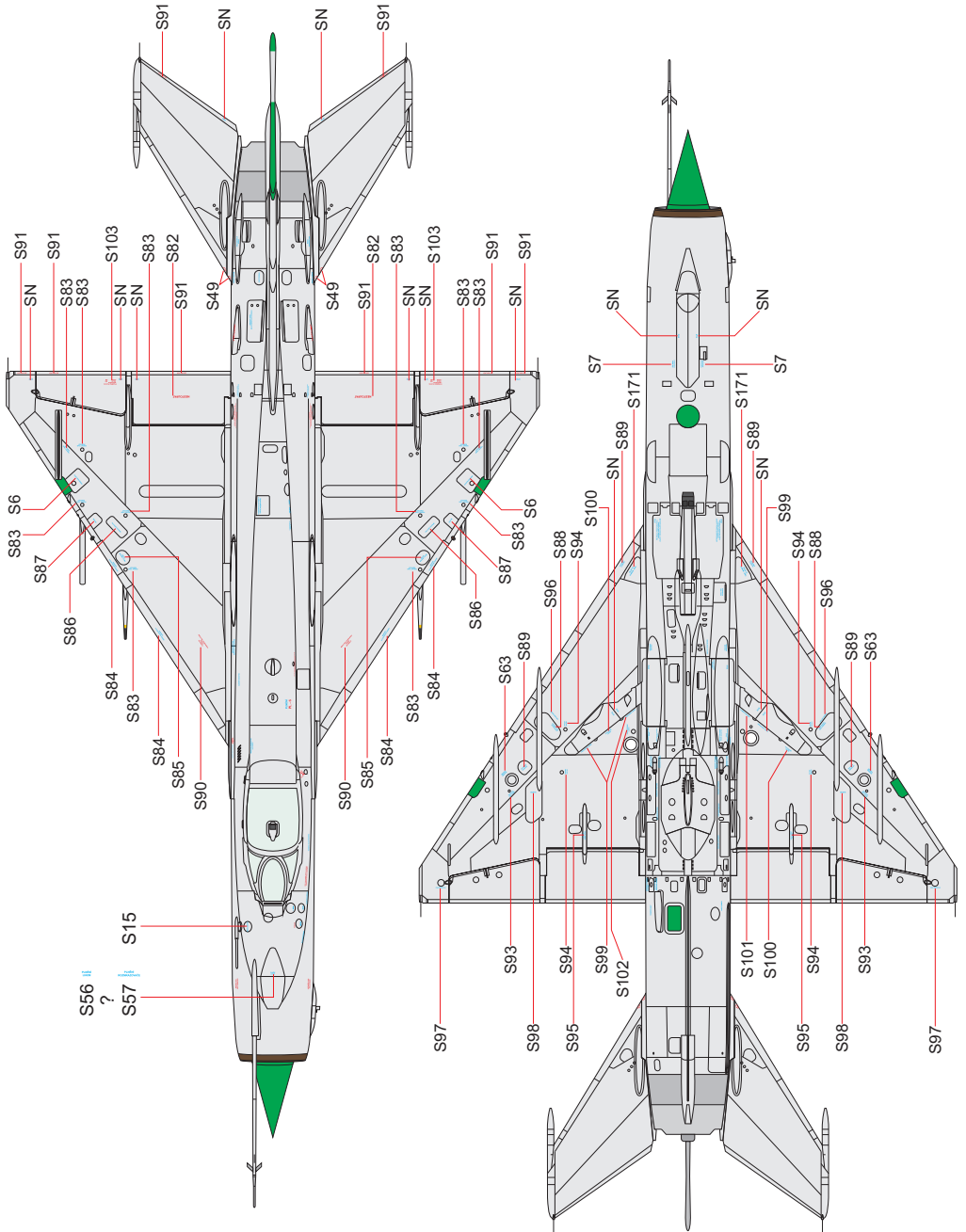

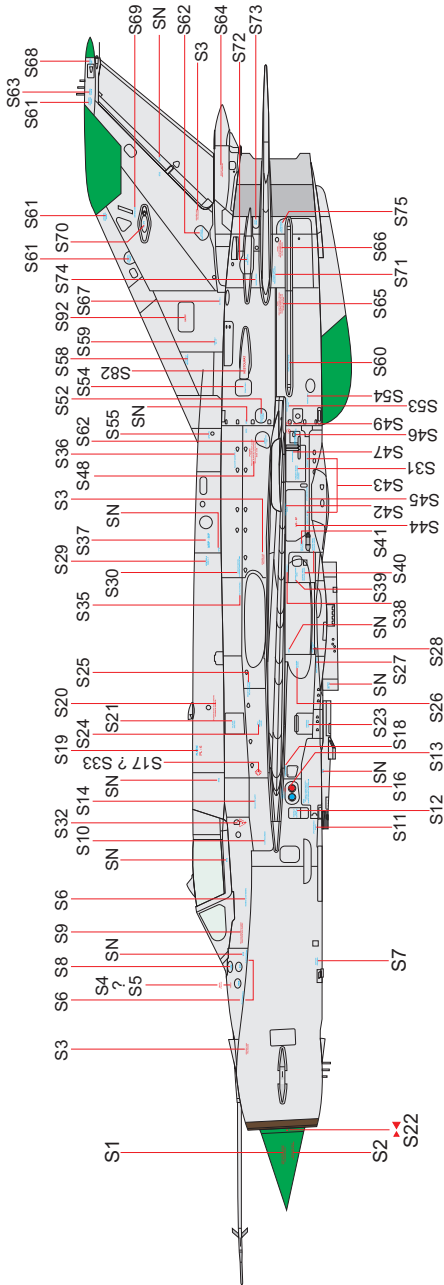

SN - SERIAL NUMBER
 SMAL TO AIRFRAME
 MEDIUM TO PYLONS
 LARGE TO ROCKET LAUNCHERS

SN - SERIAL NUMBER
 MALÉ NA DRÁK LETOUNU
 STŘEDNÍ NA ZÁVEŠNÍKY
 VELKÉ NA RAKETNICE

