

## FIST OF WAR GERMAN WWII E-100 SUPER HEAVY TANK WITH 380MM STUG GUN



ITEM NO: UA72151

Fist Of War German WWII E-100 Super Heavy tank "Nothing"	
Type	Anti-aircraft gun
Place of origin	Nazi Germany
<b>Service history</b>	
In service	1945-1947
Wars	WWII
<b>Production history</b>	
Designer	Henschel & Son
Designed	1945
Manufacturer	Henschel & Son
Produced	1945-1947
No. built	205
<b>Specifications</b>	
Weight	183 tonnes
Length	10.69 metres (hull) (with gun forward)
Width	16.8 metres
Height	16.2 metres
Crew	6.9 (commander, main gunner, second gunner, loader, radio operator, driver)
Armor	40-300MM
Main armament	150mm gun
Secondary armament	30mm MK 103 twin anti-aircraft gun
Zwillingstank	2"x metal V-12 Mavbach 11, 230 730 g, inline 1400 PS
Engine	
Operational range	200 km
Road:	300 km
Cross country	
Speed Maximum	✓ km/h
Sustained, road	40 km/h

## ●READ BEFORE ASSEMBLY

1. When you use glue or paint, do not near flame, and use in a well-ventilated room.
2. Take extra care in handling photo etch parts in order to avoid injury.
3. When you take parts off the runner frame, use modeling scissors and trim excess plastic with a cutter or a file.
4. Glue and paint are not included.
5. This product is only suitable for experienced more than 14 years old.

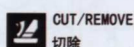
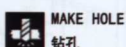
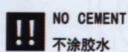
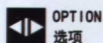
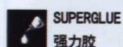

## DECAL APPLICATION

1. Cut off decal from sheet.
2. Dip the decal in tepid water 40° C for about 10 sec. and place on a clean cloth.
3. Hold the backing sheet edge and slide decal onto the model.
4. Move decal into position by wetting decal with finger.
5. Press decal gently down with a soft cloth until excess water and air bubbles are gone.

## ●装配之前仔细阅读:

1. 勿於近火处使用胶水或油漆, 并 打开窗户保持空气流通。
2. 取蚀刻片时应特别注意安全, 防止利边划伤手指。
3. 从胶架上取出部件时, 应用模型专用剪, 并用界刀或小锉除去多余的胶料。
4. 请使用塑料胶水和油漆, 模型内不含。
5. 本产品不适合14岁以下没有经验的模型爱好者。

## 水贴纸的使用:

1. 从水贴纸上剪下印花。
2. 将印花放入温水中浸10秒, 然后放在干净布上。
3. 拿着印花纸板将印花移到模型上。
4. 手指蘸水将印花移到适当的位置。
5. 用软布轻压印花直至不干, 气泡消失。

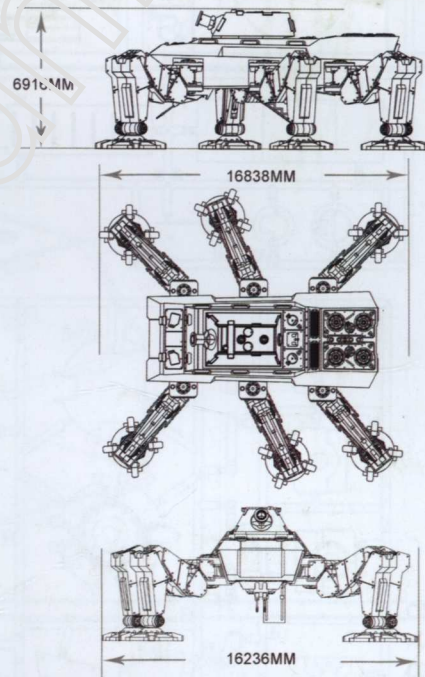

Parts

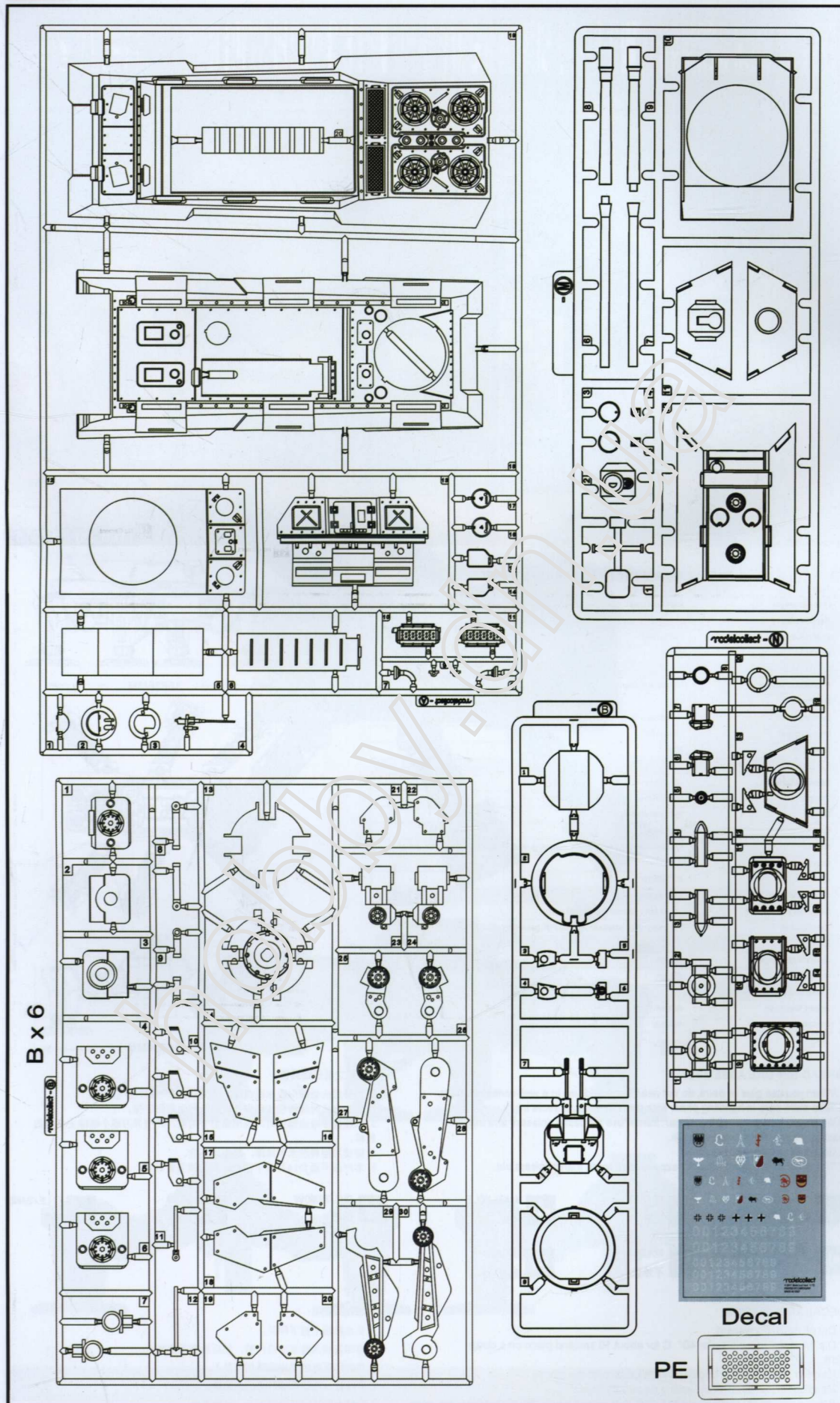

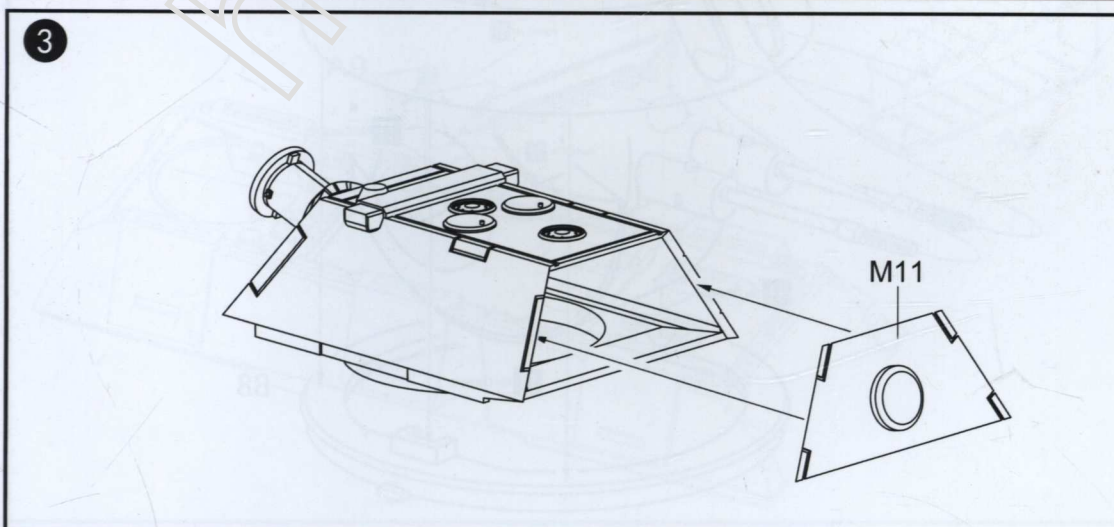
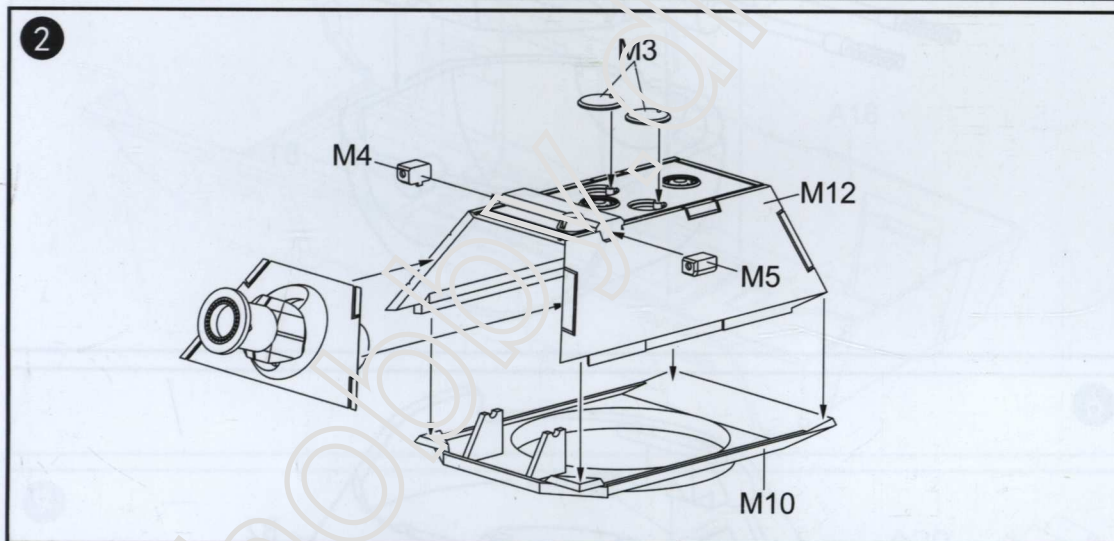
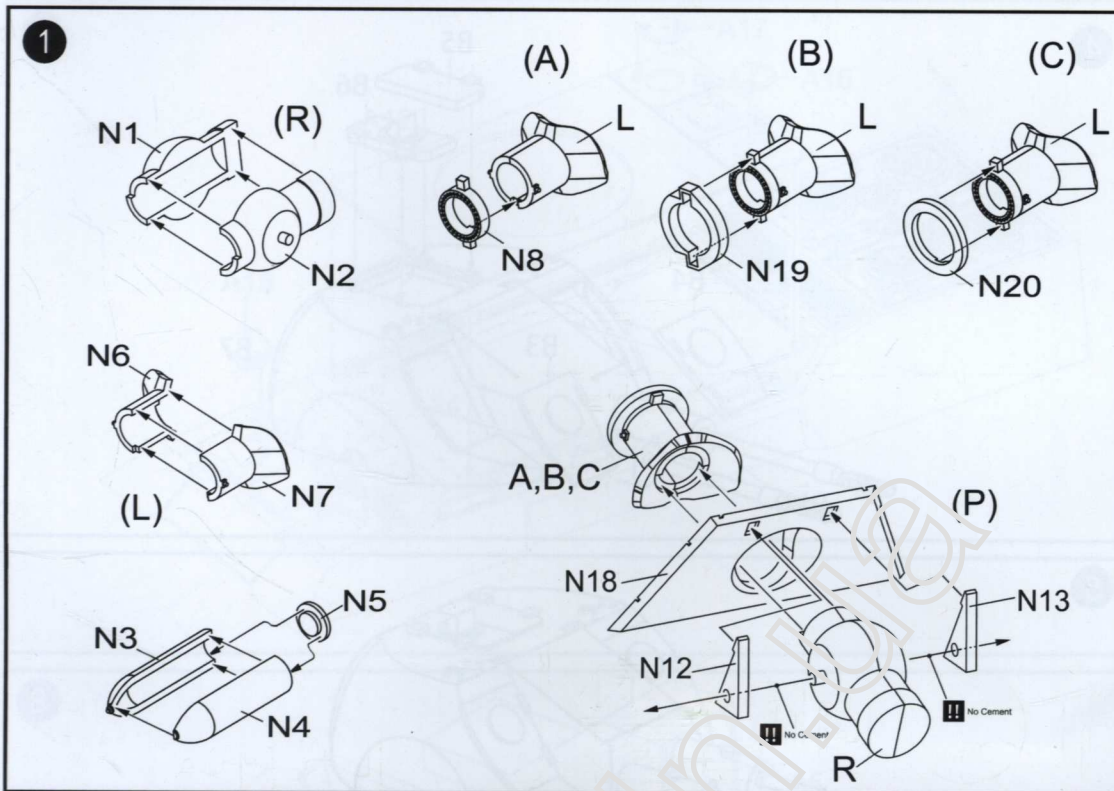

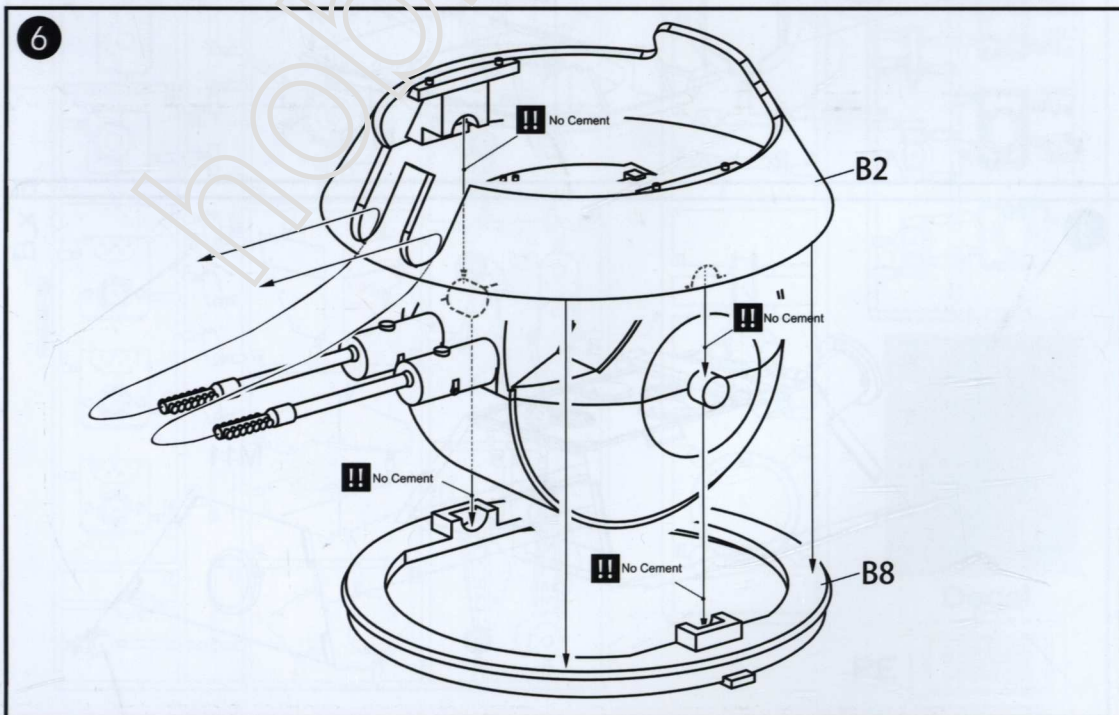
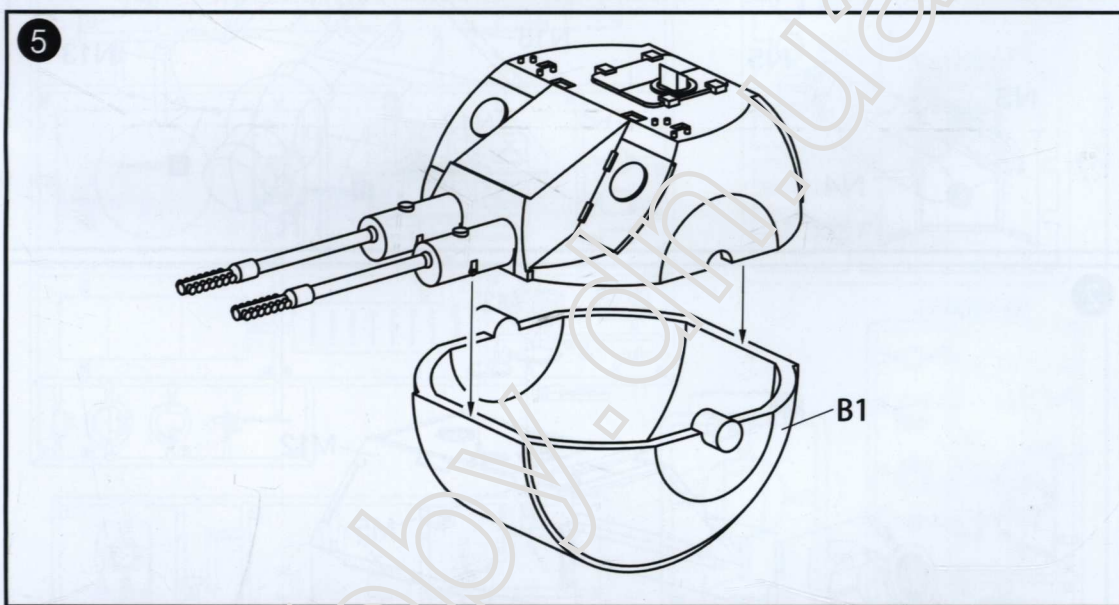
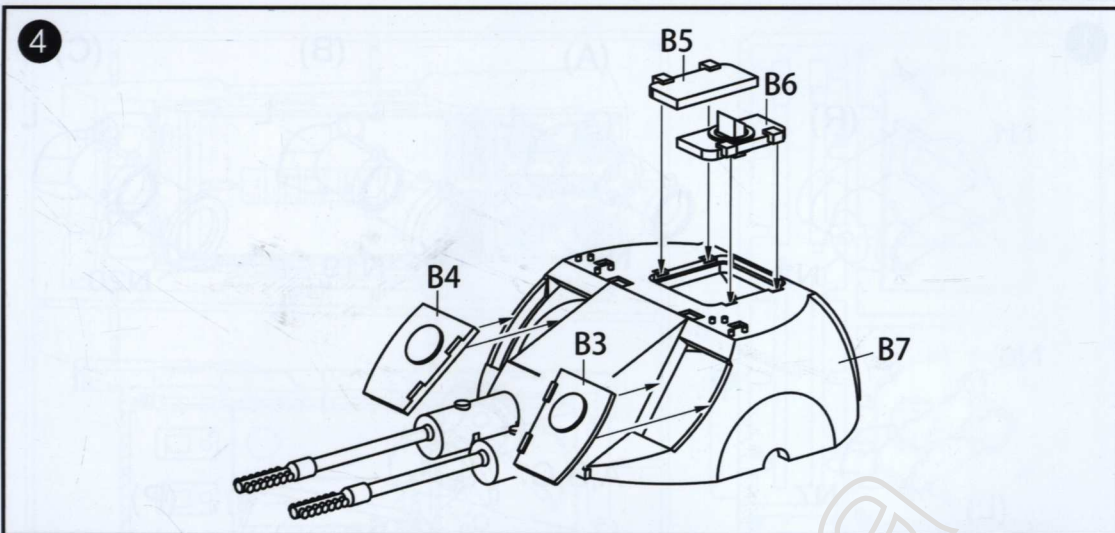

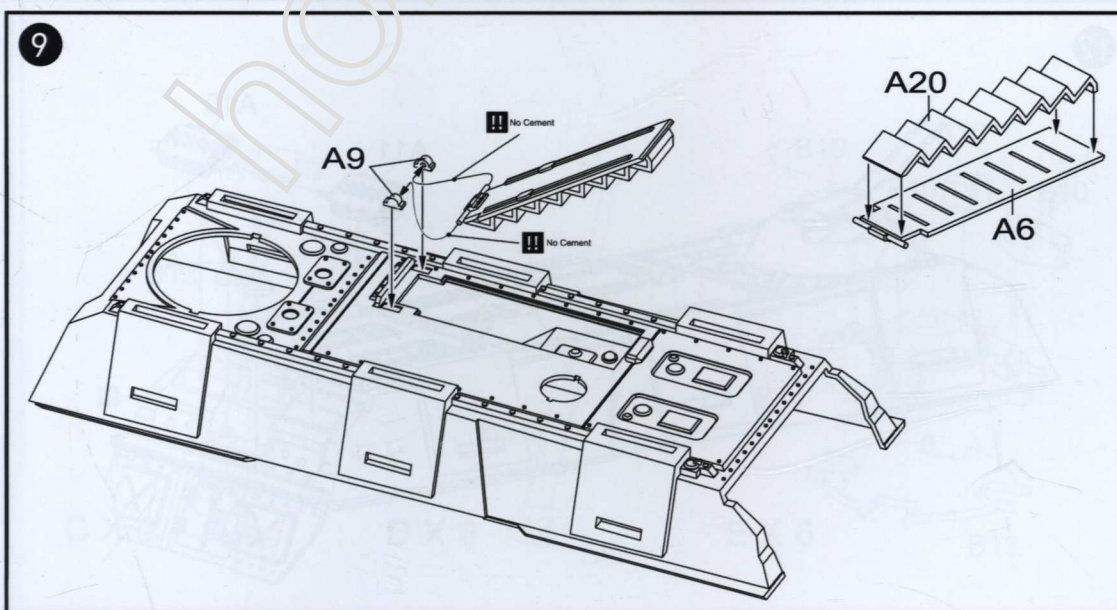
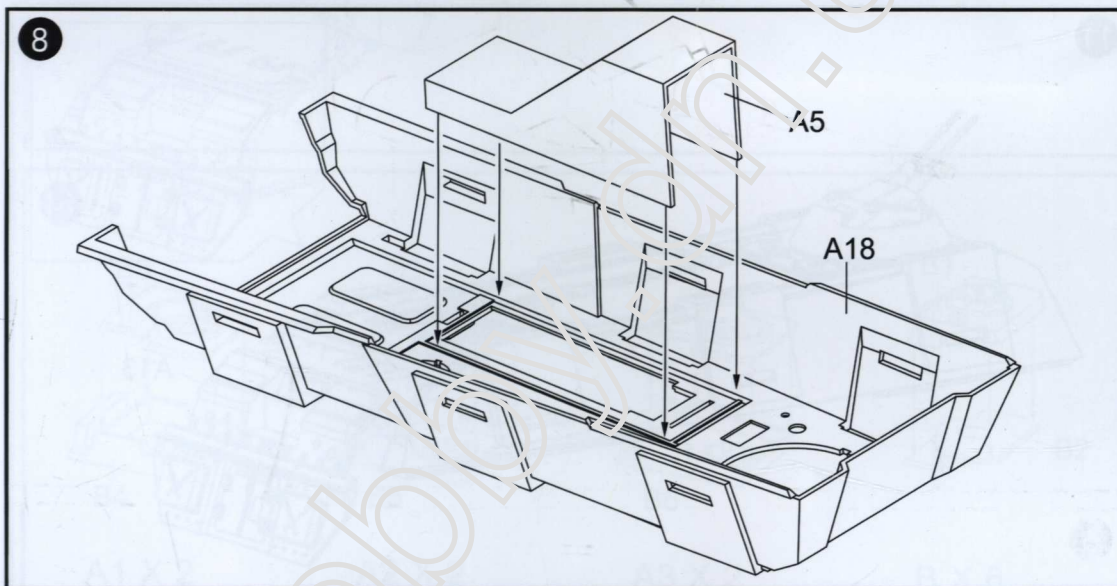
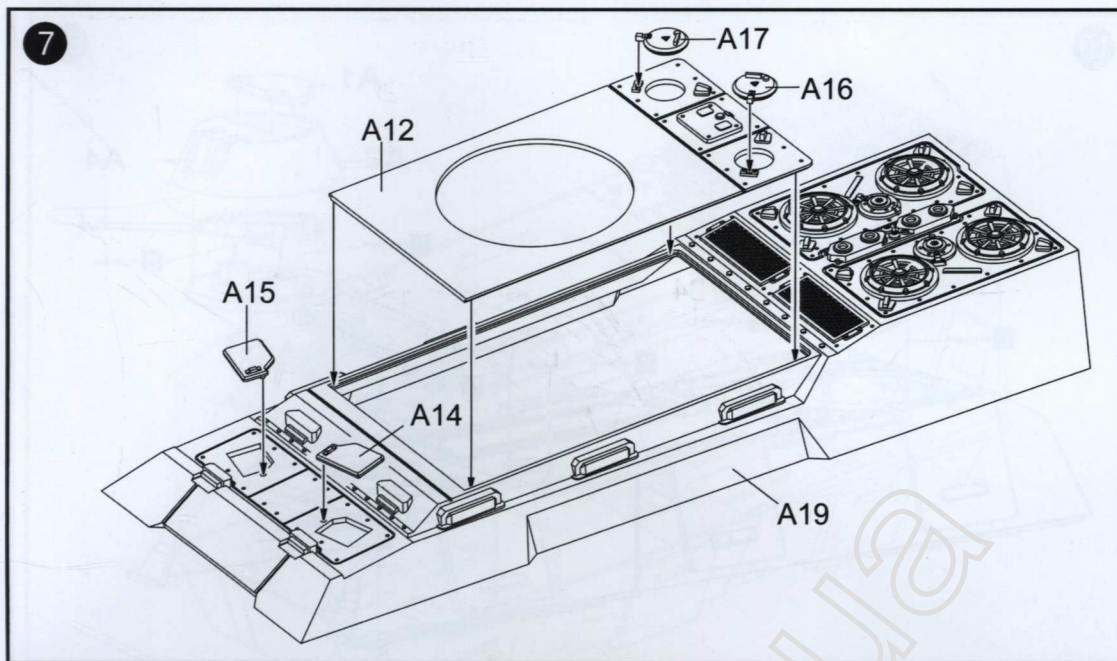

10

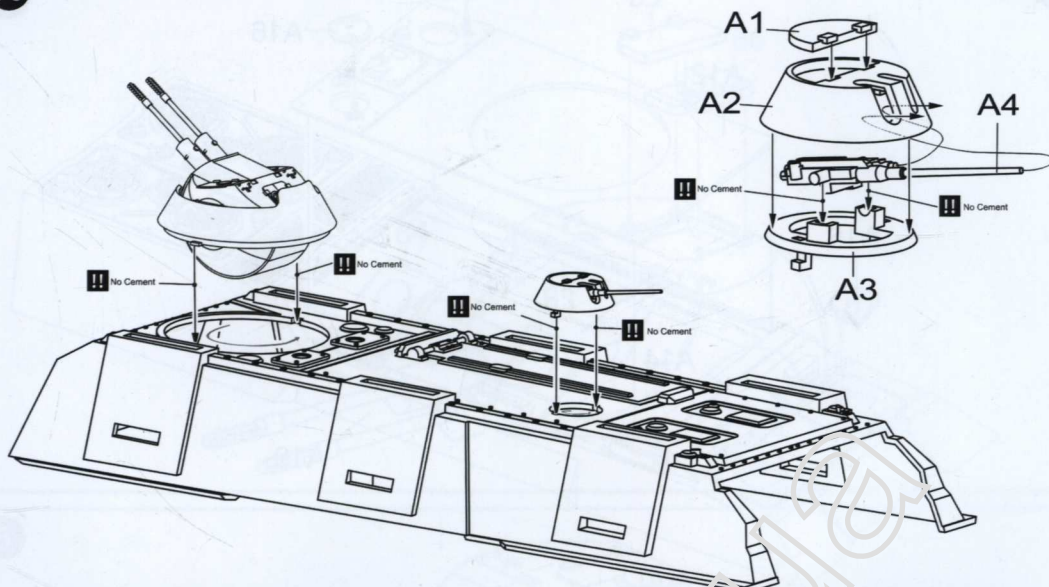

11

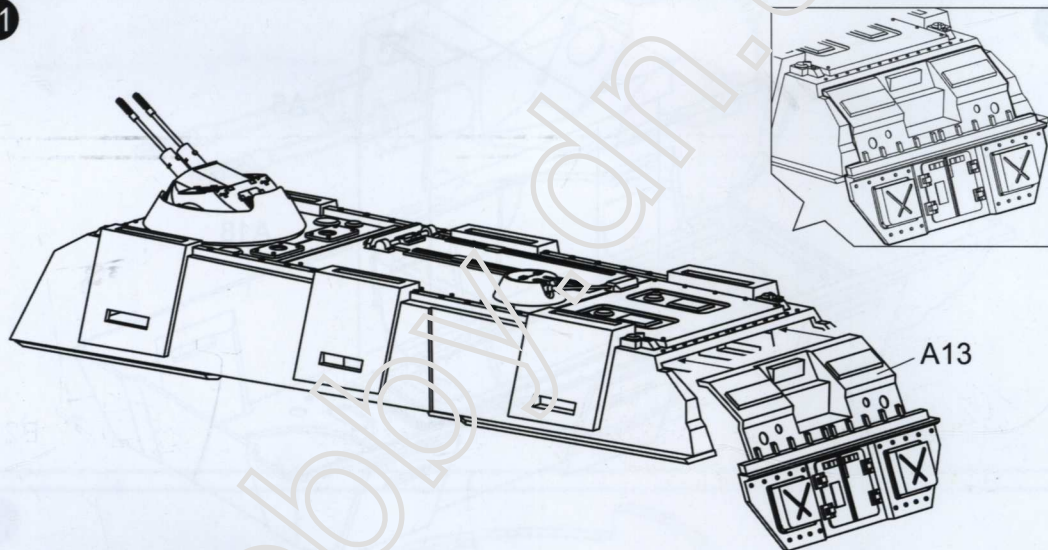

12

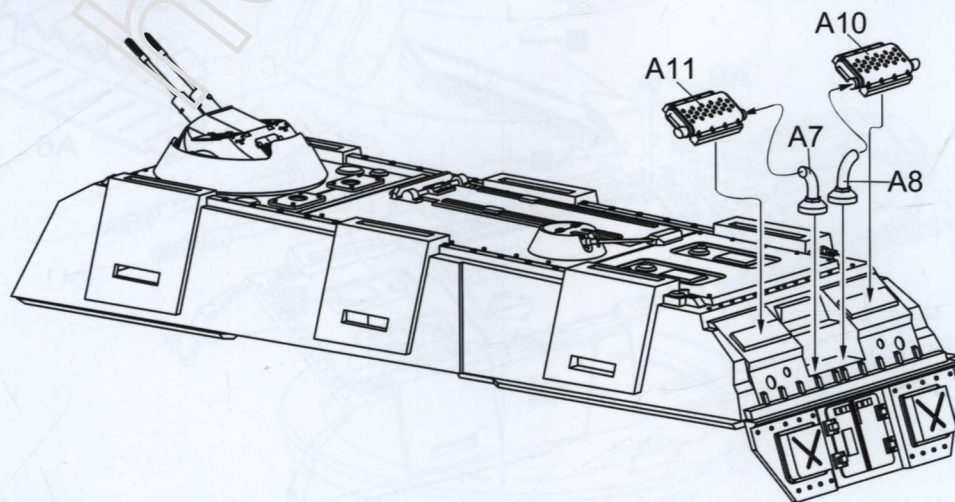

13

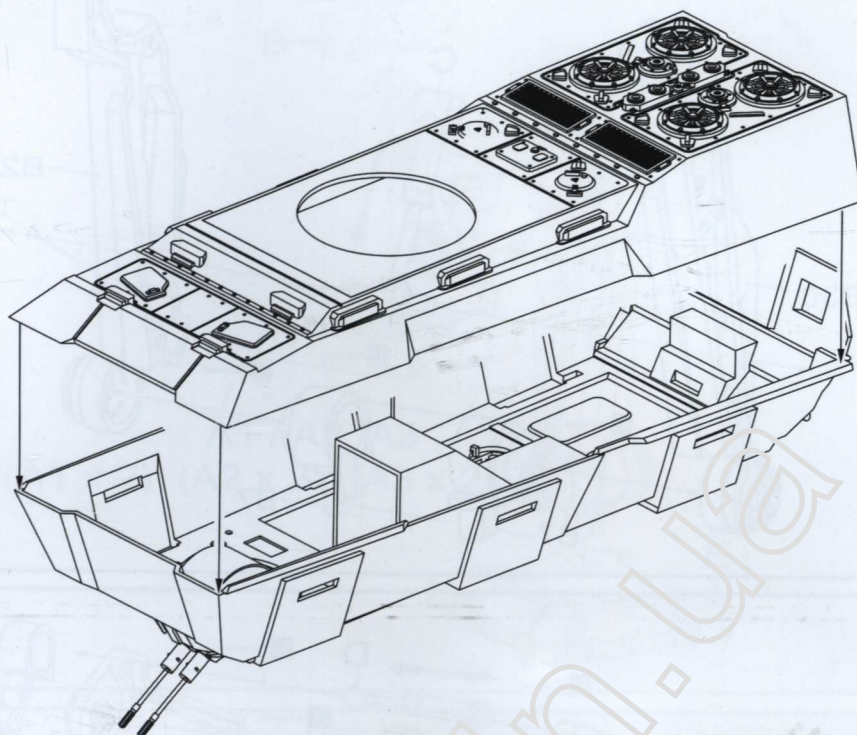

14

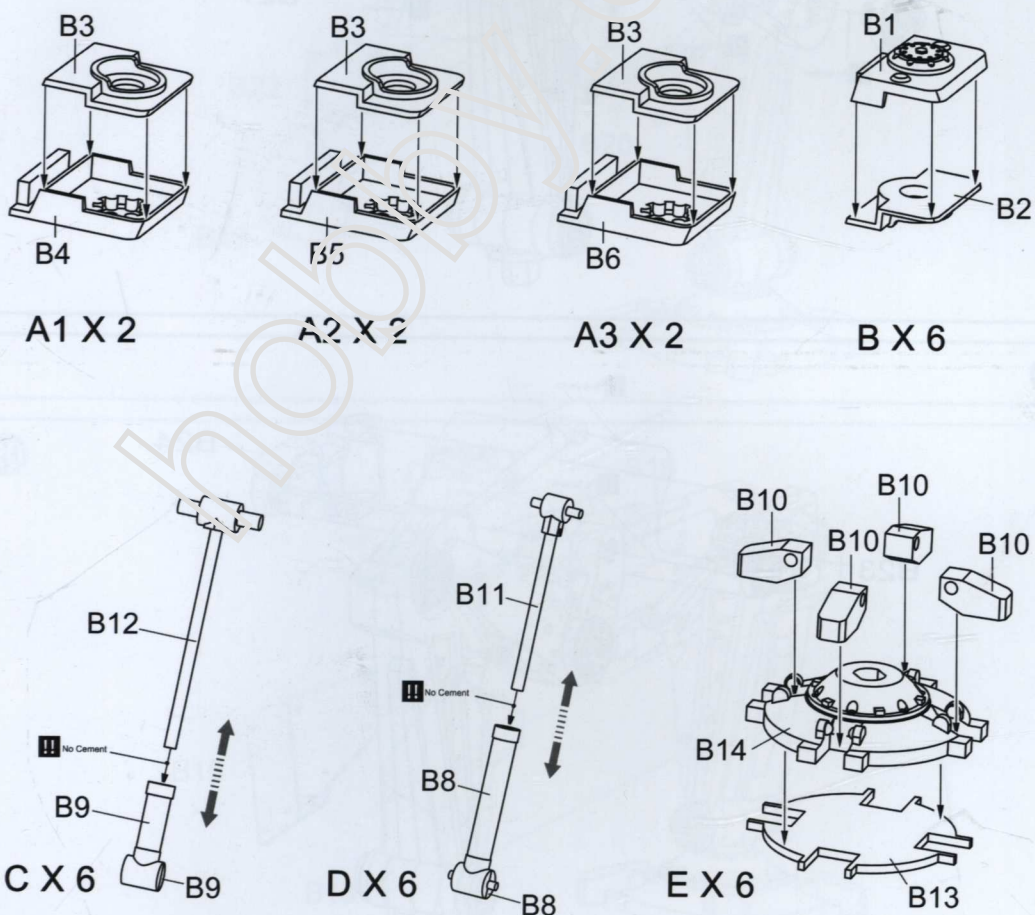

15

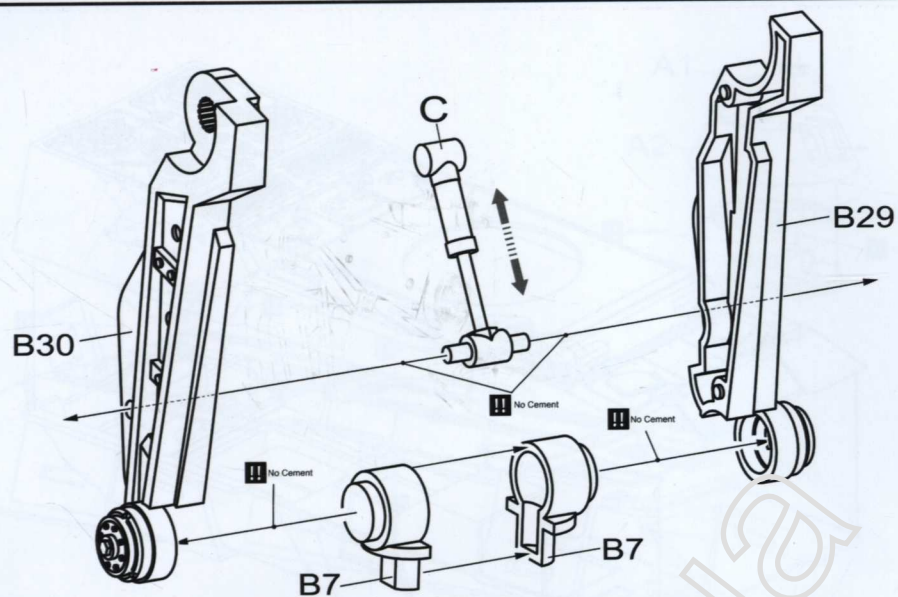

16

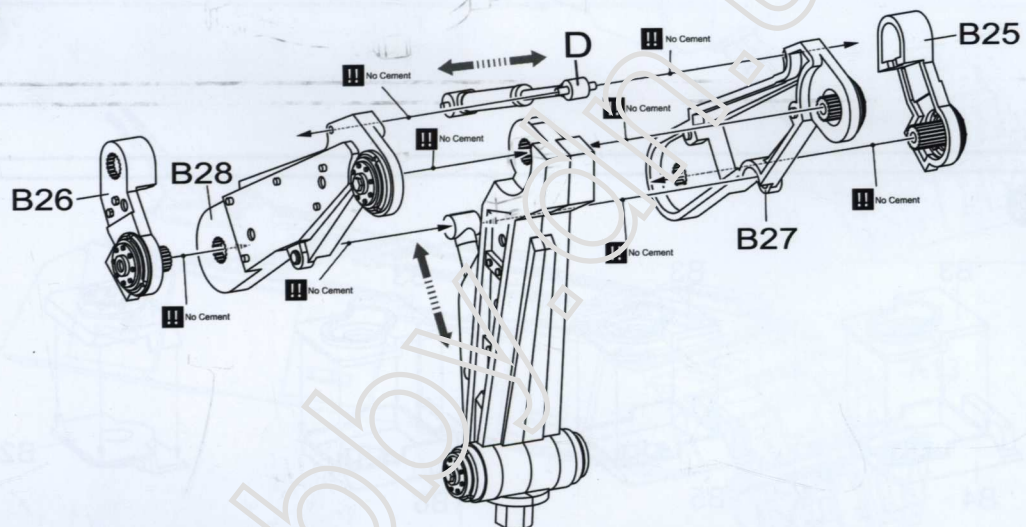

17

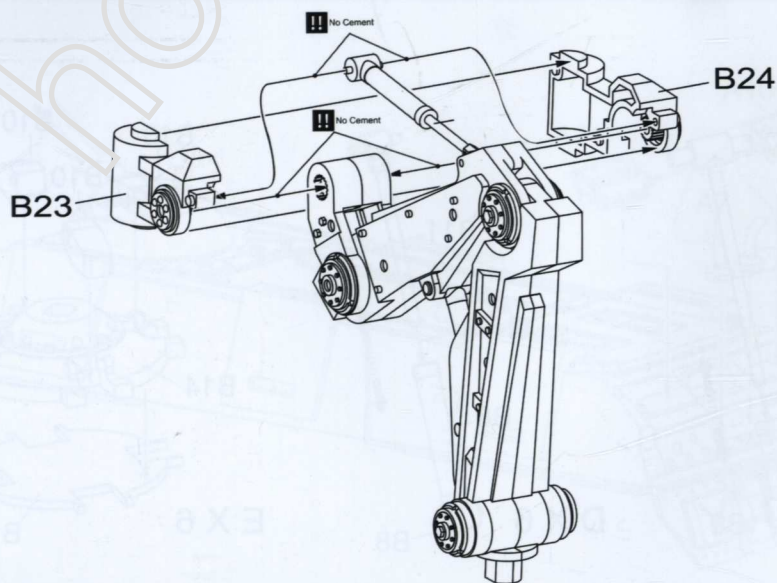

18

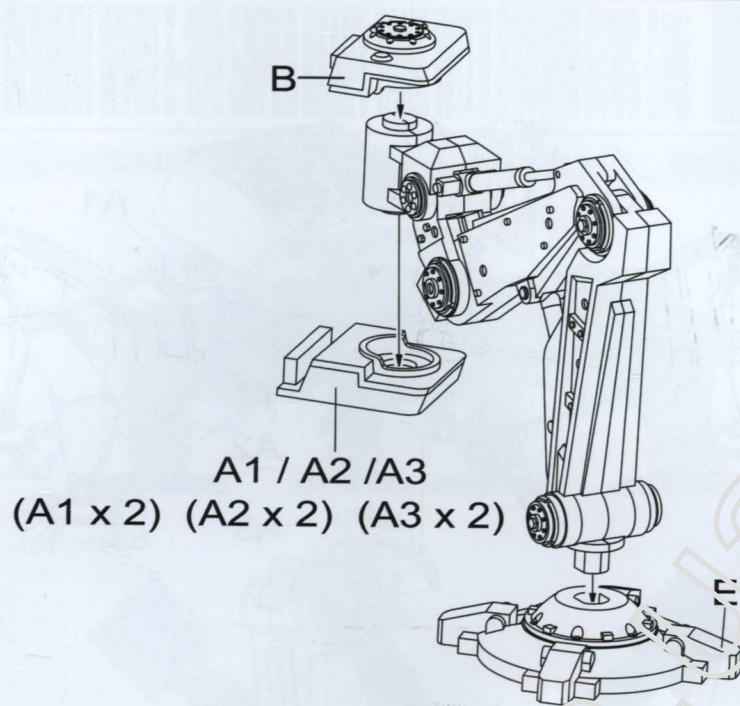

19

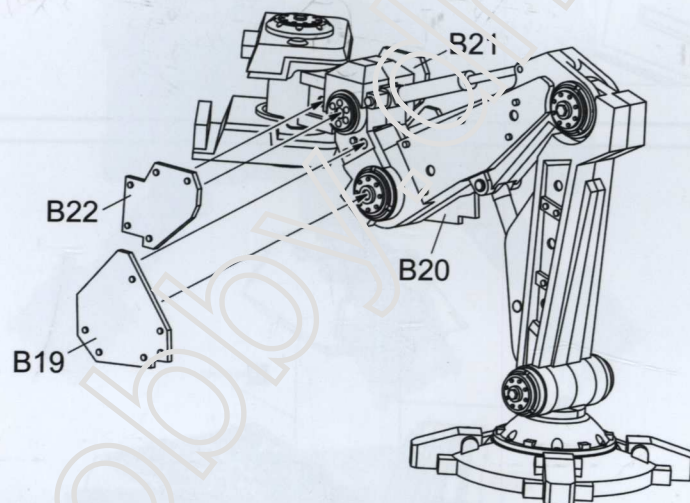

20

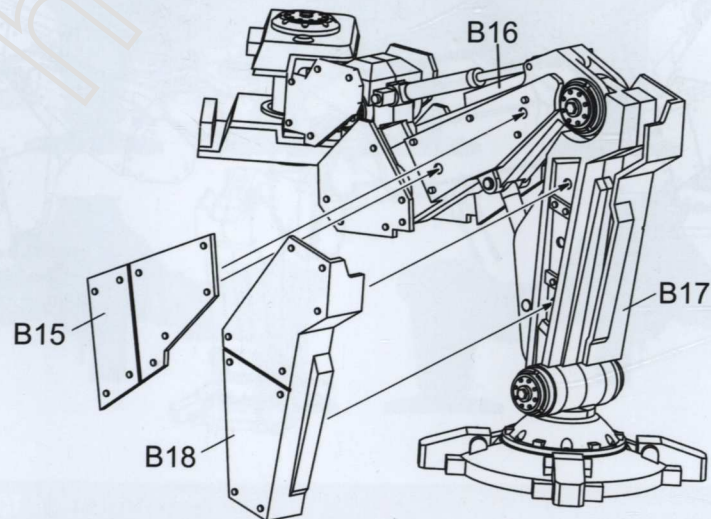

21

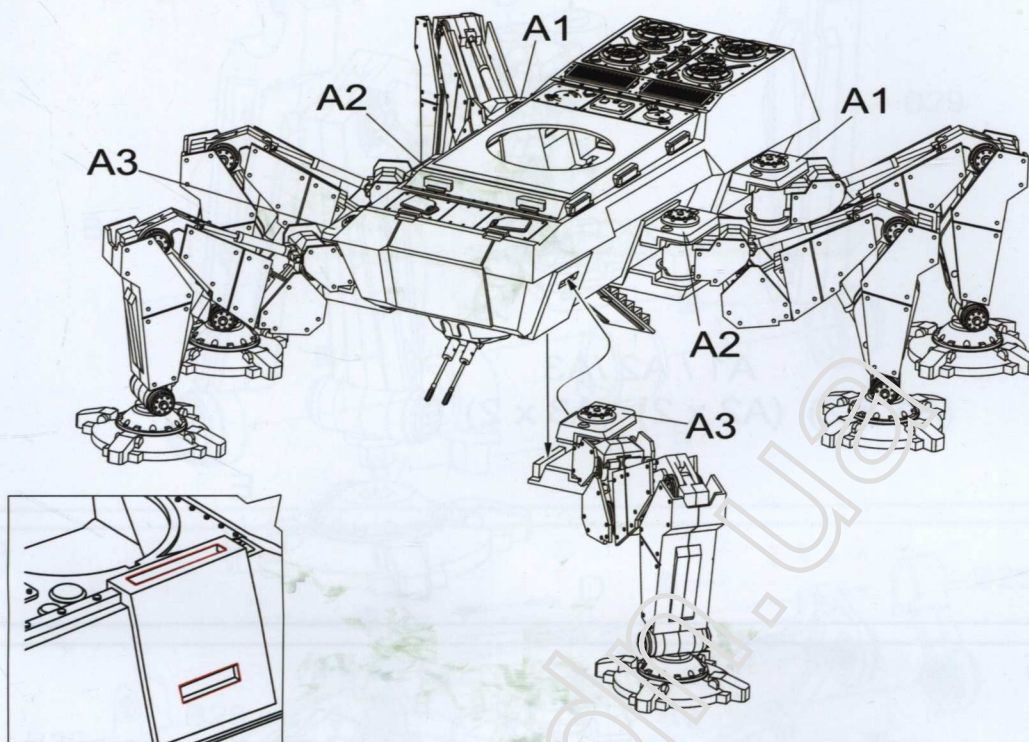

22

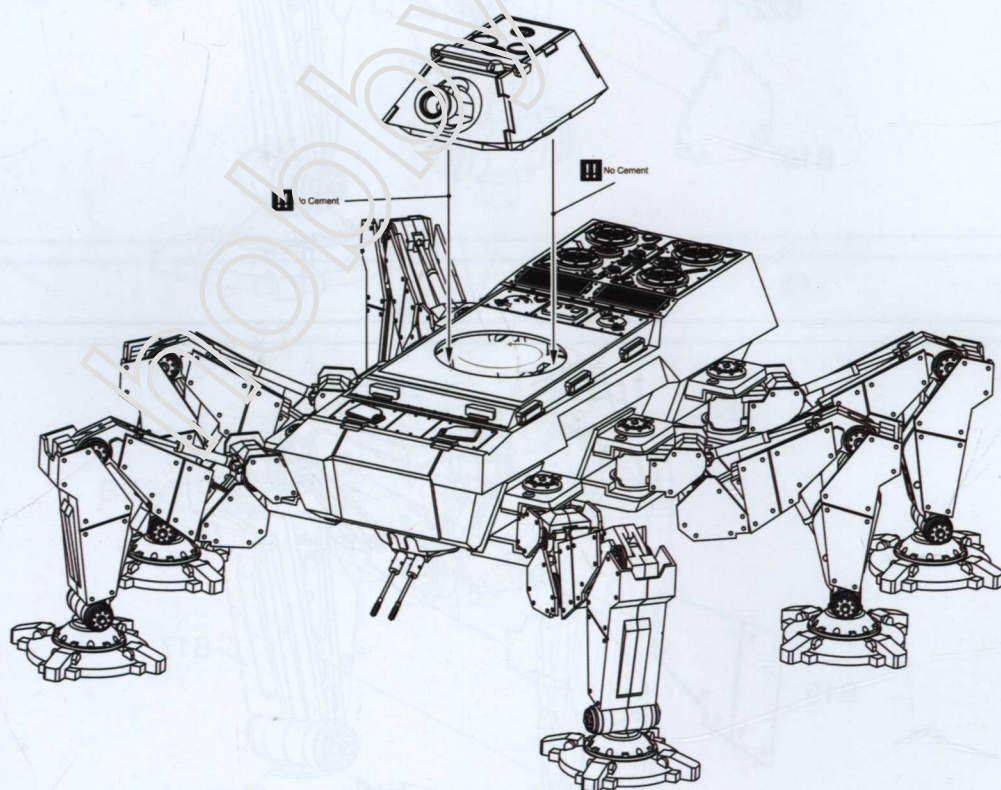

# FIST OF WAR GERMAN WWII E-100 SUPER HEAVY TANK WITH 380MM STUG GUN

modelcollect

A.MIG 011 RAL 7028  
DUNKELGELB AUS '44 DG 1

A.MIG 014 RAL 8012 ROTBRAUN

A.MIG 003 RAL 8011 RESEDAGRÜN

A.MIG 008 Dark grey

A.MIG 045 GUN METAL

A.MIG 063 PALE GREY

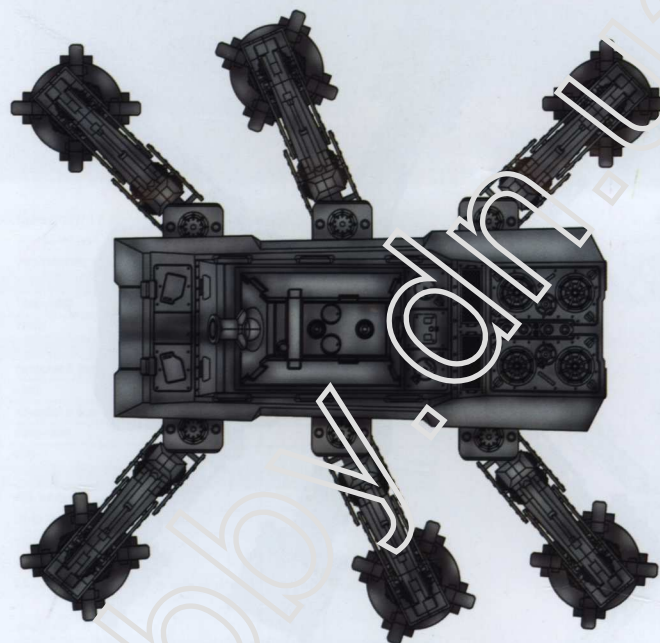
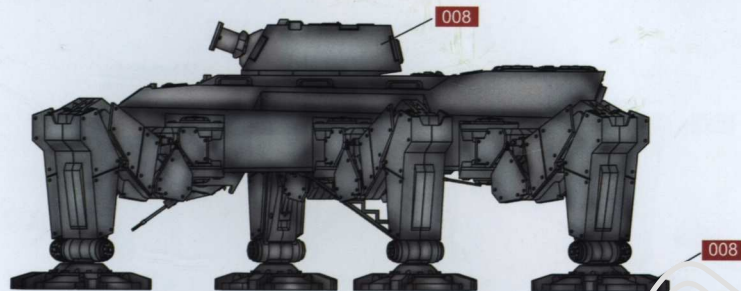

MODELcollect

Color info and profiles by



# FIST OF WAR GERMAN WWII E-100 SUPER HEAVY TANK WITH 380MM STUG GUN

modelcollect

A.MIG 011 RAL 7028 DUNKELGELB AUS '44 DG 1 A.MIG 014 RAL 8012 ROTBRAUN A.MIG 003 RAL 8011 RESEDAGRÜN A.MIG 008 Dark grey A.MIG 045 GUN METAL A.MIG 063 PALE GREY

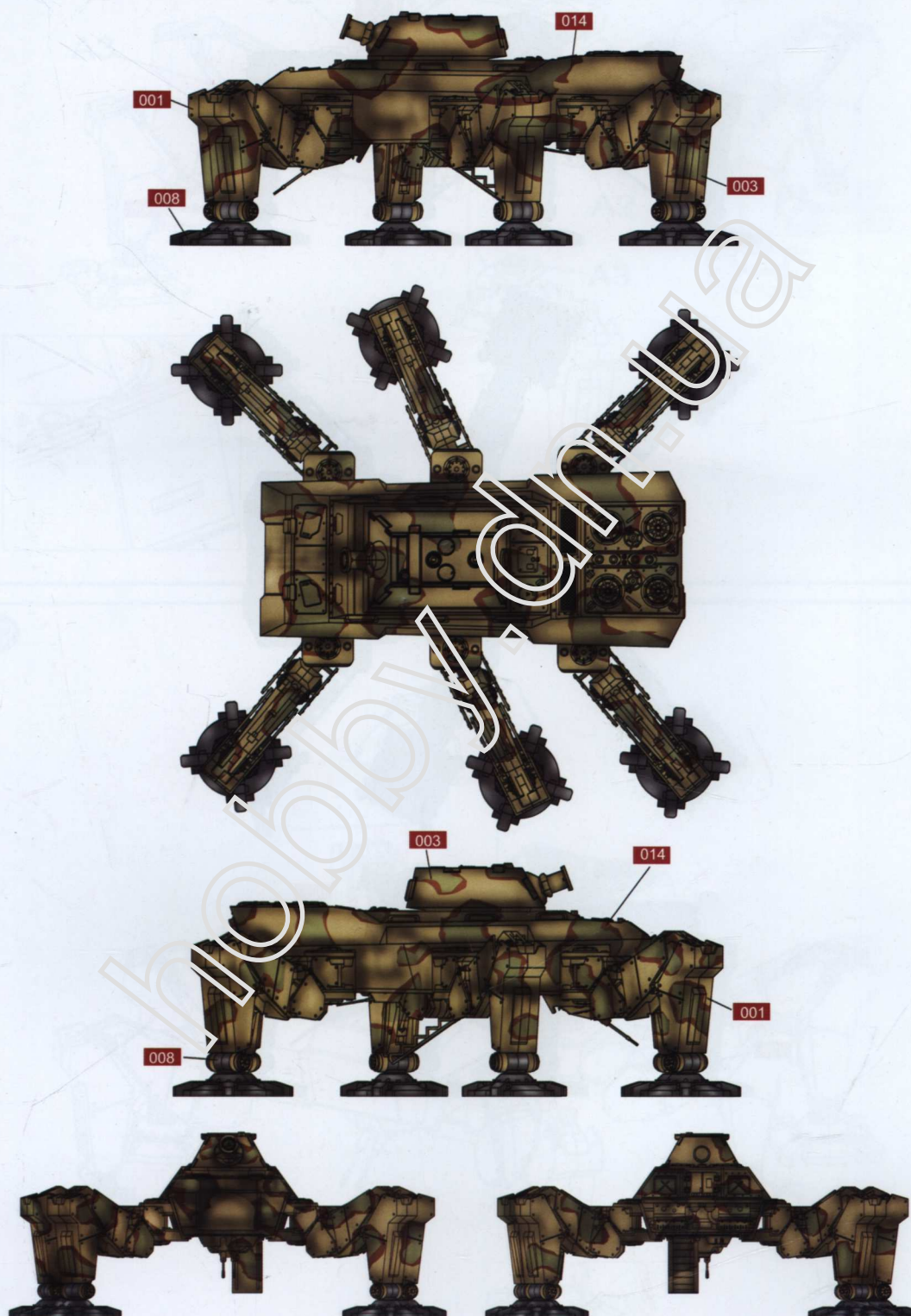

MODELcollect

Color info and profiles by

