

# SOVIET T-72 MAIN BATTLE TANK 1970S-1990S N IN 1

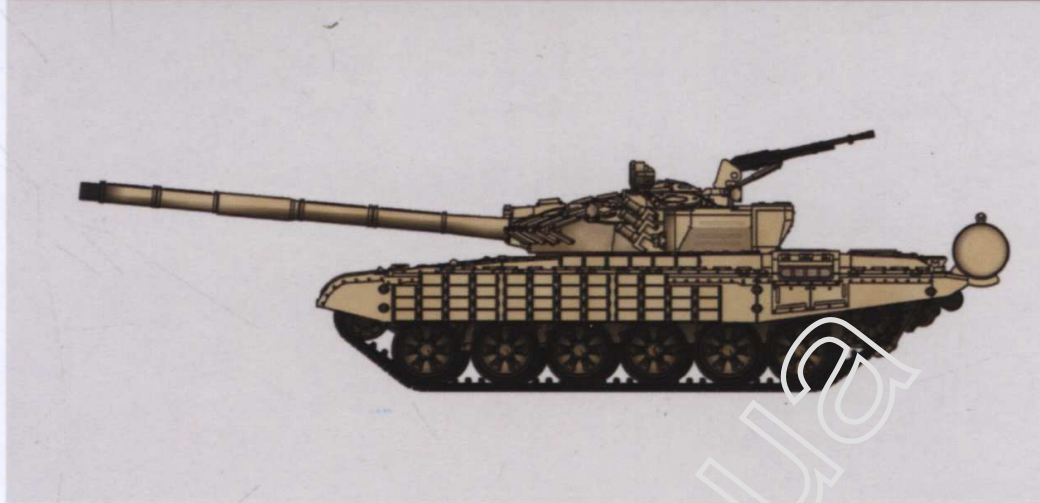

ITEM NO. UA72194

T-72AV is add the Kontakt-1 explosive reactive armour fitted to hull front and turret on T-72A. T-72A is an improved version of the basic T-72 "Ural". Overall, its offensive capabilities are similar to the basic T-72 "Ural", but it is much better protected. The differences between T-72 "Ural" and T-72A include the searchlight being placed on the right hand side of turret, the TPD-2-49 coincidence optical rangefinder being replaced by the TPD-K1 laser rangefinder, added plastic armour track skirts covering the upper part of the suspension with separate panels protecting the sides of the fuel and storage panniers instead of the flipper type armor panels used in T-72 "Ural", the turret front and top being heavily reinforced with composite armor better known by its US codename - "Dolly Parton", provisions for mounting reactive armor, an electronic fire control system, MP smoke grenade launchers, flipper armor mount and front mudguards, internal changes, and a slight weight increase.

### Specifications

Weight	41.5 tonnes (45.7 short tons)
Length	9.53 m (31 ft 3 in) gun forward
Width	6.95 m (22 ft 10 in) hull
Height	3.59 m (11 ft 9 in)
Crew	2.23 m (7 ft 4 in)
	3
<b>Armour steel and composite armour</b>	
Main armament	125 mm 2A46M/2A46M-5(3) smoothbore gun
Secondary armament	7.62 mm PKT coax machine gun 12.7 mm NSVT anti-aircraft machine gun
Engine	V-12 diesel 780 hp (582 kw)
Power/weight	18.8 hp/t
Transmission	Synchromesh hydraulically assisted, with 7 forward and 1 reverse gears.
Suspension	Torsion bar
Ground clearance	0.49 m (19 in)
Fuel capacity	1,200 L (320 U.S. gal; 260 imp gal)
Operational range	460 km (290 m), 700 km (430 m) with fuel drums
Speed	60 km/h (37 mph)

#### ● READ BEFORE ASSEMBLY

1. When you use glue or paint, do not use them in a well-ventilated room.
2. Take extra care in handling parts that are sharp to avoid injury.
3. When you take parts off the runner frame, use modeling scissors and trim excess plastic with a cutter or file.
4. Glue and paint are not included.
5. This product is only suitable for experienced more than 14 years old.

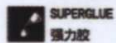

SUPERGLUE  
强力胶



WEIGHT  
配重

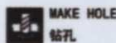

MAKE HOLE  
钻孔

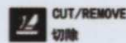

CUT/REMOVE  
切掉



BEND  
弯曲



FILE/SAND  
锉平



OPTION  
选择

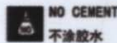

NO CEMENT  
不涂胶水



DECAL  
贴纸

#### DECAL APPLICATION

1. Cut off decal from sheet.
2. Dip the decal in tepid water 40° C for about 10 sec. and place on a clean cloth.
3. Hold the backing sheet edge and slide decal onto the model.
4. Move decal into position by wetting decal with finger.
5. Press decal gently down with a soft cloth until excess water and air bubbles are gone.

#### 水贴纸的使用:

1. 从水贴纸上剪下印花。
2. 将印花放入温水中浸10秒，然后放在干净布上。
3. 拿着印花纸底将印花移到模型上。
4. 手指蘸水将印花移到适当的位置。
5. 用软布轻压印花直至不干，气泡消失。

Parts

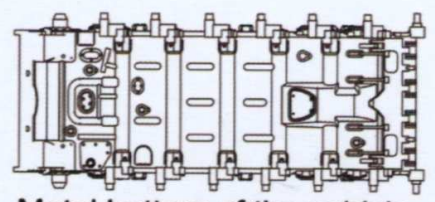
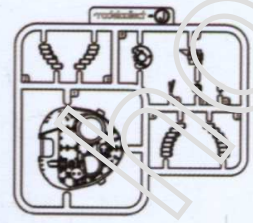
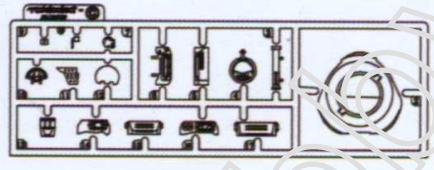
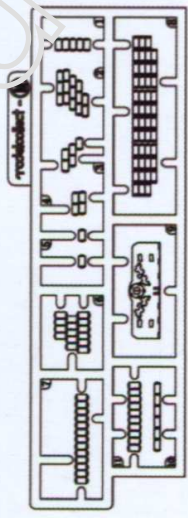
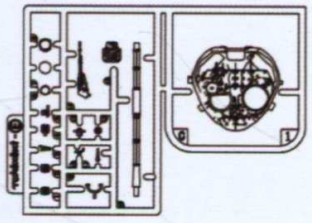
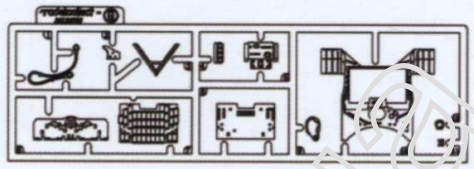
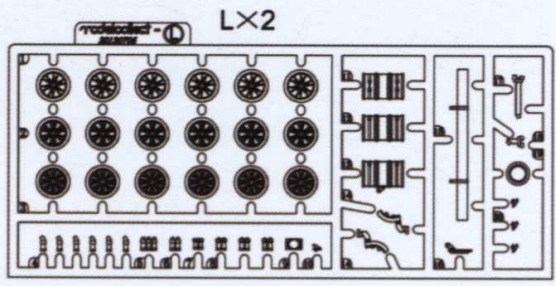
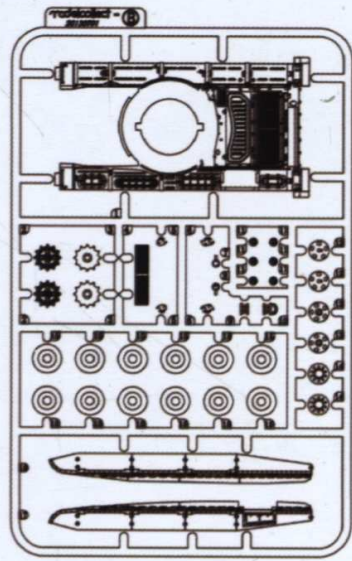

Metal bottom of the vehicle

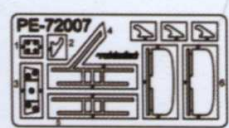

PE-72007

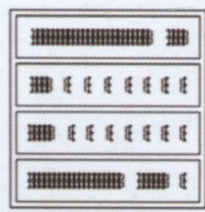

Track X 2

**1** T-72A / T-72AV / T-72B / T-72B1 / T-72BV

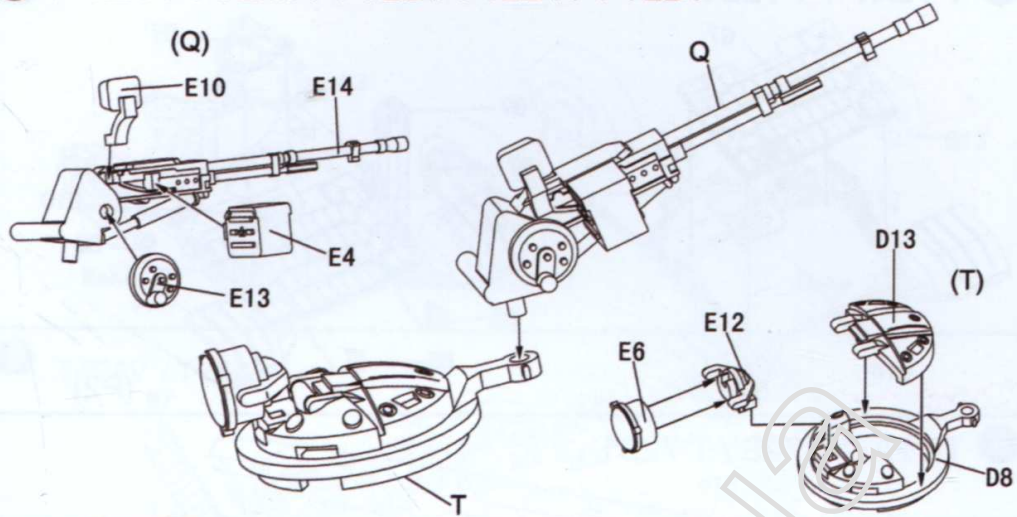

**2** T-72A / T-72B / T-72B1 / T-72BV

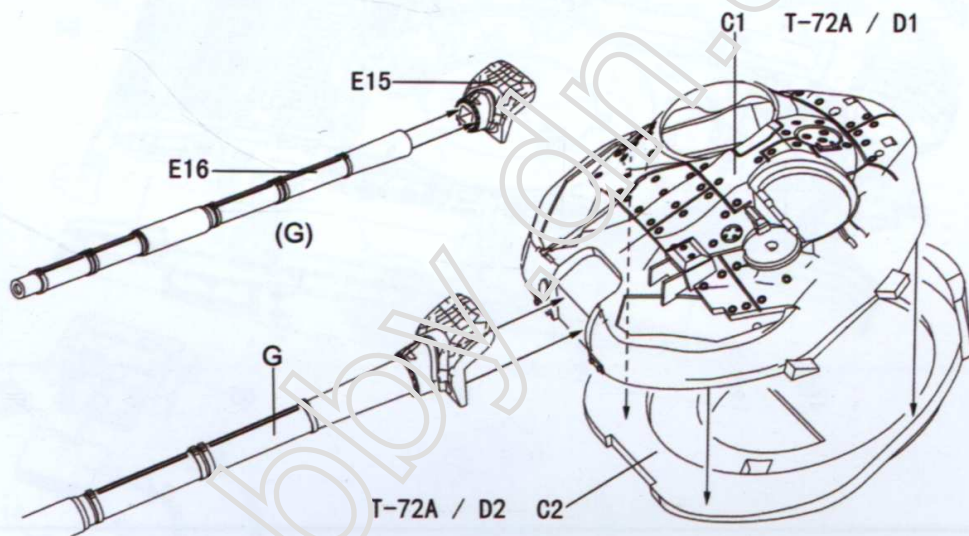

**3** T-72A / T-72B / T-72B1

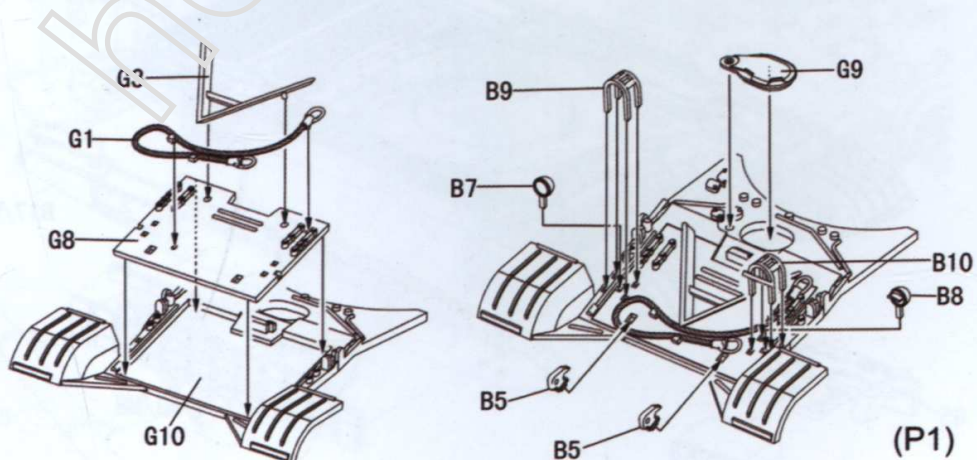

4 T-72AV / T-72BV

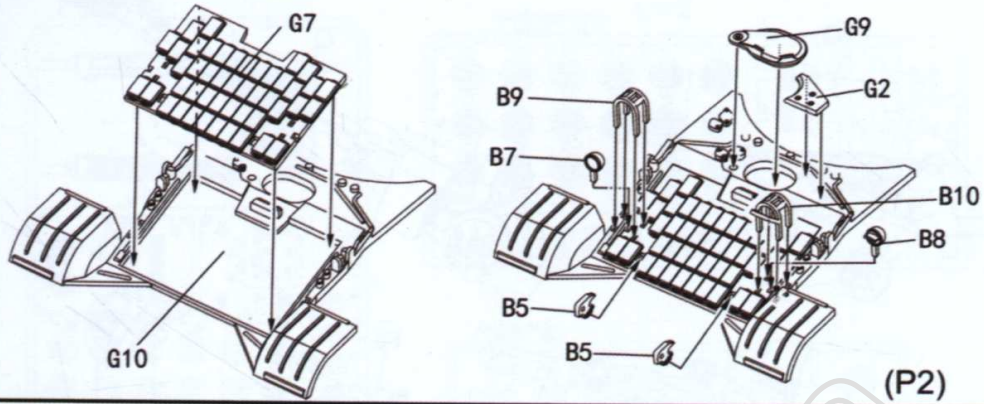

5 T-72A / T-72B / T-72B1

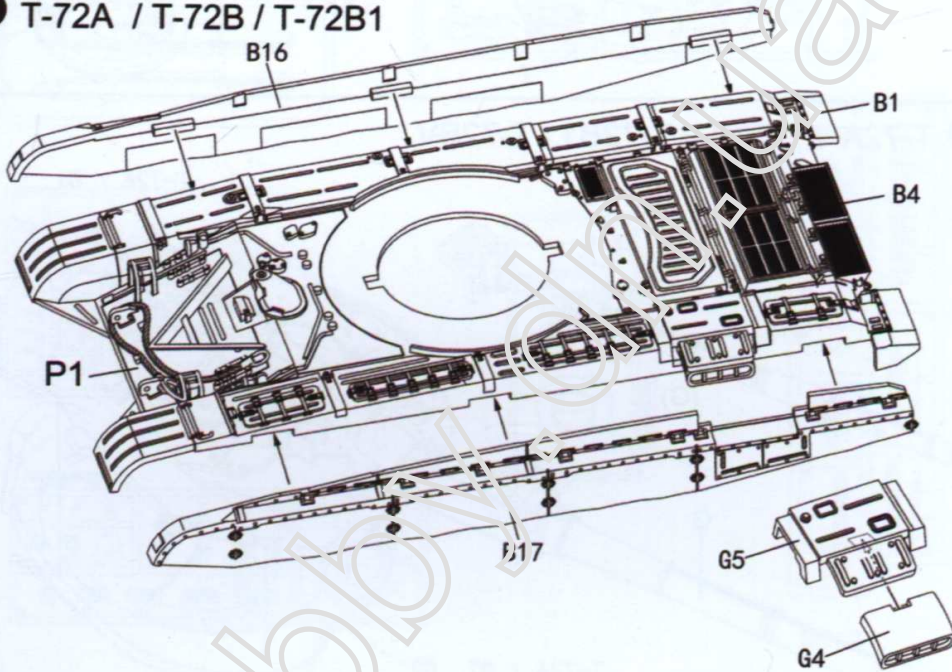

6 T-72AV / T-72BV

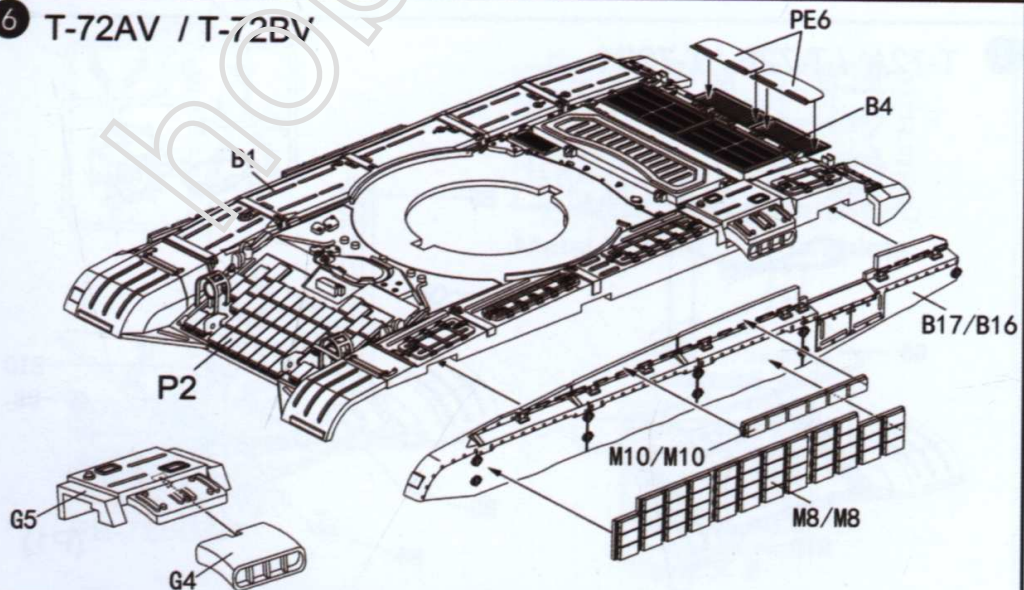

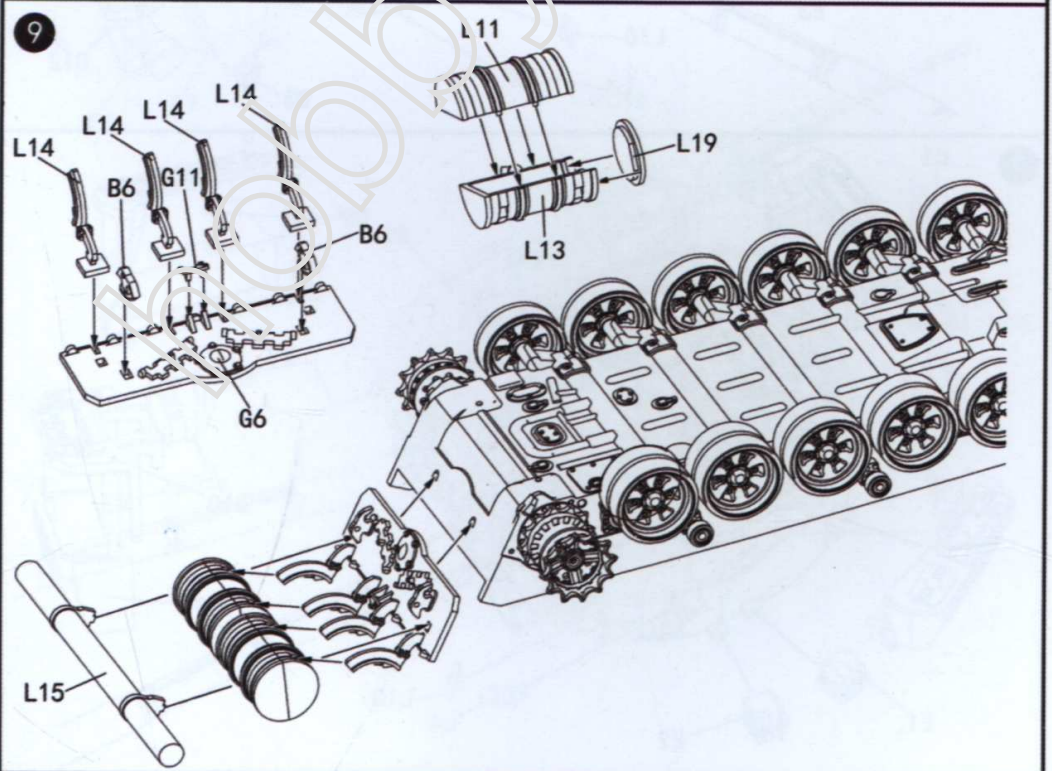
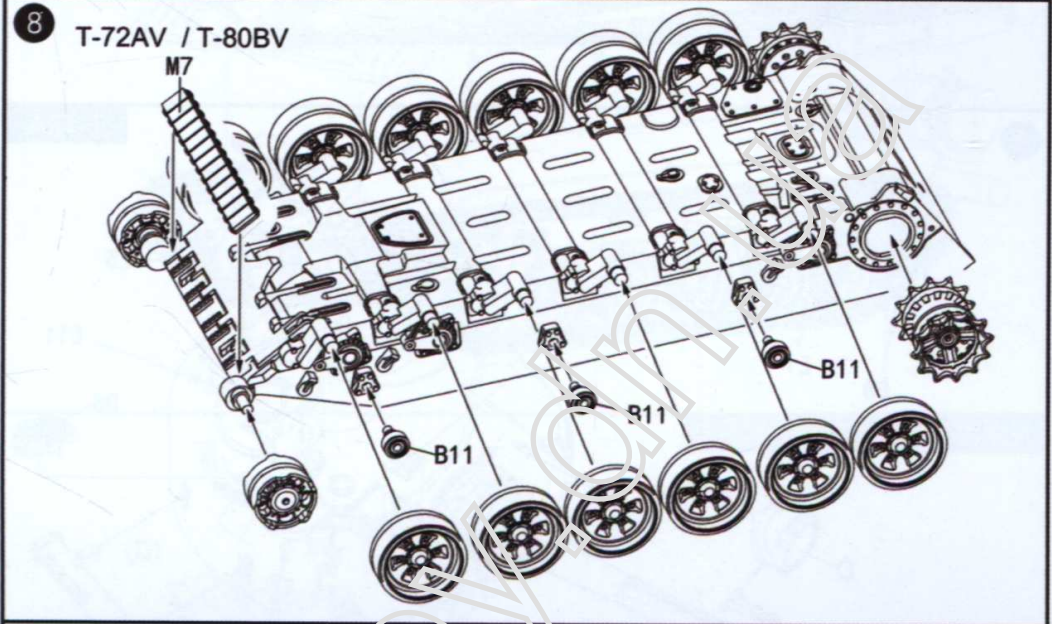
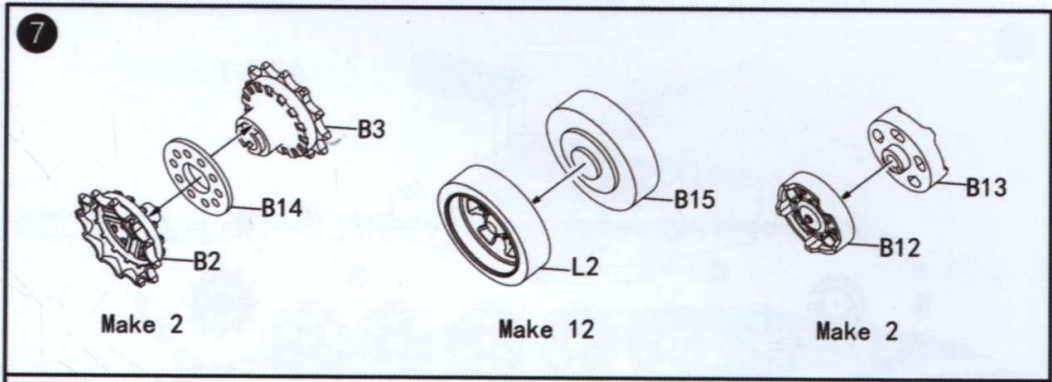

10

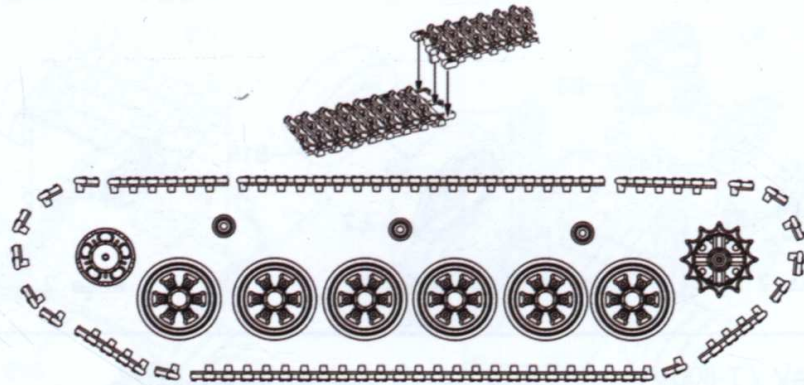

1

T-72A

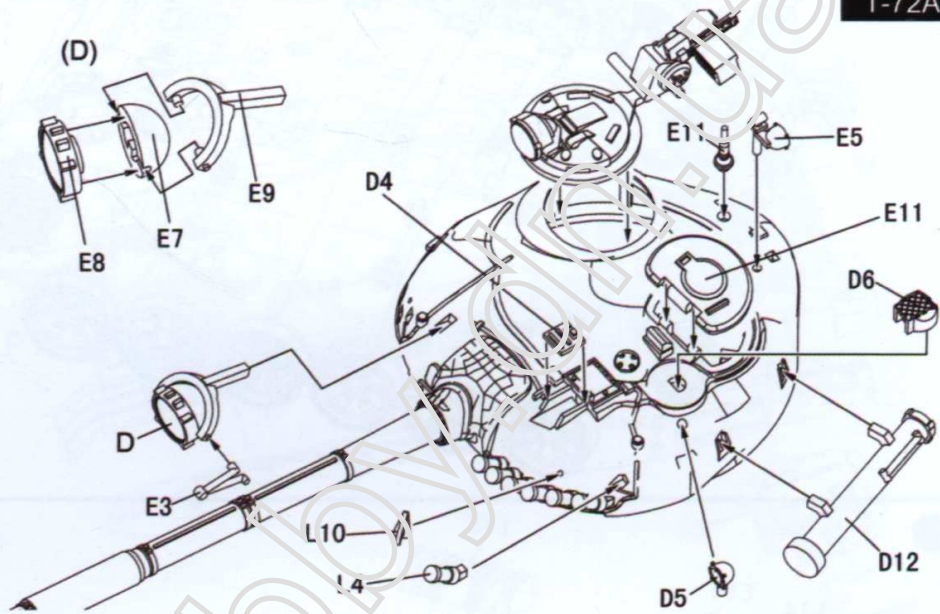

2

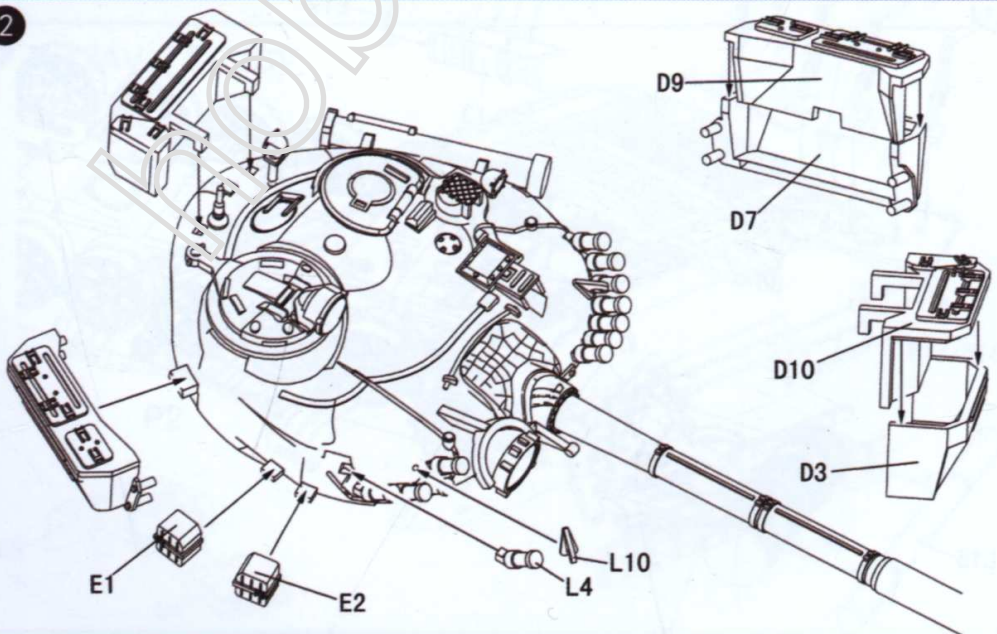

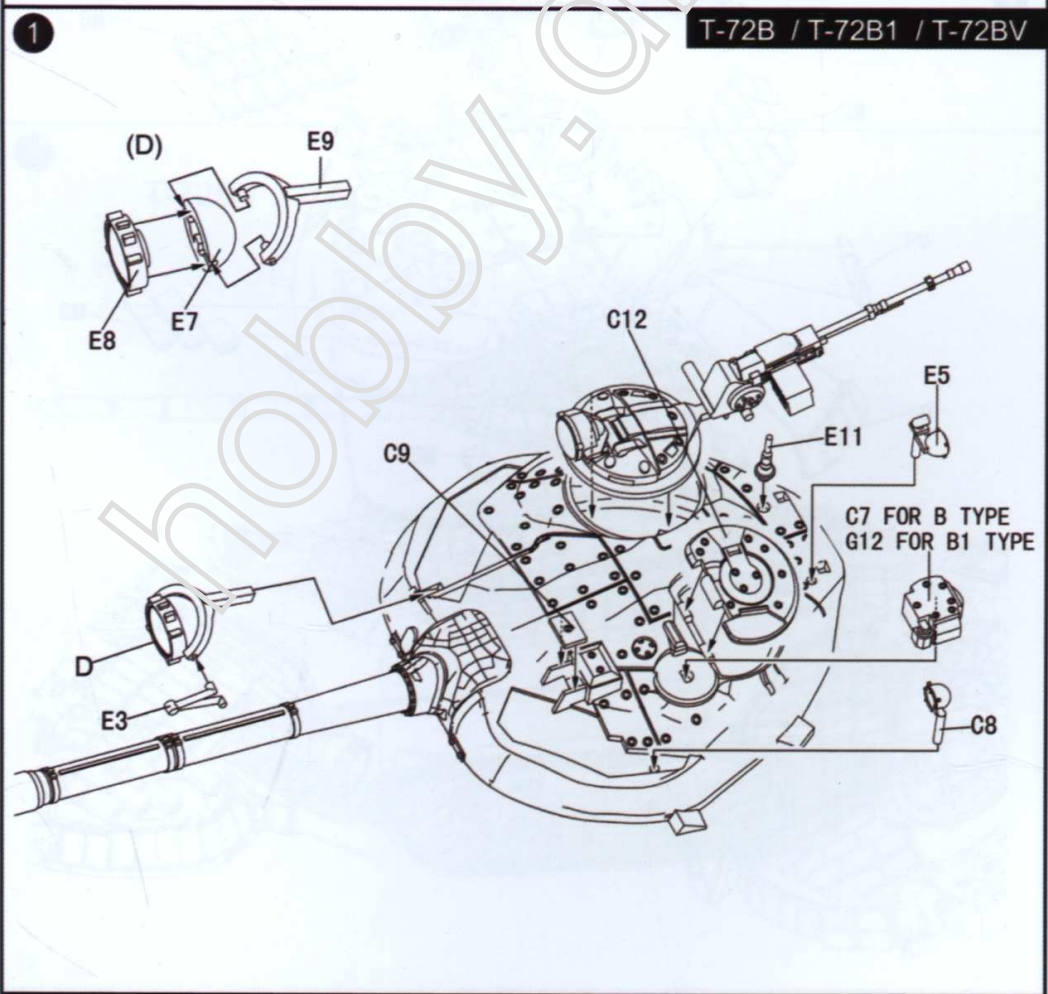
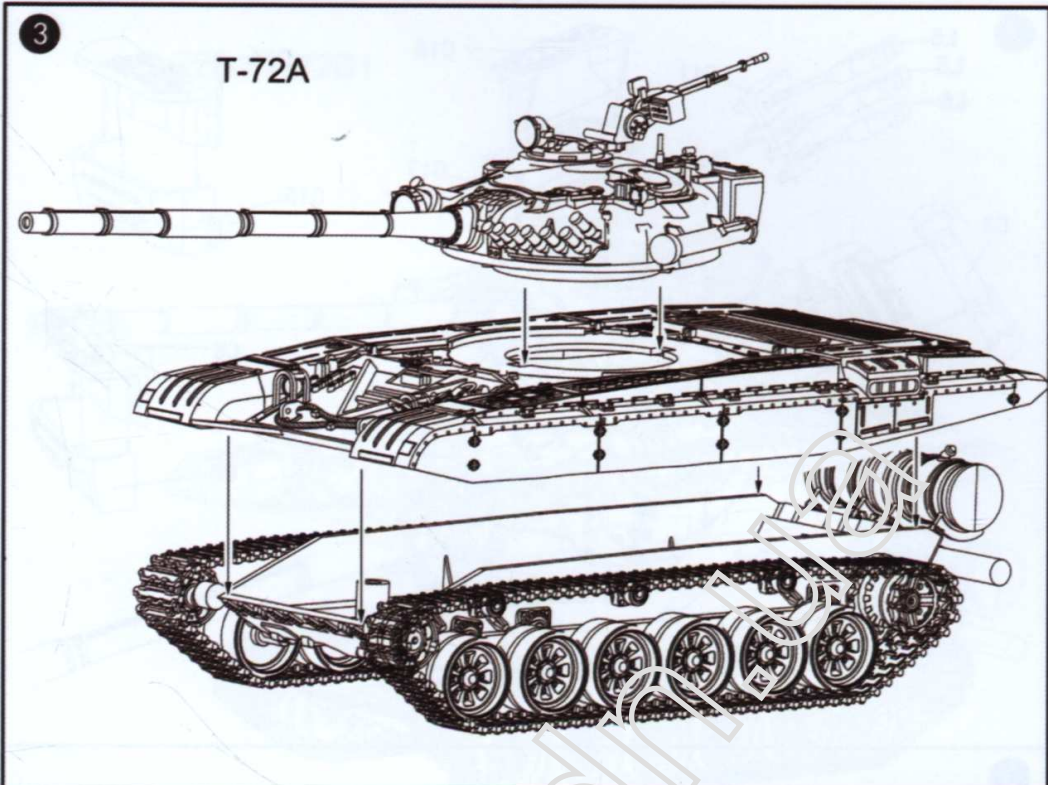

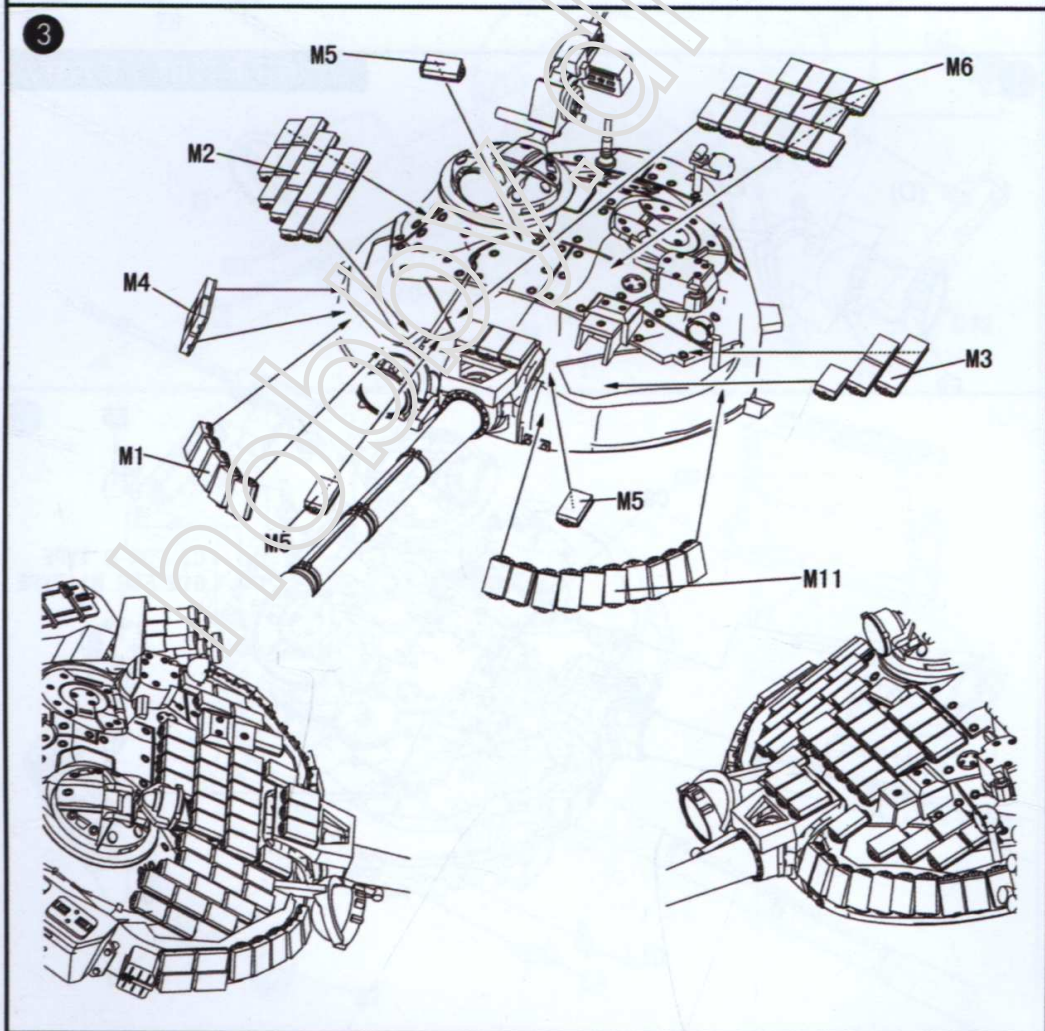
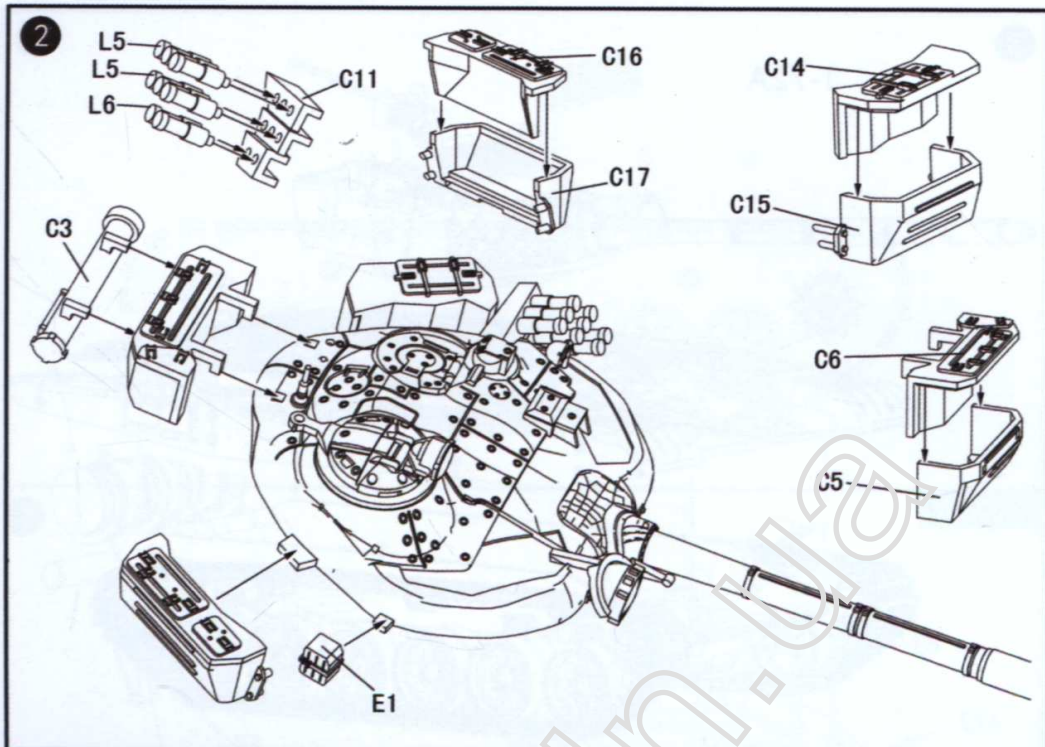



4

T-72B / T-72B1

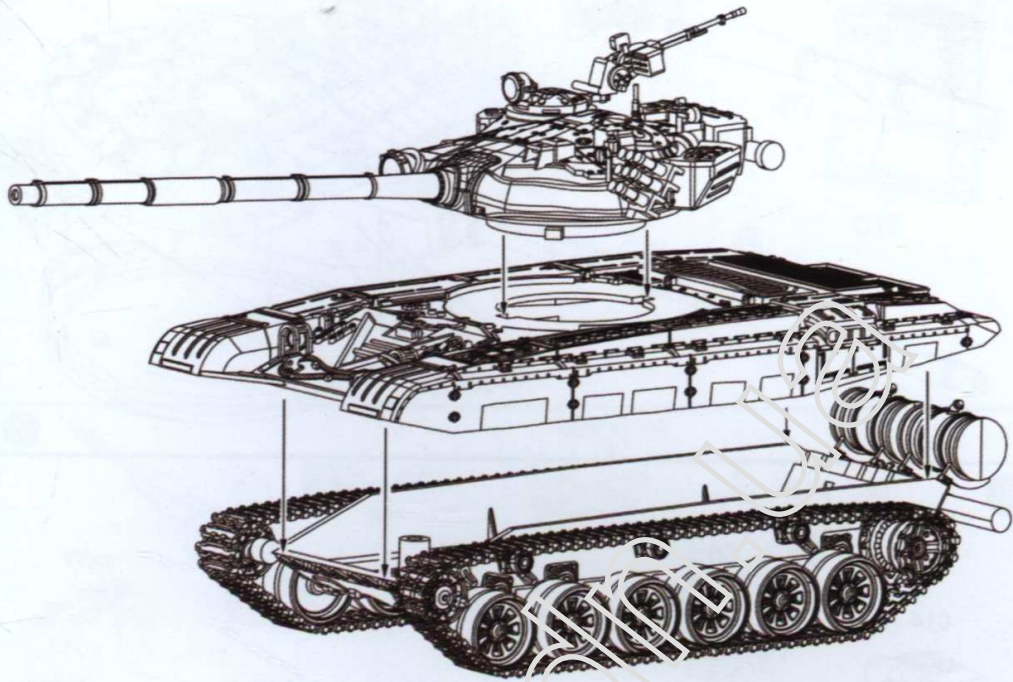

5

T-72BV

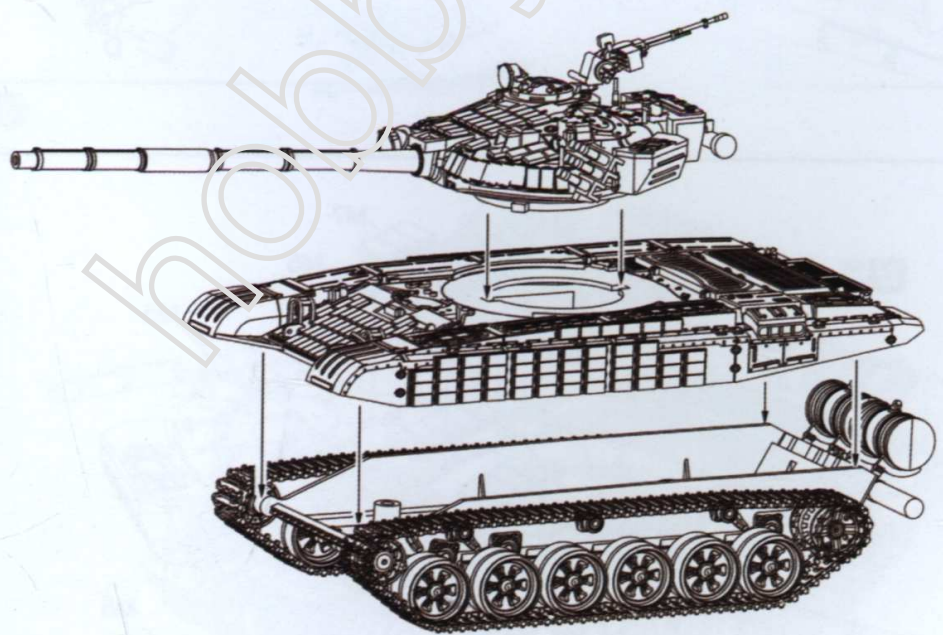

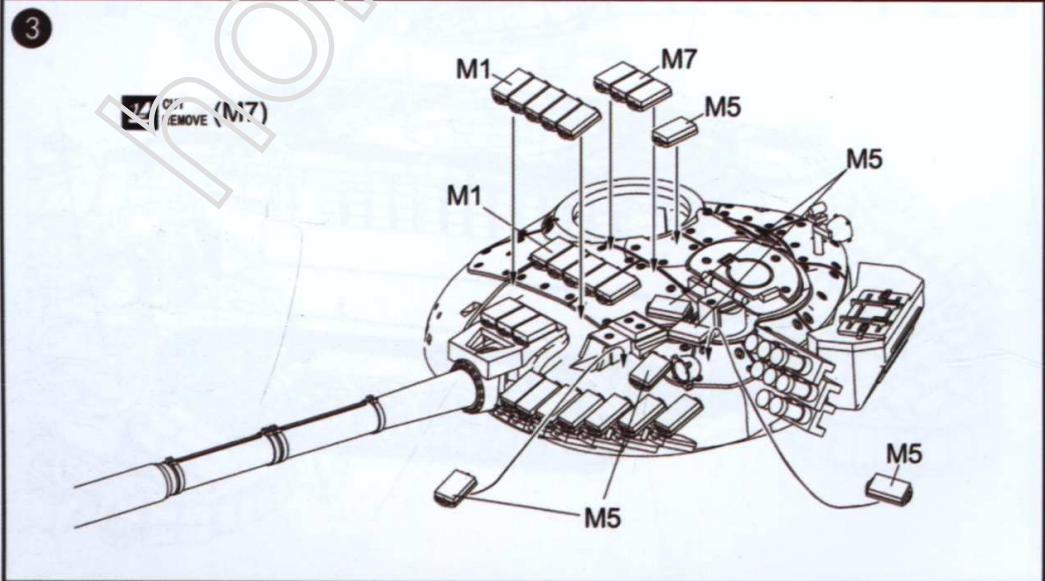
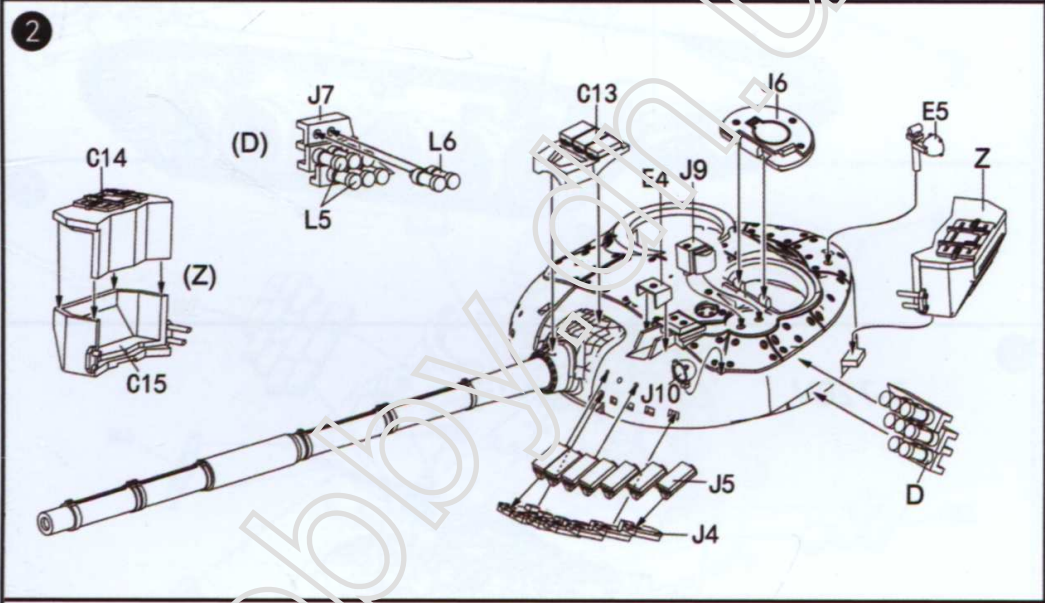
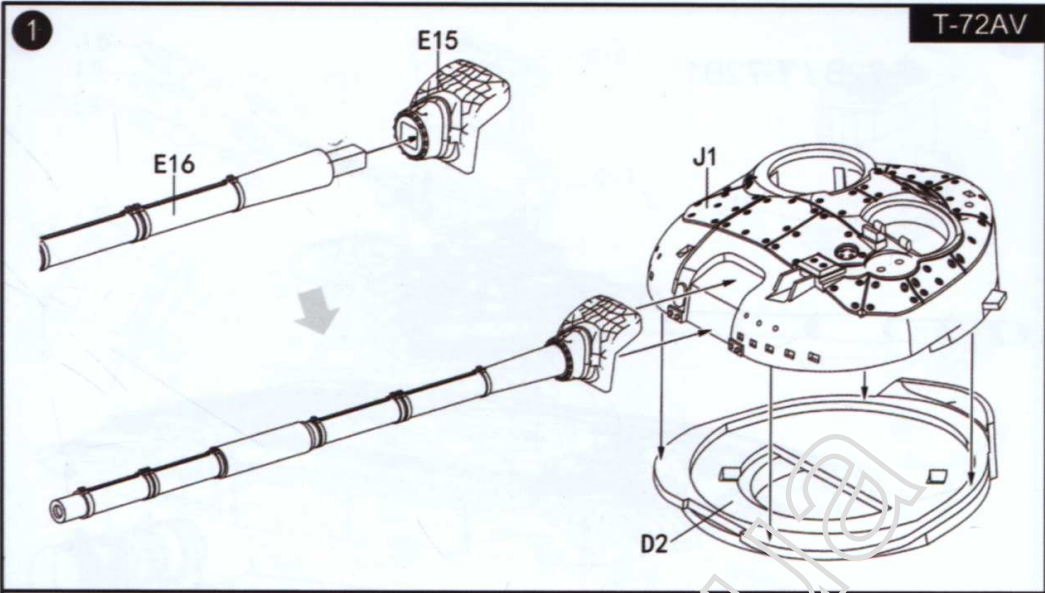

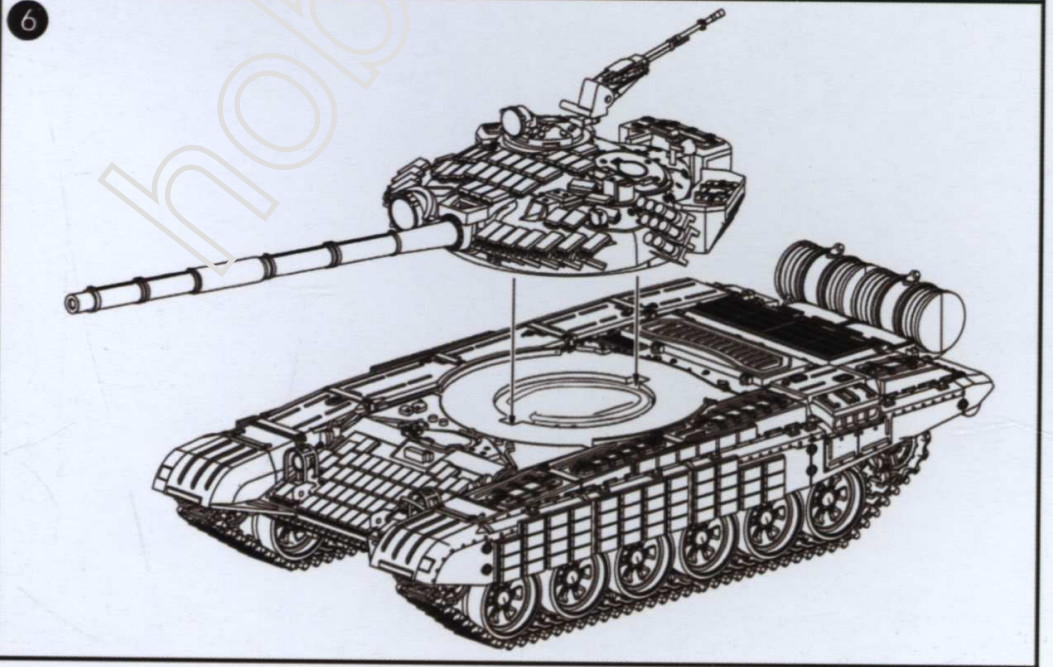
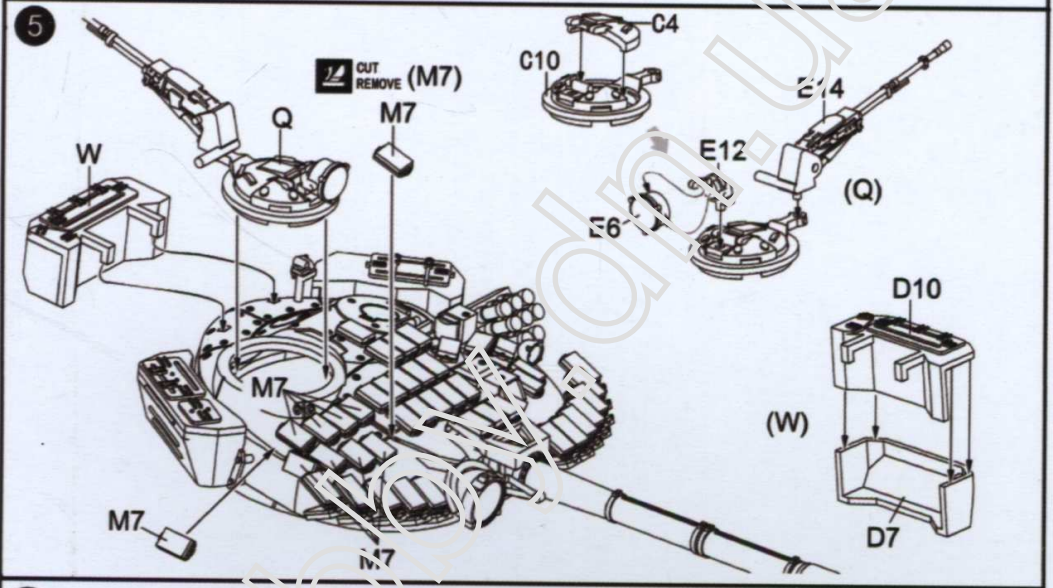
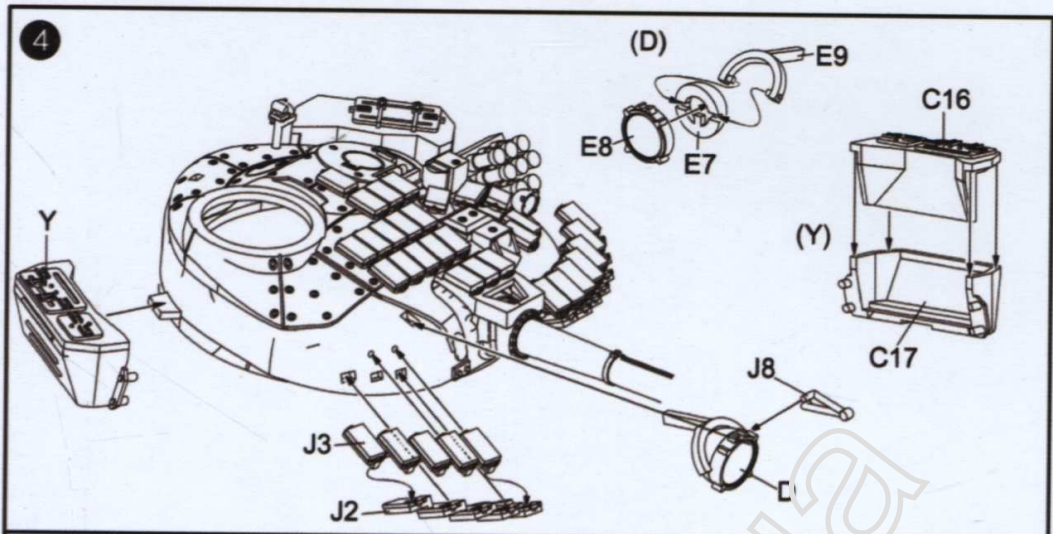

# SOVIET T-72 MAIN BATTLE TANK 1970S-1990S N IN 1

modelcollect

A.MIG 011 RAL 7025 DUNKELGELB/AUS 44 DG 1	A.MIG 014 RAL 8012 ROT/BRÄUN	A.MIG 003 RAL 8011 REISEDAGRAU	A.MIG 033 Rubber & Tyre	A.MIG 045 GUN METAL	A.MIG 095 CRYSTAL SMOKE
A.MIG 037 NEW WOOD	A.MIG 192 POLISHED METAL				

T-72A



T-72B / T-72B1



T-72AV



T-72BV



MODELCOLLECT

Color info and profiles by

