

Tu-2S
SOVIET MEDIUM BOMBER

中型爆擊機



Model kit
SCALE 1/48 No B48002

Fuselage Length: 287.5mm Wing Span: 392.9mm Total Plastic Parts: 357pcs

1. 拼装之前须仔细阅读说明书。
2. 拼装之前须检查部件是否吻合。
3. 请用小刀或模型剪从注塑件中剪去多余的胶片，请小心，勿剪断塑件零件。
4. 切勿从塑胶片中拉断零件。
5. 说明书含有重要资料，请保存好此说明书。
1. Read instructions carefully.
2. Check the completeness of each part.
3. Remove parts from frame with sharp knife and trim away excess plastic. Be careful not to break necessary parts.
4. Do not pull parts with your hands from frame.
5. Keep this booklet for future reference.

Tu-2S轰炸机

Tu-2S轰炸机，是Tu-2系列中最为成功的机型。1943年在库尔斯克战役中，出于战争的需要，苏联政府决定恢复生产Tu-2。同年图波列夫（Tupolev）返回莫斯科，带领图波列夫（Tupolev）设计局做Tu-2新机型设计修改和生产前部署，把这一机型定为Tu-2S。Tu-2S的性能在许多方面有很大提高，该机选用更大功率发动机ASH-82FN，自卫武器换装了12.7mm口径的УБТ机枪，最大载弹量增加到3000kg。Tu-2S二战结束后还在继续生产使用，在被IL-28喷气轰炸机取代前共生产了2547架。

Tu-2S轰炸机参加了苏德战争中后期的主要战役，其中包括柏林战役。战后苏联用Tu-2S支援其他国家，装备过Tu-2S国家有苏联、波兰、保加利亚、匈牙利、罗马尼亚、中国、朝鲜、印度尼西亚等。

During the battle of Kursk in 1943, the Soviet Air Force ordered additional Tu-2 from Tupolev to be used in bombing the German forces. Chief Designer Andrei Tupolev and his team made significant improvements to the design of Tu-2. The improved plane was named Tu-2S; the new version came with stronger ASH-82FN engines installed and it was equipped with 12.7mm machine guns. Moreover, the bomb load was increased from 2,000 kg to 3,000 kg.

Tu-2S played an outstanding role at the Eastern Front and became the most successful model of the Tu-2 series. After WWII, the Tu-2S bomber also served in various Air Forces such as Russia, China, North Korea, Bulgaria, Hungary, Romania, Poland and Indonesia. A total number of 2,547 Tu-2S were produced before it was retired. Tu-2S were replaced by the Ilyushin Il-28 jet bomber.

技术数据:

乘员组 (Crew): 4人 生产时间 (Year of manufacture): 1943年 长度 (Length): 13.8m 翼展 (Wingspan): 18.86m 翼面积 (Wingspan): 48.80m² 机高 (Height): 4.55m 起飞重量 (Loaded weight): (1)正常 (Normal): 10360kg (2)最大 (Max): 11575kg 发动机型号及数量 (Engines): 2×AL-82FN 功率 (马力) (Horse power): 2×1850HP 最大速度 (Max speed): 547 km/h (飞行高度: 3200m) 实用升限 (Service ceiling): 9000m 航程 (Mileage): 22100km 载弹量 (Bomb loading): (1)正常 (Normal) 2000kg (2)最大 (Max) 3000kg 防御武器 (Weapons): (1) 机炮 (Front firing cannons) 20mm×2 (2) 机枪 (Rear firing machine guns) 12.7mm×3

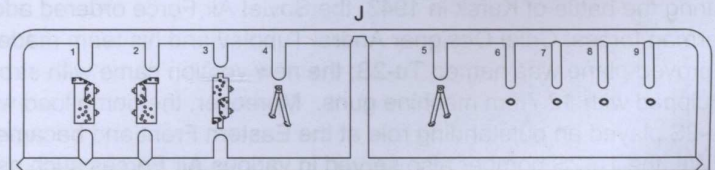
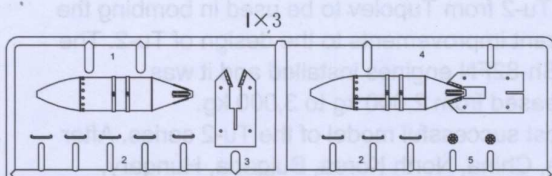
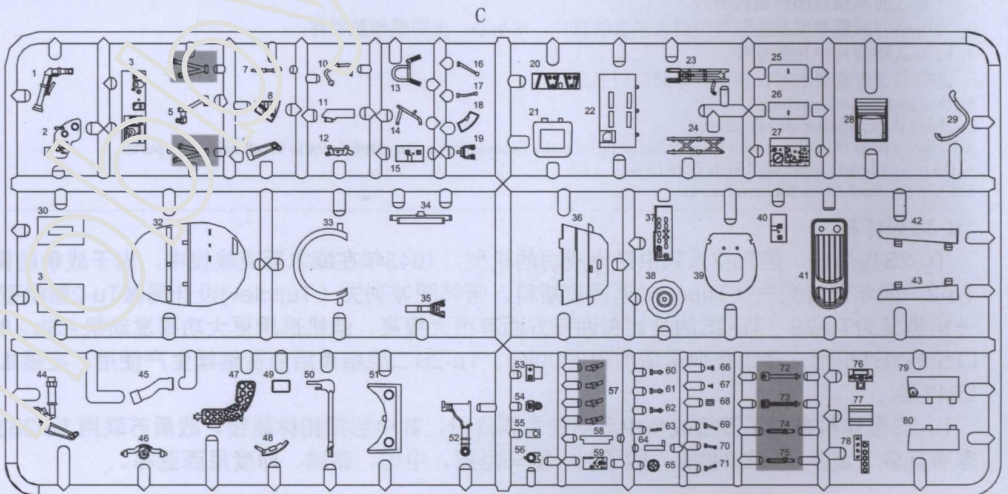
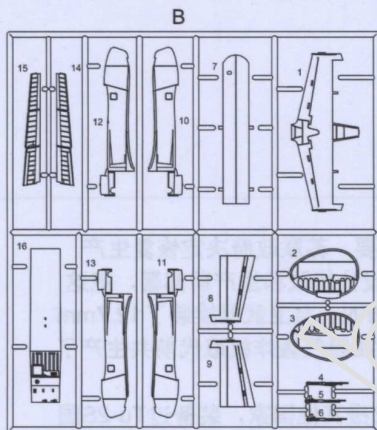
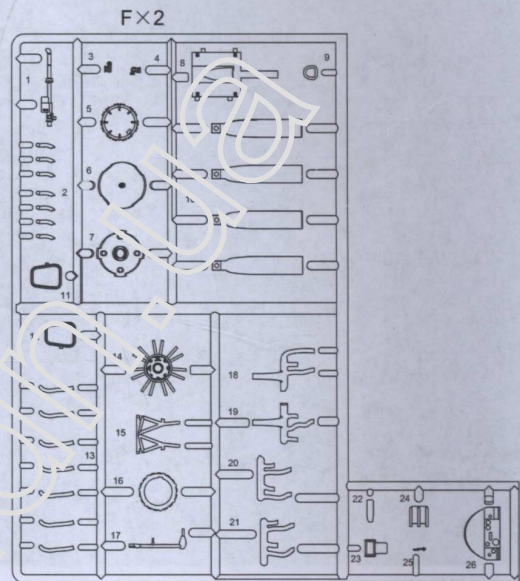
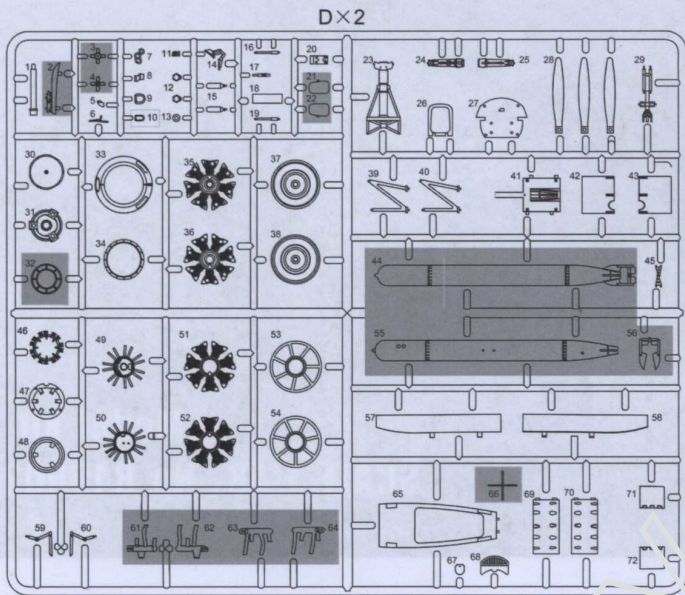
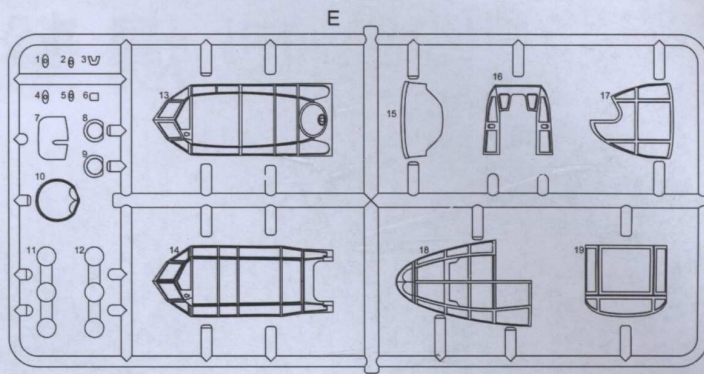
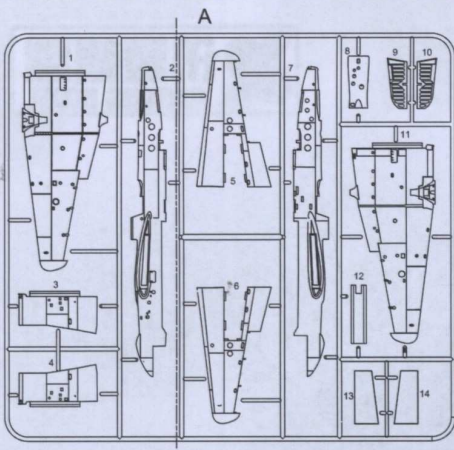

*版面限制, 板件图非实际比例。

■ 不用装配的部件 (unused part)



用胶粘合
Glue parts



不用粘合
Do not glue



小心留意
Caution



制作两份
Make two sets



选择采用
Optional



切去
Remove



贴上手印纸
Apply decal



弯曲
bend



打孔
Make hole



打磨平整
polish

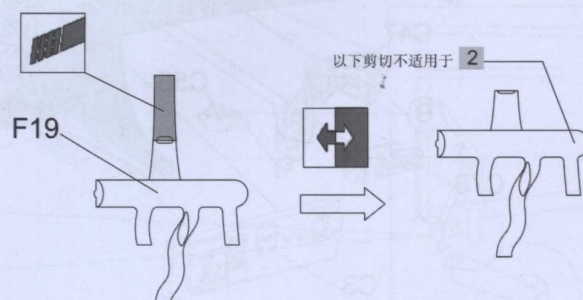
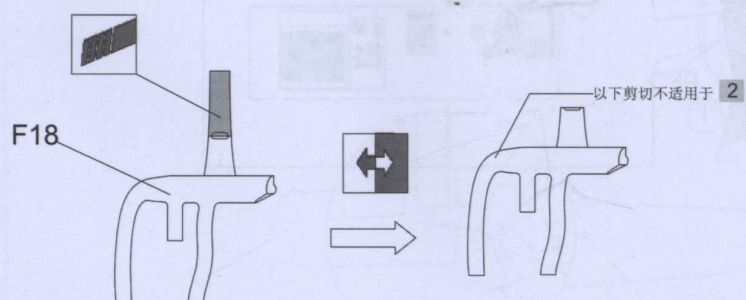
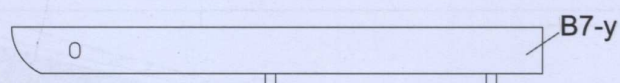
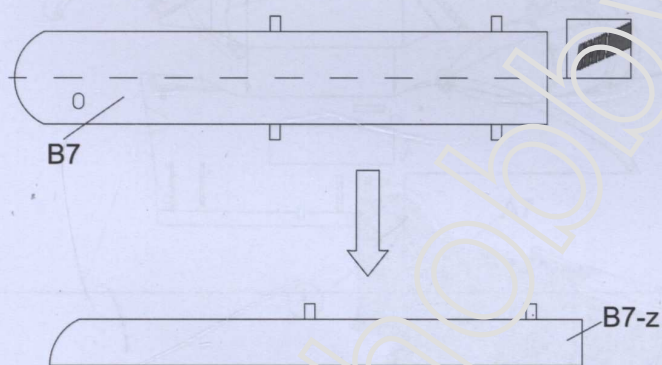
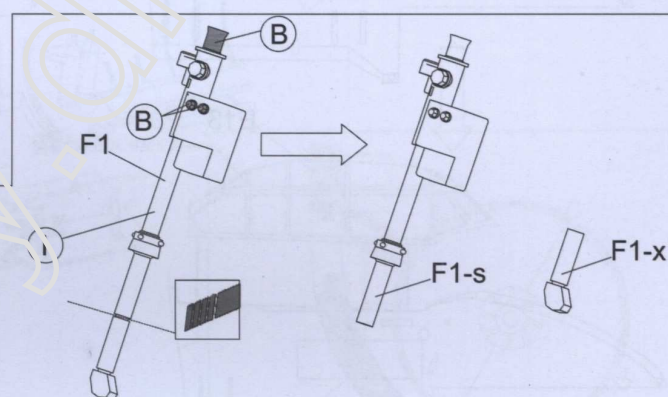
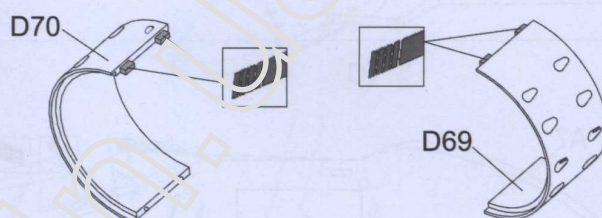
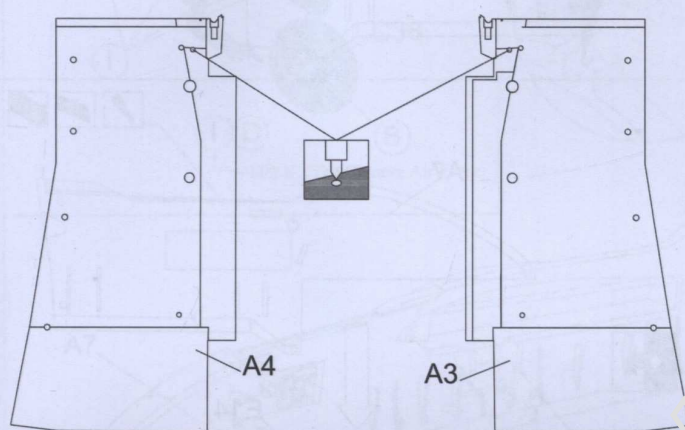
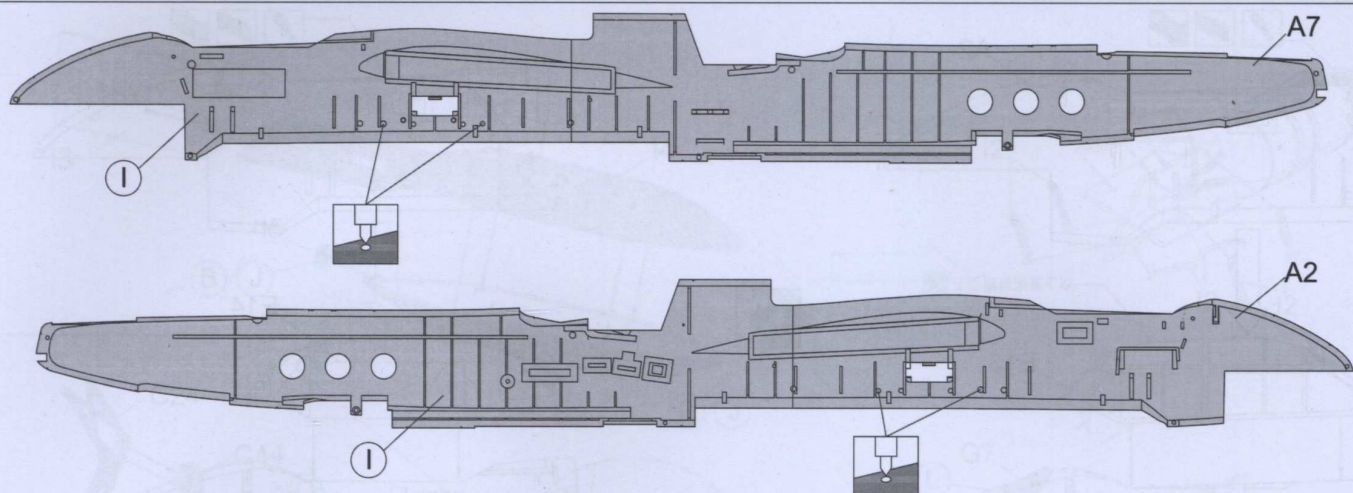

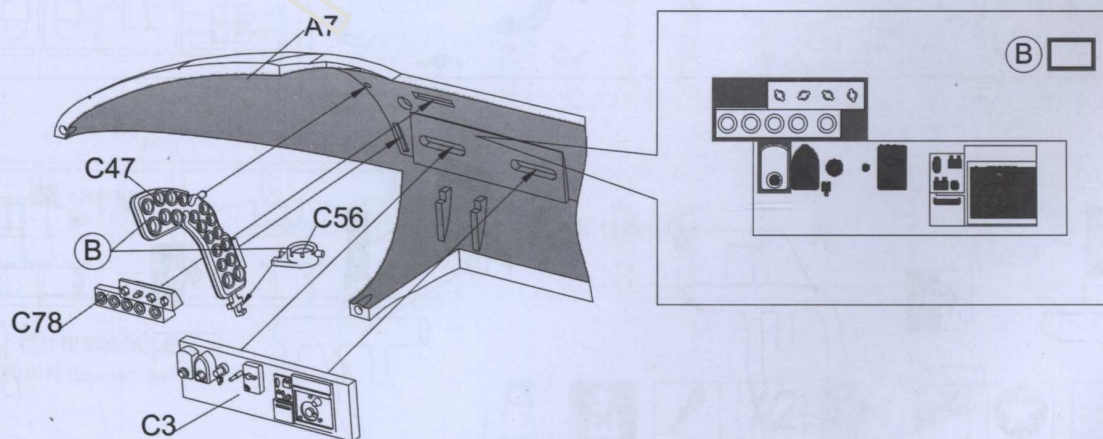
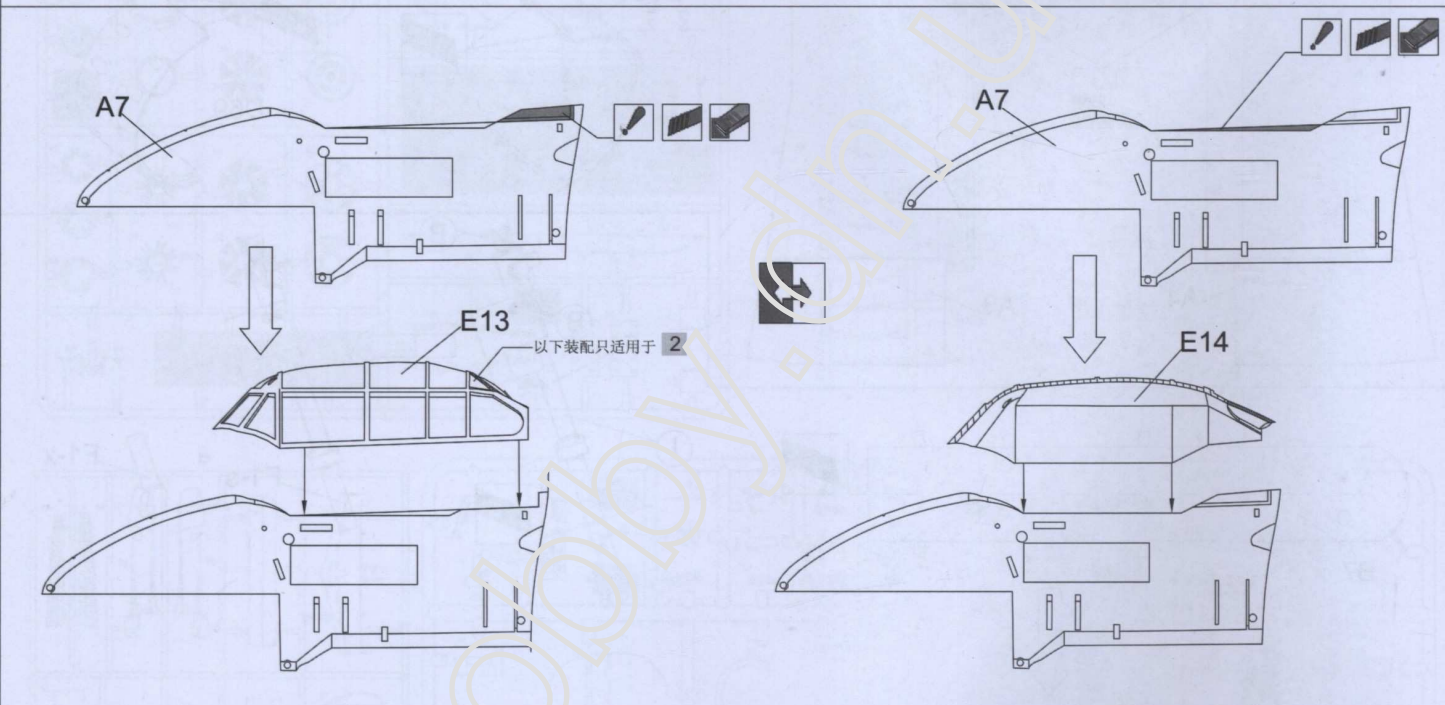
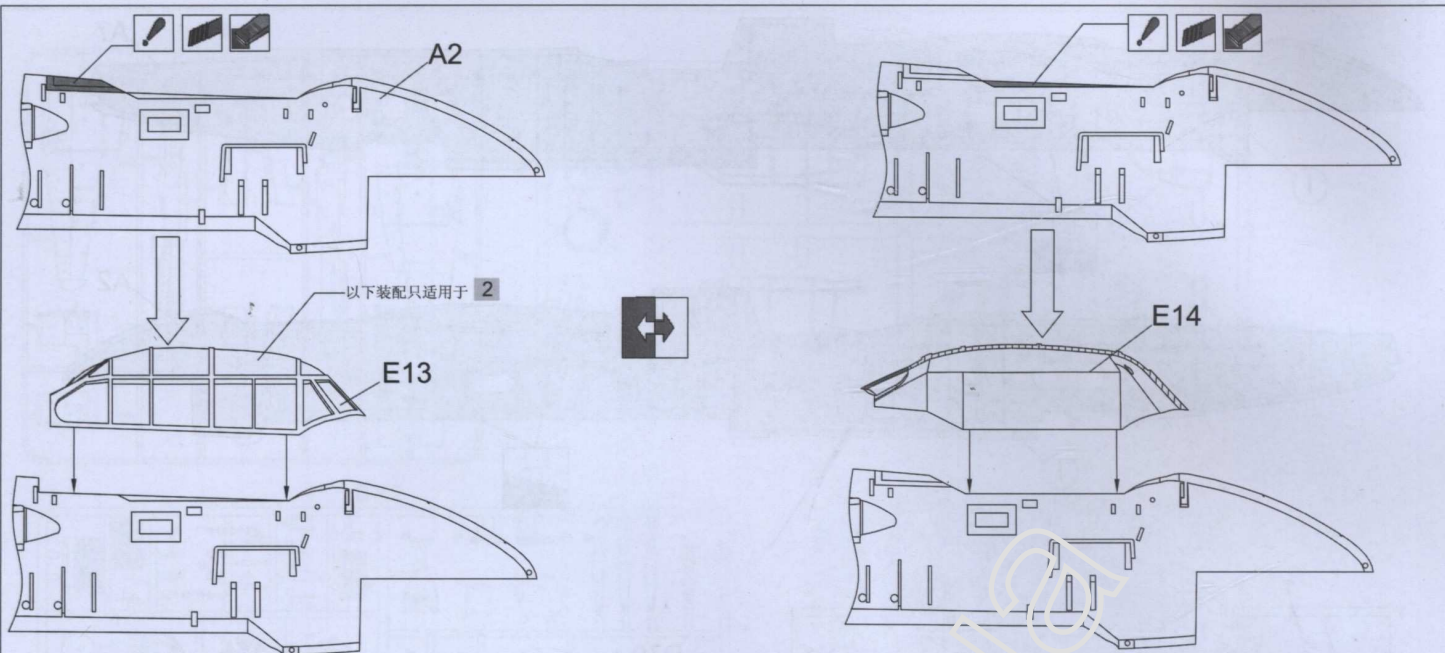

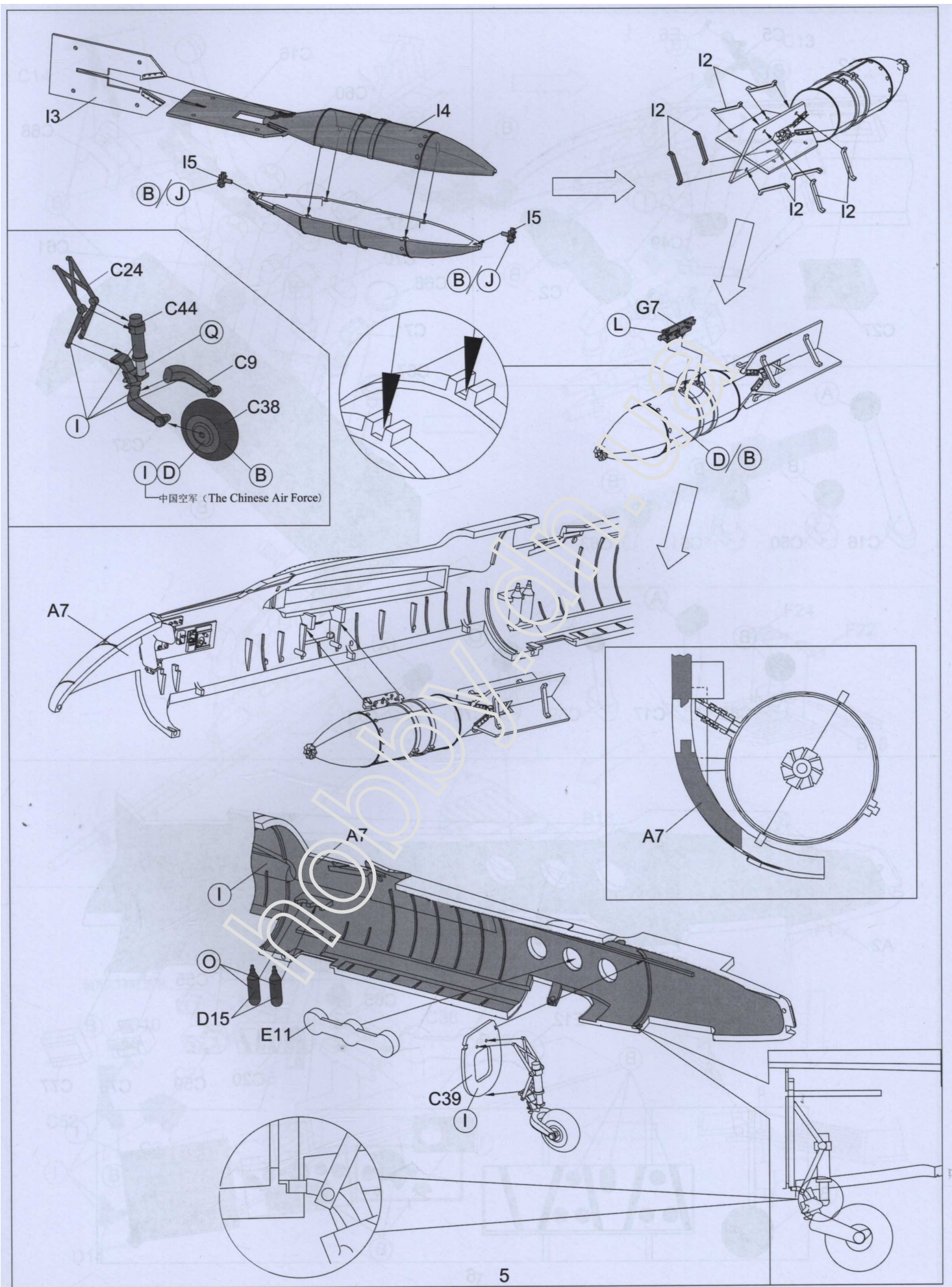

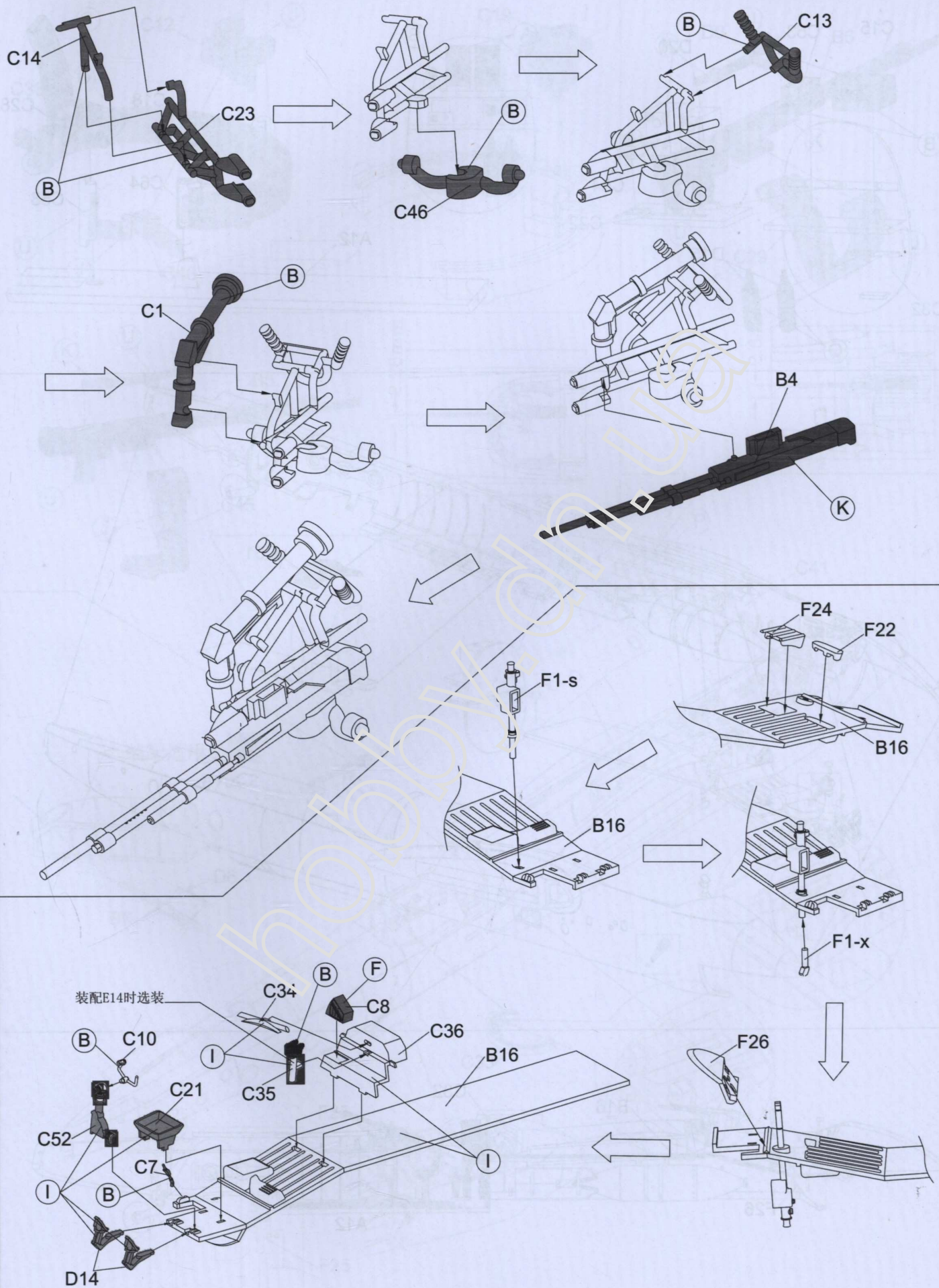

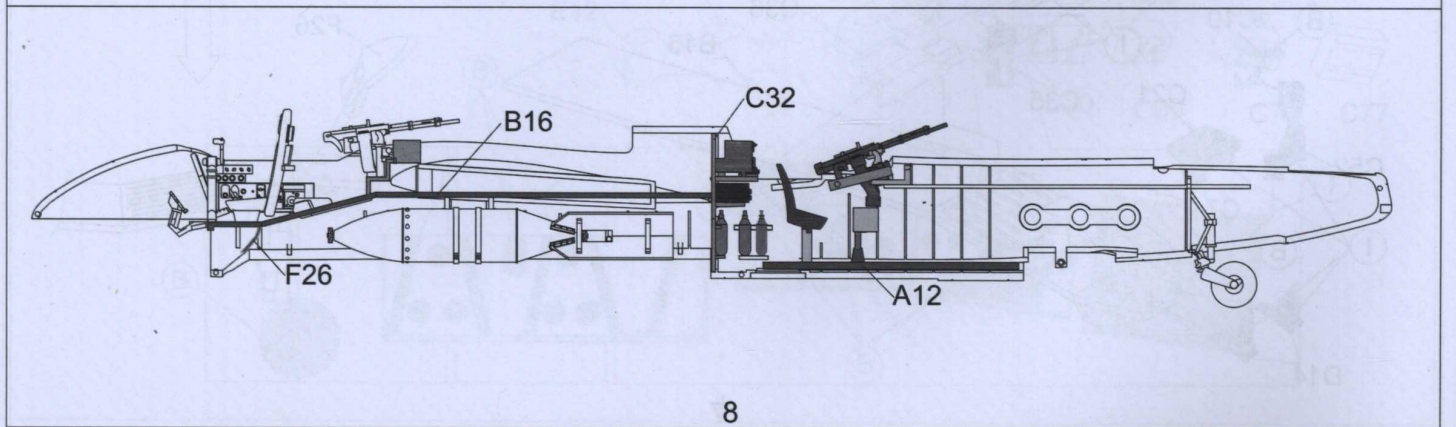
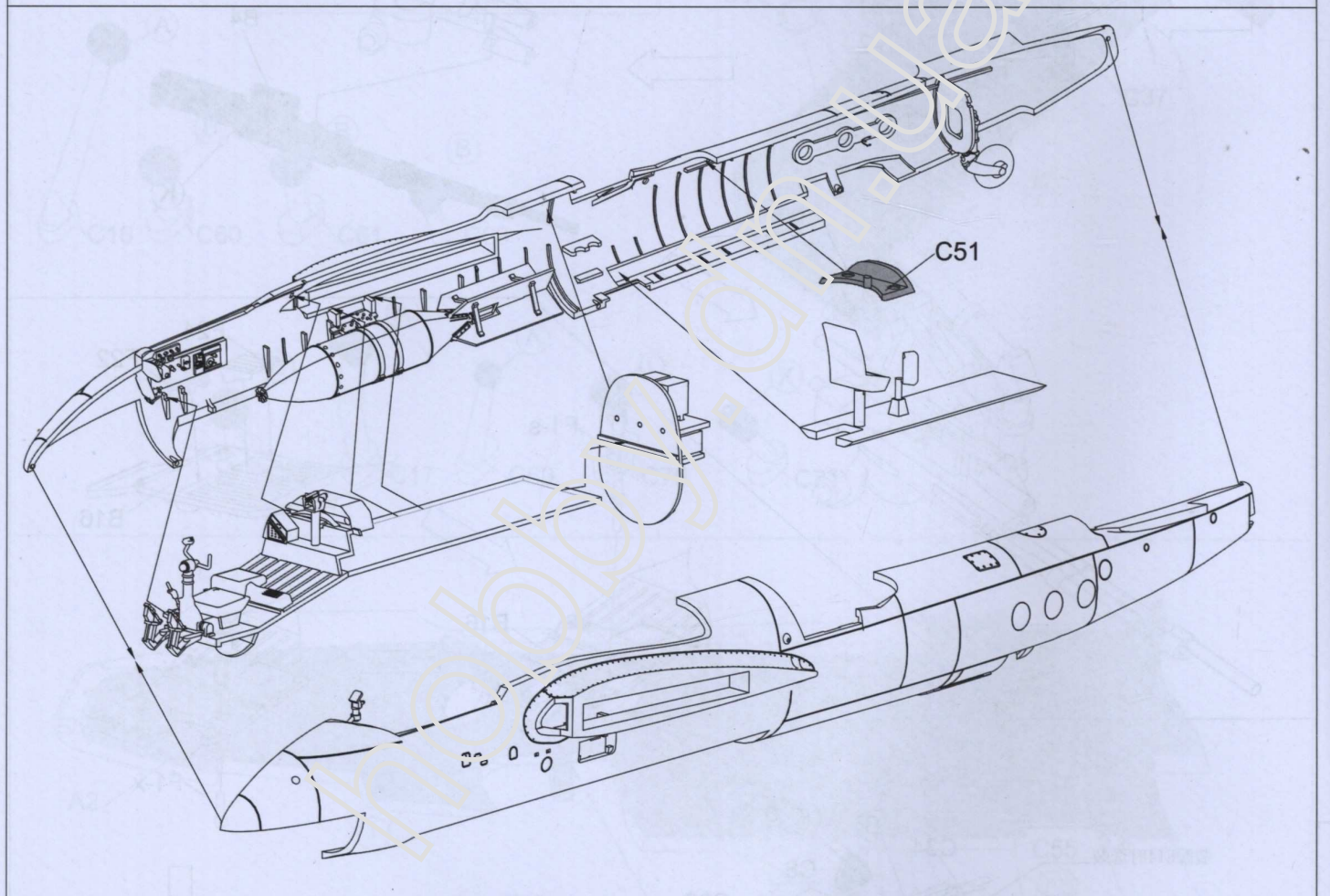
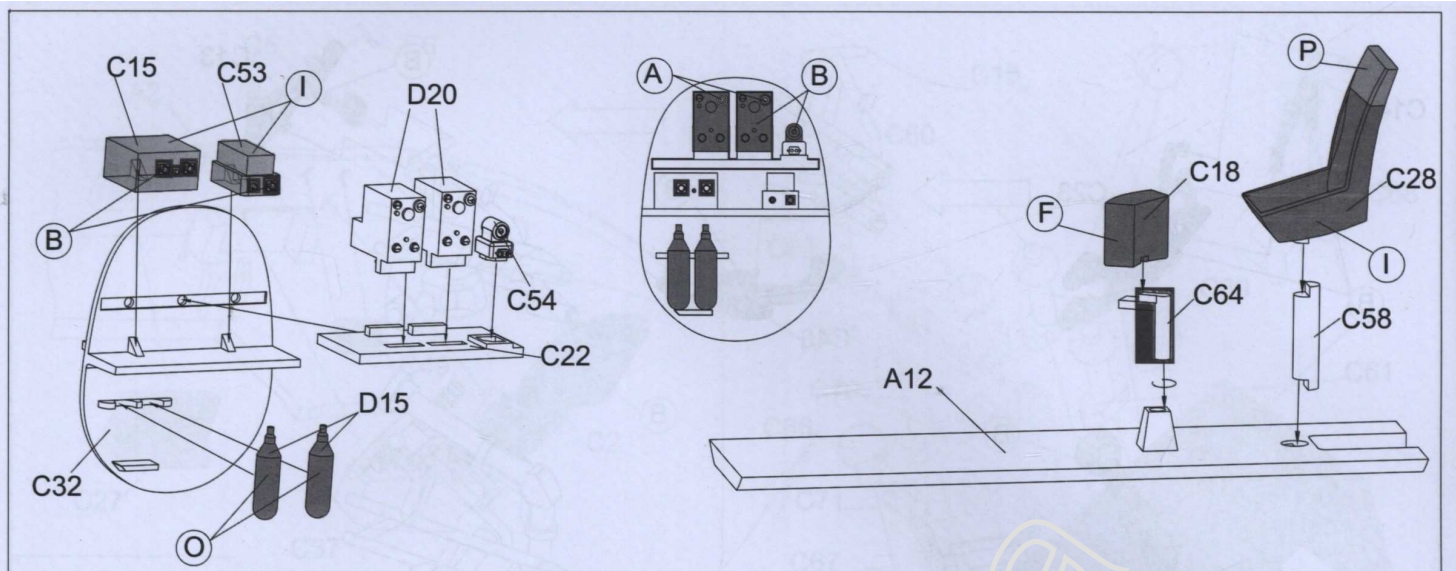

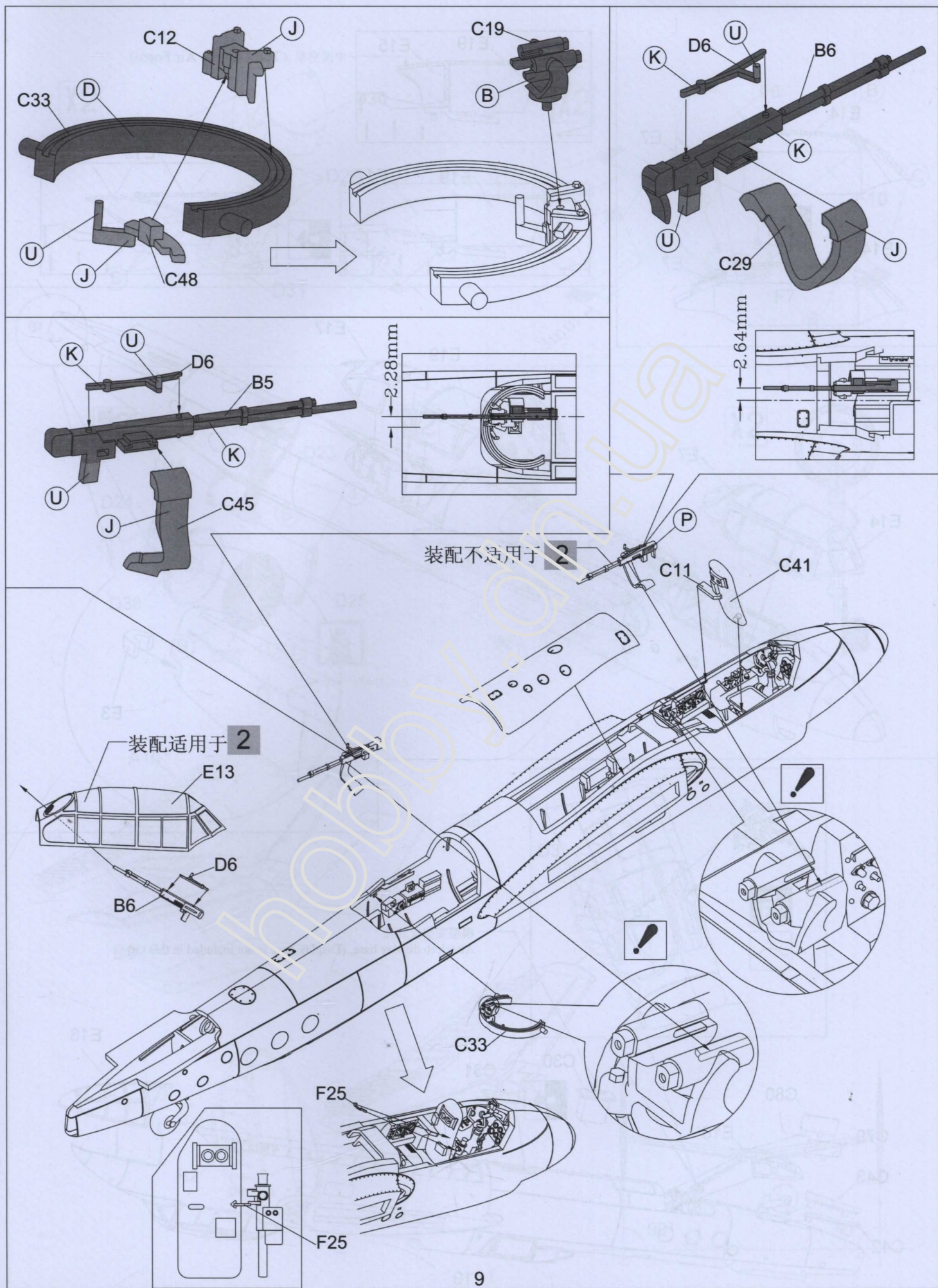

中国空军 (The Chinese Air Force)

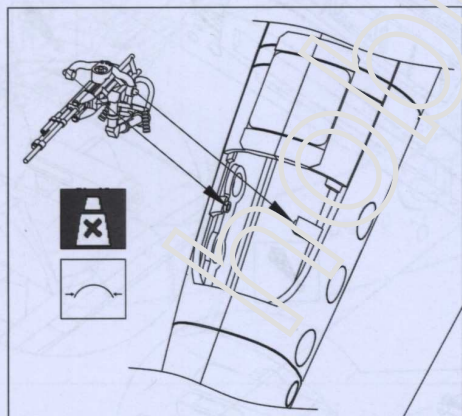
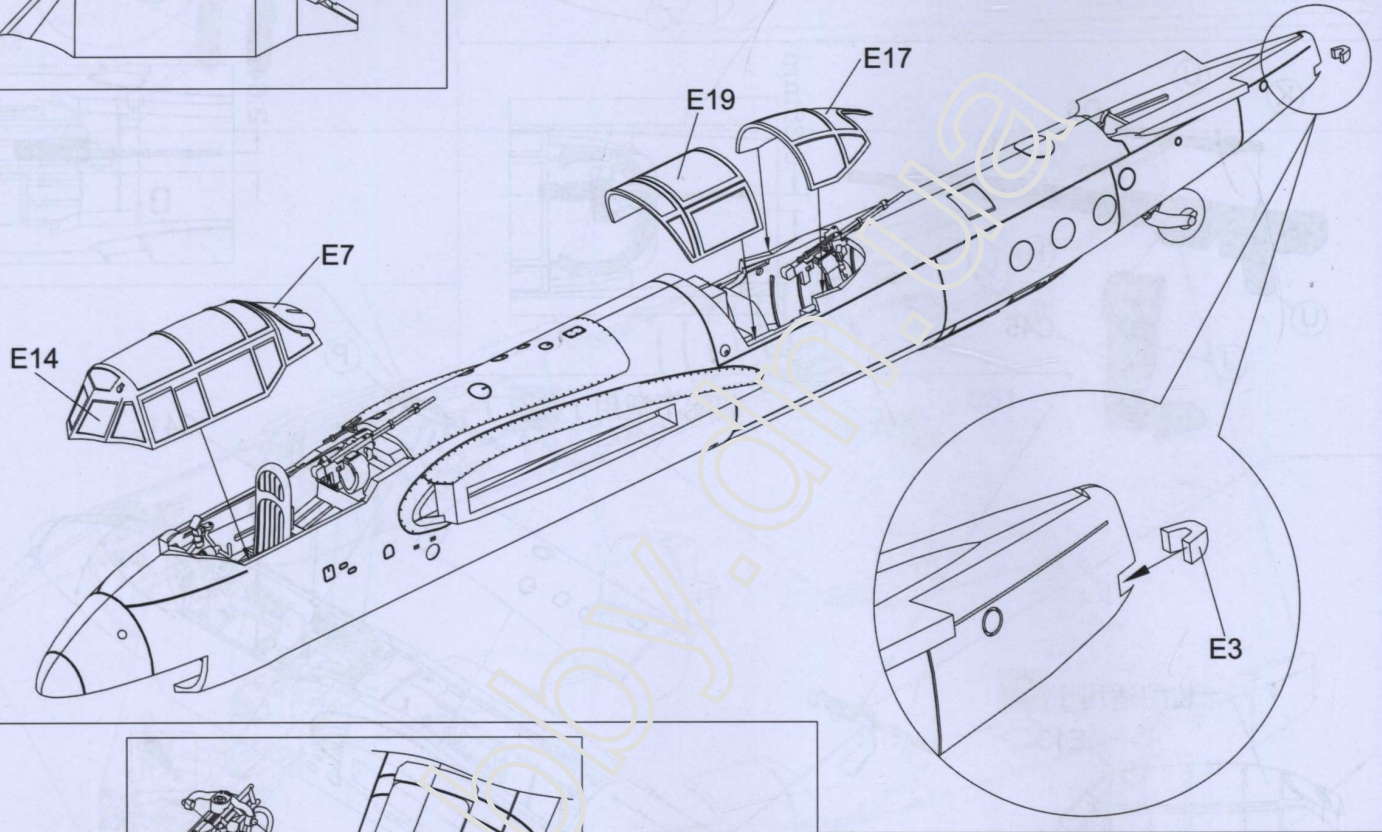
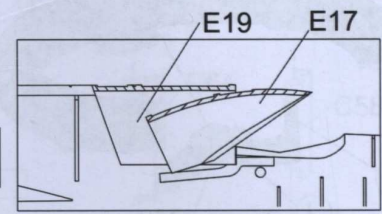
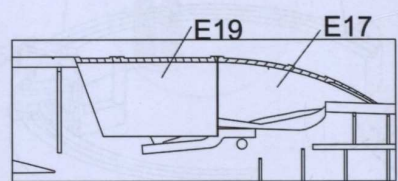
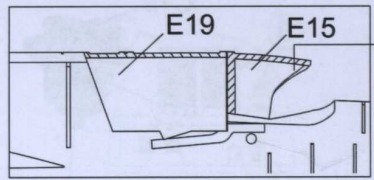
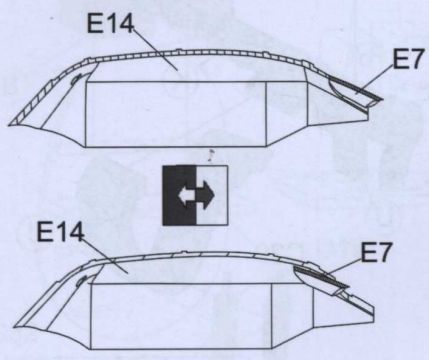

模型支架安放孔
Attach to display base. (Display base is not included in this kit)

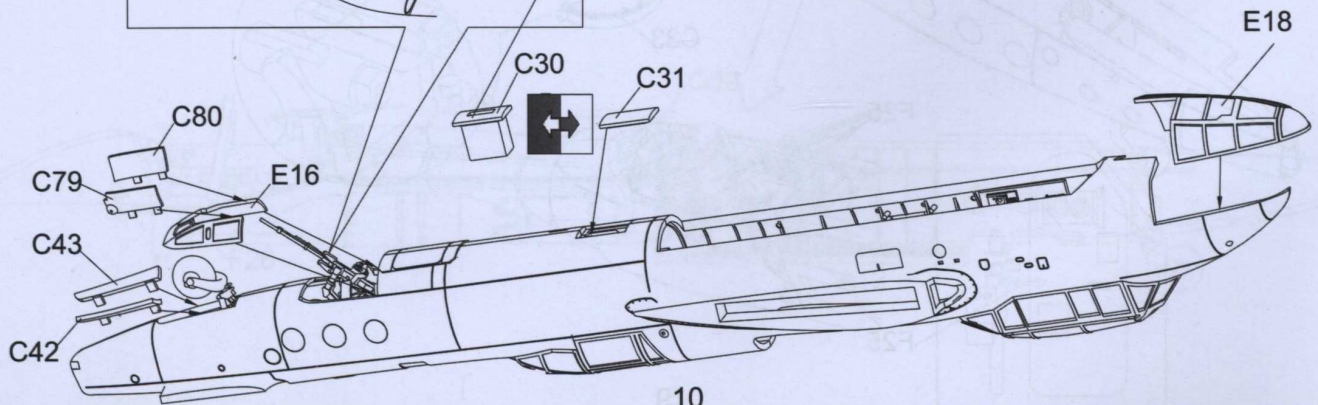

X2

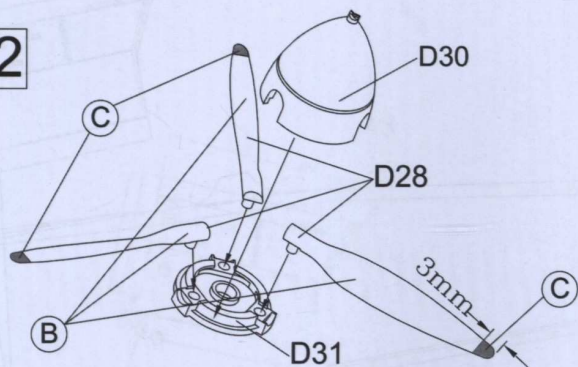

X2

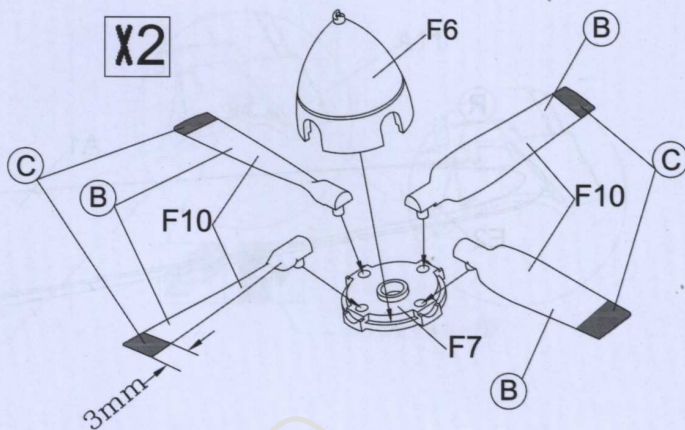

X2

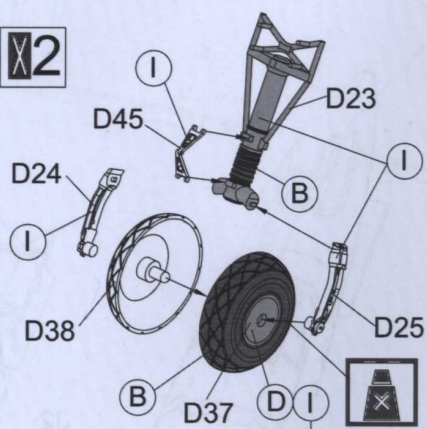

中国空军 (The Chinese Air Force)

X2

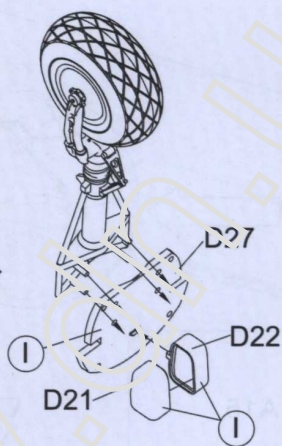

X2

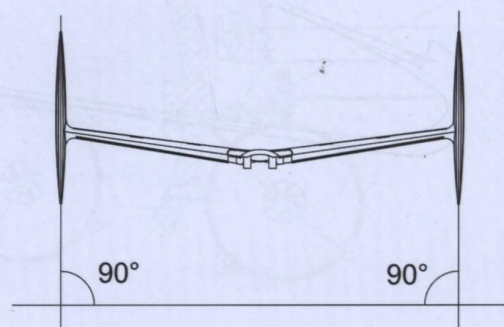
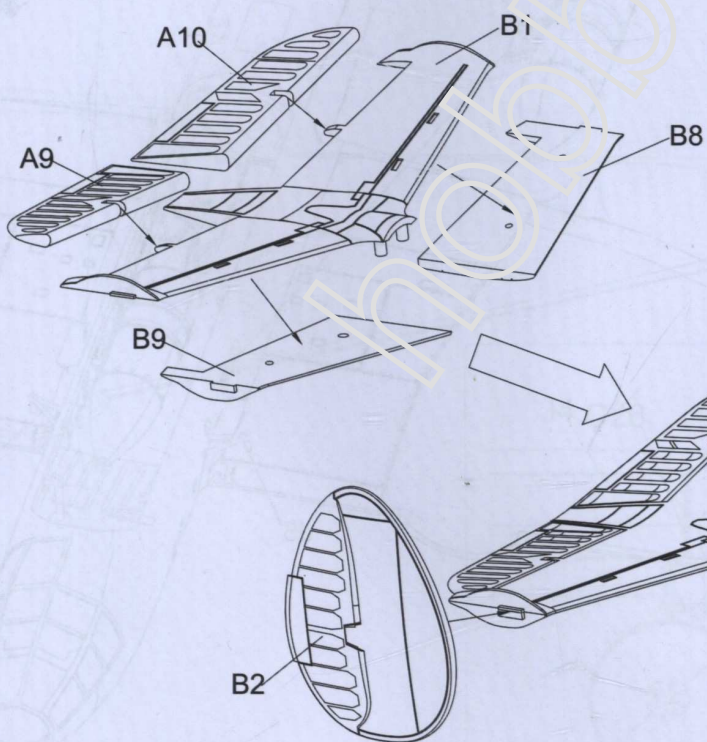
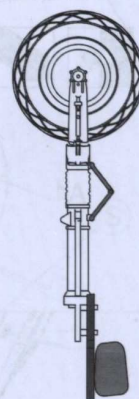

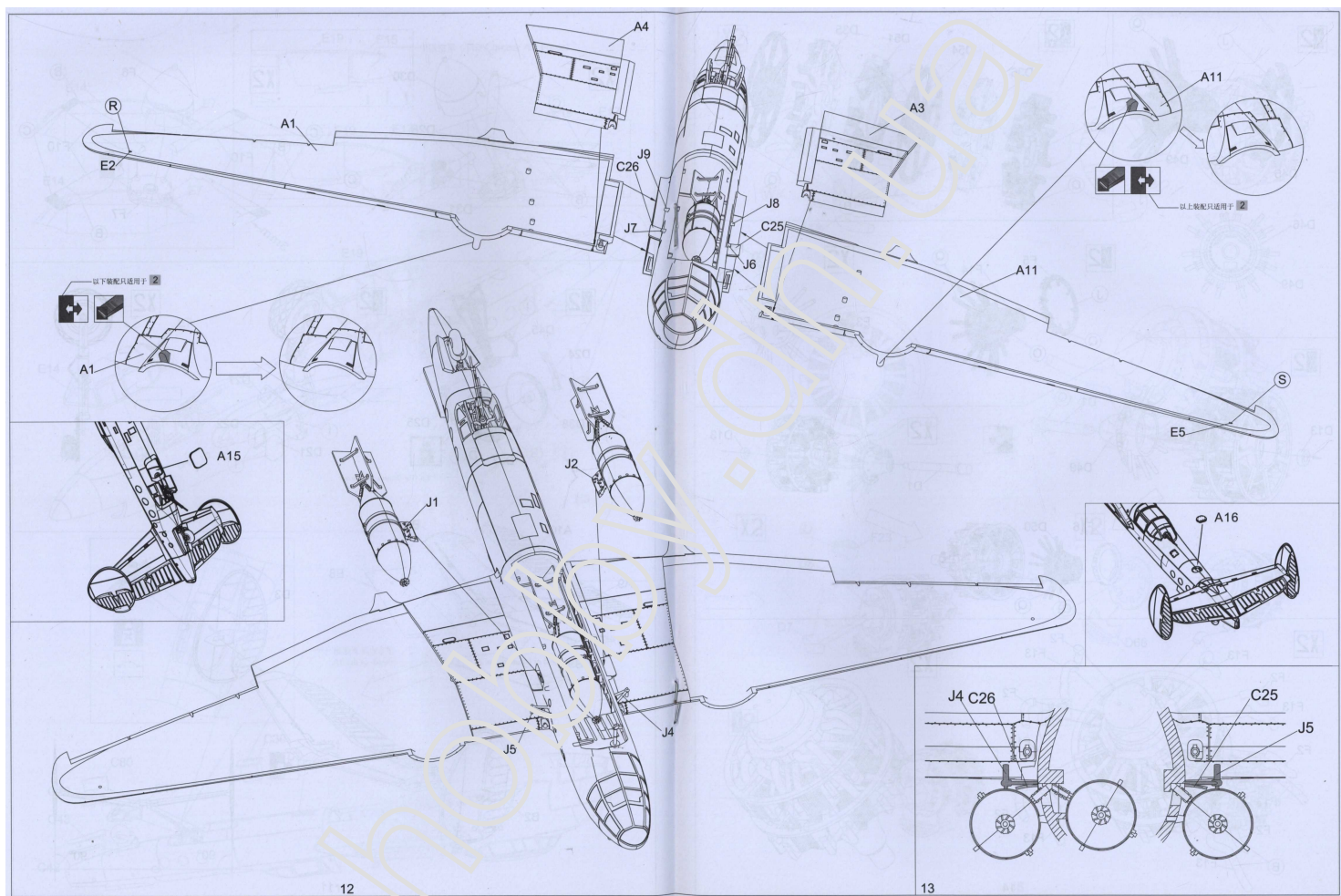

X2

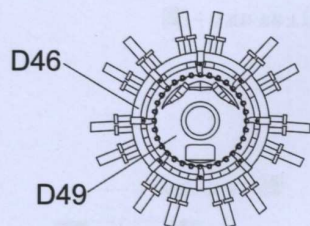
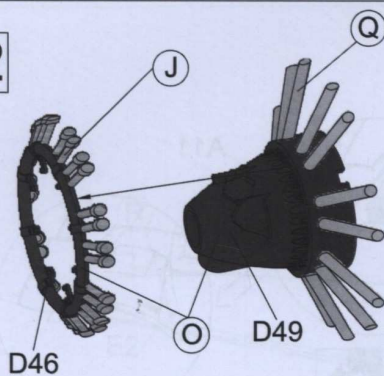

X2

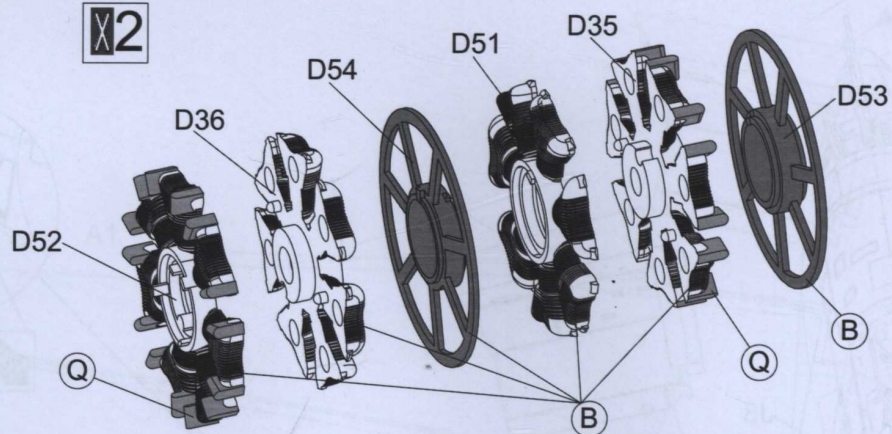

X2

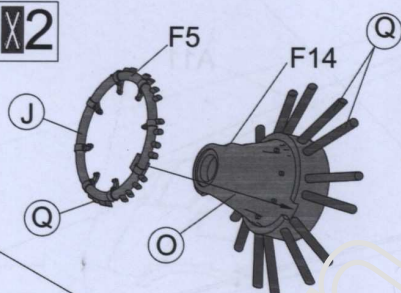

X2

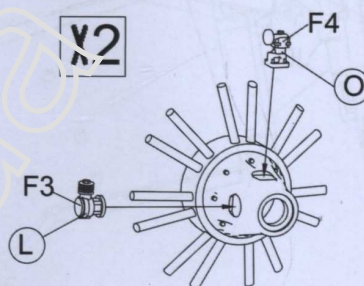

X2

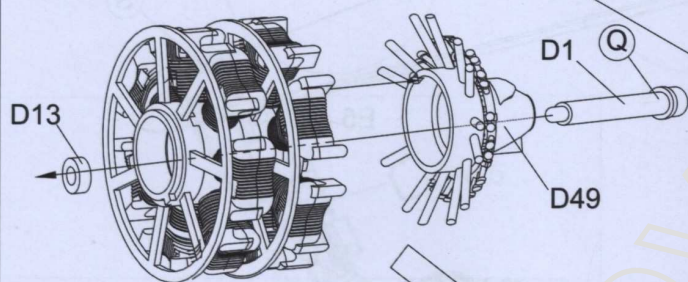

X2

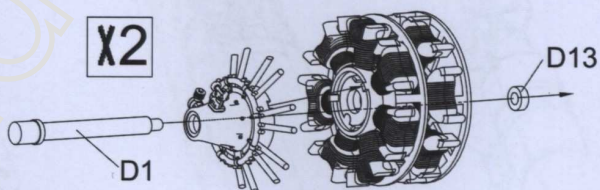

X2

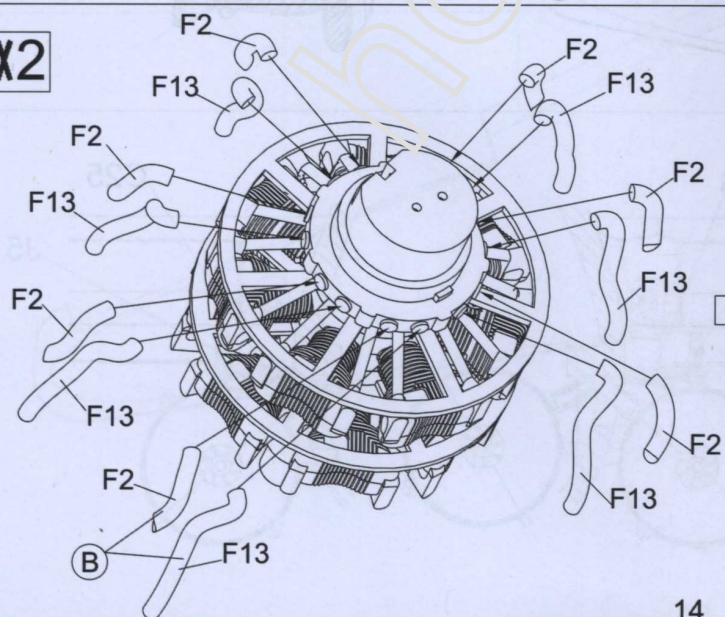

X2

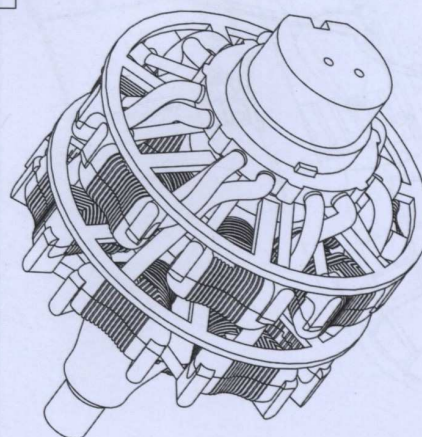

X2

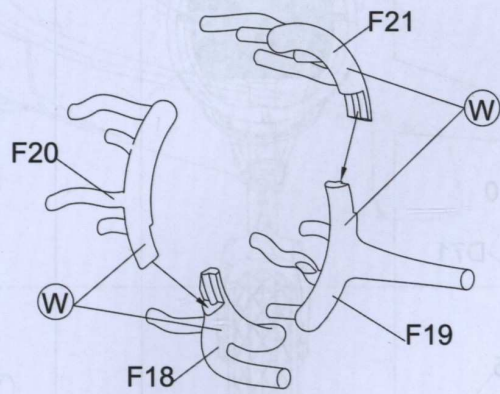

X2

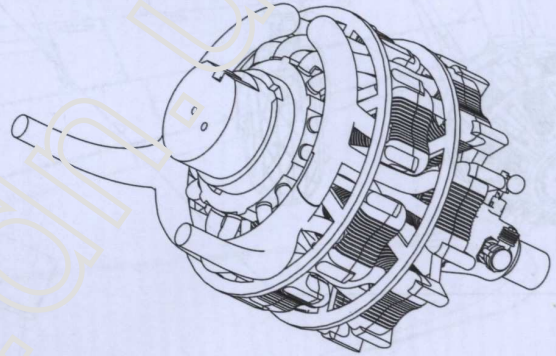
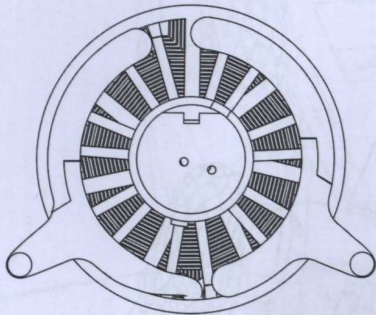
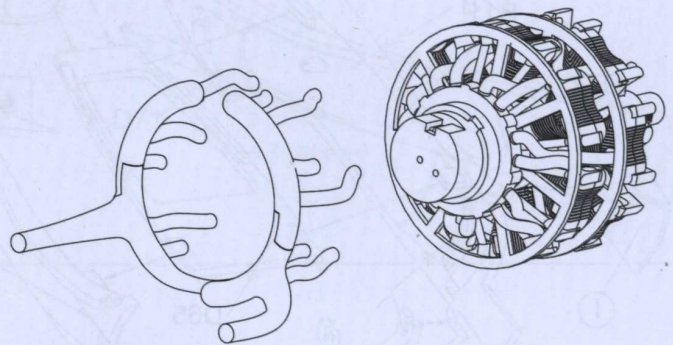

X2

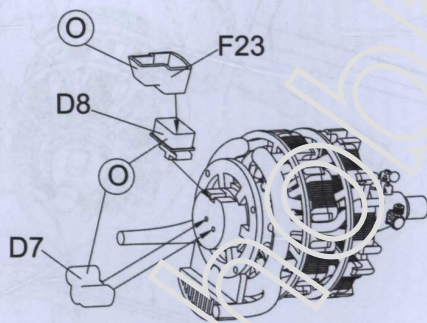

X2

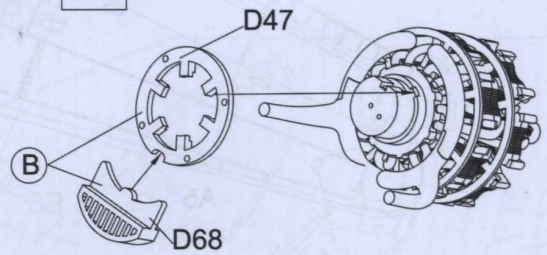

X2

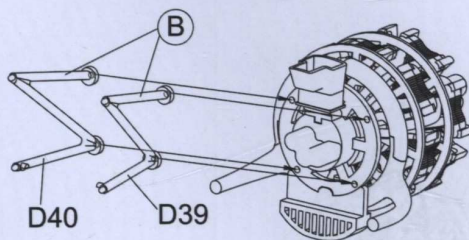

X2

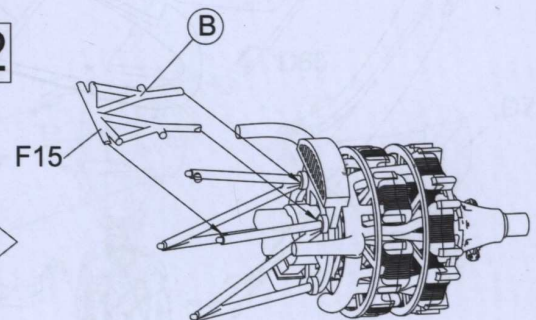

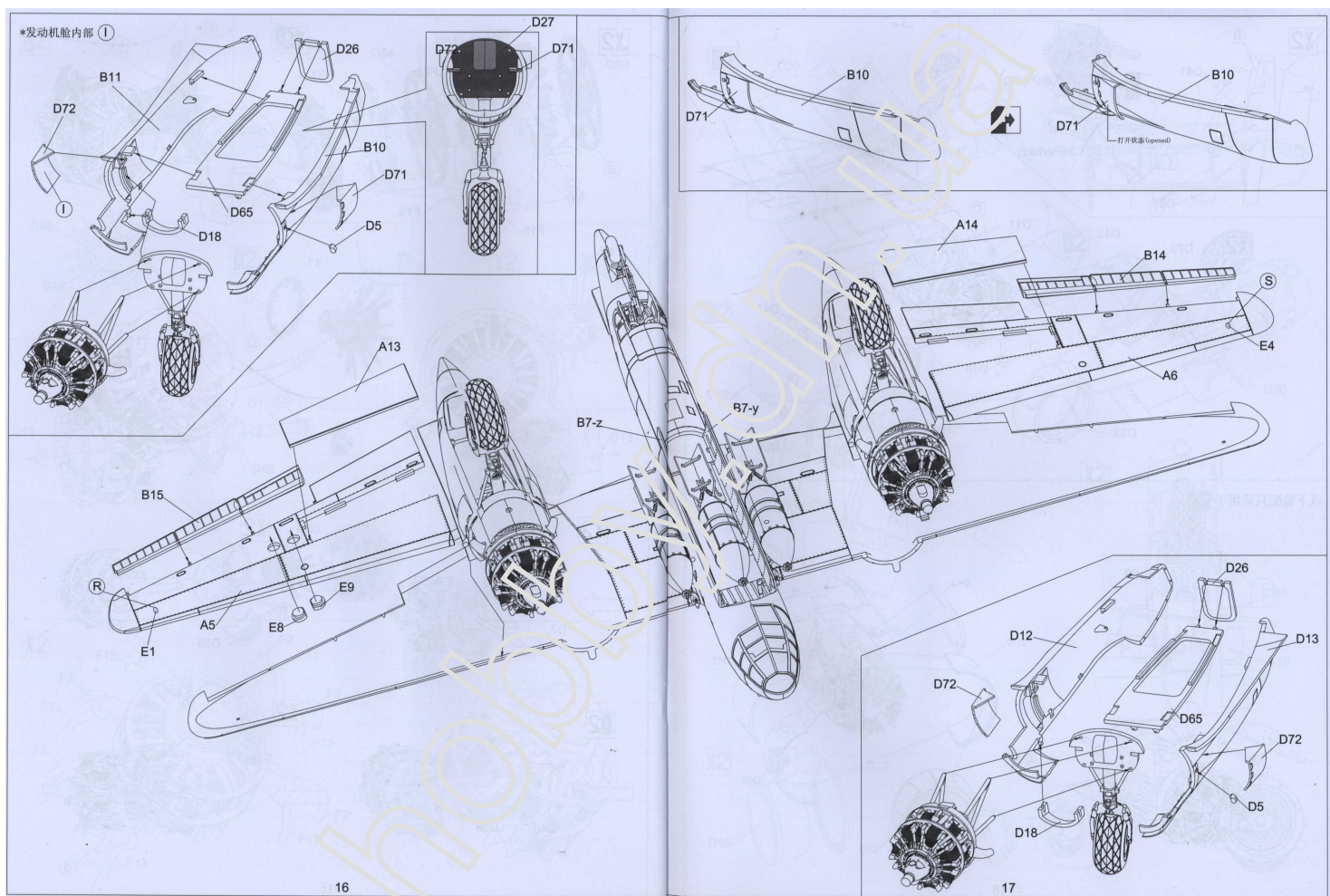

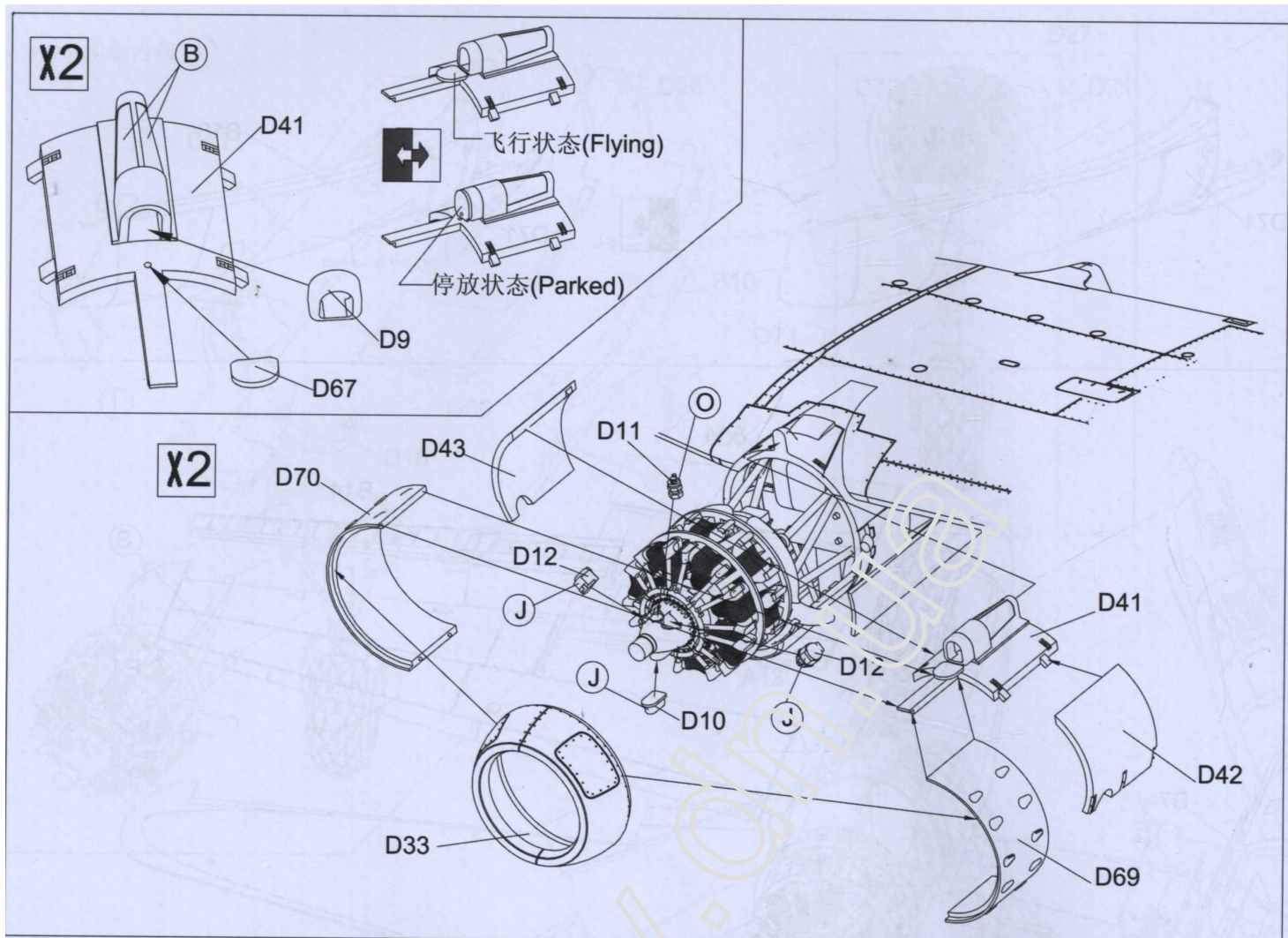

以下装配只适用于 **2**

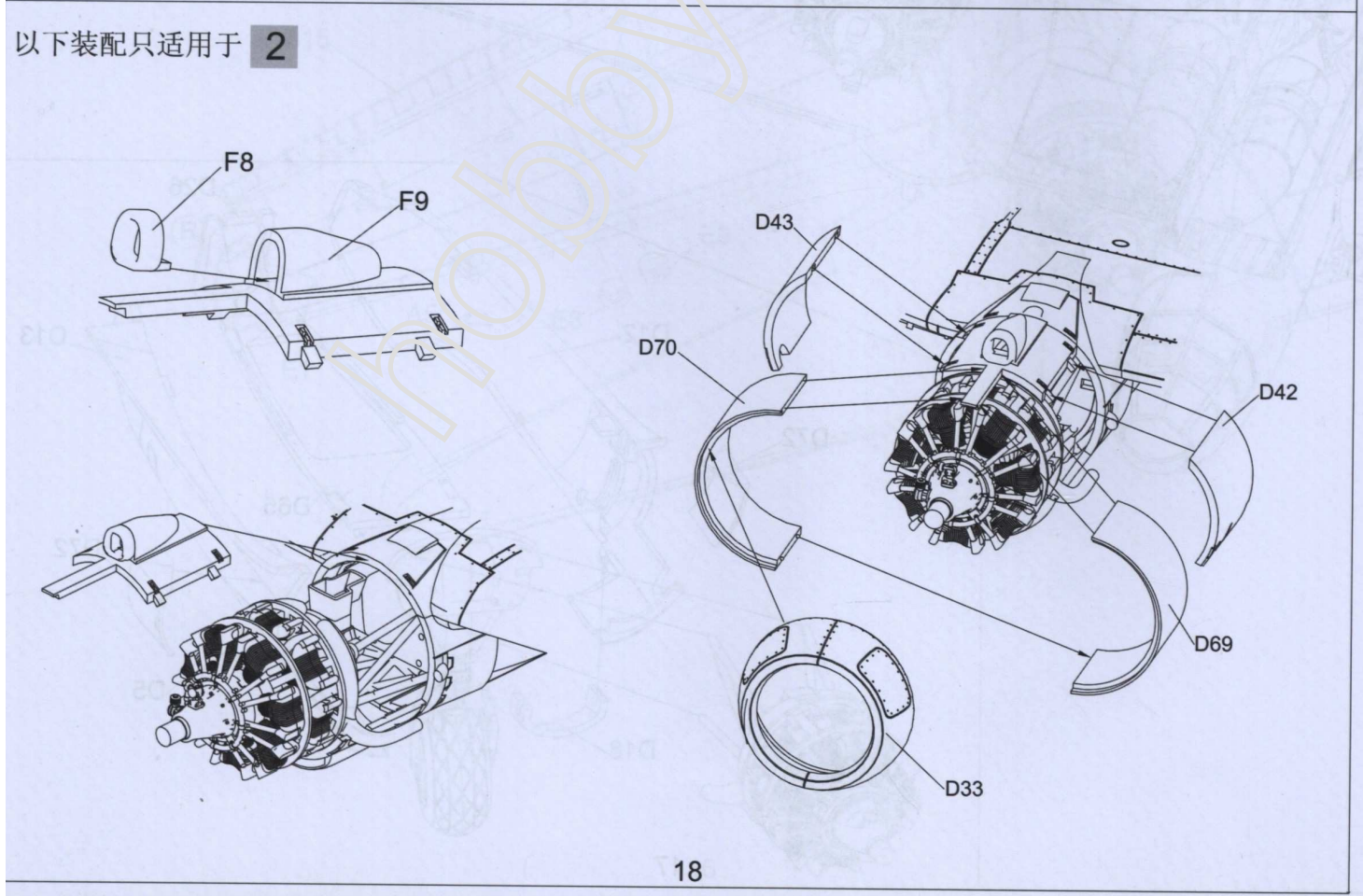

X2

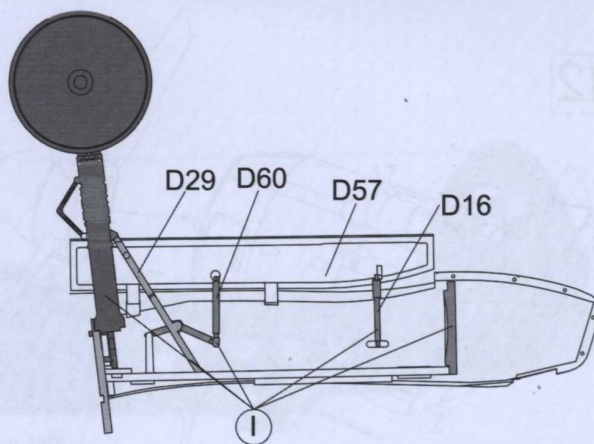
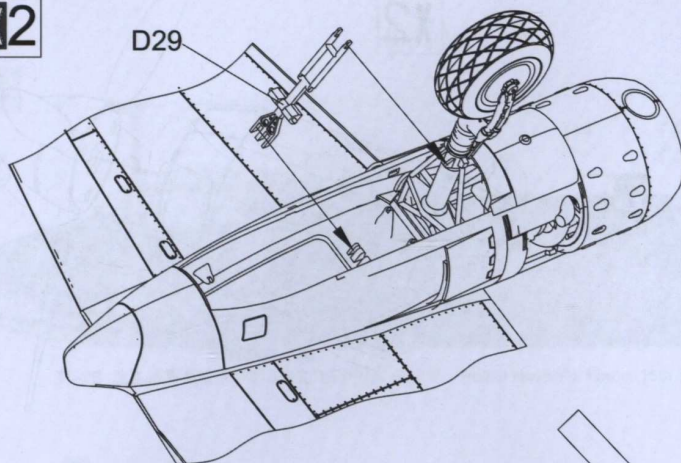

X2

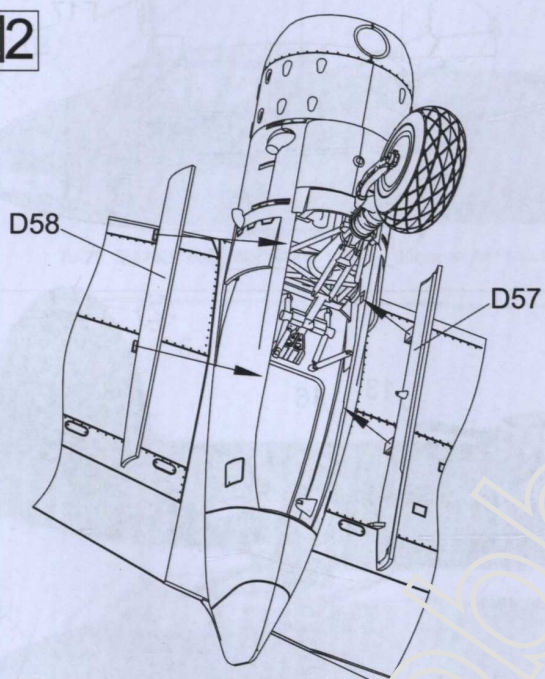

X2

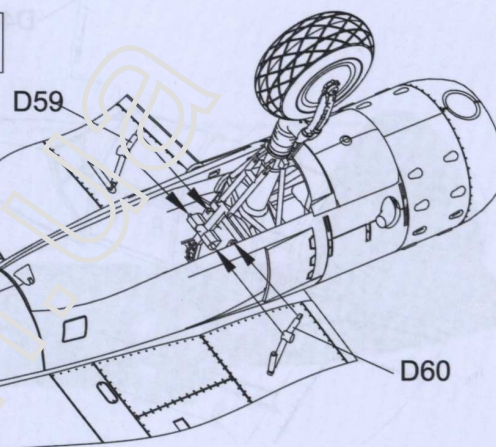

X2

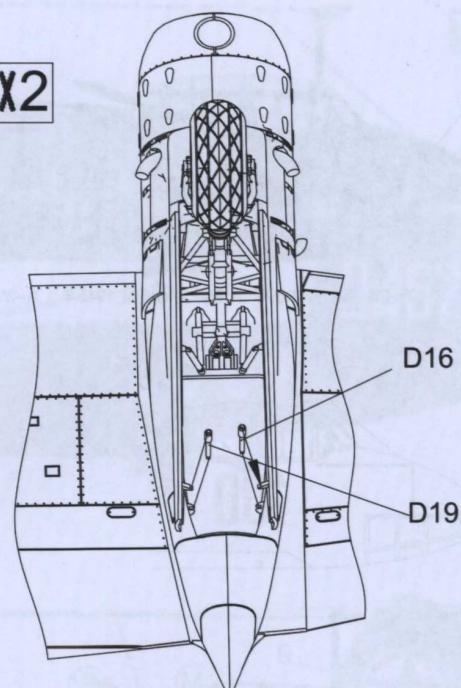

X2

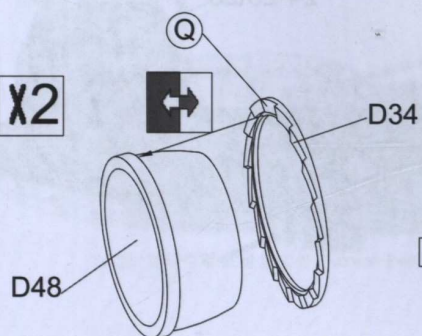

X2

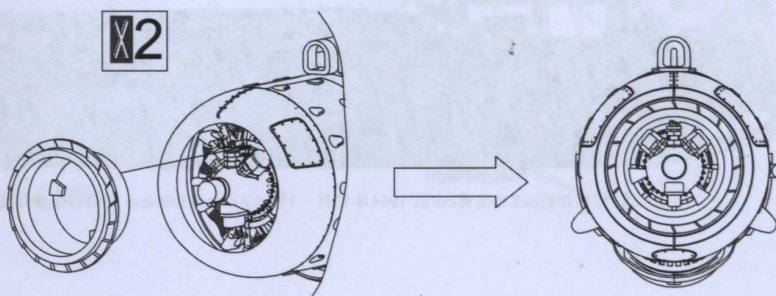

X2

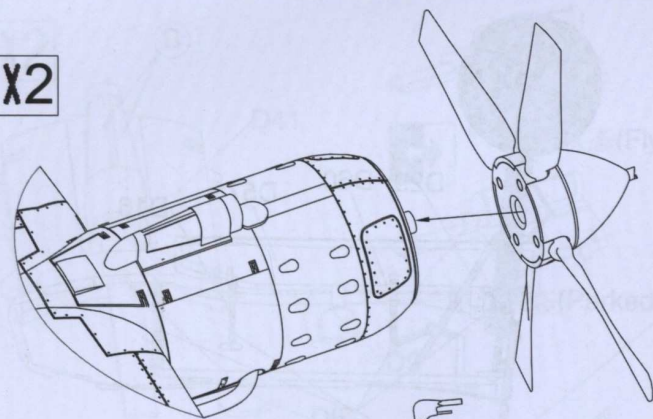

X2

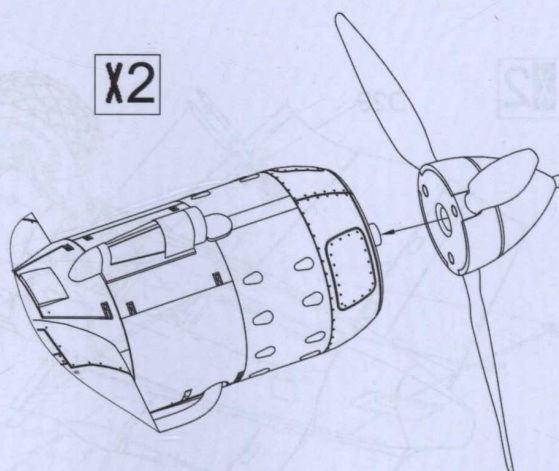

D48

以下装配只适用于 2

F17

1



Tu-2S 第88轰炸机师 A 普希金的座机 1945年 10月 2日 A.Pushkin, CO 88 BAD(bomber division), 1945

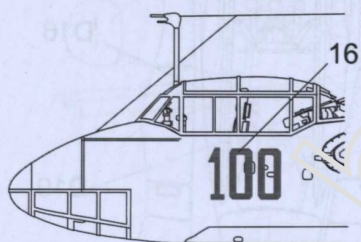

2

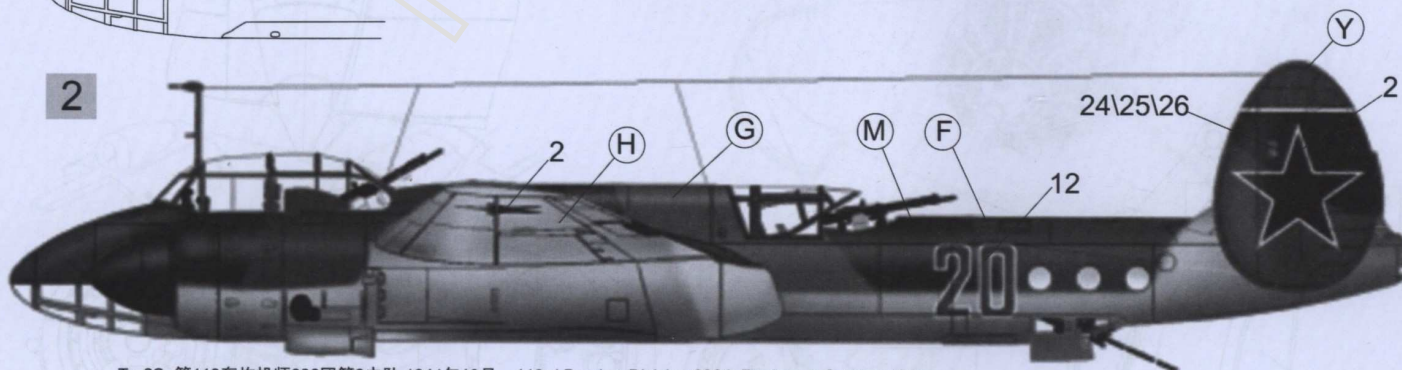

Tu-2S 第113轰炸机师836团第2中队 1944年10月 113rd Bomber Division 836th Regiment, October 1944

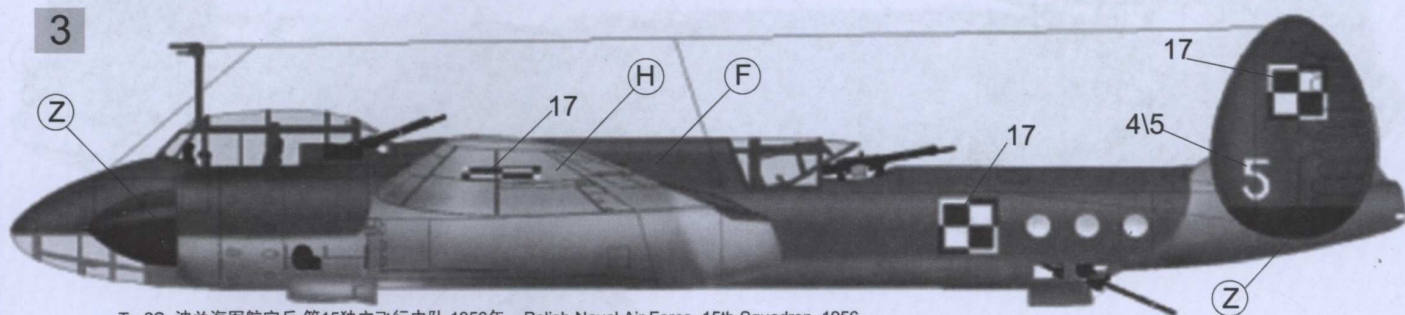

Tu-2S 波兰海军航空兵 第15独立飞行中队 1956年 Polish Naval Air Force, 15th Squadron, 1956

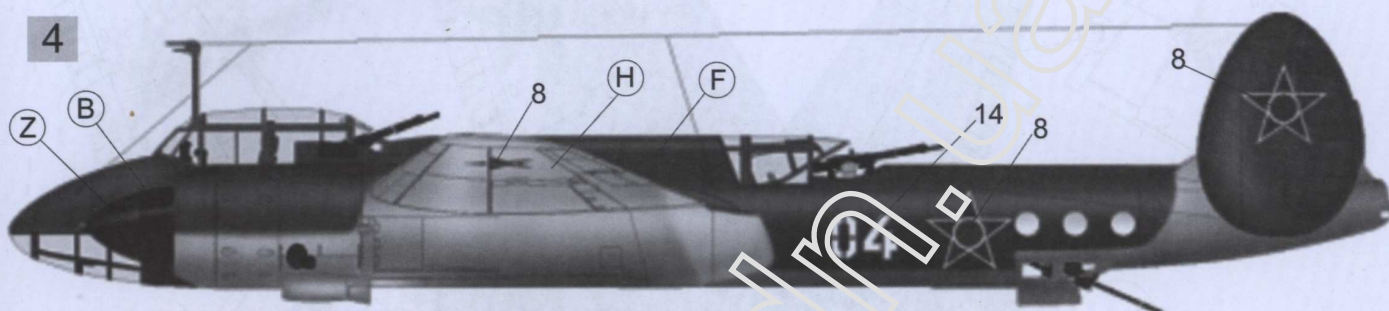

Tu-2S 第82轰炸机师 匈牙利空军 1954年 Bulgarian Air Force 82nd Bomber Division, 1954

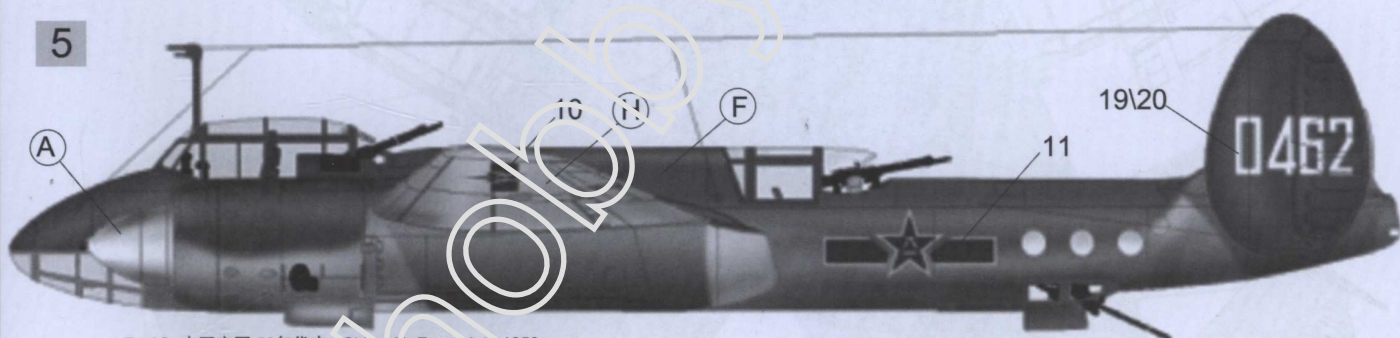

Tu-2S 中国空军 50年代末 China Air Force, late 1950s

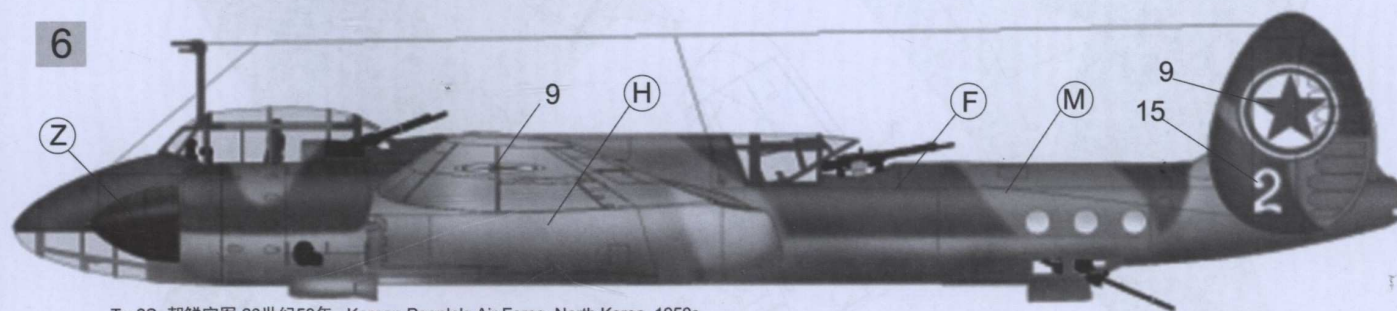

Tu-2S 朝鲜空军 20世纪50年 Korean People's Air Force, North Korea, 1950s

7

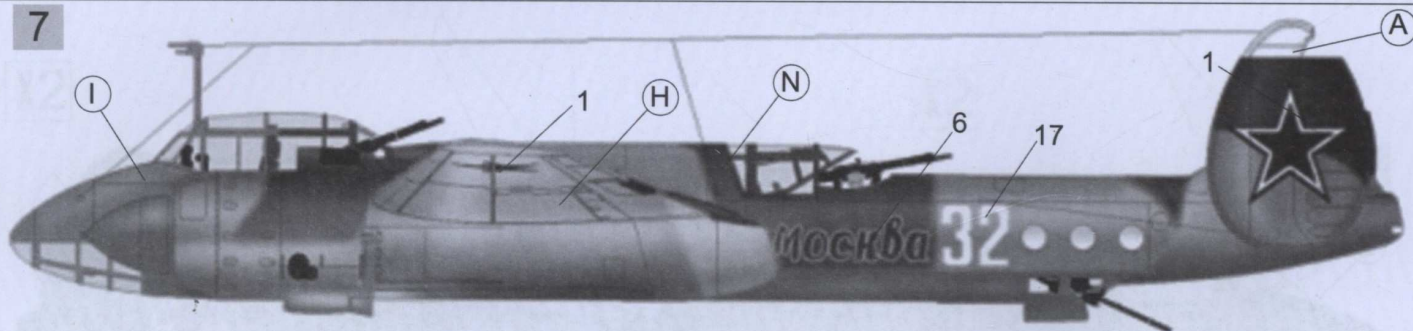

Tu-2S 第326轰炸机师第6团 马力诺机场 1944年 莫斯科工人捐赠 Aircraft funded by the donations of Moscow workers, 326th BAD 6th Regiment, 1944

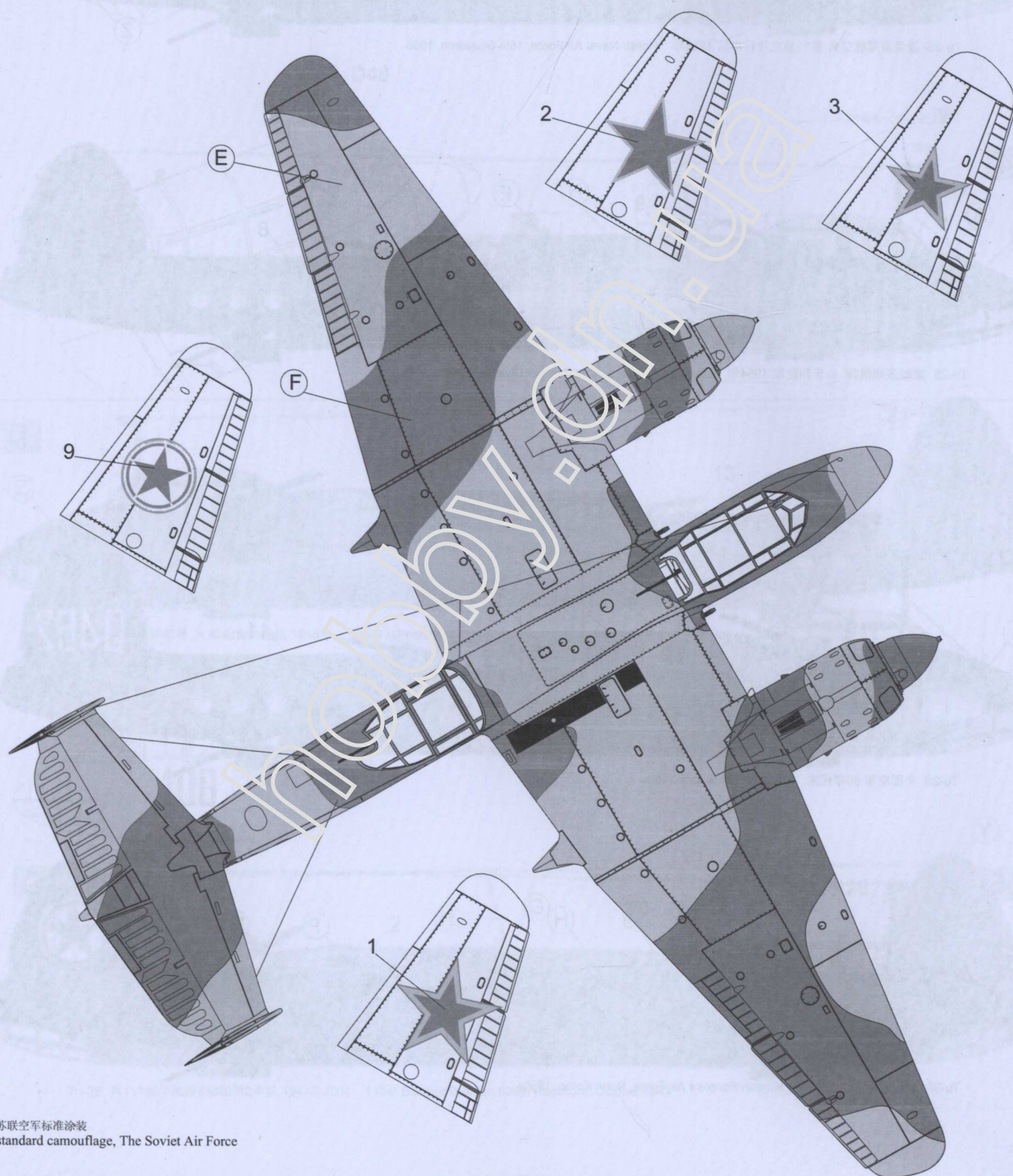

*苏联空军标准涂装
*standard camouflage, The Soviet Air Force

8

1 3 7 13 18 23

F B M I

Tu-2S 苏联 高加索军区航空兵 1947年 Soviet Union, Caucasian Front, 1947

Tu-2S 苏联 高加索军区航空兵 1947年 Soviet Union, Caucasian Front, 1947

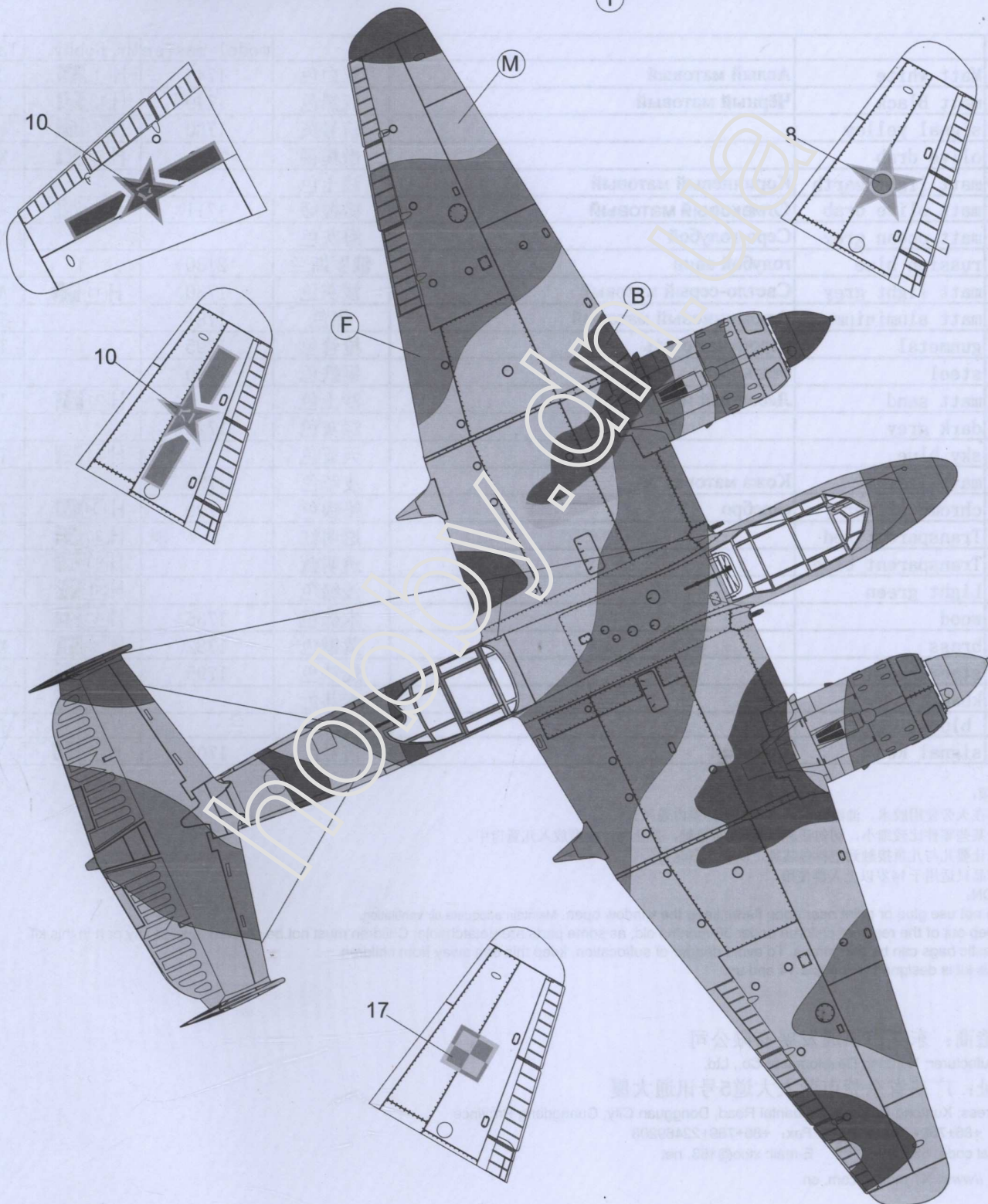

水贴纸使用说明:

1. 从印花板上剪下所需部分, 放入温水浸泡10秒钟。
2. 拿着印花板将印花移到模型上,
3. 手指蘸水后, 将印花移到适当位置;
4. 用软布轻轻压印花直至气泡消失。

DECAL APPLICATION:

1. Cut decals from sheet as needed. dip the decal in warm water for about 10 seconds and then place on soft clean cloth.
2. Hold the decal onto the model in its proper position.
3. While still wet, decal can be adjusted for better fit on model by dampening it gently with your finger.
4. When placed in the proper position, gently press decal down with a soft cloth until excess water and air bubbles are gone.

number				model master	Mr. hobby	Tamiya
A	Matt white	Аелый матовый	亚白色	1745	H 1 1	XF2
B	matt Black	Чёрный матовый	亚黑色	1749	H 12 33	XF1
C	signal yellow		信号黄	1780	H 4 4	X8
D	olive drab		橄榄褐		H 78 38	XF62
E	matt light earth	Коричневый матовый	浅土色			
F	matt olive drab	Оливковый матовый	橄榄绿	1711	H 304 304	AS14
G	matt ocean grey	Серо-голубой	海灰色			XF54
H	russian blue	голубой авиа	俄罗斯兰	2130		
I	matt light grey	Светло-серый матовый	浅灰色	1730	H 11 51	AS16
J	matt aluminium	Алюминиевый матовый	铝色	1781		TS17
K	gunmetal	вороненая сталь	枪管色	1795		TS38
L	steel	сталь	钢铁色	1780		
M	matt sand	Лесочный матовый	沙土色		H 21 71	TS46
N	dark grey		深灰色	1723		
O	sky blue		天蓝色		H 34 25	TS23
P	matt leather	Кожа матовая	皮革色	1736		
Q	chrome silver	серебро	铬银色	1790	H 104	TS30
R	Transparent red		透明红		H 90 47	X27
S	Transparent blue		透明蓝		H 93 50	X23
T	Light green		浅绿色		H 303 303	
U	wood		木棕色	1735	H 43 37	
V	brass		黄铜色	1782	H 219	XF28
W	steel red		烧铁色	1795	H 76 61	XF10
X	khaki		卡其色		H 52 48	
Y	blue		蓝色			TS54
Z	signal Red	Красный	信号红	1705	H 3 3	TS8

注意事项:

1. 切勿在火旁使用胶水、油漆和溶剂, 应保持室内通风。
2. 由于某些零件比较细小, 切勿让3岁以下儿童接触, 禁止将此模型放入儿童口中。
3. 切勿让婴儿与儿童接触到塑料包装袋, 以避免窒息。
4. 本产品只适用于14岁以上人群使用。

CAUTION:

1. Do not use glue or paint near open flame. keep the window open. Maintain adequate air ventilation.
2. Keep out of the reach of children under 36 months old, as some parts are detachable. Children must not be allowed to suck any part in this kit.
3. Plastic bags can be dangerous. To avoid danger of suffocation, keep this bag away from children.
4. This kit is designed for people 14 and up.

制造商: 东莞市讯通发展有限公司

Manufacturer: Xuntong Development Co., Ltd.

地址: 广东省东莞市莞太大道5号讯通大厦

Address: Xuntong Building, 5 Guantai Road, Dongguan City, Guangdong Province

Tel: +86+769+22493699 Fax: +86+769+22469208

Postal code: 523009 E-mail: xtco@163. net

Http: //www. XT model. com. cn