

Clear Prop!

ADVANCED



JOV-1A MOHAWK

1:72
model # CP72016



scale model kit

SPAN: 177,8 mm

LENGTH: 174,3 mm

NUMBER OF PARTS: 305 pcs

- 1** stages of assembly
- ?** optional
- A** variants of assembly
- glue by super glue
- A1** part number
- do not glue
- 1** separate details
- make a hole
- 1** apply decals
- detach with knife
- 1** apply the adhesive mask
- paint
- bend
- repeat the operation N times

Role	Light attack and observation aircraft
National origin	United States
Manufacturer	Grumman
First flight	14 April 1959
Primary users	United States Army, Argentine Army Aviation
Produced	1959–1970
Number built	380

The Grumman OV-1 Mohawk is an armed military observation and attack aircraft that was designed for battlefield surveillance and light strike capabilities. It has a twin turboprop configuration, and carries two crew members in side-by-side seating. The Mohawk was intended to operate from short, unimproved runways in support of United States Army maneuver forces.

The Mohawk began as a joint Army-Marine program through the then-Navy Bureau of Aeronautics (BuAer), for an observation/attack plane that would outperform the Cessna L-19 Bird Dog. In June 1956, the Army issued Type Specification T5145, which called for the development and procurement of a two-seat, twin turboprop aircraft designed to operate from small, unimproved fields under all weather conditions. It would be faster, with greater firepower, and heavier armour than the Bird Dog.

In mid-1961, the first Mohawks to serve with U.S. forces overseas were delivered to the 7th Army at Sandhofen Airfield near Mannheim, Germany.

Over the years, the mission and the aircraft underwent many changes and roughly 380 were built over all variants. Mohawk variants included the JOV-1, OV-1A, OV-1B, the OV-1C, and the OV-1D (SLAR pod and bigger wings), OV-1E, EV-1E and RV-1E.

REQUIRED PAINTS

- | | | | | | | | | |
|---|---|--|--|--|---|--|---|--|
| A | B | C | D | E | F | G | H | I |
| MR. COLOR 38
A.MIG-0925
OLIVE DRAB (DARK) | MR. COLOR 12
A.MIG-0237
OLIVE DRAB (FADED) | MR. COLOR 33
A.MIG-0046
BLACK MATT | MR. COLOR 62
A.MIG-0050
MATT WHITE | MR. COLOR 327
A.MIG-0121
BLOOD RED | MR. COLOR 301
A.MIG-0908
GREY BASE | MR. COLOR 55
A.MIG-0056
GREEN KHAKI | MR. COLOR 137
A.MIG-0033
RUBBER & TIRES | MR. COLOR 211
A.MIG-0192
POLISHED METAL METALLIC |
| J | K | L | M | N | O | P | R | |
| MR. COLOR 47
A.MIG-0093
RED CRYSTAL | MR. COLOR 61
A.MIG-0187
EXHAUST BURNT IRON METALLIC | MR. COLOR 317
A.MIG-0205
GULL GREY | MR. COLOR 329
A.MIG-0125
GOLD YELLOW | MR. COLOR 4
A.MIG-0048
YELLOW | MR. COLOR 340
A.MIG-0004
ARMY GREEN | MR. COLOR 138
A.MIG-0092
GREEN CRYSTAL | MR. COLOR MC218
A.MIG-0194
ALUMINIUM | AMMO
by MIG Jimenez |

THIS MODEL IS PRODUCED FOR EXPERIENCED MODELERS OVER 14 YEARS

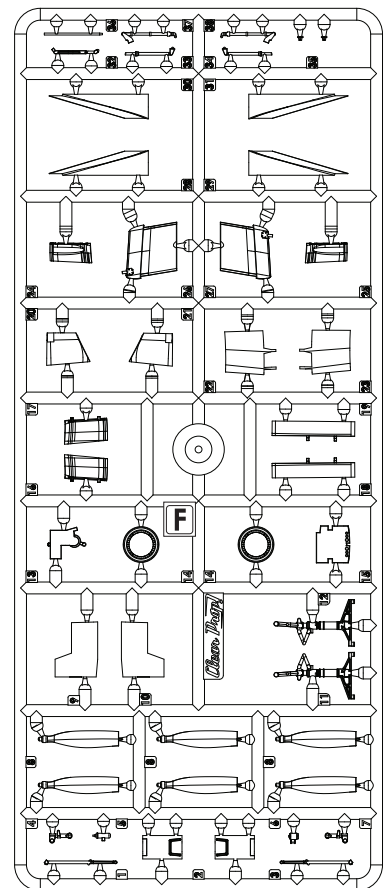
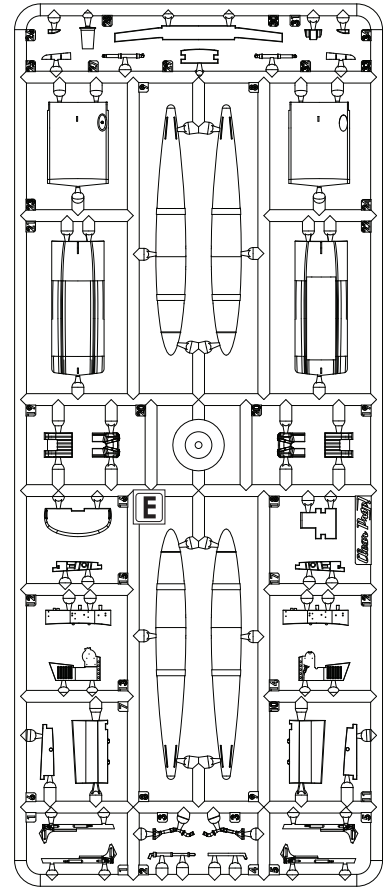
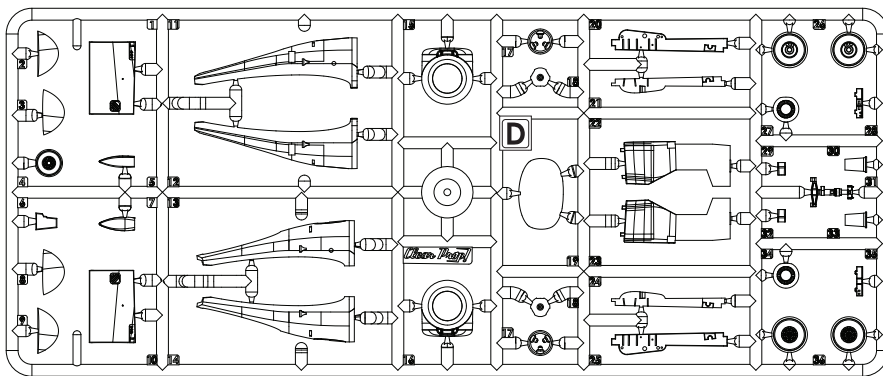
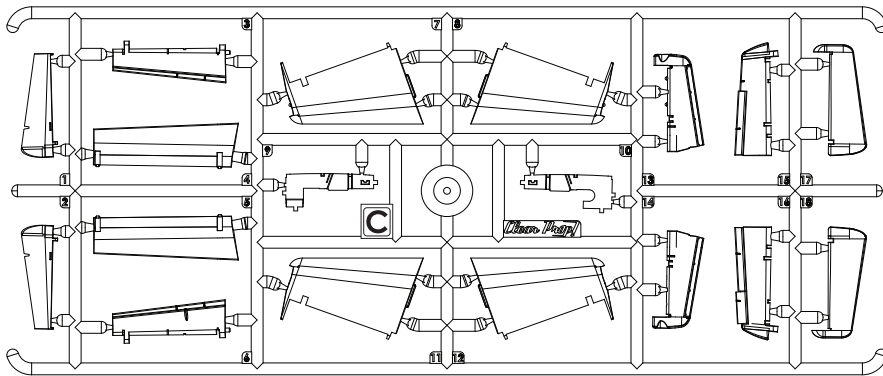
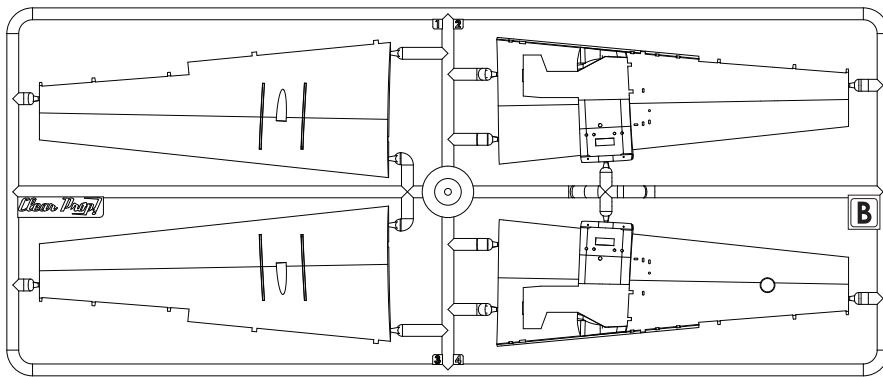
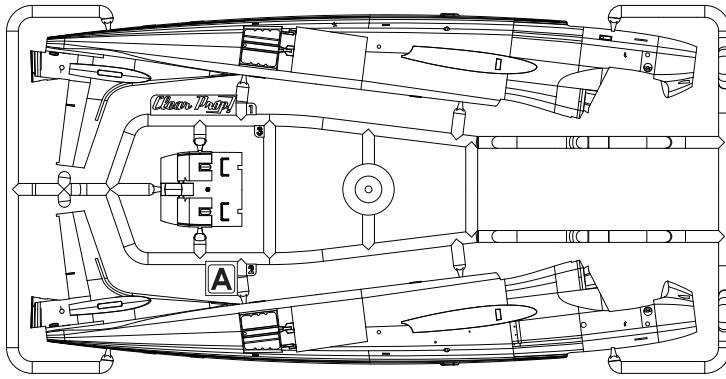

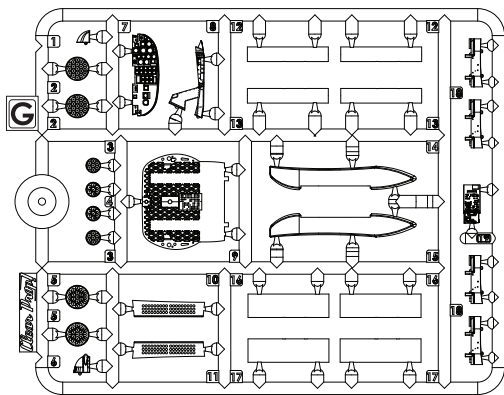

VARIANTS OF ASSEMBLY

A

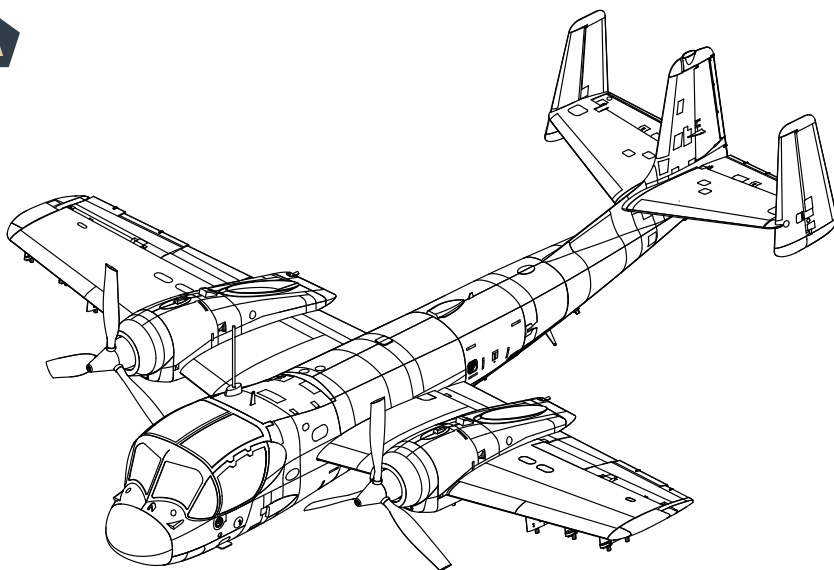

B

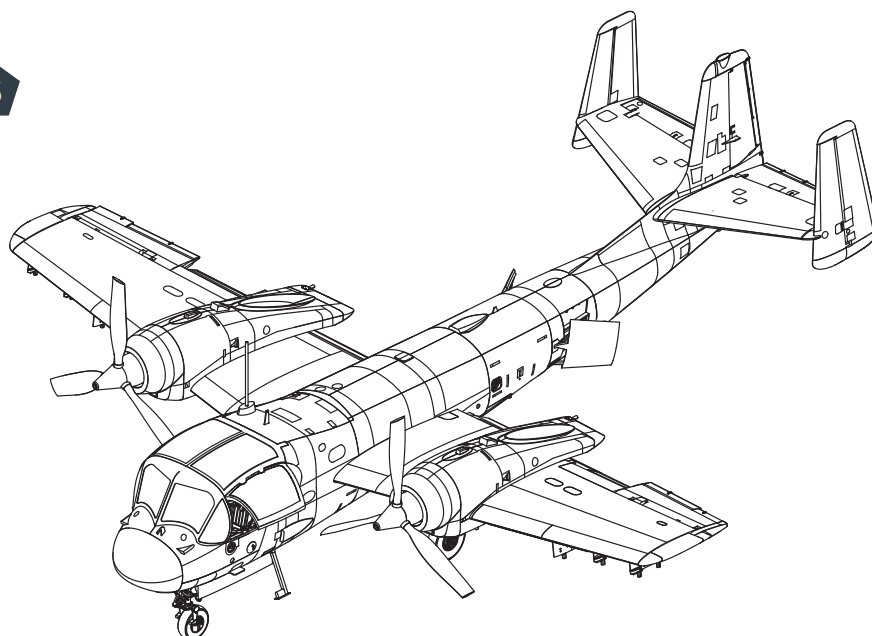

DECAL SHEETS

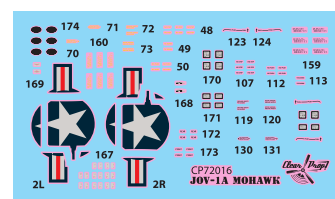
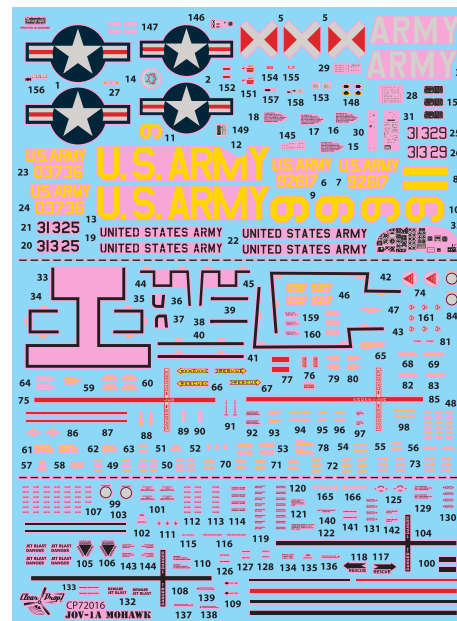

PHOTOETCHED PARTS



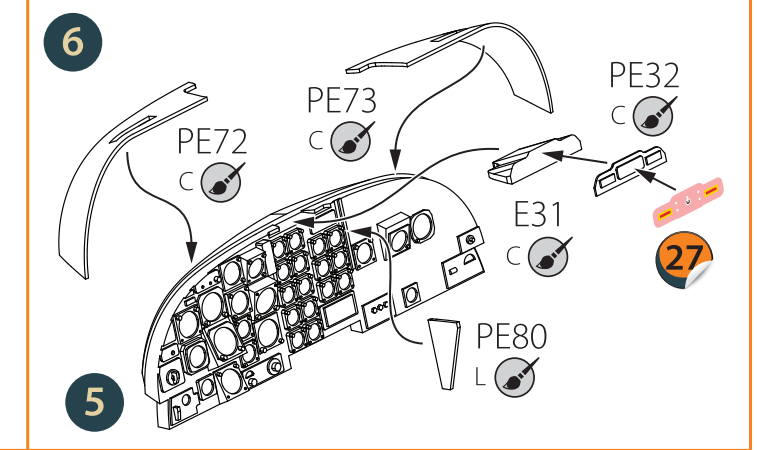
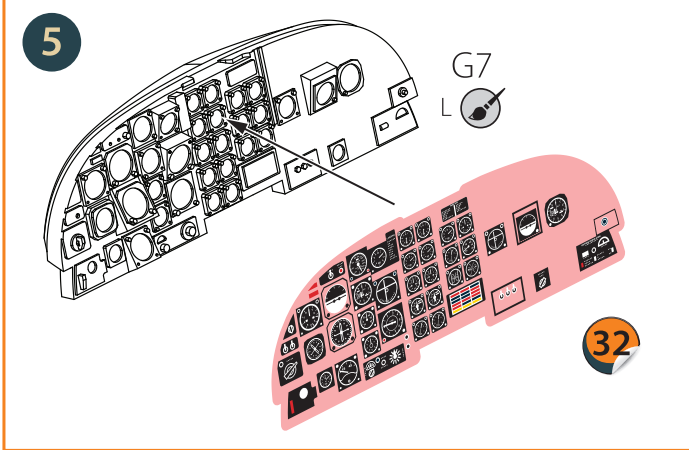
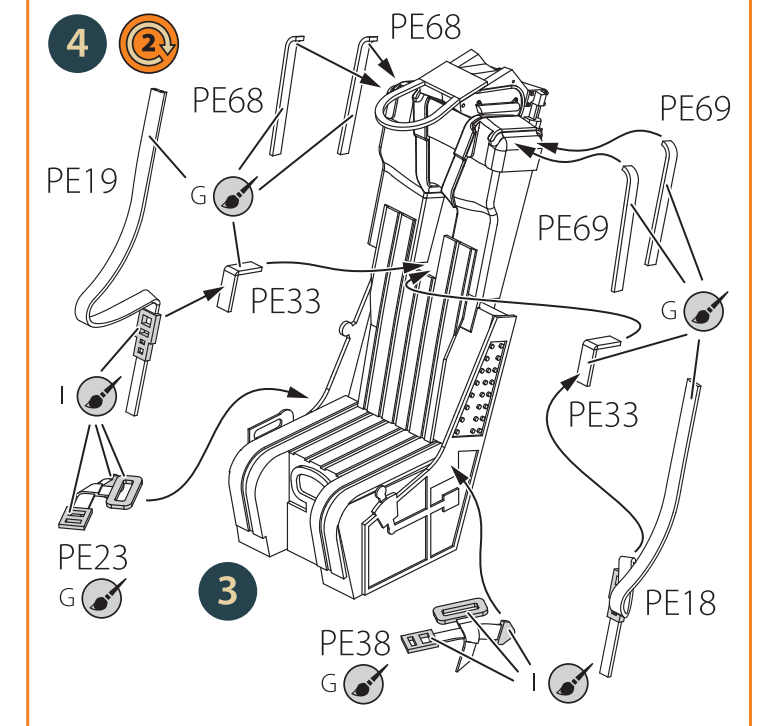
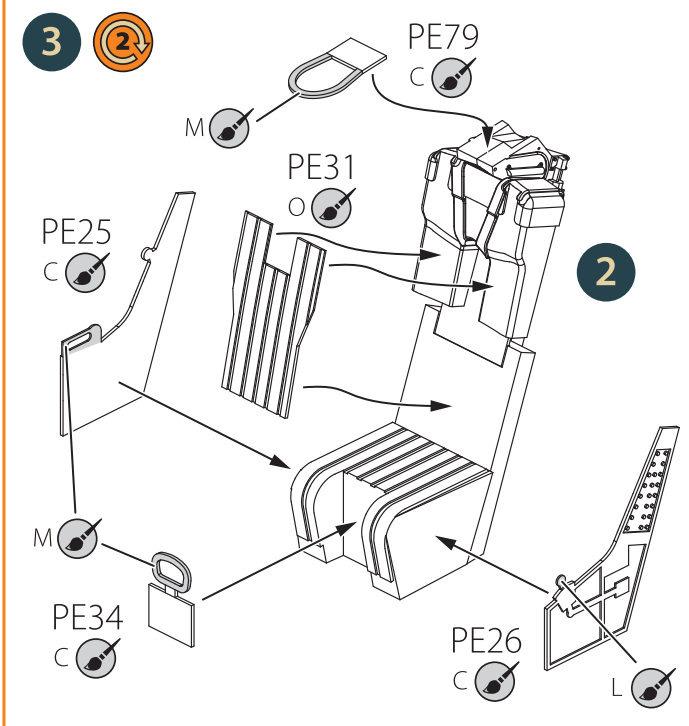
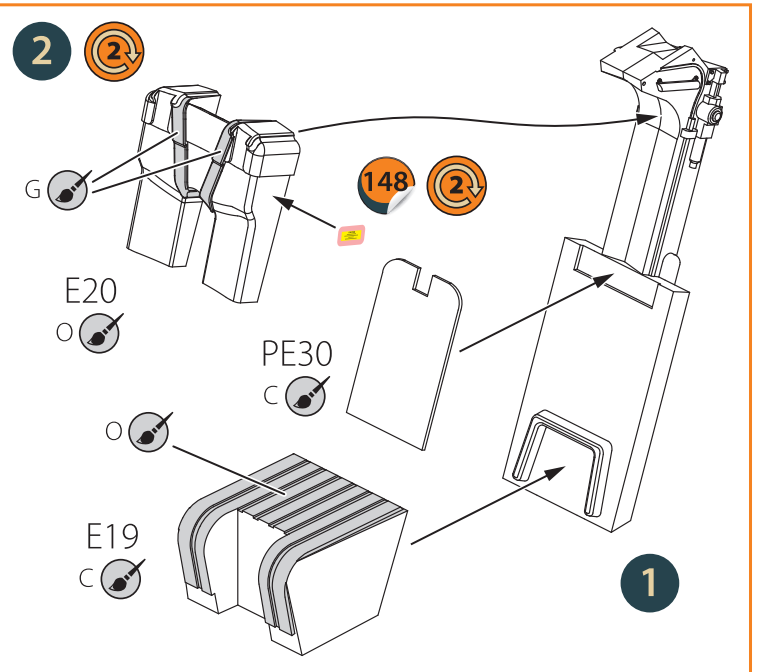
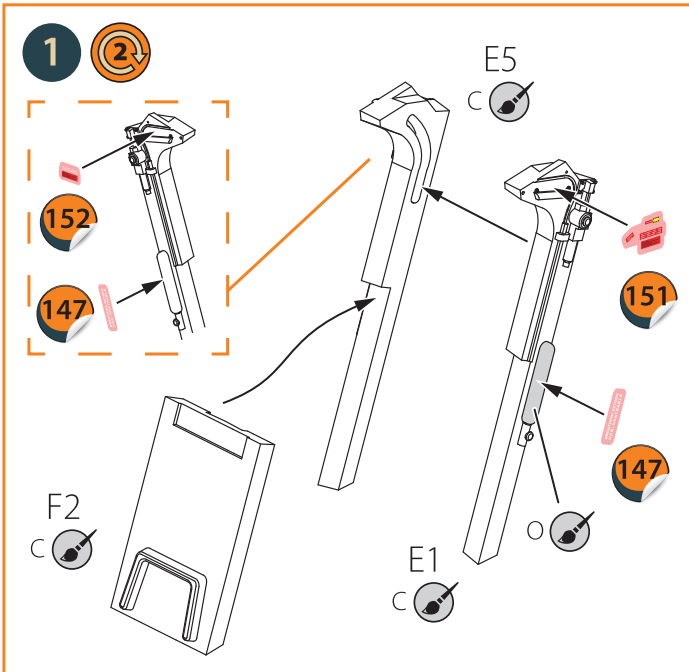

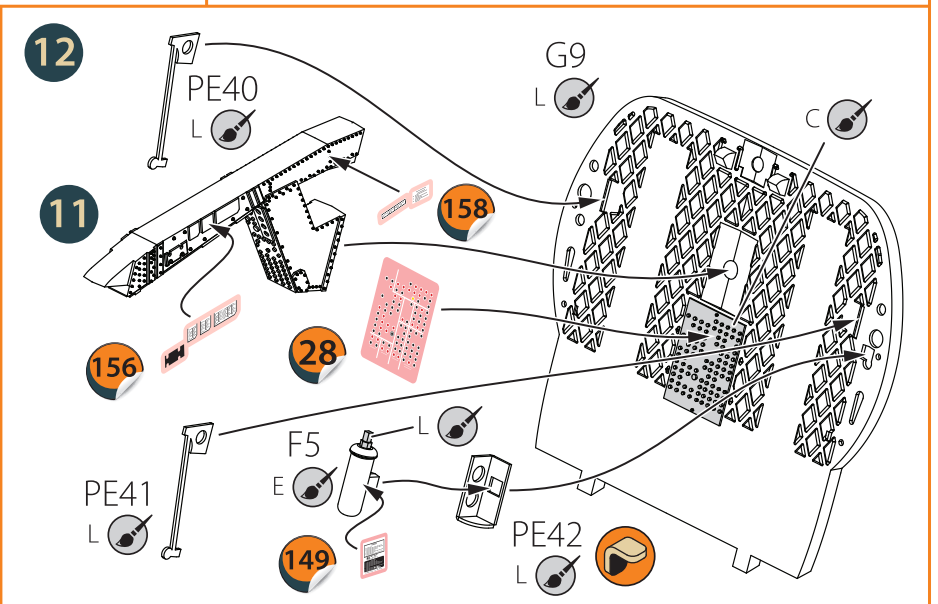
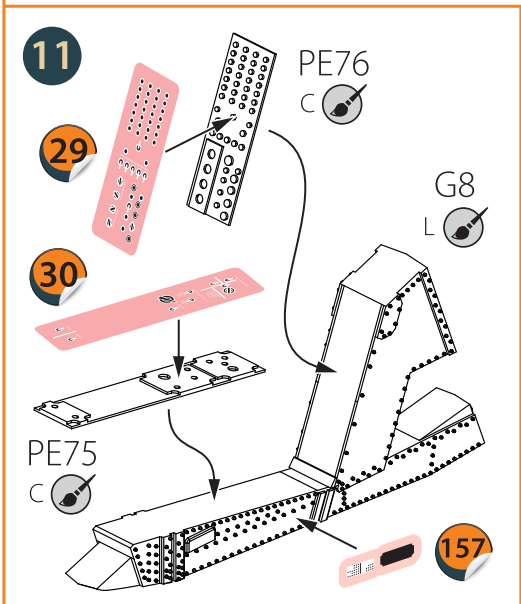
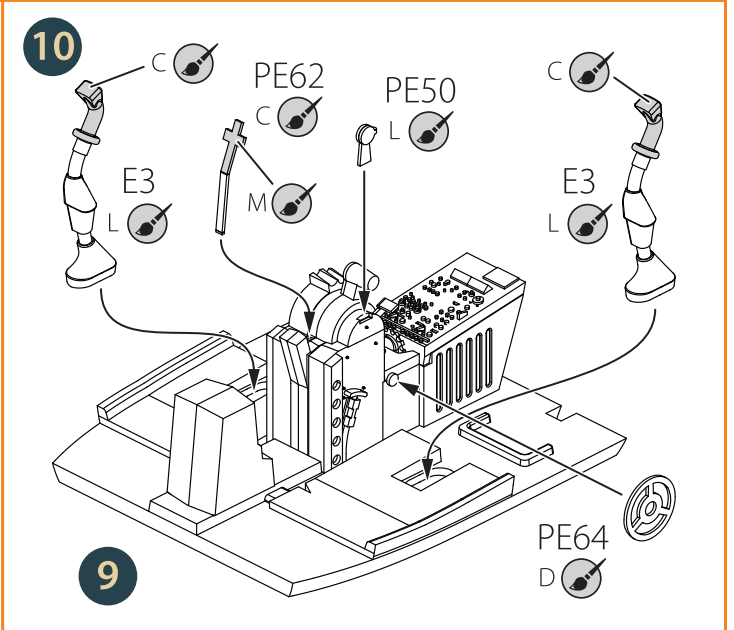
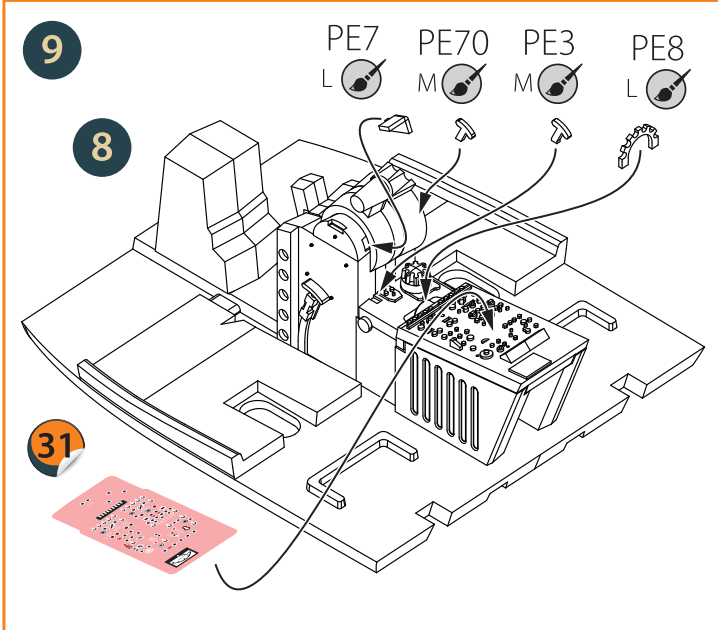
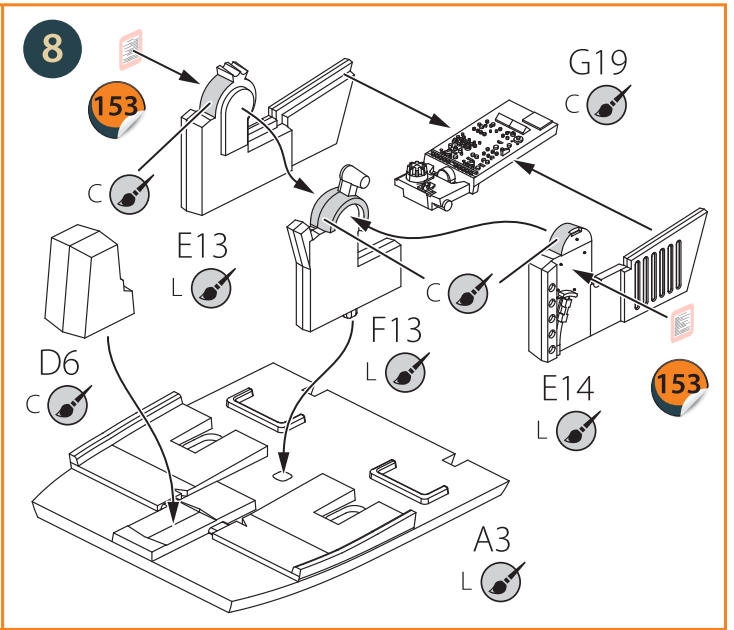
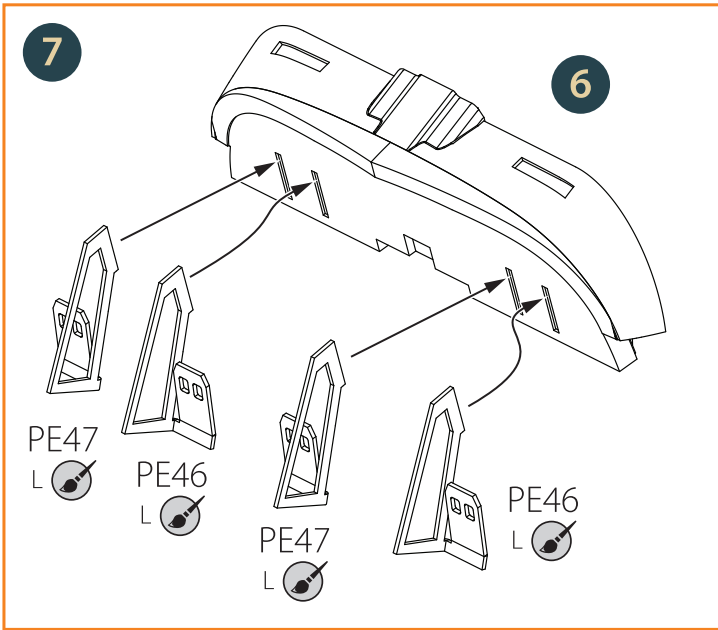

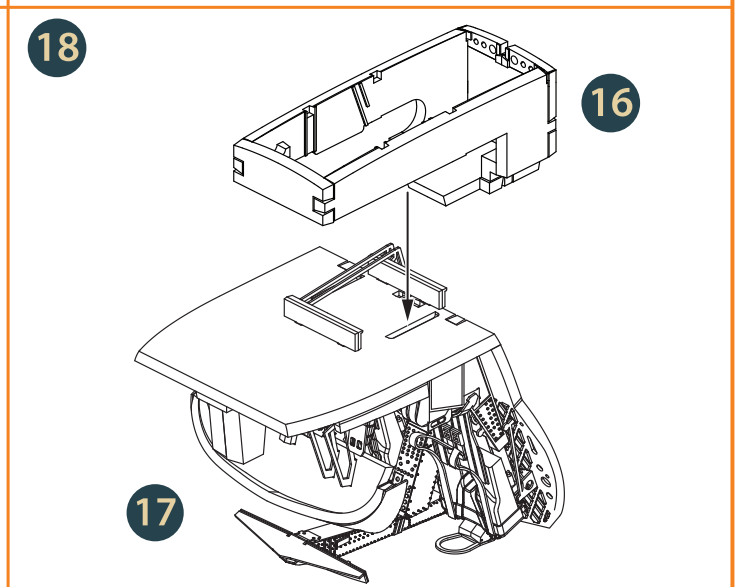
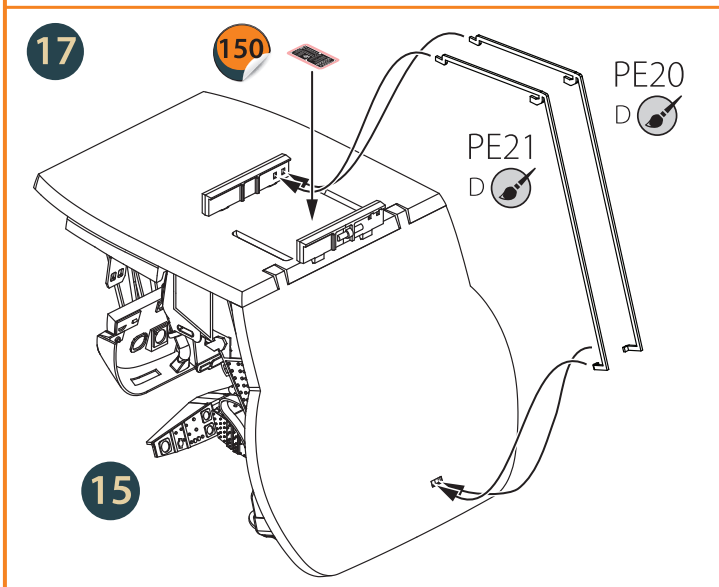
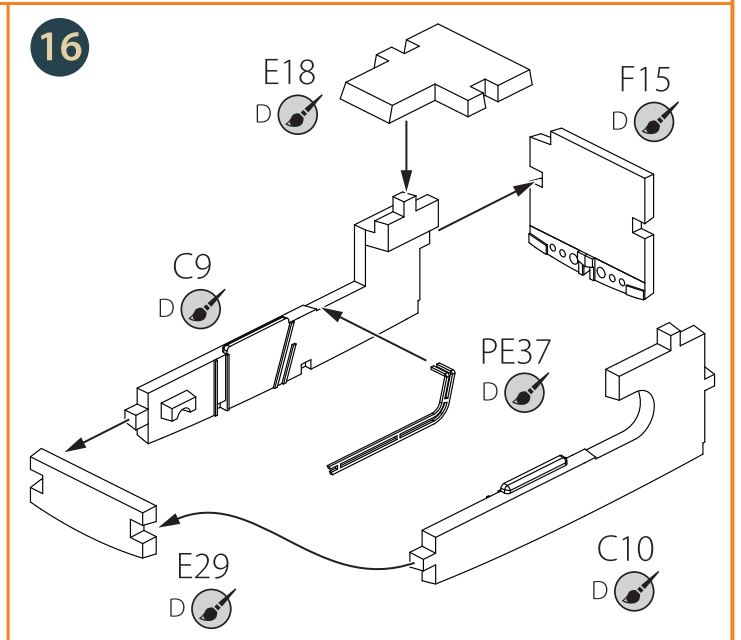
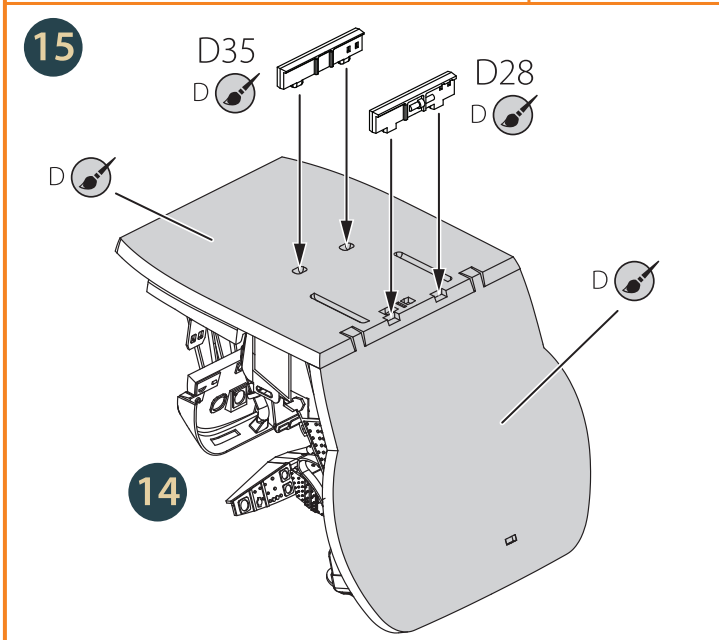
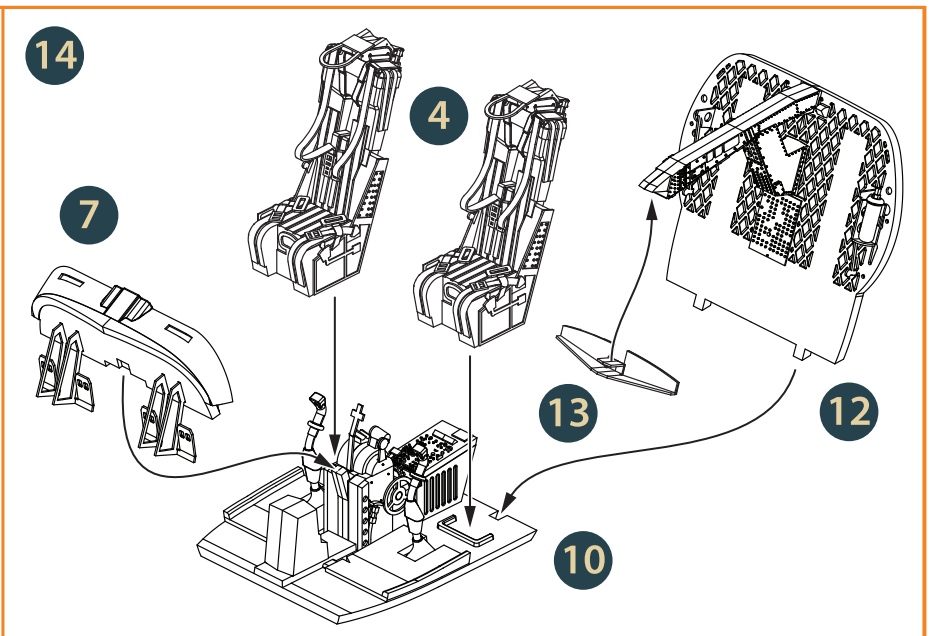
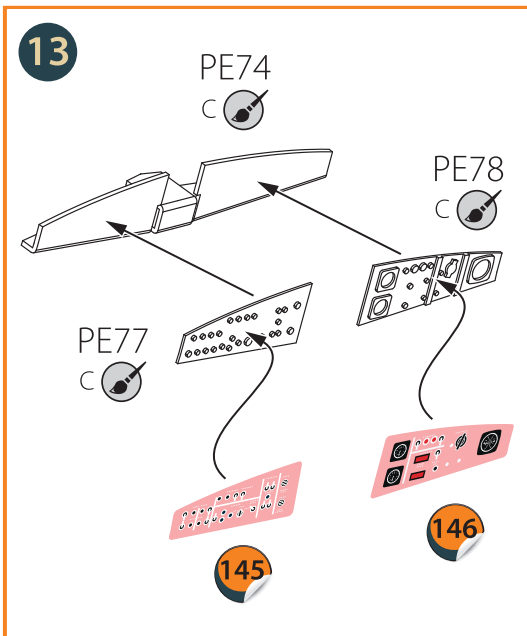

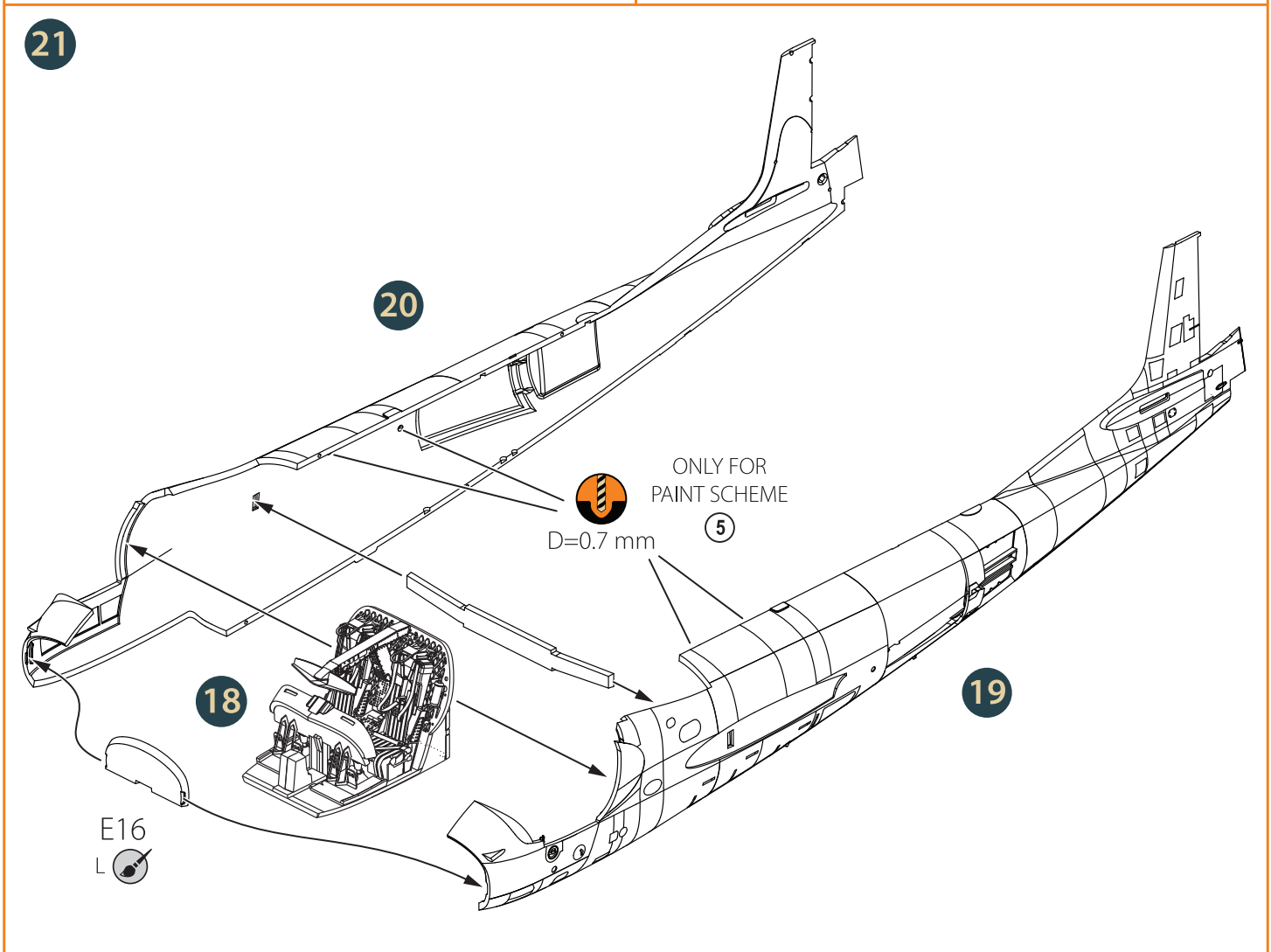
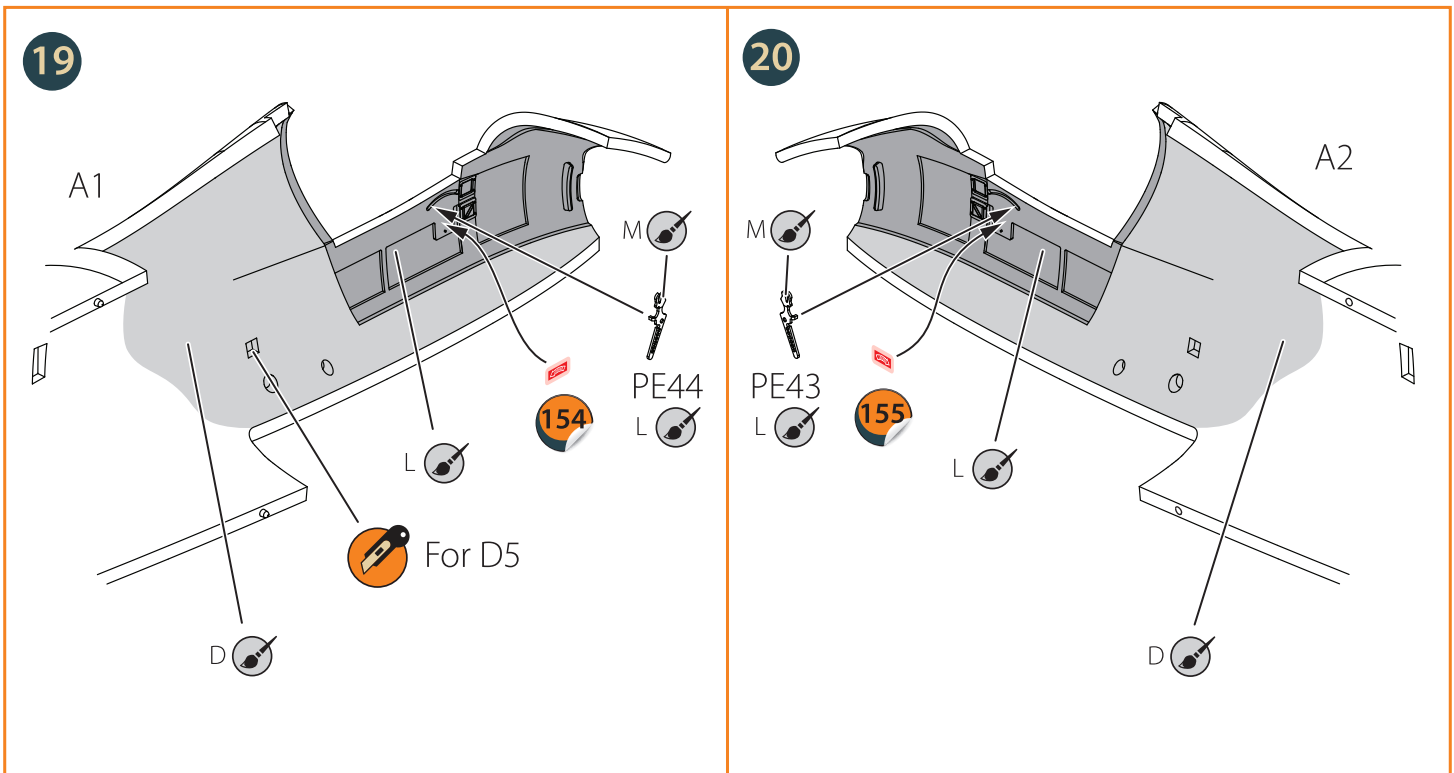

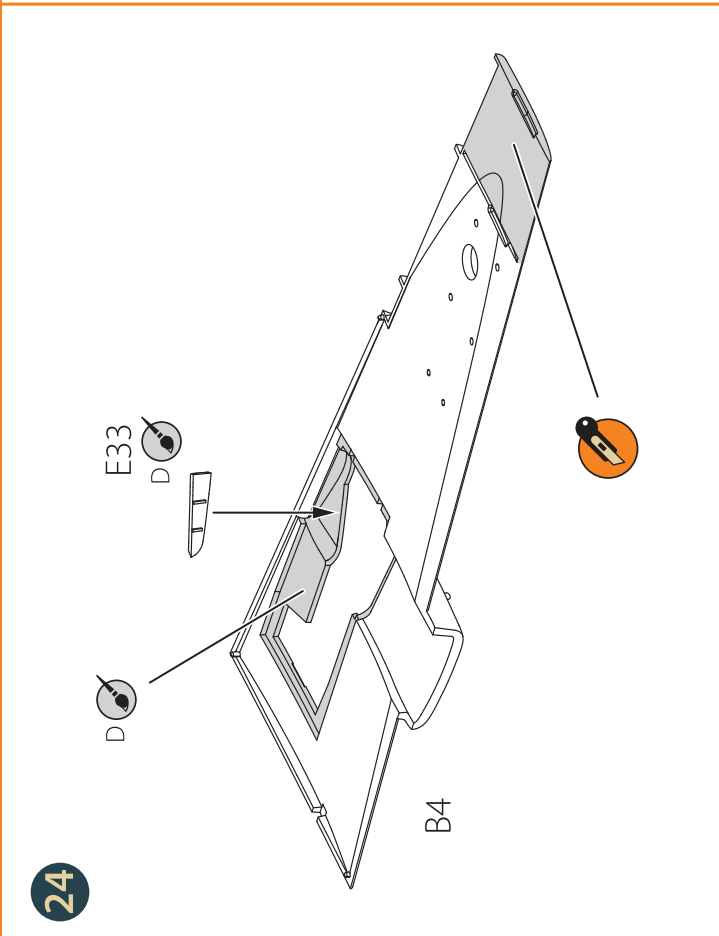
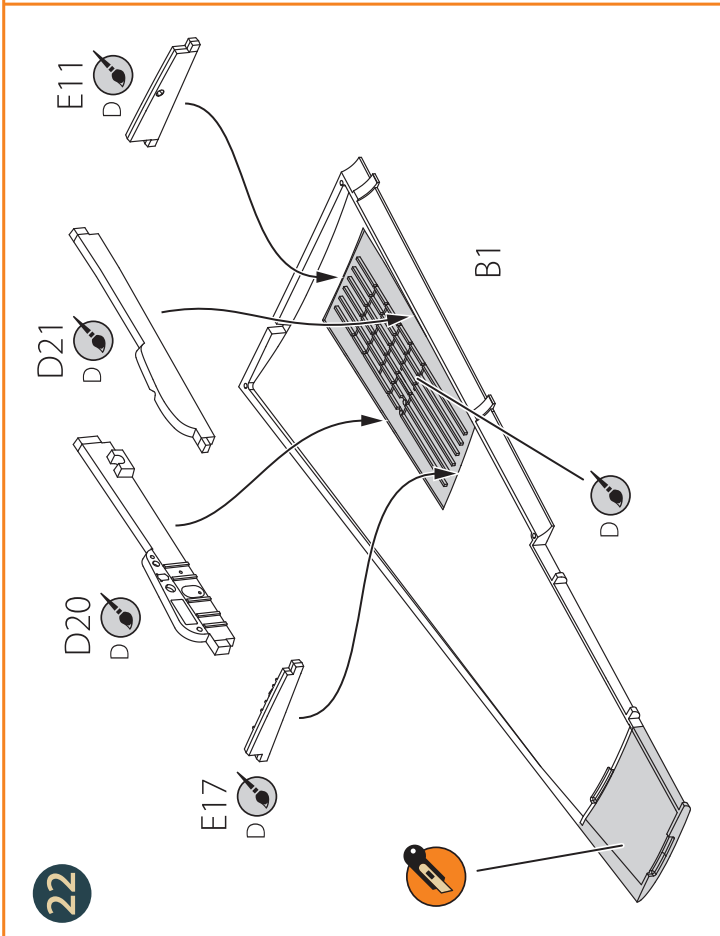
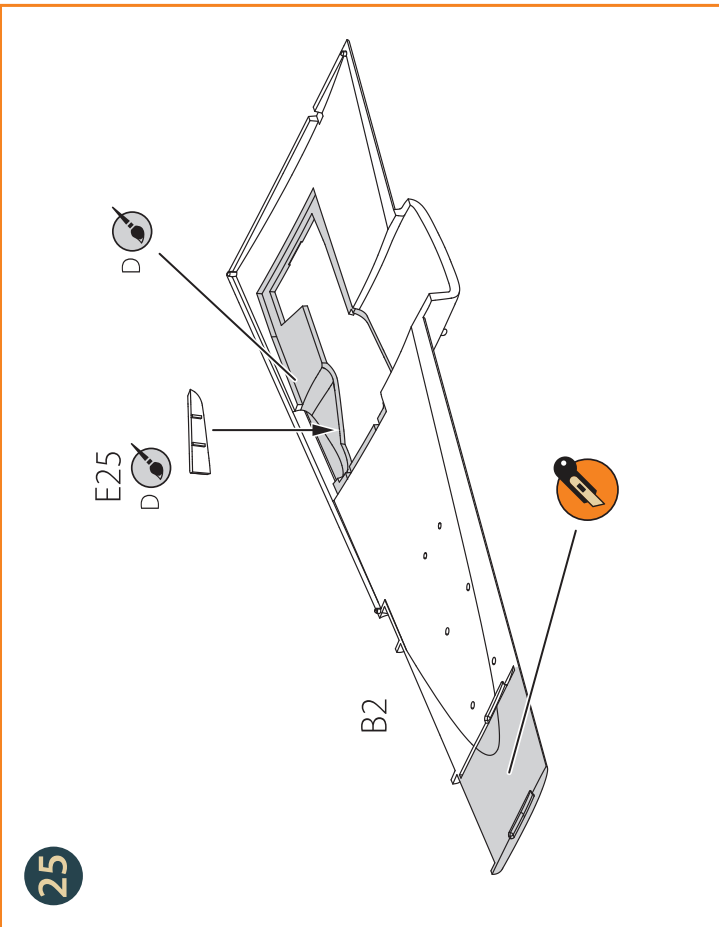
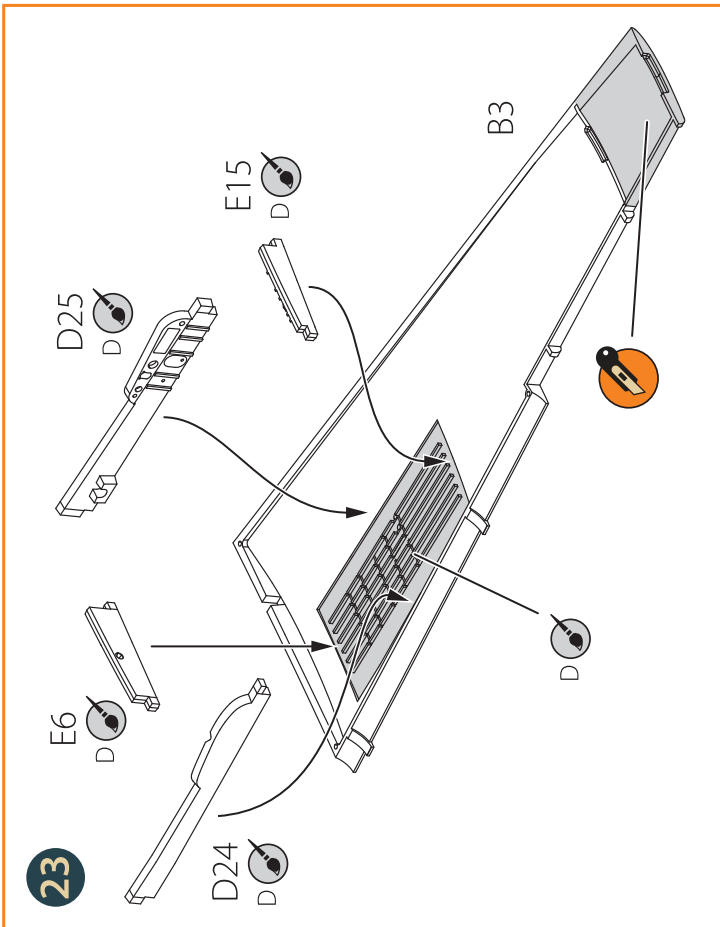

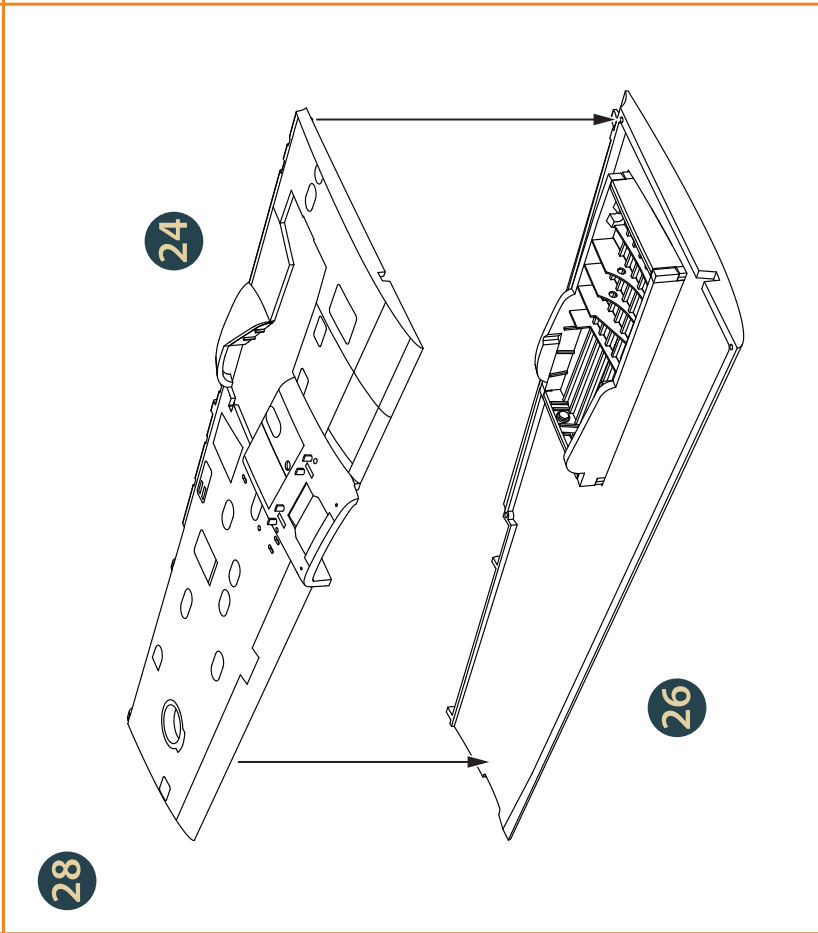
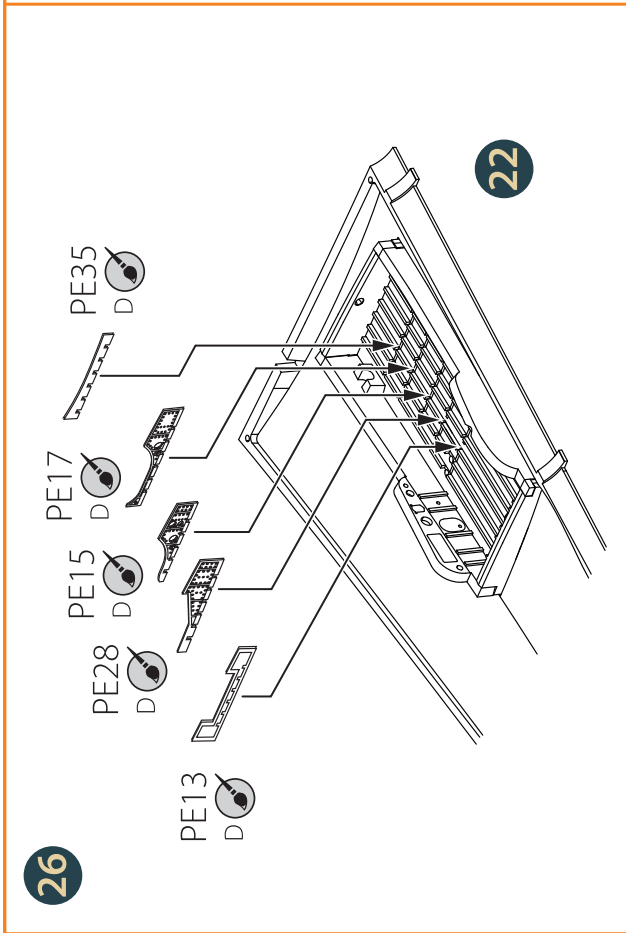
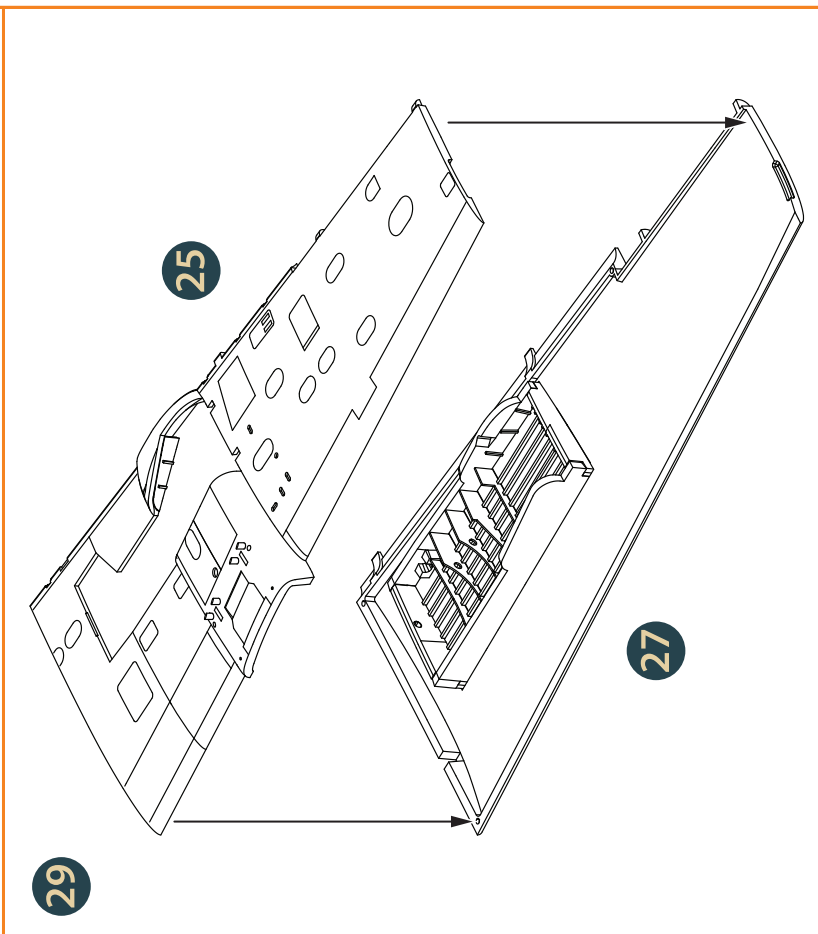
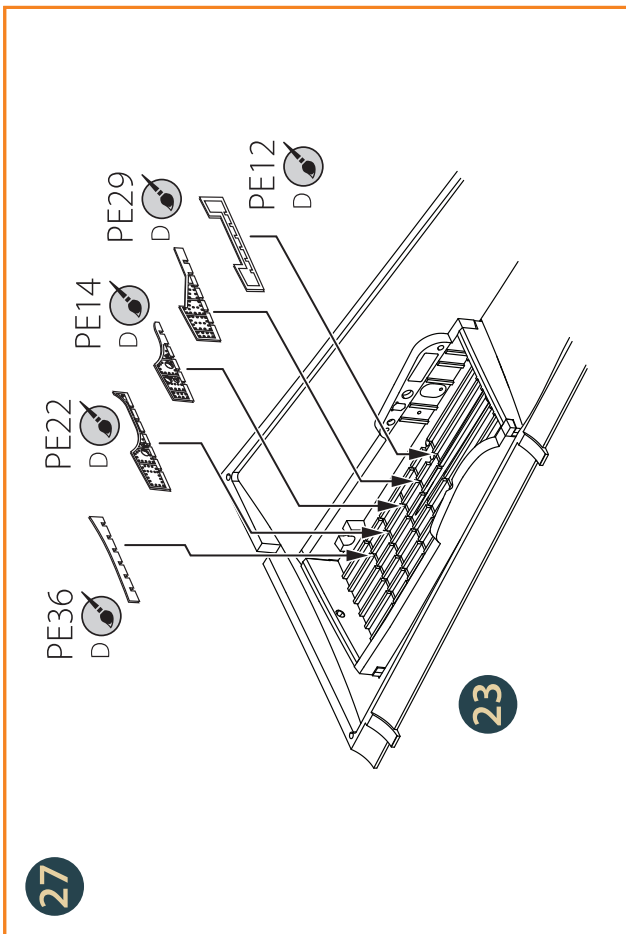

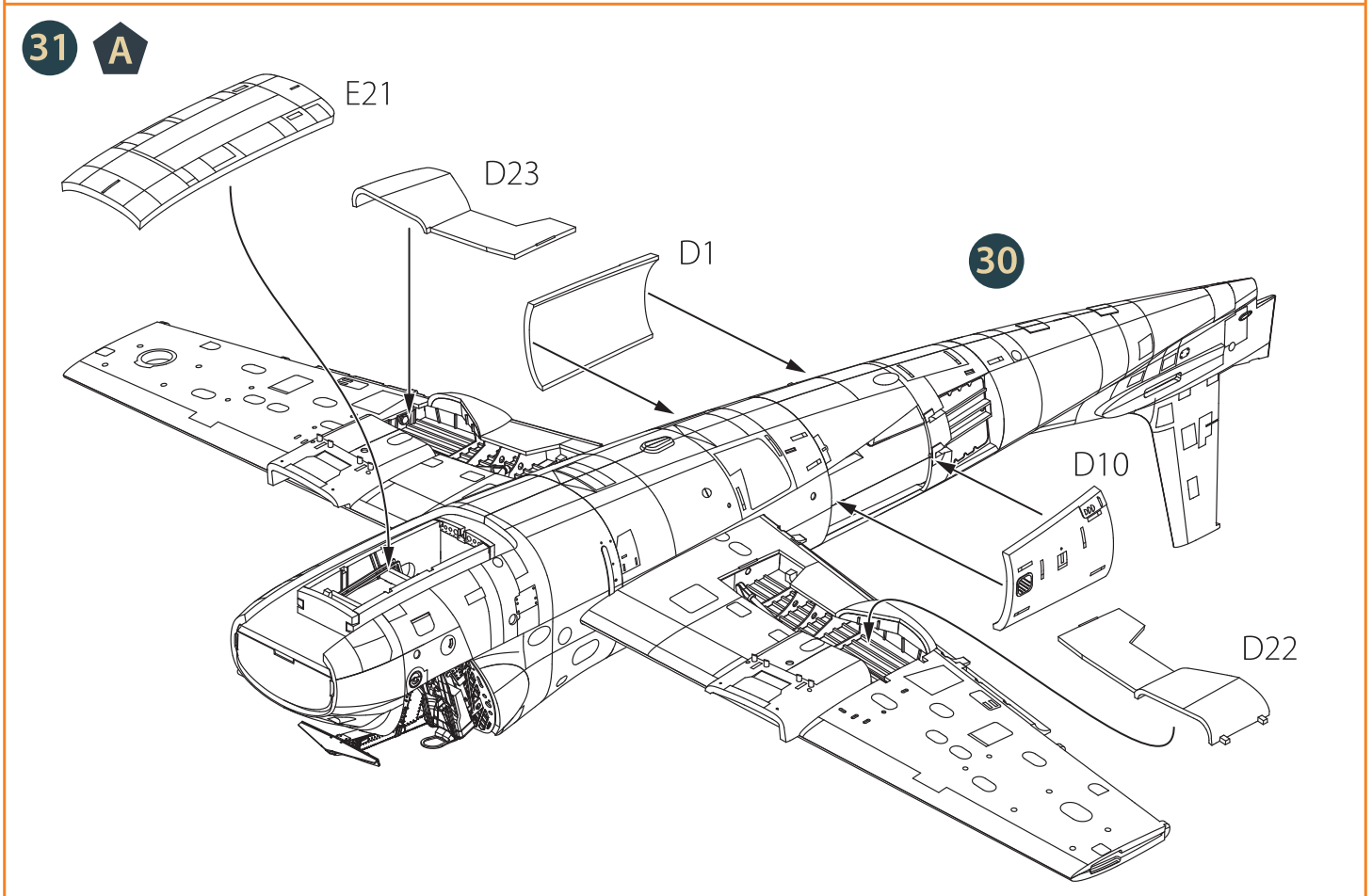
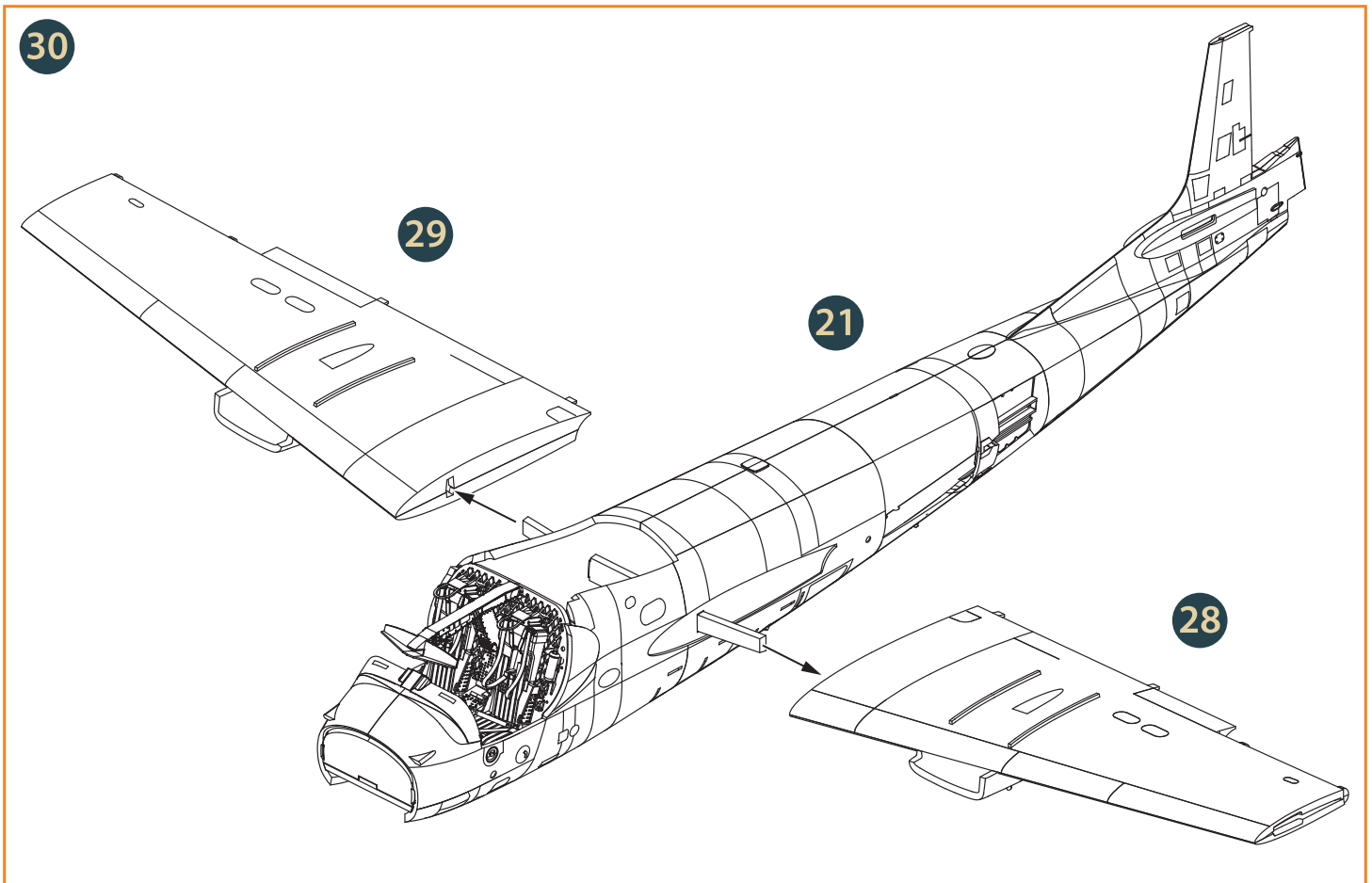

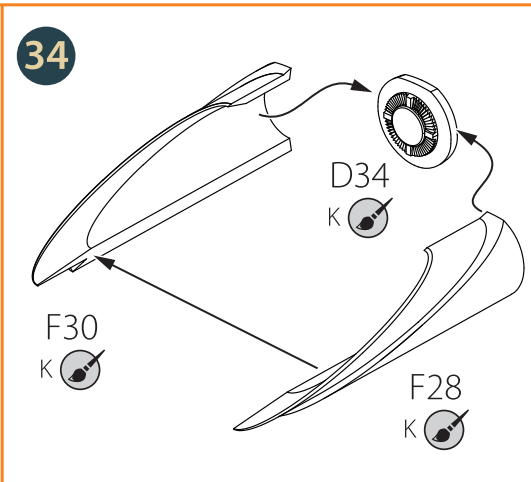
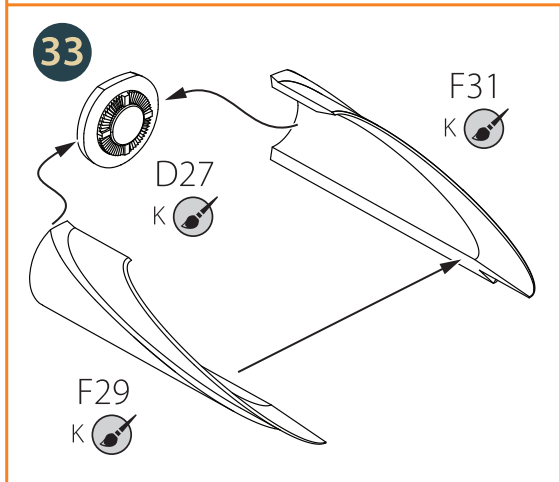
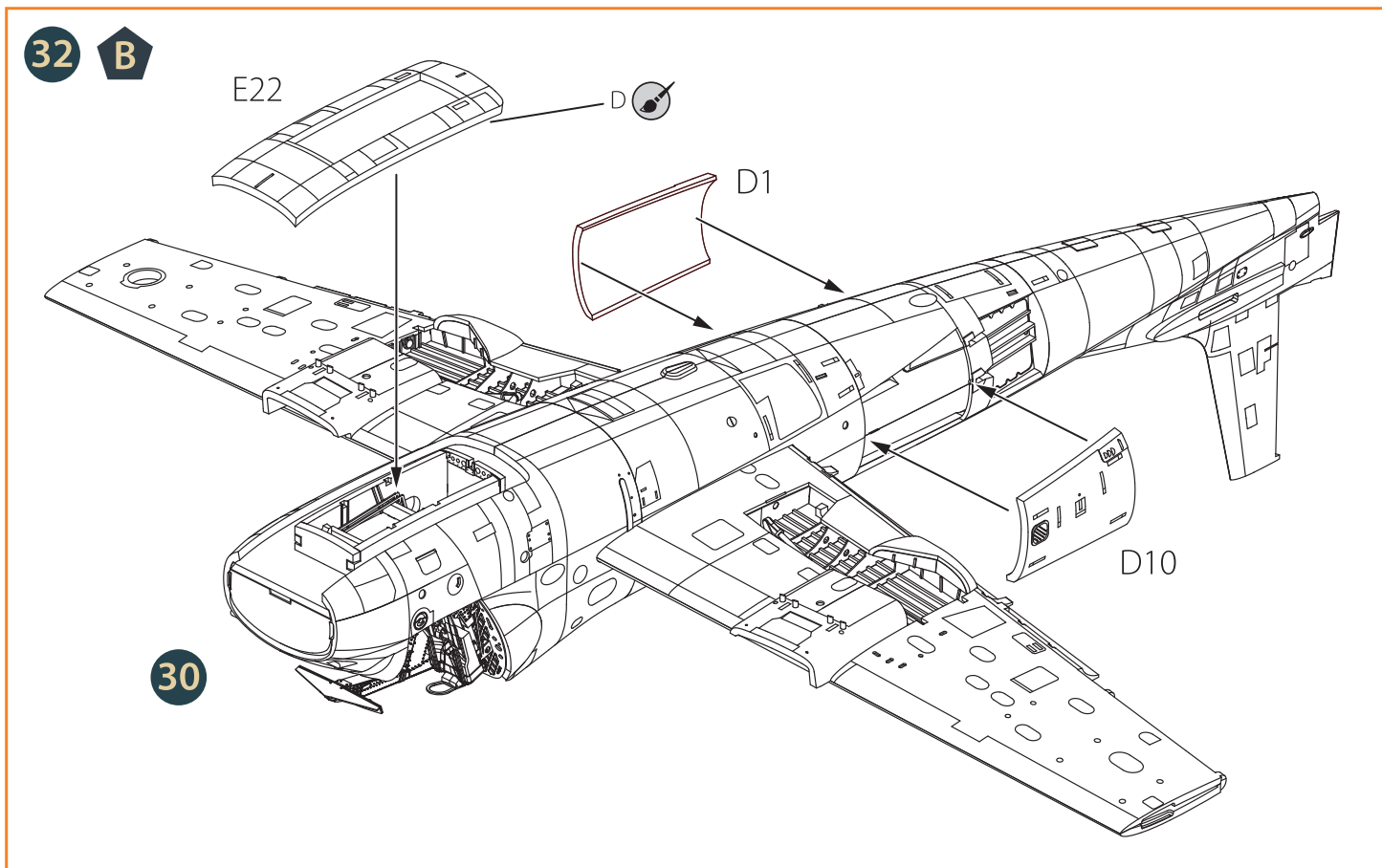

CORRECT POSITION OF
ENGINE'S TURBINE
IN EXHAUST

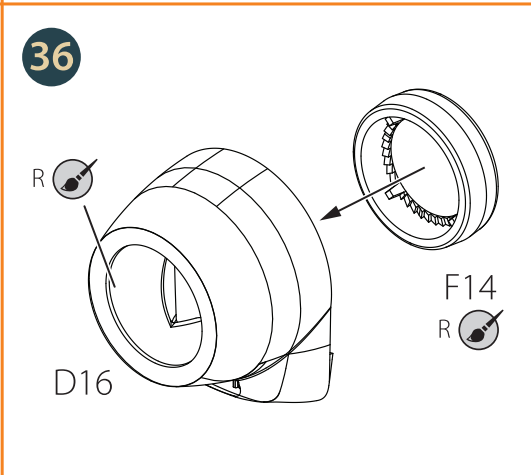
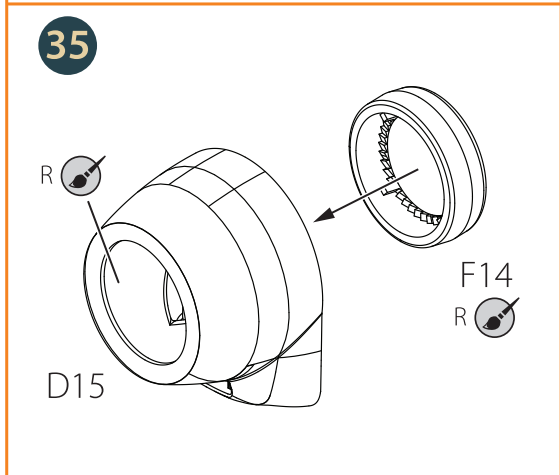
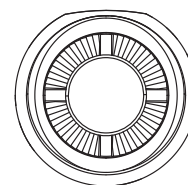

CORRECT POSITION OF
ENGINE'S COMPRESSOR
IN AIR INTAKE

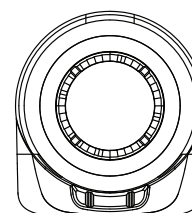

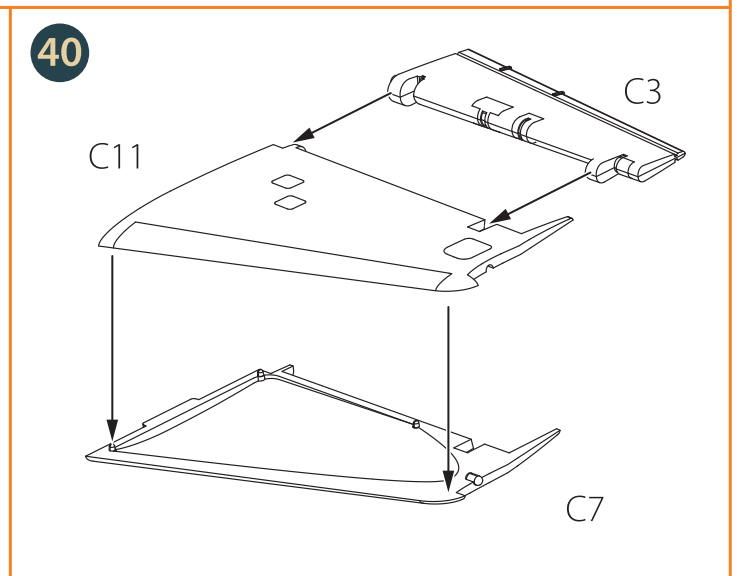
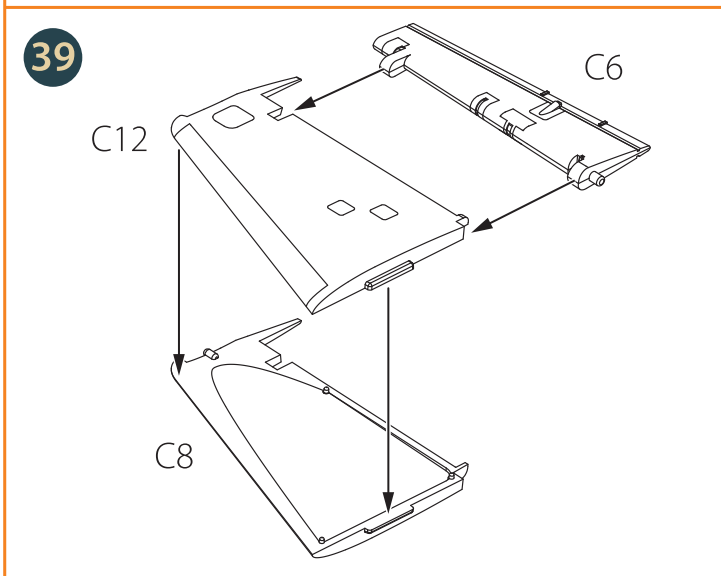
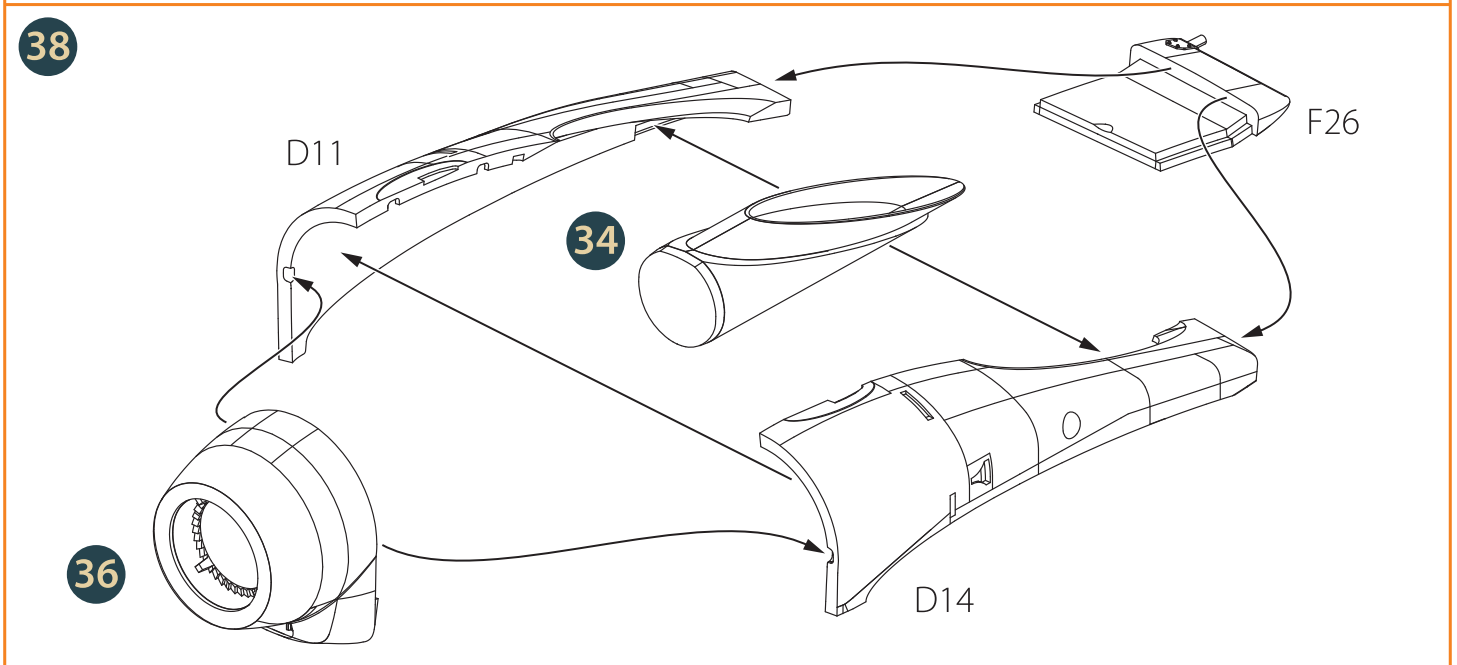
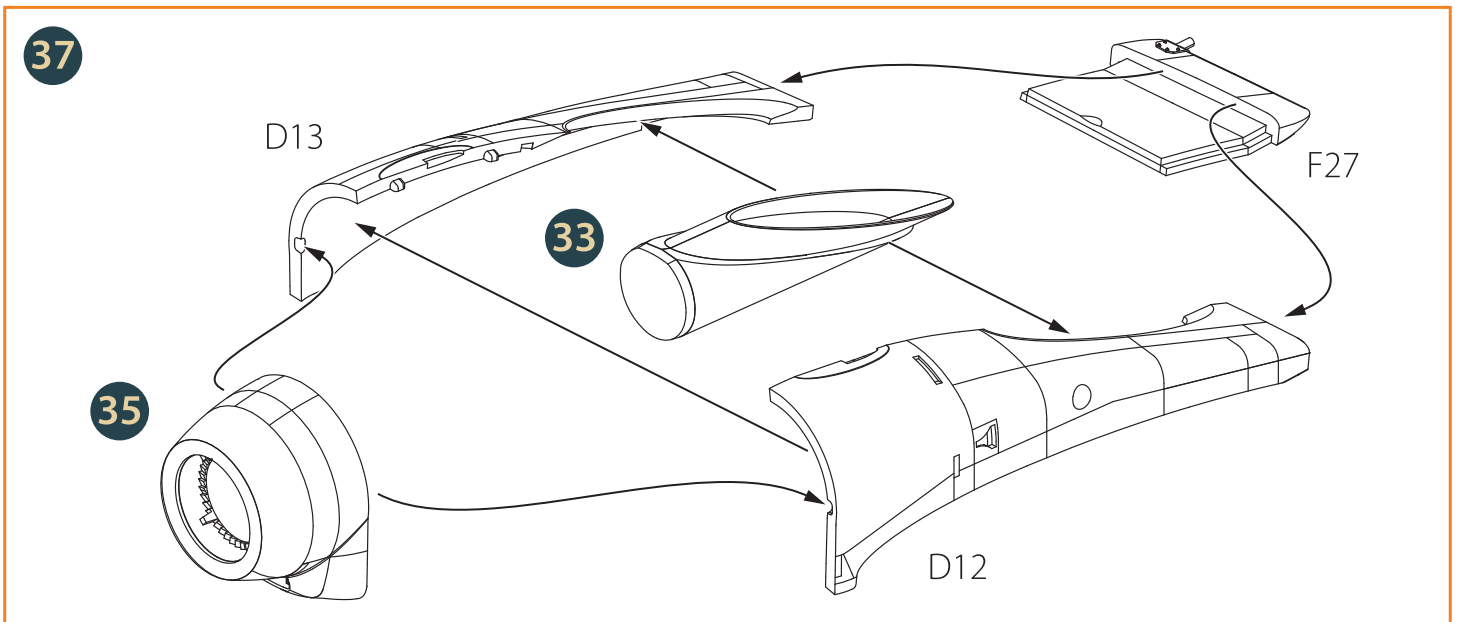

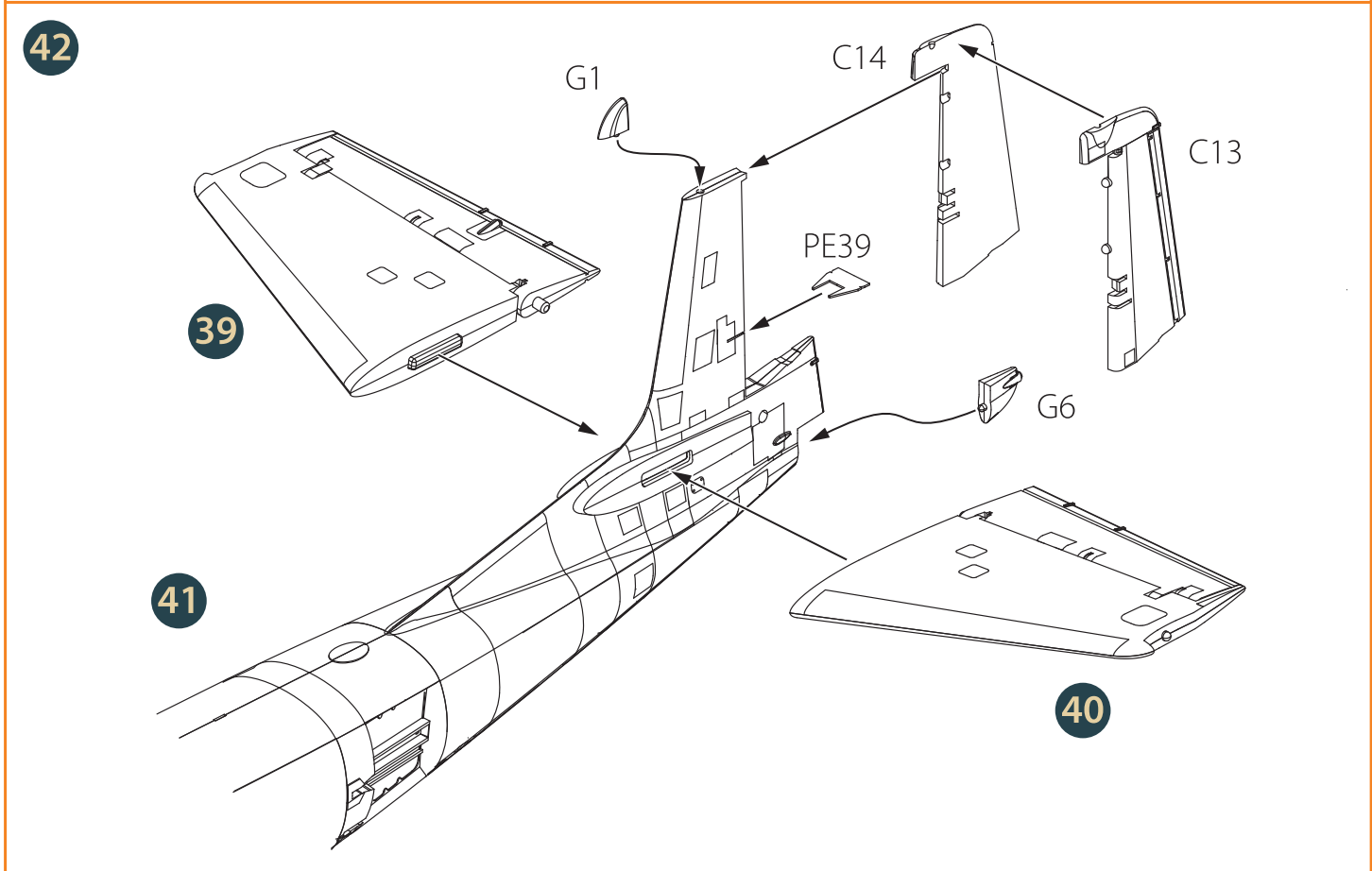
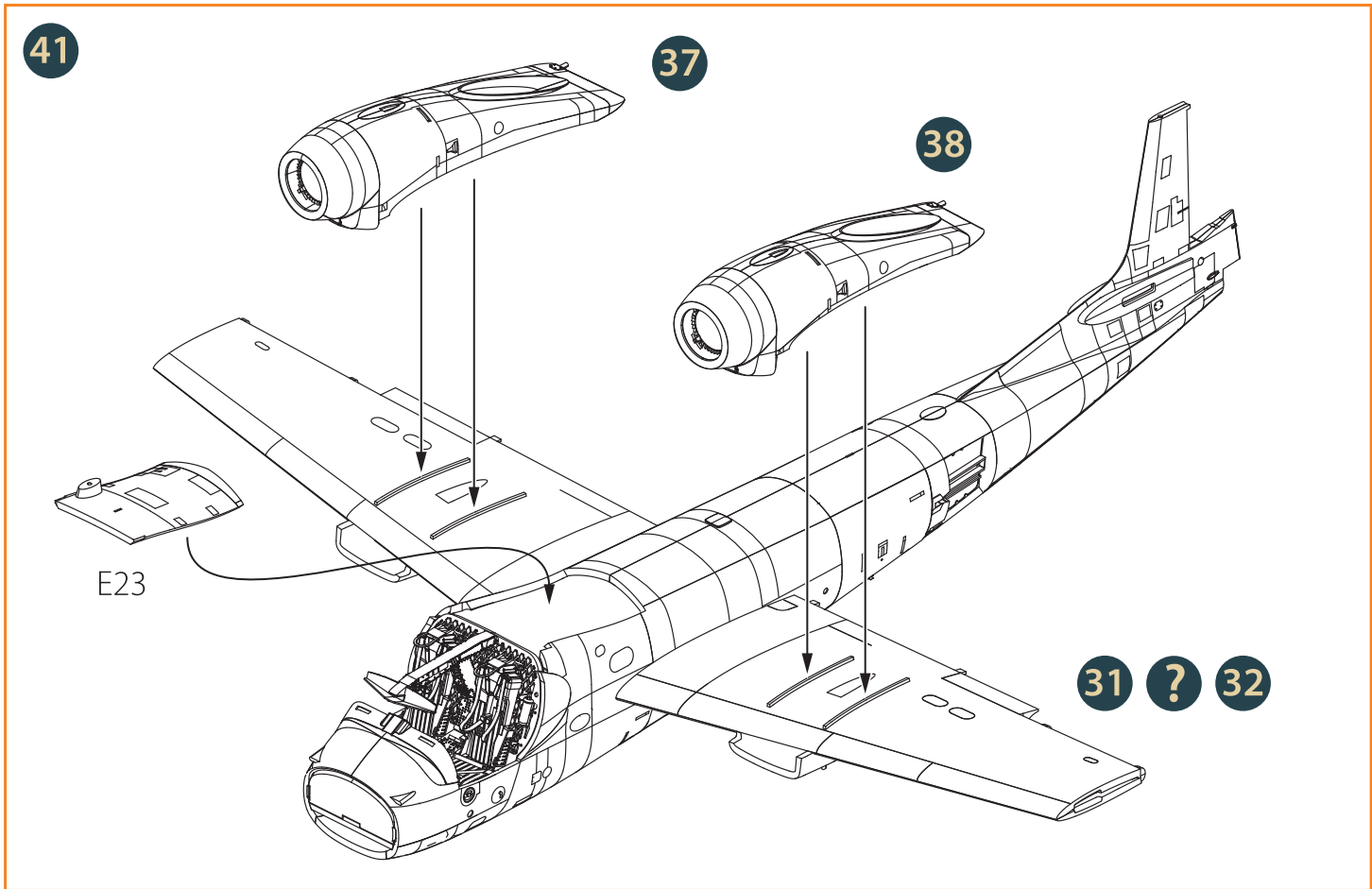

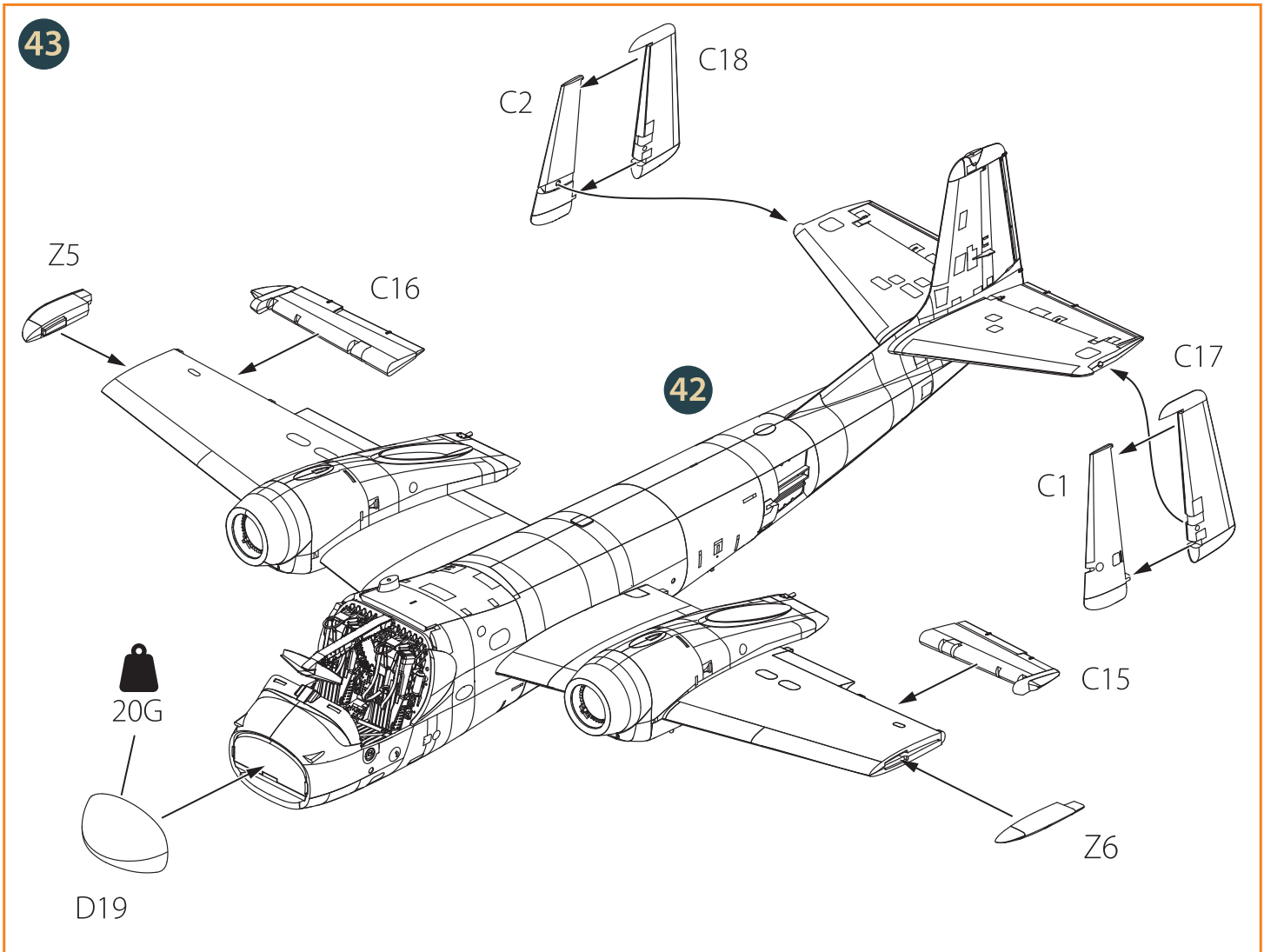

CORRECT POSITION OF STABILIZERS AND TAIL FINS

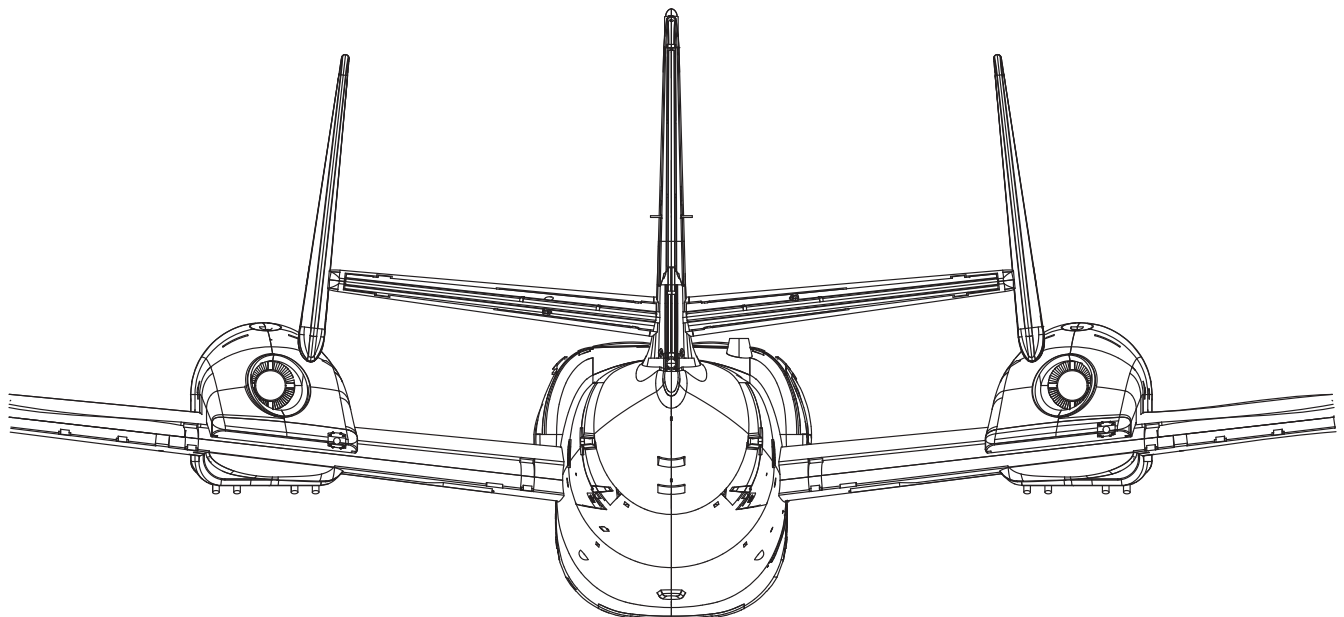

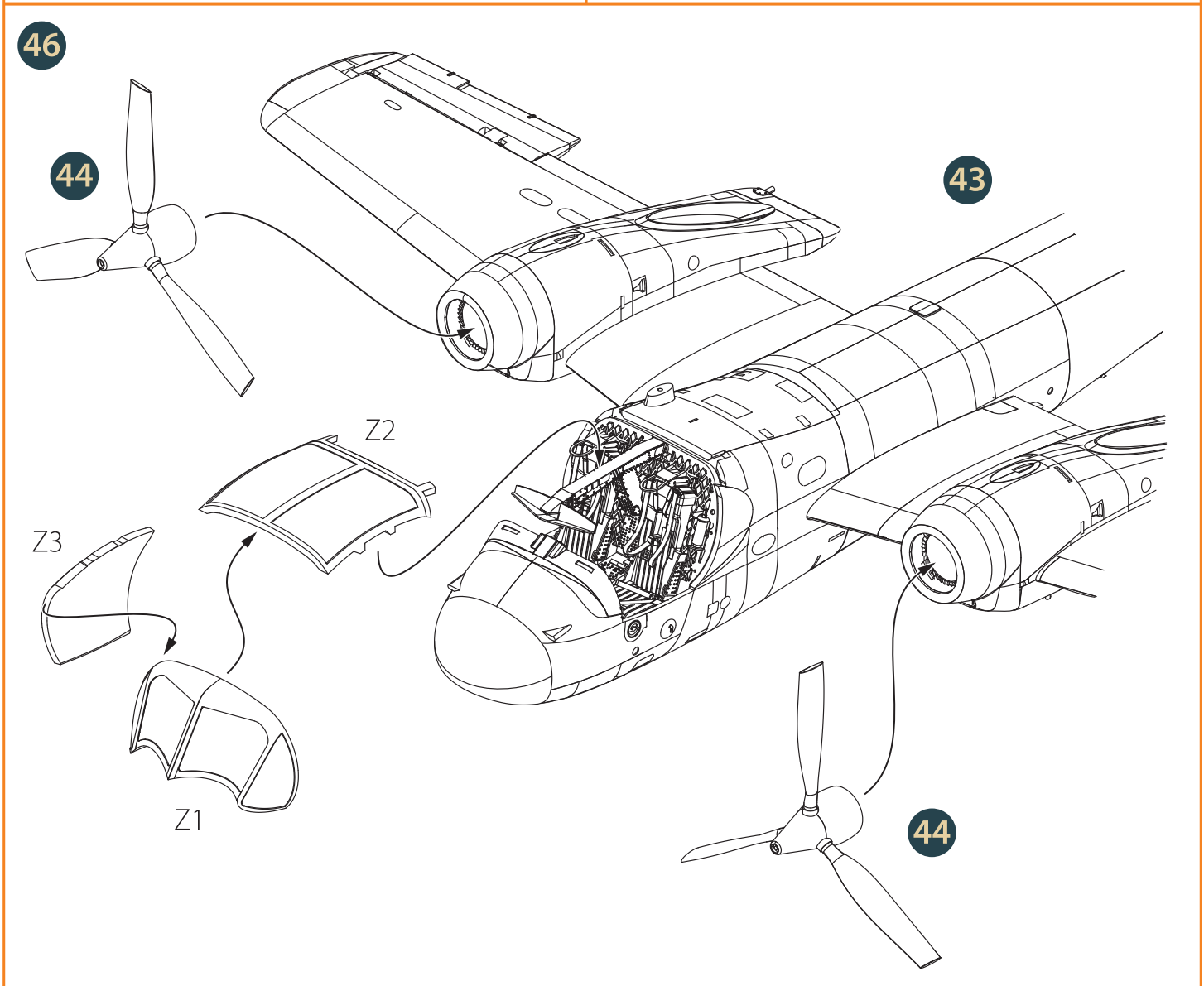
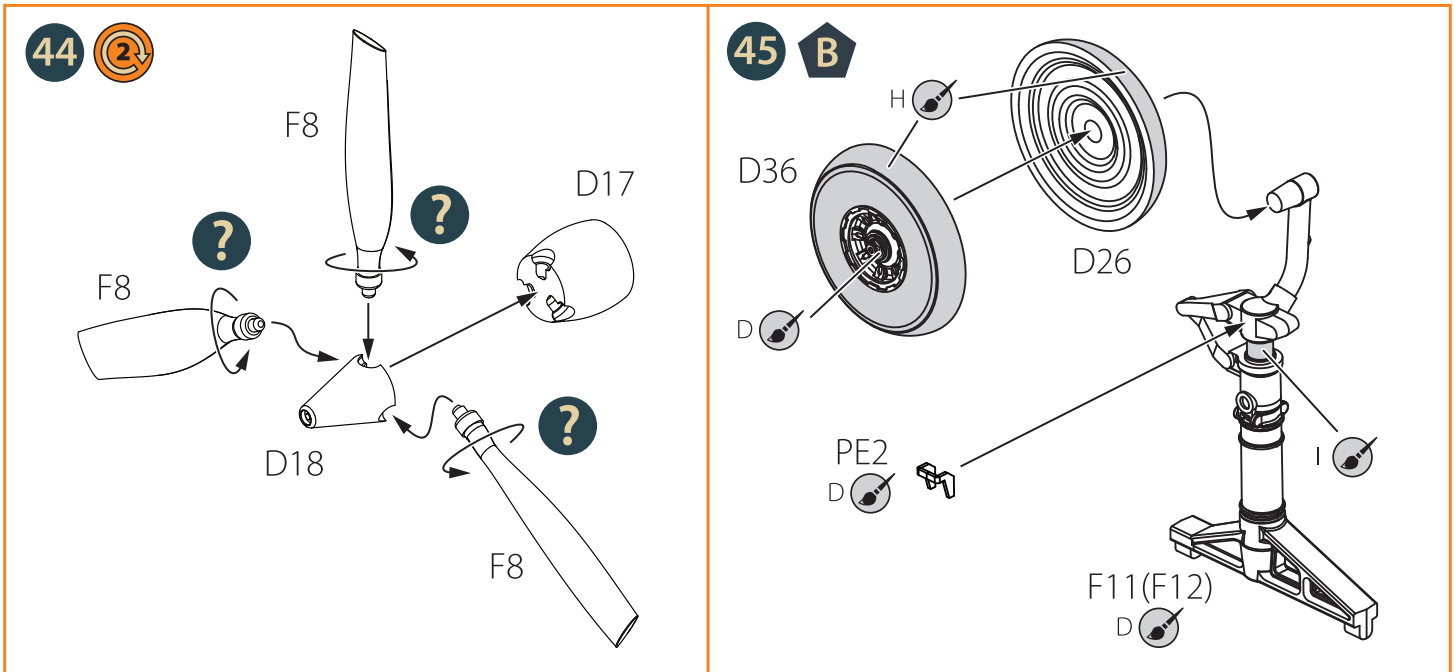

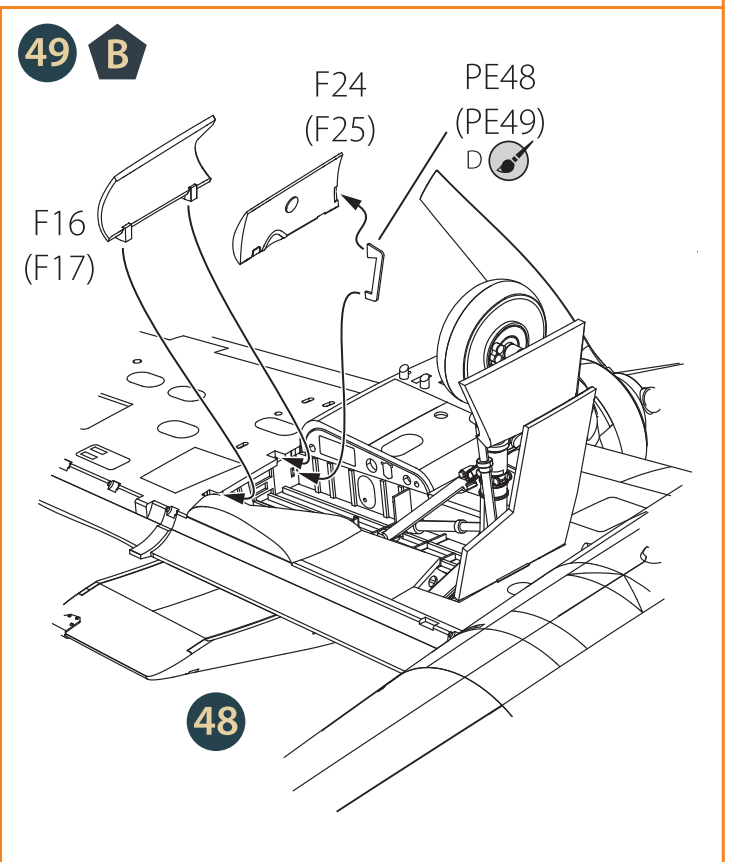
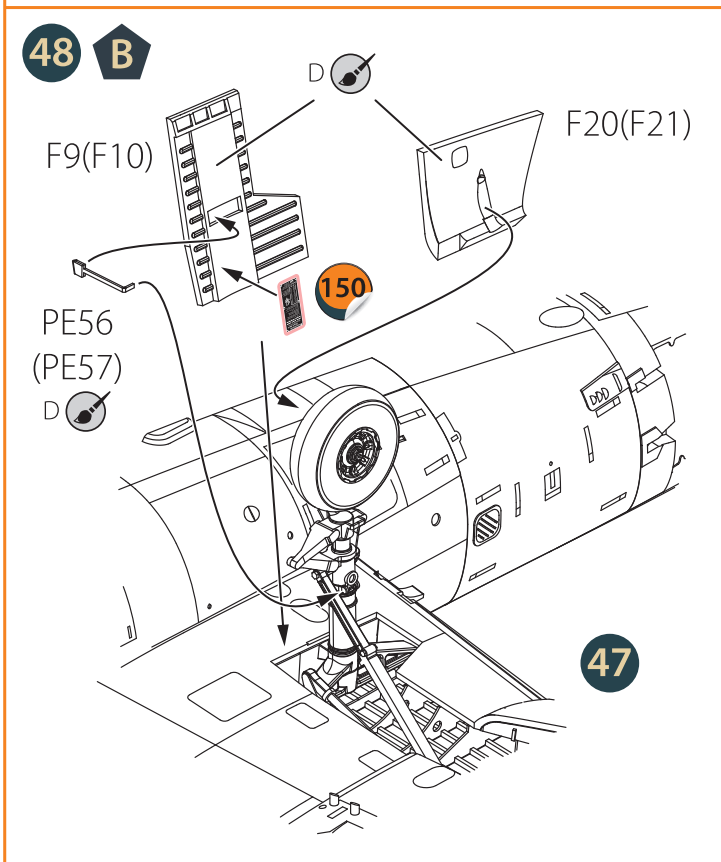
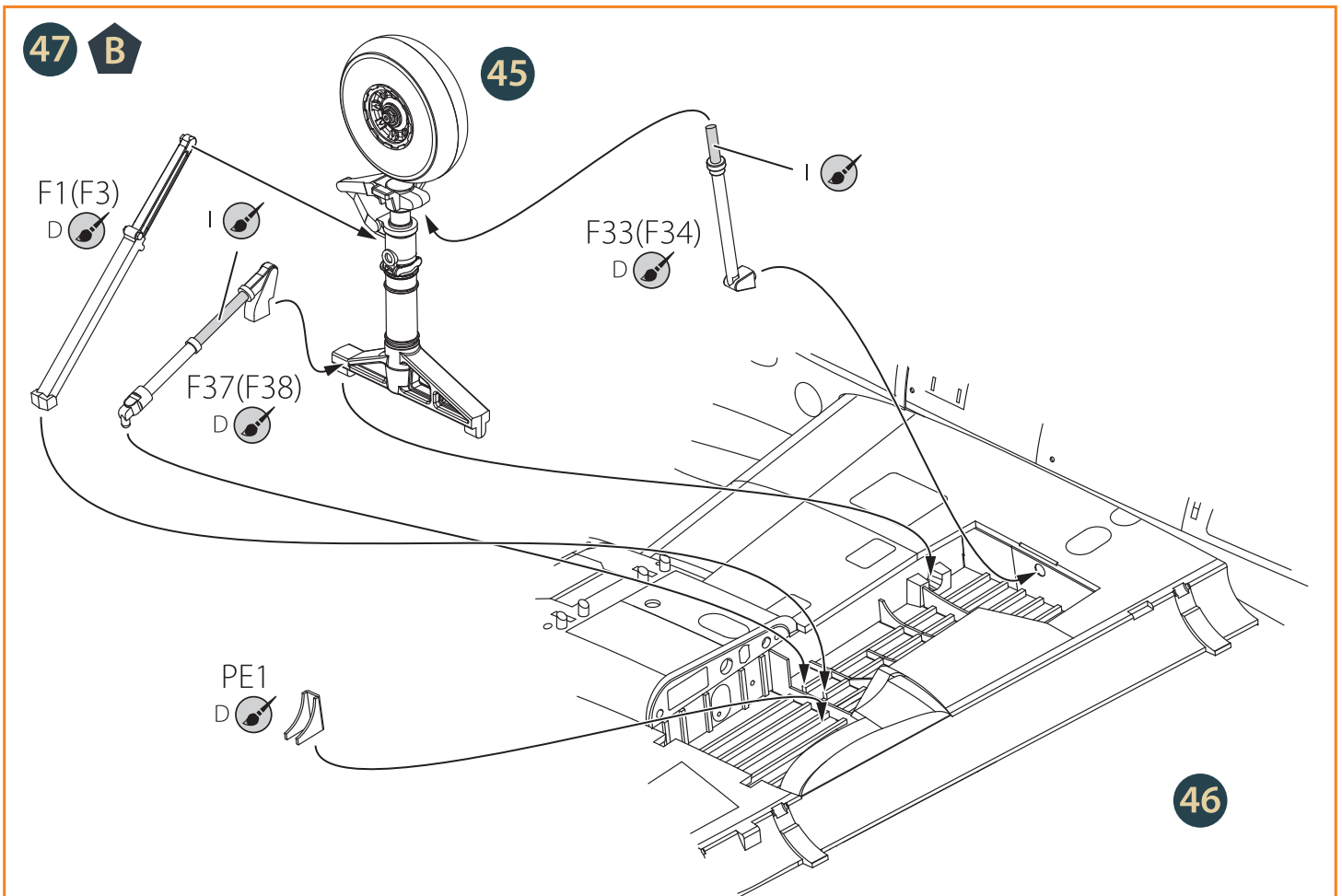

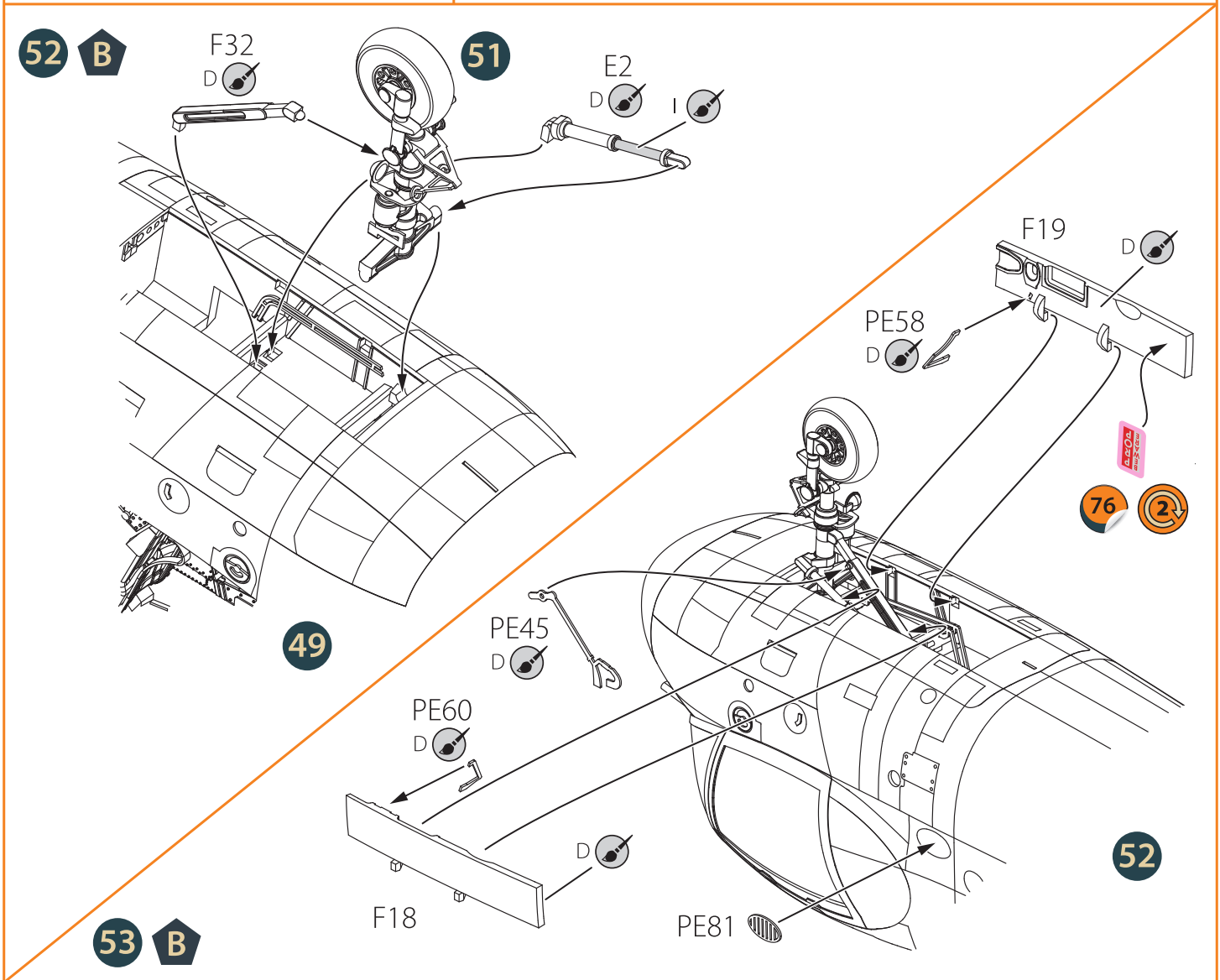
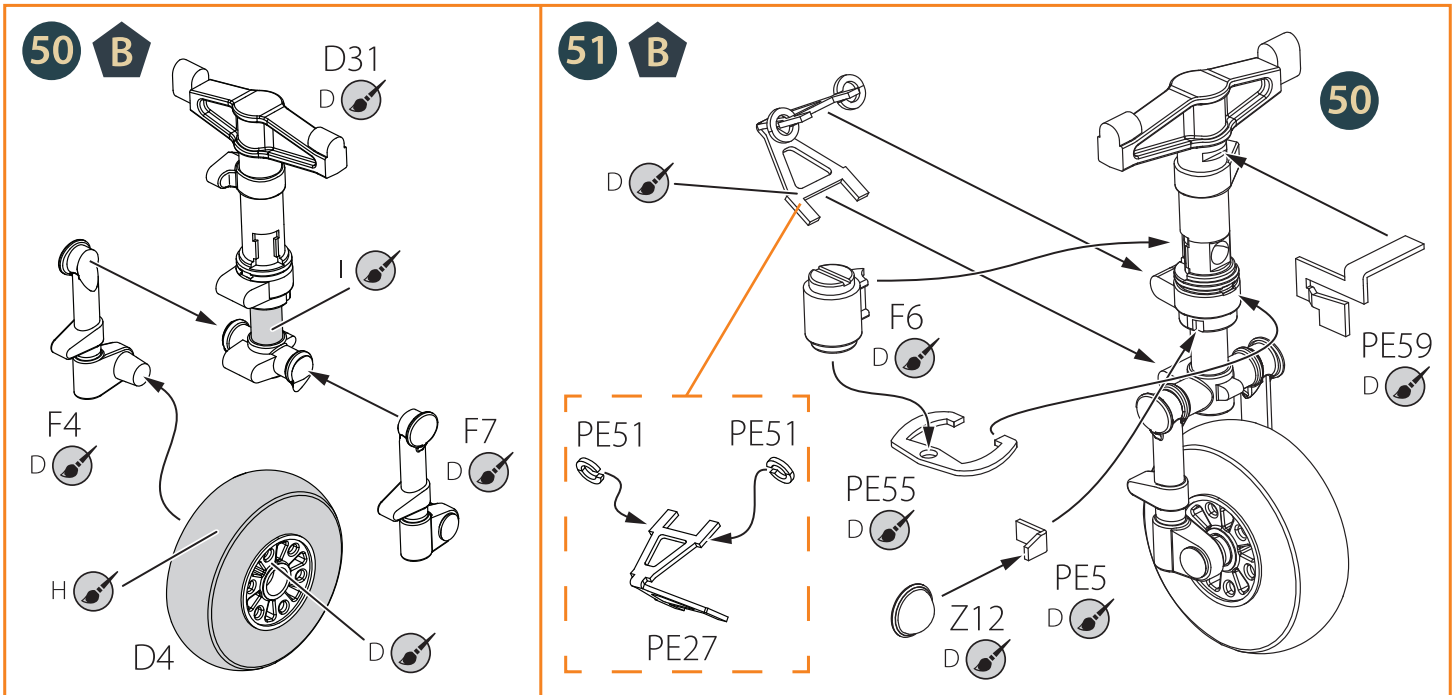

54

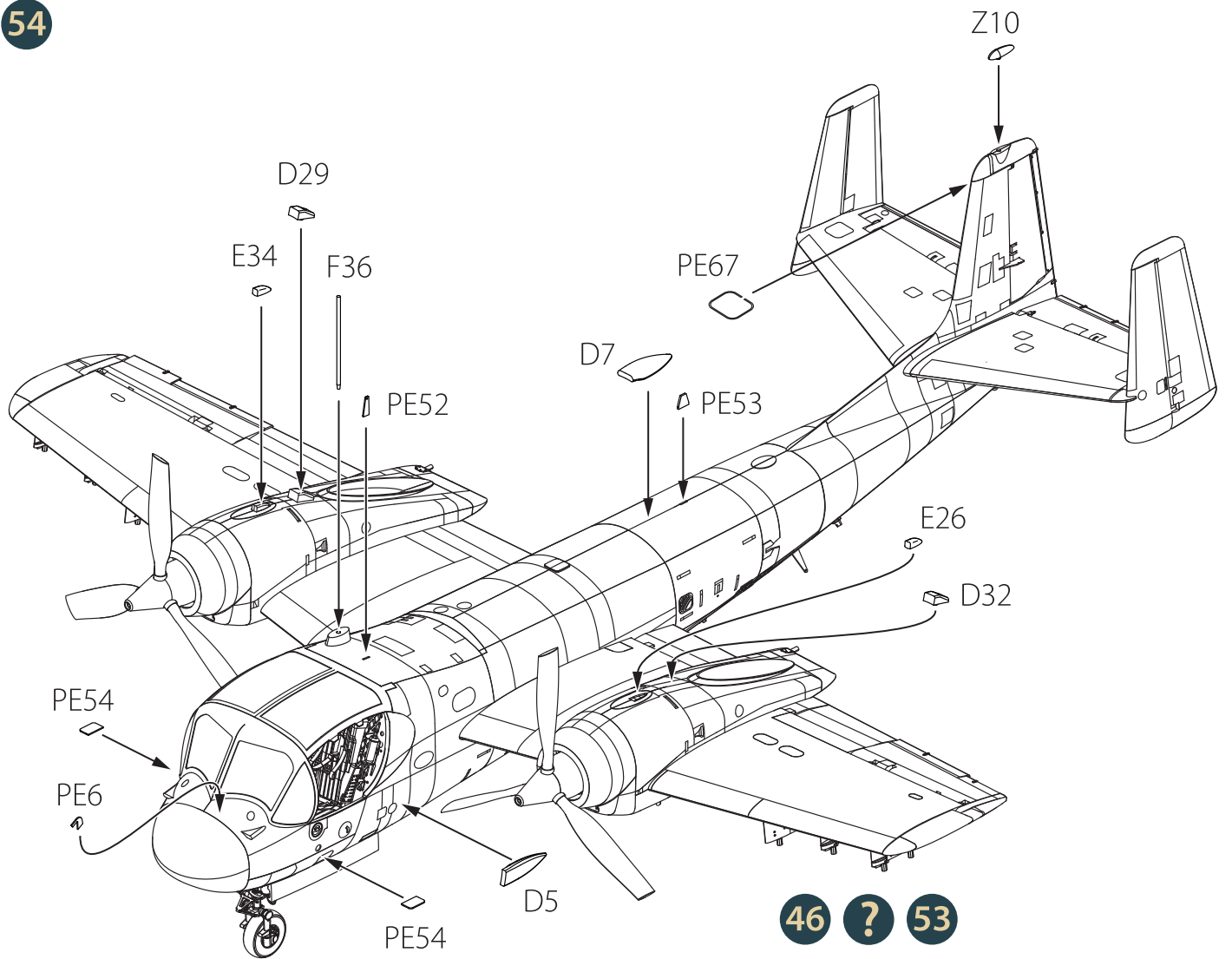

CORRECT POSITION OF LANDING GEAR DOORS

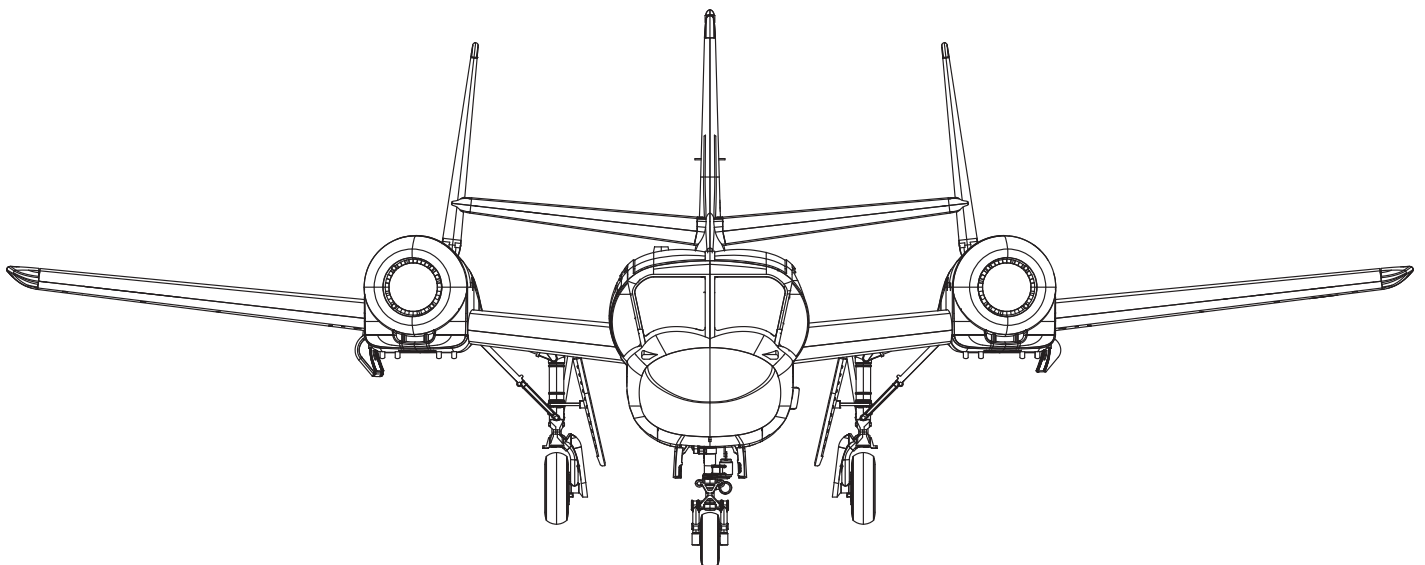

55

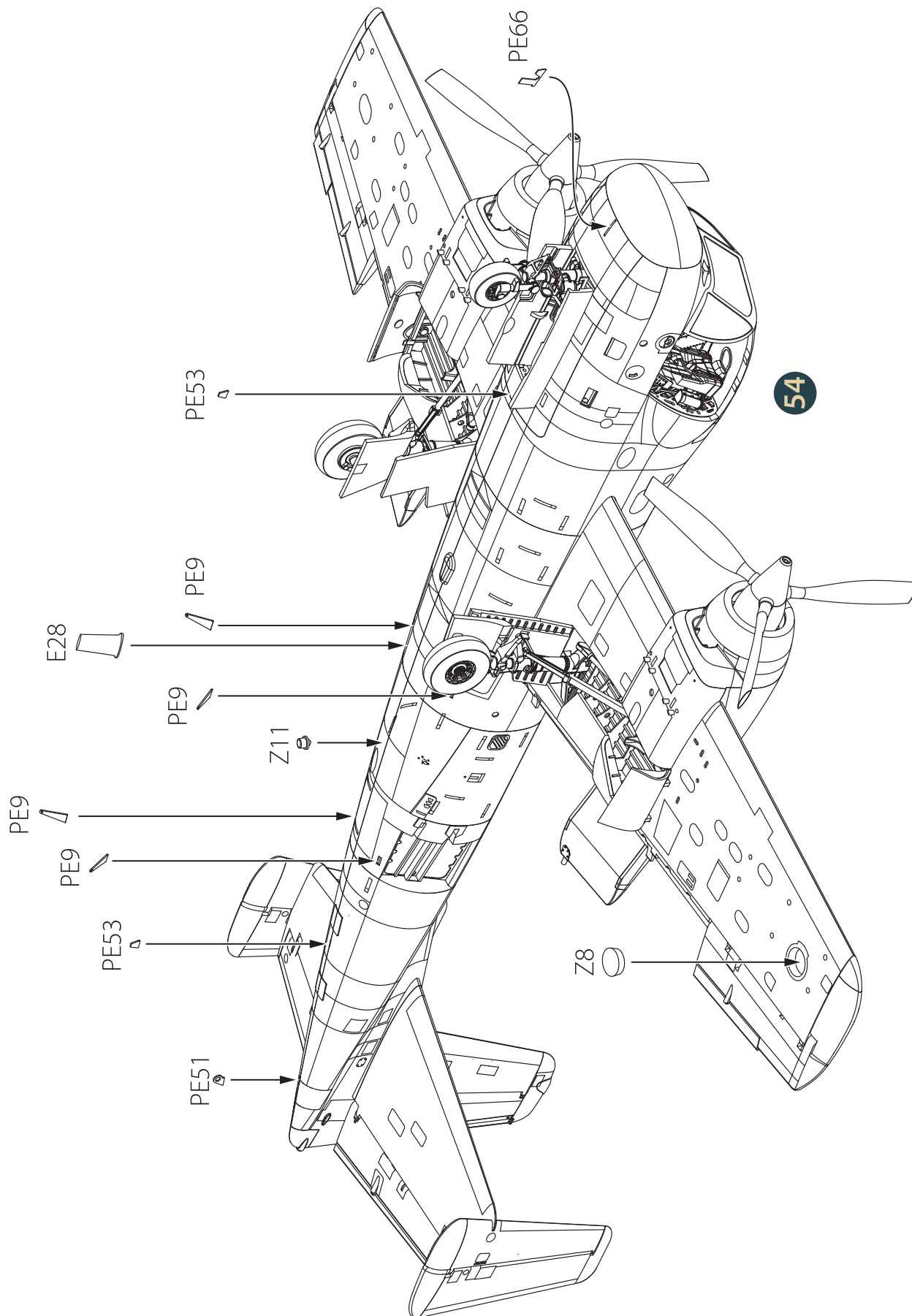

54

56 A

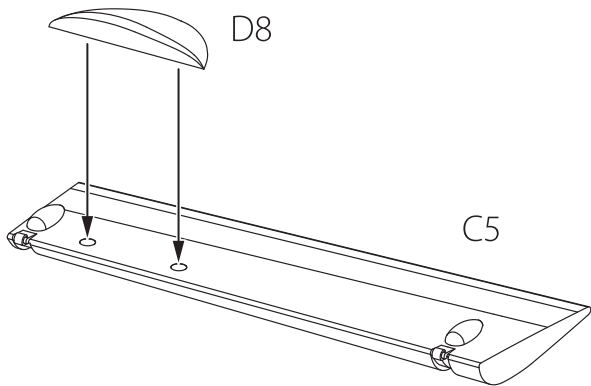

57 A

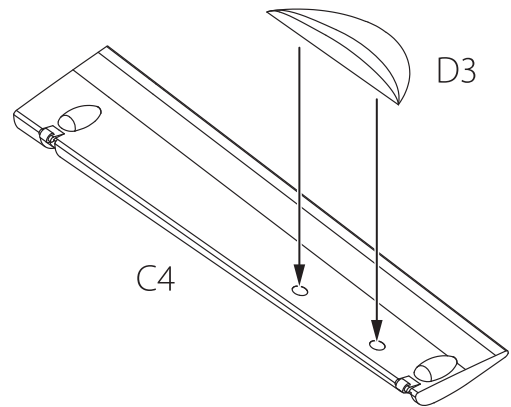

58 B

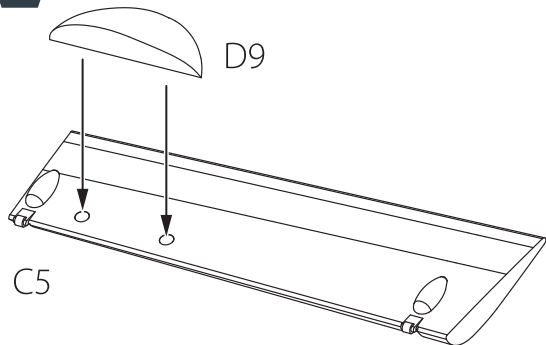

59 B

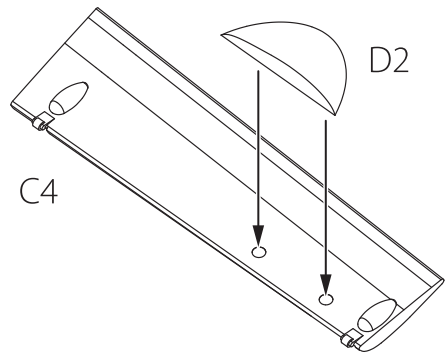

60 A

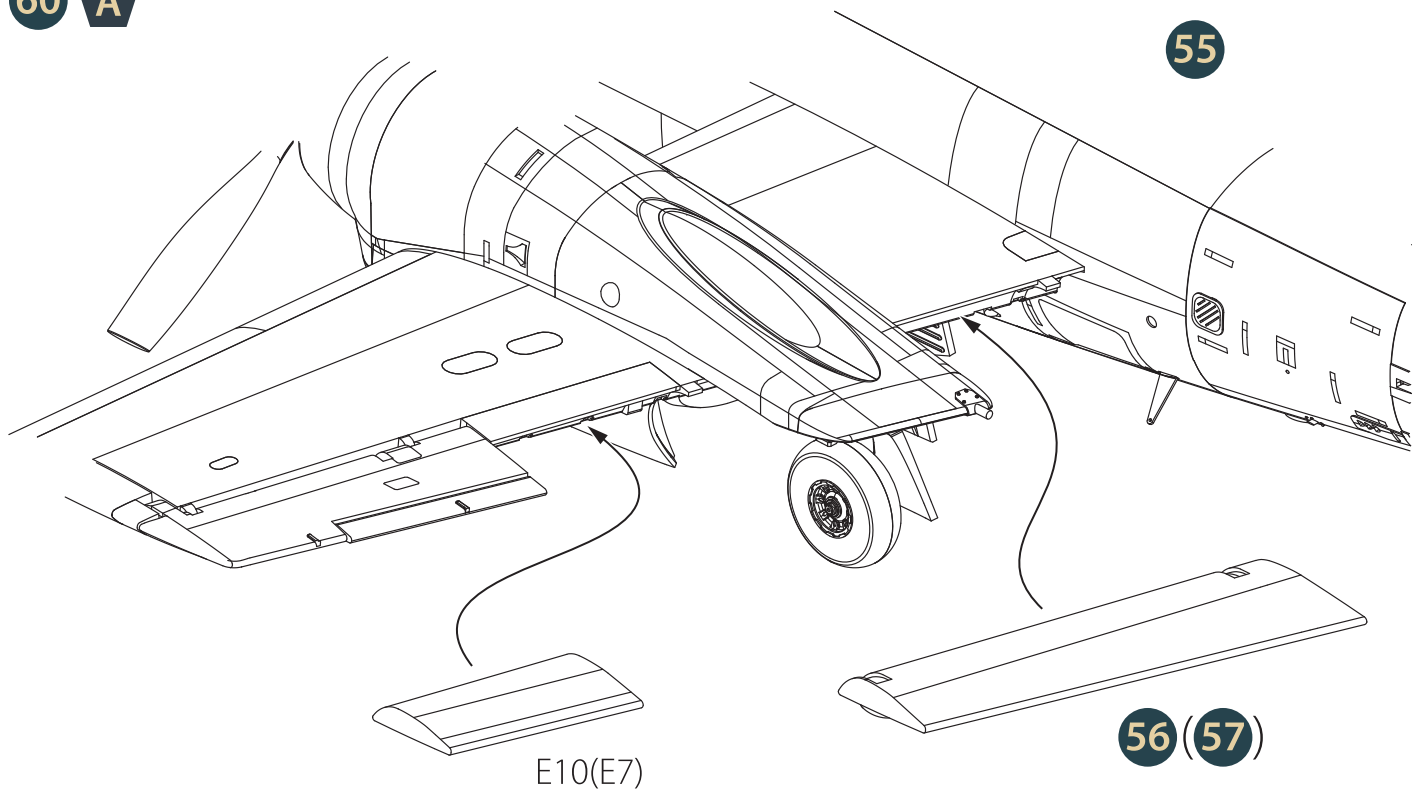

61 B

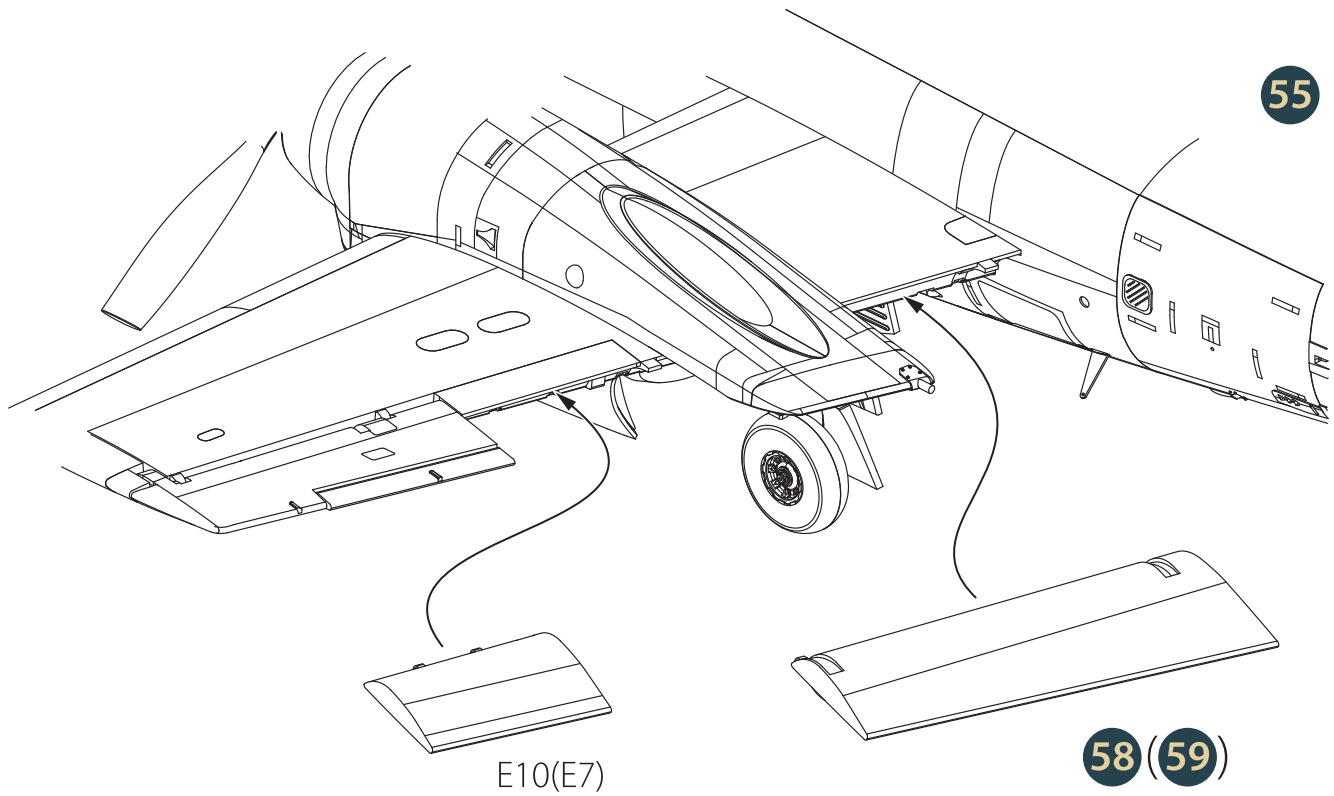

62 A

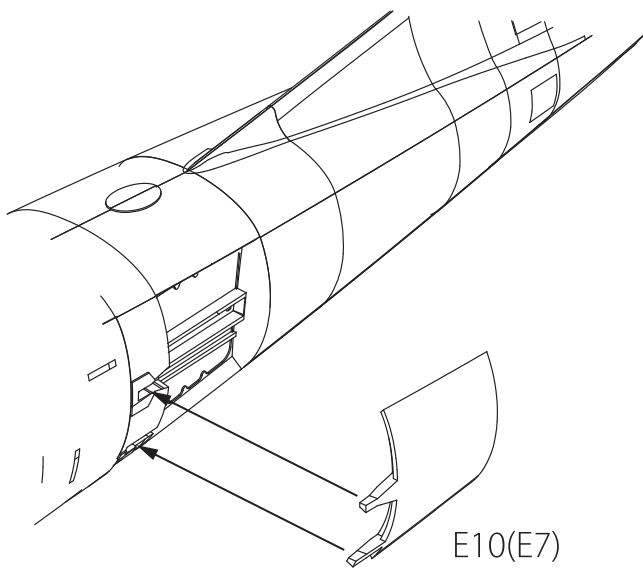

60 ? 61

63 B

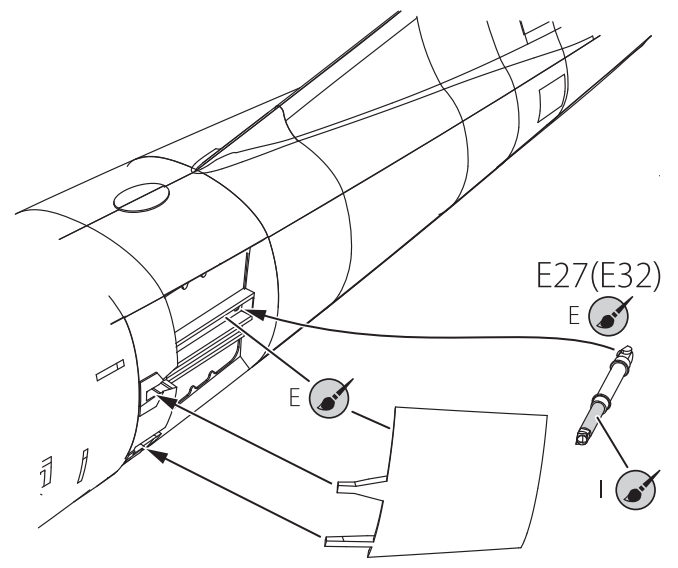

60 ? 61

E10(E7)

64 A

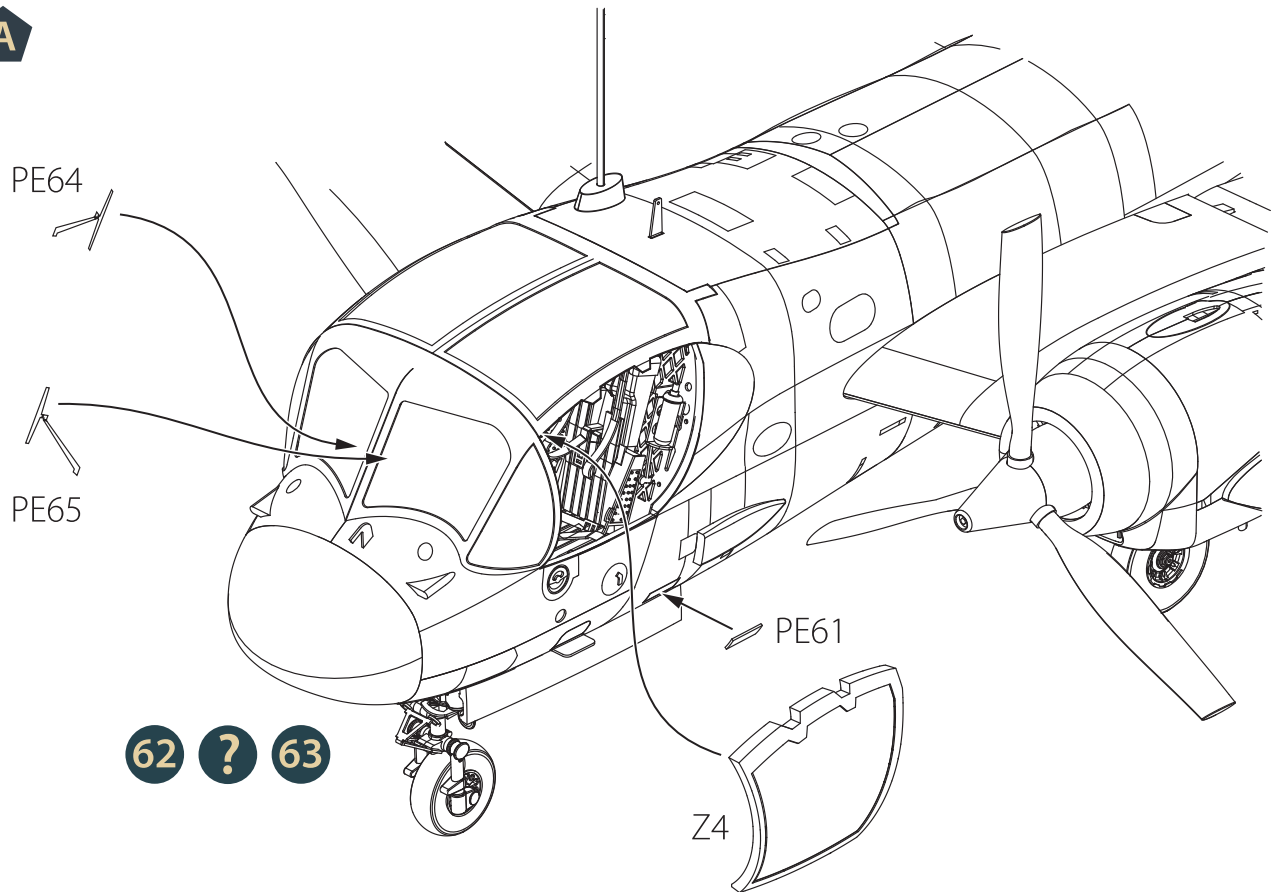

65 B

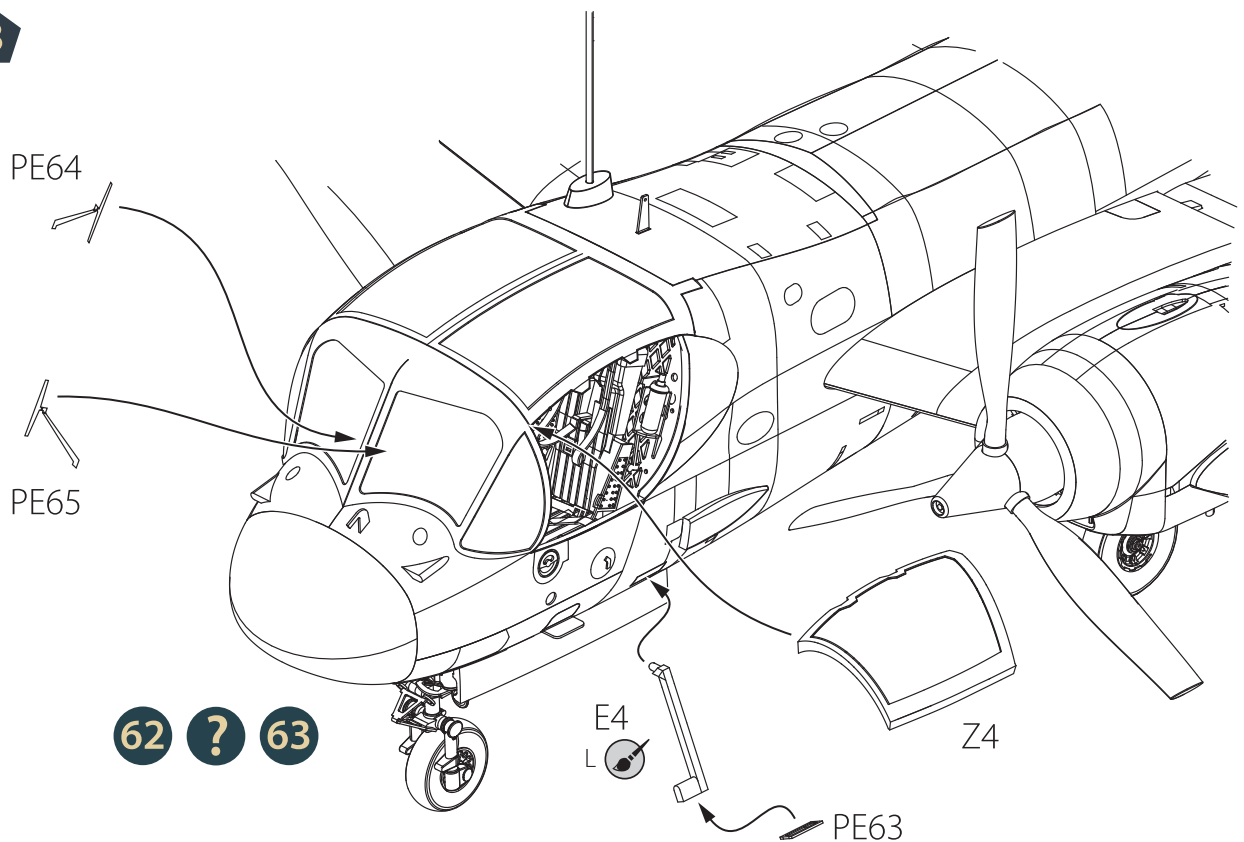

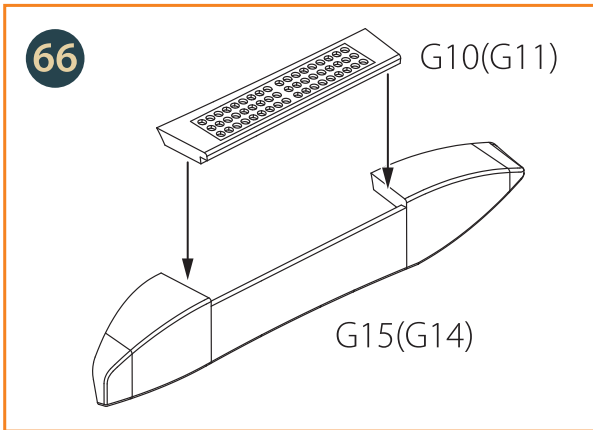

67 ONLY FOR PAINT SCHEME
5

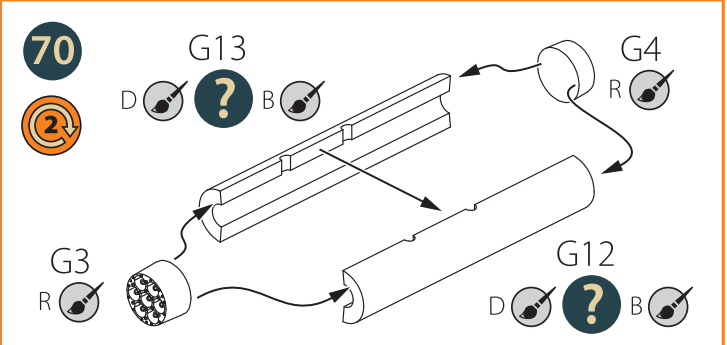
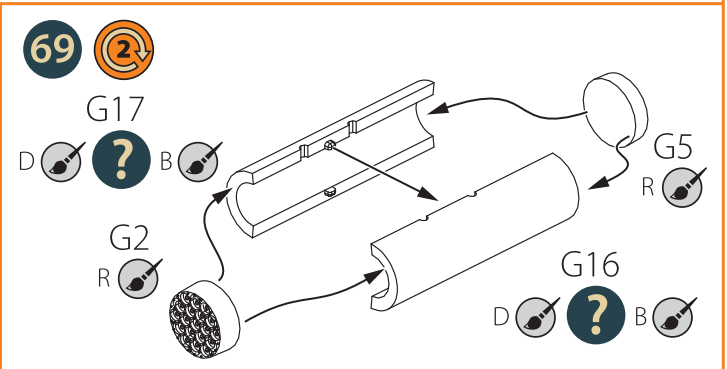
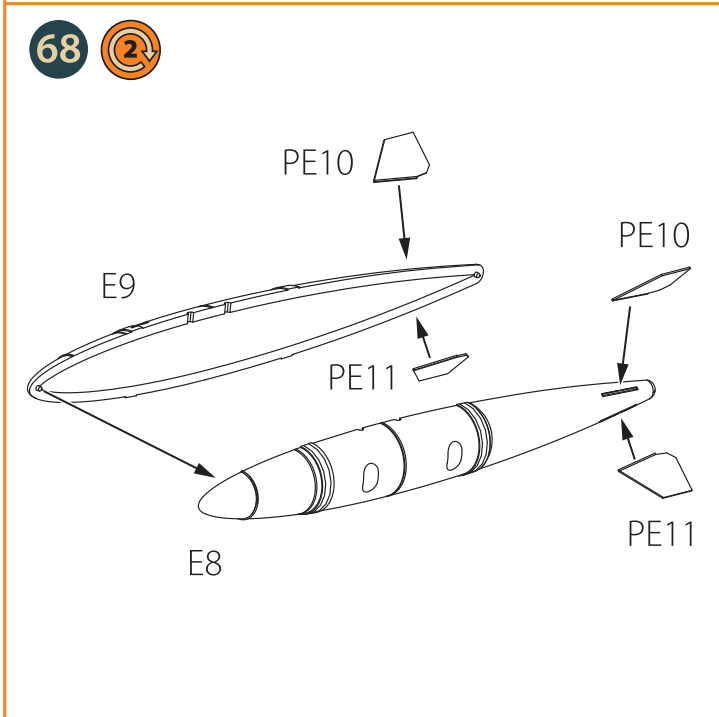
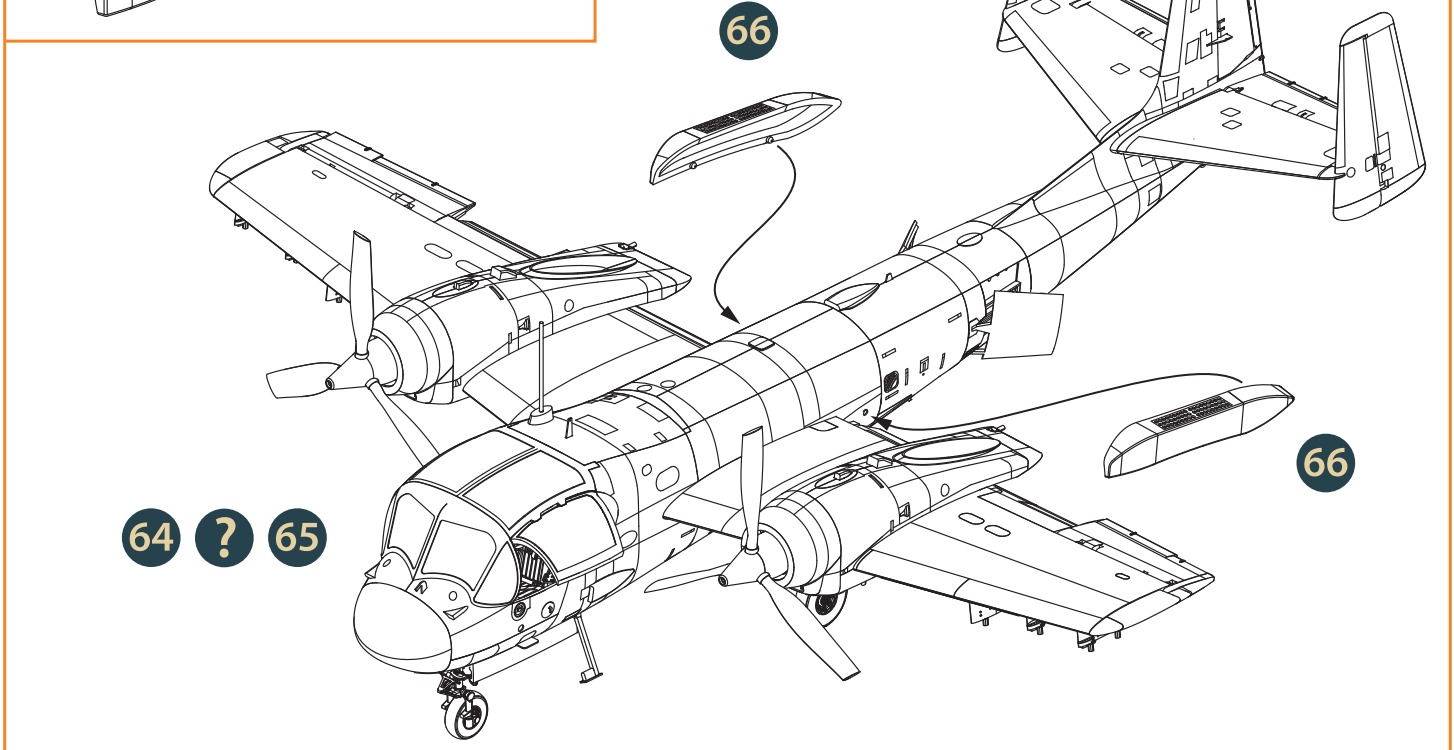

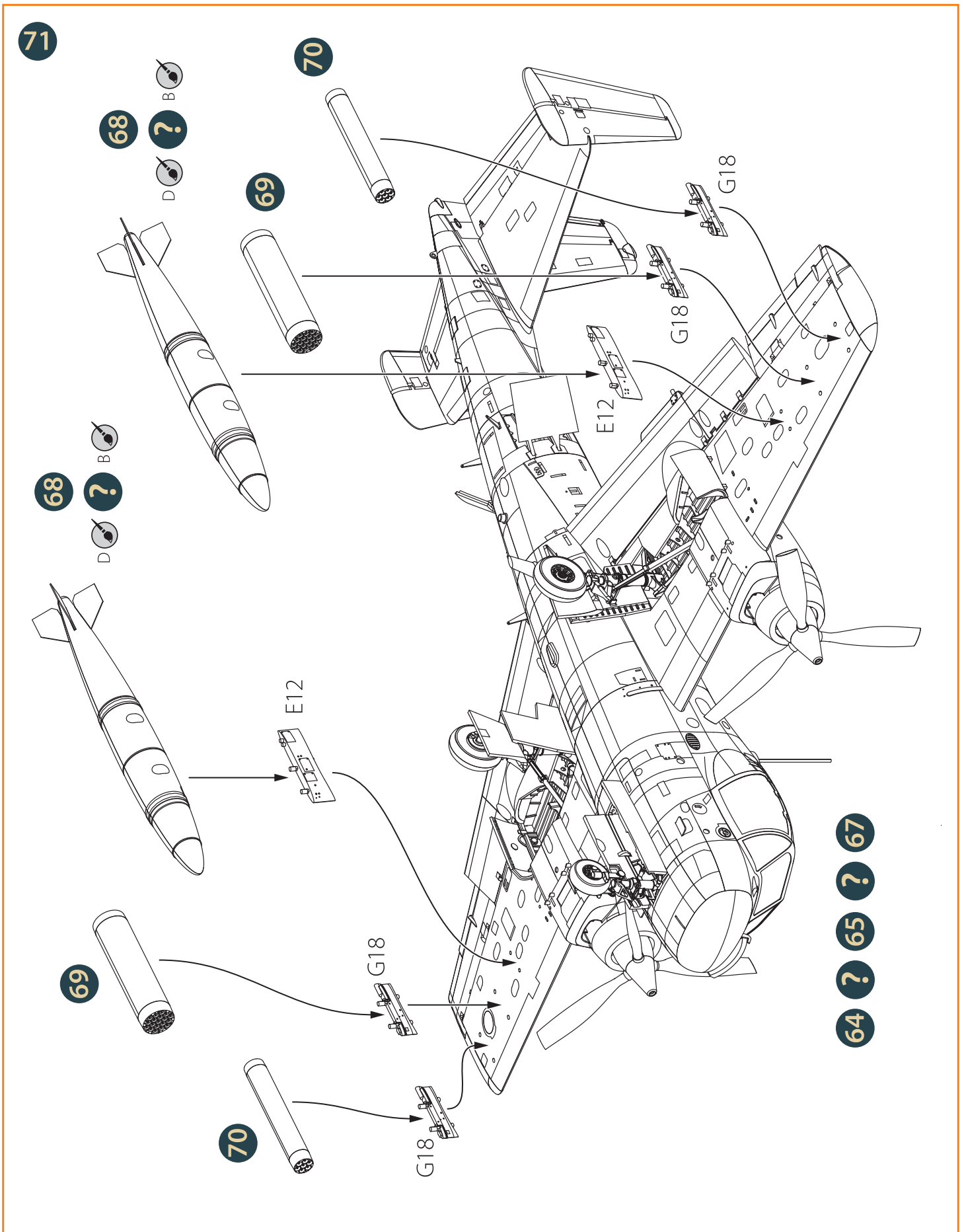



A
MR. COLOR 38
A.MIG-0925
OLIVE DRAB
(DARK)



B
MR. COLOR 12
A.MIG-0237
OLIVE DRAB
(FADED)



C
MR. COLOR 33
A.MIG-0046
BLACK MATT



F
MR. COLOR 301
A.MIG-0908
GREY BASE



J
MR. COLOR 47
A.MIG-0093
RED CRYSTAL



L
MR. COLOR 317
A.MIG-0205
GULL GREY



N
MR. COLOR 4
A.MIG-0048
YELLOW



P
MR. COLOR 138
A.MIG-0092
GREEN CRYSTAL

- ① Grumman JOV-1A Mohawk, s/n 60-3736, 225th Aviation Company,
"Phantom Hawks", flown by Capt. Mike Langer, Vietnam, December 1964.

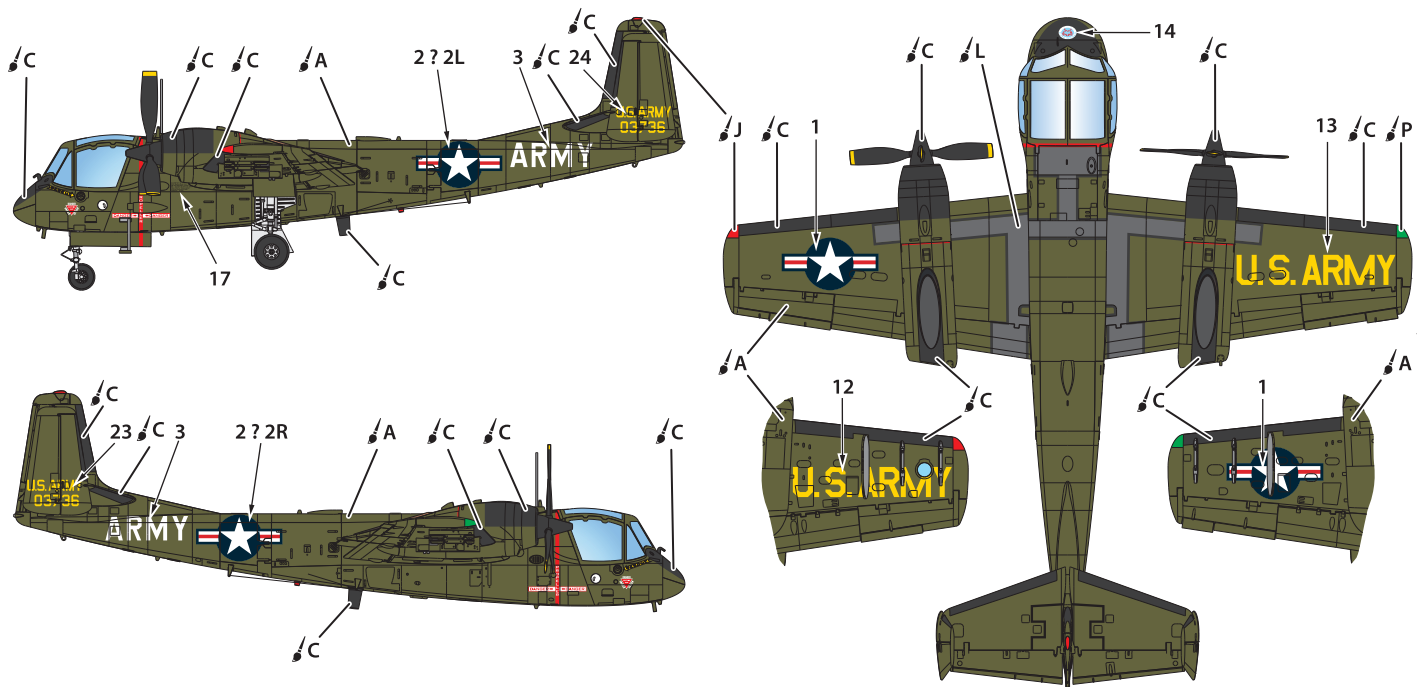

- ② Grumman OV-1A Mohawk, s/n 59-2617, 23rd Special Warfare Aviation Detachment, Vietnam, 1963.

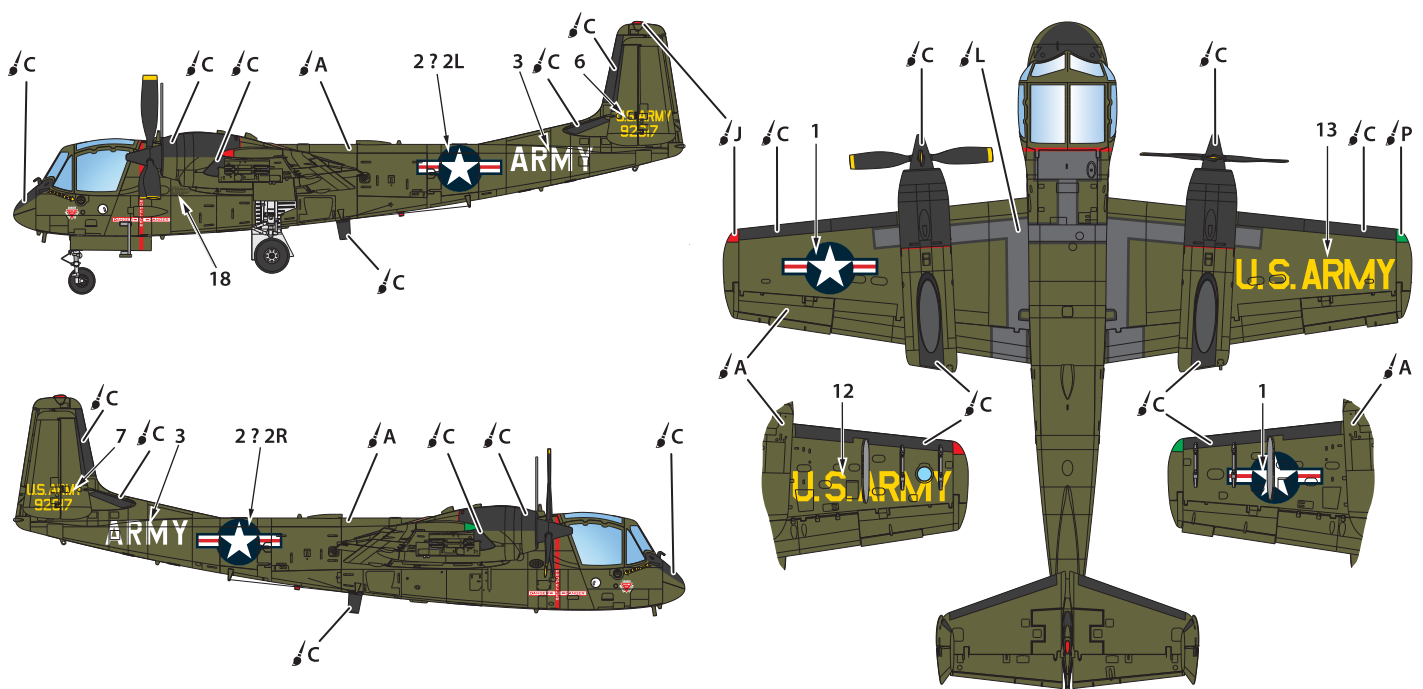



A
MR. COLOR 38
A.MIG-0925
OLIVE DRAB
(DARK)



B
MR. COLOR 12
A.MIG-0237
OLIVE DRAB
(FADED)



C
MR. COLOR 33
A.MIG-0046
BLACK MATT



F
MR. COLOR 301
A.MIG-0908
GREY BASE



J
MR. COLOR 47
A.MIG-0093
RED CRYSTAL



L
MR. COLOR 317
A.MIG-0205
GULL GREY



N
MR. COLOR 4
A.MIG-0048
YELLOW



P
MR. COLOR 138
A.MIG-0092
GREEN CRYSTAL

③ Grumman OV-1A Mohawk, s/n 63-13129, 73rd Aviation Company, Vietnam, 1966.

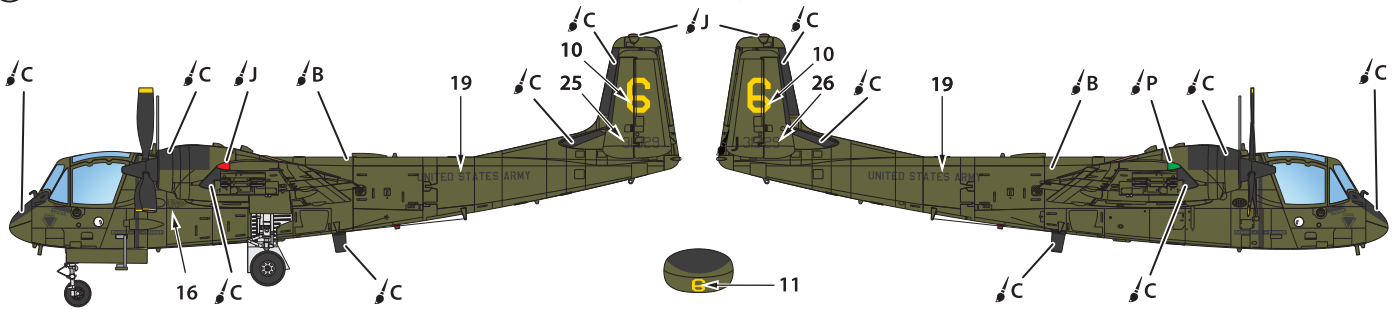

④ Grumman OV-1A Mohawk, s/n 63-13129, 73rd Aviation Company, Vietnam, 1967.

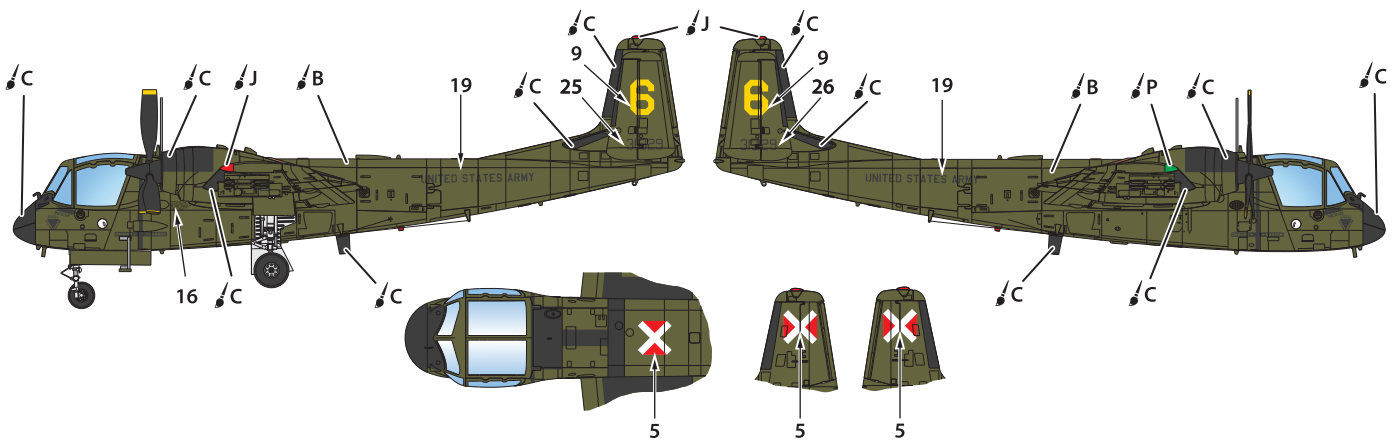

⑤ Grumman OV-1A Mohawk, s/n 63-13125, 73 Avn Co (AS), An Xuyen Province, flown by Lt. Johnson, Vietnam, September 1964.

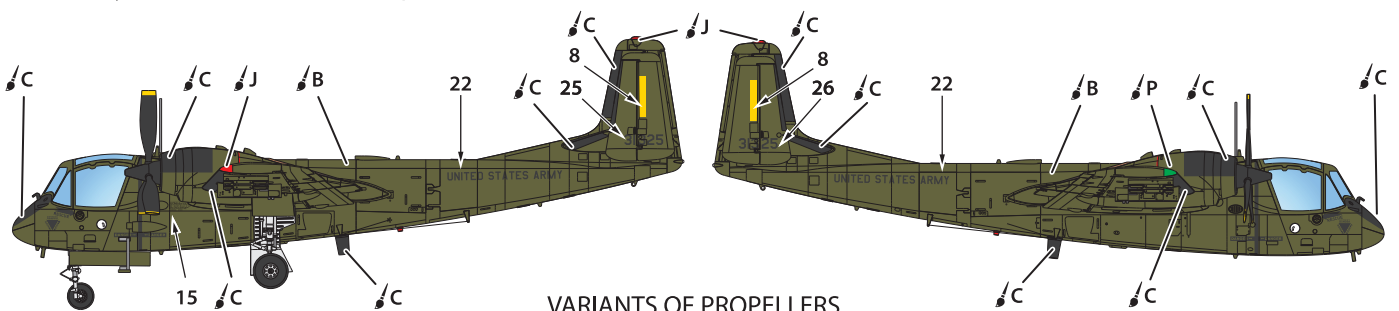

VARIANTS OF PROPELLERS

