

7467 Junkers Ju 88A-1 Cockpit
1/72 set for Revell kit

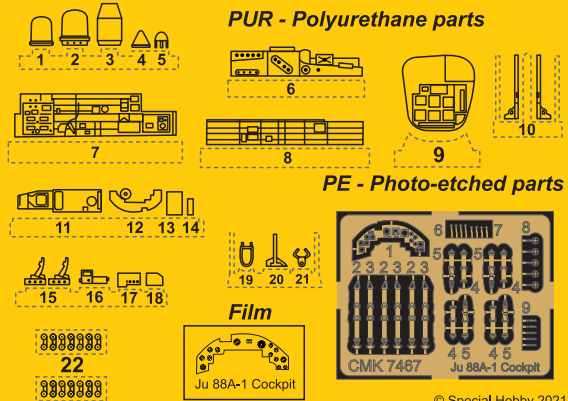

© Special Hobby 2021

Díly ohnuté popř. pokroucené vlivem teplotních změn a stárnutí materiálu, mohou být narovnány do požadovaného tvaru pomocí proudu teplé vody nebo vzduchu (fén na vlasy). K lepení použít kyanoakrylátové lepidlo! Kontaktní plochy doporučujeme před lepením odmastit. Různé drátky a tyčinky nejsou přiloženy.

Parts slightly distorted and bent owing to temperature changes or due to material ageing can be straightened to requested shape by hot water or hot air jet (hair dryer). This process can be repeated till result is entirely satisfactory. For best result use cyanoacrylate glue! Contact areas ungrease is recommended before gluing. Wires and rods not included.

Visit our official website and e-shop at
www.cmkkits.com
www.specialhobby.eu
www.facebook.com/specialhobby/
OTHER 1/72 SETS / OSTATNÍ SETY 1/72

7469 Junkers Ju 88A/C Life Boat
for Revell kits

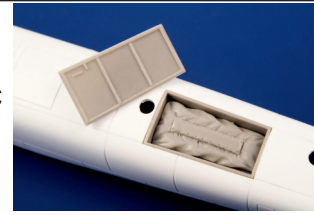

Special Hobby, Mezilesí 718, Praha 9, 193 00, Czech Republic
e-mail: office@specialhobby.eu

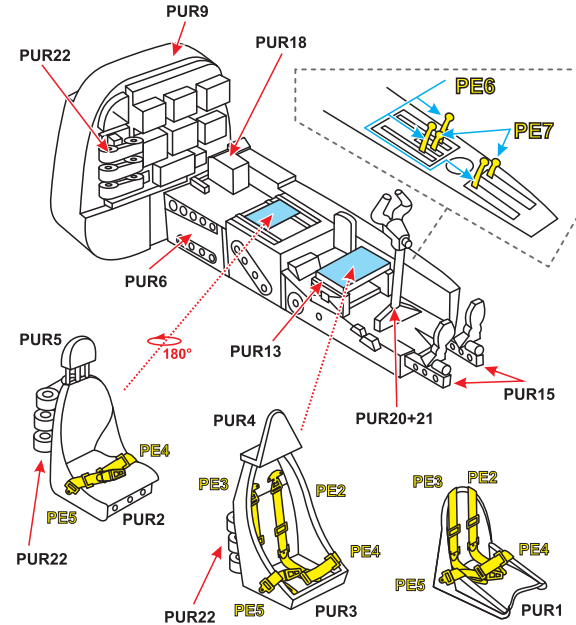

díl stavebnice E 98
kit part E 98

díl stavebnice M-B 94
kit part M-B 94

díl stavebnice E 91
kit part E 91

díl stavebnice B 55
kit part B 55

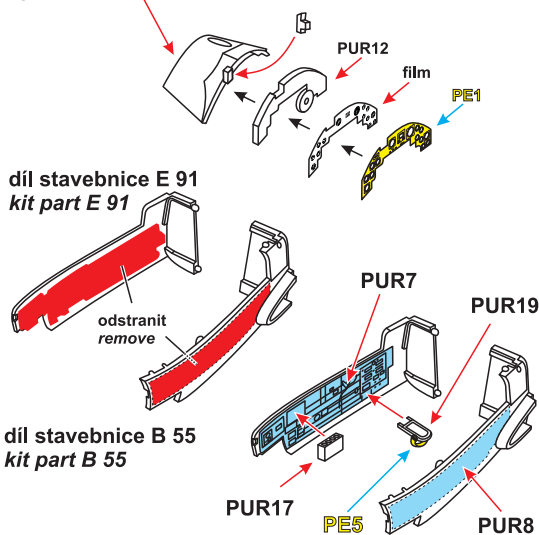

PUR16

PUR11

díl stavebnice B 44
kit part B 44

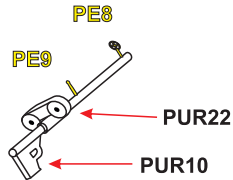

CMK H1010

The Razor Saw with Handle (cat. n. H1010) is a great tool for cutting both plastic and resin. CMK also offers a wide variety of coarse / medium / fine saws.

The kit of the Year 2021!

Bf 109E 'Emil'
by Special Hobby

