

Bedford QL Tanker



Cat. No. 72081
Scale 1/72

3d design: Jarosław Leoniec
Research: IBG Crew



1 Element assembled in previous step
Element złożony we wcześniejszym etapie

1 Element after assembly in current step
Element po złożeniu w aktualnym etapie

? Version to choose
Wersja do wyboru

A Paint colour
Kolor farby

1 Decal
Kalkomania

Photo-etched parts
/ Elementy Fototrawione

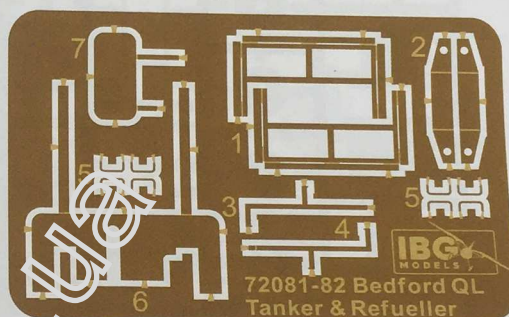

Clear film
/ Klisza

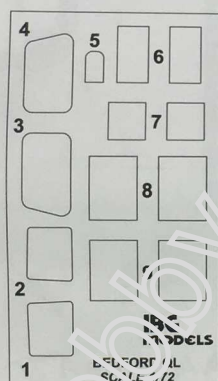

Decals
/ Kalkomanie



		Vallejo Model Air	Hataka	Mr Hobby H	Mr Hobby C	Lifecolor	AK Interactive
Black	A	71.057	HTK-A041	H077	C137	UA733	AK719
Rust	B	71.129	HTK-A132	H047	C041	LC32	AK707
S.C.C 15 Anti-gas Olive Drab	C	71.011	HTK-A110	H052	C012	UA270	RC037
S.C.C 2 MT Brown Special	D	71.032	HTK-A106	H310	C520	UA273	RC035
S.C.C 14 Blue Black	E	71.055	HTK-A224	H416	C116	UA271	RC036
White	F	71.001	HTK-A049	H011	C062	LC01	RC004

Please read instructions before assembly. Follow the sequence of assembly presented in instructions. Glue and paint not included.
Przed montażem przeczytać instrukcję. Przestrzegać kolejności montażu podanego w instrukcji. Klej i farby nie wchodzą w skład zestawu.

IBG Models
ul. Benedykta Hertza 2
04-603 Warszawa
Poland

tel +48 22 8159150
fax +48 22 8159151
ibgsc@ibg.com.pl
www.ibg.com.pl
www.ibgmodels.com

Sprue without letter designation
/ Ramka bez oznaczenia literowego

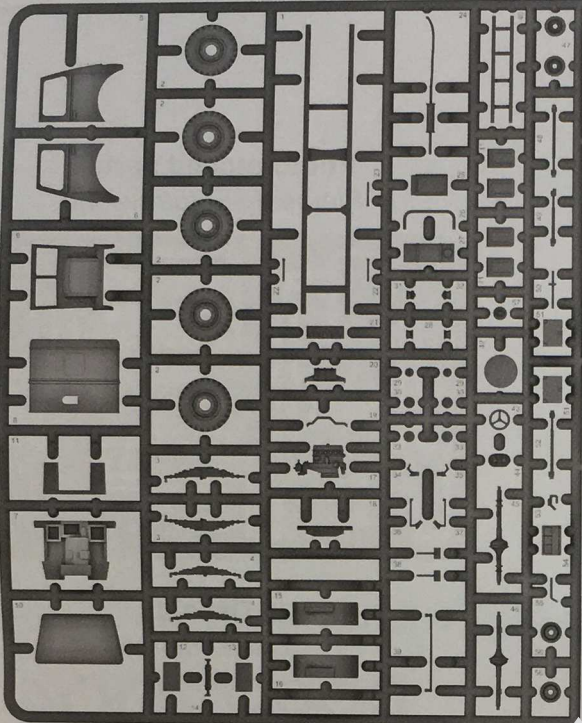

Sprue C x2 / Ramka C x2

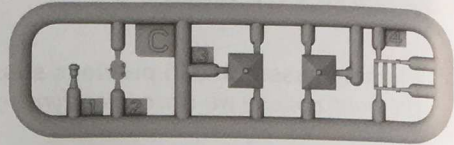

Sprue D x2 / Ramka D x2

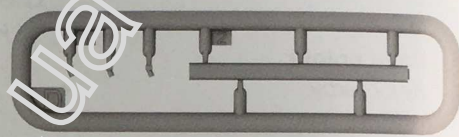

Sprue A / Ramka A

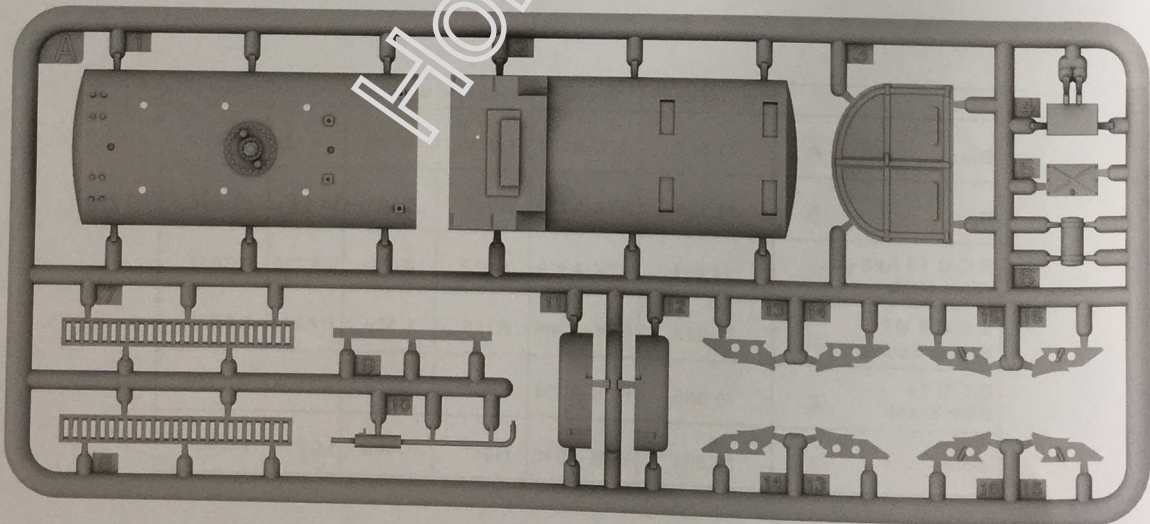

Step 1
Etap 1

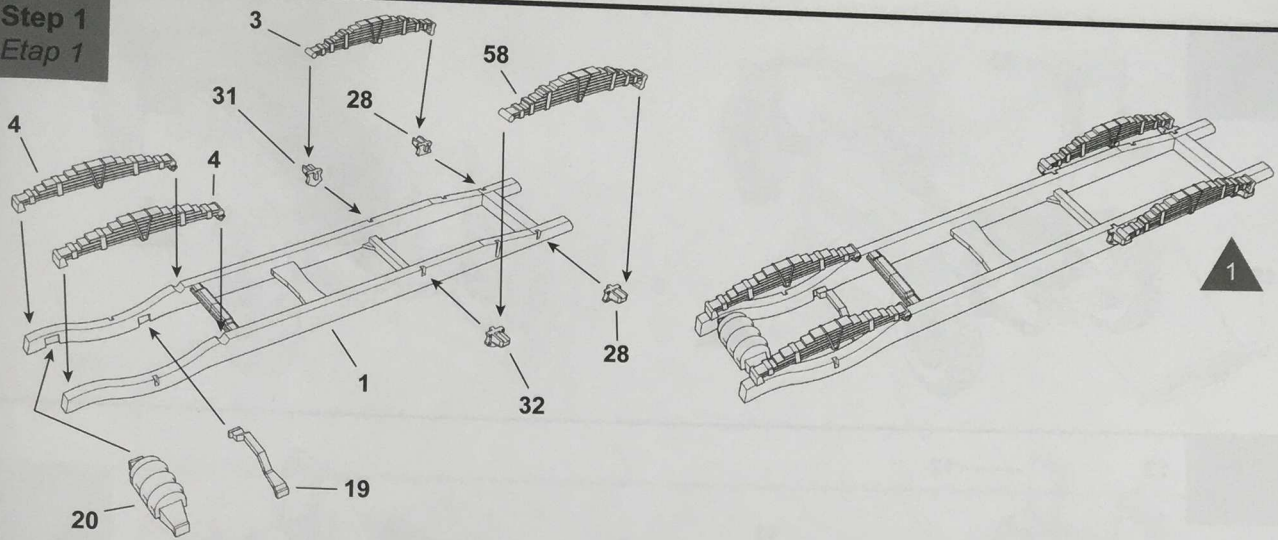

Step 2
Etap 2

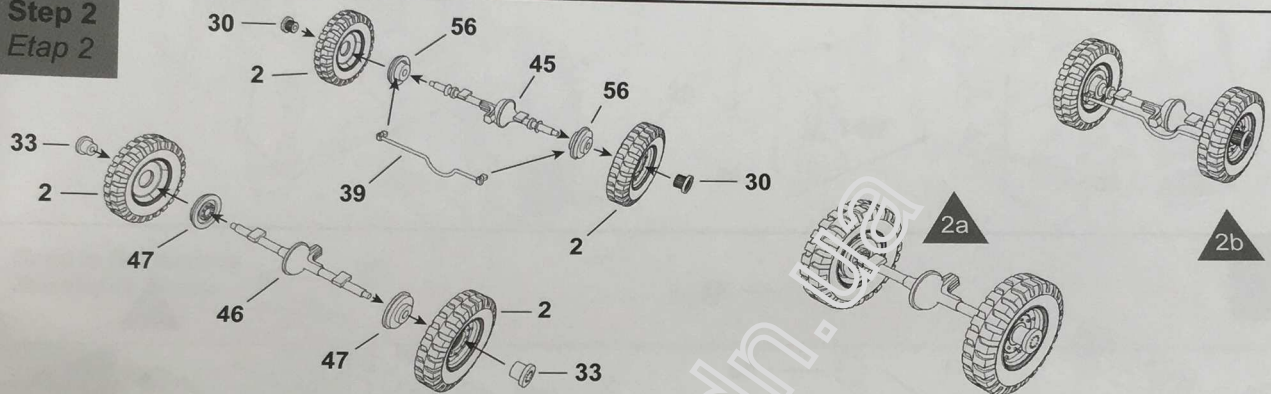

Step 3
Etap 3

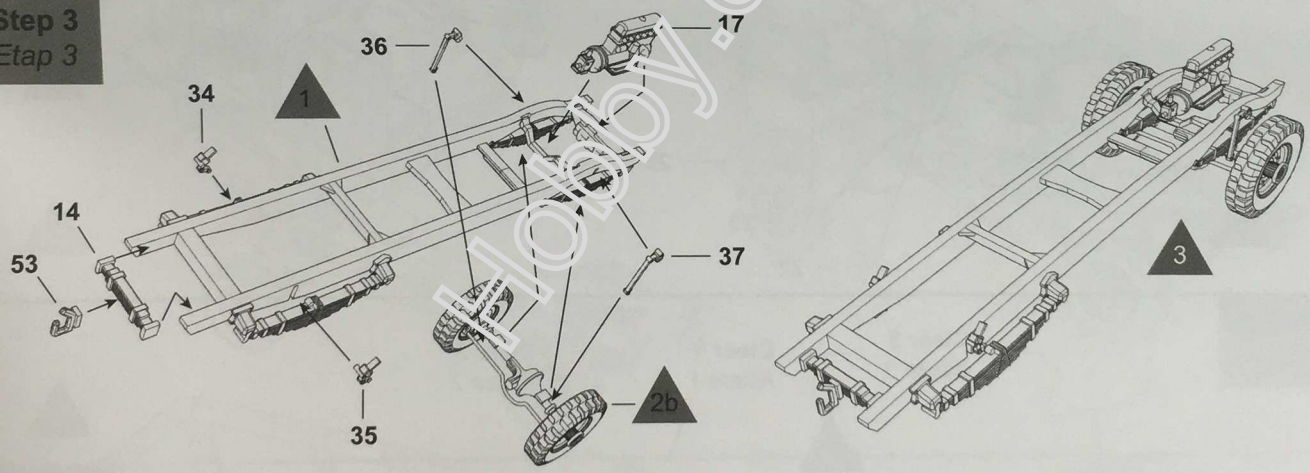

Step 4
Etap 4

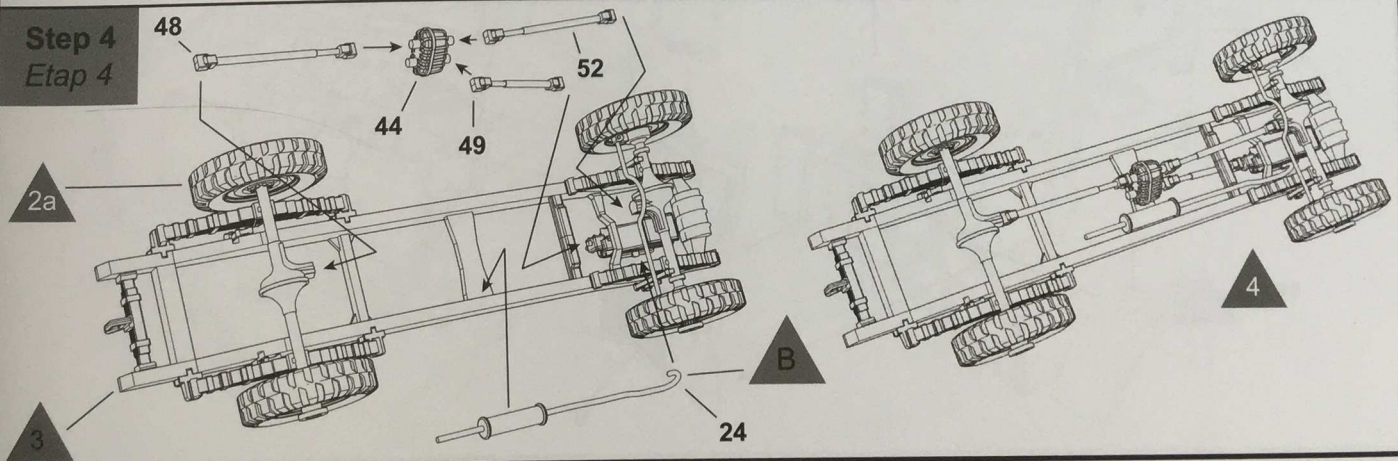

Step 5
Etap 5

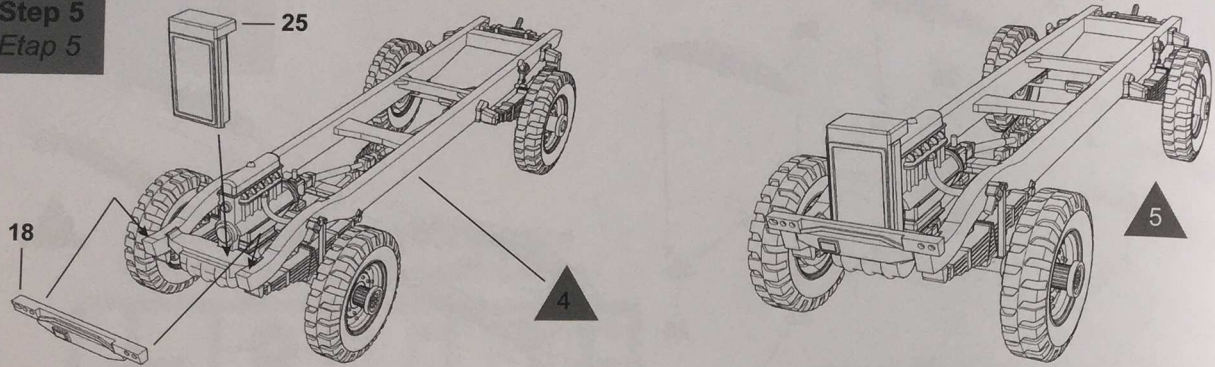

Step 6
Etap 6

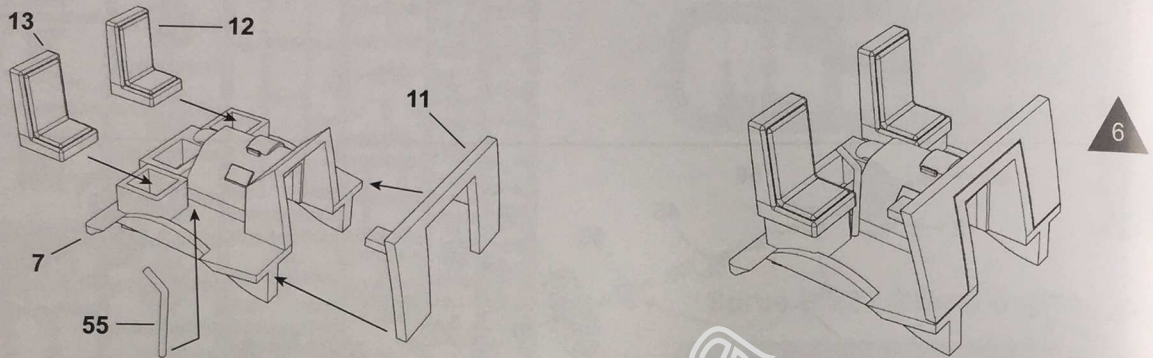

Step 7
Etap 7

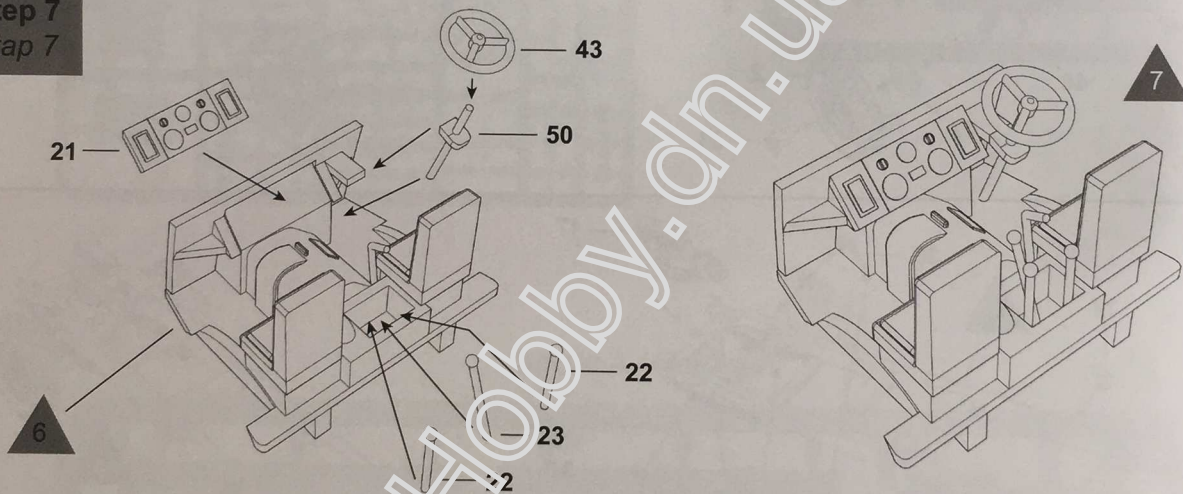

Step 8
Etap 8

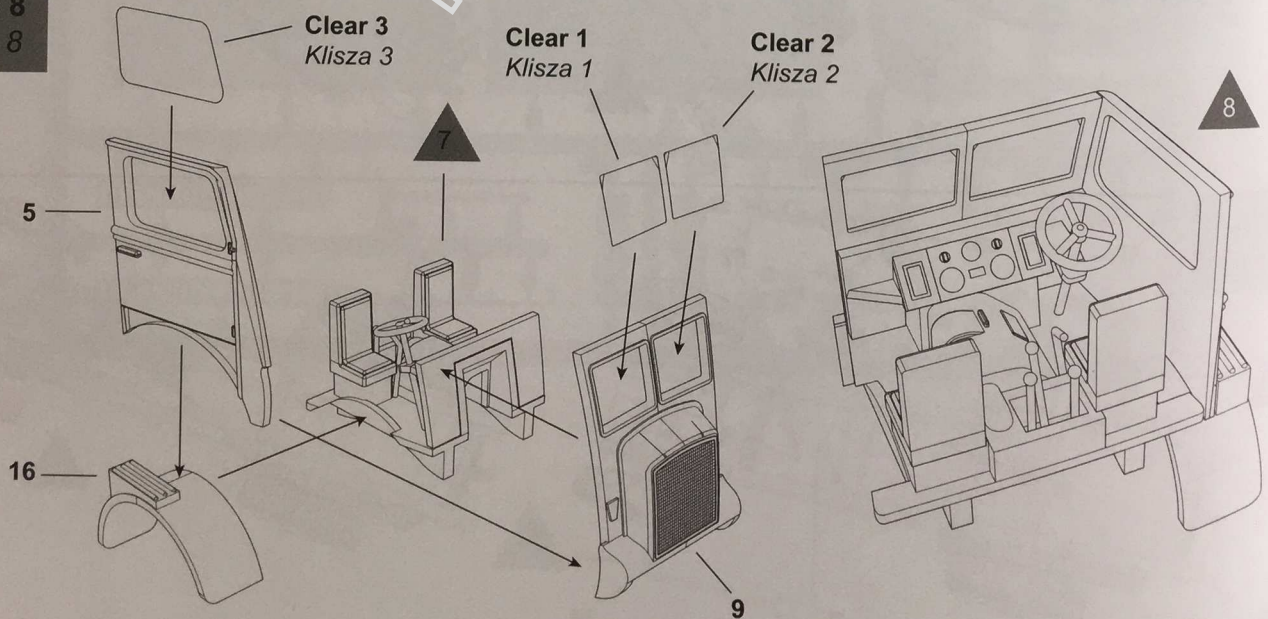

Step 9
Etap 9

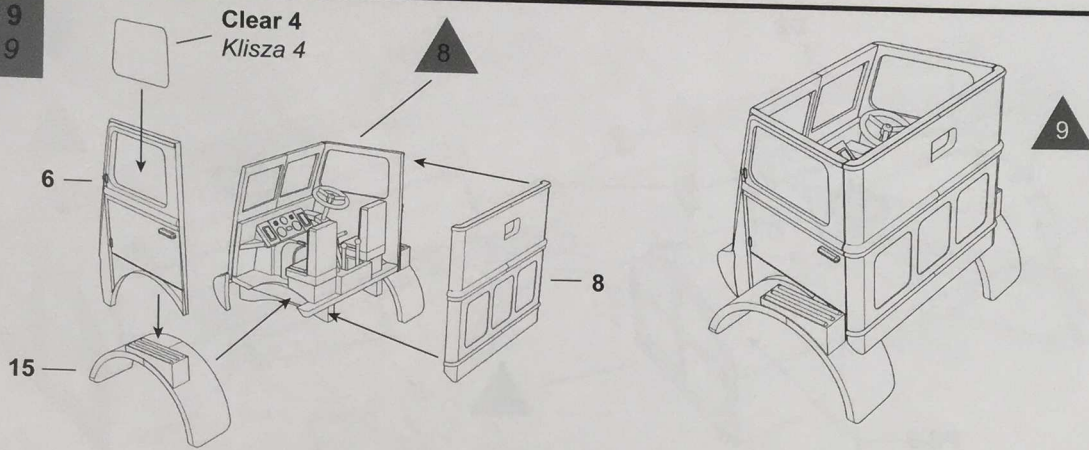

Step 10
Etap 10

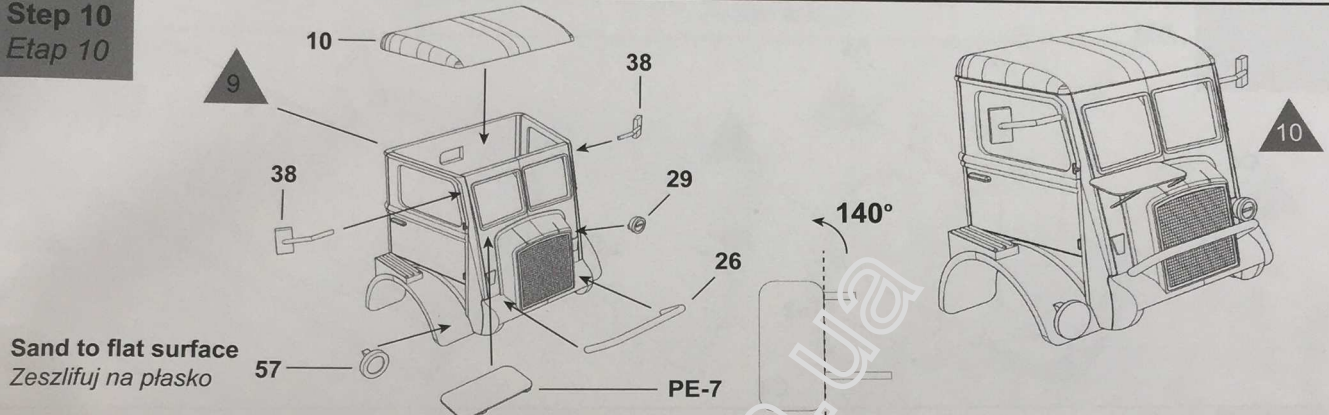

Step 11
Etap 11

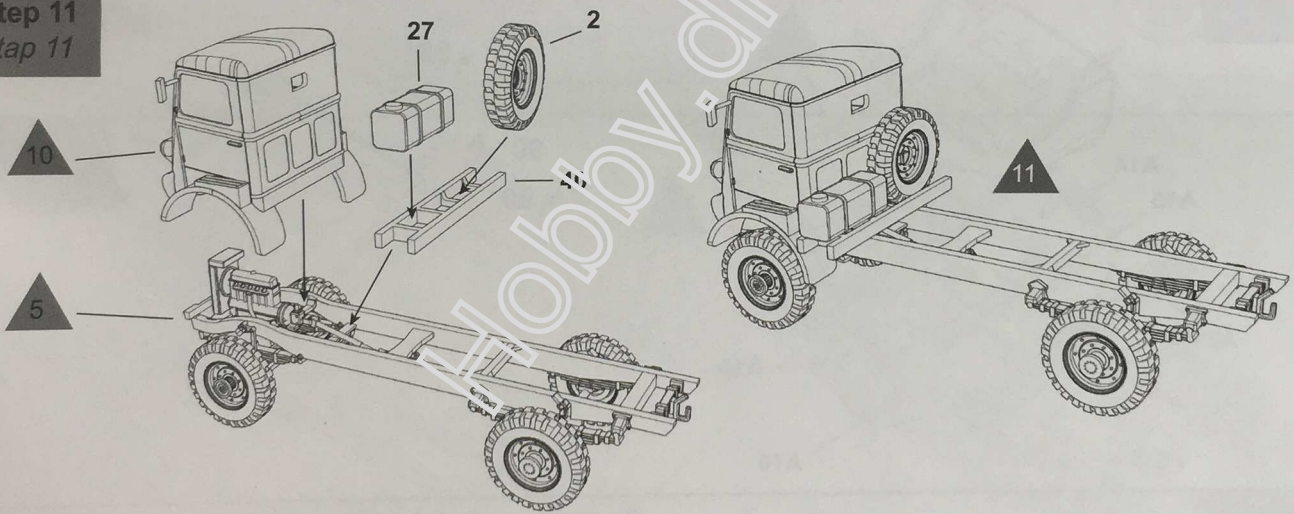

Step 12
Etap 12

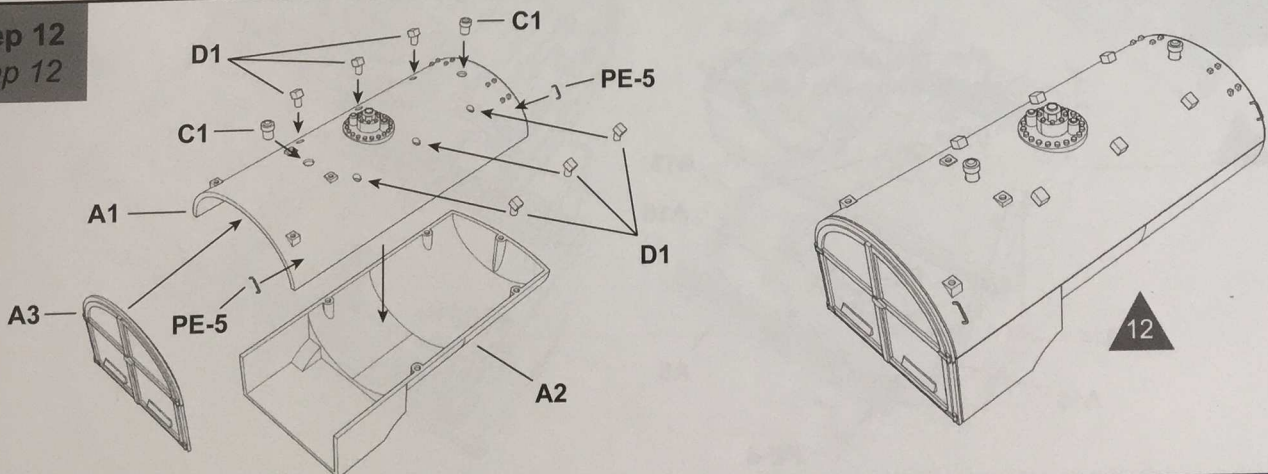

Step 13
Etap 13

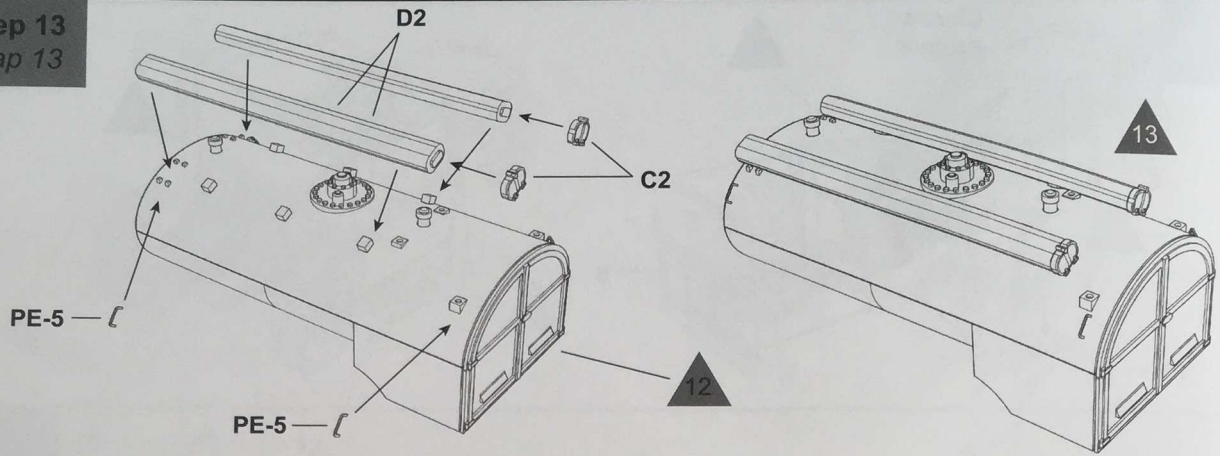

Step 14
Etap 14

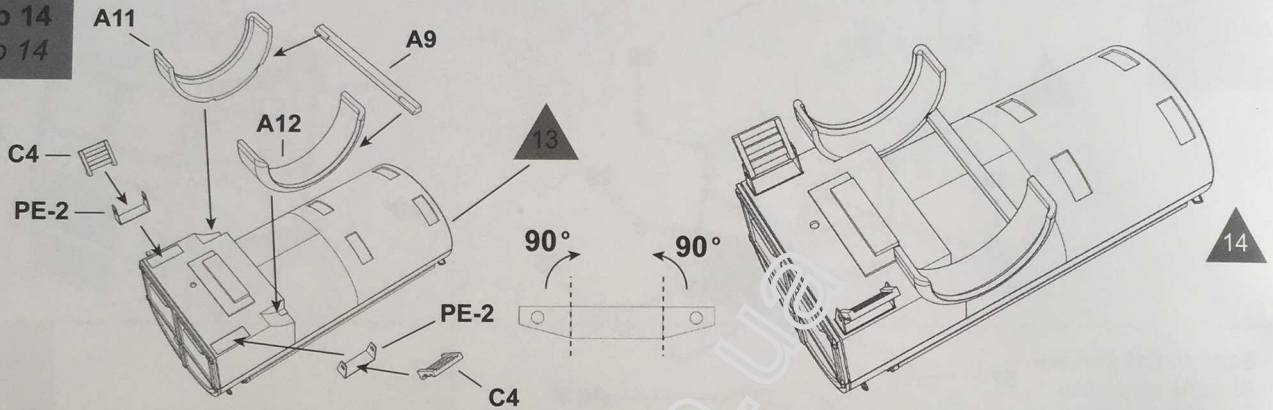

Step 15
Etap 15

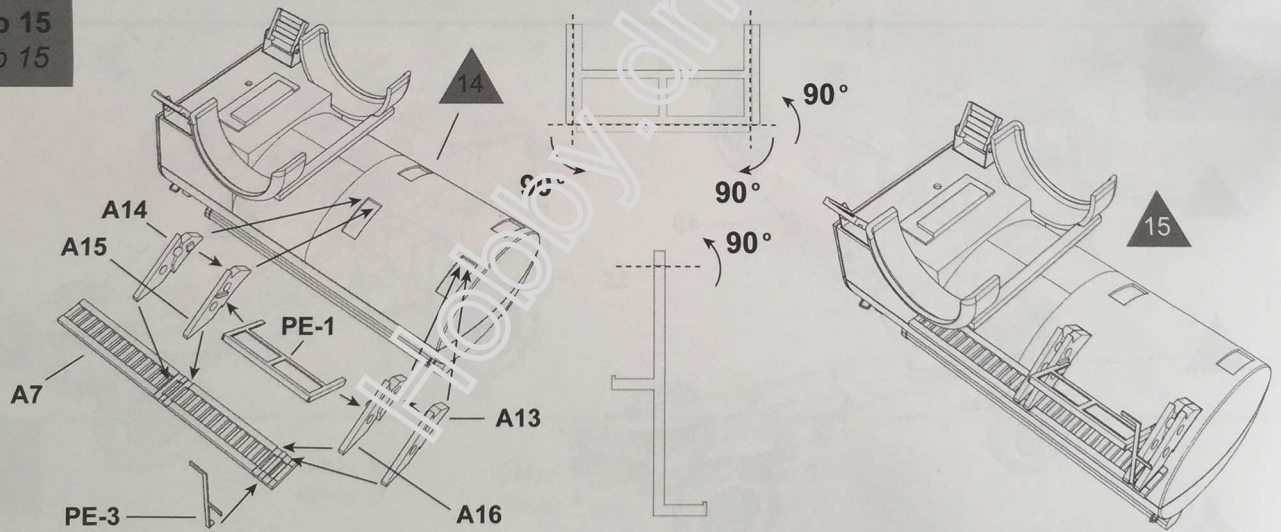

Step 16
Etap 16

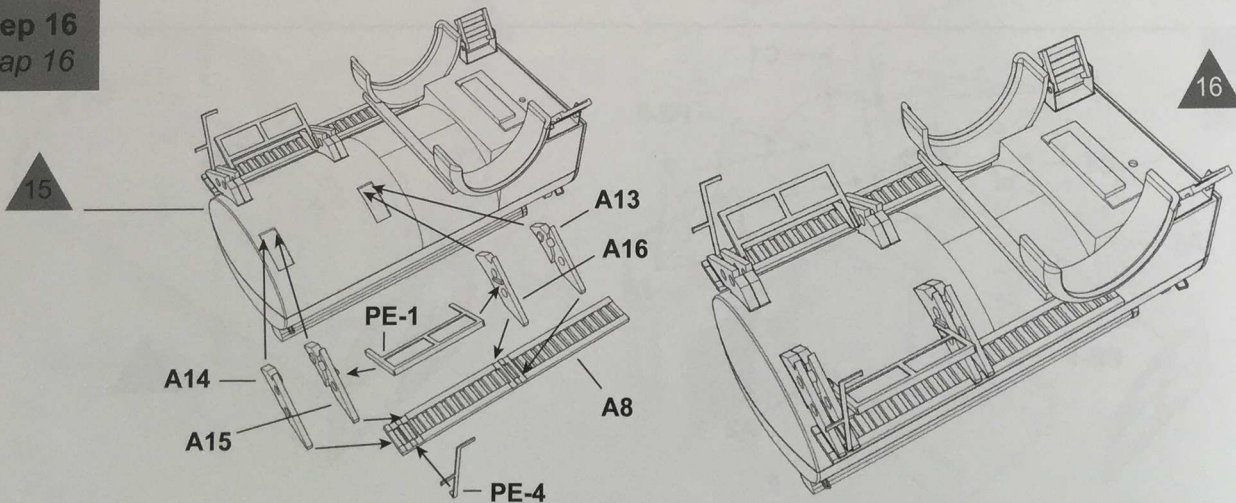

Step 17
Etap 17

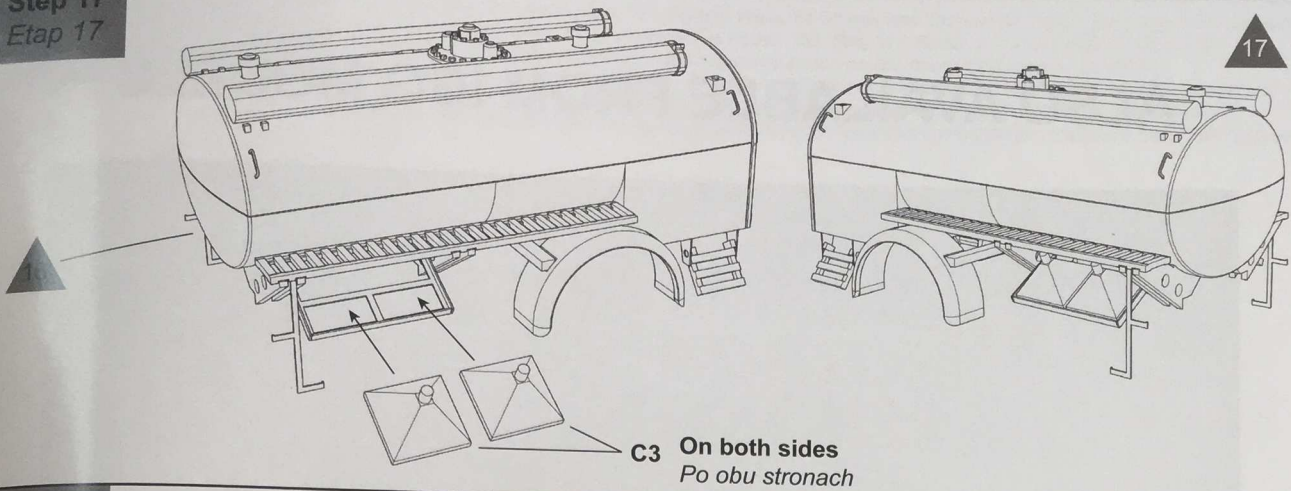

C3 On both sides
Po obu stronach

Step 18
Etap 18

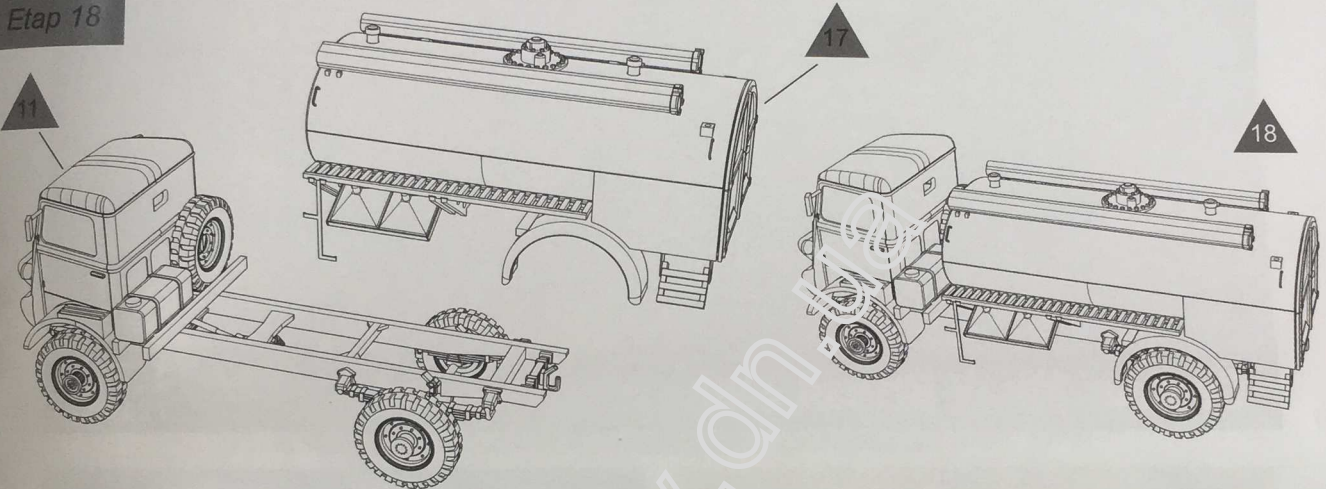

Step 19
Etap 19

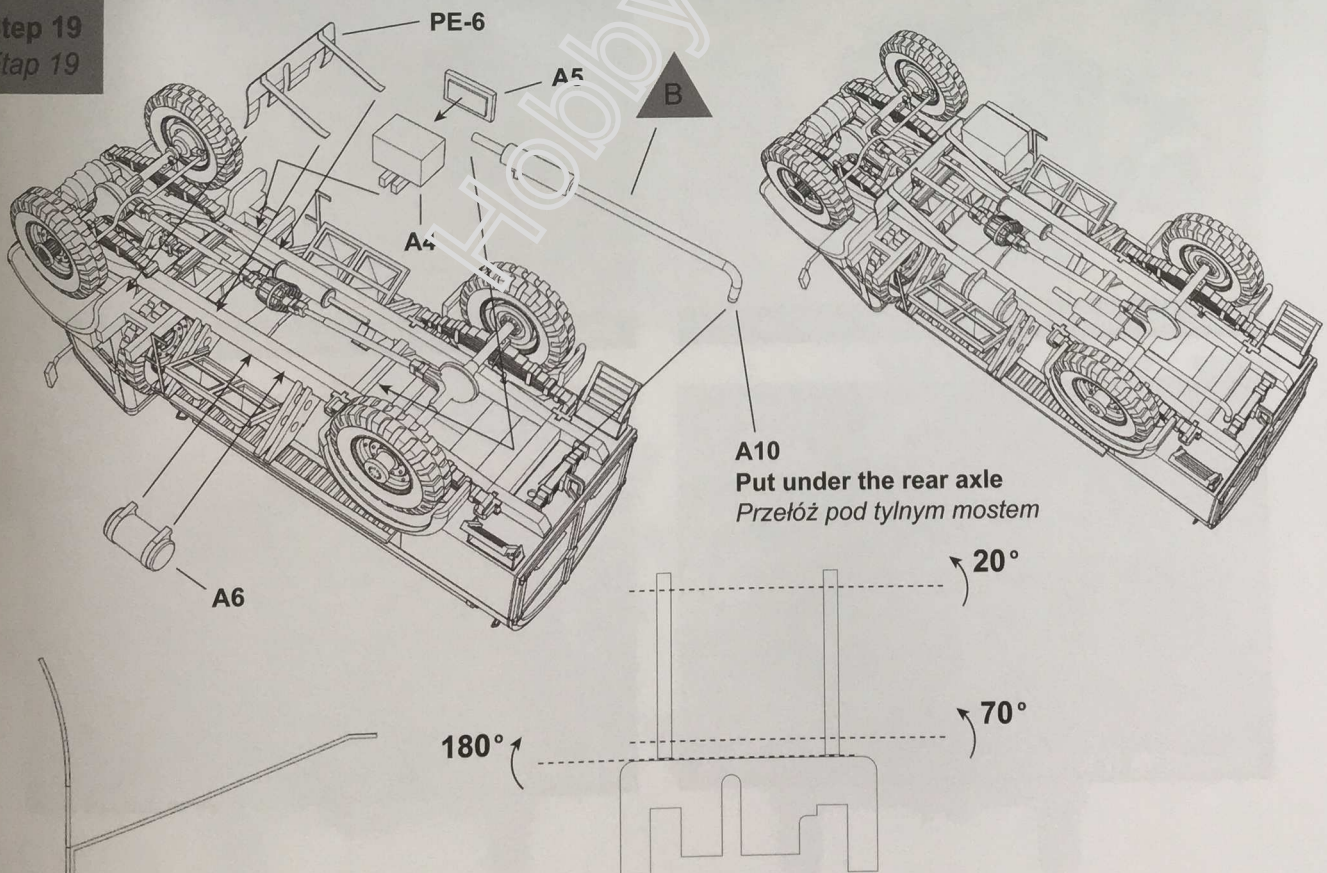

A10
Put under the rear axle
Przełoż pod tylnym mostem

180°

20°

70°

ALSO AVAILABLE FROM IBG MODELS



Centaur Mk.IV British Tank

1:72
72108



Italian Autocannone 3Ro with 90/53 90mm Anti Air Gun

1:72
72096



Scammell Pioneer Tank Transporter with TRCU30 Trailer

1:72
72080



Cromwell Mk.IV British Tank (Hull type C)

1:72
72102



V3000S/SSM Maultier German Halftrack with Flak 38

1:72
72075

1

Painting
Malowanie

RAF Bedford QL Tanker from 131 (Polish) Wing, 84 Group, 2nd Tactical Air Force, Germany, Varrelbusch, mid-1945. At that time Wing consisted of Polish 302, 308, 317, Dutch 322 and Belgian 349 Spitfire Squadrons. Vehicle had a wrong type number painted on the door (1308 instead of 1307).
RAF Bedford QL Tanker, 131 (Polskie) Skrzydło, 84 Grupa, 2 Taktyczne Siły Powietrzne, Niemcy, Varrelbusch, połowa 1945. W tym czasie w skład Skrzydła wchodziły polskie dywizjony 302, 307 i 317, holenderski 322 i belgijski 349 wyposażone w myśliwce Spitfire. Pojazd miał namalowane błędne oznaczenie typu (1308 zamiast 1307).

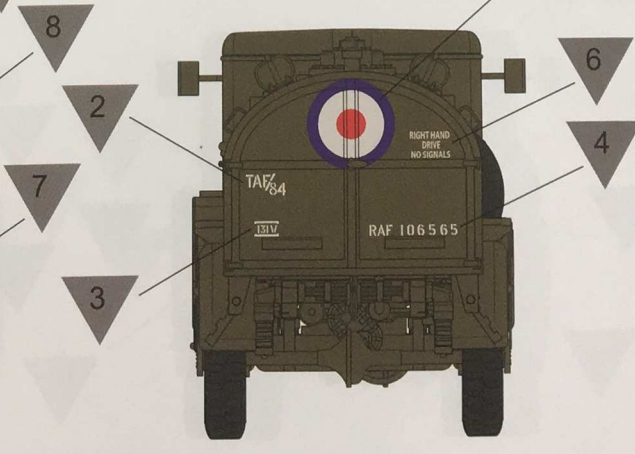
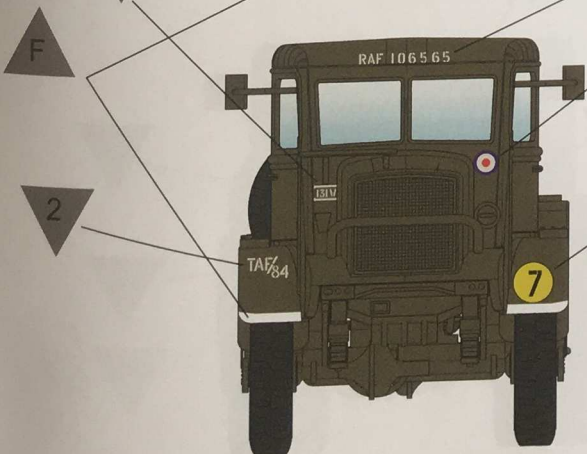
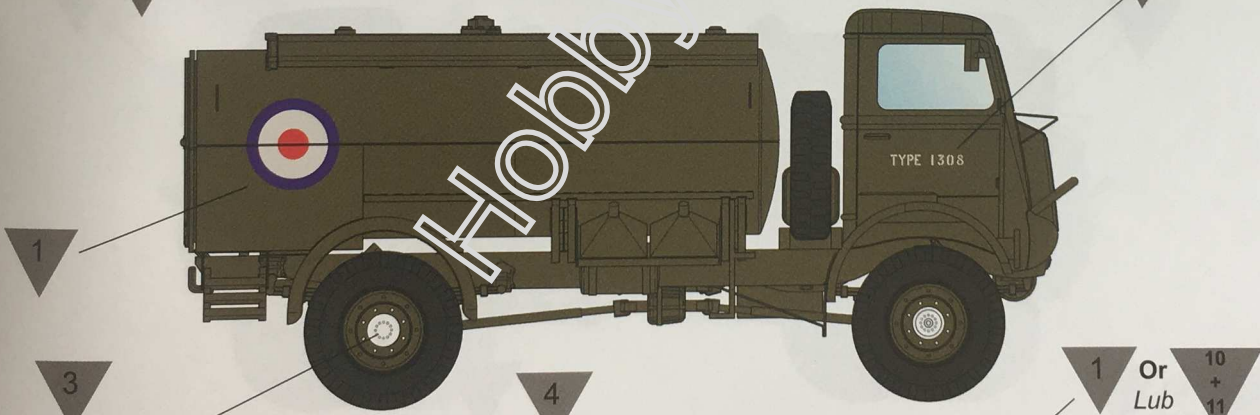
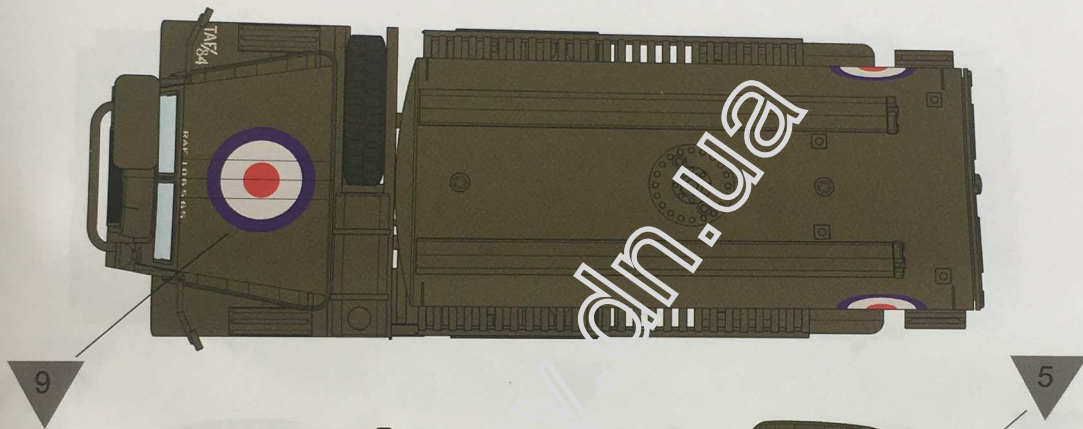
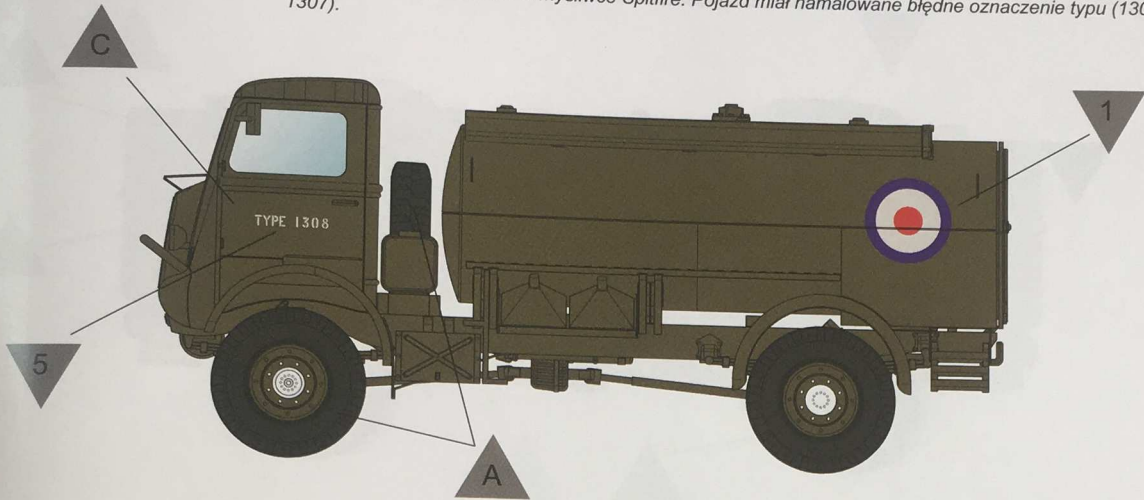

RAF Bedford QL Tanker, 139 Airfield (renamed to 139 Wing on 12th May 1944), 2 Group, 2nd Tactical Air Force, England, Dunsfold, Spring 1944. Unit consisted of 98, 180 and Dutch 320 squadrons flying Mitchell bombers.

RAF Bedford QL Tanker, 139 Polowy Port Lotniczy (przemianowany 12.05.1944 na 139 Skrzydło), 2 Grupa, 2 Taktyczne Siły Powietrzne, Anglia, Dunsfold, wiosna 1944. W skład jednostki wchodziły dywizjony 98, 180 i holenderski 320 wyposażone w bombowce Mitchell.

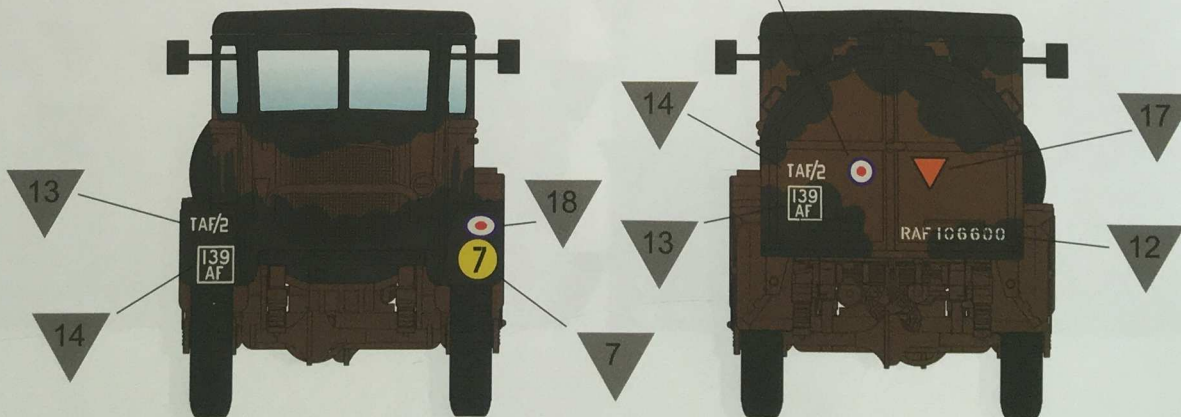
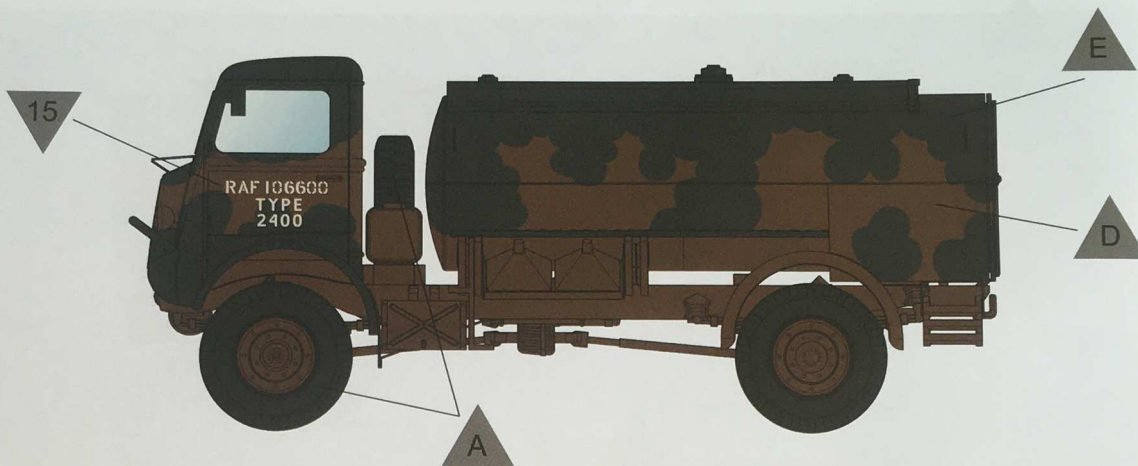

3

Painting Malowanie

RAF Bedford QL Tanker, 139 Wing, 2 Group, 2nd Tactical Air Force, Belgium, Melsbroek, March 1945
Unit consisted of 98, 180 and Dutch 320 squadrons flying Mitchell bombers.

RAF Bedford QL Tanker, 139 Skrzydło, 2 Grupa, 2 Taktyczne Siły Powietrzne, Belgia, Melsbroek, marzec 1945
W skład jednostki wchodziły dywizjony 98, 180 i holenderski 320 wyposażone w bombowce Mitchell.

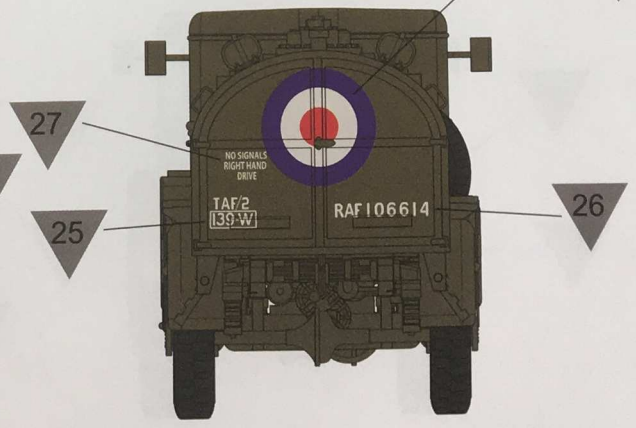
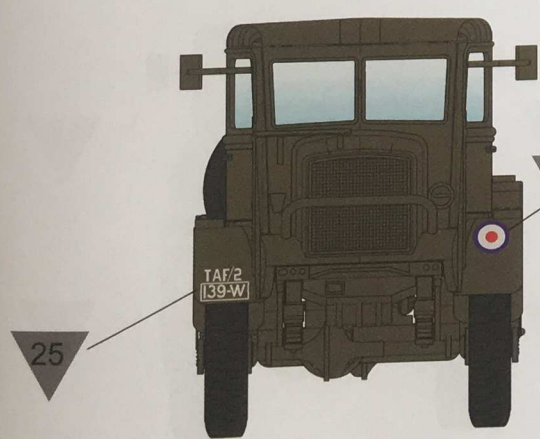
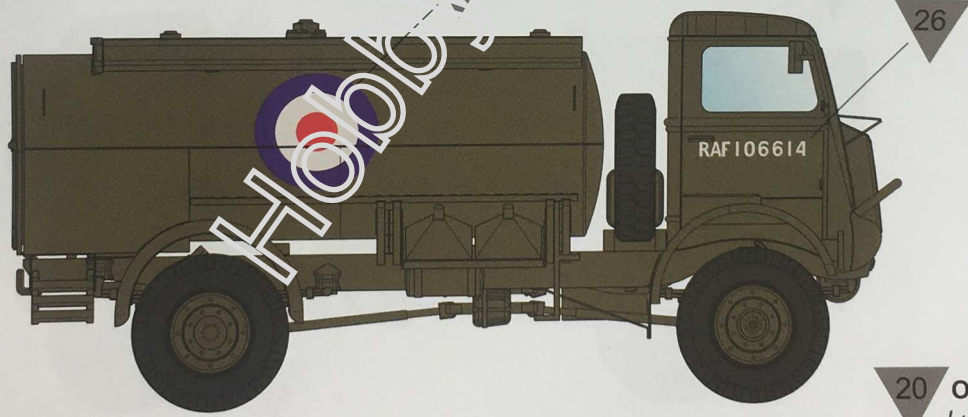
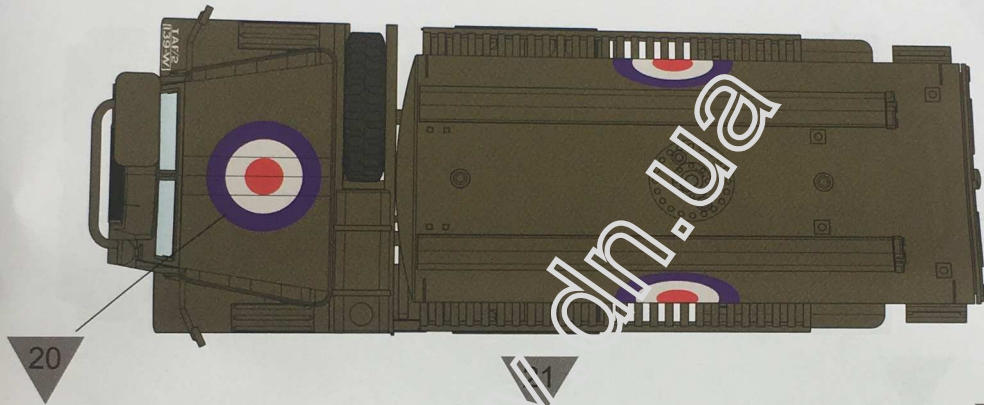

4

Painting Malowanie

124 Wing, 83 Group, 2nd Tactical Air Force, Eindhoven, Autumn 1944. Unit consisted of 137, 181, 182 and 247 squadrons flying Typhoon fighter-bombers.
124 Wing, 83 Group, 2nd Tactical Air Force, Eindhoven, jesień 1944. W skład jednostki wchodziły dywizjony 137, 181, 182 i 247 wyposażone w samoloty myśliwsko-bombowe Typhoon.

