

5035

MILITARY MINIATURE SERIES

RFM
RYEFIELD MODEL®

STURMTIGER

**RM61 L/5.4/ 38CM
w/workable track links****德国“突击虎”自行火炮 シュトルムティーガー**

ASSEMBLY ICONS

**OPTIONAL**
选择**CEMENT**
膠水**DO NOT CEMENT**
不使用膠水**INSTANT CEMENT**
瞬間接著劑**BEND**
彎折**MAKE 2**
製作2組**OPEN HOLE**
鑽孔**REMOVE**
切除**BE CAREFUL**
注意**APPLY DECAL**
貼上水貼紙

CAUTION!

Read carefully and fully understand the instructions before commencing assembly. Supervising adult should also read the instructions if a child assembles the model. When you used glue or paint, do not use near a naked flame, and use in a well-ventilated room. When assembling this kit, tools including knives are used. Extra care should be taken to avoid personal injury. Read and follow the instructions supplied with paints and/ or cement. Use plastic cement and paints only. Keep out of reach of small children. Children must not be allowed to suck any part, or pull vinyl bag over the head.

在裝配前仔細閱讀說明並完全理解。小孩裝配時需成人看護且需仔細閱讀說明。使用膠水和油漆時，應遠離火源並打開窗戶保持空氣流通。製作時請格外注意工具刀和零件的鋒利尖銳部分，避免對身體造成傷害。在使用膠水和油漆前仔細閱讀注意事項，按照說明正確使用膠水和油漆。請將本品放在兒童接觸不到的地方，套件中的塑膠包裝袋會對兒童造成窒息的危險。

PARTS・部品图

A (x1)

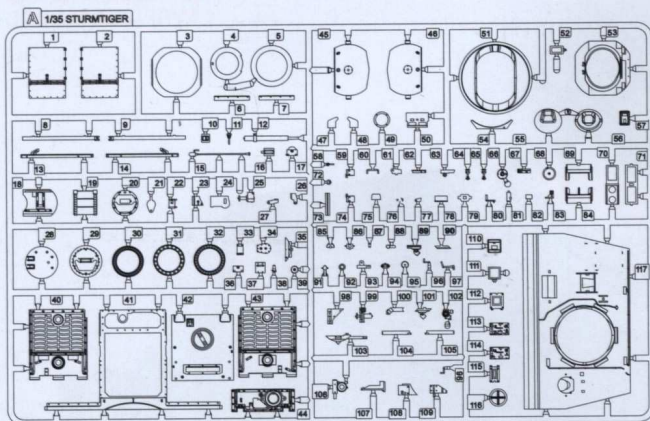

D (x2)

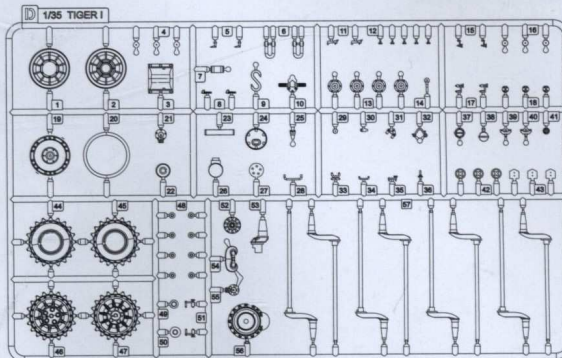

L (x1)

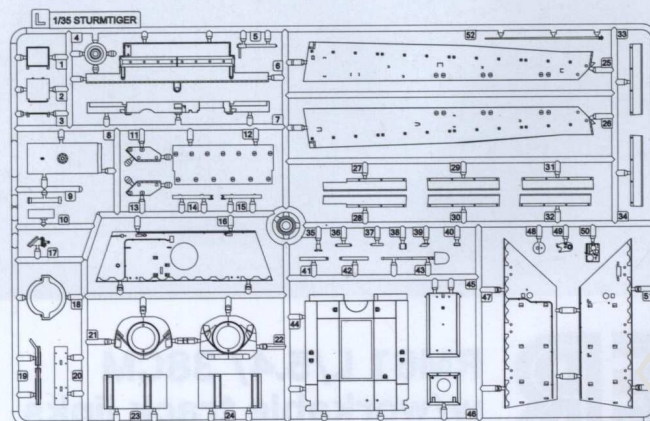

F (x1)

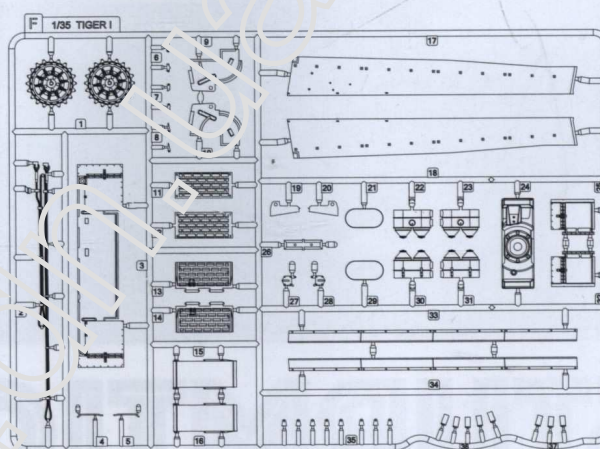

O (x1)

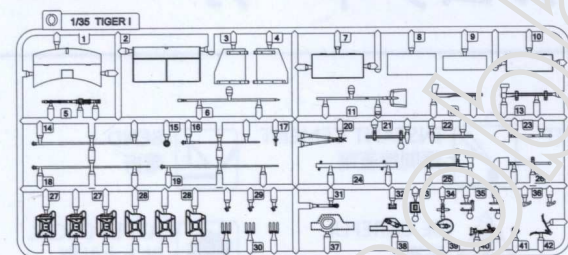

C (x2)

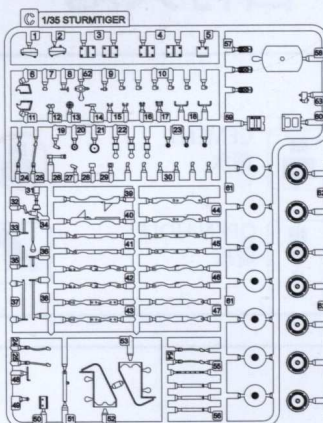

Tracks (x216 pcs)



Metal Cable: 10cm



Poly Cap



X (x2)

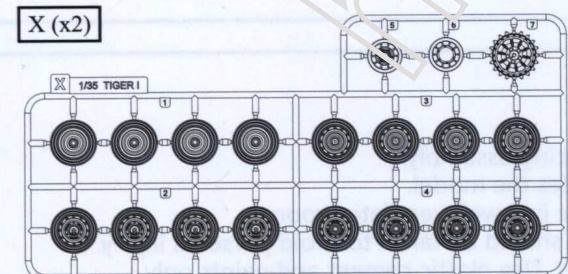

N (x4)

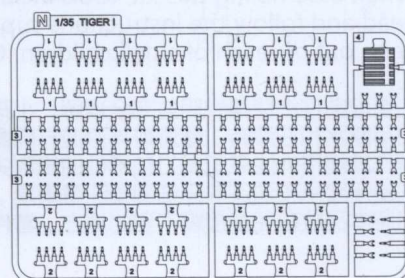

E (x1)

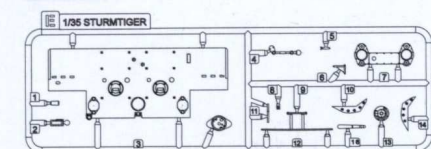

Upper Hull (x1) & B (x1)

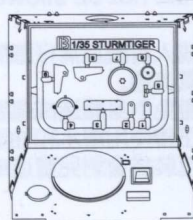

PARTS · 部品图

Lower Hull (x1)

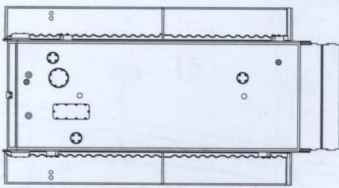

T (x1)

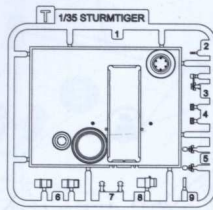

Decal (x1)

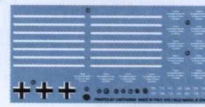

Y (x1)

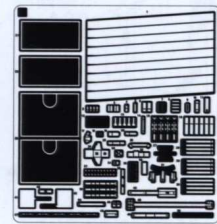

1

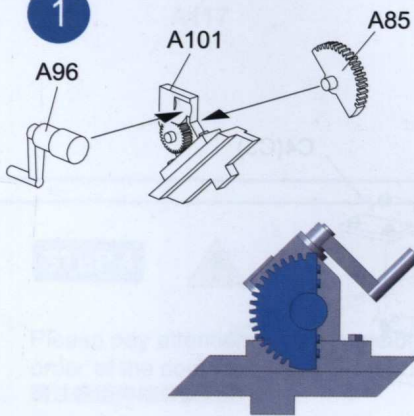

Make 4
制作4组

2



Make 4
制作4组

3

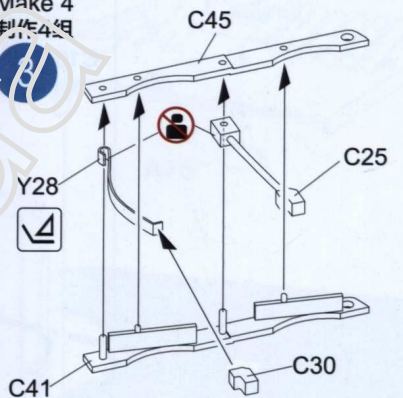

4

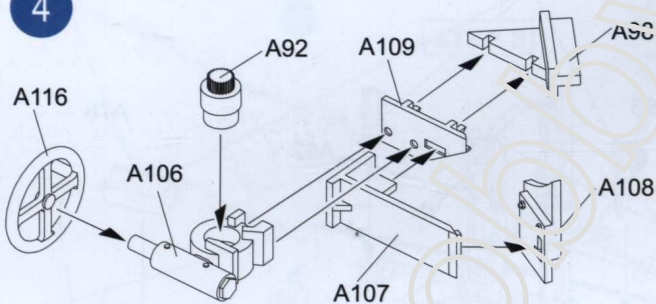

5

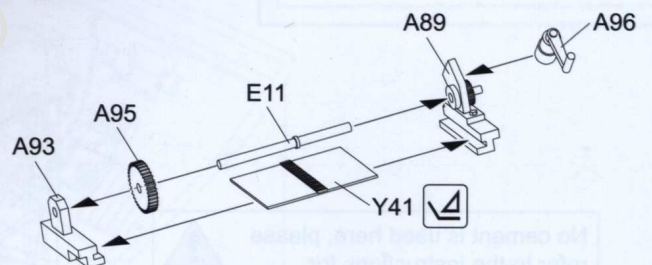

Make 2
制作2组

6



7

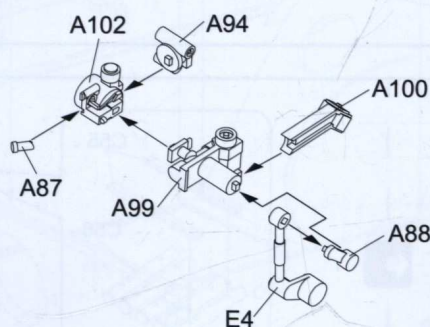

8

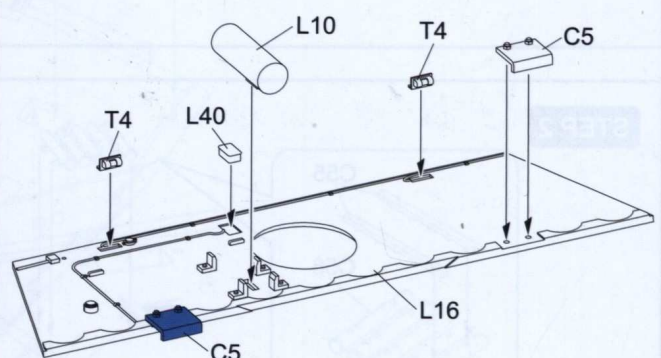

STEP 1

Make 2
制作2组

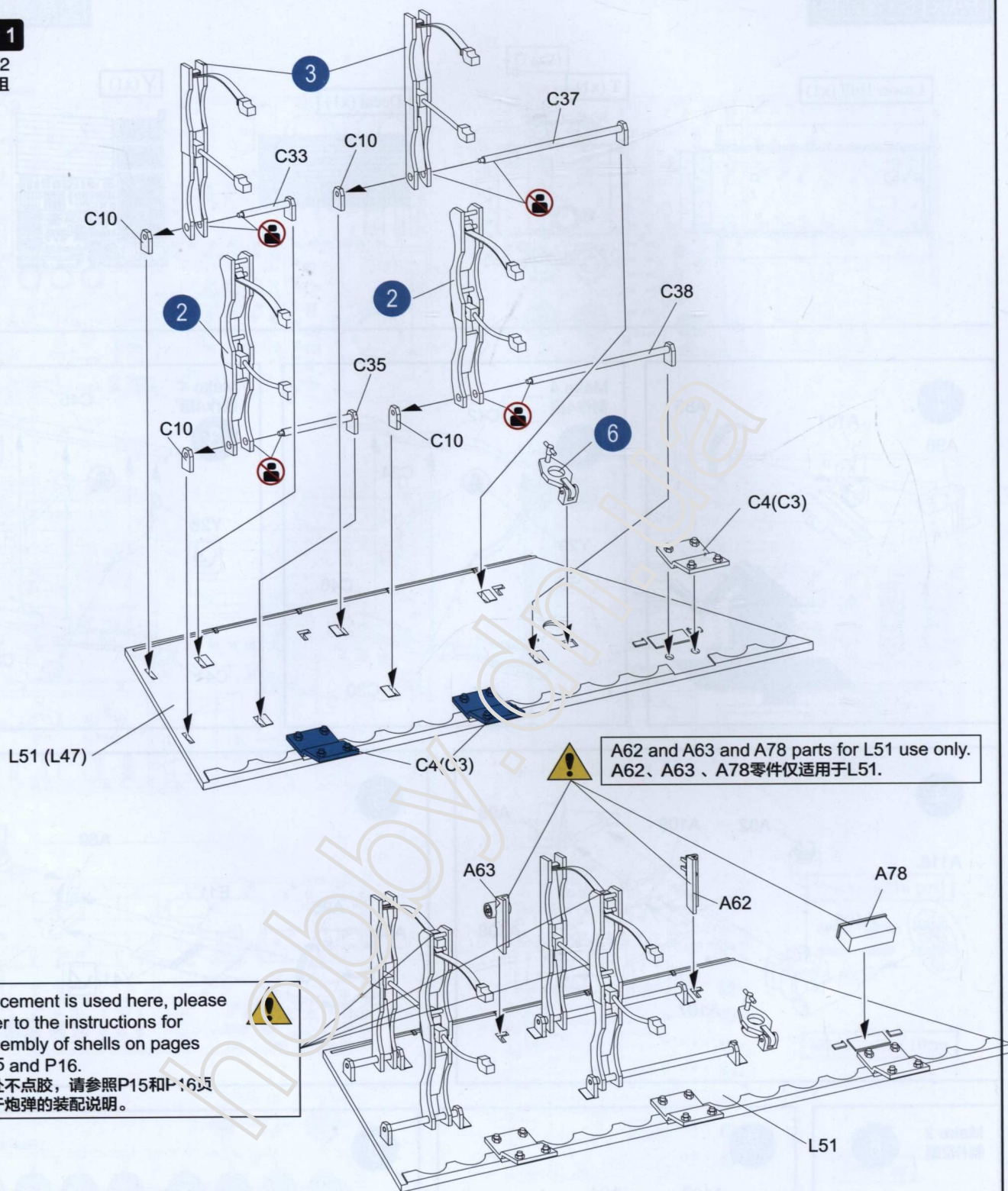

STEP 2

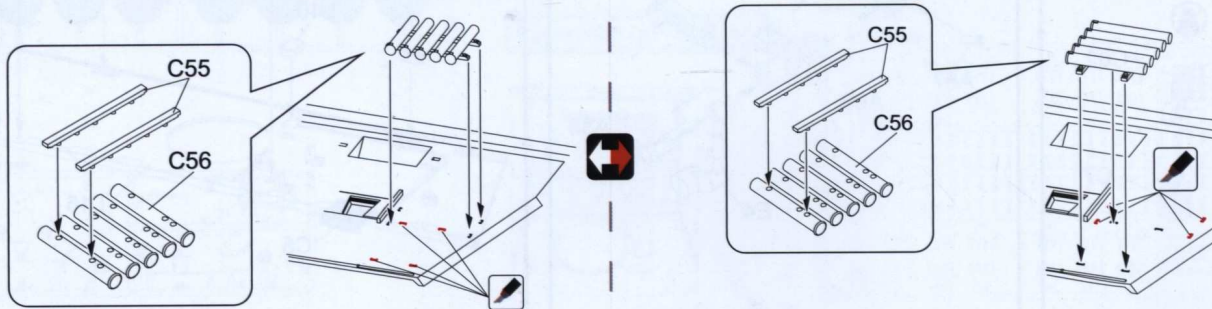

STEP 3

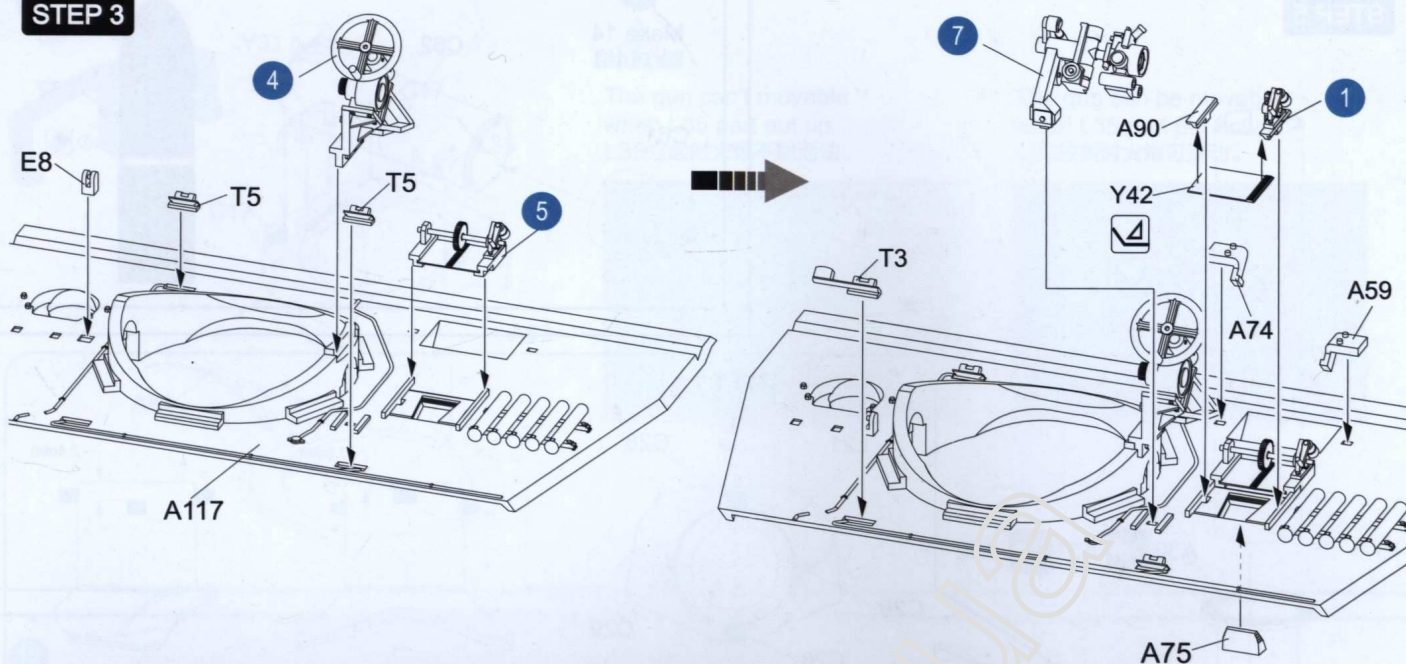

STEP 4



Please pay attention to the assembly order of the components.
 请注意组件的装配顺序。

STEP 4

8

STEP 3

STEP 1

STEP 2

L47

T6

A50

A69



A84

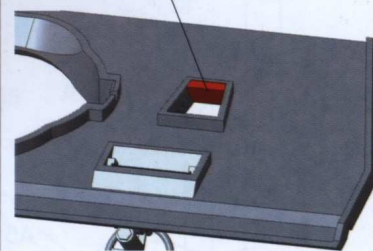

STEP 5

10

Make 14
制作14组

C61

C62

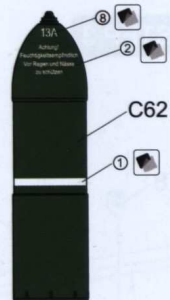

C62

1

1:1 Scale 比例 1:1

L21

C28

C29

C28

Top View
顶视图

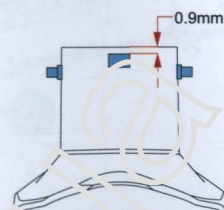

Front View
正视图

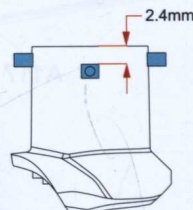

Side View
侧视图

A30

A31

A32

A51

A55

A56

L48

L8

A45

C58

A46

C58

Y37x8

Y37 (Y37)

Poly Cap
橡胶圈

Poly Cap
橡胶圈

Y37x8

Top View: 1:1 Scale
顶视图: 比例 1:1



11

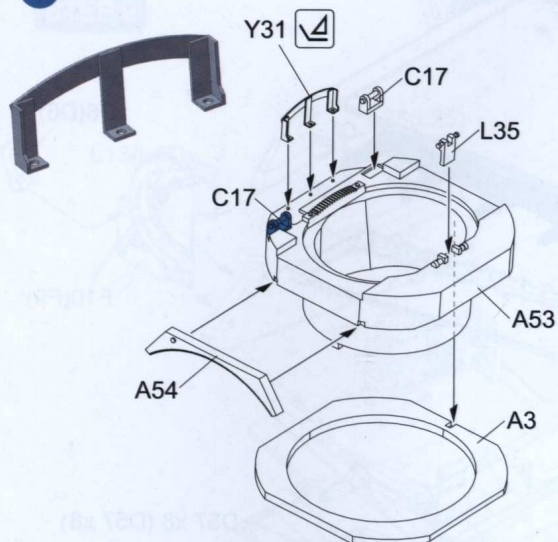

The gun can't movable
when L35 part put up.
L35立起时火炮不能活动。

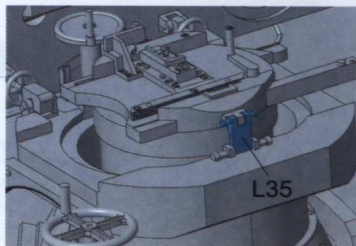

The gun can be movable
when L35 part put down.
L35放倒时火炮可活动。

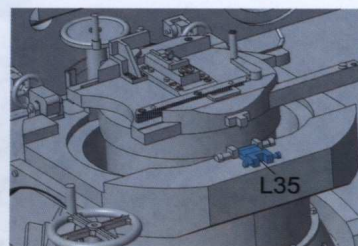

12

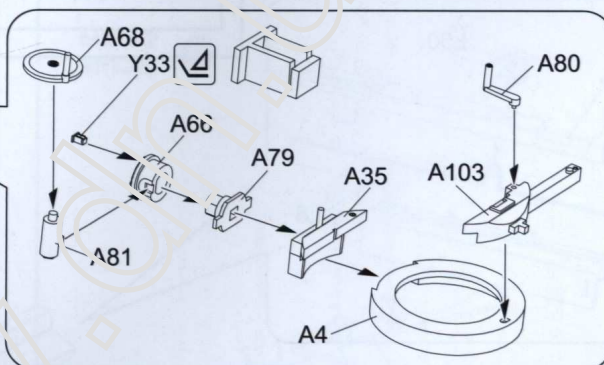
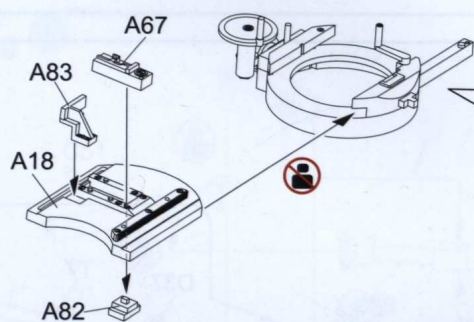

STEP 6

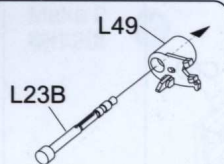
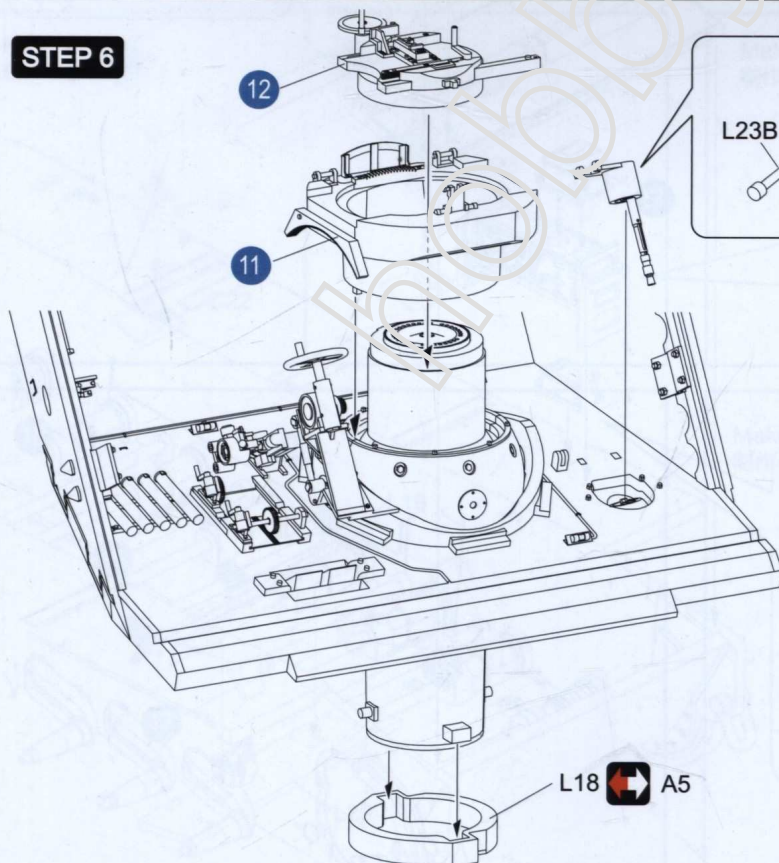

Cloesed
关闭

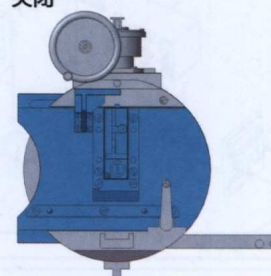

Open
打开

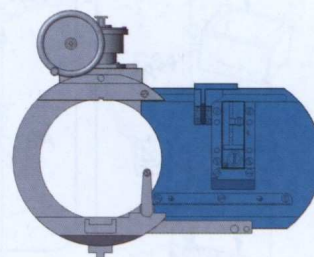

STEP 7

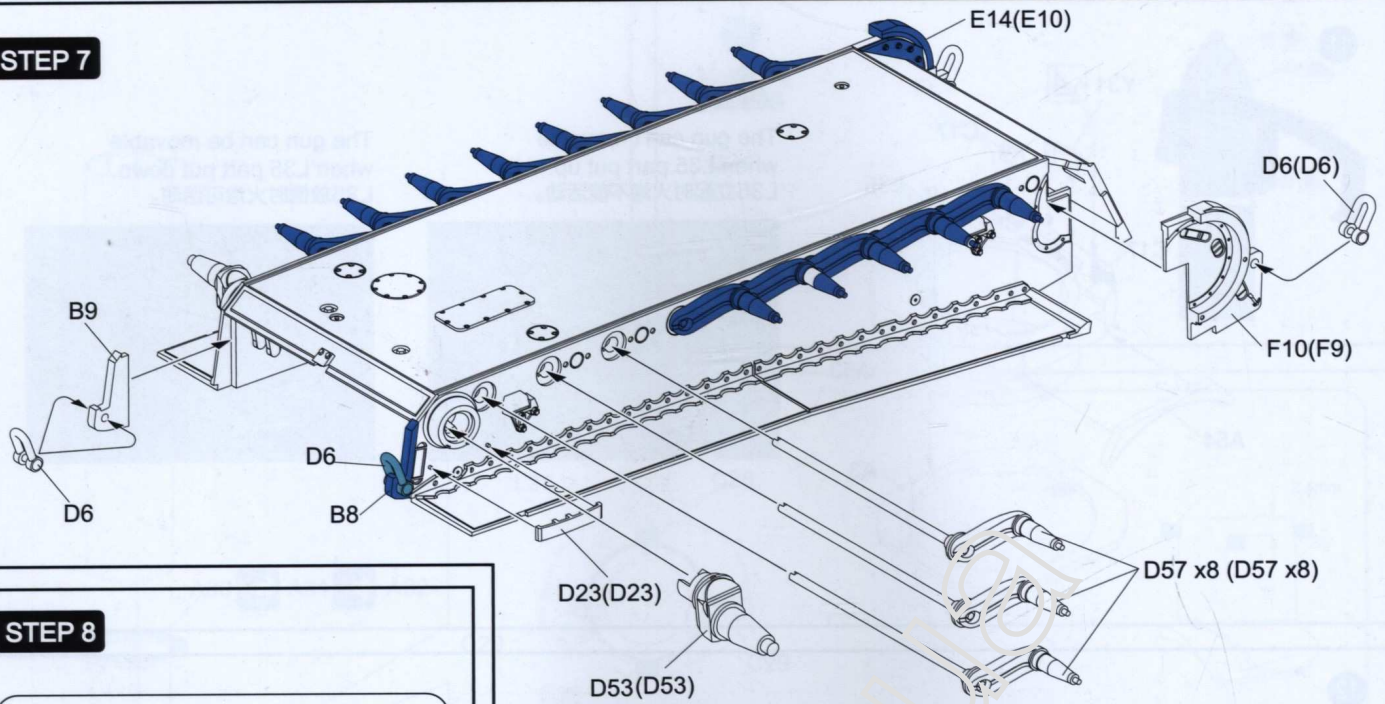

STEP 8

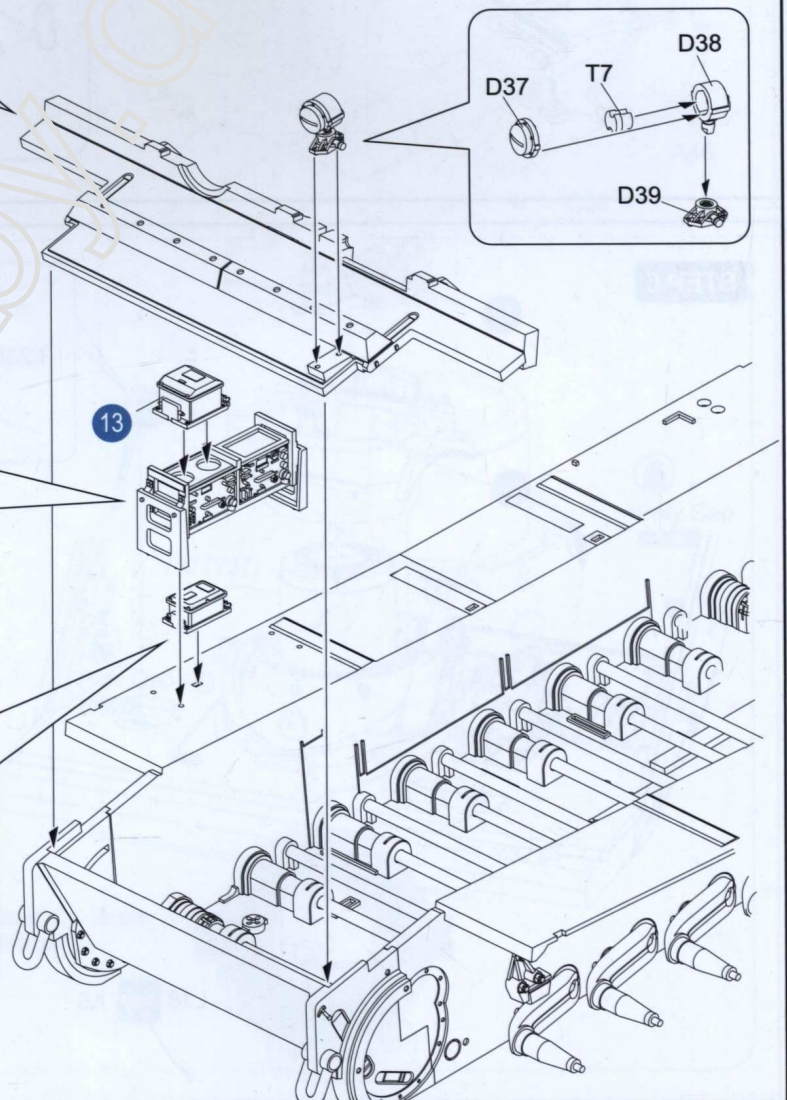
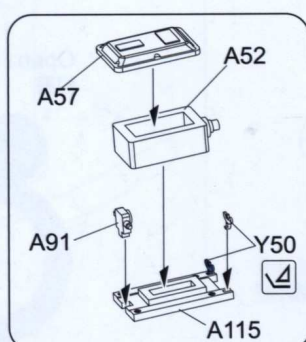
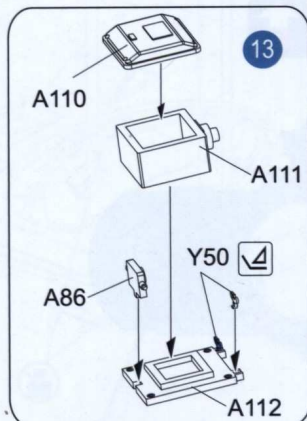
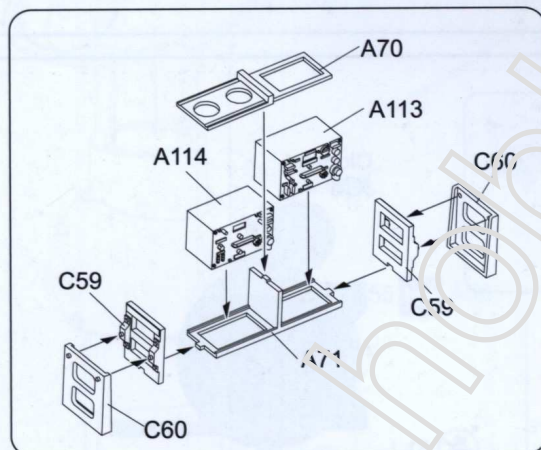
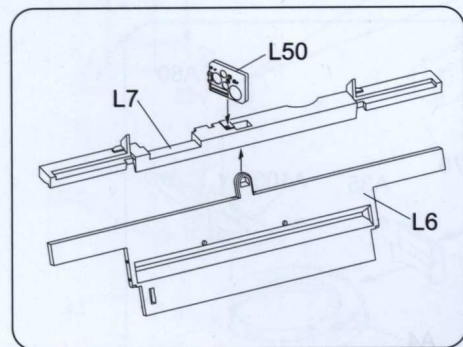

STEP 9

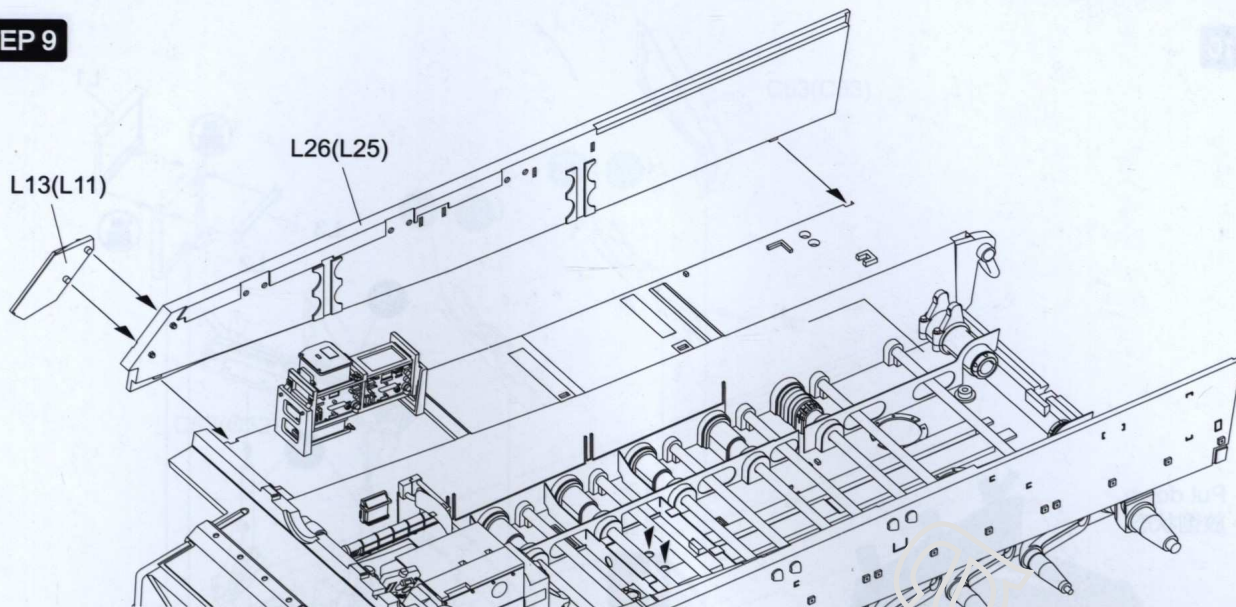

Make 2
制作2组 15

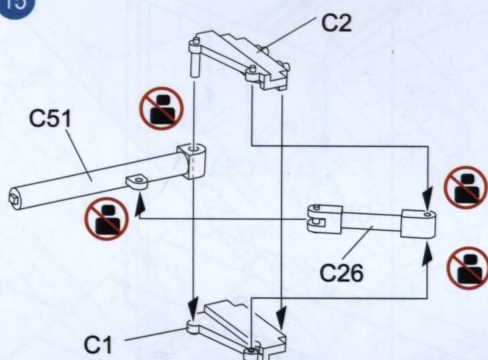

Make 2
制作2组 19

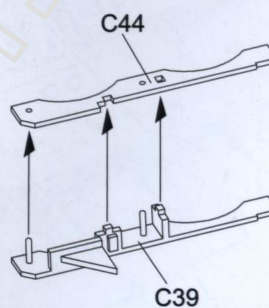

Make 5
制作5组 16

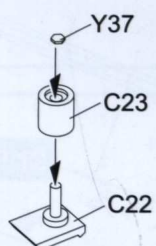

Make 2
制作2组 20

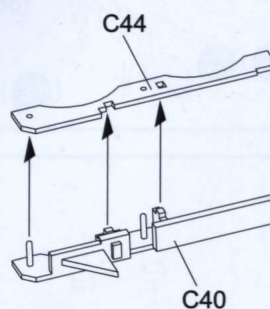

Make 4
制作4组 21

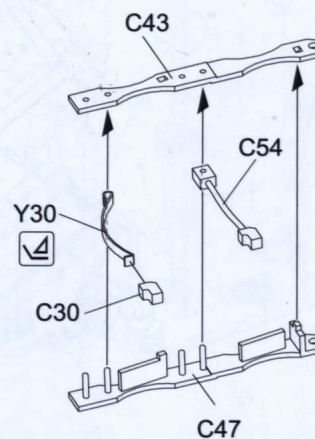

18

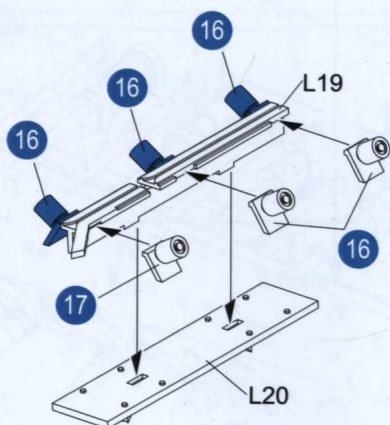

STEP 10

Put down
放倒状态

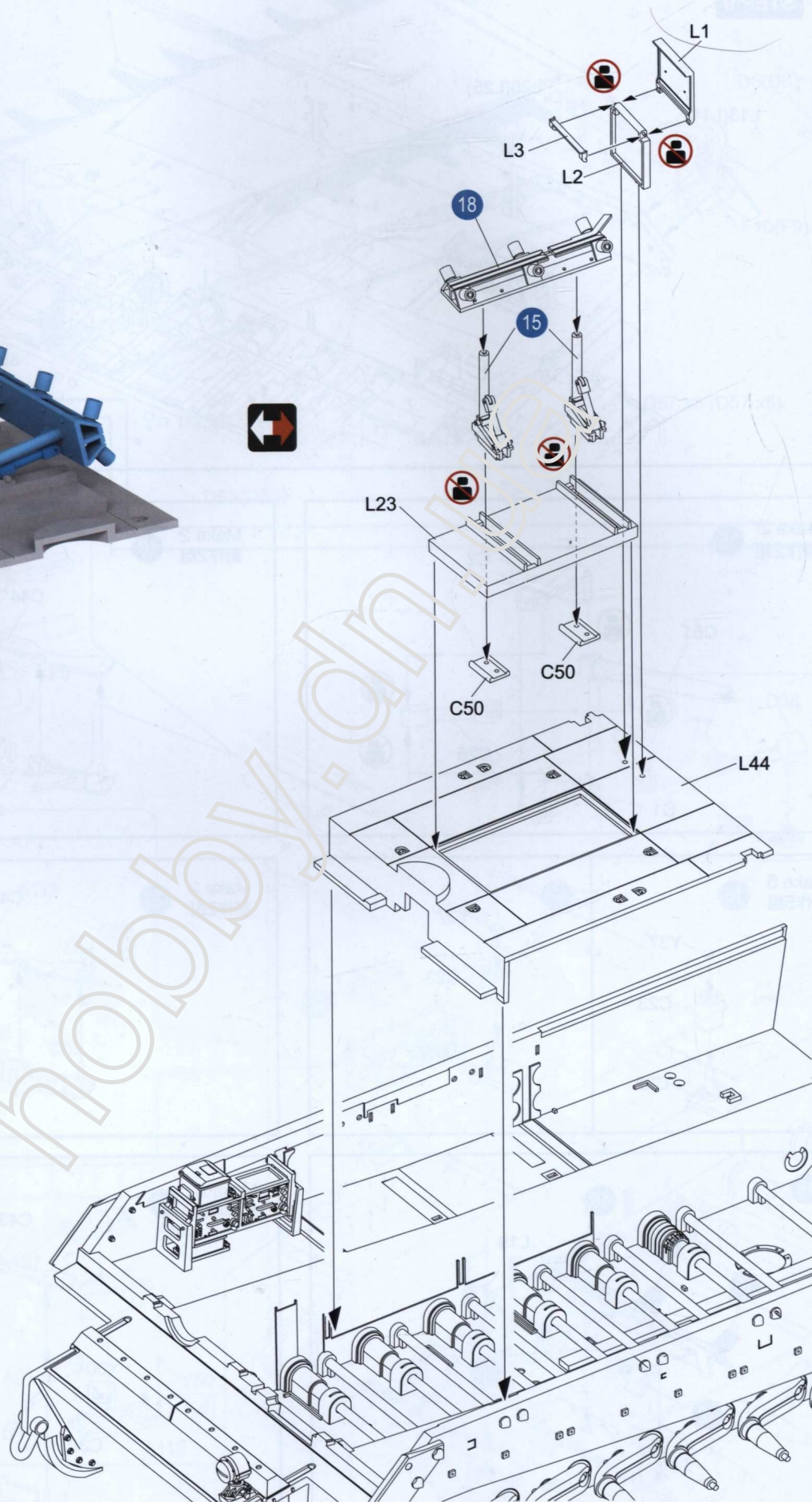

STEP 11

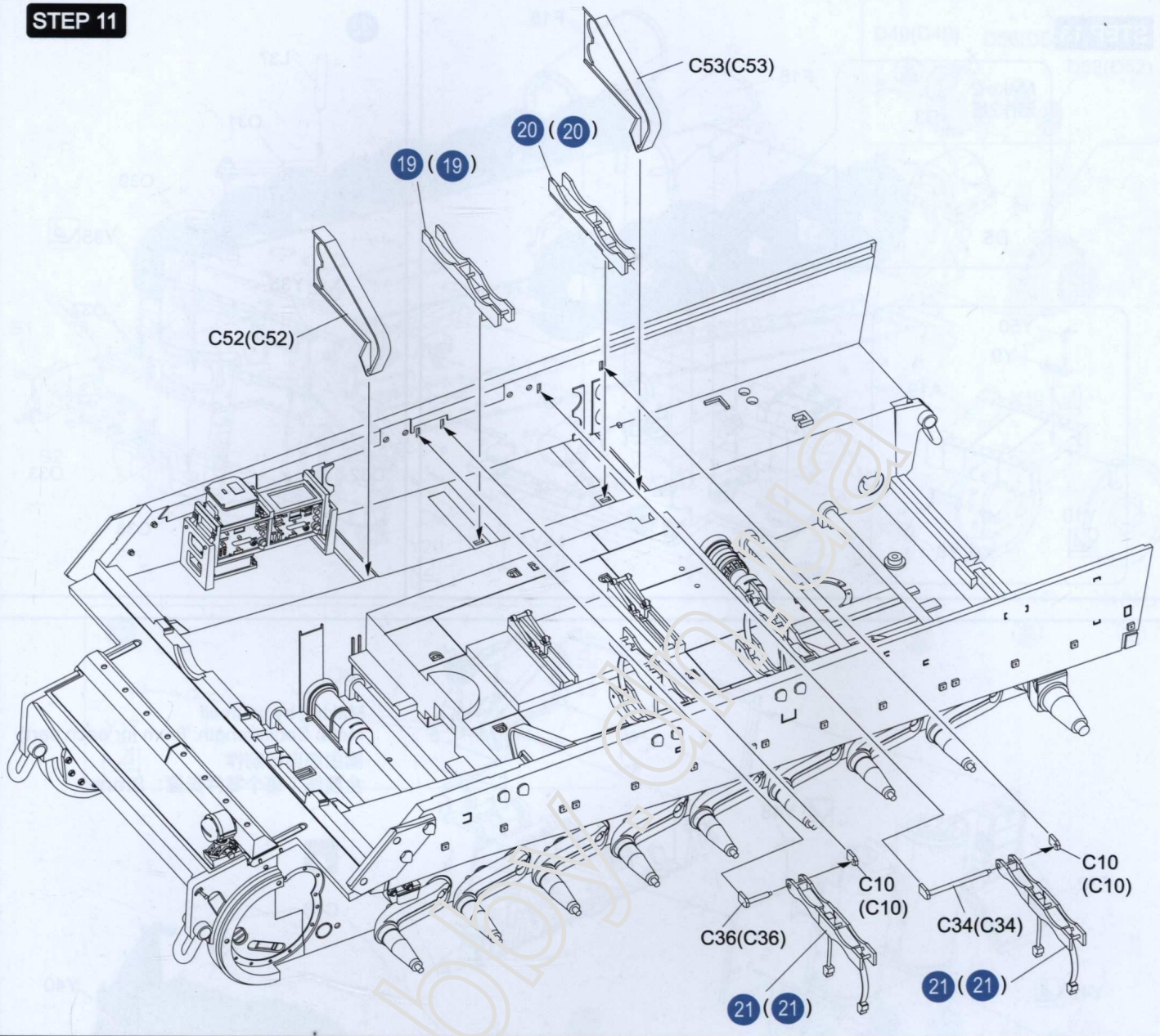

STEP 12

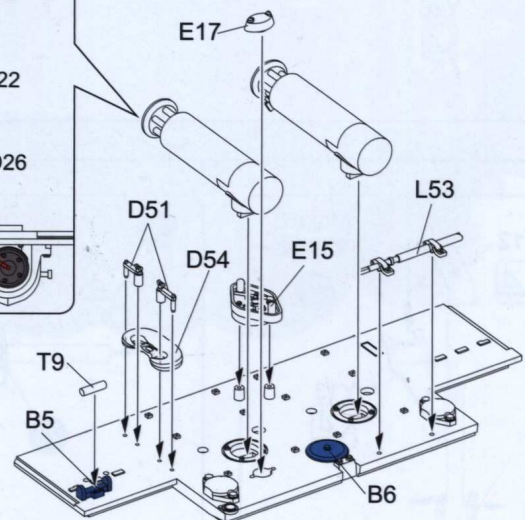
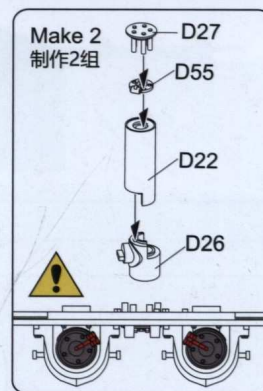
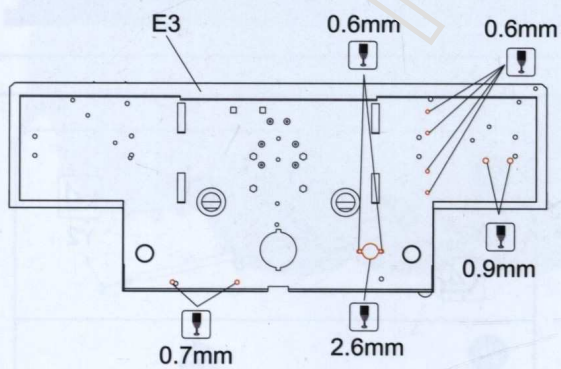

STEP 13

Make 2
制作2组

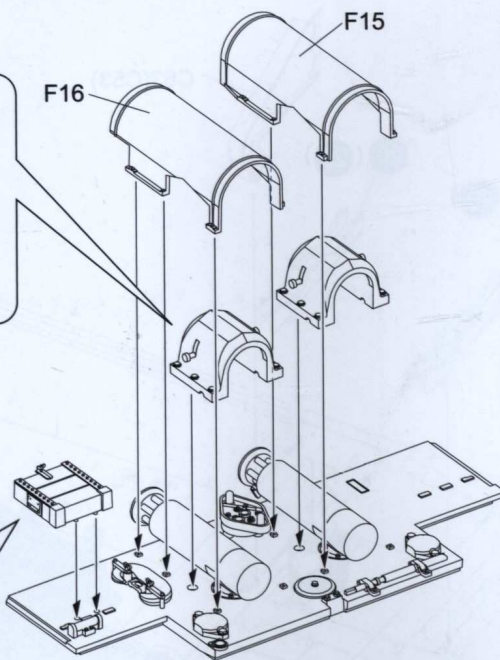
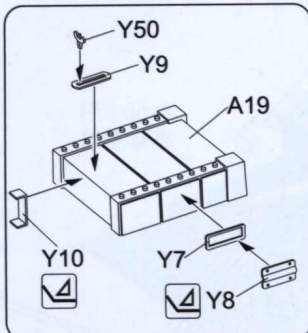
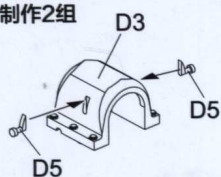

22

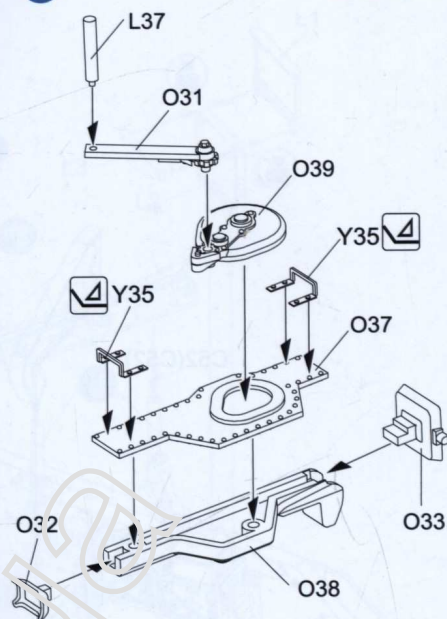

Making by yourself
Metal Cable(length: 8mm for each part)
需由您自行制作
金属线 (每个零件长度: 8mm)

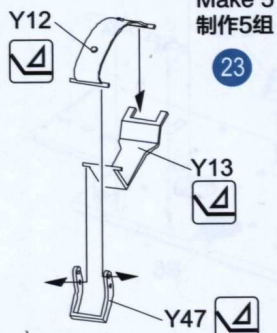
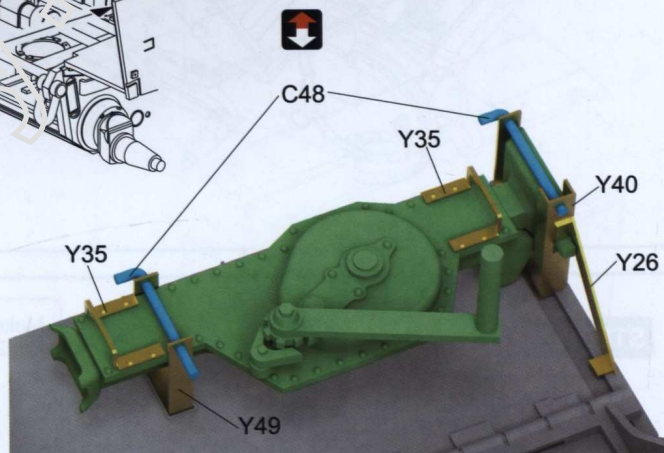
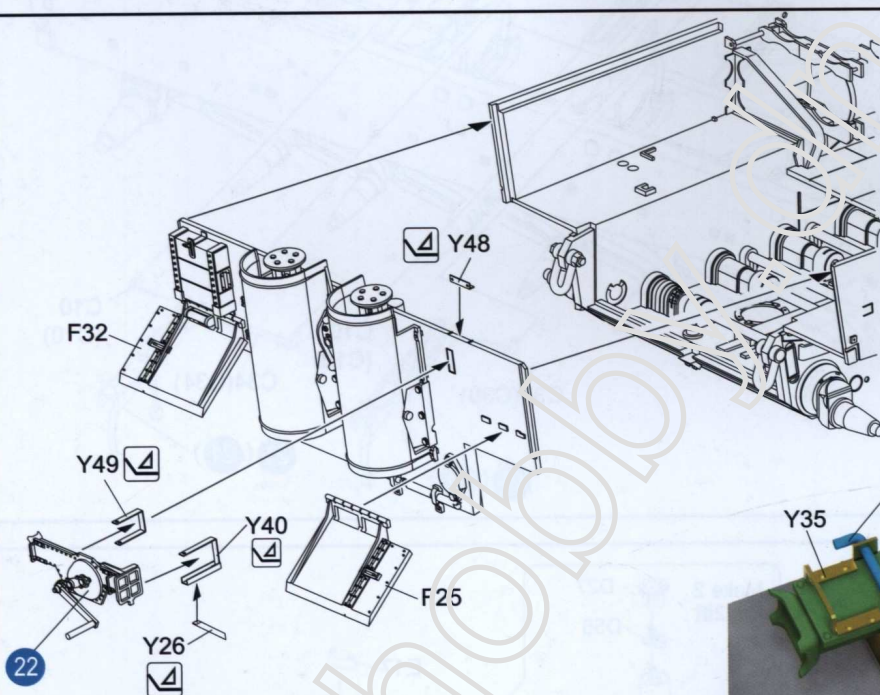

Make 5
制作5组

23

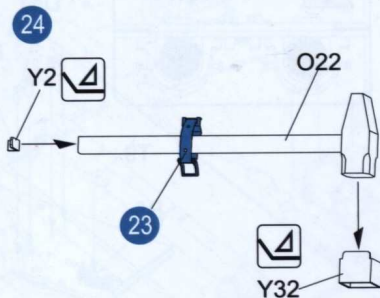

24

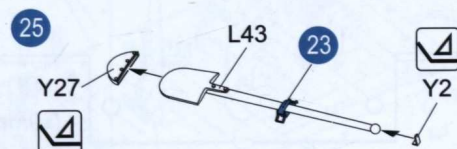

25

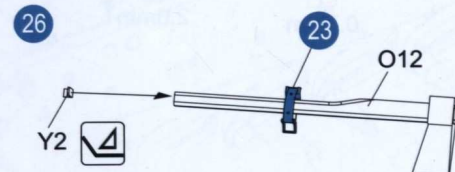

26

STEP 14

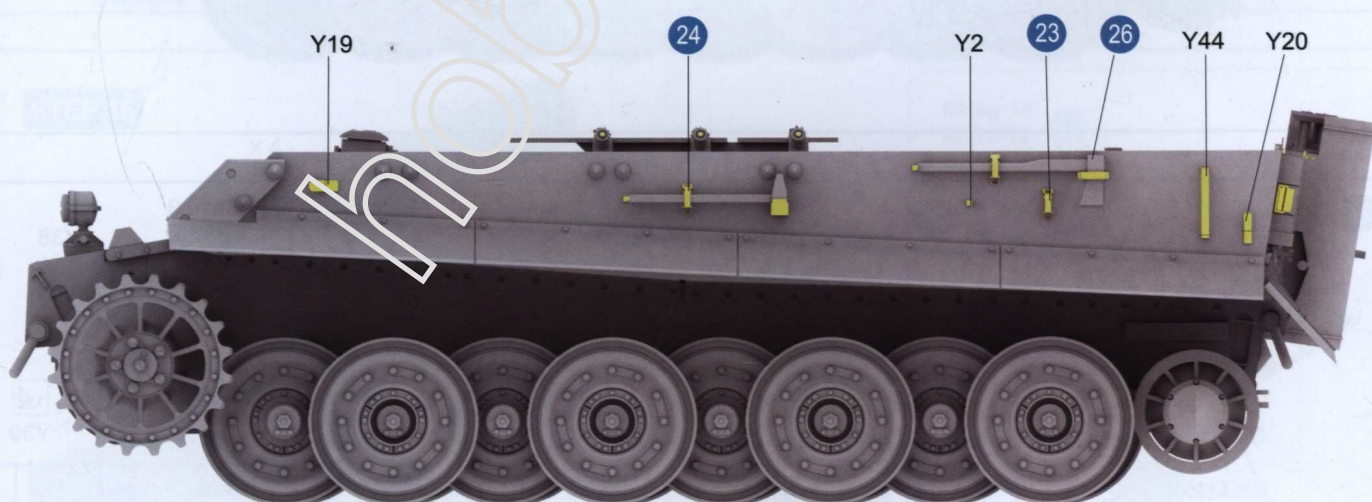
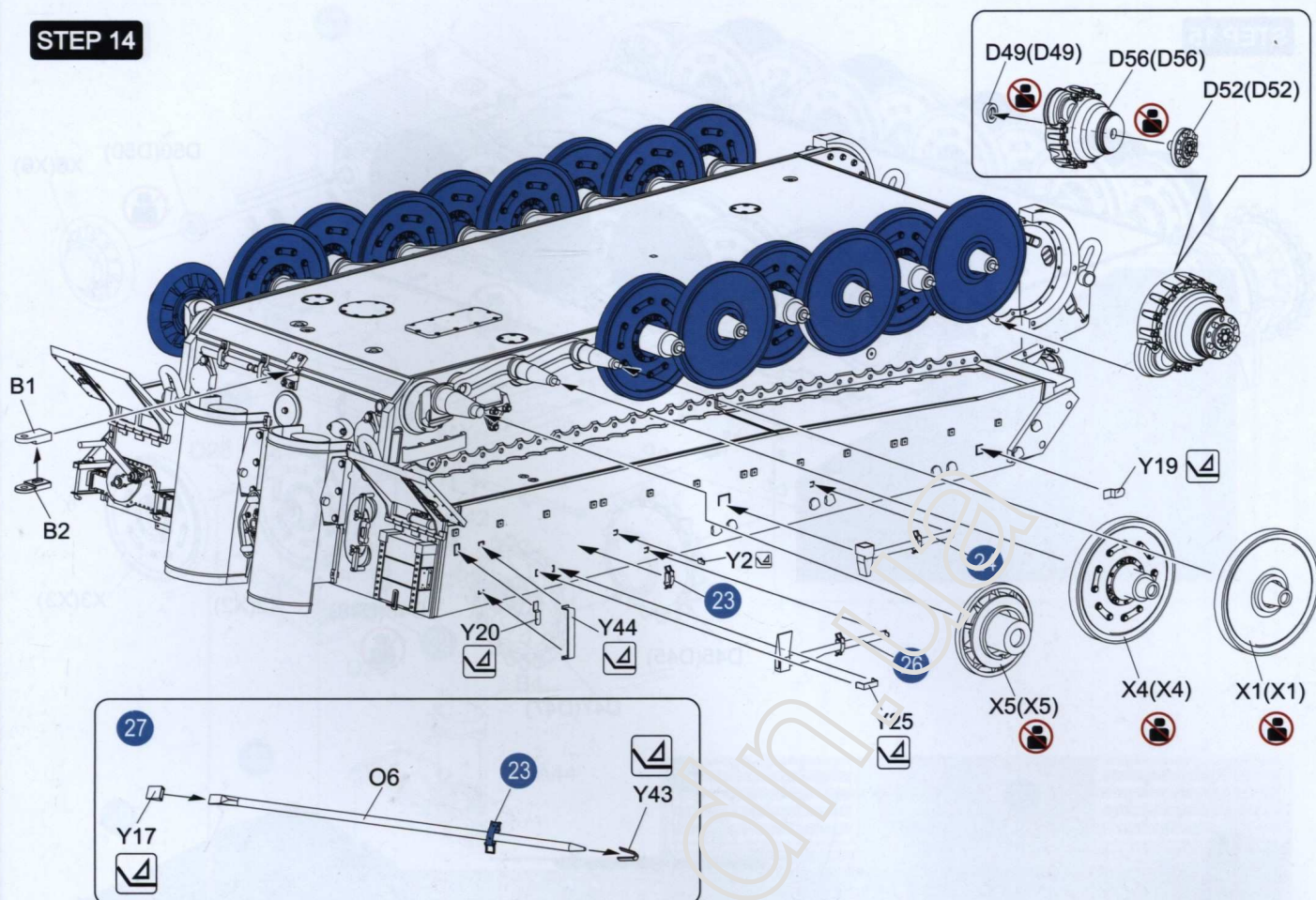

STEP 15

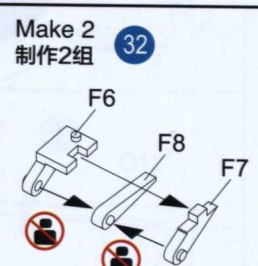
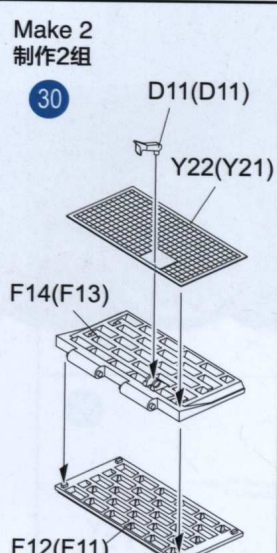
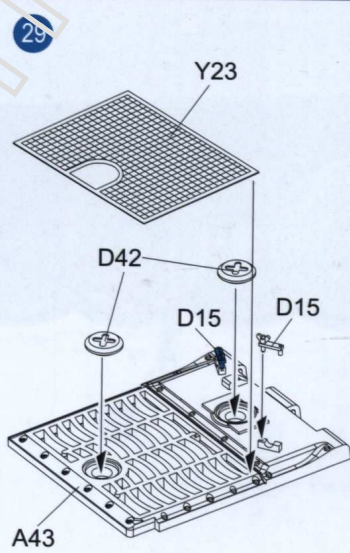
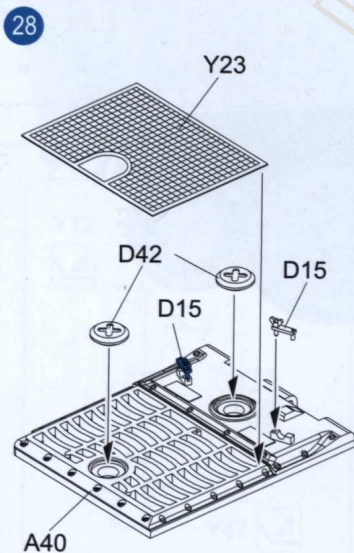
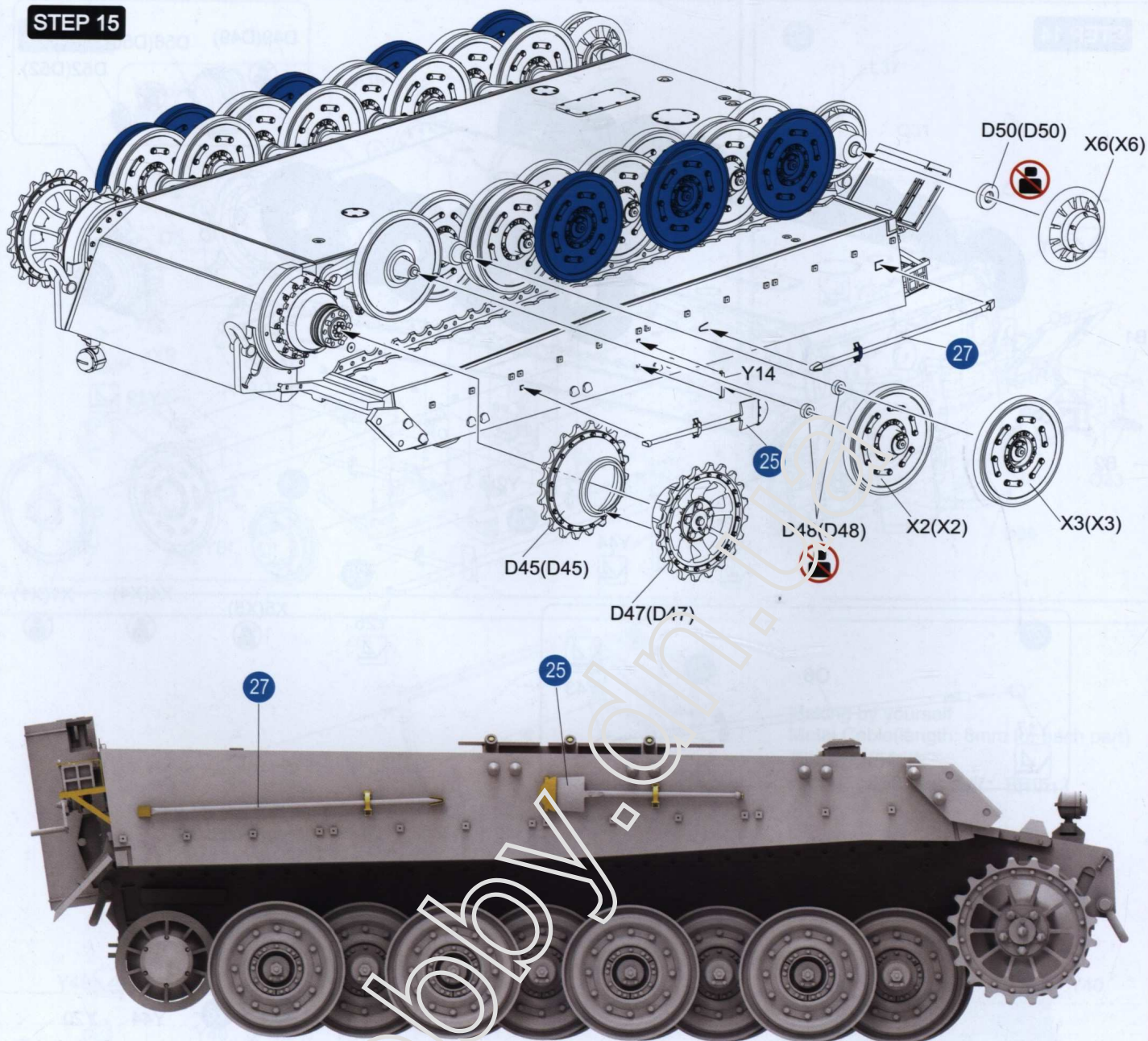

STEP 15

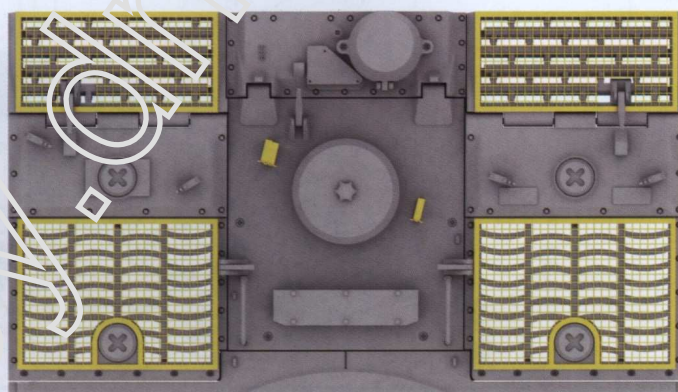
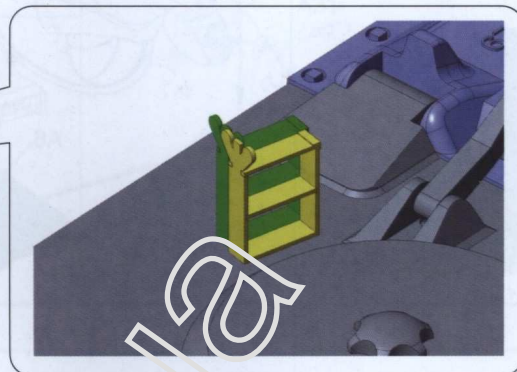
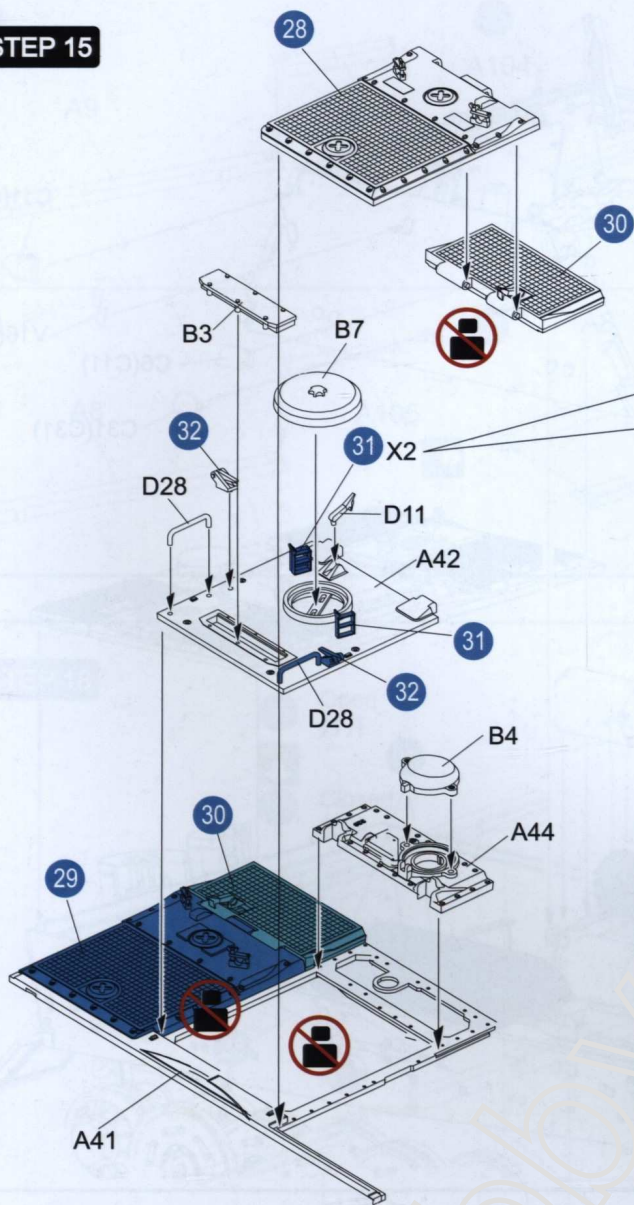

STEP 16

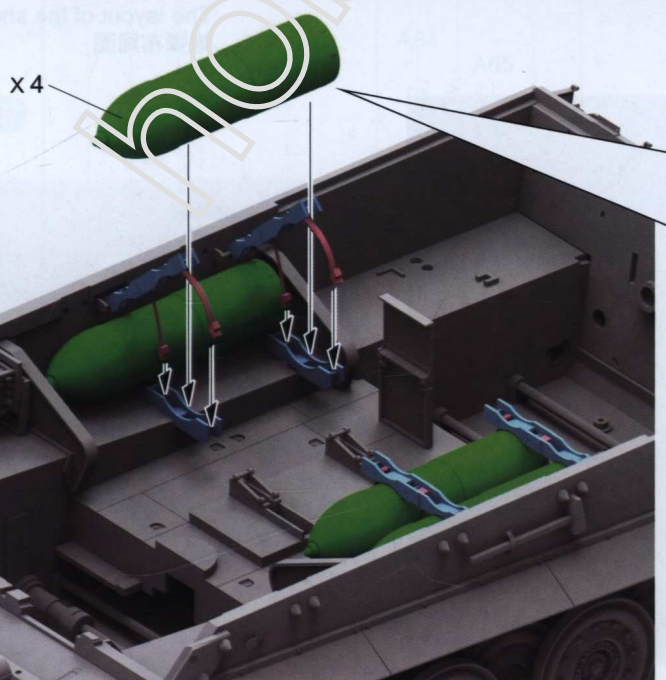

Make 14
制作14组

10

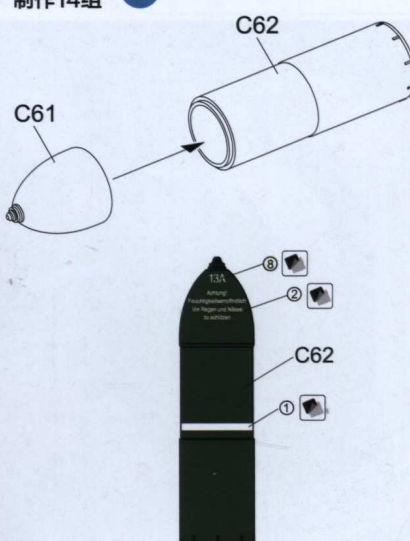

STEP 17

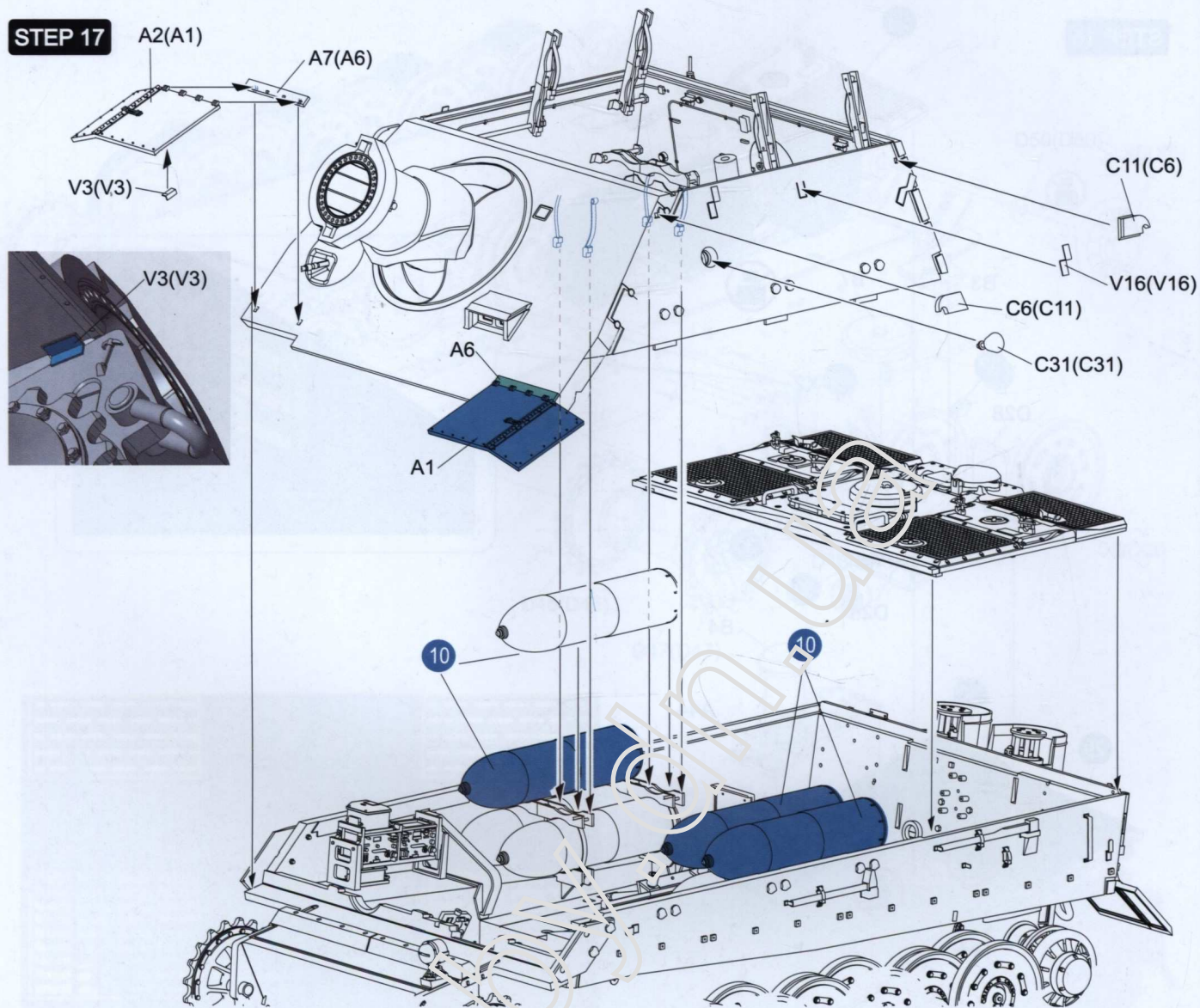

Optional the push shell handle
推弹手柄的选装方案

The layout of the shells
炮弹布局图

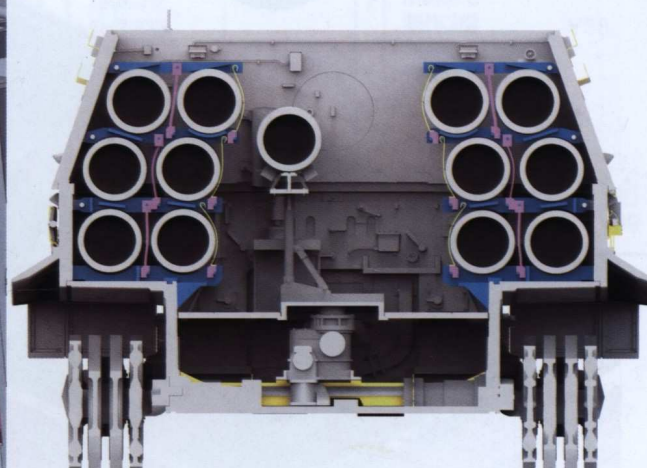
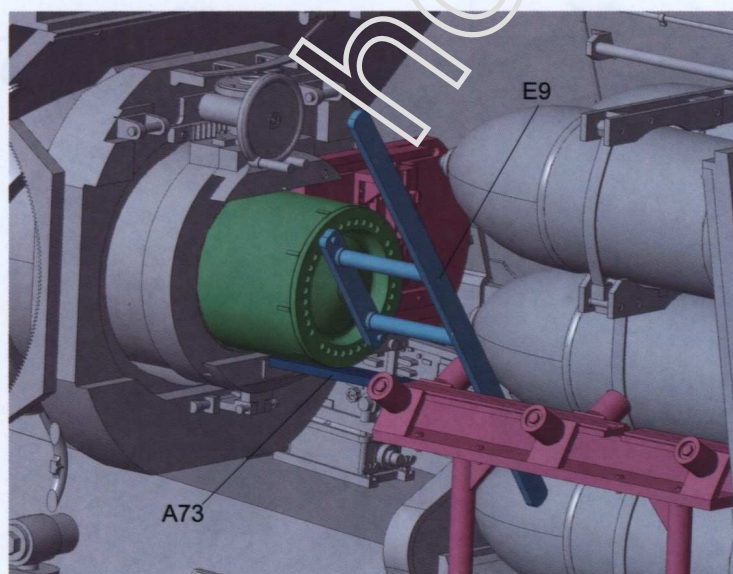

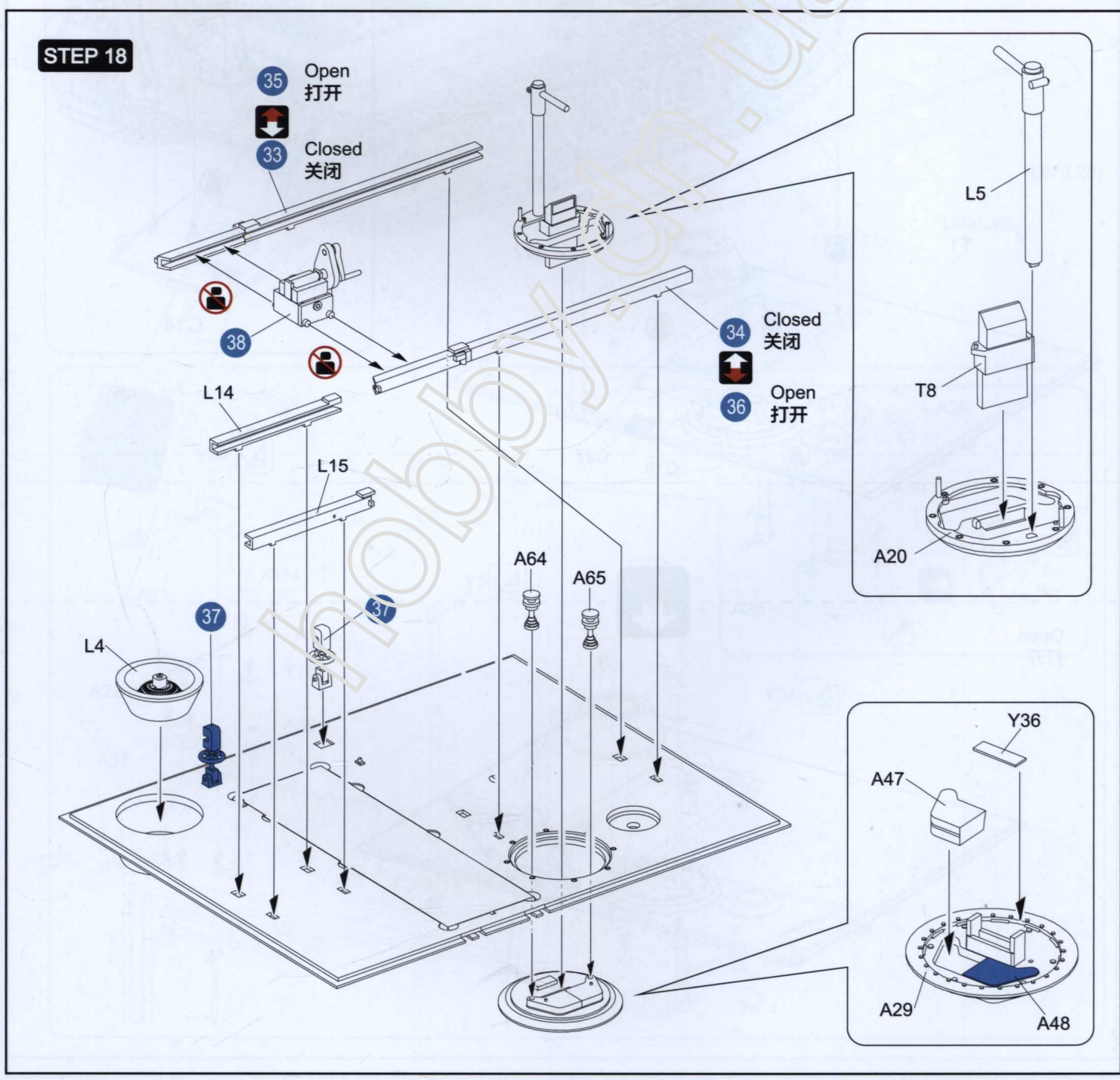
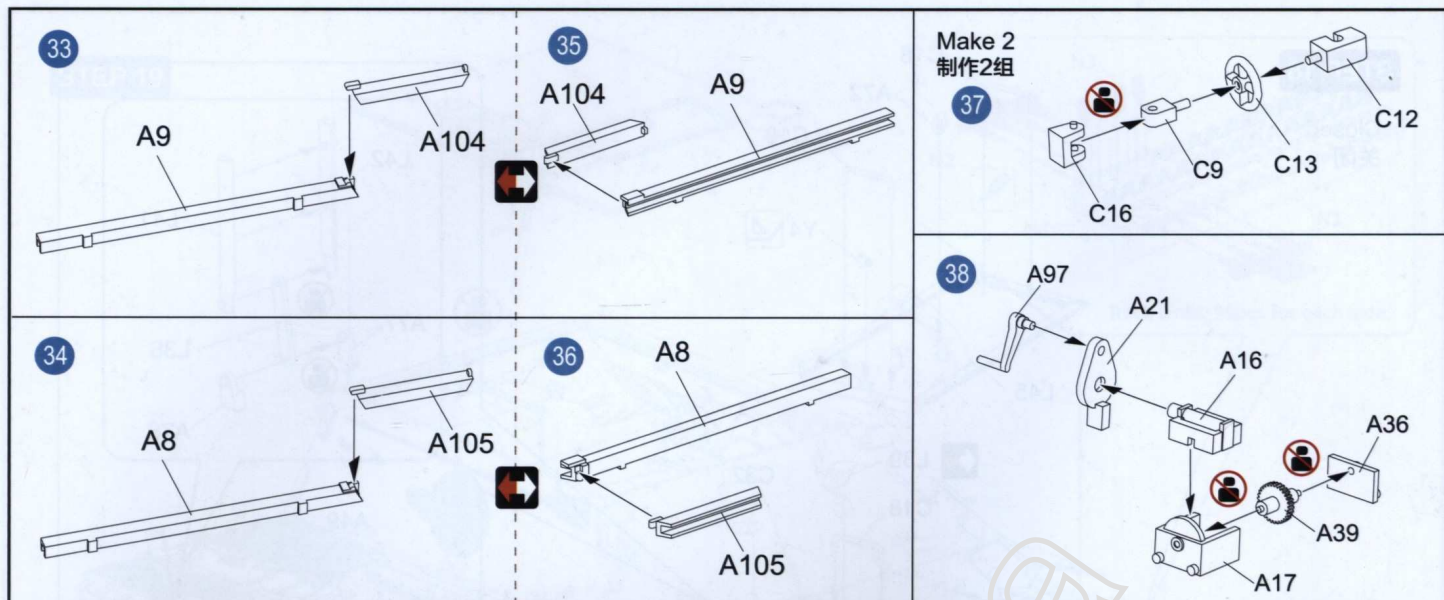

STEP 18

Closed
关闭

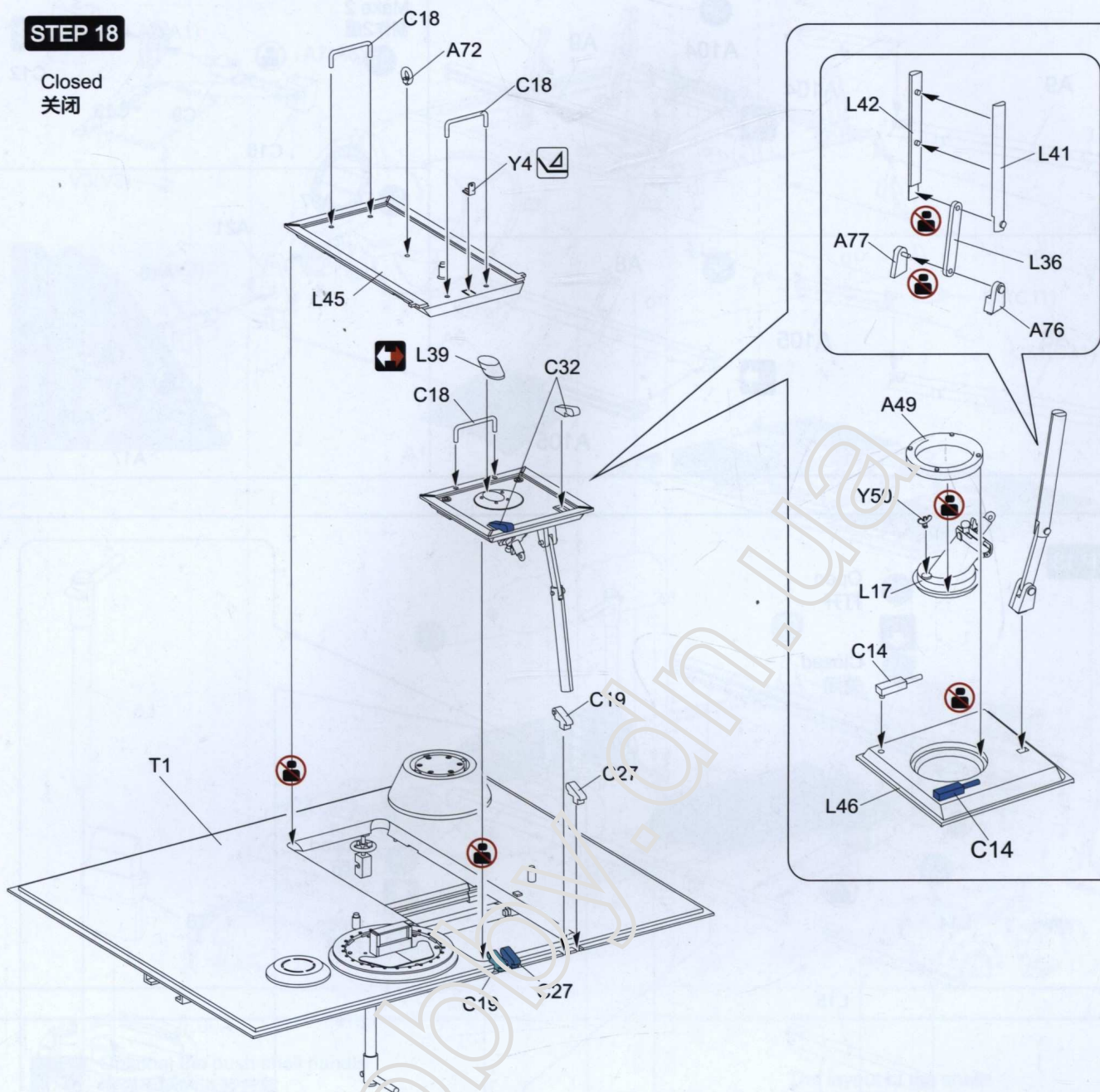

Open
打开

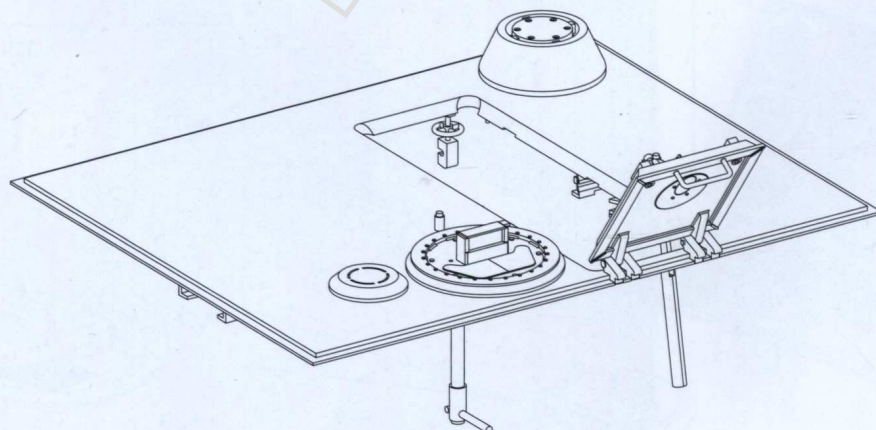

STEP 19

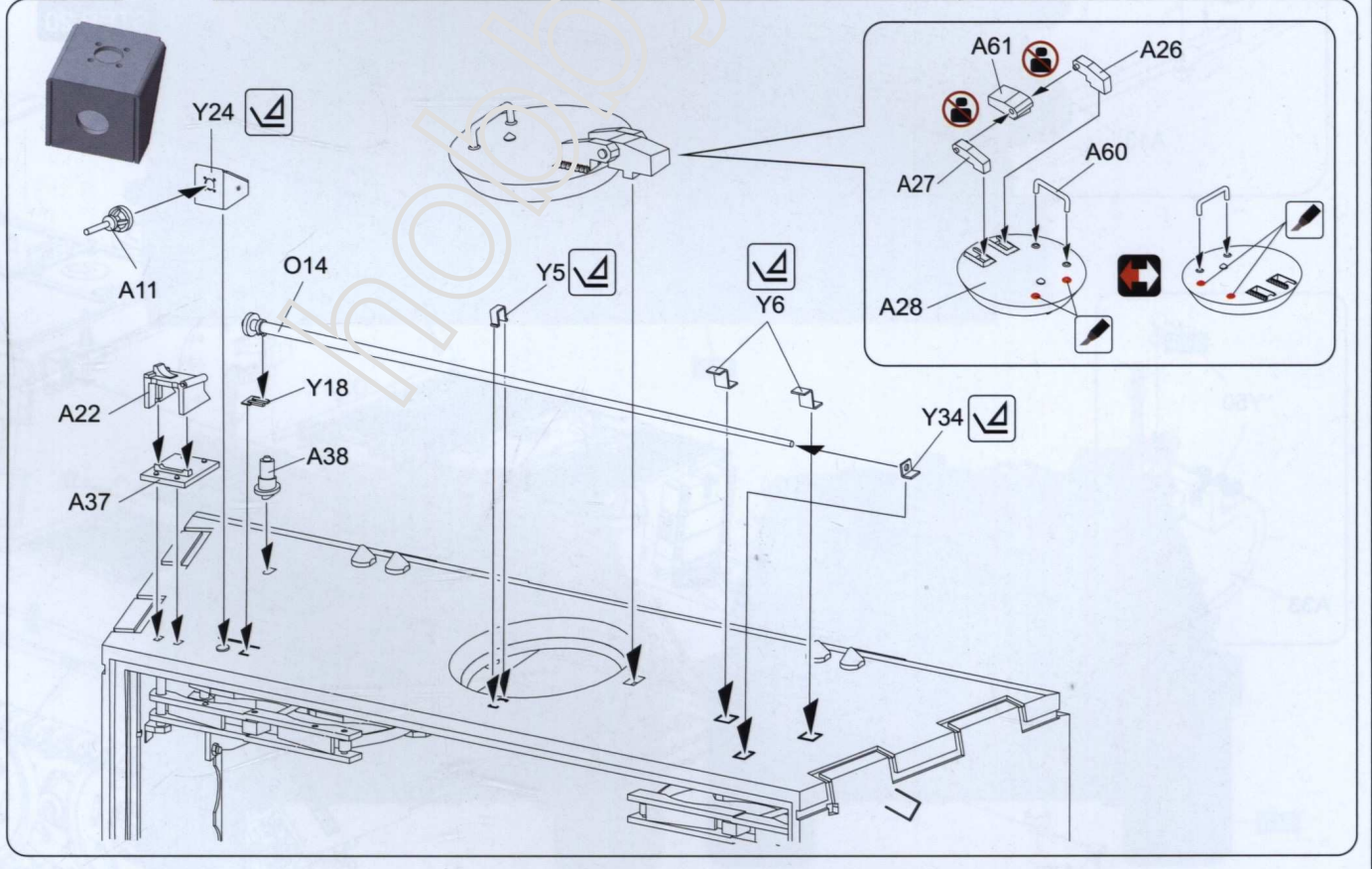
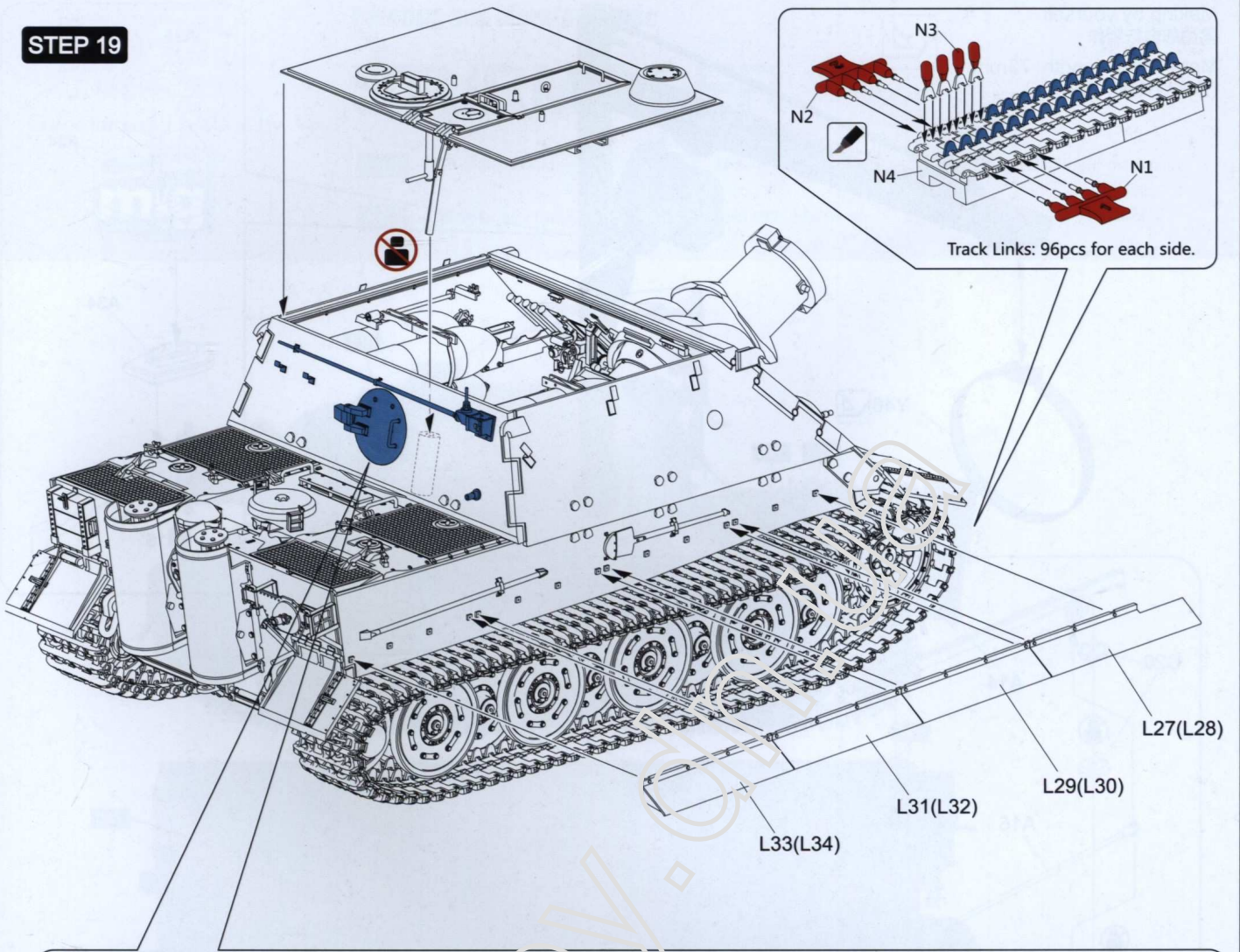

Making by yourself
需由您自行制作

Metal Cable length: 73mm
(金属线长度: 73mm)

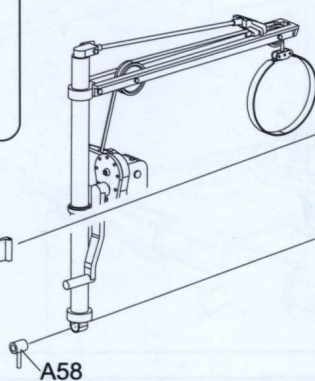
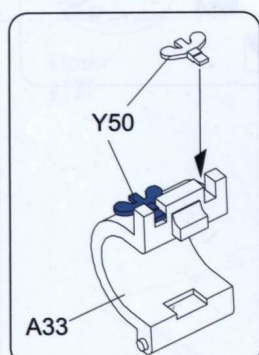
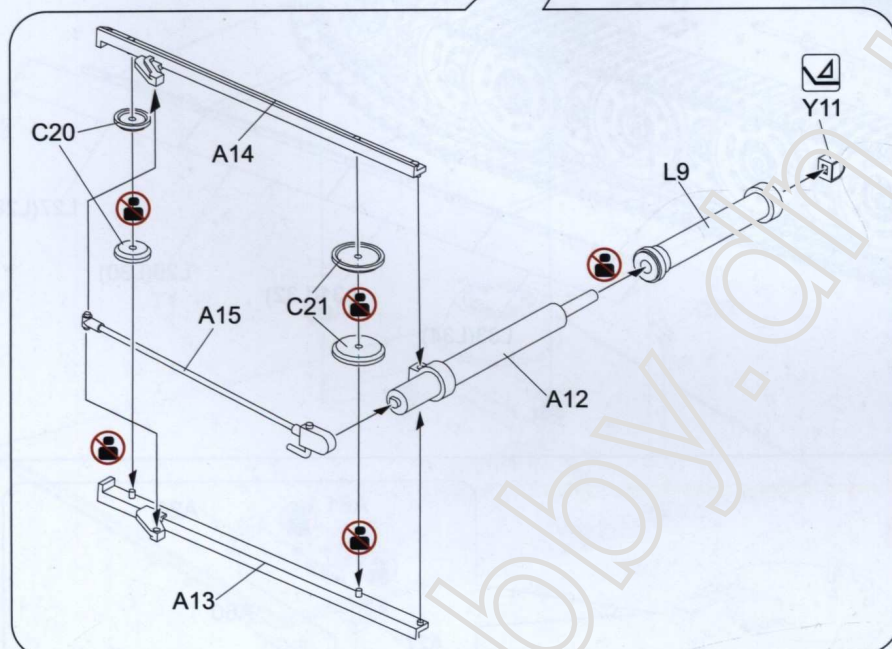
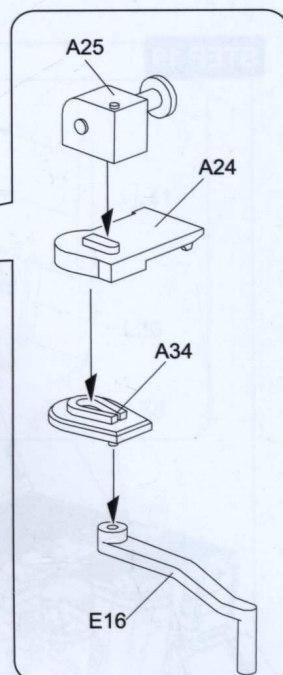
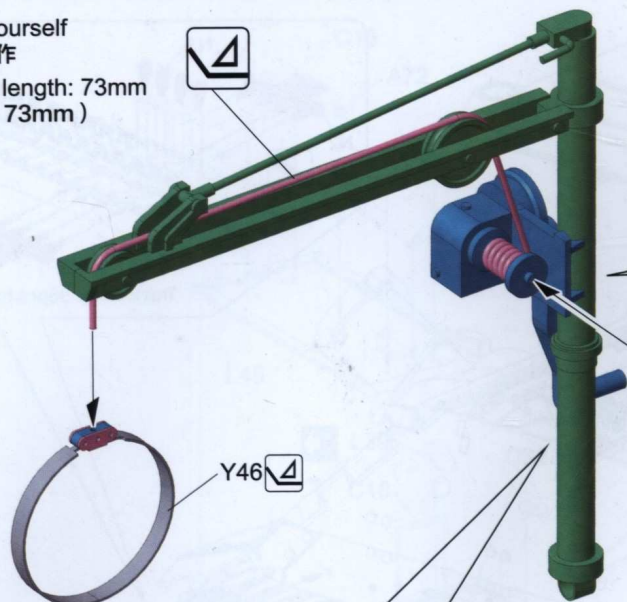

STEP 20

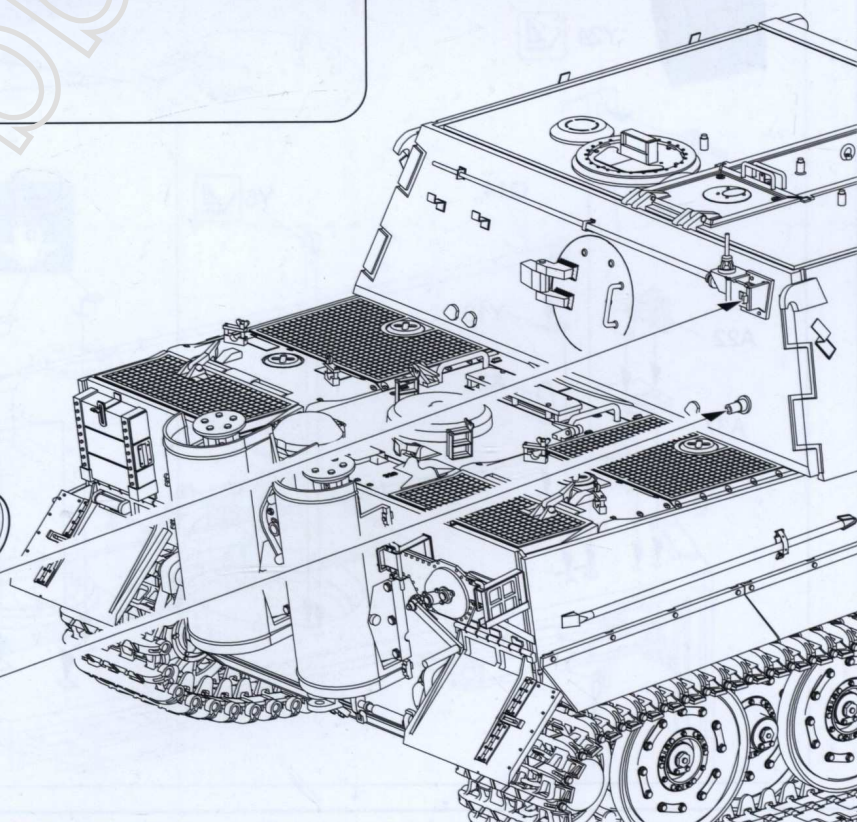

STURMTIGER



A.MIG 003 Resedagrün



A.MIG 011 Dunkelgelb AUS '44 DG1



A.MIG 015 Schokobraun



A.MIG 035 Dark Tracks



A.MIG 037 New Wood



A.MIG 045 Gun Metal



STURMTIGER



A.MIG 010 Dunkelgelb



A.MIG 035 Dark Tracks



A.MIG 037 New Wood



A.MIG 045 Gun Metal

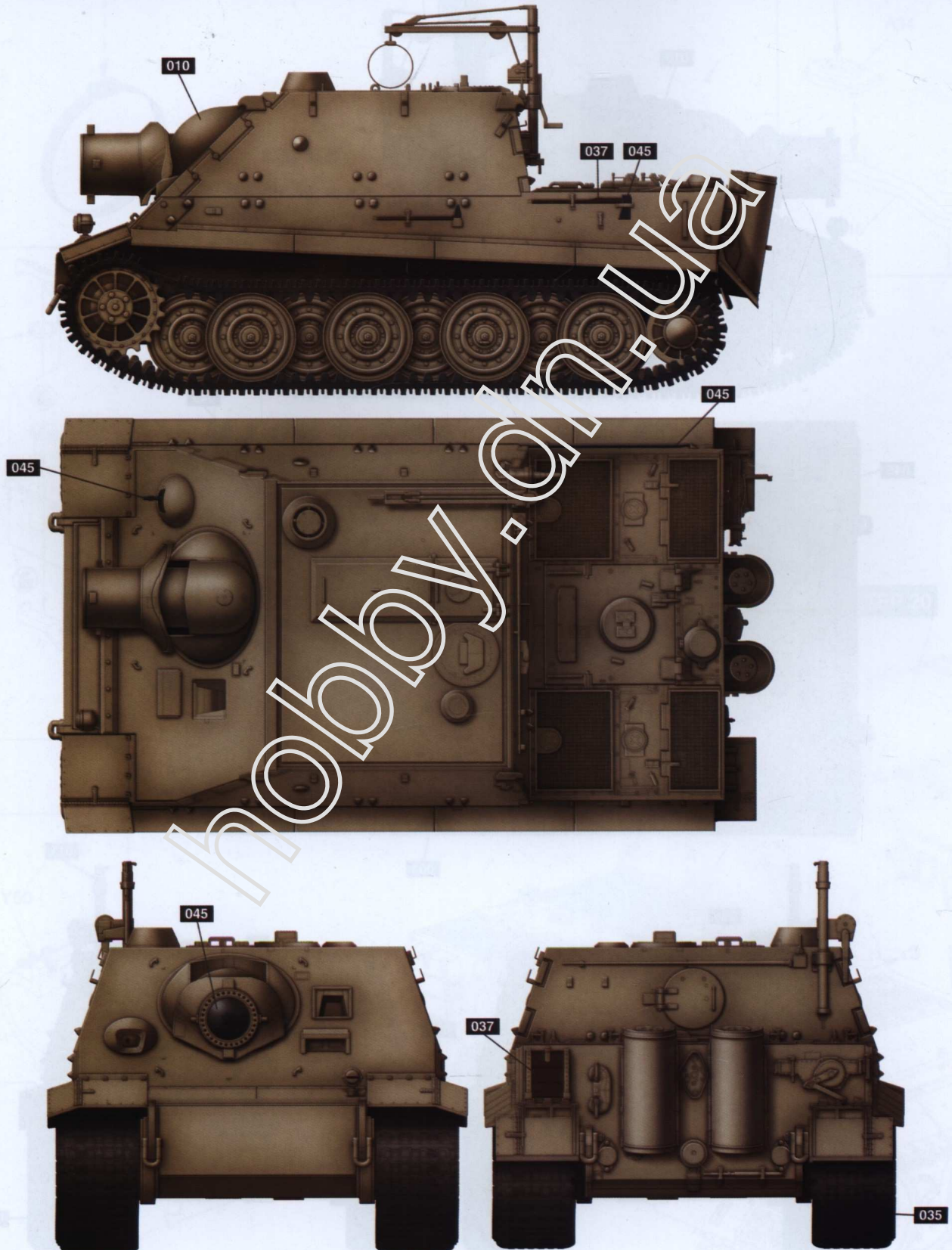



Painting and Marking Guide

STURMTIGER

A.MIG 003 Resedagrün

A.MIG 010 Dunkelgelb

A.MIG 014 Rotbraun

A.MIG 035 Dark Tracks

A.MIG 037 New Wood

A.MIG 045 Gun Metal

