

Sd.Ah 115 Flatbed Trailer (Tank Transport)

CZ

1/72

Tiefladeanhänger für Panzerkampfwagen nebo také Sonderanhänger 115, tak znělo označení přívěsu pro transport lehkých tanků. Přívěs, označovaný v kódovém systému Wehrmachtu Sd.Ah115 byl vyvinut v roce 1937. Ve Španělsku během občanské války byla otestována jeho první verze s nosností 8 tun. Pro Wehrmacht byla od roku 1938 vyráběna finální verze s nosností 10 tun. Sd.Ah 115 byl určen k přepravě lehkých tanků / Pz.I, Pz.II, Pz.38(t), Pz.35(t) /, ale na jeho ložné ploše mohly být přepravovány jakékoliv vozidla do hmotnosti 10 tun. K tažení byl užívány těžké nákladní vozy Faun L900 nebo Büssing-NAG 900A. Tyto vozy byly schopny přepravovat jeden tank na korbě a druhý na přívěsu Sd.An 115. V polních podmínkách se k tahání Sd.Ah 115 často používal i polopásový tahač Sd.Kfz 7. Přívěsy Sd.Ah 115 byly používány celou válku, nejvíce ovšem v Polsku a Francii. Přívěsy byly používány jak k přepravě bojové techniky do výchozích pozic k útoku, tak ke stahování poškozených strojů k opravám či k přepravě kořistní techniky. Se vzrůstajícími počty středních tanků byly do výzbroje Wehrmachtu zařazovány přívěsy s větší nosností Sd.Ah.116. To ovšem neznamenalo konec používání Sd.Ah 115. Doloženy jsou při přepravě různých vozidel, min či dokonce miniponorky Biber na konci války. Část přívěsů byla dokonce používána po válce v civilním sektoru.

EN

The Tiefladeanhänger für Panzerkampfwagen and also the Sonderanhänger 115 were the official names attached to a trailer designed and constructed to move lighter types of tanks and other military vehicles. The Wehrmacht's code name for this trailer was the Sd.Ah115. Developed in 1937, it was first used in the Spanish civil war where the early version capable of carrying an 8-ton load was put to military tests. In 1938, a more powerful, 10-ton load version was introduced to service with the Wehrmacht. The Sd.Ah115 trailer was used for moving lightweight Pz.I, Pz.II, Pz.38(t) and Pz.35(t) tanks, however, any type of AFV with a total weight of up to 10 ton could be carried on its bed. The trailer was towed by a heavy lorry, usually the Faun L900 or Büssing-NAG 900A. Such unit was able to transport one tank on the lorry itself and another one on the trailer flatbed. In field conditions, a Sd.Kfz 7 half-track vehicle could also be used. The Sd.Ah115 trailer remained in service throughout the war, most notably during the French and Polish campaigns. Its job was not just to move the military vehicles towards their front line destination, damaged vehicles were also taken back for repairs by means of the tractor and trailer unit. As the numbers of medium tanks in Wehrmacht rose, heavier Sd.Ah116 trailers were being introduced to service, capable of moving heavier loads. This, however, did not bring the end to the Sd.Ah115 being used by the German military. Rather unusual cargos were seen carried on the Sd.Ah115 towards the end of the war such as various vehicles, mines and even the Biber midget submarine. Some number of the trailers were also put to civilian use when the war was finally over.

Plastic Parts

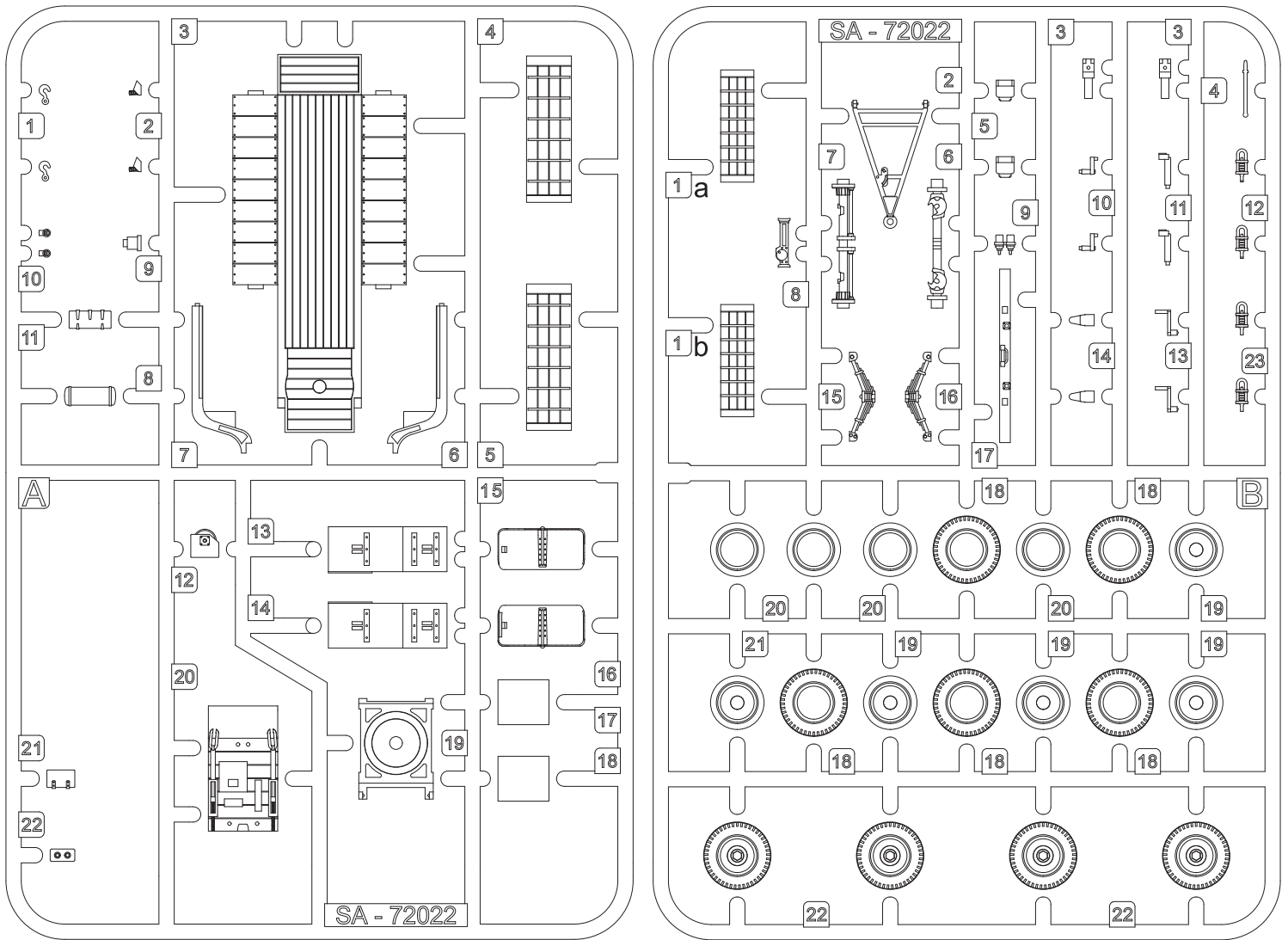

Barvy GUNZE/ GUNZE Colour No.

Barva pneu / Tyre Black

H77 / C137

Tank Grey / Tanková šedá / Panzergrau

H32 / C40

SYMBOLS



MOŽNOST VOLBY
OPTIONAL
NACH BELIEBEN
OPTION



POUŽÍT KYANOAKRYLÁTOVÉ LEPIDLO
INSTANT CYANOACRYLATE GLUE
ZYANOAKRYLÁTKLEBER
COLLE CYANOACRYLAT



OHNOUT
BEND
BIEGEN
COURBER



ZHOTOVIT NOVĚ
SCRATCH BUILD
FERTIGSTELLEN
ACHEVER



ŘEZAT/VRTAT
CUT OFF/DRILL
ENTFERNEN
DETACHER

GSI
colour code



NATŘÍT
COLOUR
FARBEN
PEINDRE

Assembly

STEP 1

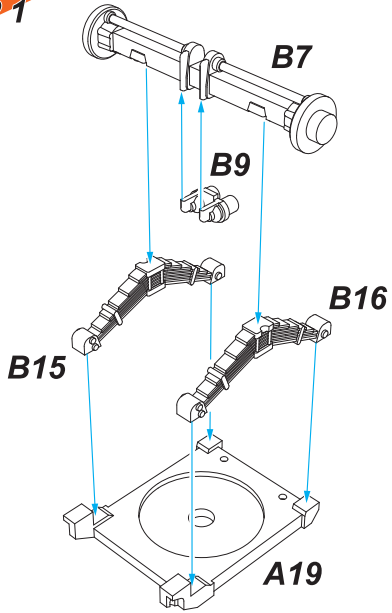

STEP 2

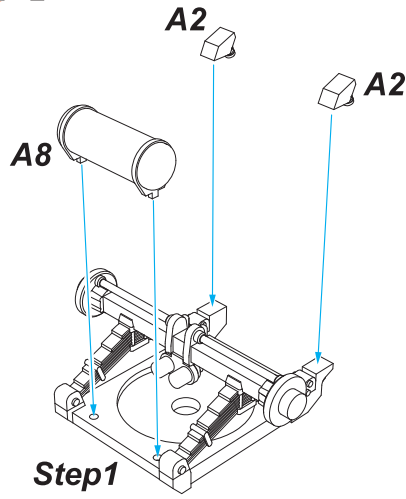

STEP 3

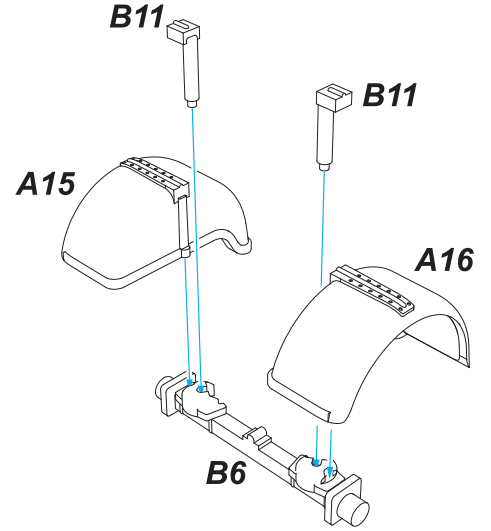

STEP 4

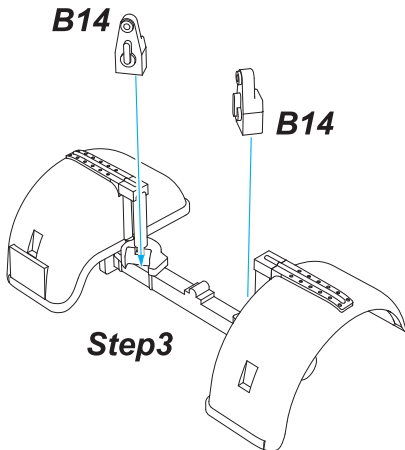

STEP 5

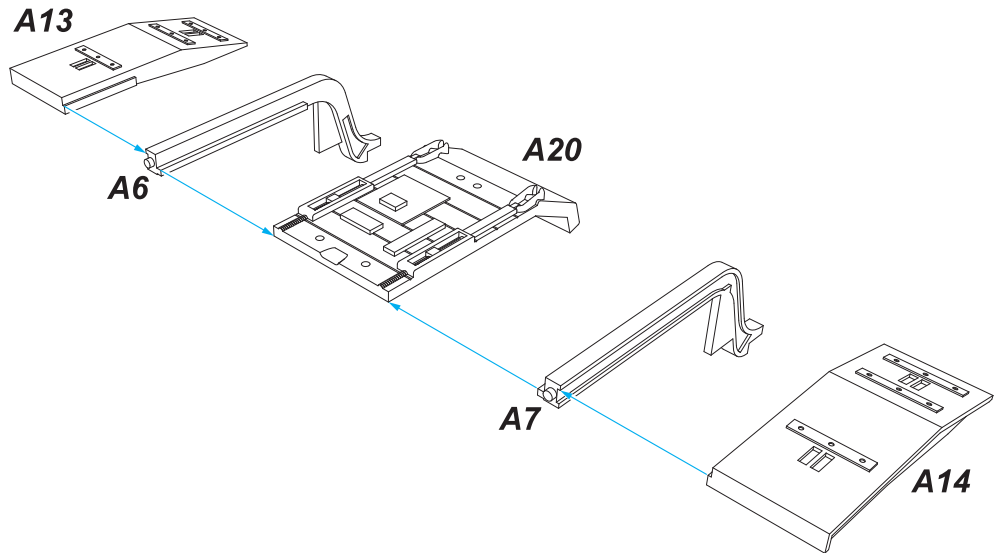

STEP 6

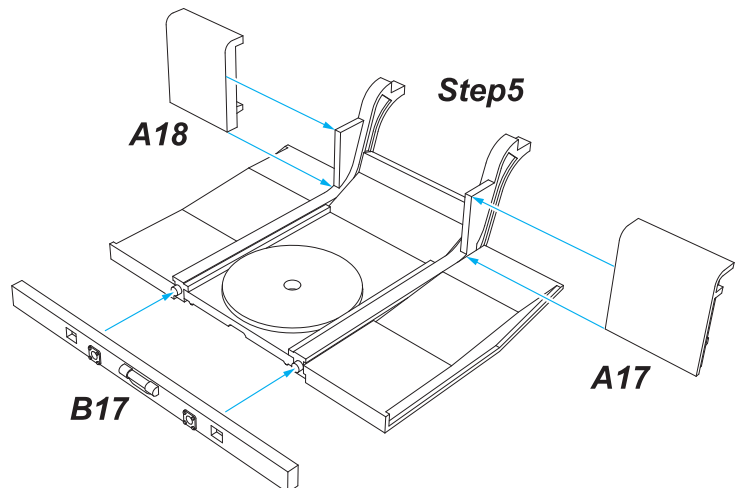

STEP 7

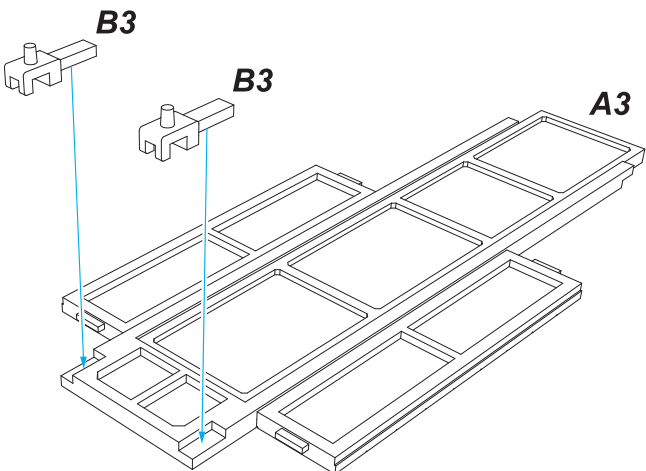

STEP 8

Step7

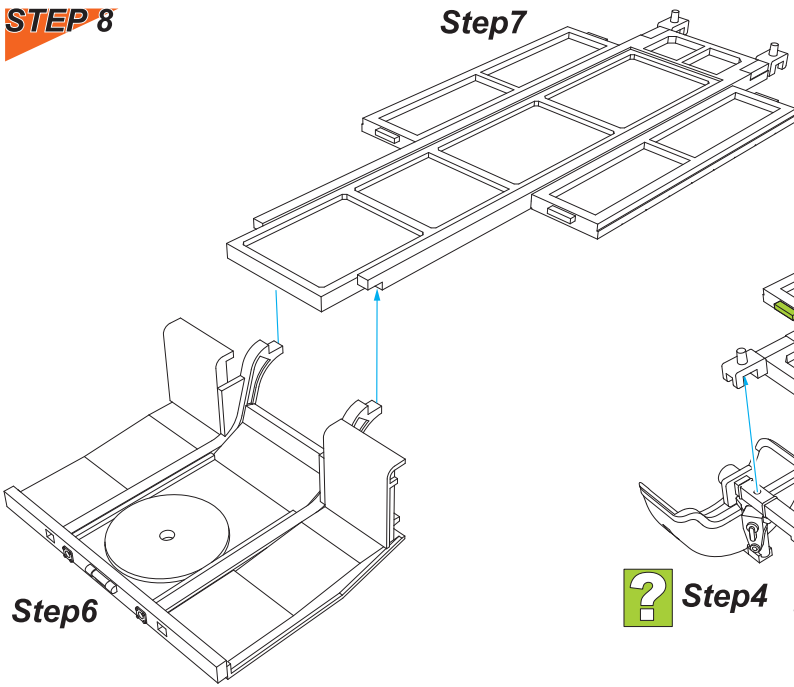

STEP 9

Step8

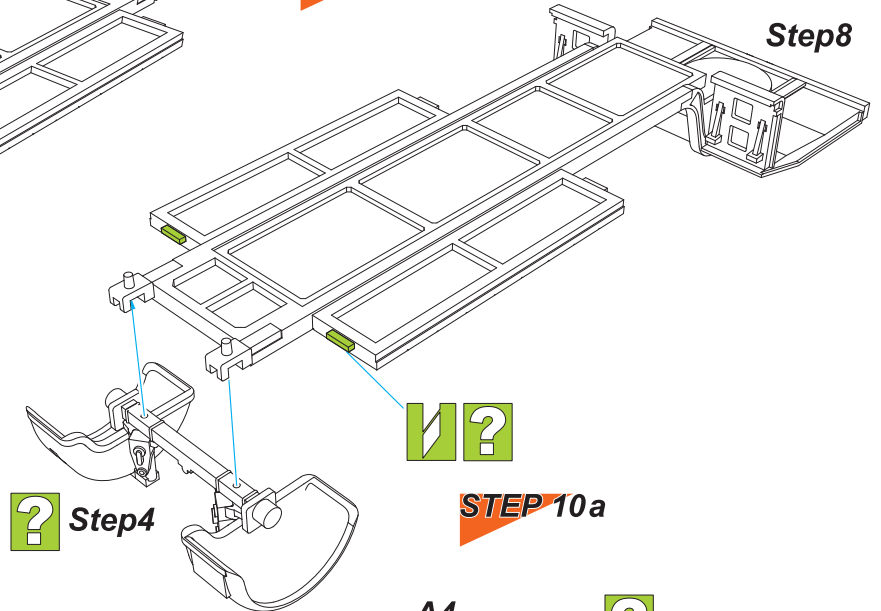

Step6

? Step4

STEP 10a

STEP 11

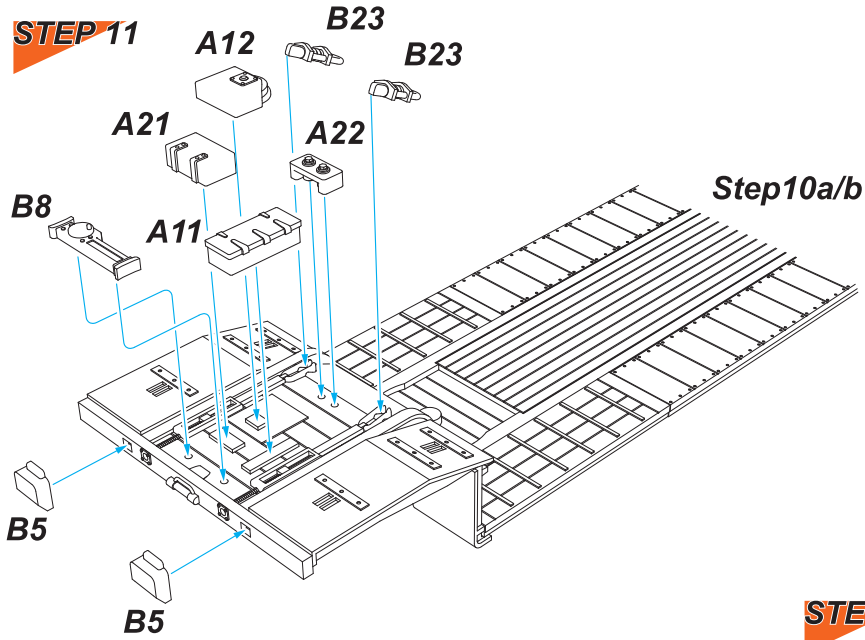

Step10a/b

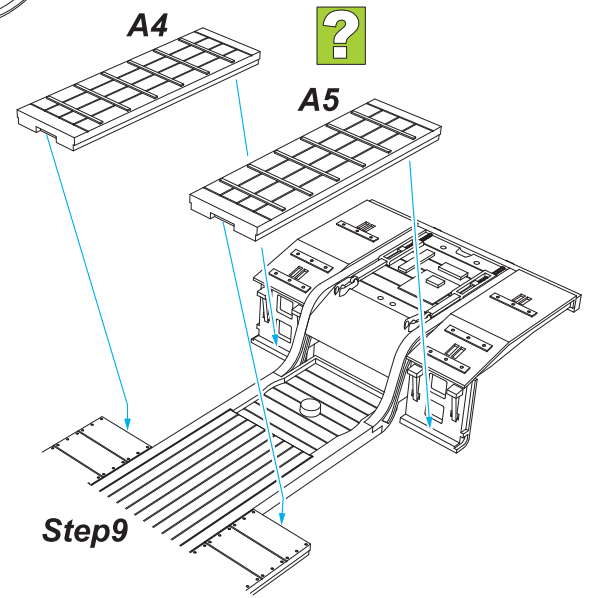

Step9

STEP 12

Step4/ 9

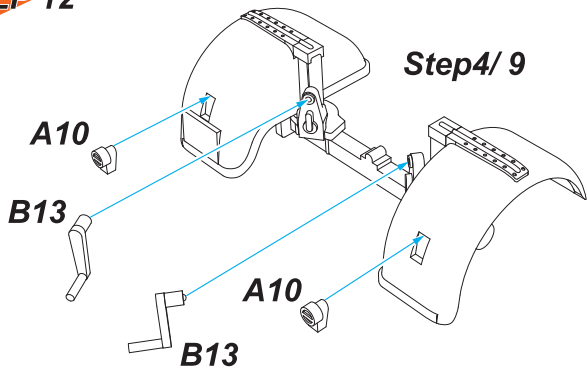

STEP 10b

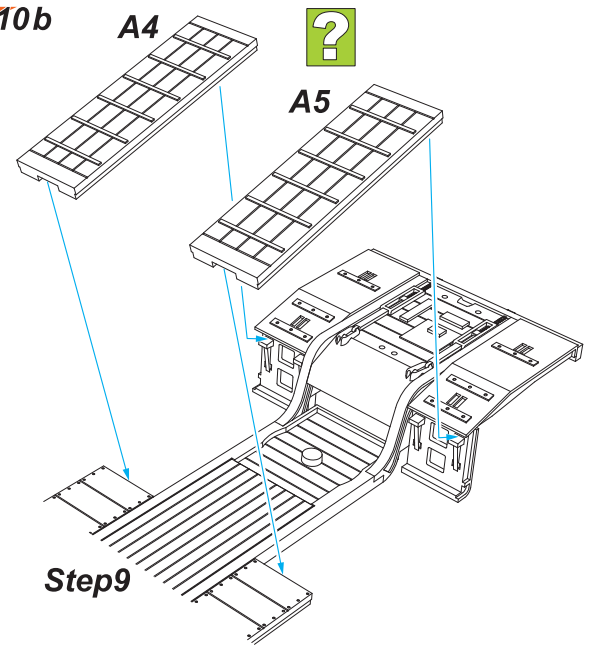

Step9

STEP 13 4x

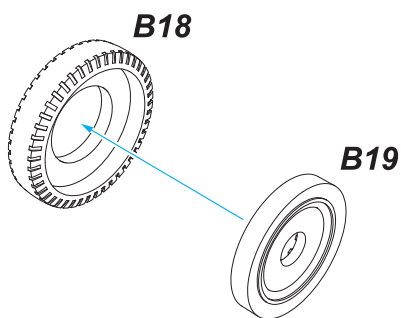

STEP 14

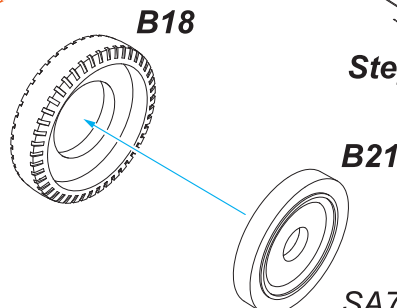

STEP 15 4x

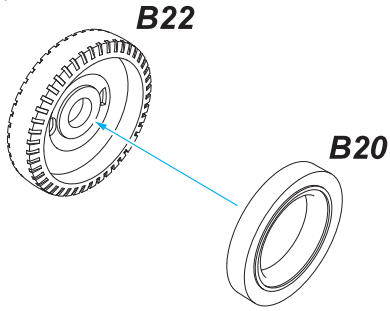

STEP 17

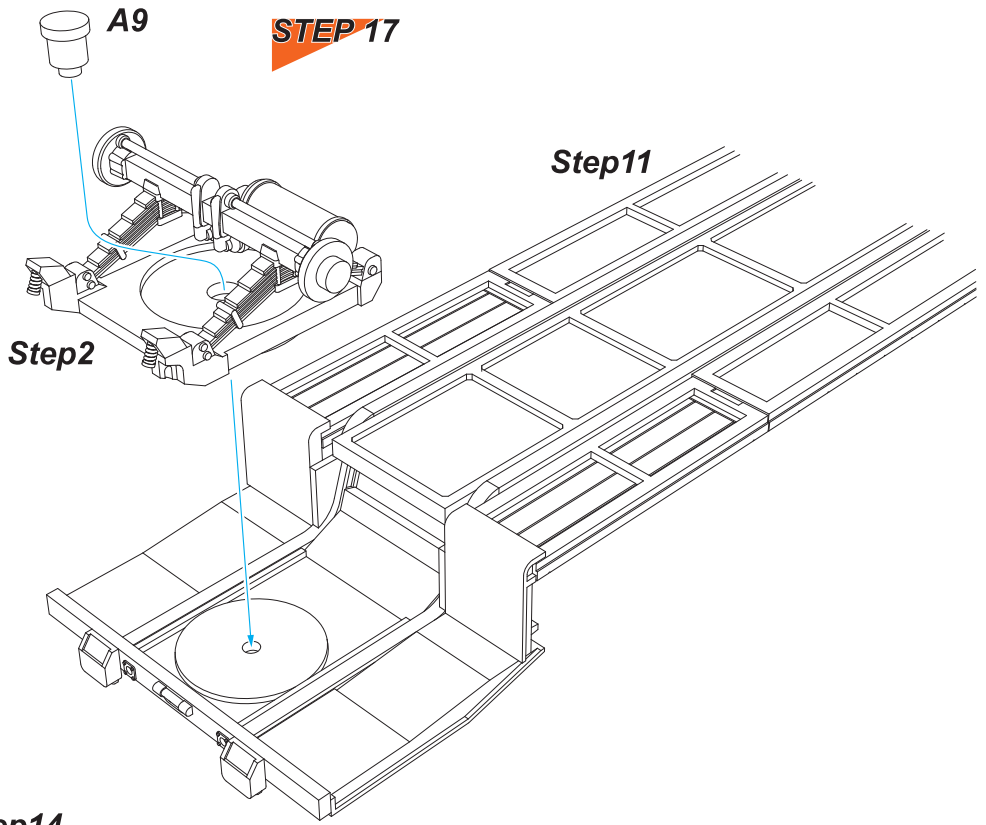

STEP 16 4x

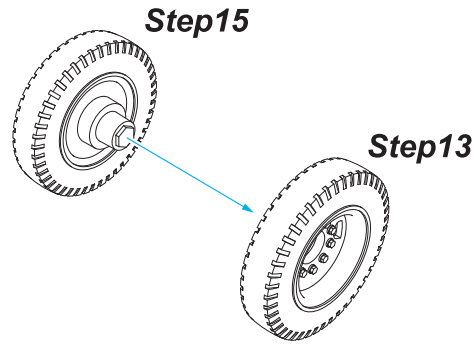

Step 14

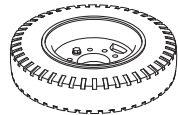

STEP 19

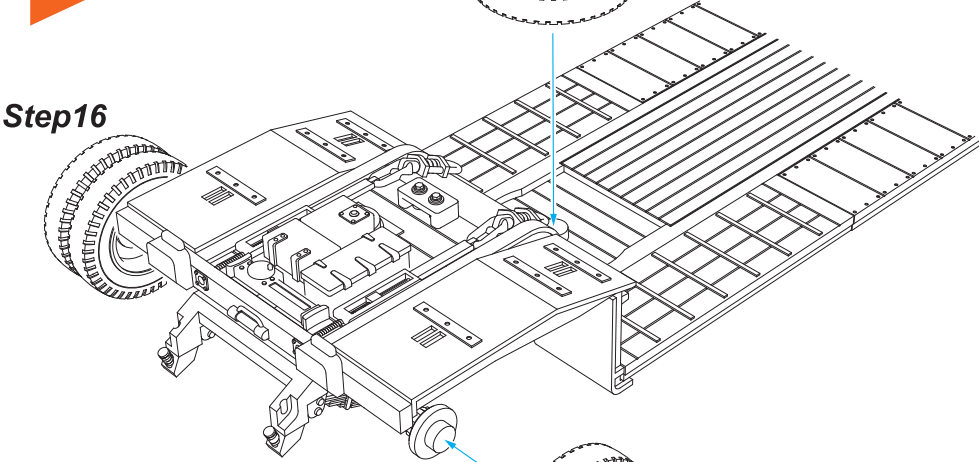

STEP 18

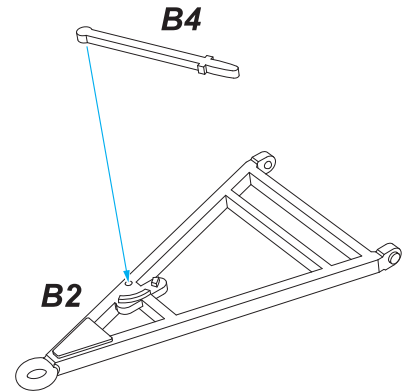

STEP 20

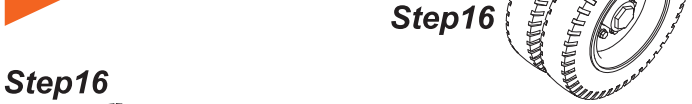

STEP 21

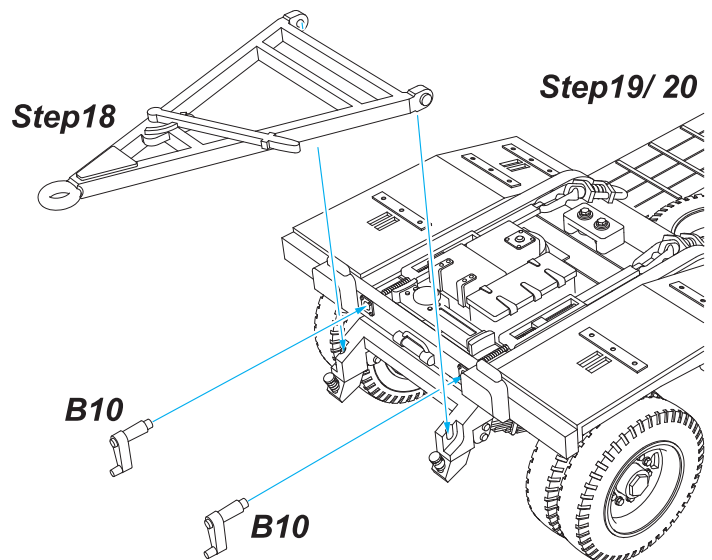

Step 16

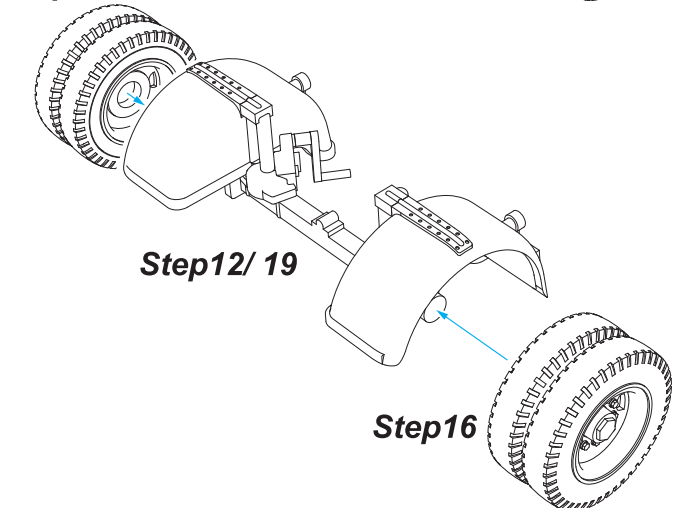

STEP 22

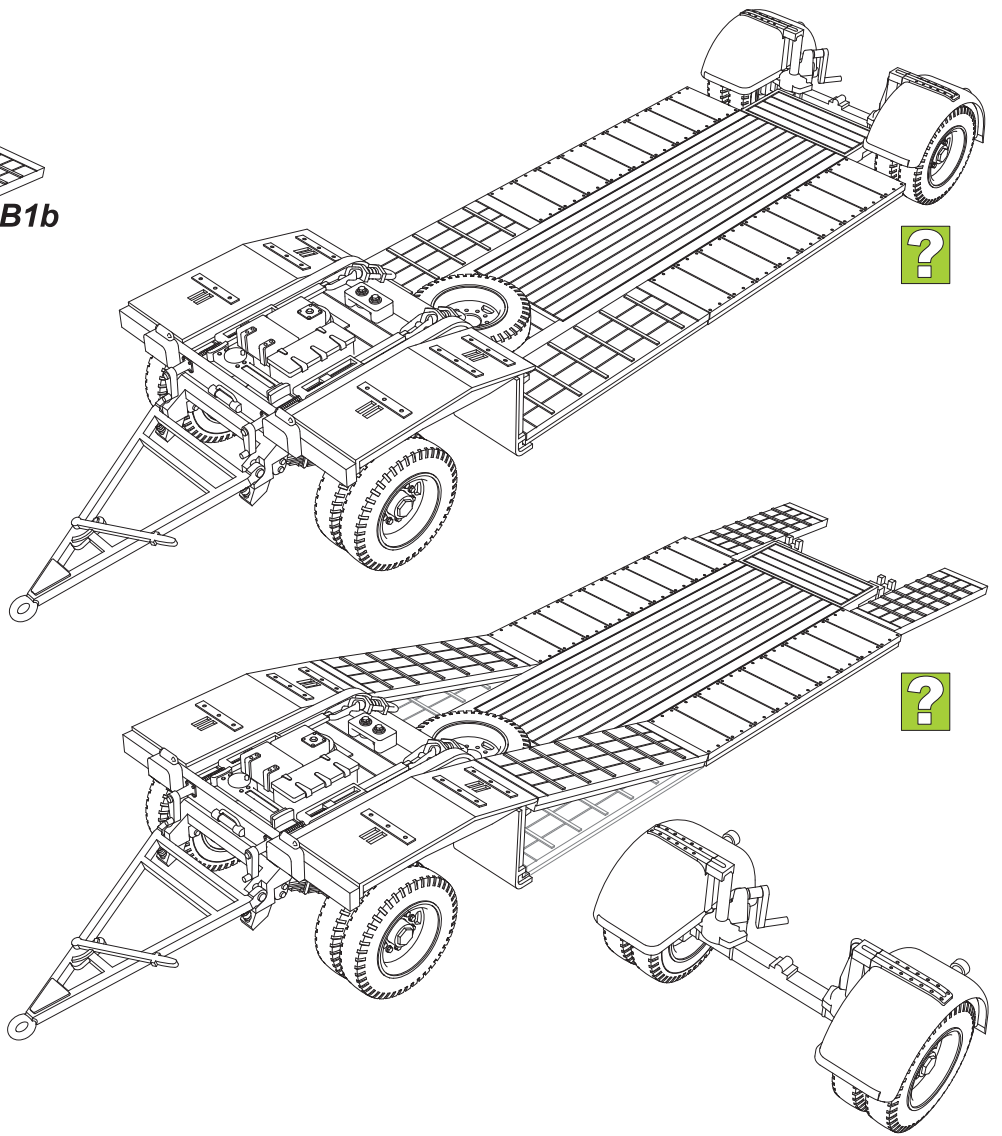
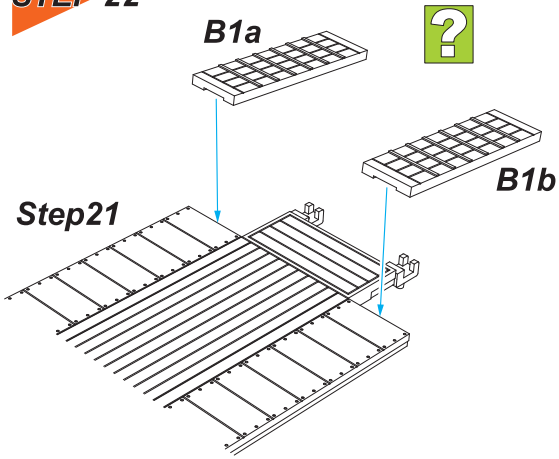

CMK
resin set



B72104
Sd.An 115
Wheels



1/72 SA72001
SS-100 Gigant Schwerer
Radschlepper / Heavy Tractor



1/72 SA72012
Meillerwagen "V-2 Transporter"

Special
ARMOUR



1/72 B72100
Meillerwagen
"V-2 Transporter" Wheels Set
for Special Armour kit



1/72 B72094
SS-100 Gigant
Wheels
for Special Armour kit



1/72 B72102
Biber Trailer Wheels
for Special Armour kit

Tank Grey
Tanková šedá
Panzergrau
H32 / C40



Barva pneu
Tyre Black
H77 / C137

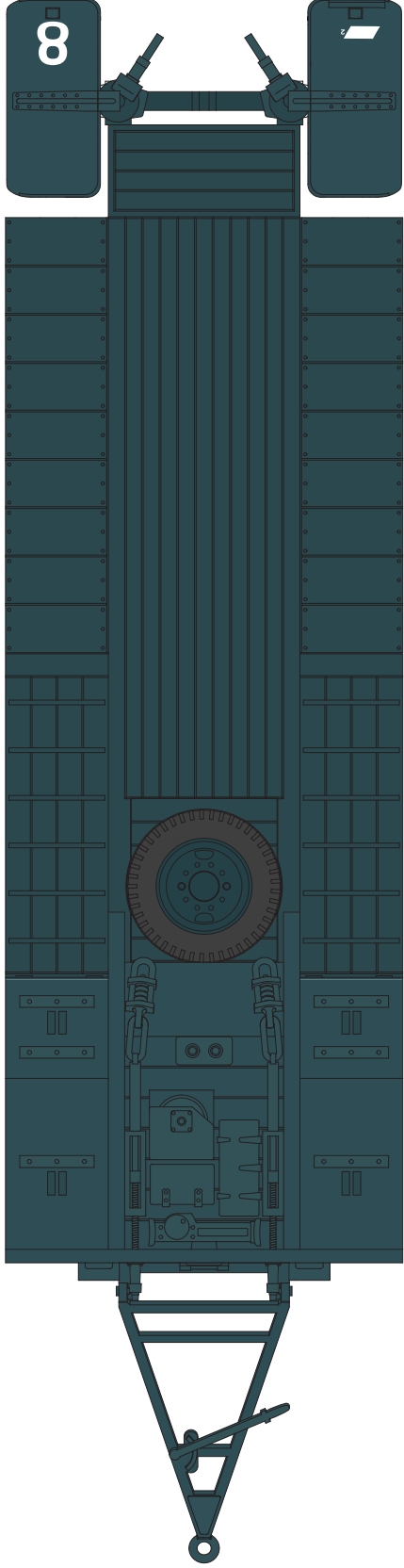

1 (without dec. 3)

WH
155 682

4

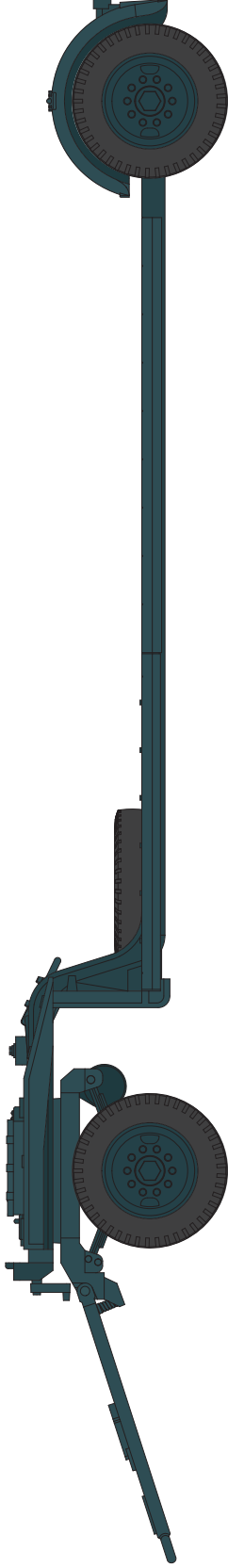

3

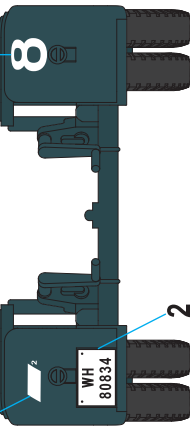

2

WH
80834

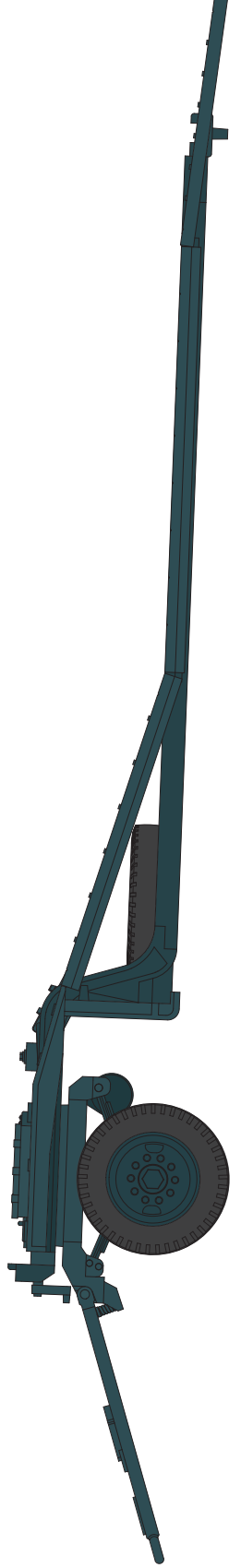
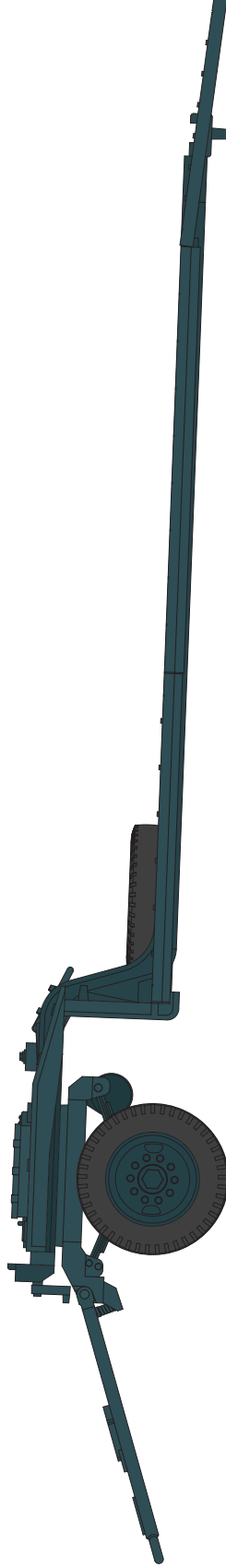
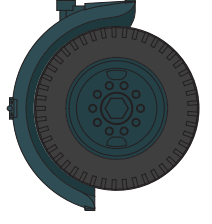
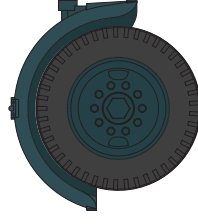

SA72020

Sd.Kfz 131

Marder II

7,5 cm PaK 40/2

PLASTIC KIT



B72103

Sd.Kfz 131 Marder II

EQUIPMENT

CMK RESIN SETS



SA72021

Sd.Kfz 10

Zugkraftwagen 1t

(Demag D7)

PLASTIC KIT

SA72018

BIBER

TRAILER

PLASTIC KIT

