

Clear Prop!

STARTER

I-16  
TYPE 5

EARLY  
VERSION

1:72

model # CP72024



scale model kit

SPAN: 125,2 mm

LENGTH: 84,5 mm

NUMBER OF PARTS: 100 pcs

- 1** stages of assembly
- ?** optional
- A** variants of assembly
- glue by super glue
- A1** part number
- do not glue
- fill with putty
- make a hole
- 1** apply decals
- detach with knife
- 1** apply the adhesive mask
- paint
- bend
- repeat the operation N times

Role	Fighter
National origin	Soviet Union
Manufacturer	USSR, Plant No. 21, Plant No. 39, Plant No. 153, Plant No. 458
First flight	30 December 1933 (TsKB-12)
Primary users	Soviet Air Force, Spanish Republican Air Force, Chinese Nationalist Air Force
Produced	November 1934 – 1942
Number built	10,292 (6,848 fighters and 3,444 trainers)

I-16 (TsKB-12) - a Soviet single-engine monoplane fighter of the 1930s, created at the Central Design Bureau by a team led by aircraft designer Nikolai Polikarpov. One of the world's first mass-produced monoplane fighters with retractable landing gear in flight. The aircraft had a mixed design. The serial production of the aircraft, originally with the M-22 engine, started in 1934, and really unfolded only the next year. In 1935, it became possible to install M-25 engines on the aircraft, which were a Soviet copy of the American Wright-Cyclone F-3. The production of these engines was launched at the newly built aircraft factory No.19 in Perm. In 1935, using often American parts, the plant produced 660 M-25 engines. Some of these engines were intended for the I-16. In general, this aircraft was very reminiscent of the third prototype with the Wright-Cyclone F-3. However, the engine cowling has changed somewhat and received frontal blinds, which have become a characteristic feature of this aircraft. At production plant No.21 in Gorky, the aircraft received the designation type 5 and became the most massive single-seat modification of the I-16. Until the end of 1937, more than 2,500 planes were built. I-16 type 5 fought in Spain, China, were widely used at the initial stage of the Second World War

REQUIRED PAINTS

- |   |                                      |   |                                   |                                  |                                       |                                  |                                   |                                 |
|---|--------------------------------------|---|-----------------------------------|----------------------------------|---------------------------------------|----------------------------------|-----------------------------------|---------------------------------|
| <b>A</b> A.MIG-0080<br>AMT-4 GREEN      | <b>B</b> A.MIG-0046<br>AMT-6 BLACK   | <b>C</b> A.MIG-0251<br>AMT-7 LIGHT BLUE | <b>D</b> A.MIG-0046<br>BLACK      | <b>E</b> A.MIG-0194<br>ALUMINIUM | <b>F</b> A.MIG-0191<br>POLISHED STEEL | <b>G</b> A.MIG-0195<br>SILVER    | <b>H</b> A.MIG-0033<br>TIRE BLACK | <b>I</b> A.MIG-0202<br>DECK TAN |
| <b>J</b> A.MIG-0187<br>PALE BURNT METAL | <b>K</b> A.MIG-0125<br>ORANGE YELLOW | <b>L</b> A.MIG-0049<br>INSIGNIA RED     | <b>M</b> A.MIG-0205<br>STEEL GRAY | <b>N</b> A.MIG-0050<br>WHITE     | <b>O</b> A.MIG-257<br>AZURE BLUE      | <b>P</b> A.MIG-249<br>LIGHT BLUE |                                   |                                 |



THIS MODEL IS PRODUCED FOR EXPERIENCED MODELERS OVER 14 YEARS

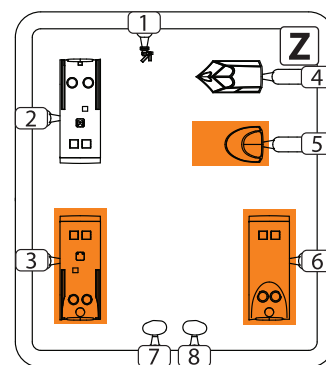
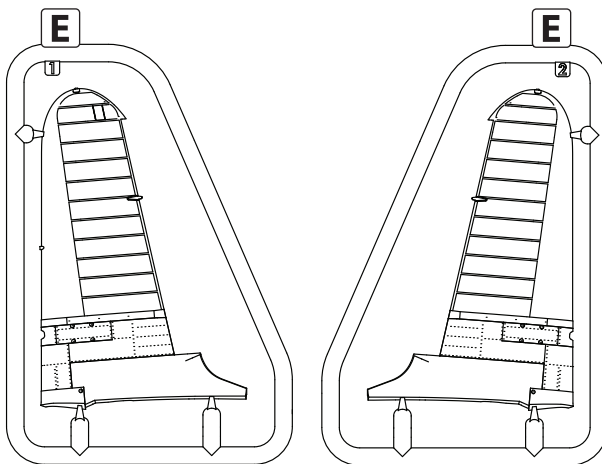
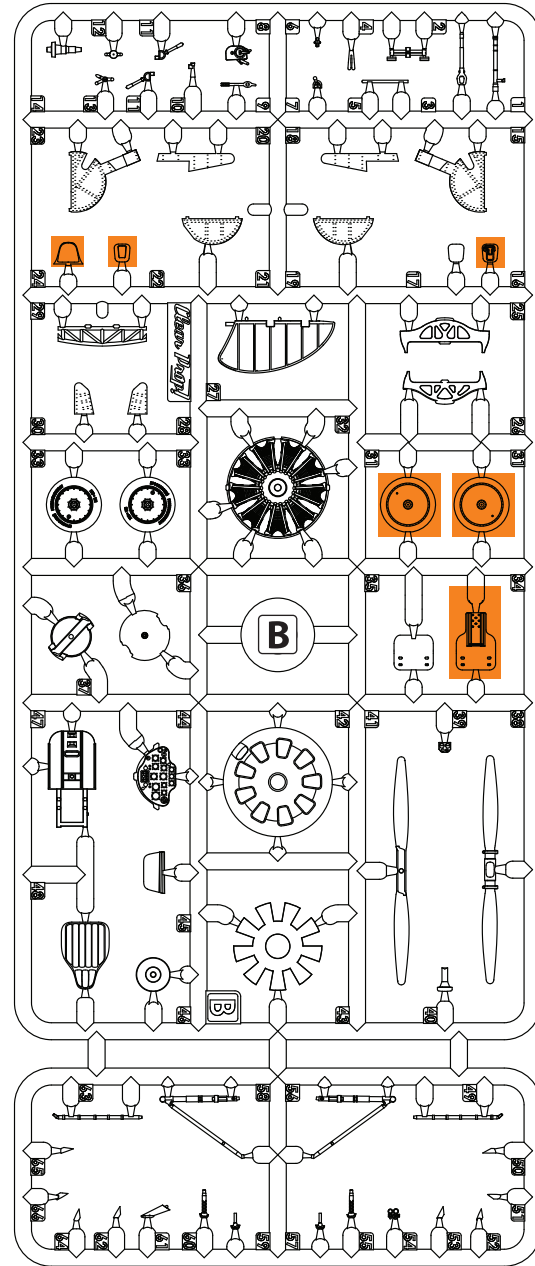
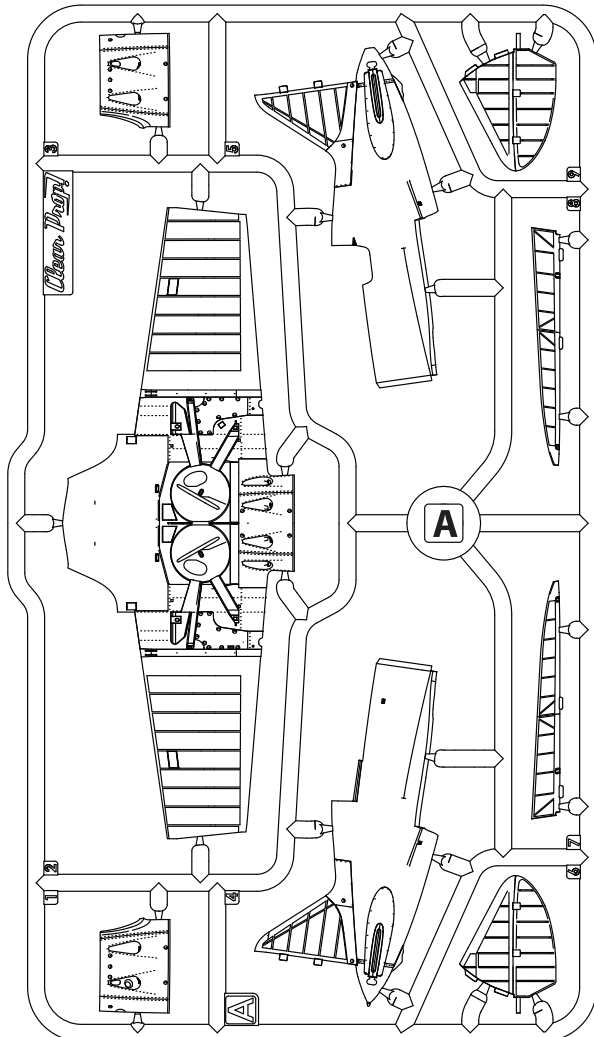

Parts not for use

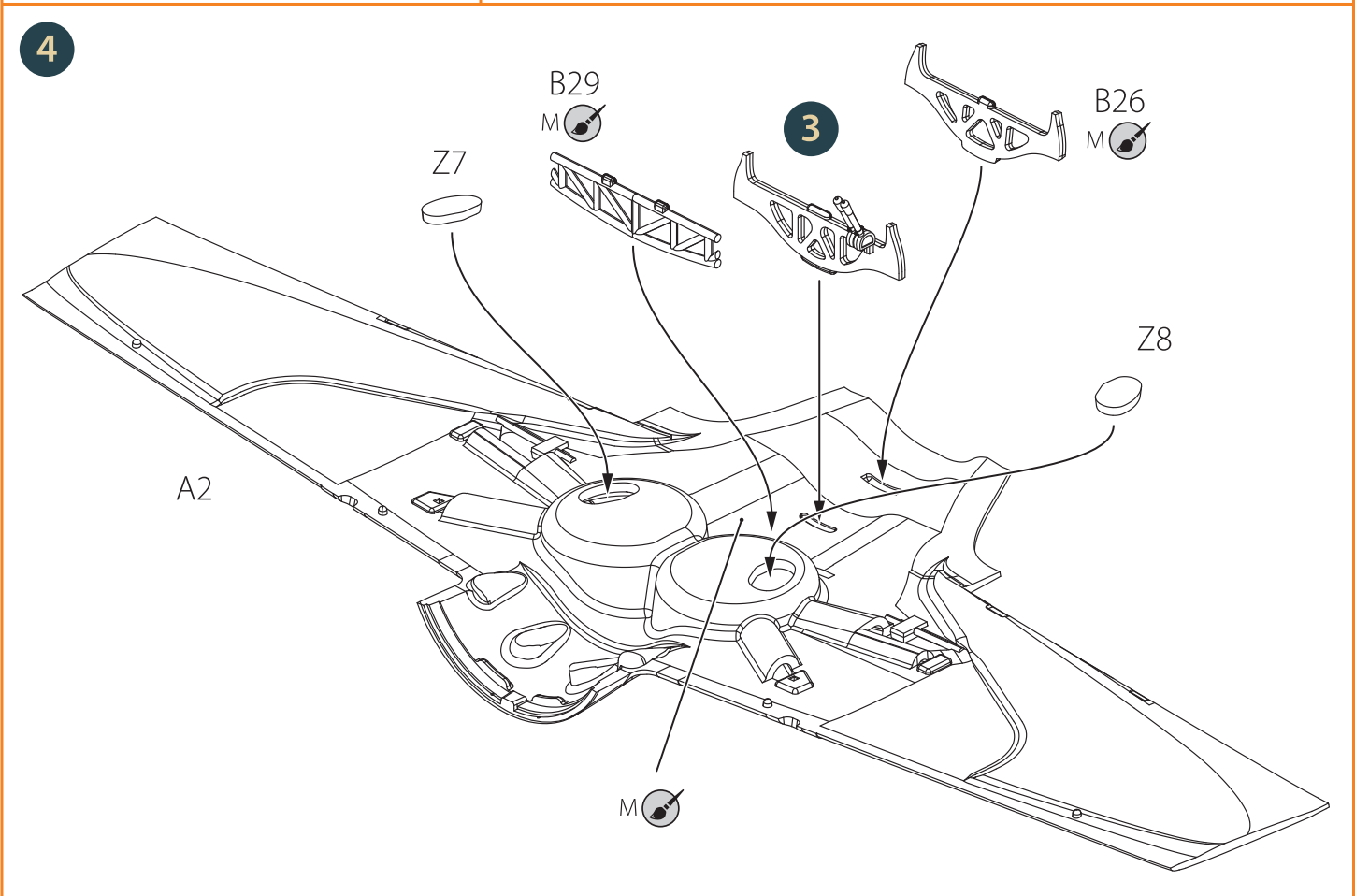
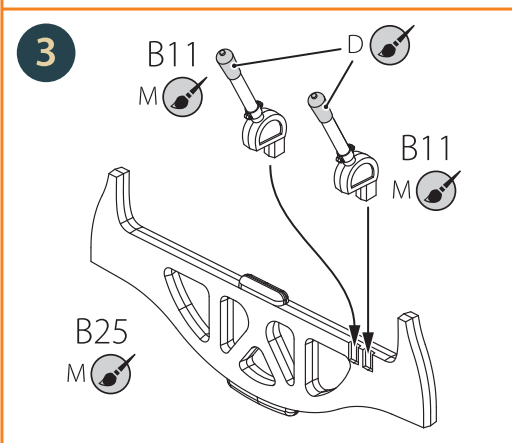
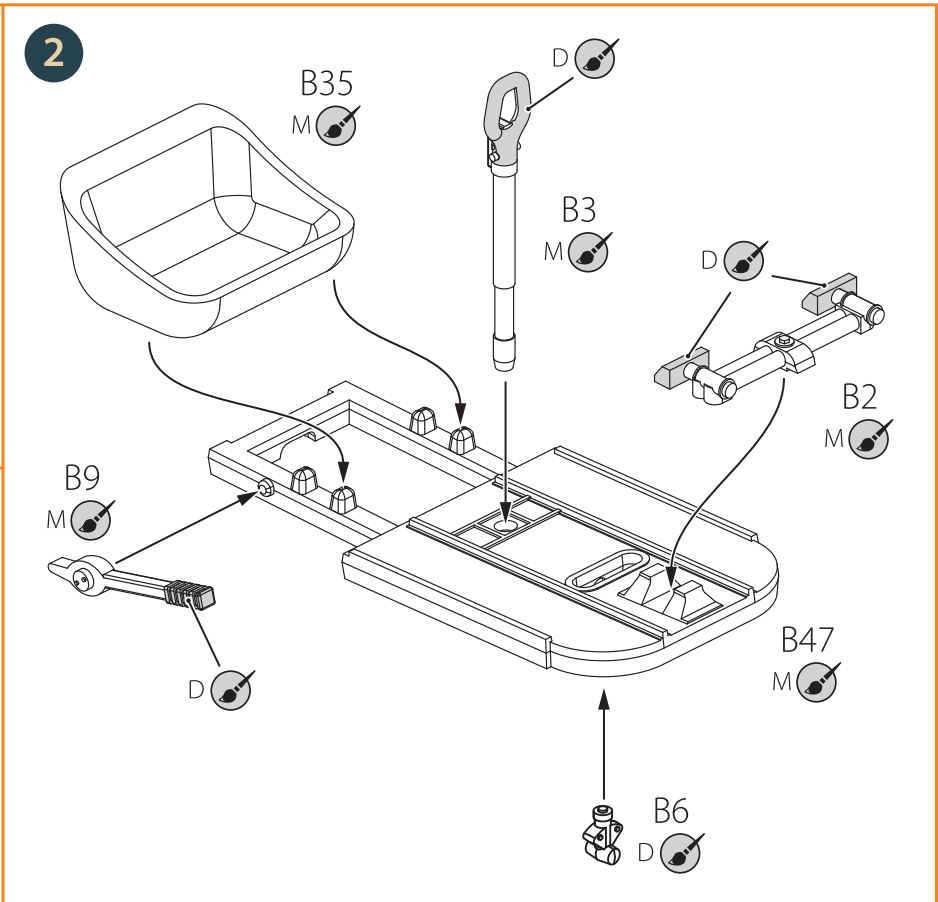
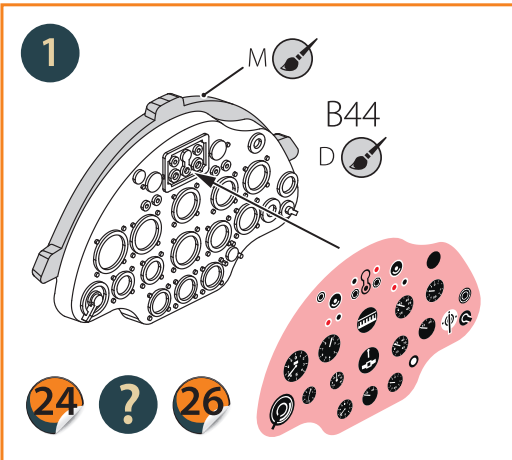

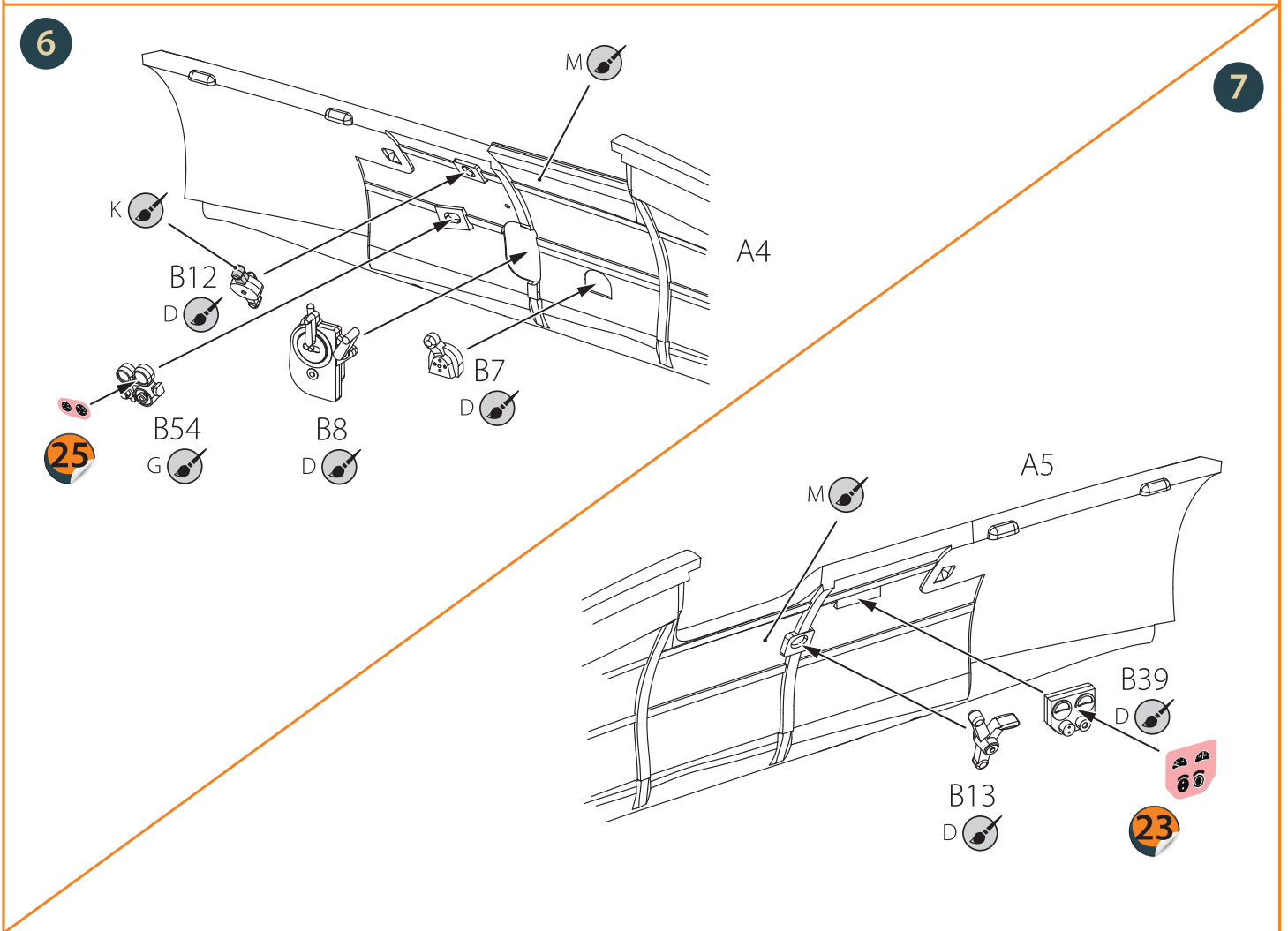
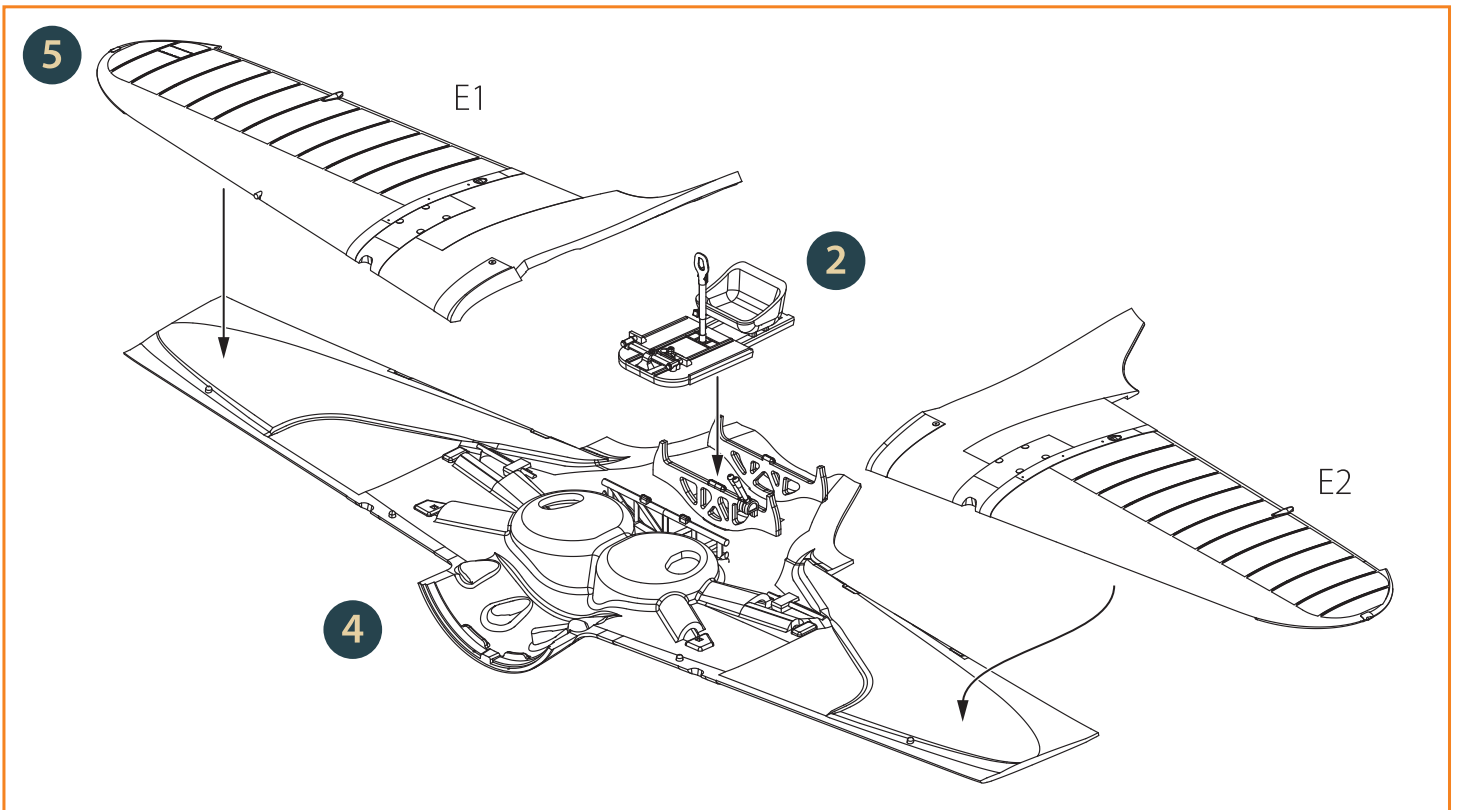

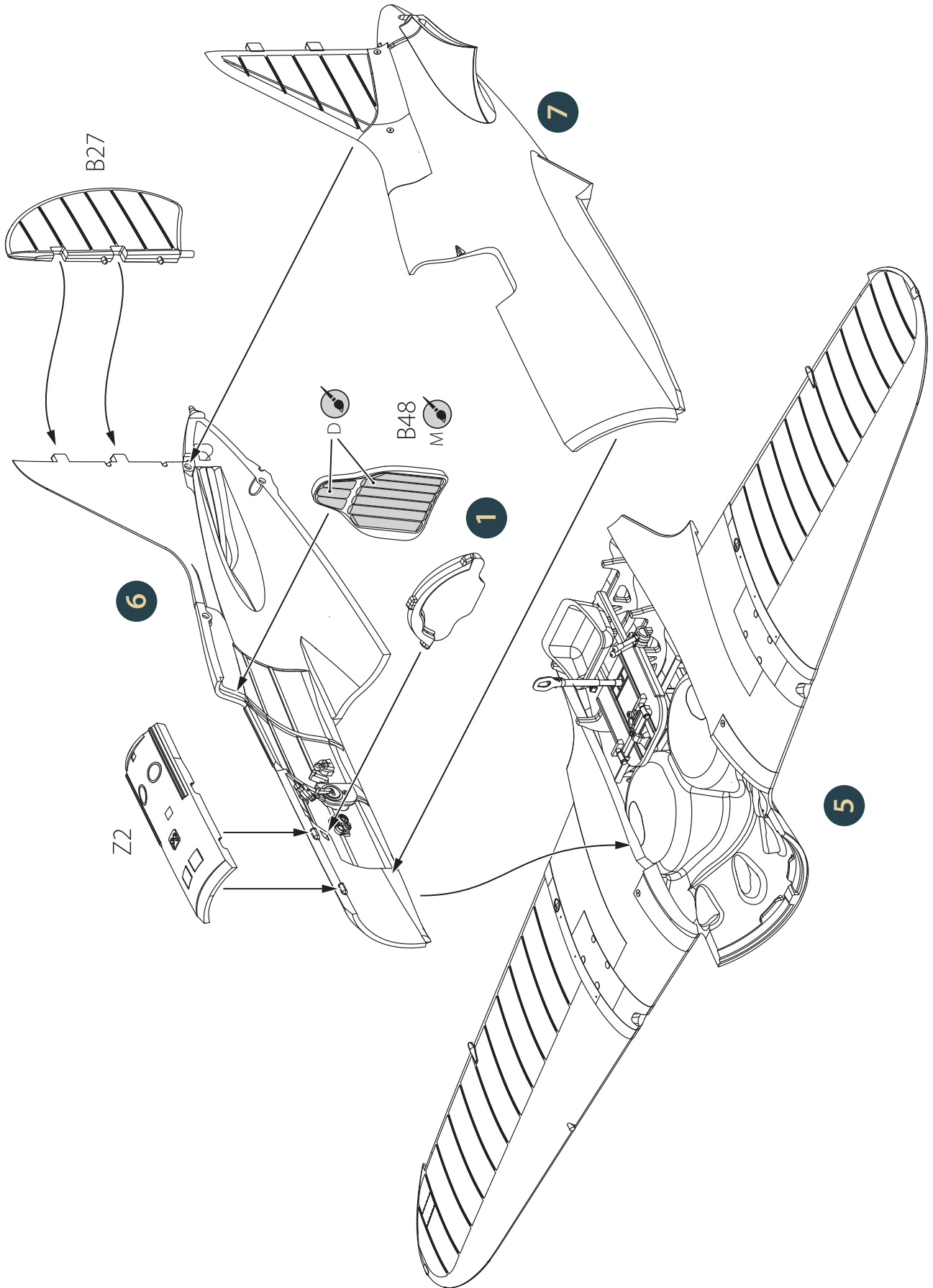



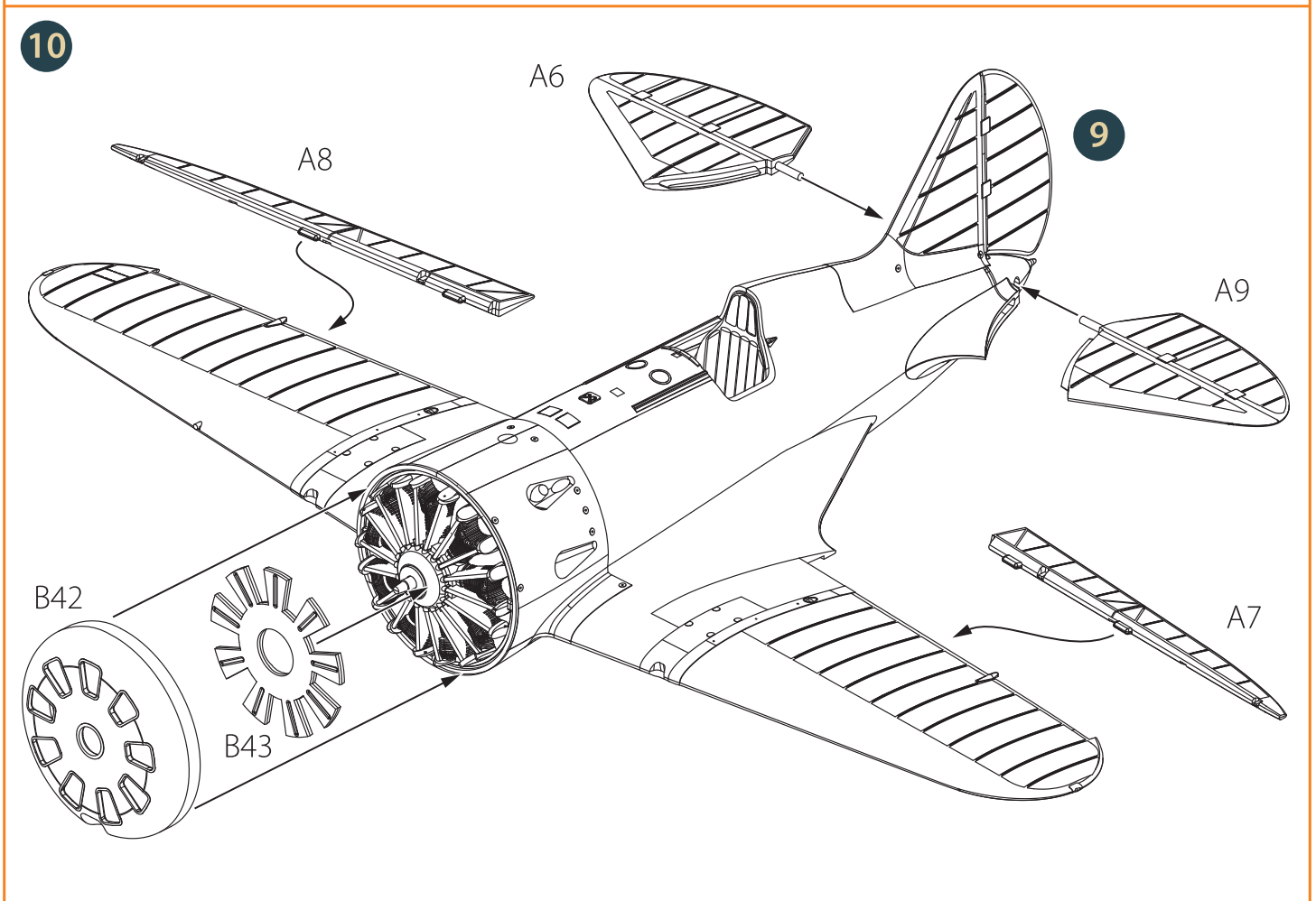
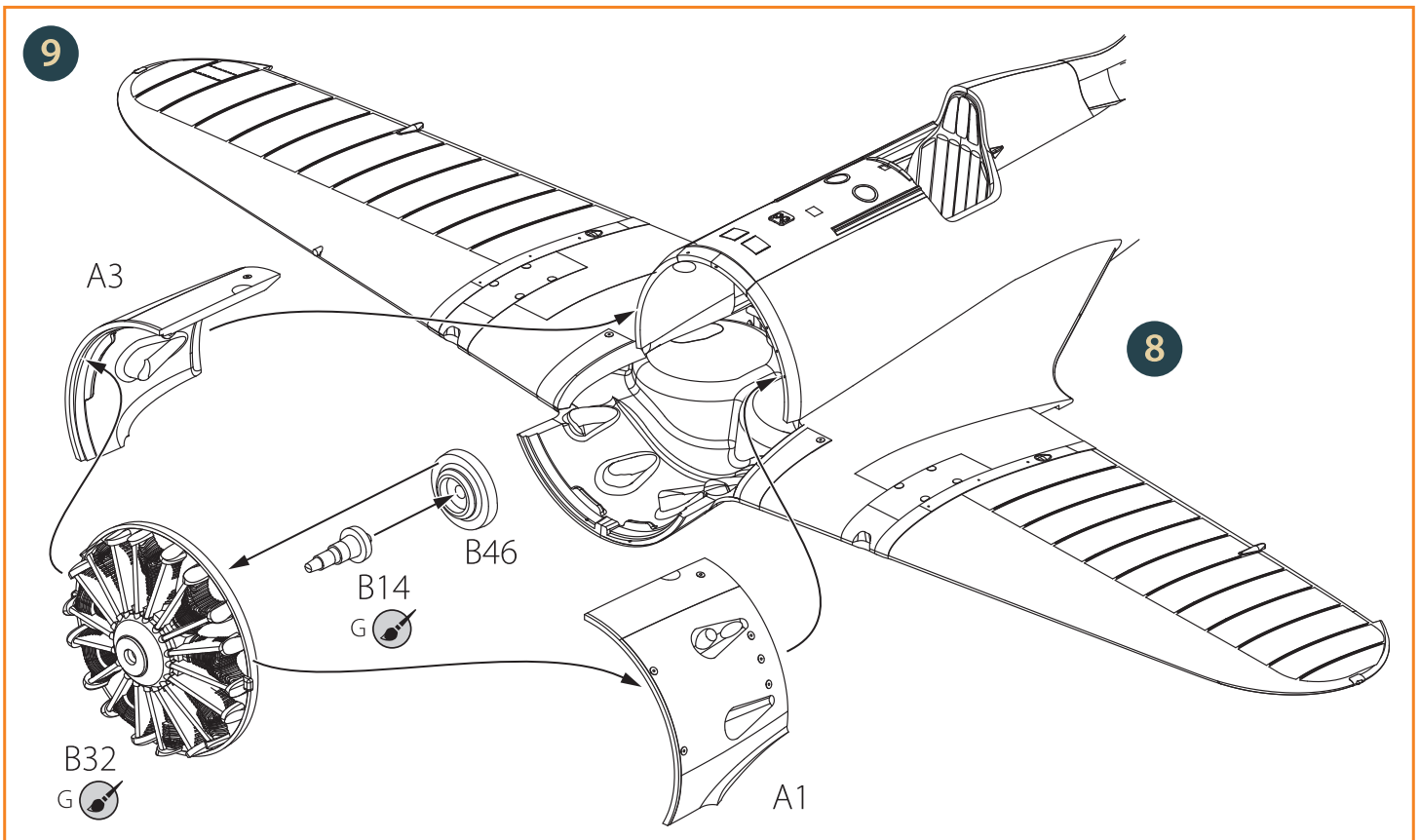

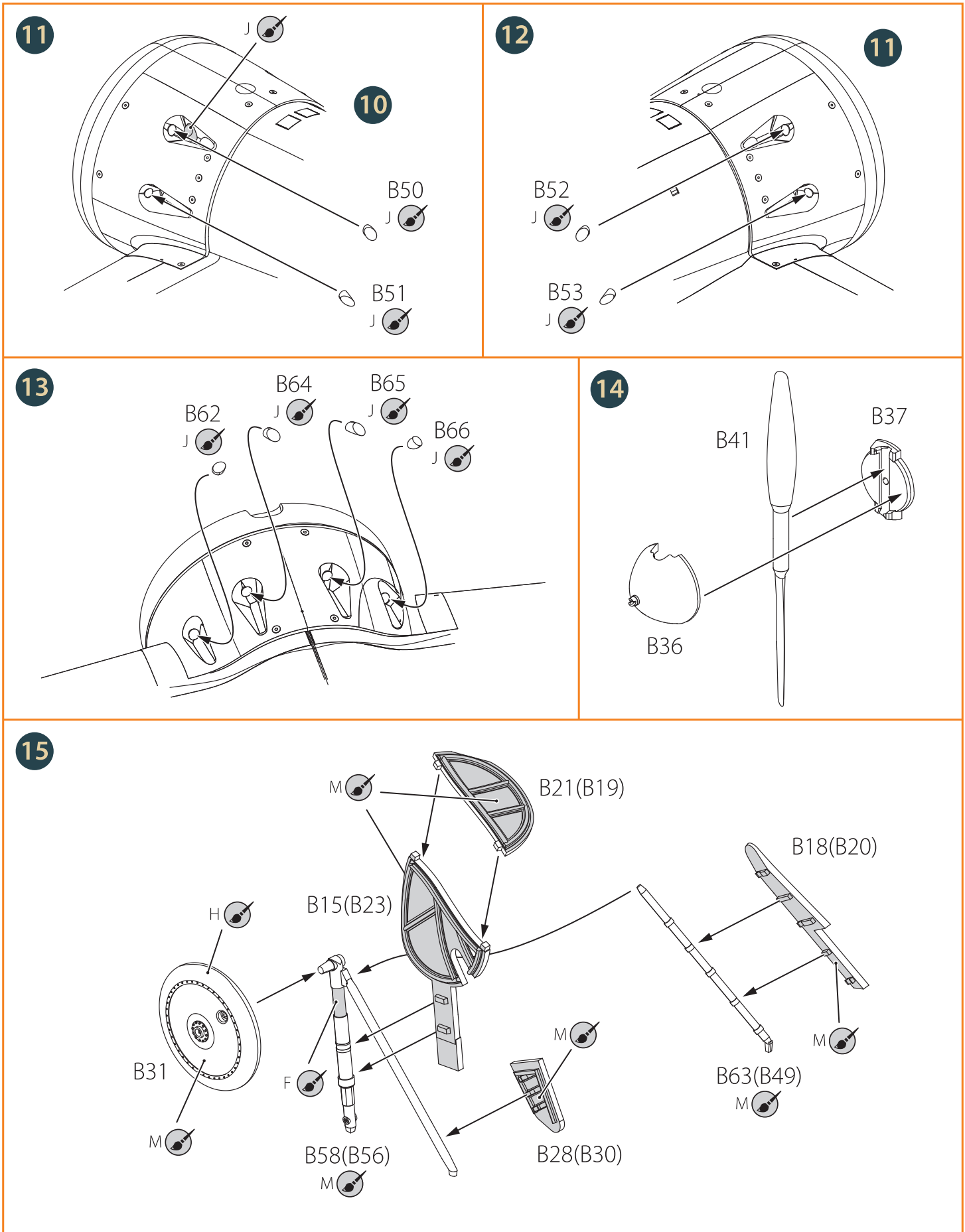







A. MIG-0080  
AMT-4 GREEN



B. MIG-0046  
AMT-6 BLACK



C. MIG-0224  
SKY LINE BLUE



E. MIG-122  
BONE



F. MIG-0191  
POLISHED STEEL



L. MIG-0049  
RED



N. MIG-0050  
WHITE



O. MIG-257  
AZURE BLUE



P. MIG-249  
LIGHT BLUE

① I-16 type 5. Belarusian Military District, 1936.

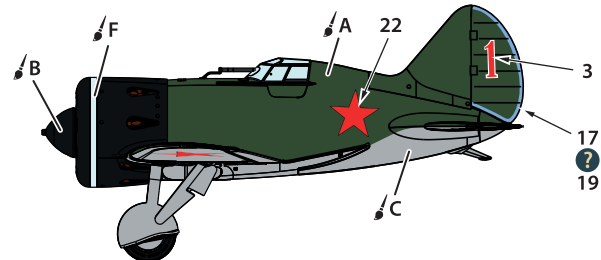
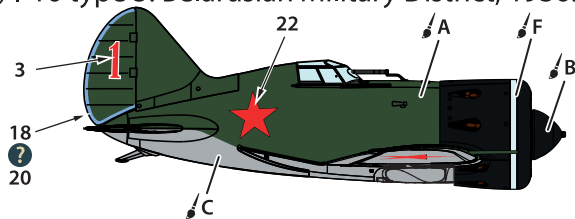

② I-16 type 5. Air Force Research Institute, summer 1939.

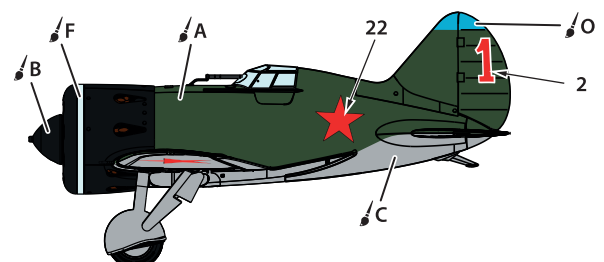
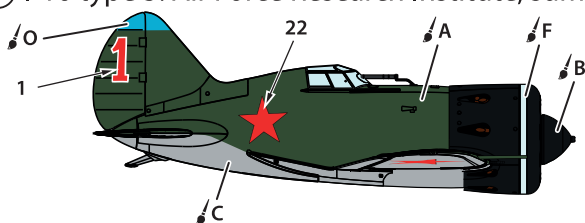

③ I-16 type 5. 2ae. 70th IAP. Mongolian People's Republic, autumn 1938.

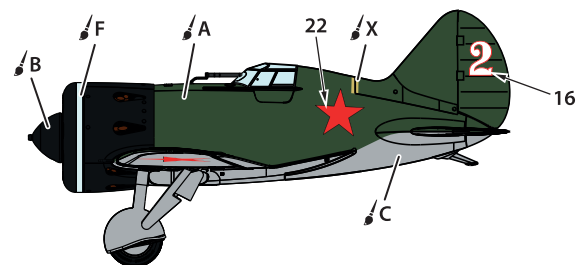
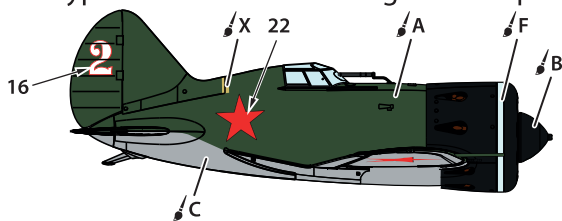

④ I-16 type 5. (No. 123954) prototype of the first serial I-16 type 5. Air Force Research Institute J.

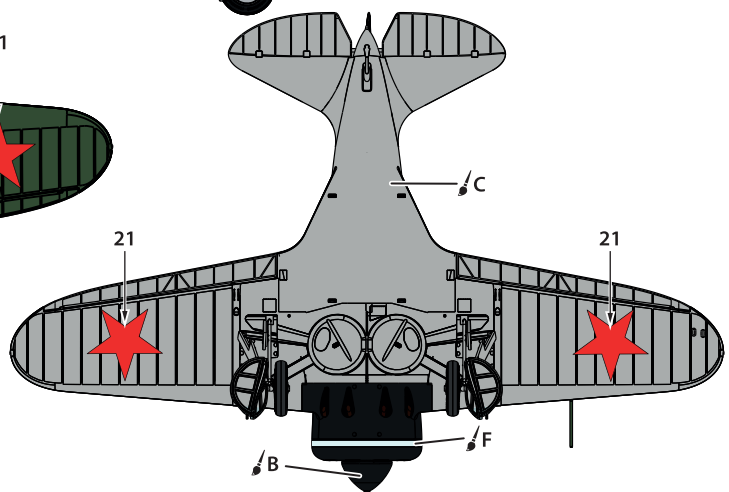
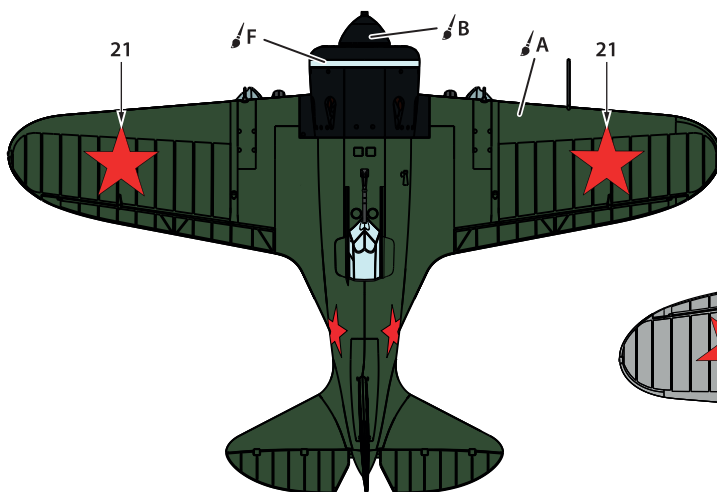
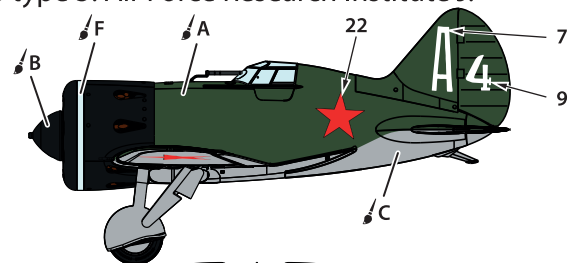
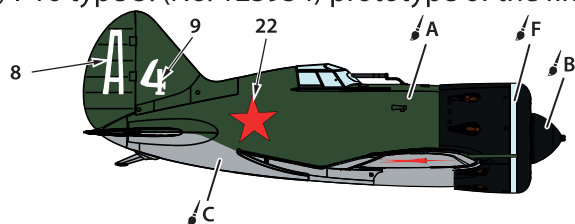

<b>A</b>	<b>B</b>	<b>C</b>	<b>E</b>	<b>F</b>	<b>L</b>	<b>N</b>	<b>O</b>	<b>P</b>
A.MIG-0080 AMT-4 GREEN	A.MIG-0046 AMT-6 BLACK	A.MIG-0224 SKY LINE BLUE	A.MIG-122 BONE	A.MIG-0191 POLISHED STEEL	A.MIG-0049 RED	A.MIG-0050 WHITE	A.MIG-257 AZURE BLUE	A.MIG-249 LIGHT BLUE

⑤ I-16 type 5. 21st squadron. Pilot Liu Chi Sheng (Three victories) Hankow, March 1938.

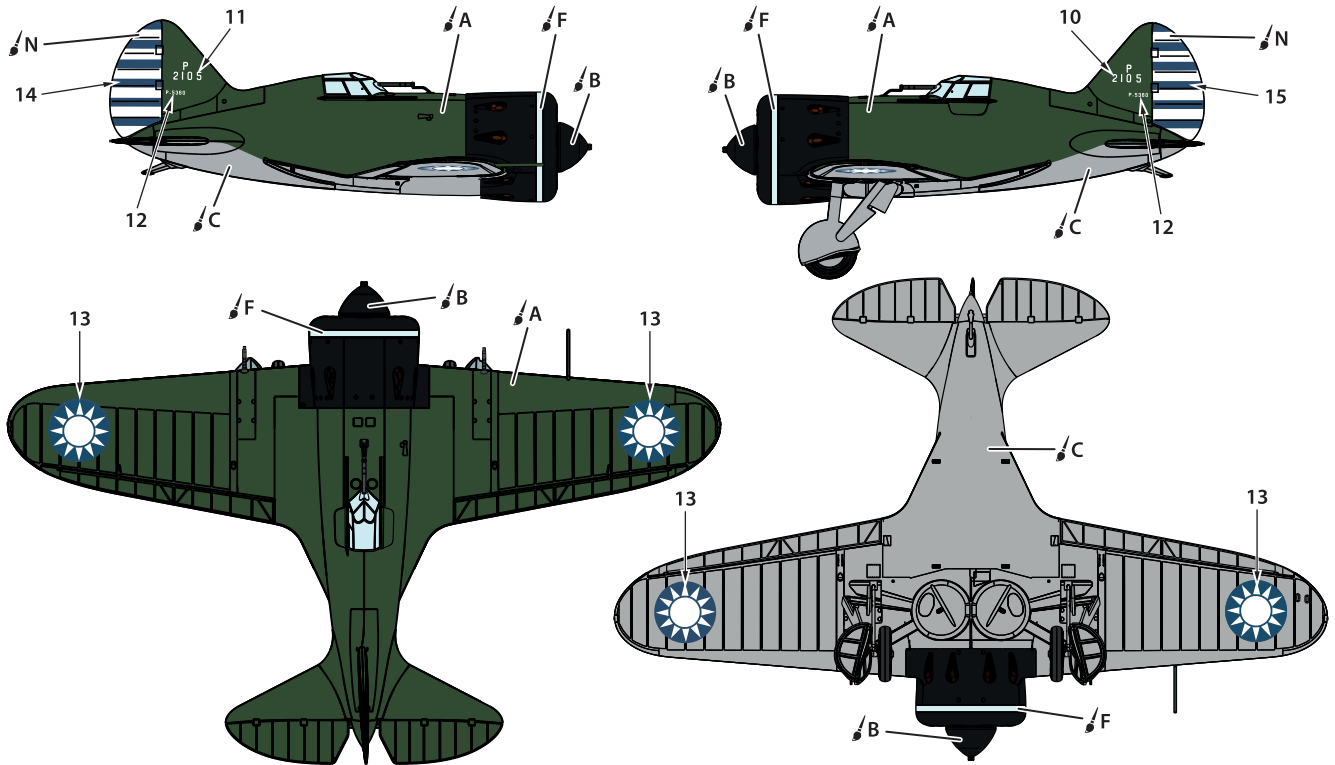

⑥ I-16 type 5. Aircraft of Soviet pilots of internationalists, 1938.

