



*Lukasz Sztybel*

--- eduArt

# Dawn Patrol

SPAD XIII & Fokker D.VII 1/48 scale plastic kit

INSTRUCTION SHEET

**eduard**

#11102X

#11102X - NAVI

ATTENTION



UPOZORNĚNÍ



ACHTUNG



ATTENTION



注意



Carefully read instruction sheet before assembling. When you use glue or paint, do not use near open flame and use in well ventilated room. Keep out of reach of small children. Children must not be allowed to suck any part, or pull vinyl bag over the head.



Před započatím stavby si pečlivě prostudujte stavební návod. Při používání barev a lepidel pracujte v dobře větrané místnosti. Lepidla ani barvy nepoužívejte v blízkosti otevřeného ohně. Model není určen malým dětem, mohlo by dojít k požití drobných dílů.

INSTRUCTION SIGNS

\* INSTR. SYMBOLY

\* INSTRUKTION SINNBILDEN

\* SYMBOLES

\* 記号の説明

OPTIONAL  
VOLBABEND  
OHNOUTOPEN HOLE  
VYVRTAT OTVORSYMMETRICAL ASSEMBLY  
SYMETRICKÁ MONTÁŽREMOVE  
ODŘÍZNOUTREVERSE SIDE  
OTOČITAPPLY EDUARD MASK  
AND PAINT  
POUŽÍT EDUARD MASK  
NABARVIT

PARTS



DÍLY



TEILE



PIÈCES



部品

# Fokker D.VII

## PLASTIC PARTS

A&gt;

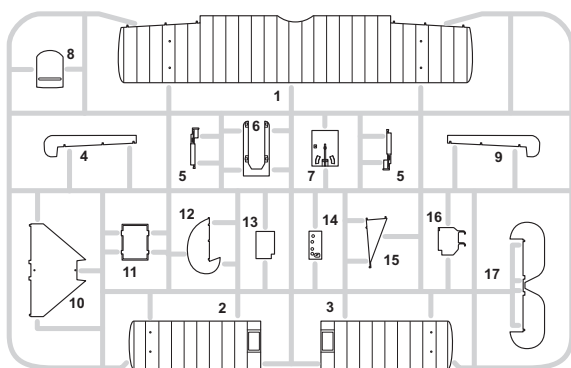

B&gt;

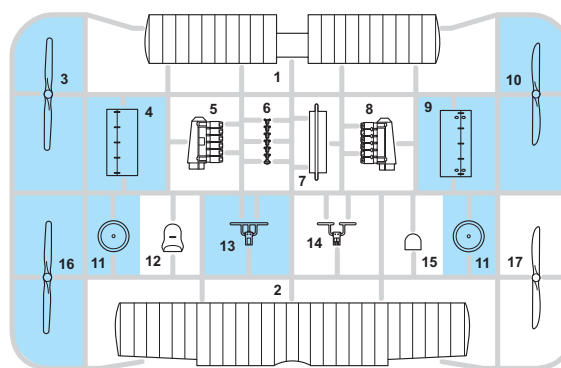
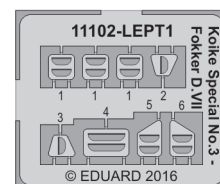
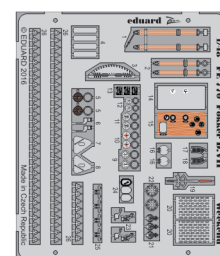
PE - PHOTO ETCHED  
DETAIL PARTS

C&gt;

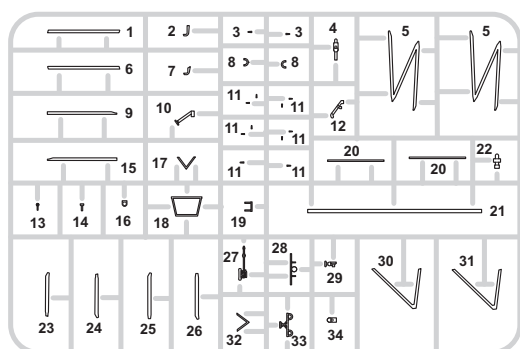

E&gt;

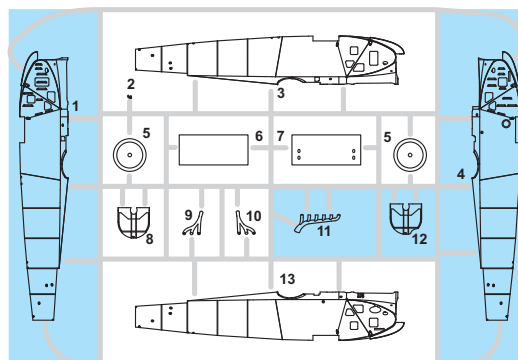
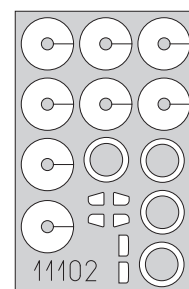
eduard  
MASK

-Parts not for use. -Teile werden nicht verwendet. -Pièces à ne pas utiliser. -Tyto díly nepoužívejte při stavbě. - 使用しない部品

COLOURS



BARVY



FARBEN



PEINTURE



色

| GSI Creos (GUNZE) |          |              |
|-------------------|----------|--------------|
| AQUEOUS           | Mr.COLOR |              |
| H 3               | C3       | RED          |
| H 8               | C8       | SILVER       |
| H 11              | C62      | FLAT WHITE   |
| H 12              | C33      | FLAT BLACK   |
| H 37              | C43      | WOOD BROWN   |
| H 47              | C41      | RED BROWN    |
| H 53              | C13      | NEUTRAL GRAY |
| H 76              | C61      | BURNT IRON   |

| AQUEOUS                 | Mr.COLOR |                 |
|-------------------------|----------|-----------------|
| H 77                    | C137     | TIRE BLACK      |
| H 85                    | C45      | SAIL COLOR      |
| H 423                   | C123     | DARK GREEN      |
| Mr.METAL COLOR          |          |                 |
|                         | MC212    | IRON            |
|                         | MC219    | BRASS           |
| Mr.COLOR SUPER METALLIC |          |                 |
|                         | SM04     | SUPET STAINLESS |

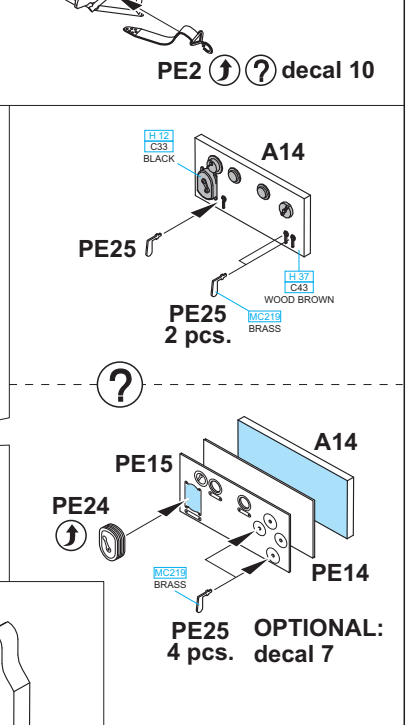
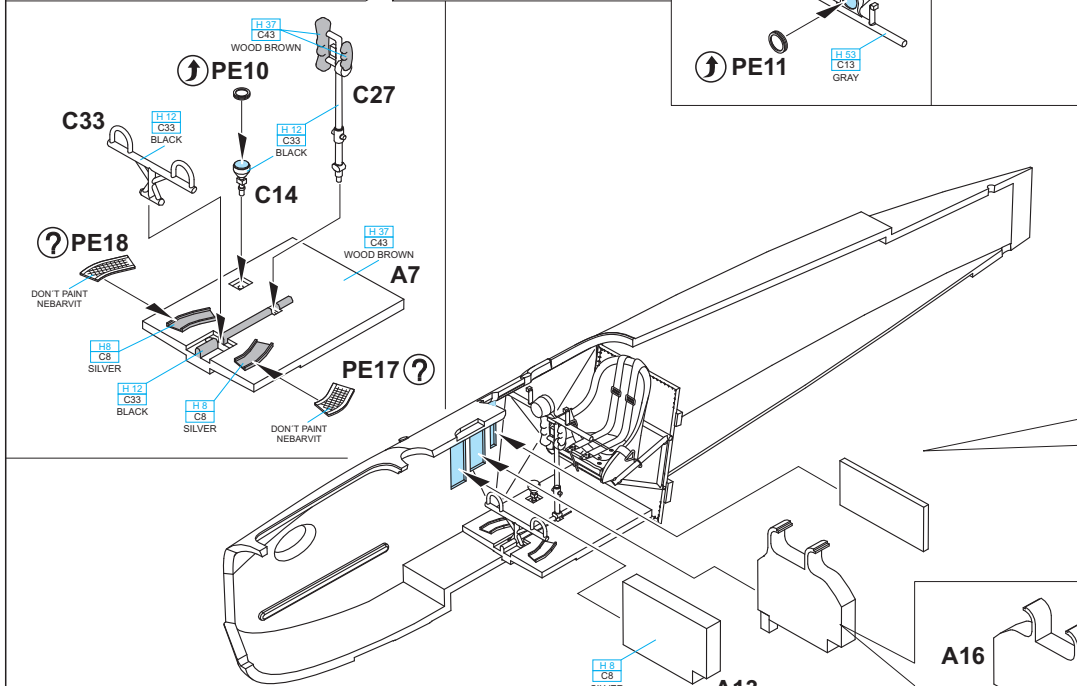
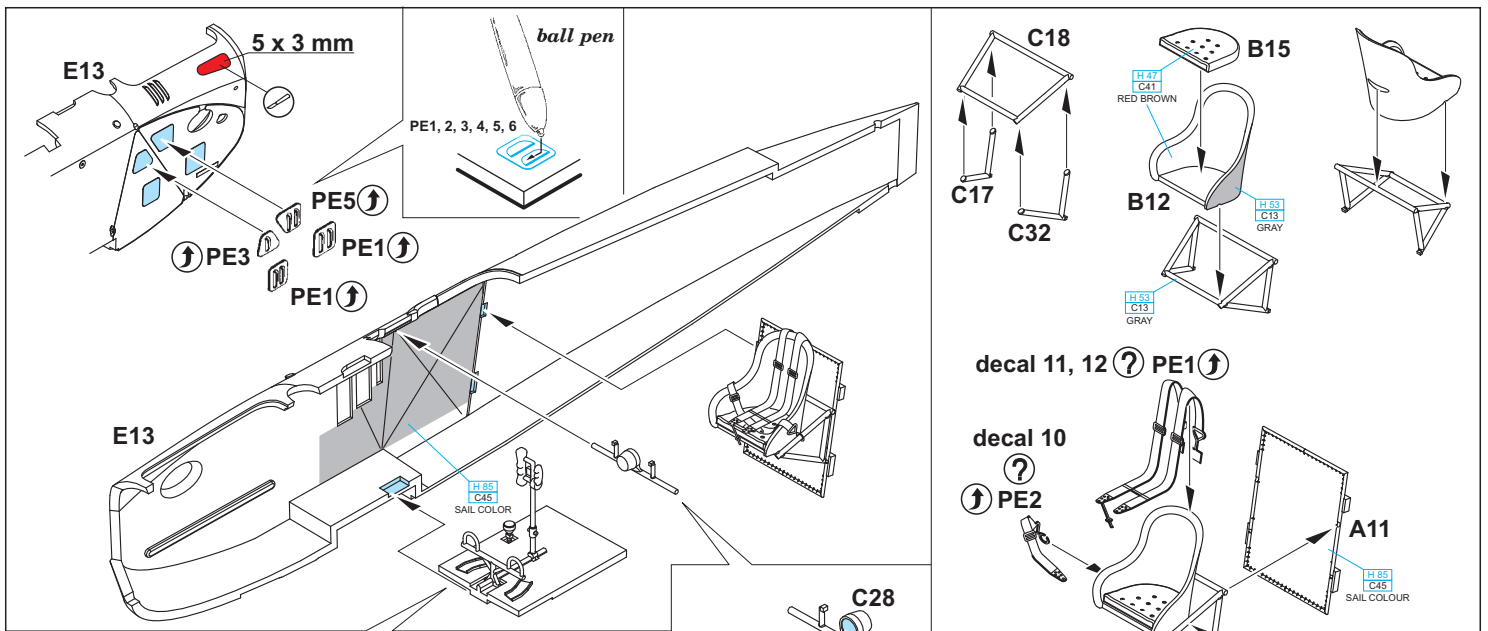

Mercedes D.IIIa engine installation. Art by Mark Miller.  
Instalace motoru Mercedes D.III. Obraz od Marka Millera.

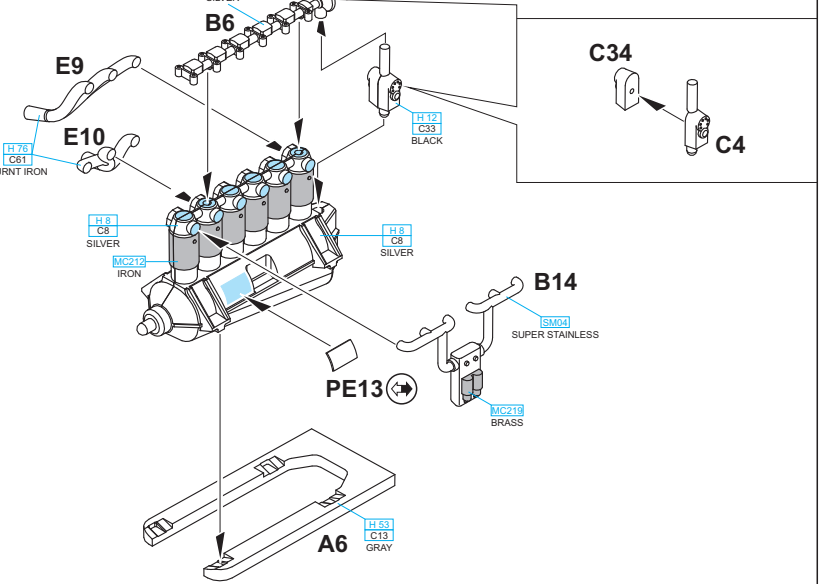
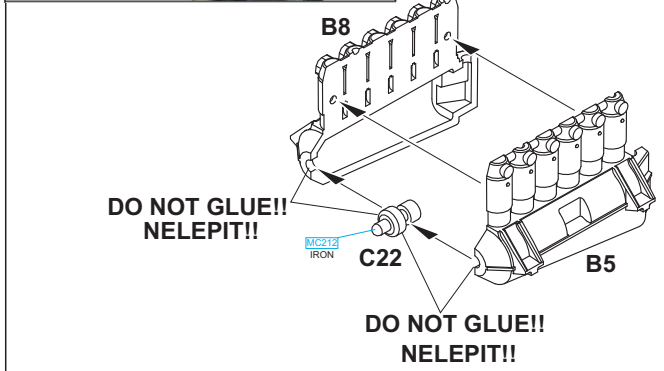
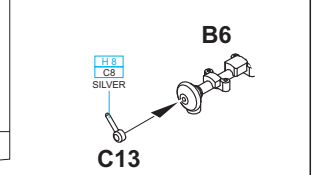
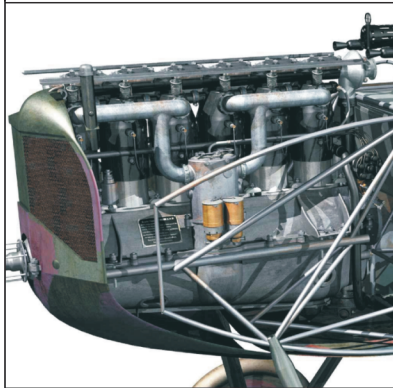

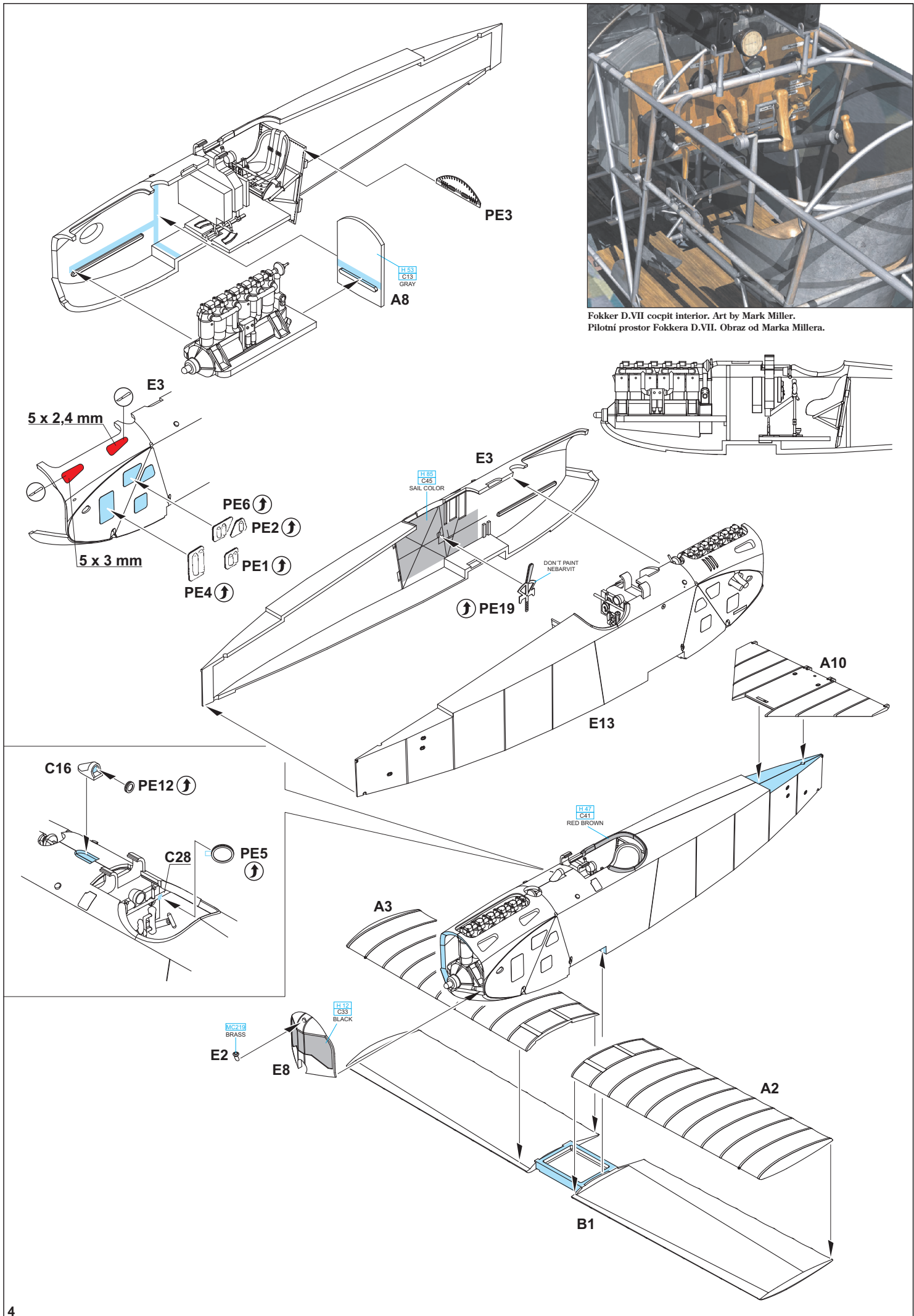

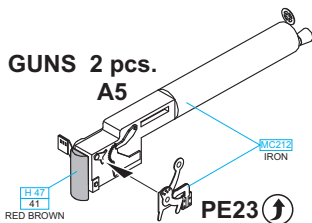
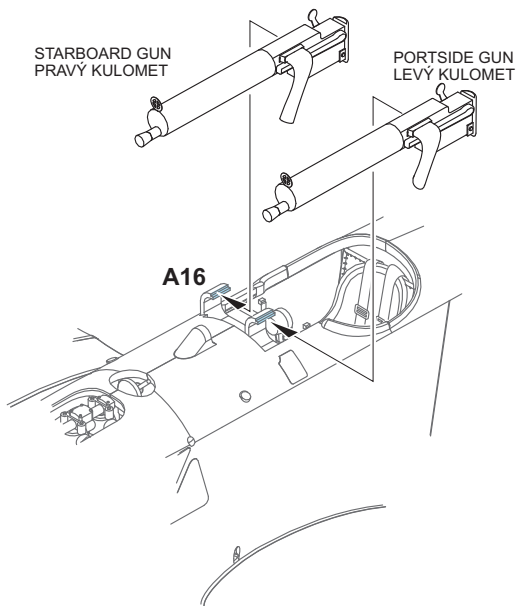
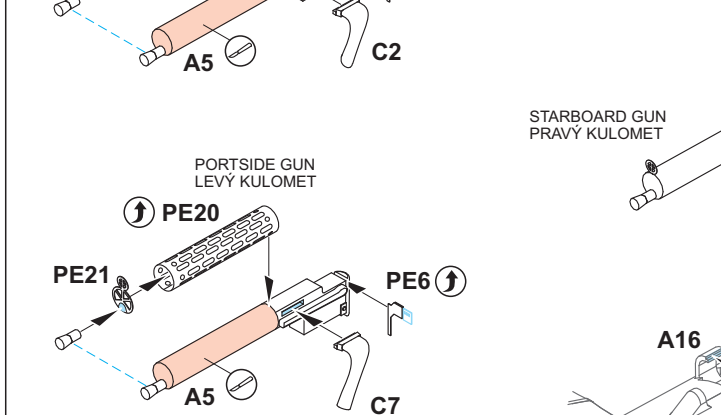
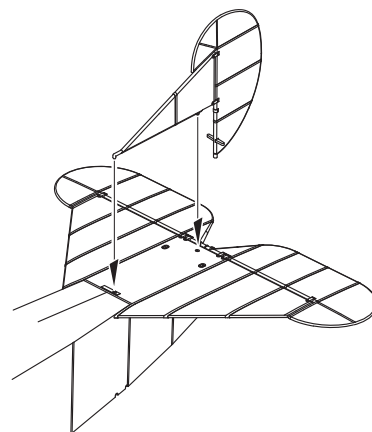
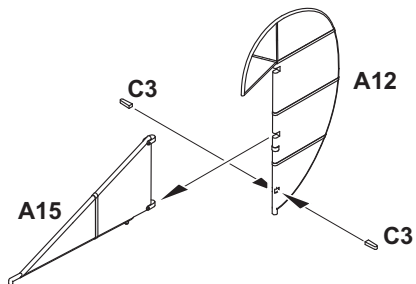
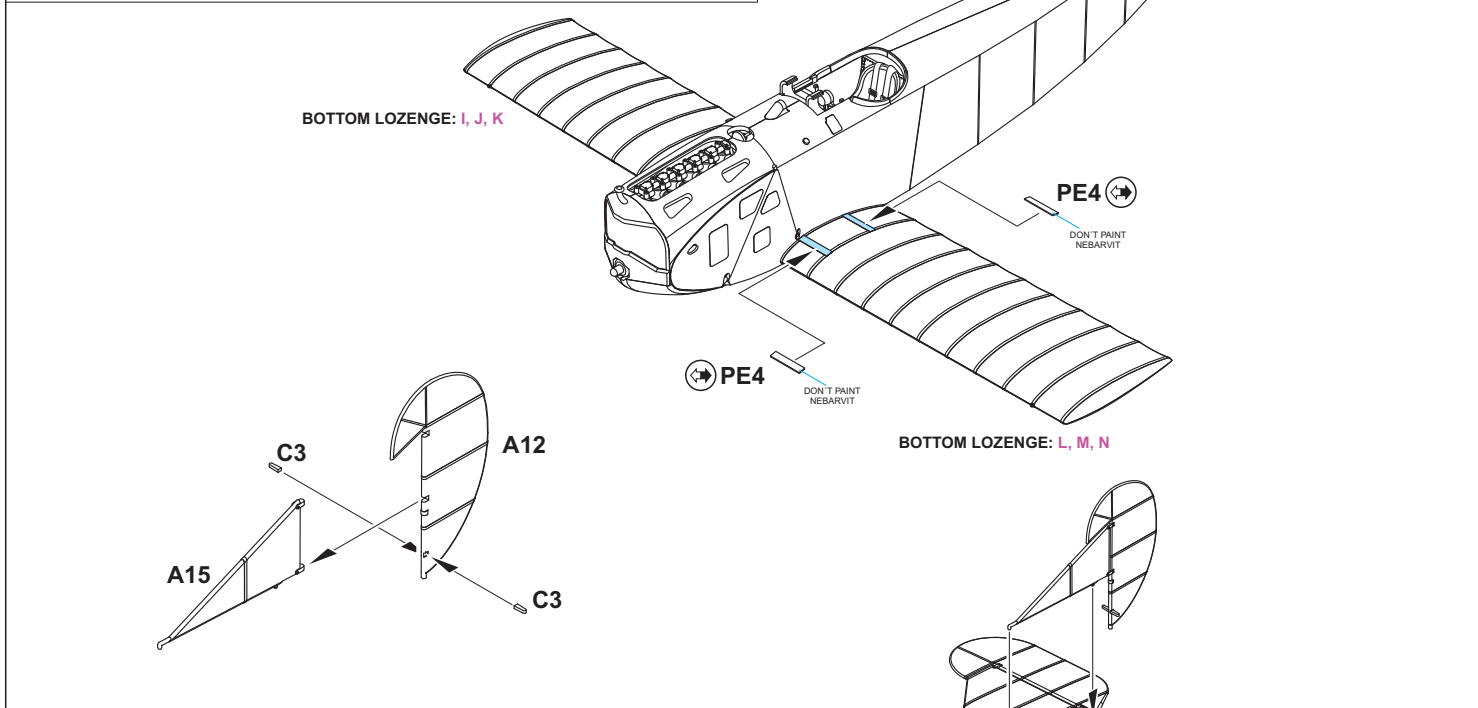
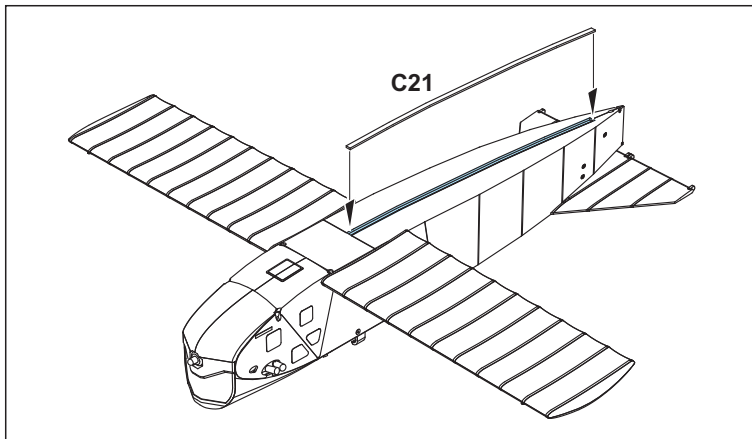

Dashboard & machine gun instalation. Art by Mark Miller.  
Palubní deska a kulometry. Obraz od Marka Millera.

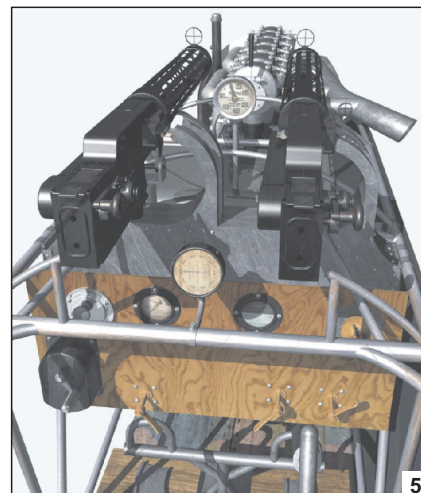

APPLY LOZENGE DECAL IN THIS STEP  
V TOMTO KROKU NANESTE OBTISKY LOZENGE

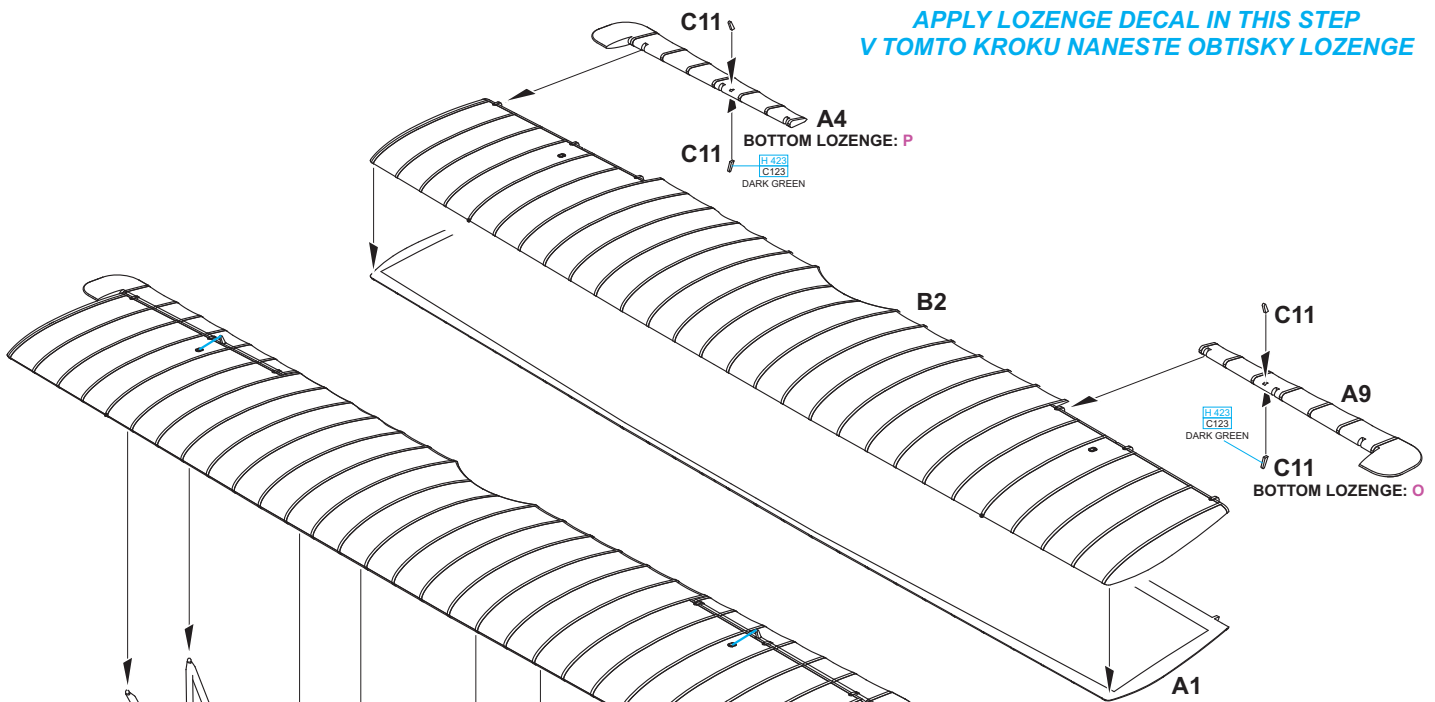

**BOTTOM LOZENGE: A, B, C, D, E, F, G, H**  
RIB STRIPES AND COMPLETE LOZENGE DECAL  
APPLICATION - SEE PAGE 7  
PRO APLIKACI PÁSKŮ NA ŽEBRA A KOMPLETNÍCH  
LOZENGOVÝCH OBTISKŮ PROSTUDUJTE str. 7

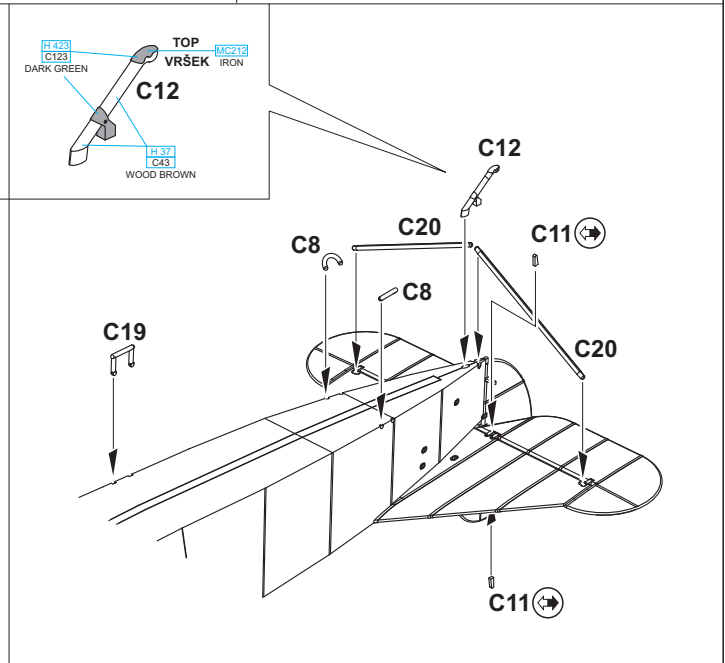
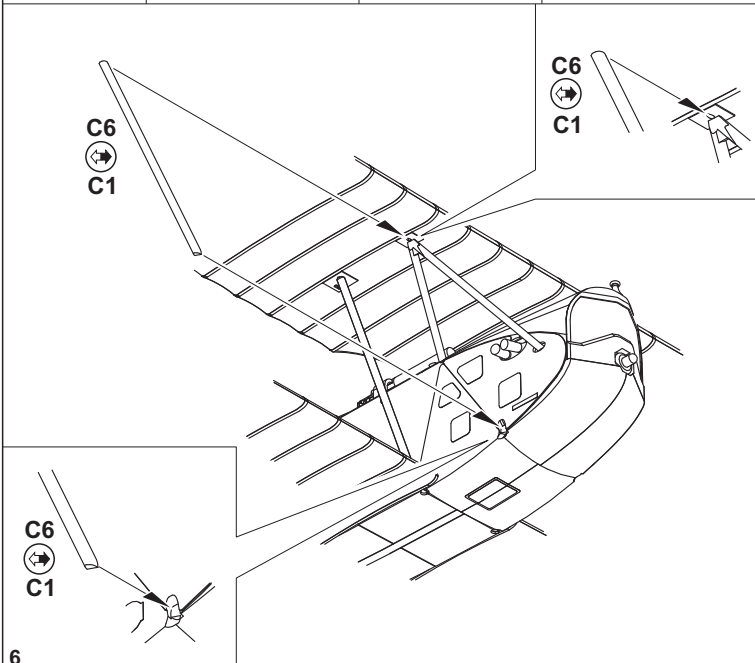
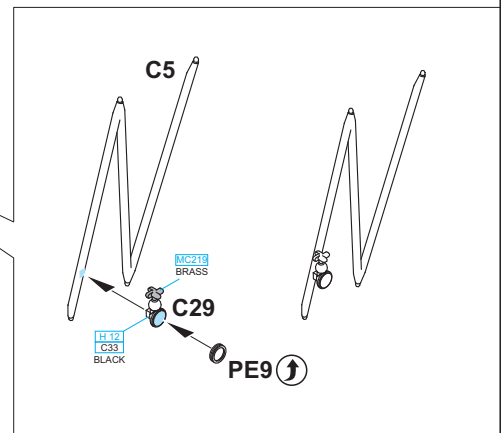
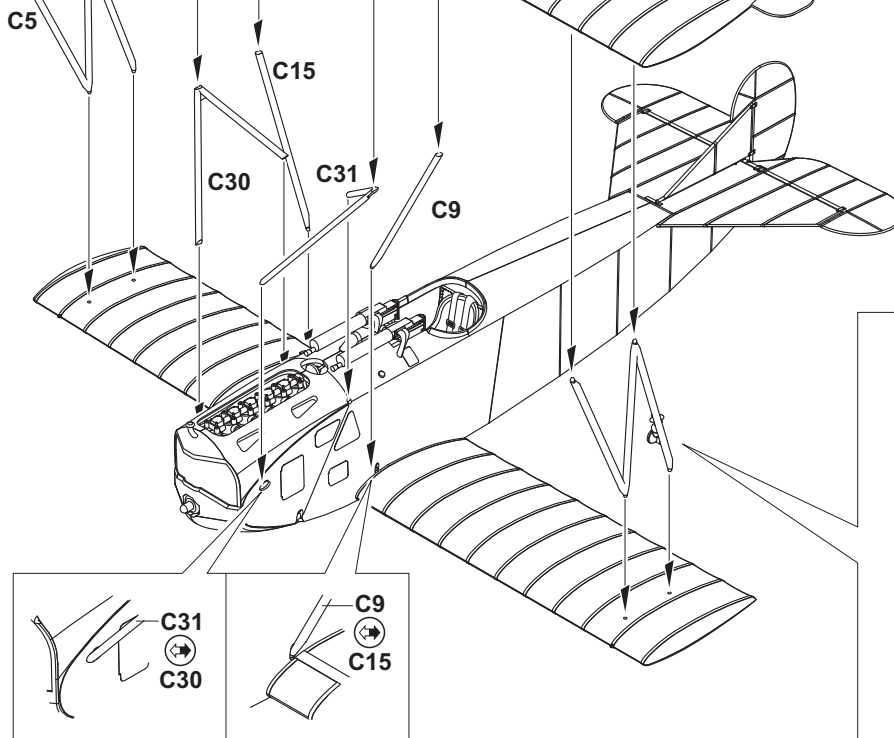

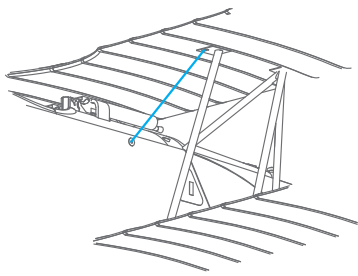
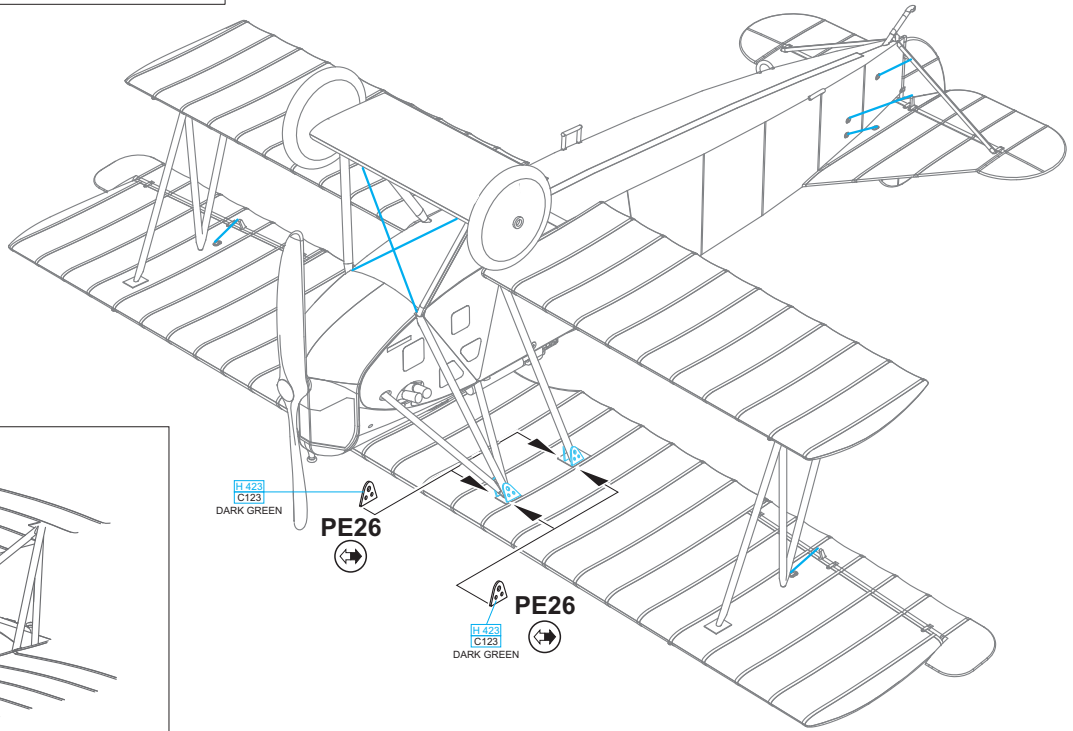
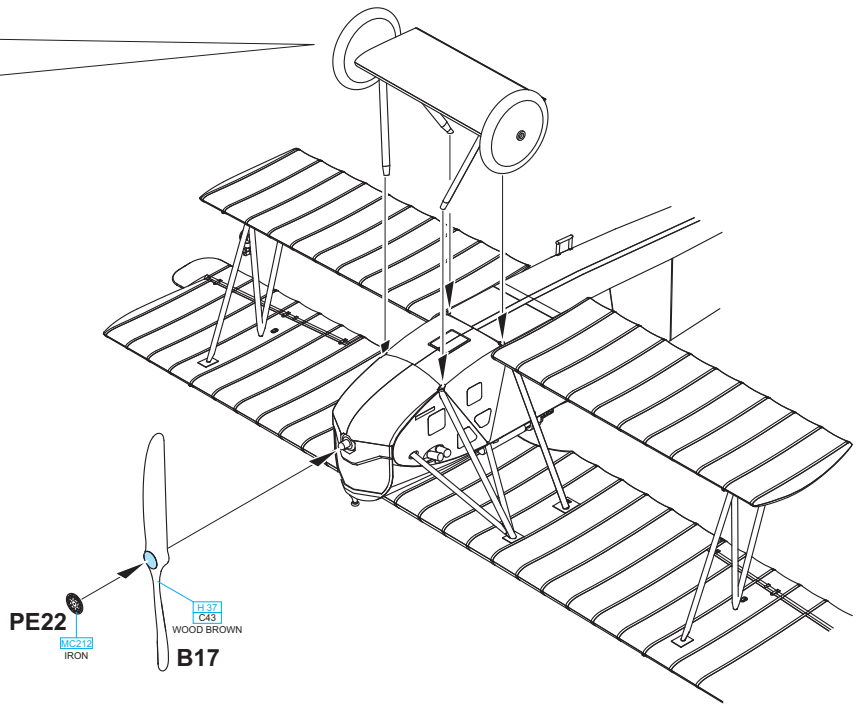
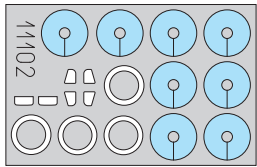
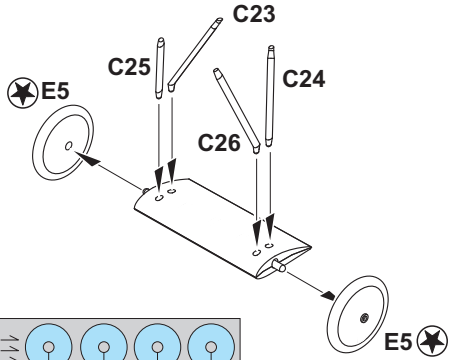
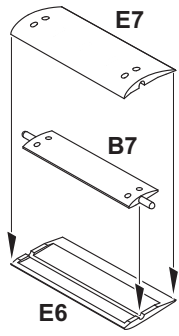

# PORTY

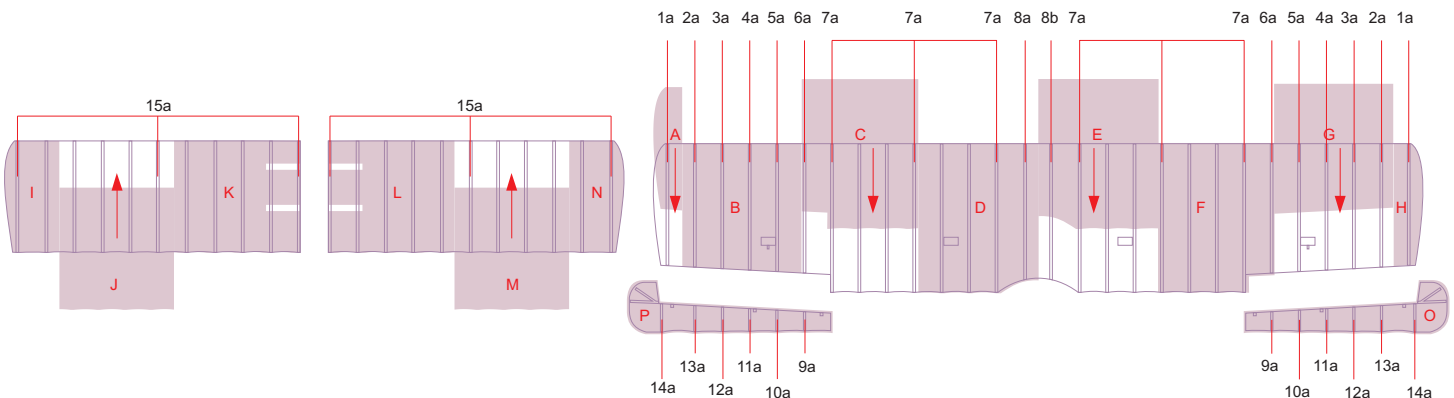

# A Fokker D.VII (Alb), flown by Ltn. d. R. Günther von Büren, Jasta 18, Montingen, September 1918

This aircraft was flown by Ltn. d. R. Günther von Büren, a native of Berlin – Charlottenburg. When war broke out, he joined an infantry regiment as a volunteer (2. Königlich Sächsischen Ulanen-Regiment Nr. 18). He served with this unit until the Summer of 1918 when he joined Fliegerabteilung 31. In August 1918, von Büren became a member of Jasta 18, know as Raben Staffel. The squadron was named after the Staffel CO – August Raben. The raven (der Raben in German) was painted on many Staffel aircraft, including von Büren’s machine. The front half of the aircraft is painted red, and the rear is white. It is not clear if the lower surface of wings were left unpainted in their lozenge-printed fabric, or if painted red.

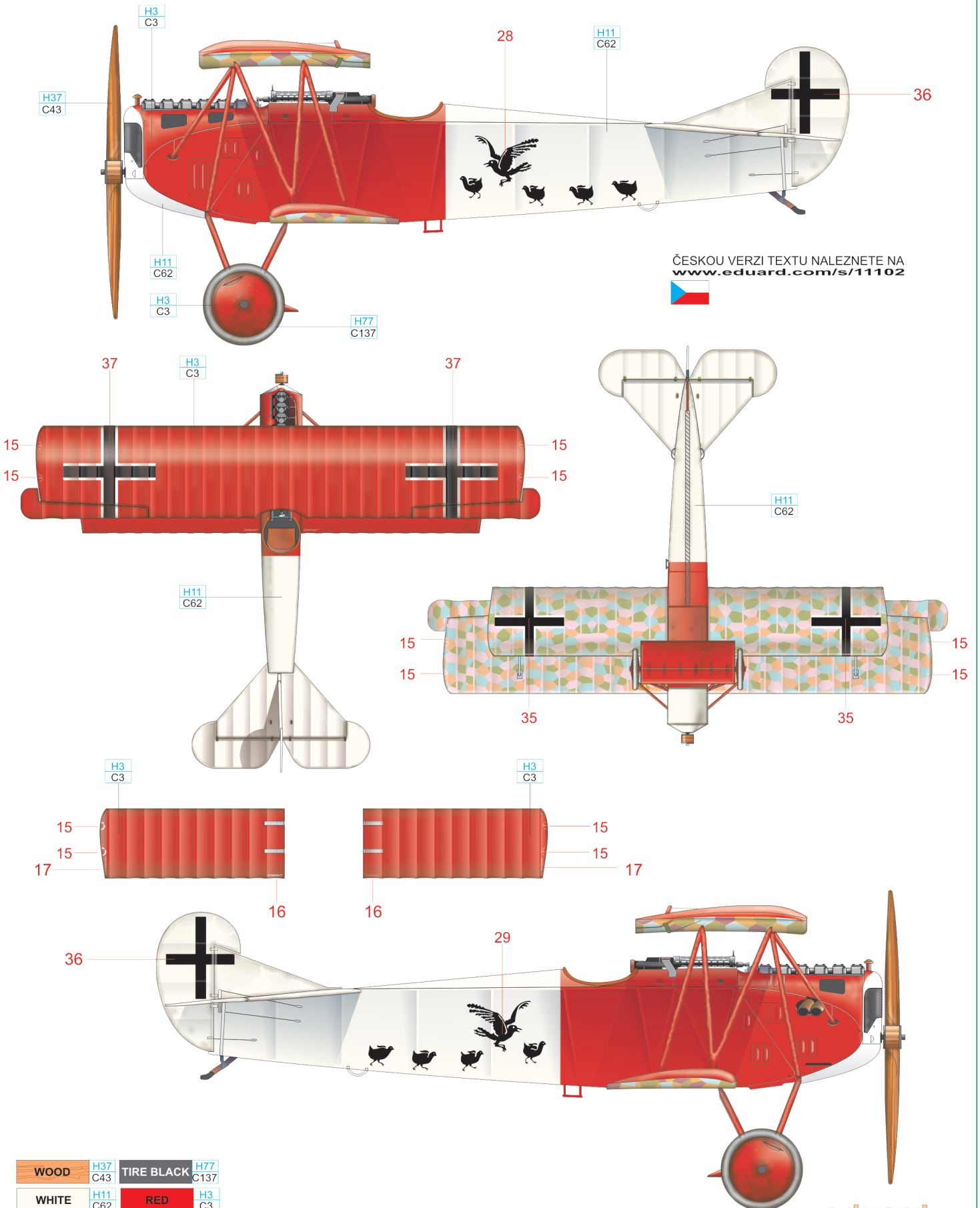

ČESKOU VERZI TEXTU NALEZNETE NA [www.eduard.com/s/11102](http://www.eduard.com/s/11102)



|       |            |            |             |
|-------|------------|------------|-------------|
| WOOD  | H37<br>C43 | TIRE BLACK | H77<br>C137 |
| WHITE | H11<br>C62 | RED        | H3<br>C3    |



ATTENTION



UPOZORNĚNÍ



ACHTUNG



ATTENTION



注意



Carefully read instruction sheet before assembling. When you use glue or paint, do not use near open flame and use in well ventilated room. Keep out of reach of small children. Children must not be allowed to suck any part, or pull vinyl bag over the head.



Před započítím stavby si pečlivě prostudujte stavební návod. Při používání barev a lepidel pracujte v dobře větrané místnosti. Lepidla ani barvy nepoužívejte v blízkosti otevřeného ohně. Model není určen malým dětem, mohlo by dojít k požití drobných dílů.

INSTRUCTION SIGNS



INSTR. SYMBOLY



INSTRUKTION SINNBILDEN



SYMBOLES

記号の説明

OPTIONAL  
VOLBABEND  
OHNOUTOPEN HOLE  
VYVRTAT OTVORSYMMETRICAL ASSEMBLY  
SYMETRICKÁ MONTÁŽREMOVE  
ODŘÍZNOUTREVERSE SIDE  
OTOČITAPPLY EDUARD MASK  
AND PAINT  
POUŽÍT EDUARD MASK  
NABARVIT

PARTS



DÍLY



TEILE



PIÈCES



部品

# SPAD XIII

PLASTIC PARTS

B&gt;

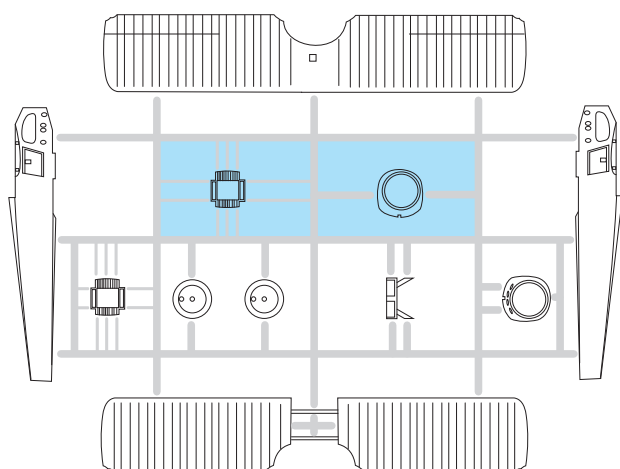

C&gt;

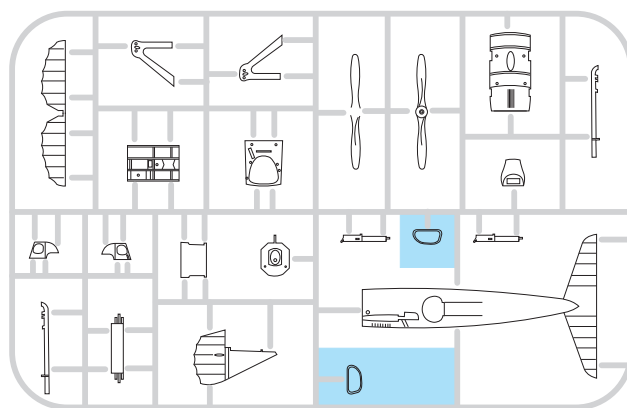

D&gt;

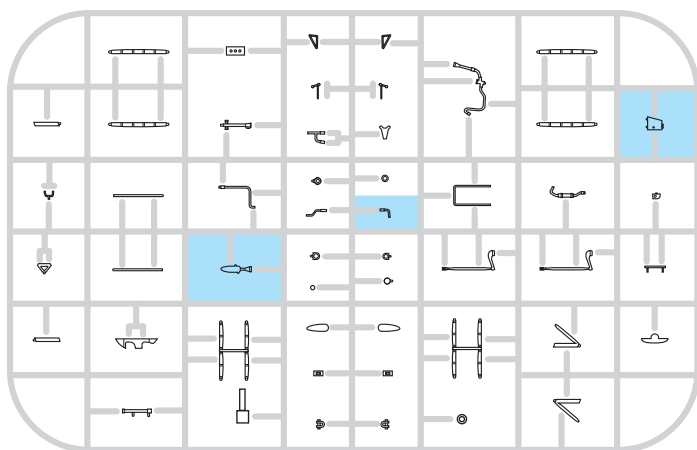

E&gt;

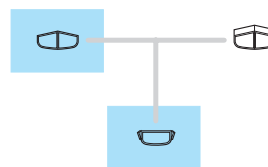

## PE - PHOTO ETCHED DETAIL PARTS

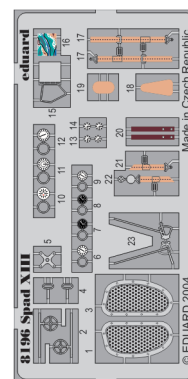

-Parts not for use. -Teile werden nicht verwendet. -Pièces à ne pas utiliser. -Tyto díly nepoužívejte při stavbě. - 使用しない部品

COLOURS



BARVY



FARBEN



PEINTURE



色

| GSI Creos (GUNZE)    |                      |              |
|----------------------|----------------------|--------------|
| AQUEOUS              | Mr.COLOR             |              |
| <a href="#">H 5</a>  | <a href="#">C5</a>   | BLUE         |
| <a href="#">H 12</a> | <a href="#">C33</a>  | FLAT BLACK   |
| <a href="#">H 37</a> | <a href="#">C43</a>  | WOOD BROWN   |
| <a href="#">H 47</a> | <a href="#">C41</a>  | RED BROWN    |
| <a href="#">H 51</a> | <a href="#">C11</a>  | LIGHT GRAY   |
| <a href="#">H 53</a> | <a href="#">C13</a>  | NEUTRAL GRAY |
| <a href="#">H 64</a> | <a href="#">C17</a>  | BLACK GREEN  |
| <a href="#">H 66</a> | <a href="#">C119</a> | SANDY BROWN  |

| GSI Creos (GUNZE)     |                       |            |
|-----------------------|-----------------------|------------|
| AQUEOUS               | Mr.COLOR              |            |
| <a href="#">H 72</a>  | <a href="#">C22</a>   | DARK EARTH |
| <a href="#">H 85</a>  | <a href="#">C45</a>   | SAIL COLOR |
| <a href="#">H 303</a> | <a href="#">C303</a>  | GREEN      |
| AQUEOUS               | Mr.COLOR              |            |
| Mr.METAL COLOR        |                       |            |
|                       | <a href="#">MC214</a> | DARK IRON  |
|                       | <a href="#">MC218</a> | ALUMINIUM  |
|                       | <a href="#">MC219</a> | BRASS      |

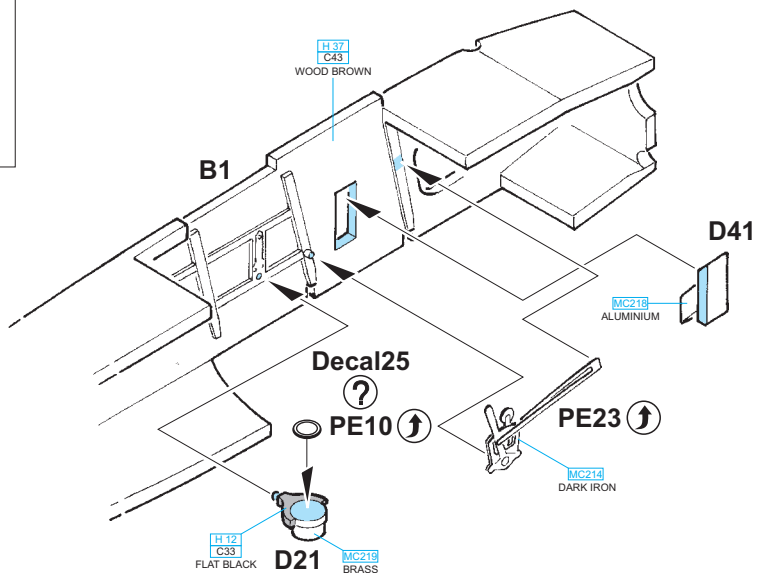
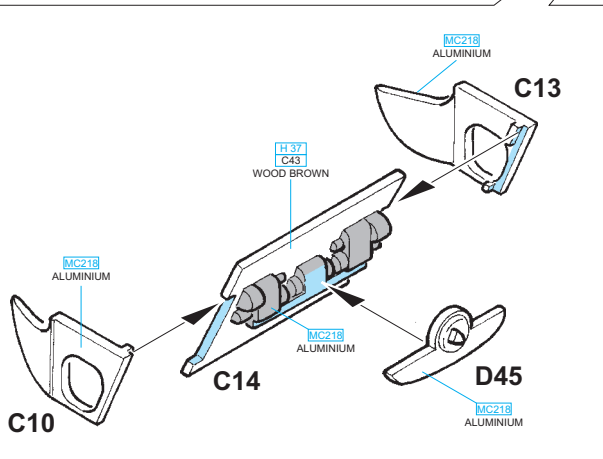
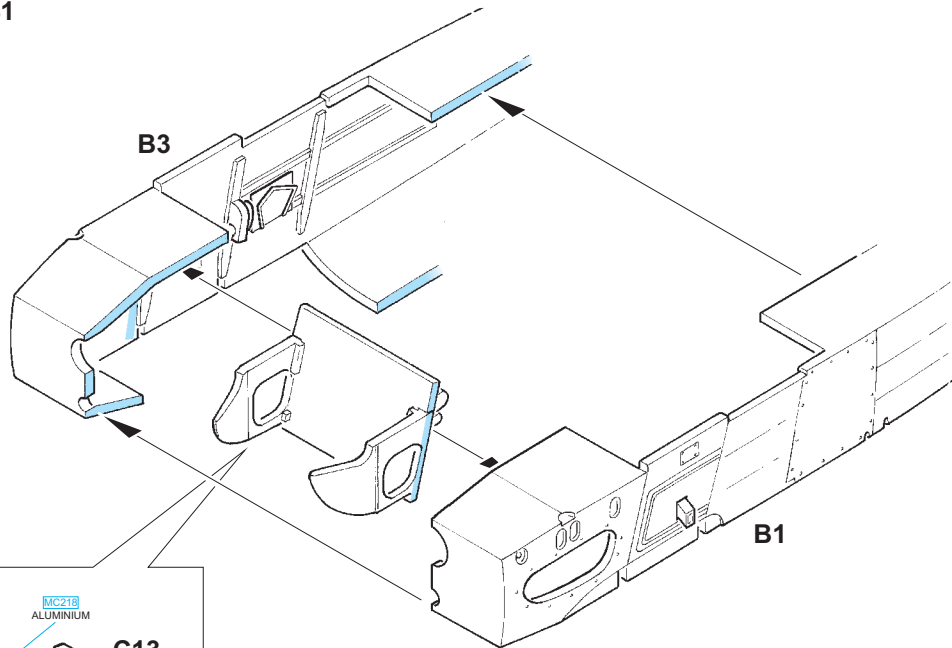
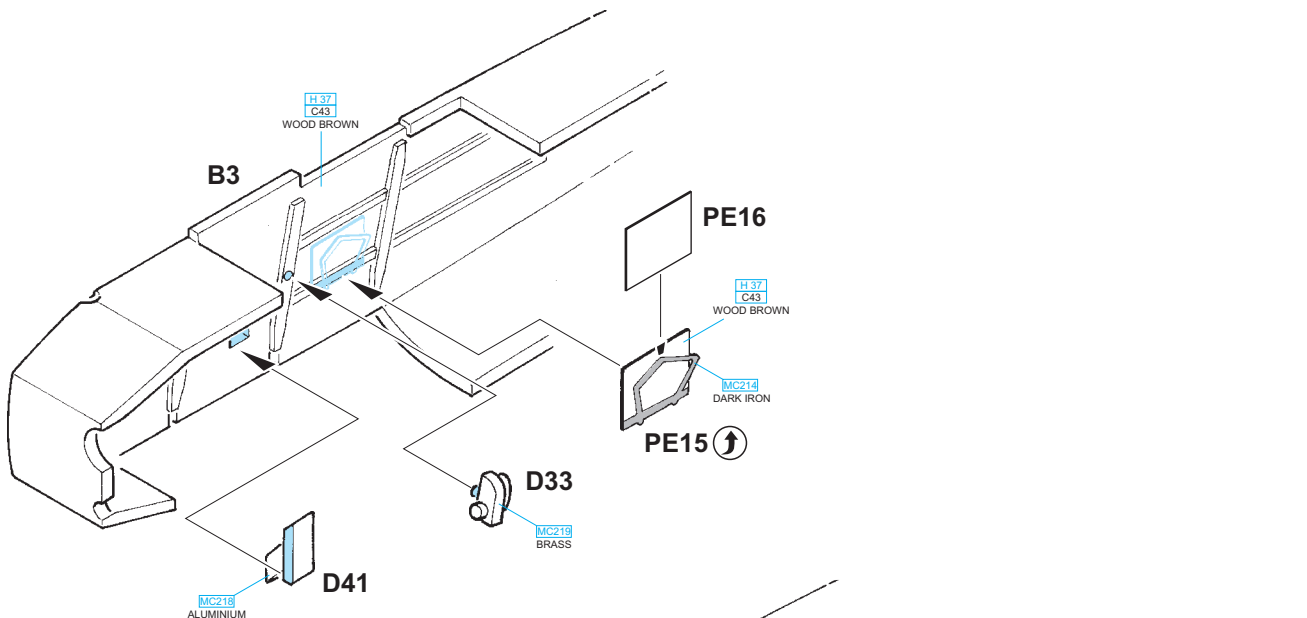

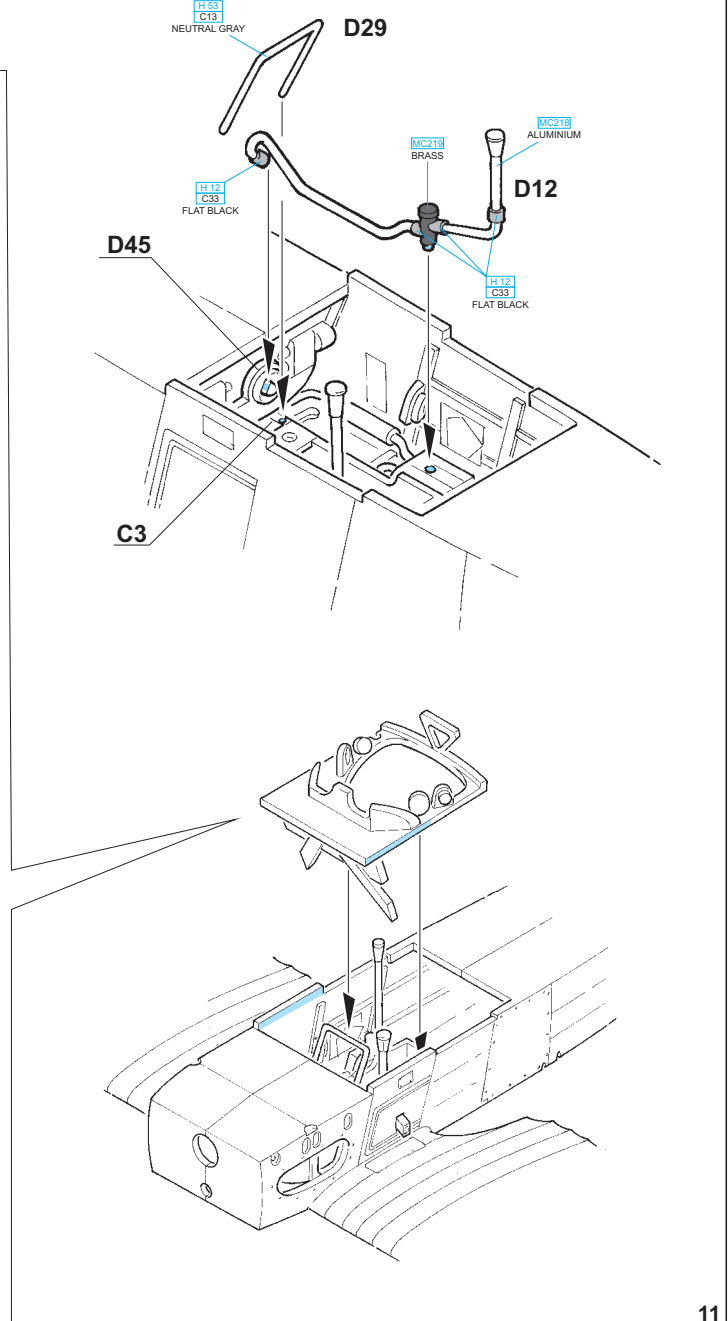
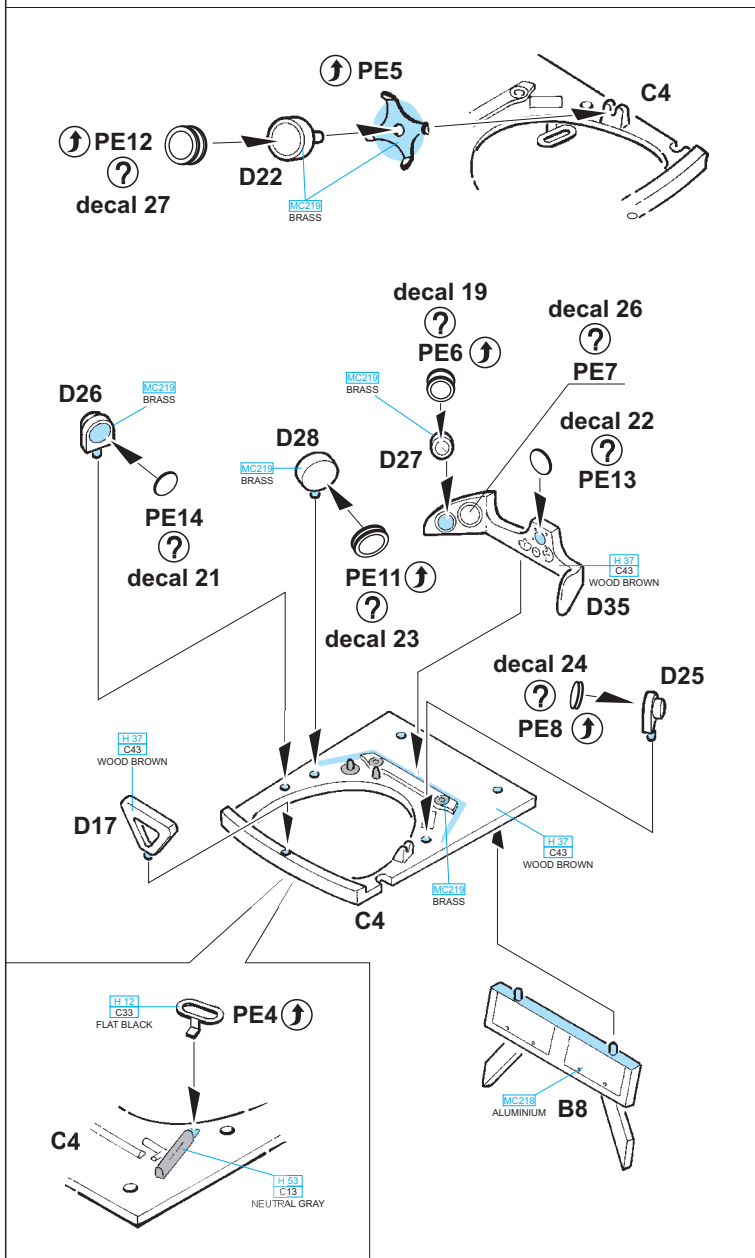
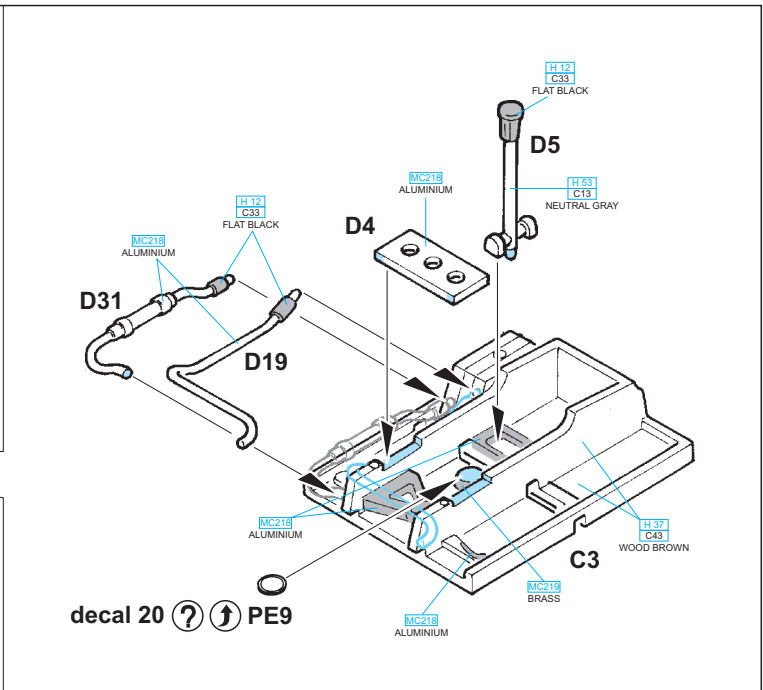
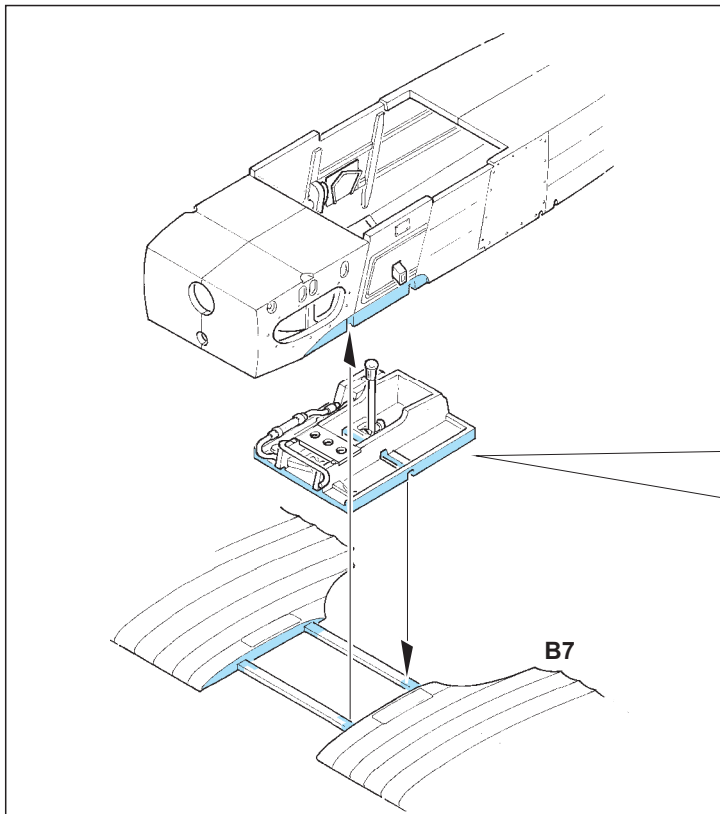

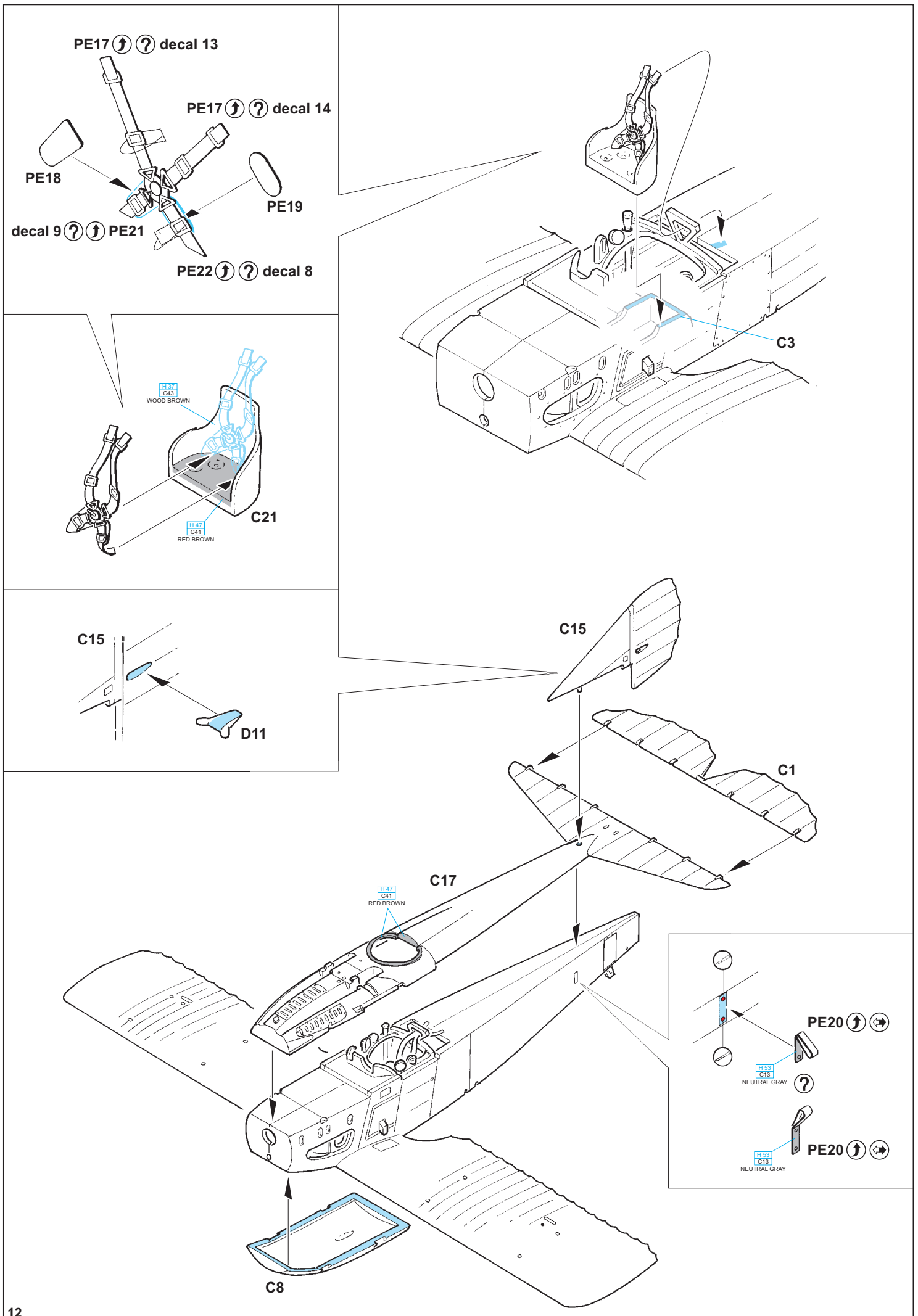

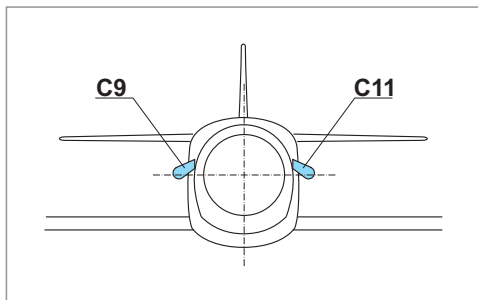
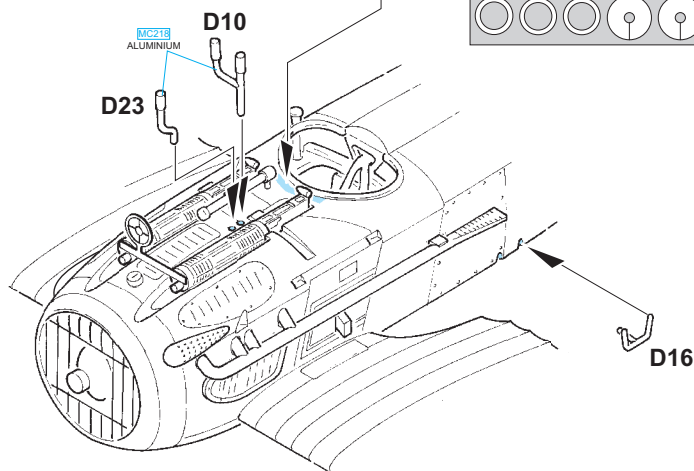
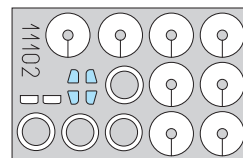
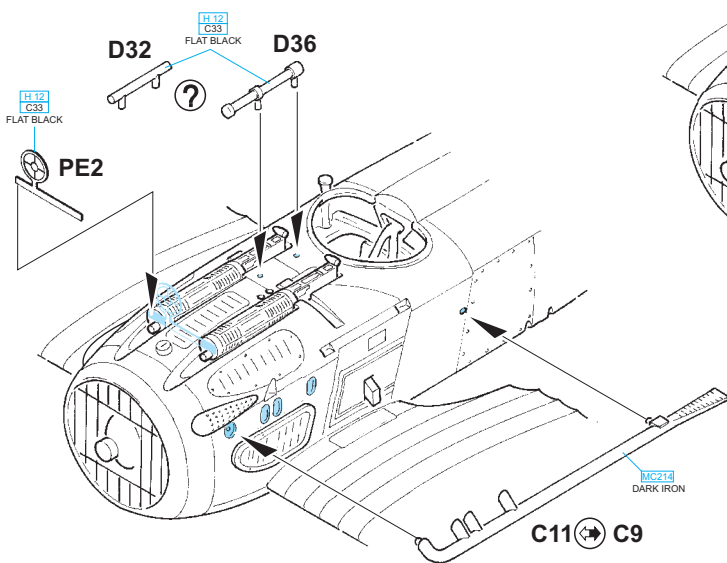
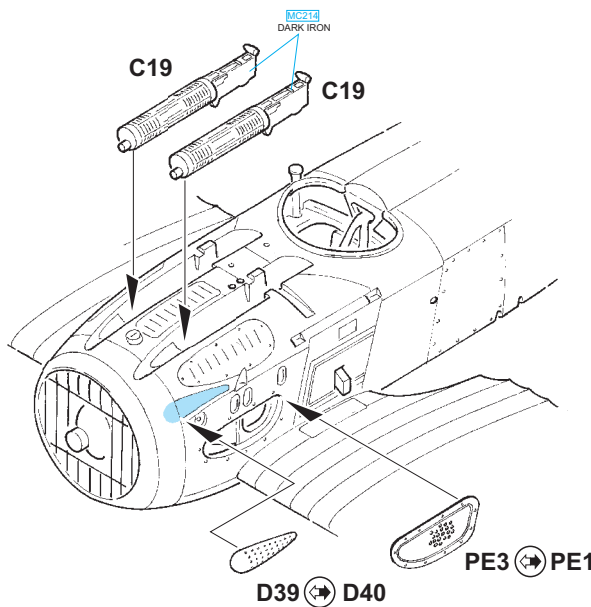
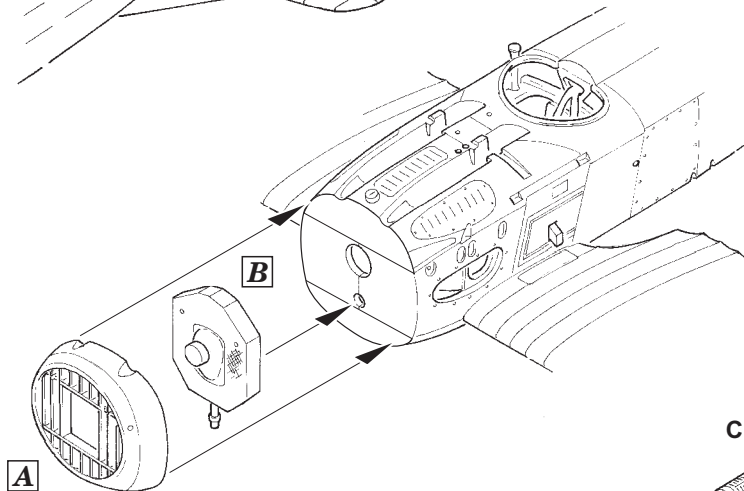
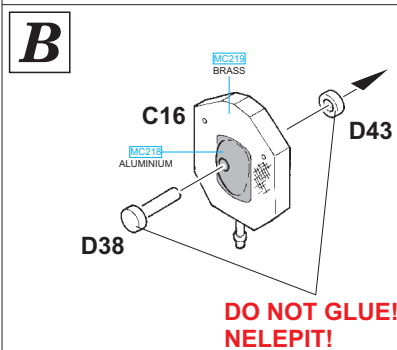
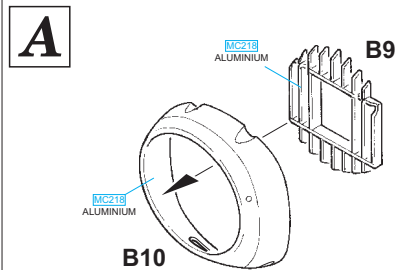
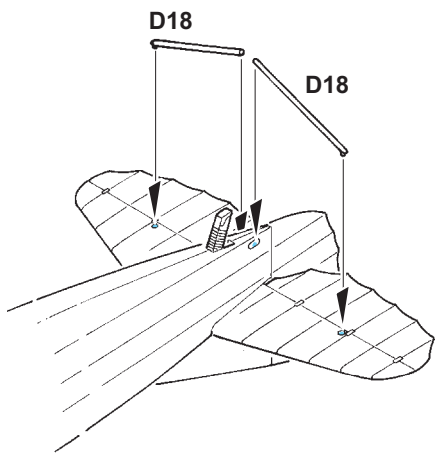

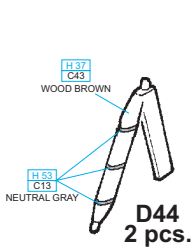

**D44**  
2 pcs.

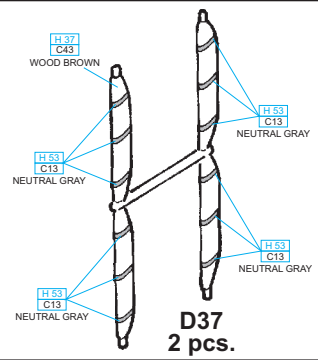

**D37**  
2 pcs.

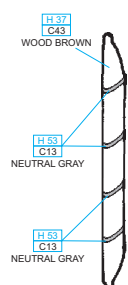

**D2, D3,**  
**D13,**  
**D14**

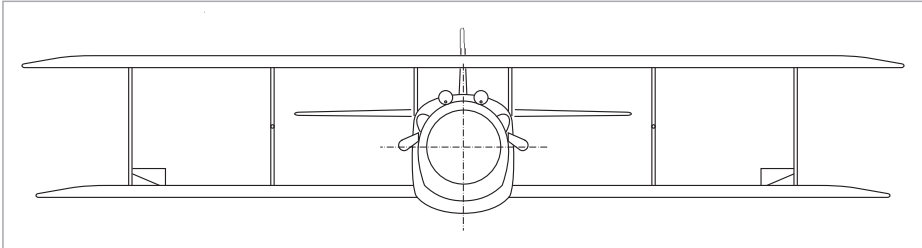
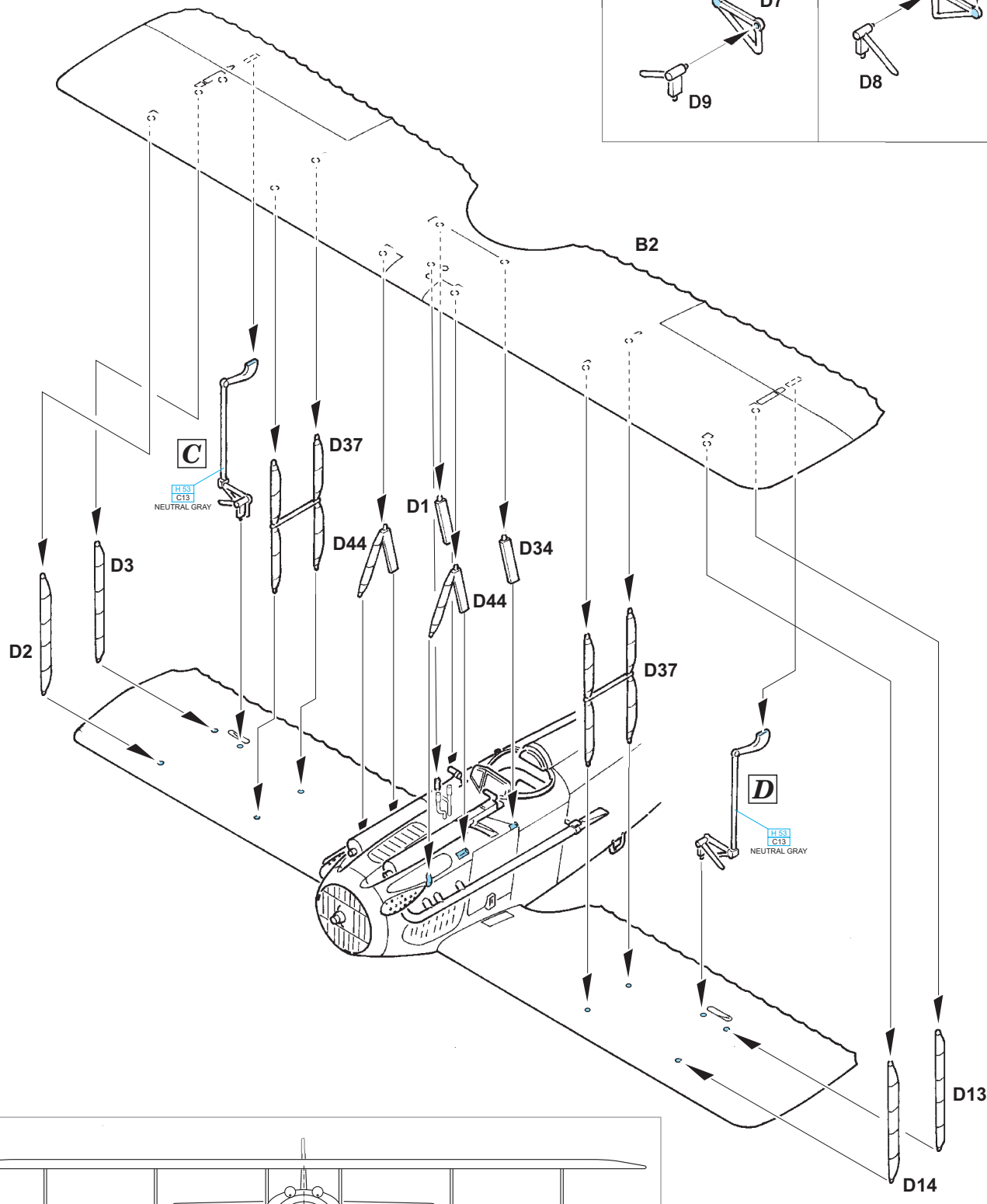
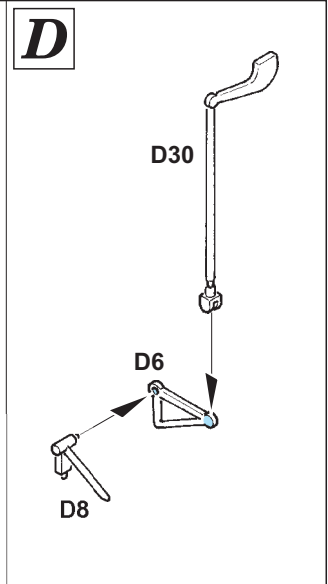
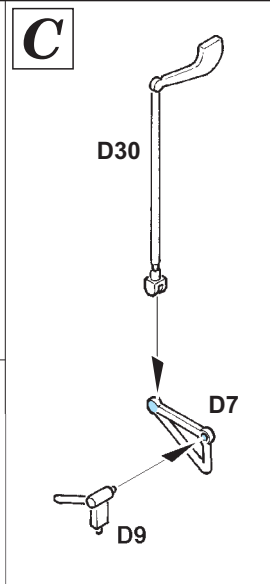

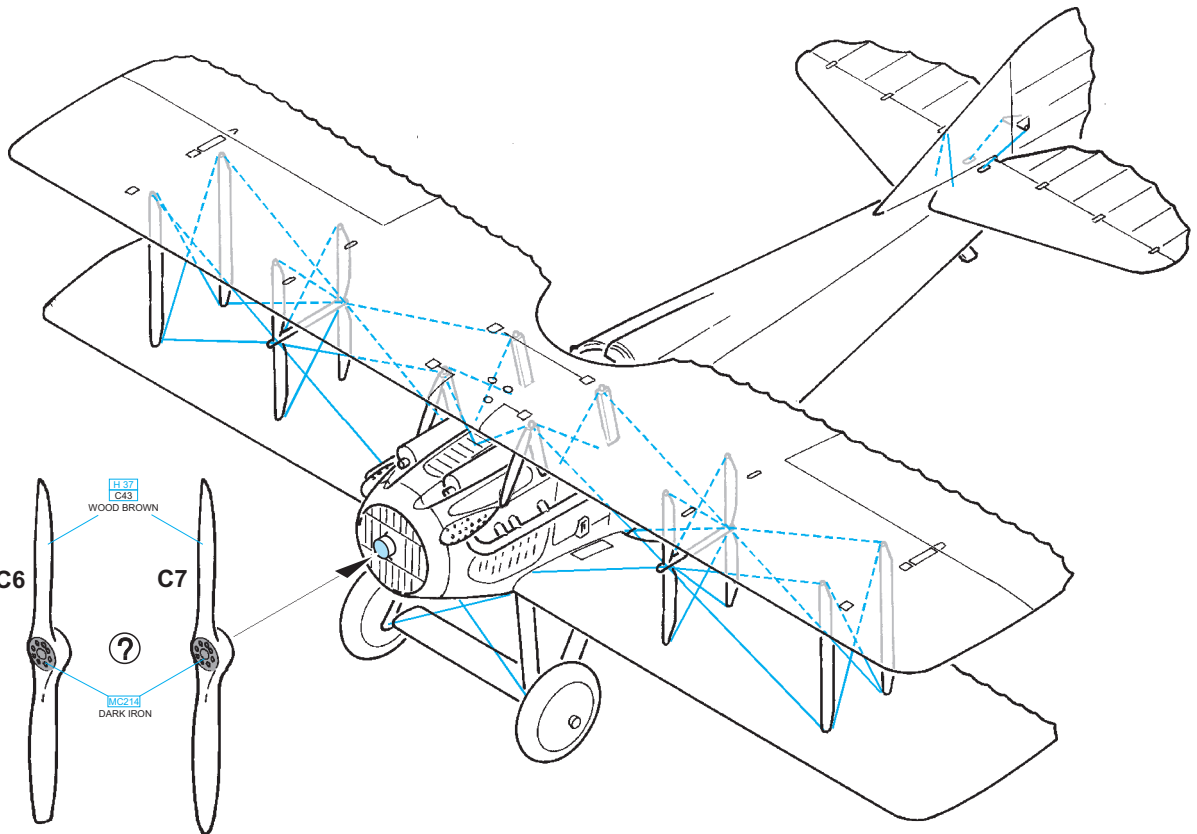
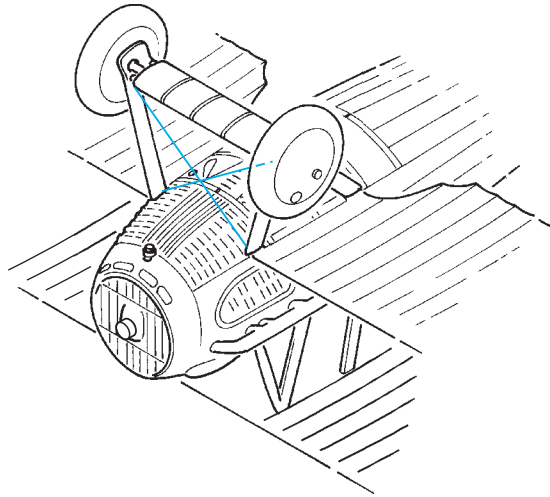
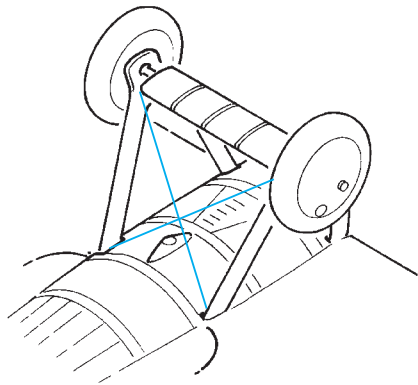
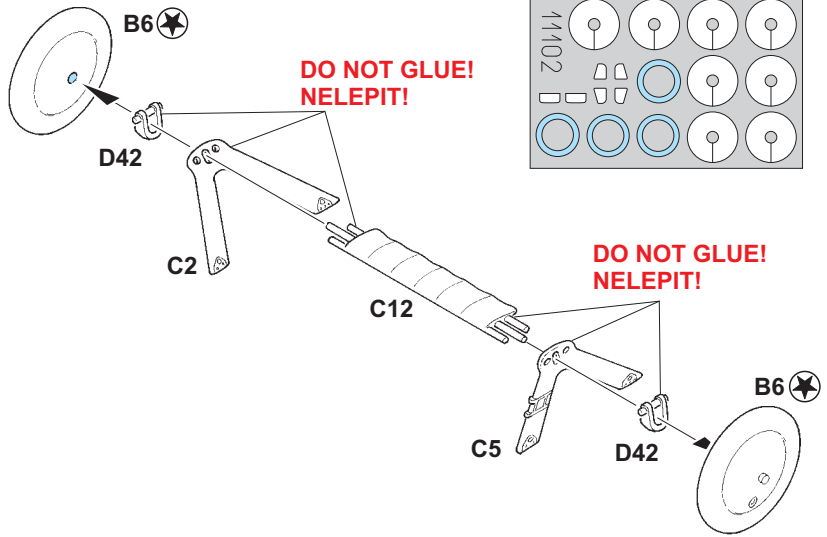
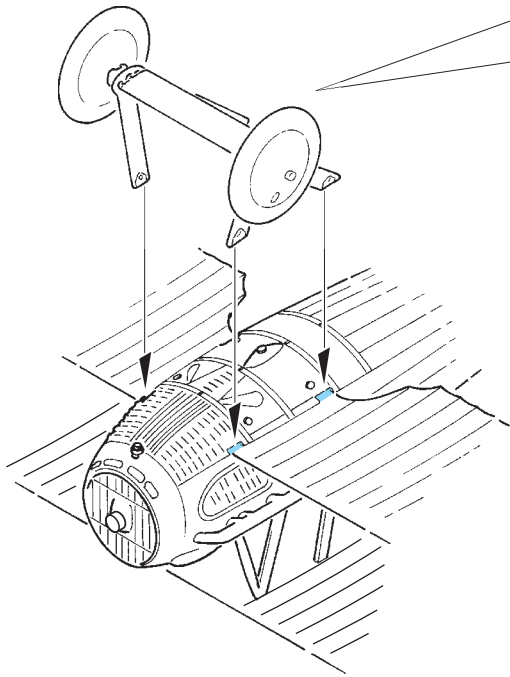

# B SPAD XIII, Lt. Frank Luke Jr., 27th Aero Squadron, September 1918

One of the SPAD XIII's used over the course of September, 1918 by American balloon ace, Second Lieutenant Frank Luke, pilot with the 27th Aero Squadron, USAS. All of his eighteen kills, including fourteen balloons, were gained by Luke between September 12 and 27, 1918, when he himself was killed. The SPAD shown sports one of two camouflage schemes used by the firm Bleriot. Frank Luke was not only known as an excellent fighter pilot, but also as an overall undisciplined soloist.

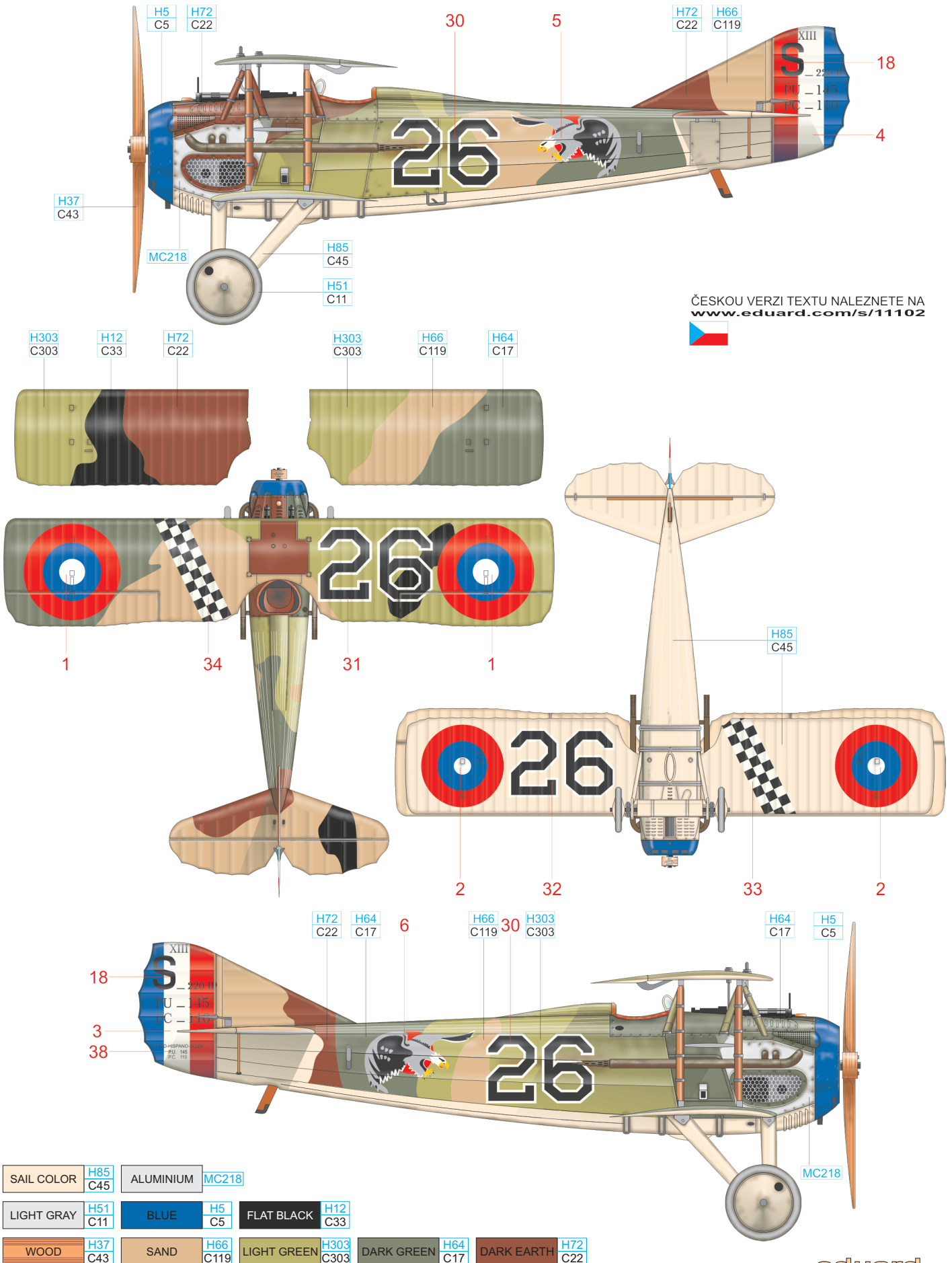

ČESKOU VERZI TEXTU NALEZNETE NA  
[www.eduard.com/s/11102](http://www.eduard.com/s/11102)



SAIL COLOR **H85**  
**C45** ALUMINIUM **MC218**

LIGHT GRAY **H51**  
**C11** BLUE **H5**  
**C5** FLAT BLACK **H12**  
**C33**

WOOD **H37**  
**C43** SAND **H66**  
**C119** LIGHT GREEN **H303**  
**C303** DARK GREEN **H64**  
**C17** DARK EARTH **H72**  
**C22**