

FLAK TOWER IV HEILIGENGEISTFELD G TOWER

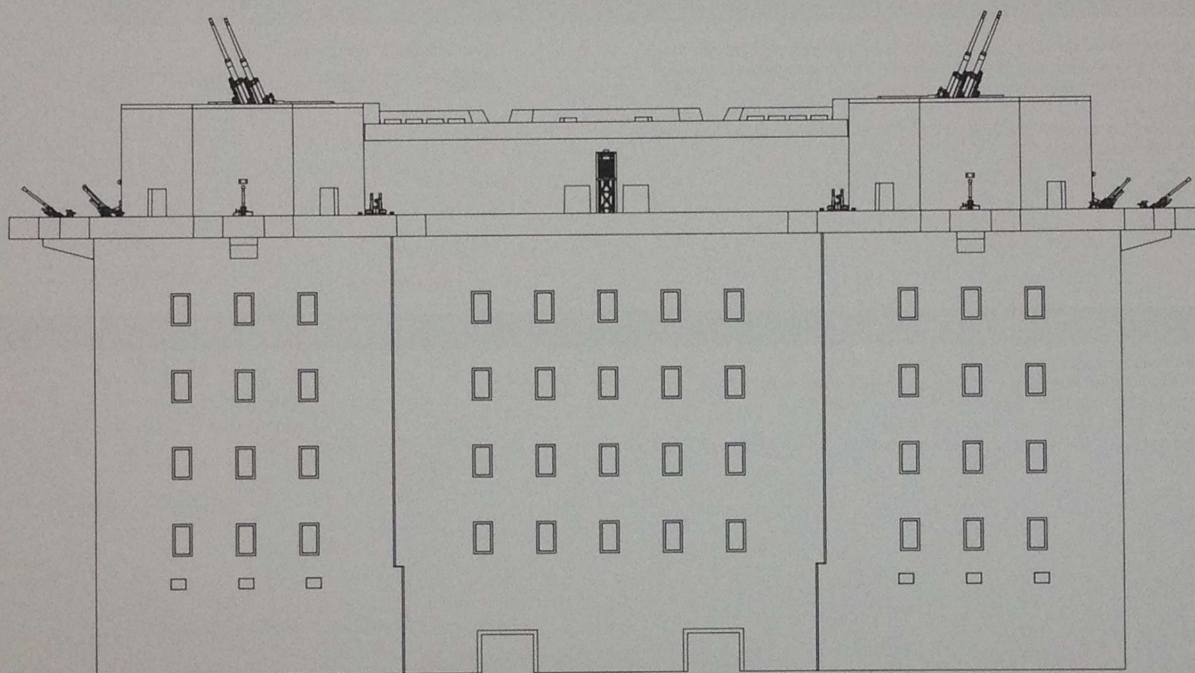

The Flaktower IV Heiligengeistfeld G Tower was a fortified flak tower built in Hamburg in 1941. It was one of multiple flak towers built to protect German cities from Allied bomber raids. The roof of the structure was armed with four twin 12.8 cm FlaK 40 mounts (See Takom no.2023). Each barrel could fire 10 to 12 rounds a minute, meaning each twin mounted battery was rated to fire a maximum of 24 rounds a minute, and all four twin mounts combined could fire as many as 96 rounds a minute. Small 20mm & 37mm anti-aircraft guns were mounted on lower platforms to protect the big guns from low-level attacks.

The Flaktower contained a cellar and six upper floors above it, but the tower itself rose to roughly the height of a 13-story building. The second floor was used to house the most priceless and irreplaceable holdings of 14 museums from Berlin. The third floor featured a hospital with 85 beds. In addition, the tower house was designed to be used as a civilian air-raid shelter.

03.02.6005

READ BEFORE ASSEMBLY

CAUTION

- Read carefully and fully understand the instructions before commencing assembly. A supervising adult should also read the instructions if a child assembles the model.
- When assembling this kit, tools including knives used. Extra care should be taken to avoid personal injury.
- Keep out of reach of small children. Children must not be allowed to suck any part, or pull vinyl bag over their heads.



Be Careful



Instant Glue
for Metal

PAINTS REQUIRED

Color info and profiles by Mig Jimenez

A.MIG-0002 Olive Green

A.MIG-0008 Dunkelgrau

A.MIG-0009 Grey

A.MIG-0070 Stone Grey

APPLYING DECALS

1. Clean the model surface with a wet cloth.
2. Cut out each decal design from sheet, and dip it in tepid water for 15-20 sec.
3. Hold the backing sheet edge and slide decal onto the model.
4. Move decal into position by wetting decal with finger.
5. Press decal gently down with a soft cloth until excess water and air bubbles are gone.

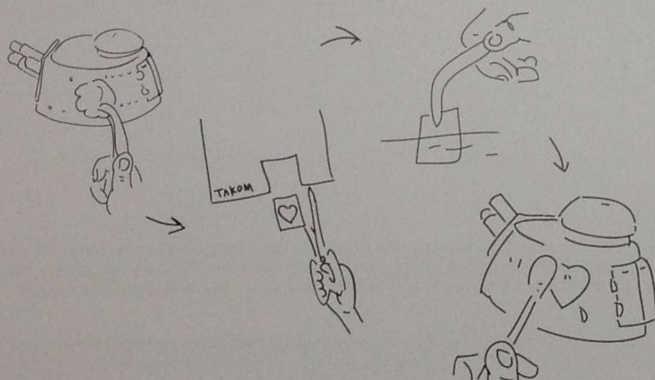

REMOVING PE

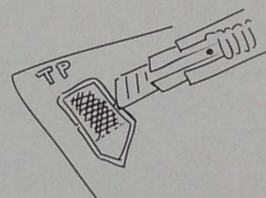

Be careful not to hurt when removing PE parts.

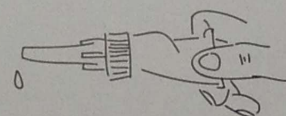

Secure using instant glue (not included).

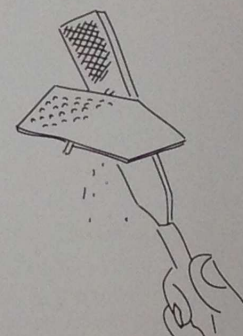

Finish using file.

PARTS

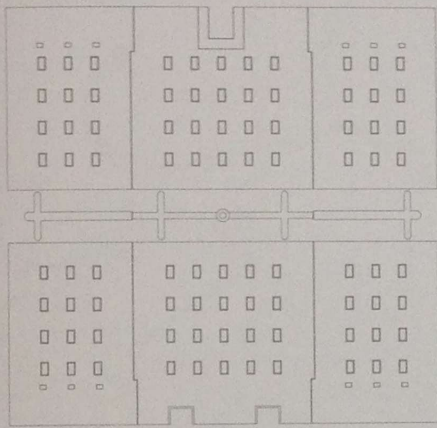

X2

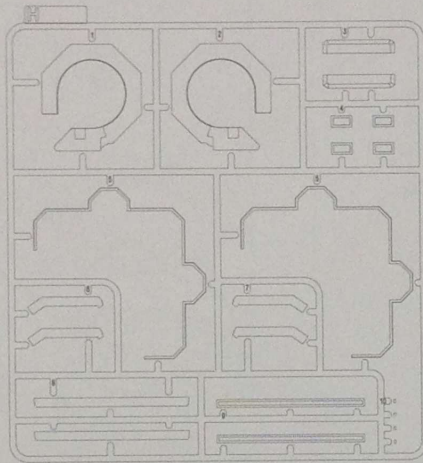

X2

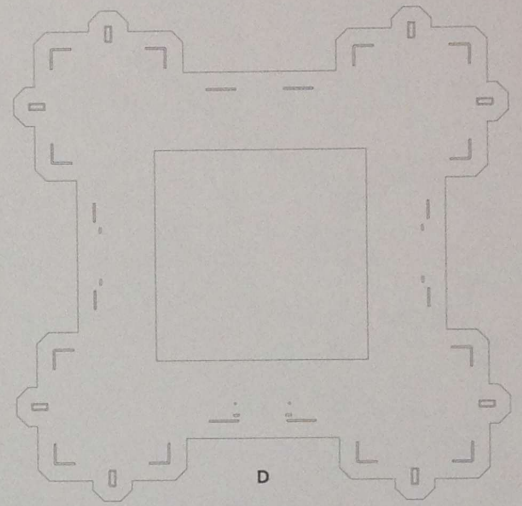

D

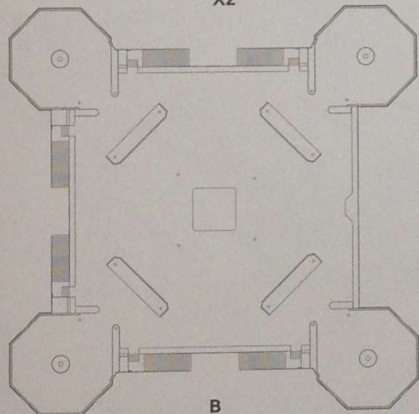

B

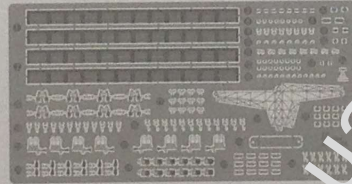
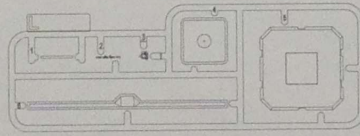

TP

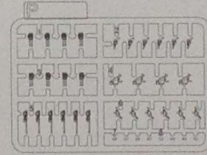

X2

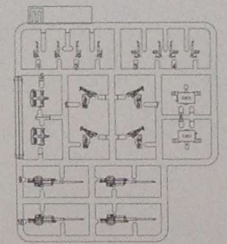

X2

1

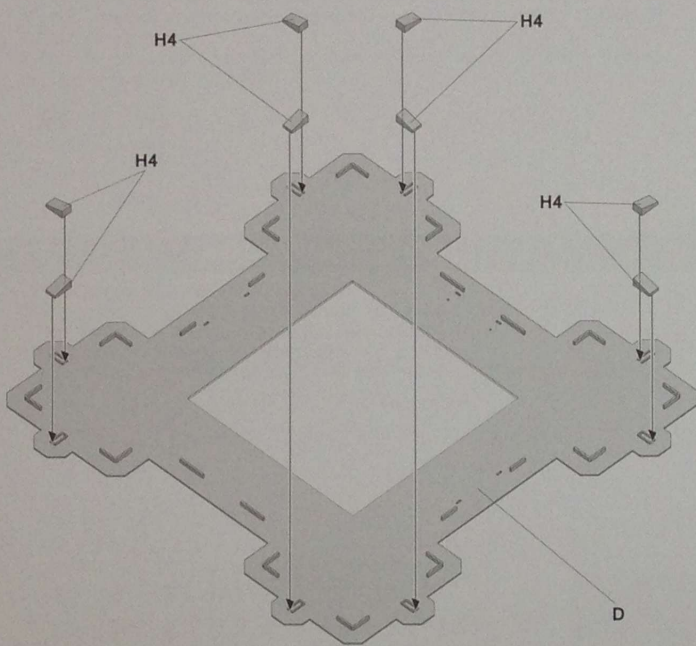

2

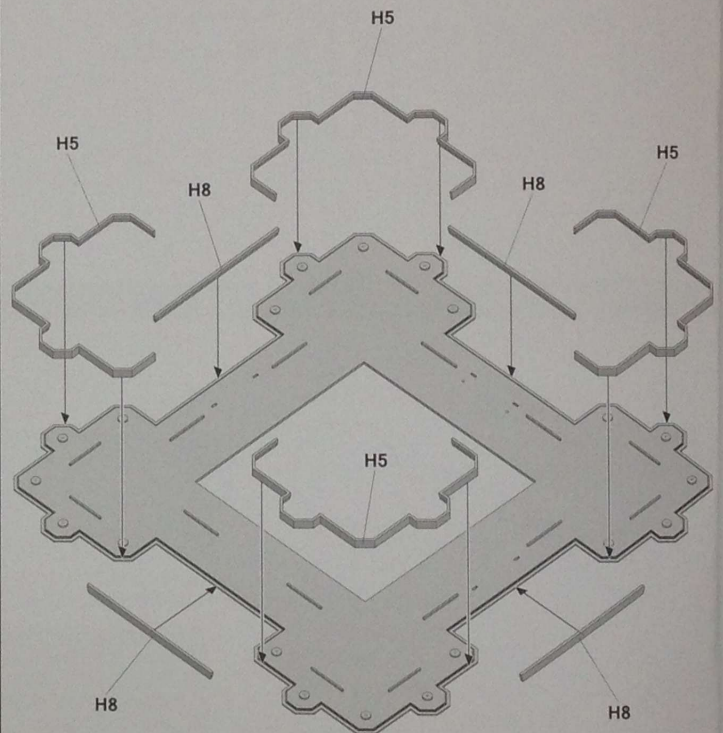

3

3

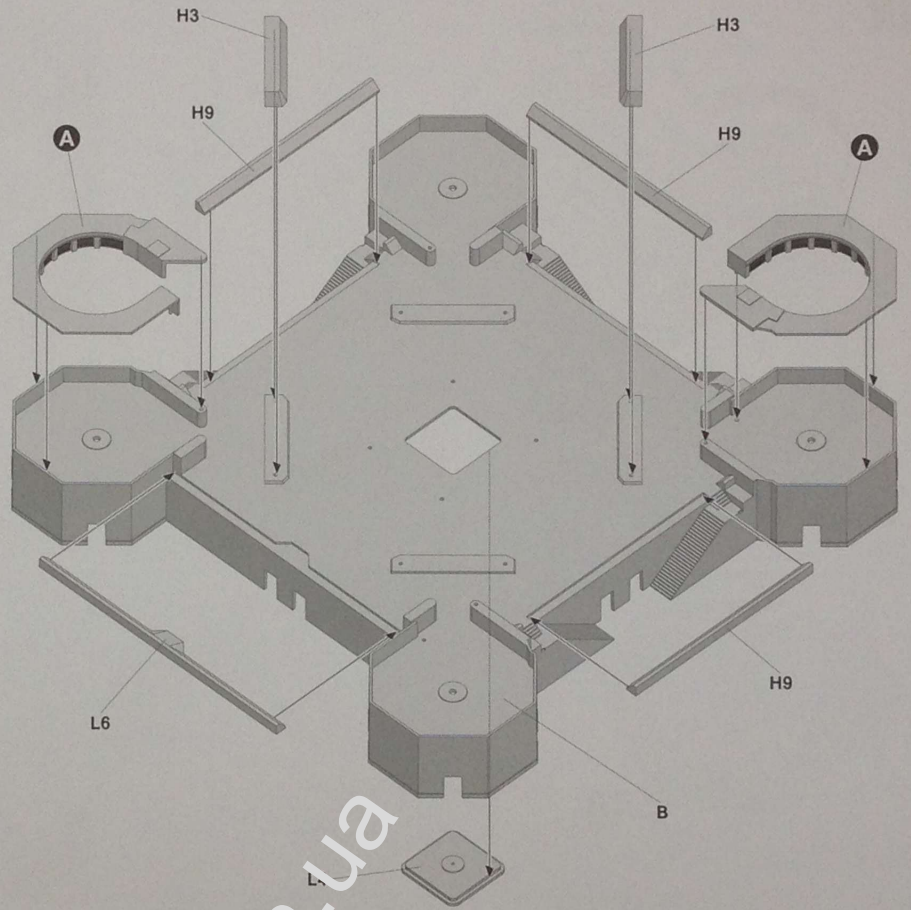
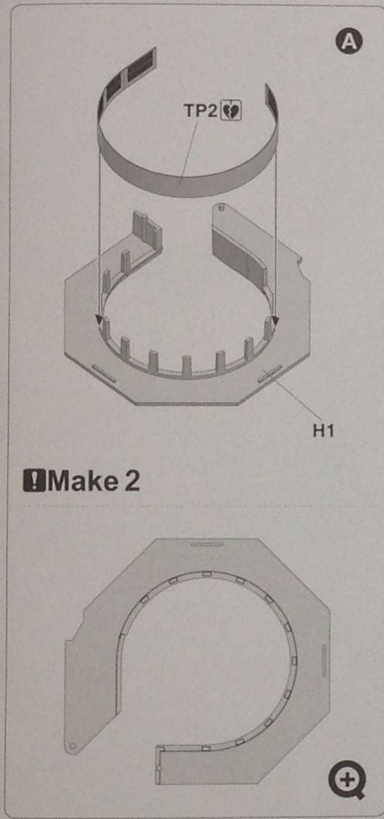

4

4

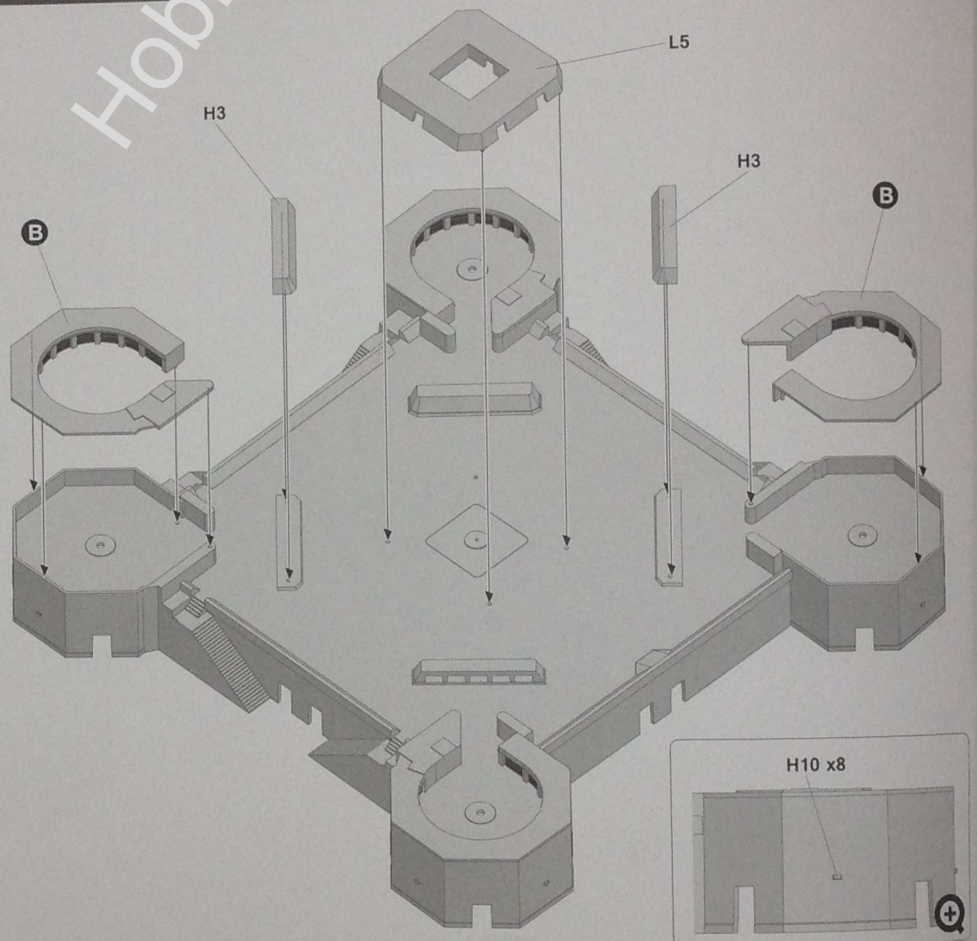
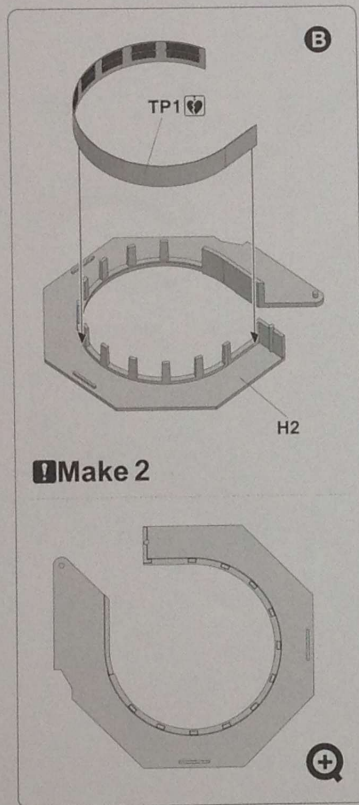

5

5

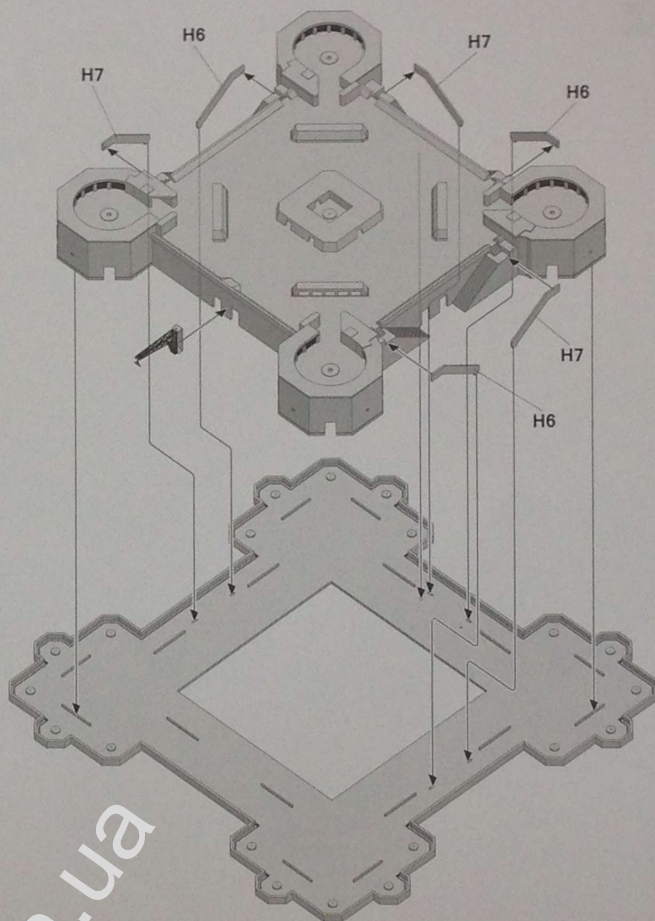
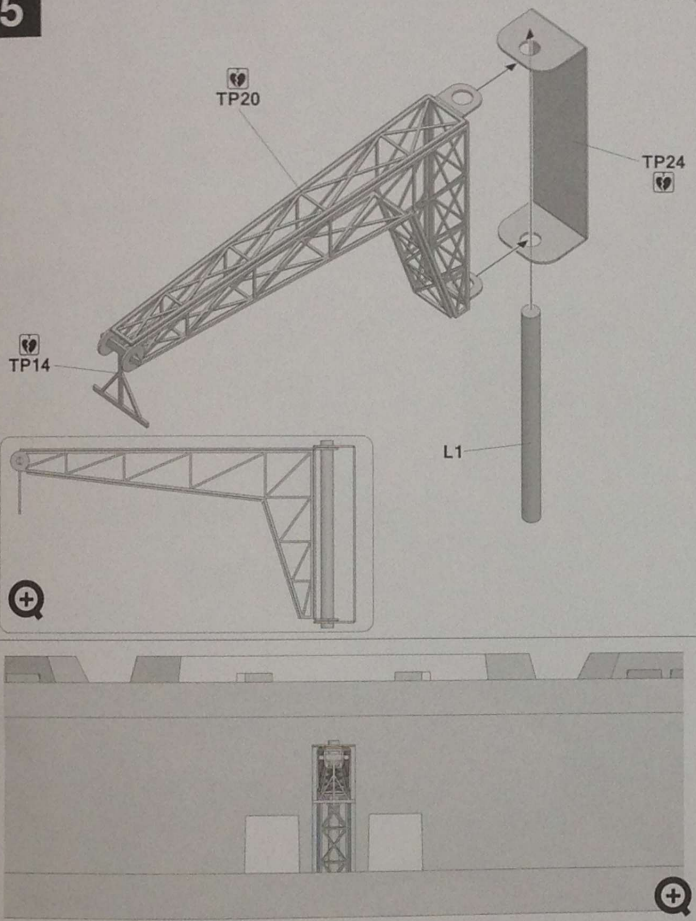

6

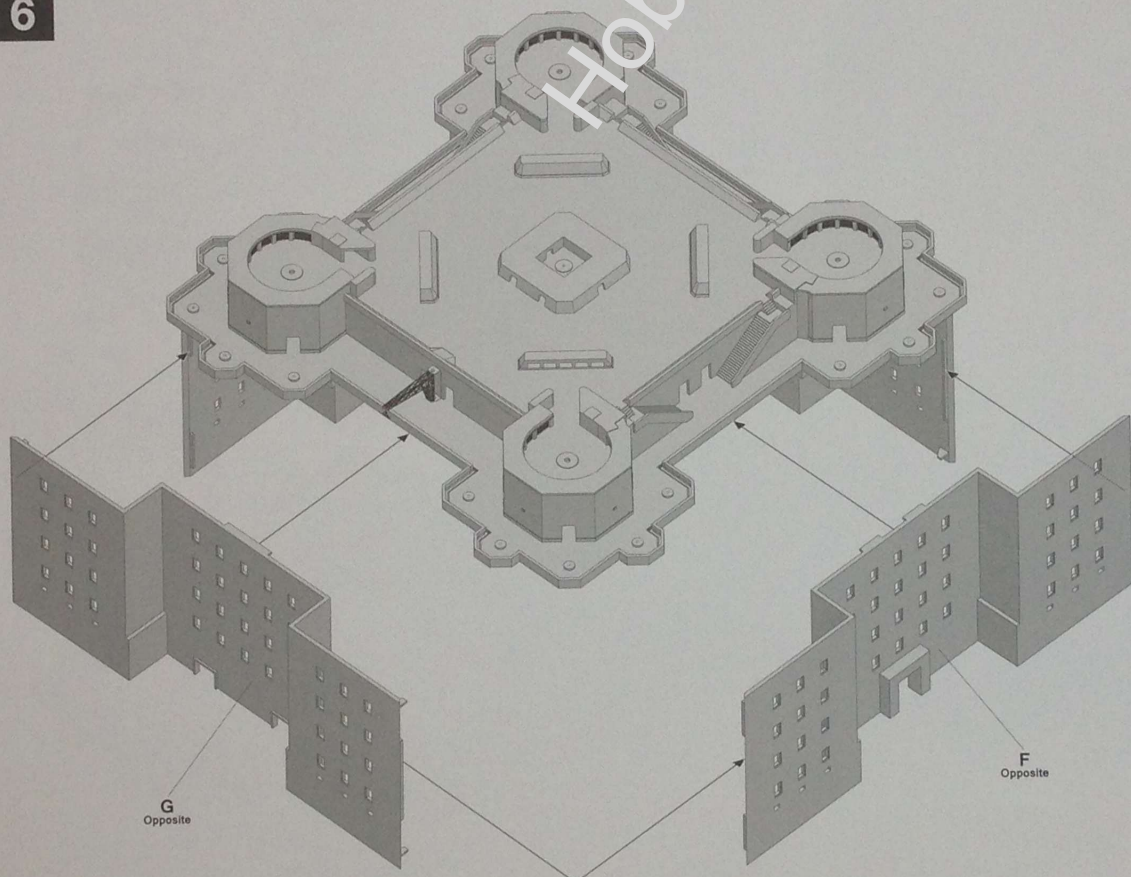

7

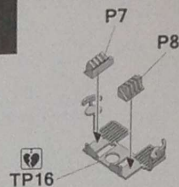

Make 8

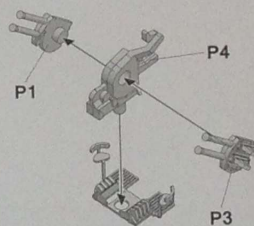

Make 8

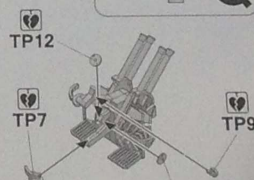
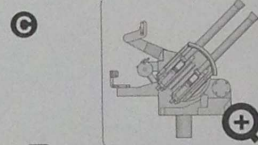

Make 8

7

8

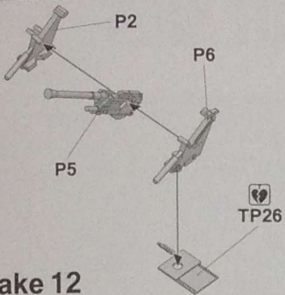

Make 12

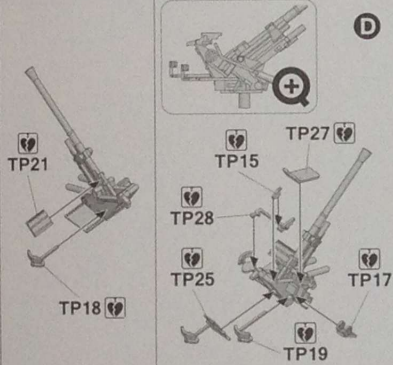

Make 12

Make 12

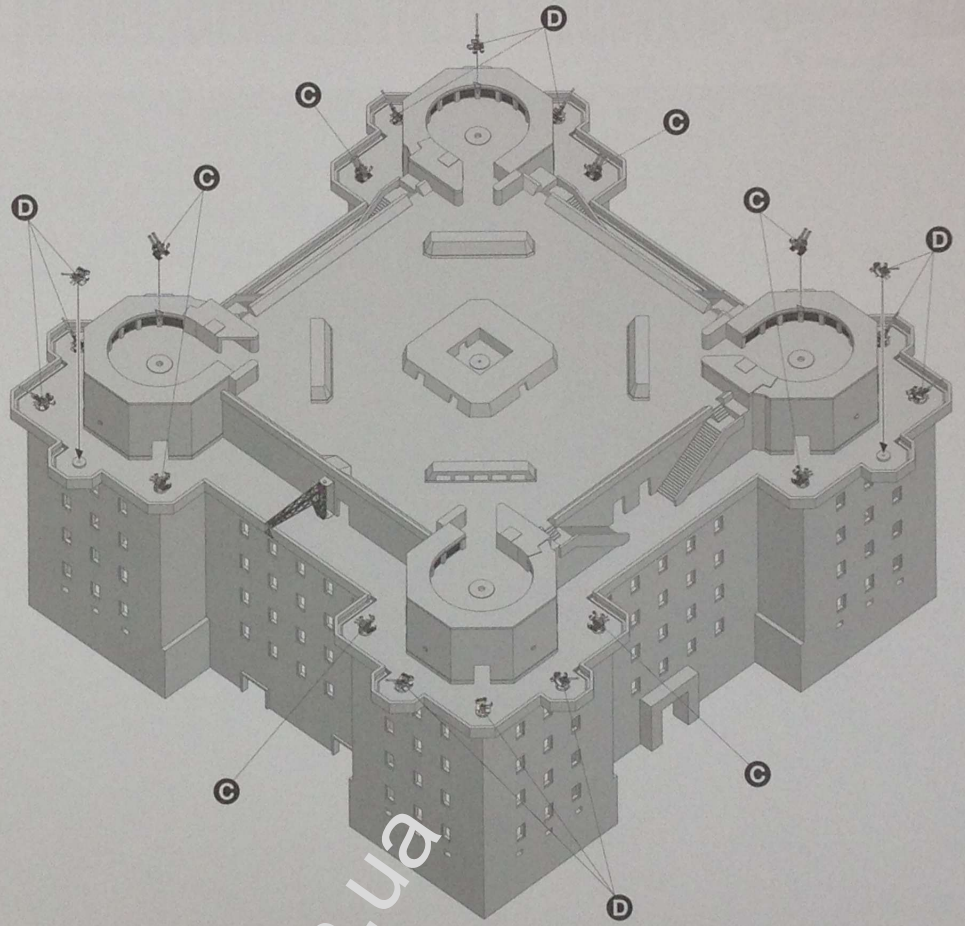
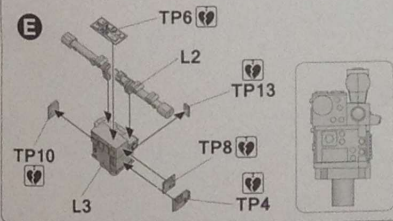

9

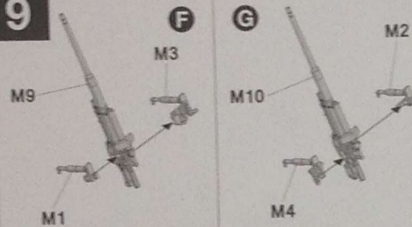

Make 4

Make 4

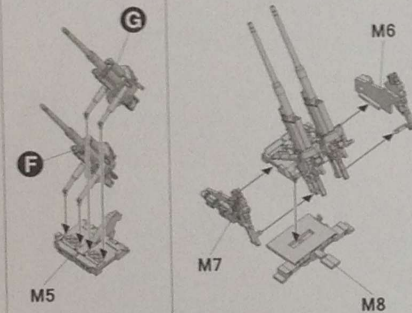

Make 4

Make 4

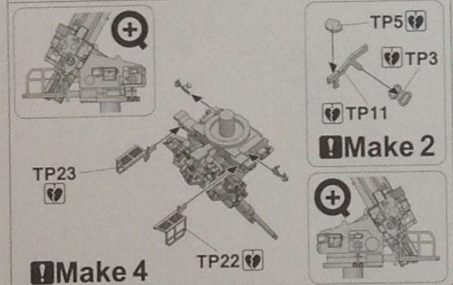

Make 4

Make 2

